

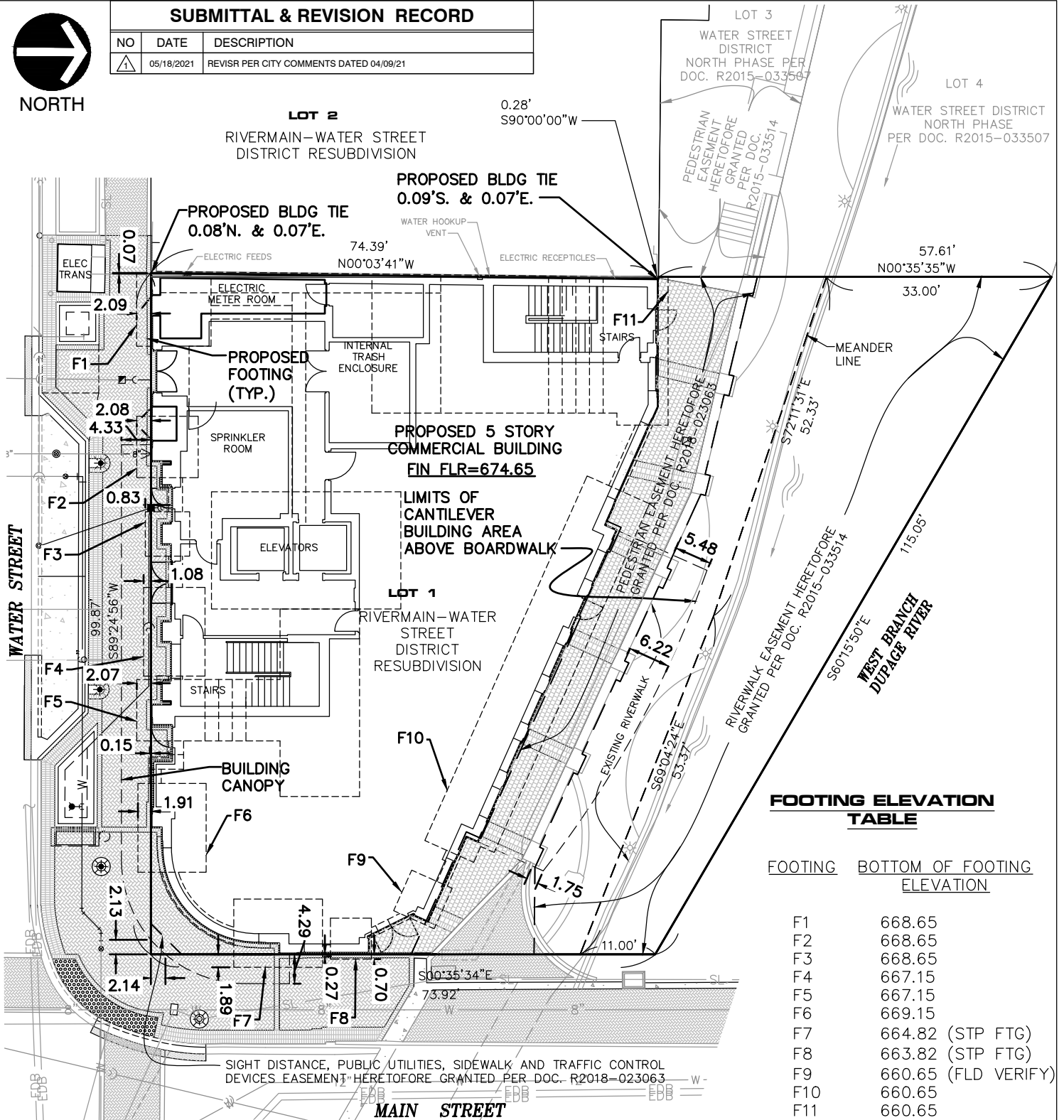

NORTH

SUBMITTAL & REVISION RECORD

NO	DATE	DESCRIPTION
1	05/18/2021	REVISOR PER CITY COMMENTS DATED 04/09/21



REFERENCE

1. ARCHITECTURAL AND FOUNDATION FOOTING INFORMATION PROVIDED BY CHARLES VINCENT GEORGE ARCHITECTS. ELEVATIONS SHOWN ARE BASED ON FINISH FLOOR: 100.00' = 674.65

SCALE IN FEET

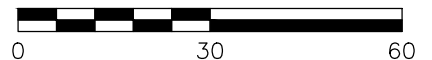

Civil & Environmental Consultants, Inc.

1230 East Diehl Road, Suite 200 - Naperville, IL 60563

630-963-6026 · 877-963-6026

www.cecinc.com

RIVER MAIN NAPERVILLE LLC

RIVER MAIN

315 S. MAIN STREET

NAPERVILLE, ILLINOIS 60540

ENCROACHMENT AGREEMENT

EXHIBIT 01

DRAWN BY:	SRH	CHECKED BY:	JGC	APPROVED BY:	JGC	FIGURE NO.:
DATE:	11/30/2020	DWG SCALE:	1"=30'	PROJECT NO:	196-520.AW00	EX01