

Document Record:

Issue Date:	Description
05.01.2019	CLIENT REVIEW #1
02.07.2020	ISSUED FOR CITY: CONCEPT MEETING
02.24.2020	CLIENT REVIEW # 2
03.03.2020	ISSUED FOR CITY: BRB MEETING
03.10.2020	ISSUED FOR CITY: BRB MEETING
07.14.2020	ISSUED FOR CITY: OUTDOOR PLAY
08.28.2020	ISSUED FOR CITY: OUTDOOR PLAY
01.31.2021	ISSUED FOR PLANNING & ZONING (STAFF REVIEW-1)
04.15.2021	ISSUED FOR PLANNING & ZONING (STAFF REVIEW-2)

DO NOT SCALE THE DRAWING. Purohit Architects, Inc. ASSUME NO RESPONSIBILITY FOR USE OF INCORRECT SCALE. CONTRACTOR SHALL VERIFY ALL EXISTING CONDITIONS PRIOR TO PROCEEDING WITH CONSTRUCTION. IN THE EVENT THAT THE CONTRACTOR DISCOVERS ANY ERROR, OMISSION OR CONFLICT, THE CONTRACTOR SHALL IMMEDIATELY NOTIFY THE OWNER OR THE ARCHITECT AND SEEK CORRECTION OR INTERPRETATION THEREOF PRIOR TO STARTING THE AFFECTED WORK.

THESE PLANS AND SPECIFICATIONS ARE PROTECTED UNDER FEDERAL COPYRIGHT LAWS. Purohit Architects, Inc. MAINTAINS OWNERSHIP OF SUCH AND ALL RIGHTS AND PRIVILEGES. THESE DRAWINGS ARE NOT TO BE REPRODUCED OR COPIED IN WHOLE OR PART. IT IS NOT TO BE USED ON ANY OTHER PROJECT.

PROFESSIONAL DESIGN FIRM ARCHITECT CORPORATION LICENSE NO.: 18A-005943 License Expires: 04/30/2023

PA
PUROHIT
ARCHITECTS
251 BRADWELL ROAD,
INVERNESS, IL 60010
Tel. (847) 220-8037
Cell. (847) 757-1618
info@purohitarchitects.com
www.purohitarchitects.com

Daycare & After-Hours Activity Center
776 S. Route 59, Suite 123, Naperville, IL 60540
Fox River Common's Shopping Center

Issue Date: 04.15.2021
Drawn By: PAI

Sheet:
LANDSCAPE PLAN

L1.0

PAI PROJECT NUMBER
20116.00

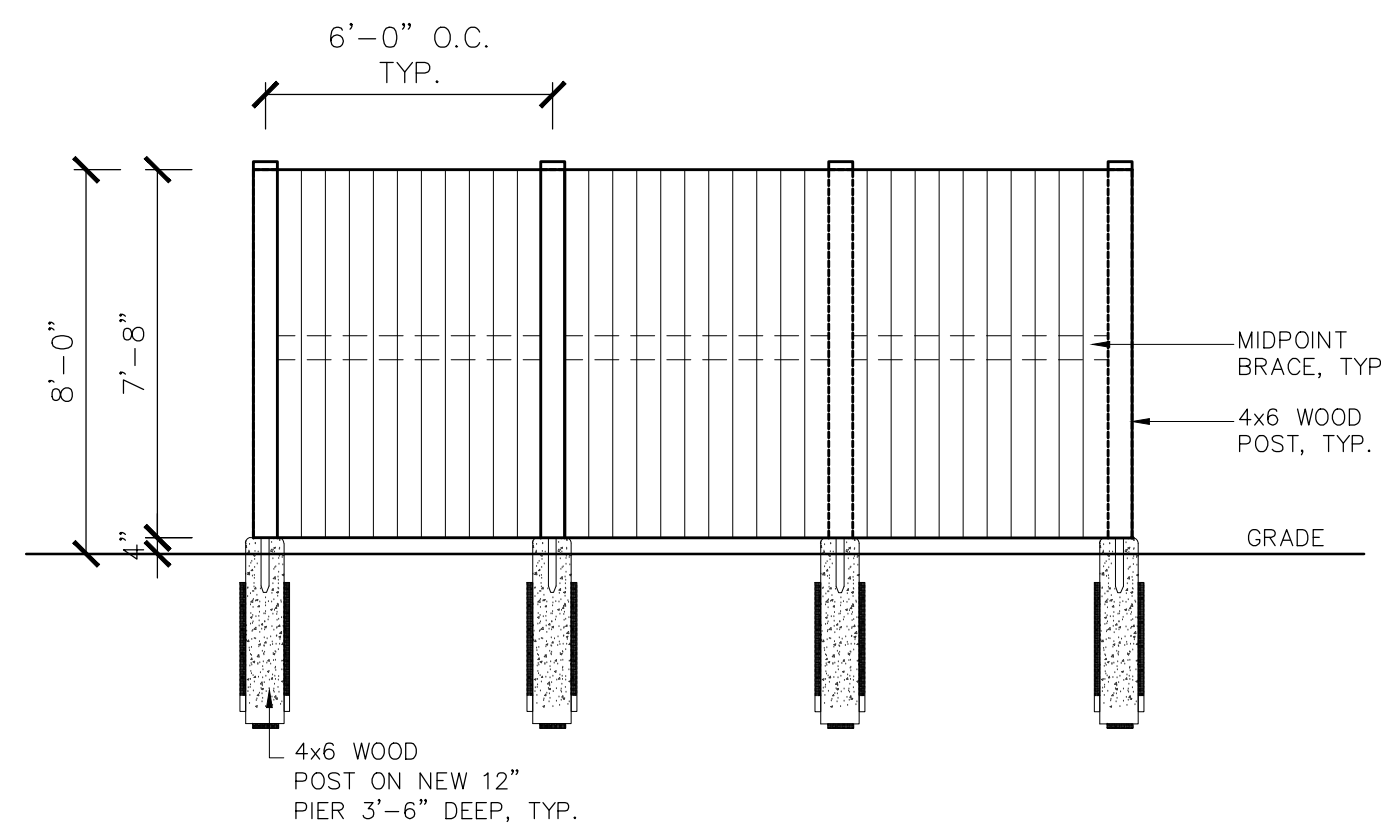

WOODEN FENCE- PARTIAL

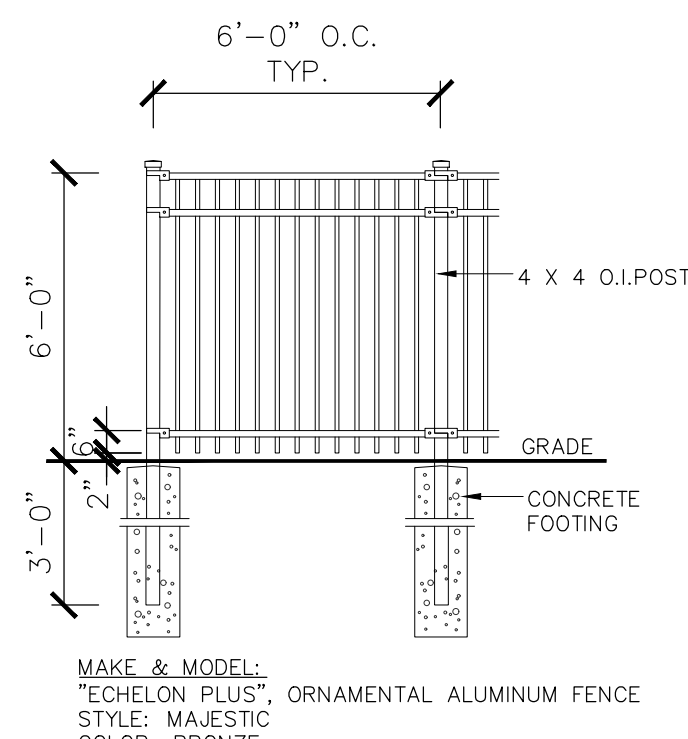

ORNAMENTAL METAL FENCE - PARTIAL

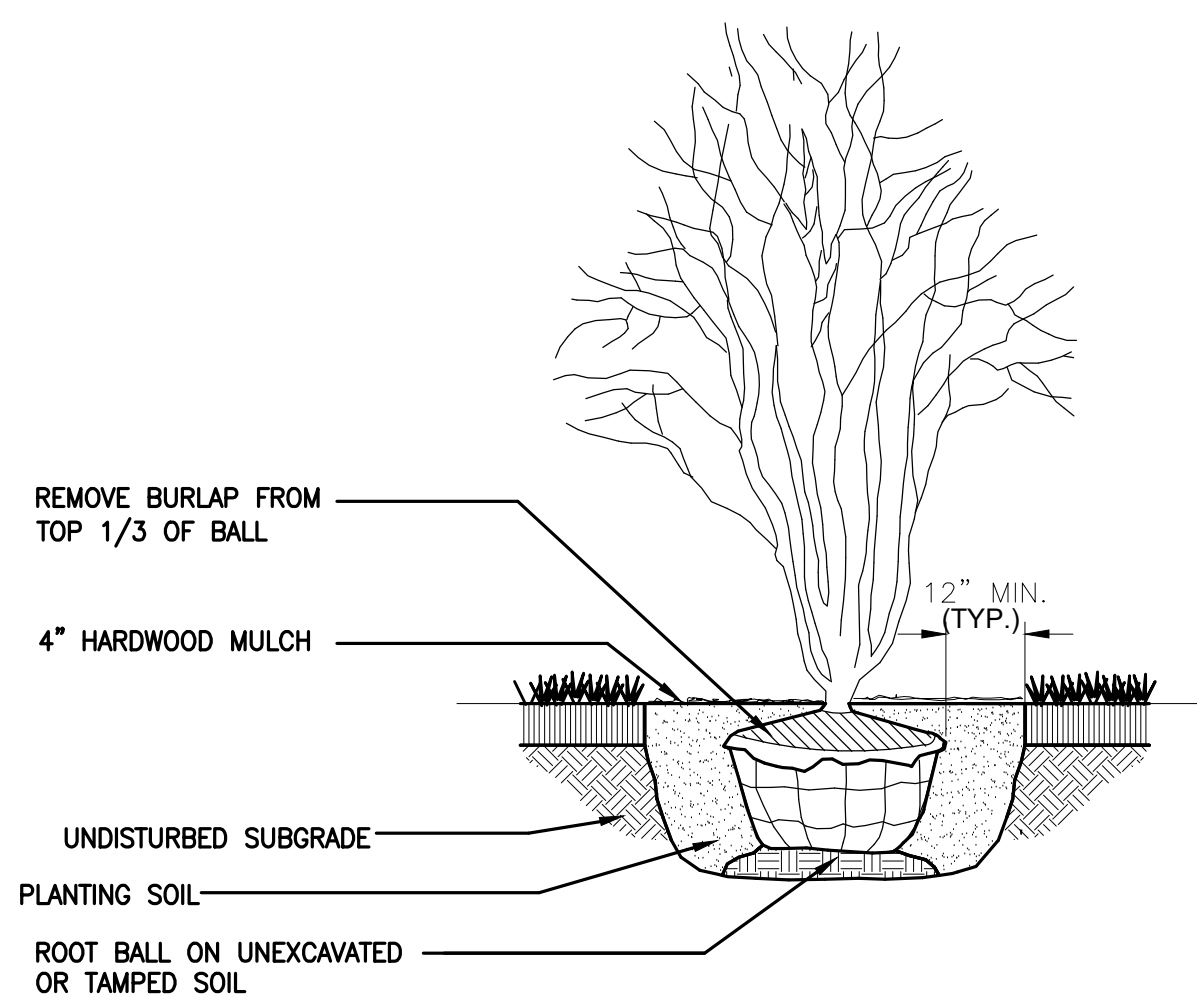

ORNAMENTAL TREE PLANTING DETAIL

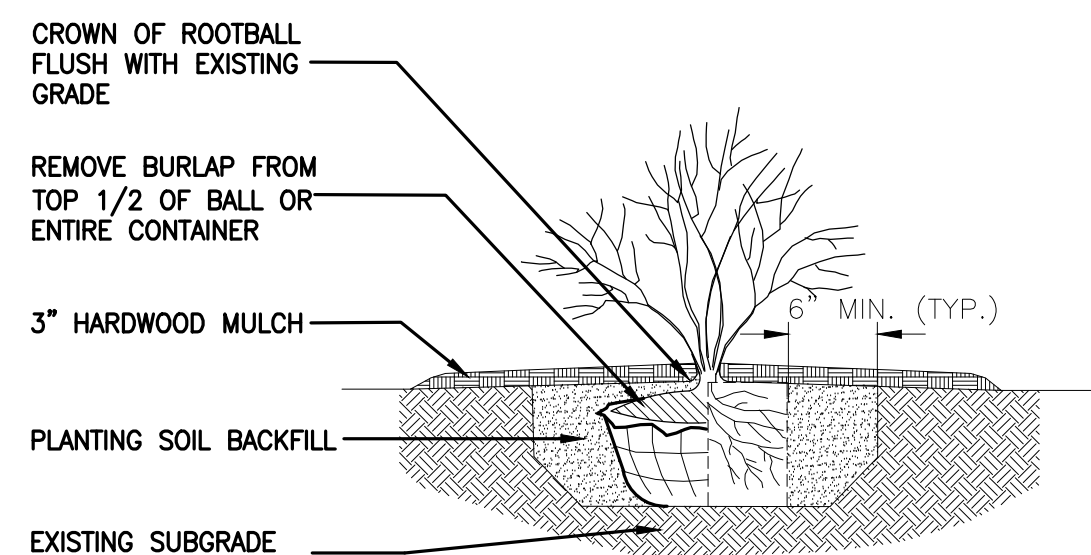

SHRUB PLANTING DETAIL

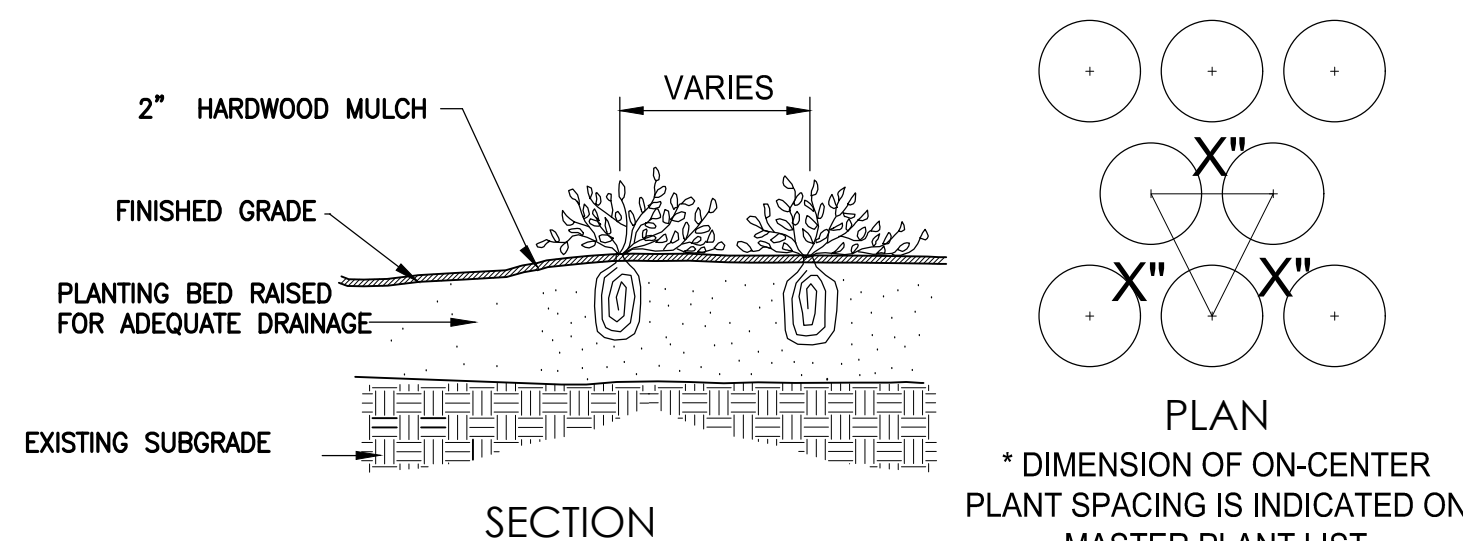

PERENNIAL PLANTING DETAIL

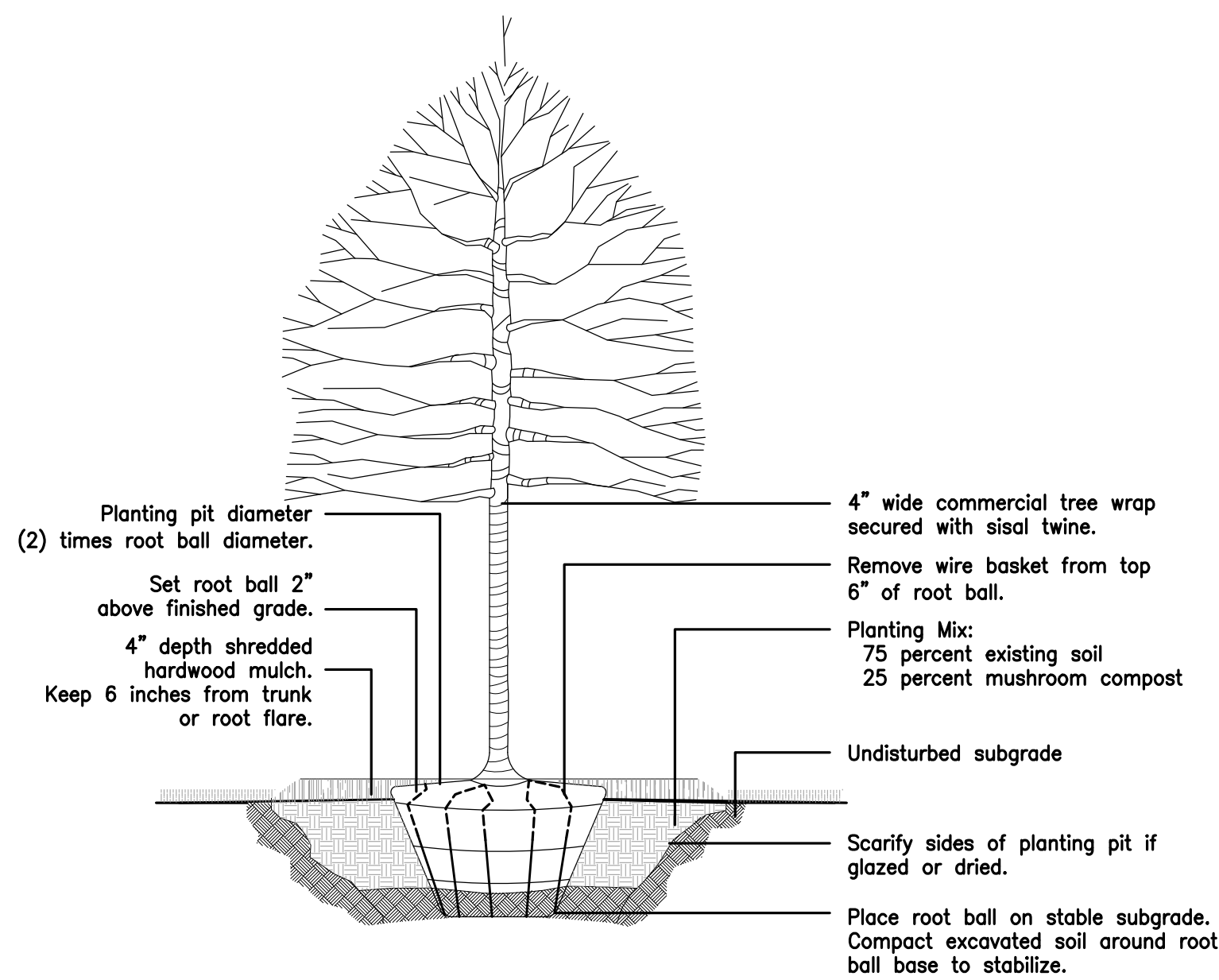

SHADE TREE PLANTING DETAIL

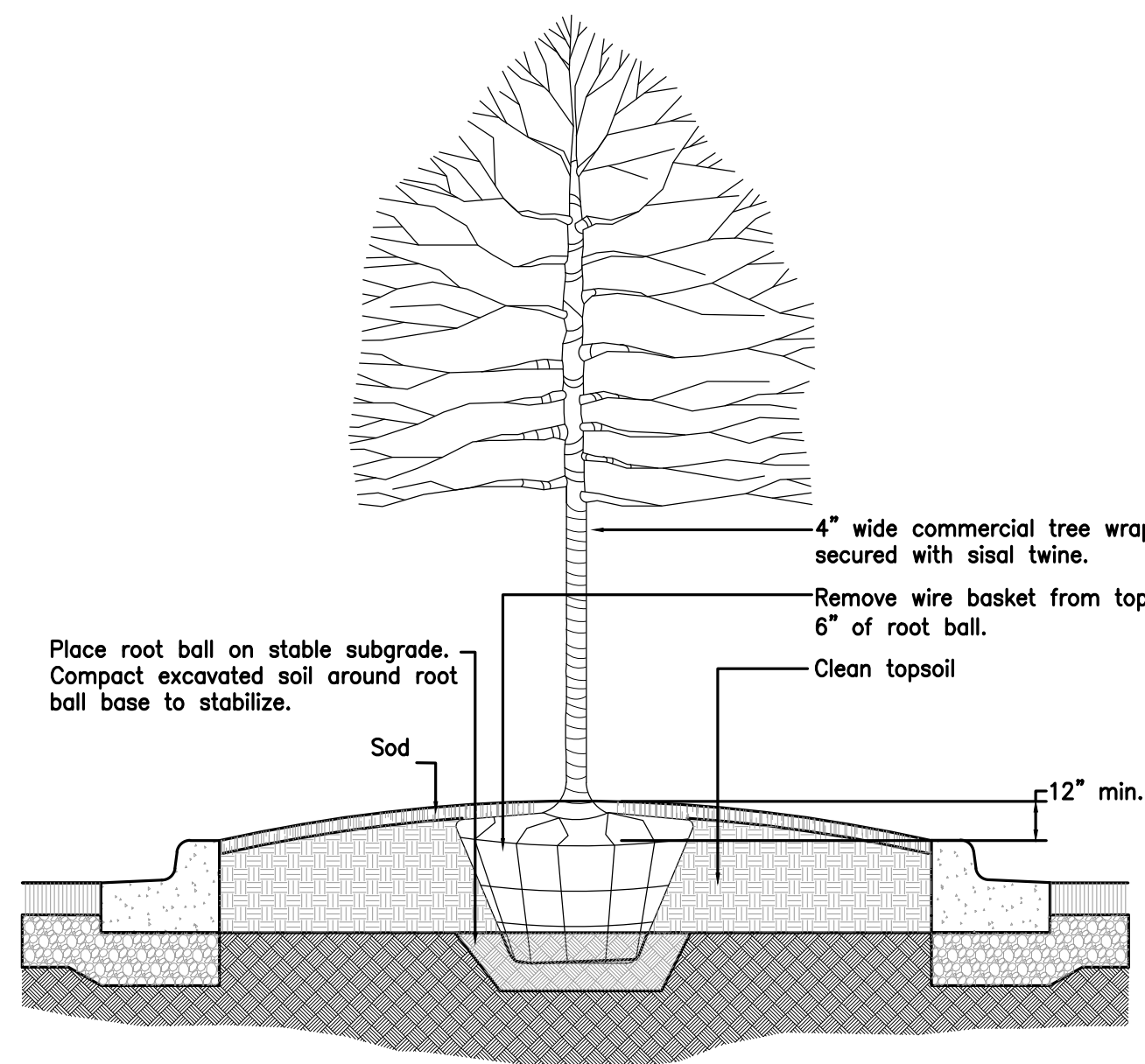

SHADE TREE PLANTING DETAIL @ PARKING LOT (NOT USED)

LANDSCAPE GENERAL NOTES

- ALL LANDSCAPE MATERIALS SHALL BE INSTALLED IN ACCORDANCE WITH ALL APPLICABLE LOCAL JURISDICTION, LANDSCAPING CODES AND ZONING ORDINANCES.
- PRIOR TO COMMENCING ANY WORK, CONTRACTOR SHALL HAVE J.U.L.I.E (811) LOCATE AND MARK ALL UNDERGROUND & OVERHEAD UTILITY FACILITIES AND LINES. IF ANY CONFLICTS SHOULD EXIST BETWEEN UTILITIES AND PROPOSED MATERIAL LOCATIONS, FIELD ADJUSTMENTS MUST BE APPROVED BY THE LANDSCAPE ARCHITECT PRIOR TO INSTALLATION.
- CONTRACTOR SHALL OBTAIN ALL NECESSARY LOCAL PERMITS AND PERMISSIONS TO INSTALL THE PROPOSED IMPROVEMENTS.
- THE LANDSCAPE CONTRACTOR SHALL PROVIDE THE OWNER A BONDED WRITTEN ONE-YEAR WARRANTY AGREEMENT (BEGINNING ON THE OWNER'S POSSESSION DATE). THIS AGREEMENT SHALL COVER MAINTENANCE, REPAIR, AND REPLACEMENT OF ALL DEAD OR DAMAGED LANDSCAPING TO PRESERVE THE SAME QUANTITY AND QUALITY AS INITIALLY APPROVED.
- NO MATERIALS, INCLUDING STOCKPILED SOIL, OR VEHICLES SHALL BE STORED, DRIVEN, OR PARKED WITHIN THE DRIP LINE OF ANY PRESERVED TREES
- CONTRACTOR IS RESPONSIBLE FOR PROVIDING QUANTITY TAKE-OFFS AND FOR PROVIDING SUFFICIENT MATERIALS TO COMPLETE THE JOB PER PLAN. LANDSCAPE ARCHITECT SHALL BE NOTIFIED OF ANY VARIATION TO QUANTITIES.
- CONTRACTOR SHALL VERIFY ALL EXISTING CONDITIONS IN THE FIELD PRIOR TO COMMENCEMENT OF CONSTRUCTION, AND SHALL REPORT TO LANDSCAPE ARCHITECT ANY VARIANCE OR CONDITION WHICH WOULD PREVENT ADHERENCE TO SCHEDULE, PLANS OR SPECIFICATIONS.
- WORK SHALL CONFORM TO AMERICAN STANDARD FOR NURSERY STOCK, STATE OF ILLINOIS HORTICULTURAL STANDARDS, AND LOCAL MUNICIPAL REQUIREMENTS.
- NURSERY TAGS (SPECIES, SIZE) FOR ALL SHADE TREES SHALL REMAIN ATTACHED TO TREES UNTIL FINAL APPROVAL FROM VILLAGE.
- FINE GRADE, FERTILIZE AND SOD/SEED ALL DISTURBED AREAS WITHIN THE CONSTRUCTION LIMITS AS SHOWN. ALL AREAS SHALL DRAIN COMPLETELY AND SHALL NOT POND OR PUDDLE.
- WHERE PLANTING BEDS MEET TURF AREAS, THE CONTRACTOR SHALL PROVIDE A CULTIVATED EDGE. MULCH ALL SHRUB BEDS TO THE LINE SHOWN.
- FOR TREES PLANTED IN TURF AREAS, PROVIDE 3'-0" DIAMETER MULCH RING (REMOVE EXISTING TURF) AT 4" THICK WITH A CULTIVATED EDGE.
- TREES AND SHRUBS SHALL NOT BE LOCATED CLOSER THAN TEN (10) FEET TO FIRE HYDRANTS, TRANSFORMERS OR OTHER ABOVE GROUND UTILITIES AND AND 5 FEET FROM MANHOLES. ANY DISCREPANCY ON THE PLAN RELATED TO THESE PROXIMATE UTILITIES SHALL BE BROUGHT TO THE ATTENTION OF THE LANDSCAPE ARCHITECT FOR RESOLUTION.
- ALL SHADE/OVERSTORY TREES SHALL HAVE A 'CENTRAL LEADER'.
- THE CONTRACTOR IS RESPONSIBLE FOR PROTECTING ALL EXISTING VEGETATION TO BE PRESERVED.
- ALL PLANT MATERIALS (EXCEPT FOR GROUNDCOVER, ANNUALS, AND PERENNIALS) SHALL BE BALLED AND BURLAPPED STOCK AND MEET CURRENT STANDARDS OF THE AMERICAN ASSOCIATION OF NURSERYMEN'S STANDARD FOR NURSERY STOCK (ANSI 260.1-1986) OR EQUAL. PLANT MATERIALS MUST BE SUPPLIED WITHIN A 150 MILE RADIUS OF PROJECT SITE WITHIN NORTHEAST ILLINOIS. CONTRACTOR MAY SUBSTITUTE CONTAINER STOCK FOR SHRUBS IF SIZES ARE EQUAL TO SPECIFIED B&B STOCK, WITH THE APPROVAL OF THE LANDSCAPE ARCHITECT.
- SOIL IN GROUNDCOVER BEDS SHALL BE AMENDED USING 2 INCHES OF MUSHROOM COMPOST INCORPORATED INTO THE TOP 4 INCHES OF SOIL.
- DISTURBED AREAS TO RECEIVE SOD SHALL BE TILLED TO 6" DEPTH AND FINE GRADED TO PROVIDE SMOOTH BASE SURFACE. IF EXISTING SOIL IS A MAJORITY OF CLAY OR UNSUITABLE, 2" OF FINE GRADED TOPSOIL SHALL BE ADDED PRIOR TO TILLING. EXISTING SOD AREAS SHALL HAVE TURF REMOVED WITH AUTOMATED SODCUTTER OR HAND SPACE TO REMOVE ALL BLADES AND ROOTS. 1" OF FINE GRADED TOPSOIL SHALL BE TILLED AND GRADED.
- SEEDED GRASS LAWN SHALL BE PERFORMED BY HYDROSEEDING. PRIOR TO SEEDING, 2" OF FINE TOPSOIL SHALL BE TILLED INTO EXIST SOIL MIXTURE. A MIX CONSISTING OF ROUGHLY 30 % BLUEGRASS / 30% FINE FESCUES / 40% RYE GRASSES AND TACKIFIER SHALL BE APPLIED AT MANUFACTURERS SPECIFIED RATES FOR NEW LAWNS BETWEEN 5 AND 10 LBS PER 1,000 SF.
- TREE AND SHRUB BACKFILL MIXTURE SHALL BE 2 PARTS EXIST. NATIVE TOPSOIL AND 1 PART SPHAGNUM PEAT MOSS W/ DECOMPOSED MANURE.
- ALL SHRUB BEDS AND INDIVIDUAL TREE PLANTINGS, UNLESS OTHERWISE NOTED, SHALL RECEIVE A 4 INCH LAYER OF SHREDDED HARDWOOD MULCH. ALL GROUNDCOVER, ANNUAL AND PERENNIAL BEDS SHALL RECEIVE A 2 INCH LAYER OF THE SAME MULCH MATERIAL. COSTS FOR MULCH SHALL BE CONSIDERED INCIDENTAL AND SHALL BE INCLUDED IN THE COST OF PLANTINGS.
- CONTRACTOR SHALL PROVIDE A SEPARATE ESTIMATE FOR AN AUTOMATIC UNDERGROUND IRRIGATION SYSTEM FOR COMPLETE EFFECTIVE COVERAGE OF ALL LAWN AREAS AND SHRUB BEDS. CONTRACTOR SHALL SUBMIT SHOP DRAWINGS FOR APPROVAL AND APPLY FOR ALL NECESSARY PERMITS PRIOR TO COMMENCING WORK. IRRIGATION PLANS SHALL INCLUDE HUNTER PRO-C CONTROLLER W/WIRELESS SOLAR SYNC STATION AND HUNTER SPRAYHEADS AND NOZZLES. IRRIGATION WORK SHALL BE WARRANTY ALL LABOR AND MATERIALS FOR 1 FULL YEAR AFTER INSTALLATION AND TESTING.

Document Record:

Issued Date	Description
05.01.2019	CLIENT REVIEW #1
02.07.2020	ISSUED FOR CITY: CONCEPT MEETING
02.24.2020	CLIENT REVIEW # 2
03.03.2020	ISSUED FOR CITY: BRB MEETING
03.10.2020	ISSUED FOR CITY: BRB MEETING
07.14.2020	ISSUED FOR CITY: OUTDOOR PLAY
08.28.2020	ISSUED FOR CITY: OUTDOOR PLAY
01.31.2021	ISSUED FOR PLANNING & ZONING (STAFF REVIEW-1)
04.15.2021	ISSUED FOR PLANNING & ZONING (STAFF REVIEW-2)

DO NOT SCALE THE DRAWING. Purohit Architects, Inc. ASSUME NO RESPONSIBILITY FOR USE OF INCORRECT SCALE. CONTRACTOR SHALL VERIFY ALL EXISTING CONDITIONS PRIOR TO PROCEEDING WITH CONSTRUCTION. IN THE EVENT THAT THE CONTRACTOR DISCOVERS ANY ERROR, OMISSION OR CONFLICT AS TO THE INTENT OF THE CONTRACT DOCUMENTS WITH REGARD TO THE PROPOSED DESIGN AND CONSTRUCTION OF THE WORK, THE CONTRACTOR SHALL IMMEDIATELY NOTIFY THE OWNER OR THE ARCHITECT AND SEEK CORRECTION OR INTERPRETATION THEREOF PRIOR TO STARTING THE AFFECTED WORK.

THESE PLANS AND SPECIFICATIONS ARE PROTECTED UNDER FEDERAL COPYRIGHT LAWS. Purohit Architects, Inc. MAINTAINS OWNERSHIP OF SUCH AND ALL RIGHTS AND PRIVILEGES. THESE DRAWINGS ARE NOT TO BE REPRODUCED OR COPIED IN WHOLE OR PART. IT IS NOT TO BE USED ON ANY OTHER PROJECT.

PROFESSIONAL DESIGN FIRM ARCHITECT CORPORATION LICENSE NO. 18A-005943 License Expires: 04/30/2023

PA
PUROHIT
ARCHITECTS
251 BRADWELL ROAD,
INVERNESS, IL 60010
Tel. (847) 220-8037
Cell. (847) 757-1618
info@purohitarchitects.com
www.purohitarchitects.com

Daycare & After-Hours Activity Center
776 S. Route 59, Suite 123, Naperville, IL 60540
Fox River Common's Shopping Center

Issue Date: 04.15.2021
Drawn By: PAI

Sheet: LANDSCAPE DETAILS

L2.0

PAI PROJECT NUMBER
20116.00

ECHELON PLUS®

Ornamental Aluminum Fence



PRIMARY APPLICATIONS

- Municipal Facilities
- Childcare Facilities
- Coastal Environments
- Parks & Recreation
- Schools

Echelon Plus has taken the quality and performance of aluminum ornamental fencing to a higher level. The strength characteristics of the reinforced rail and posts, coupled with a superior powder coat finish, make Echelon Plus the most durable .75" ornamental picket product on the market.

PICKETS	RAILS	POSTS	HEIGHTS
.75" SQ. x .045"	1.4375" x 1.25" x (.090" SIDE / .060" TOP) FORERUNNER RAILS	2.5" SQ. x .060"	3', 3½', 4', 4½', 5', 6' <i>Custom heights also available</i>



Echelon Plus gate options vary from swing gates for pedestrian or vehicle access to sliding gates for high-functioning points of entry. Each of these gate systems is individually constructed to provide project specific performance.

STYLES

CLASSIC™

MAJESTIC™

GENESIS™

CONQUEROR™

WARRIOR™

ADORNMENTS

QUAD
FLARE

TRIAD

ROYALTY

BALL CAP

RING
(internally secured)

BUTTERFLY
SCROLL

COLORS

Refer to color sample for actual color

BLACK

BRONZE

WHITE

Custom colors also available

