

S:\DATA\2011_13011_016B\Auturn\Auturn - Round 2\2011-016B_Auturn File v2.dwg, MASTER SITE PLAN, 12/29/2010 7:02:25 AM, S.P.

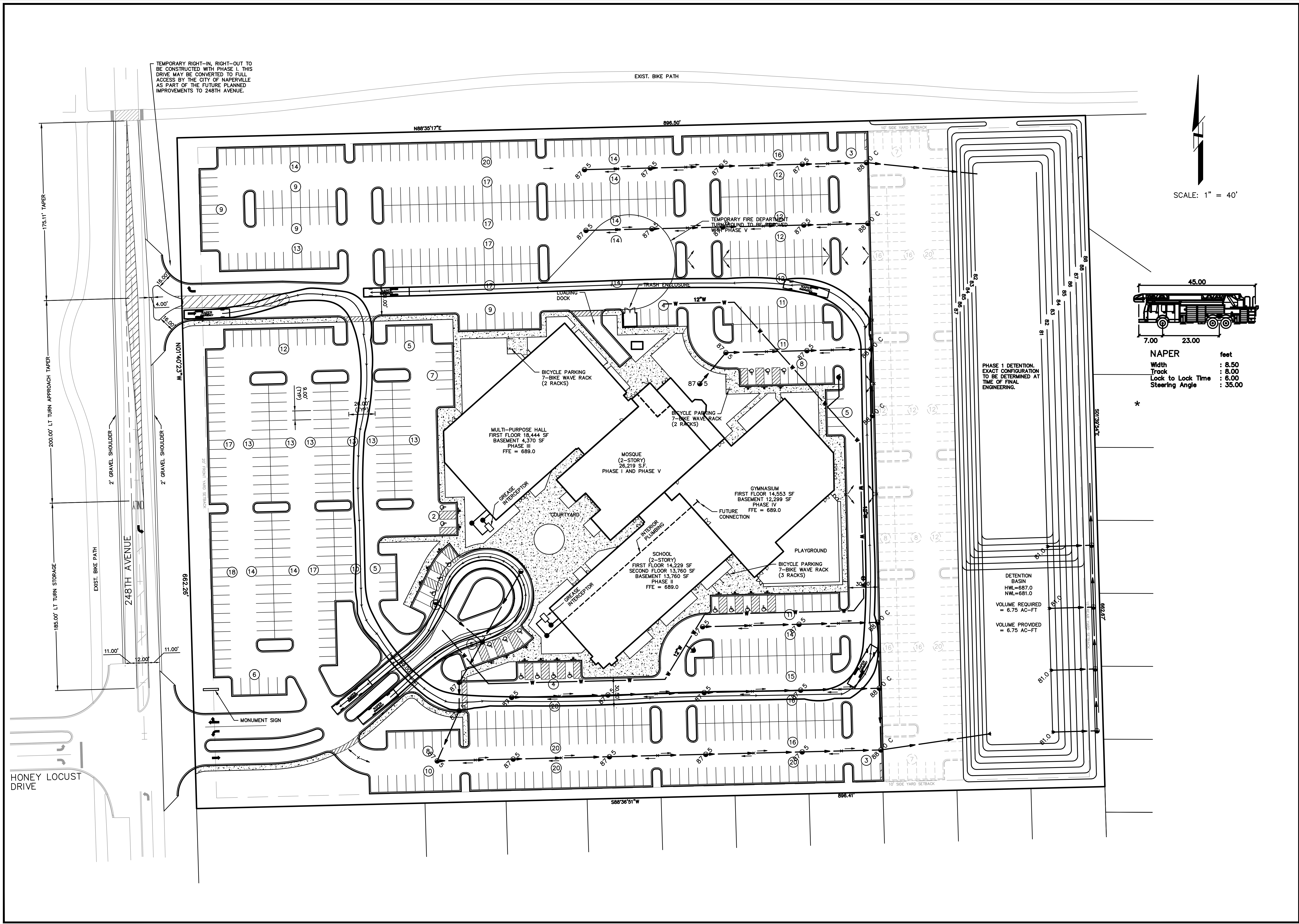

TEMPORARY RIGHT-IN, RIGHT-OUT TO BE CONSTRUCTED WITH PHASE I. THIS DRIVE MAY BE CONVERTED TO FULL ACCESS BY THE CITY OF NAPERVILLE AS PART OF THE FUTURE PLANNED IMPROVEMENTS TO 248TH AVENUE.

EXIST. BIKE PATH

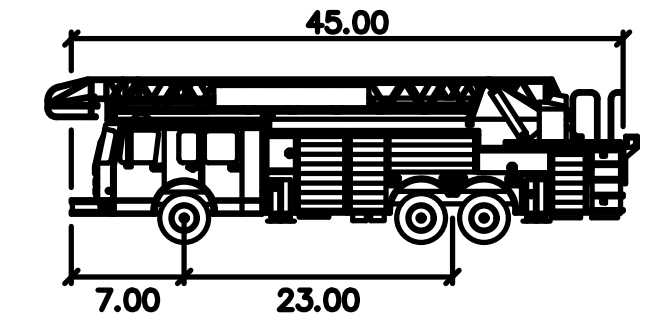
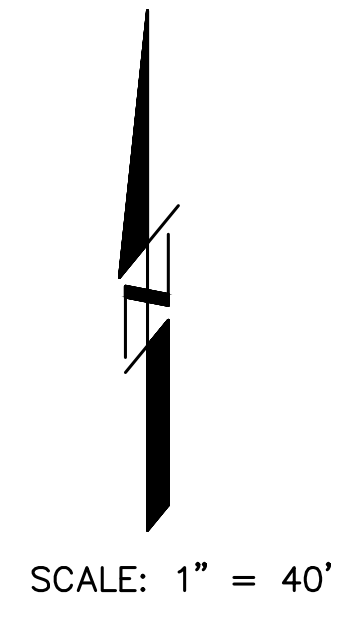

NAPER feet
 Width : 8.50
 Track : 8.00
 Lock to Lock Time : 6.00
 Steering Angle : 35.00

PHASE I DETENTION EXACT CONFIGURATION TO BE DETERMINED AT TIME OF FINAL ENGINEERING.

DETECTION BASIN
 HWL=687.0
 NWL=681.0
 VOLUME REQUIRED = 6.75 AC-FT
 VOLUME PROVIDED = 6.75 AC-FT

INTECH CONSULTANTS, INC. 1889 UNIVERSITY LANE, SUITE D ENGINEERS - SURVEYORS LISLE, ILLINOIS 60532 ILLINOIS REGISTRATION NO. 184-001040 PHONE: 630-964-5656	
ISLAMIC CENTER OF NAPERVILLE 248TH AVENUE SITE NAPERVILLE, ILLINOIS	
AUTOTURN EXHIBIT	
SCALE	1"=40'
DATE	9-4-20
DRAWN	BC
DESIGNED	EFS
PROJECT NO.	2011-016B
SHEET	1 OF 1