

AMC NAPERVILLE 16

COMMERCIAL BUILDING

PAVING LEGEND

- HMA PAVEMENT (SHOWPLACE DRIVE)
- HMA PAVEMENT (PRIVATE)
- CONCRETE SIDEWALK
- BRICK PAVEMENT (REFER TO LANDSCAPE PLAN FOR ADDITIONAL DETAILS)
- TURF OR LANDSCAPING (GREEN SPACE)
- B6.12 CURB AND GUTTER
- DEPRESSED CURB
- REVERSE CURB
- ADA DETECTABLE WARNING

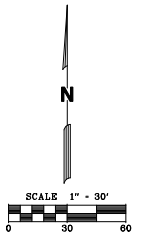

- PAVING PLAN GENERAL NOTES**
- ALL DIMENSIONS ARE TO BACK OF CURB OR FACE OF BUILDING, UNLESS OTHERWISE NOTED.
 - ALL RADII ARE TO BACK OF CURB, UNLESS OTHERWISE NOTED.
 - ALL BUILDING DIMENSIONS ARE BASED ON ARCHITECTURAL PLANS PREPARED BY LENNAR HOMES. CONTRACTOR SHALL REFER TO ARCHITECTURAL PLANS FOR EXACT BUILDING DIMENSIONS AND CONTACT THE ARCHITECT FOR ANY DISCREPANCIES.
 - ALL ON-SITE PAVEMENT MARKINGS SHALL BE PAINTED, UNLESS OTHERWISE NOTED.
 - ALL PROPOSED CURB AND GUTTER SHALL BE B6.12 AND SHALL BE DEPRESSED CURB WHERE SIDEWALK MEETS A STREET, UNLESS OTHERWISE INDICATED. CURB DEPRESSIONS SHALL MEET ADA REQUIREMENTS AS NOTED IN THE CONSTRUCTION DETAILS.
 - ALL JOINTS MADE WITH EXISTING PAVEMENT, CURB, WALK OR CURB AND GUTTER ARE TO BE SAWCUT FULL DEPTH WITHIN 24 HOURS OF PLACEMENT.
 - ALL CURB ISLANDS TO HAVE 1-FOOT MINIMUM RADIUS ON CORNERS, UNLESS OTHERWISE SHOWN.
 - BOLLARDS TO BE PLACED AROUND TRANSFORMER PADS, IF DEEMED NECESSARY DUE TO PROXIMITY TO VEHICULAR TRAFFIC. FINAL TRANSFORMER PAD LOCATIONS TO BE COORDINATED WITH IRI/PE.

- ① R1-1 "STOP" (30"x30")
- ② R7-1 "NO PARKING ANYTIME" (12"x18")

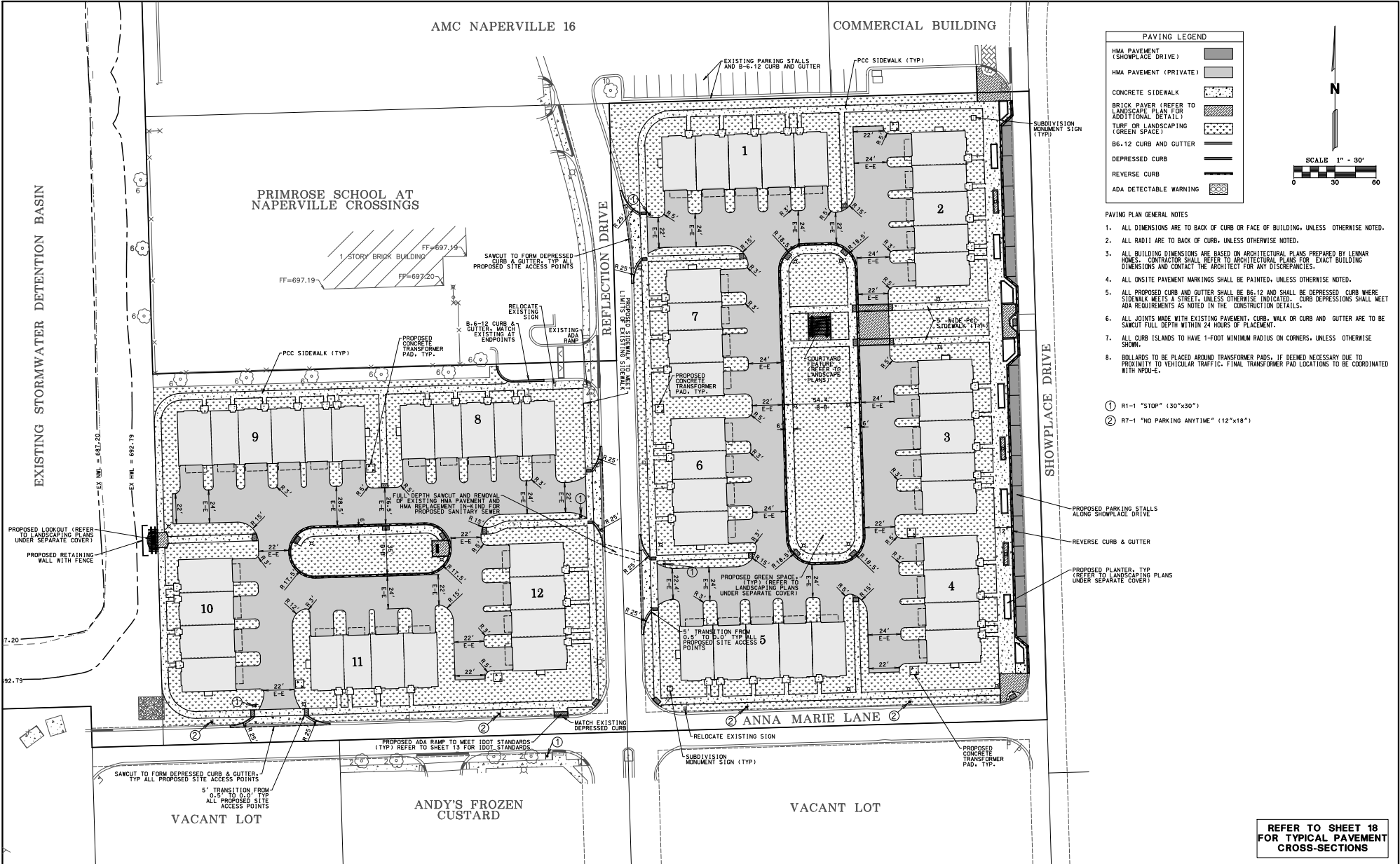

REFER TO SHEET 18 FOR TYPICAL PAVEMENT CROSS-SECTIONS

6/6/2019 12:05:30 PM P:\1887\Naperville\Drawings\18-Paving-Geometry.dwg



Mackie Consultants, LLC
 9575 W. Higgins Road, Suite 500
 Rosemont, IL 60018
 (847) 696-1400
 www.mackieconsult.com

CLIENT:



Lennar Homes
 1141 East Main Street, Suite 108
 East Dundee, IL 60118
 Phone: 224-293-3100 Fax: 224-293-3101

DATE	DESCRIPTION OF REVISION	BY	SCALE
08/08/2019	REVISED PER CITY COMMENT LETTER DATED 7/10/2019	OZ	1" = 30'

DESIGNED	OZ
DRAWN	DWP
APPROVED	RNM
DATE	06/11/2019
SCALE	1" = 30'

**PAVING & GEOMETRY PLAN
 NAPERVILLE CROSSINGS COMMUNITY
 NAPERVILLE, WILL COUNTY, IL**

SHEET
12 OF 21
 PROJECT NUMBER: 3687
 © MACKIE CONSULTANTS, LLC 2019
 ILLINOIS FIRM LICENSE 184-00894