

PRELIMINARY LANDSCAPE PLAN
FOR
MAIN STREET PROMENADE PHASE III
NAPERVILLE, ILLINOIS

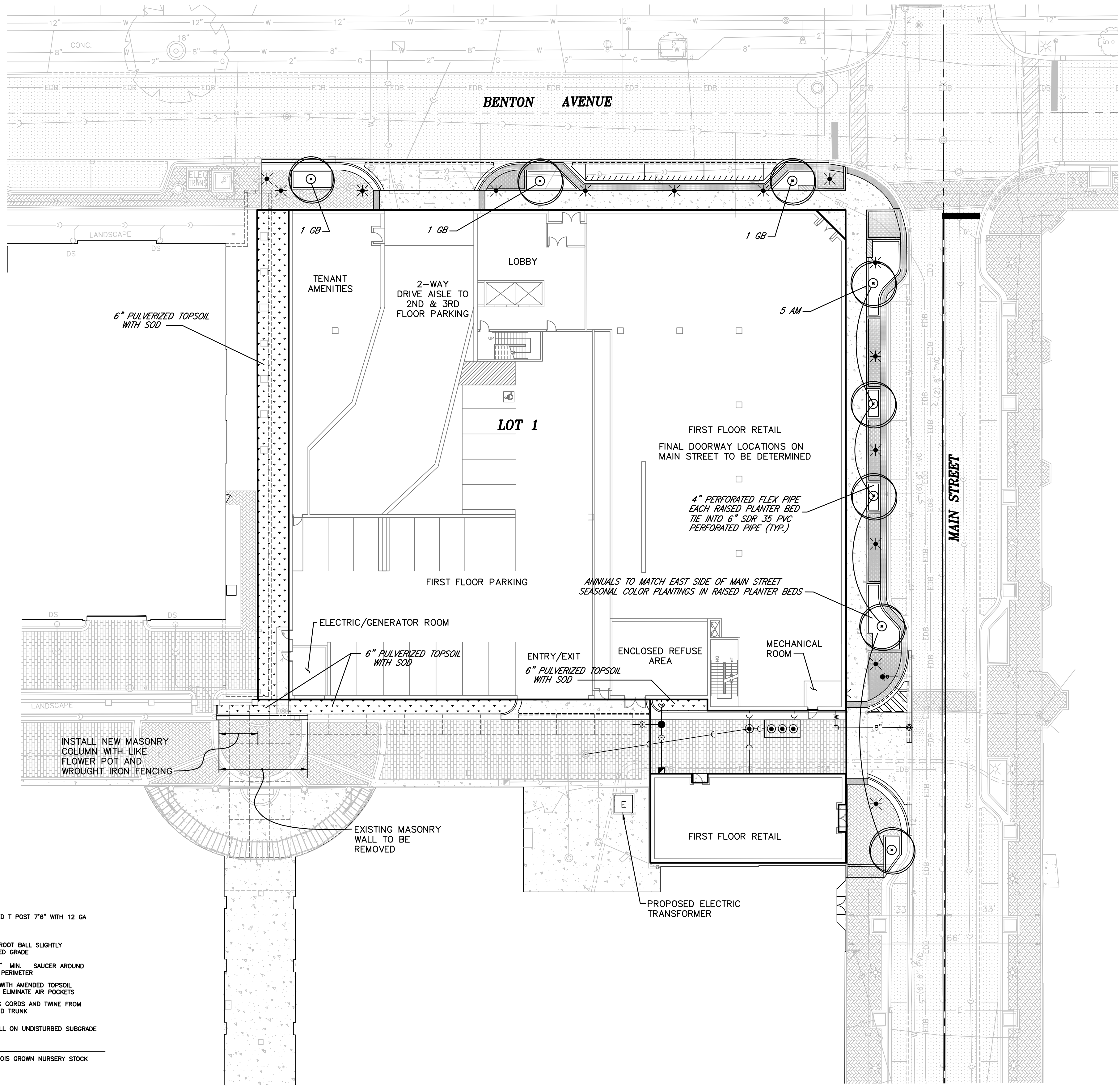

PIN: 07-13-418-004
07-13-418-005
07-13-418-006
07-13-418-007
07-13-418-013

SOUTH LINE OF BENTON AVENUE
BEING N 90°00'00\"/>

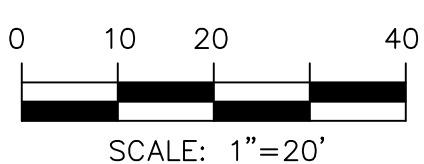
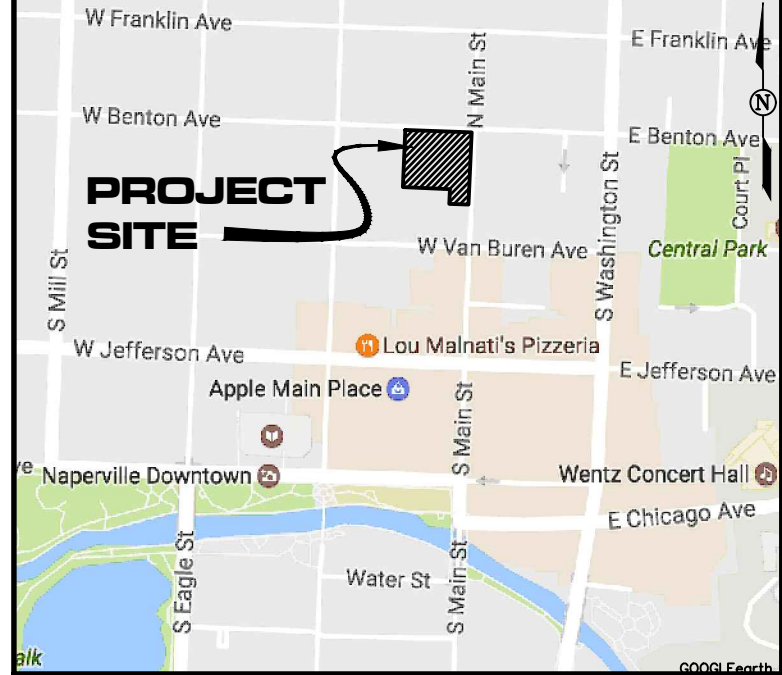

LOCATION MAP
N.T.S.

PLANT LIST

KEY	NAME	BOTANICAL/COMMON	SIZE (CALIPER)	QUANTITY
AM	ACER MIYABEI	MIYABE MAPLE	2.5"	5
GB	GINKGO BILOBA (MALE)	GINKGO	2.5"	3

GENERAL NOTES

- ALL PLANT MATERIAL SHALL BE NORTHERN ILLINOIS NURSERY GROWN TO ASSURE CLIMATIC AND SOIL SIMILARITY. ALL MATERIAL SHALL BE BALLED AND BURLAPPED PER AMERICAN STANDARD FOR NURSERY STOCK BY THE AMERICAN ASSOCIATION OF NURSERYMEN, INC. PERENNIAL AND GROUND COVER SHALL BE CONTAINER GROWN.
- ALL BEDS SHALL RECEIVE 3-4" OF FINELY SHREDDED HARDWOOD MULCH. GROUND COVER BEDS SHALL BE TREATED WITH TRFLAN PRE-EMERGENT HERBICIDE, ALL OTHER BEDS SHALL RECEIVE RONSTAR 5g OR SIMILAR PRE-EMERGENT HERBICIDE FOR WEED CONTROL. ALL TREES SHALL RECEIVE 6" OF FINELY SHREDDED HARDWOOD MULCH. ALL LANDSCAPE SPOILS SHALL BE REMOVED FROM THE SITE BY THE CONTRACTOR.
- OWNER SHALL PROVIDE SUFFICIENT WATER FOR THE CONTRACTOR TO MAINTAIN THE PLANT MATERIAL, SEED AND SOD AREAS. CONTRACTOR SHALL WATER SOD UNTIL THE TURF HAS BECOME ADEQUATELY ESTABLISHED. CONTRACTOR SHALL WARRANTEE ALL MATERIAL AND LABOR FOR A PERIOD OF ONE YEAR FROM ACCEPTANCE OF ALL WORK. OWNER TO PROVIDE ALL SUPPLEMENTAL WATERING AND PROPER CARE AND MAINTENANCE OF ALL MATERIAL AFTER CONTRACTOR'S INITIAL CARE.
- QUANTITY LISTS ARE SUPPLIED AS A CONVENIENCE. THE CONTRACTOR SHALL VERIFY ALL QUANTITIES ON-SITE. THE CONTRACTOR SHALL VERIFY LOCATION OF ALL UNDERGROUND UTILITIES PRIOR TO DIGGING.
- PLANTING BEDS SHALL BE ELEVATED SLIGHTLY TO INSURE PROPER DRAINAGE. ALL ROOT BALLS OF TREES SHALL BE ELEVATED ABOVE FINISHED GRADE. ALL GRADING SHALL PROVIDE SLOPES WHICH ARE SMOOTH, CONTINUOUS AND HAVE POSITIVE DRAINAGE IN ALL AREAS.
- CONTRACTOR SHALL BE RESPONSIBLE FOR PROVIDING TEMPORARY EROSION CONTROL FOR SOIL AREAS DUE TO SLOPE CONDITIONS. CONTRACTOR SHALL MAINTAIN ALL EROSION CONTROL STRUCTURES, FENCES, DITCH CHECKS, AND INLET PROTECTORS UNTIL ADEQUATE VEGETATION HAS BEEN ESTABLISHED.
- EXCAVATED MATERIALS IN EXCESS OR THOSE NOT REQUIRED OR UNSUITABLE FOR RE-USE SHALL BE DISPOSED OF OFF SITE AT CONTRACTOR'S EXPENSE. CONTRACTOR SHALL REMOVE ALL DEBRIS DAILY AND MAINTAIN THE SITE IN A NEAT AND SAFE CONDITION.
- SOIL TESTS SHALL BE MADE TO DETERMINE THE EXACT REQUIREMENTS FOR BOTH SOIL AMENDMENTS AND FERTILIZER. SOIL TESTS SHALL BE CONDUCTED BY A GOVERNMENT LABORATORY OR RECOGNIZED COMMERCIAL LABORATORY, COST OF WHICH SHALL BE BORNE BY THE CONTRACTOR. CONTRACTOR IS RESPONSIBLE FOR MATERIAL COST AND APPLICATION OF TESTING LABORATORY'S RECOMMENDATIONS.
- LANDSCAPE CONTRACTOR SHALL PROVIDE THE OWNER WITH AN EQUIPMENT AND LABOR RATE SCHEDULE. THIS LIST SHALL INCLUDE COST OF TOPSOIL AND LANDSCAPE DEBRIS/SPOILS REMOVAL WITH SQUARE FOOT COST FOR TURF RESTORATION (SOD AND SEED). LANDSCAPE CONTRACTOR SHALL RESTORE ALL TURF AREAS DAMAGED DUE TO CONSTRUCTION ON AND OFF SITE AT THE AGREED RATES TO RESTORE TOE EXISTING CONDITIONS.
- LANDSCAPE CONTRACTOR SHALL FOLLOW ALL LOCAL AND MUNICIPAL CODES AND REQUIREMENTS. CONTRACTOR SHALL SECURE ALL REQUIRED PERMITS AS NECESSARY TO COMPLETE THE SCOPE OF THE JOB.
- TREES SHALL BE INSTALLED A MINIMUM OF FIVE (5) FEET HORIZONTALLY FROM UNDERGROUND ELECTRICAL FEEDERS, SANITARY SEWERS, SANITARY SERVICES, WATER MAINS, AND WATER SERVICES. TREES SHALL BE INSTALLED A MINIMUM OF TEN (10) FEET HORIZONTALLY FROM UTILITY STRUCTURES AND APPURTENANCES, INCLUDING BUT NOT LIMITED TO MANHOLES, VALVE VAULTS, VALVE BOXES AND FIRE HYDRANTS. NO TREES, SHRUBS OR OBSTACLES WILL BE ALLOWED 10 FEET IN FRONT OF, 5 FEET ON THE SIDES AND 7 FEET TO THE REAR OF THE ELECTRICAL TRANSFORMER.
- TREE, SHRUB AND PLANT BED FERTILIZER LESCO 14-14-14 PLOY PLUS SULFUR COATED LANDSCAPE AND ORNAMENTAL ALL PURPOSE FERTILIZER RATE: 5 POUNDS PER 1000 S.F. PLANT BEDS ONE POUND PER CALIPER INCH FOR TREES

I, CRAIG A HERNAN, ILLINOIS REGISTERED LANDSCAPE ARCHITECT NO. 157-000419 DO HEREBY CERTIFY THE THE PLAN SHOWN HEREON IS A CORRECT REPRESENTATION OF LANDSCAPE IMPROVEMENTS TO THE NOTED PROPERTY.

CRAIG A HERNAN
IRLA #157-000419
WESTWOOD LANDSCAPE
WEST CHICAGO, IL

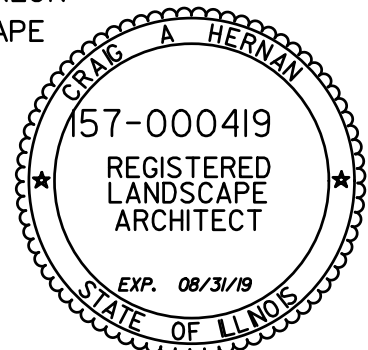

CITY PROJECT NO. 19-10000040

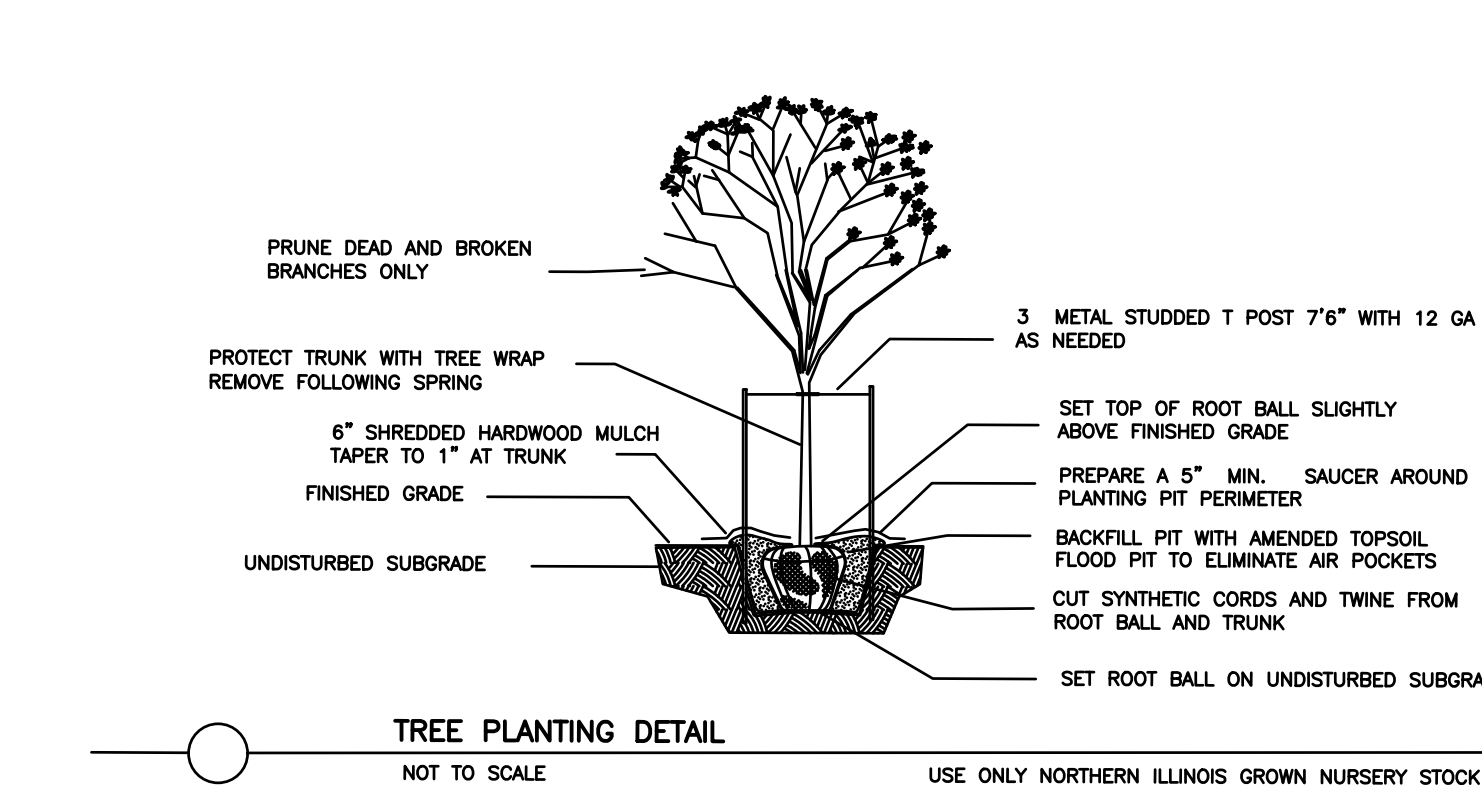

REVISIONS					
NO.	DATE	DESCRIPTION	NO.	DATE	DESCRIPTION
1	05/15/19	REV. PER CITY RWV (DATED 4/25/19)			

MAIN STREET PROMENADE PHASE III

LANDSCAPE PLAN

DRN./CKD. BY: SRH/JGC	FILE: 6422NEX_PRELIM_LS	FLD. BK./PG.: 147/3	SHEET NO. 1 OF 1
SCALE: 1"=20'	DATE: 03/18/19	JOB NO.: 190-311	