

©2018 Hitchcock Design Group

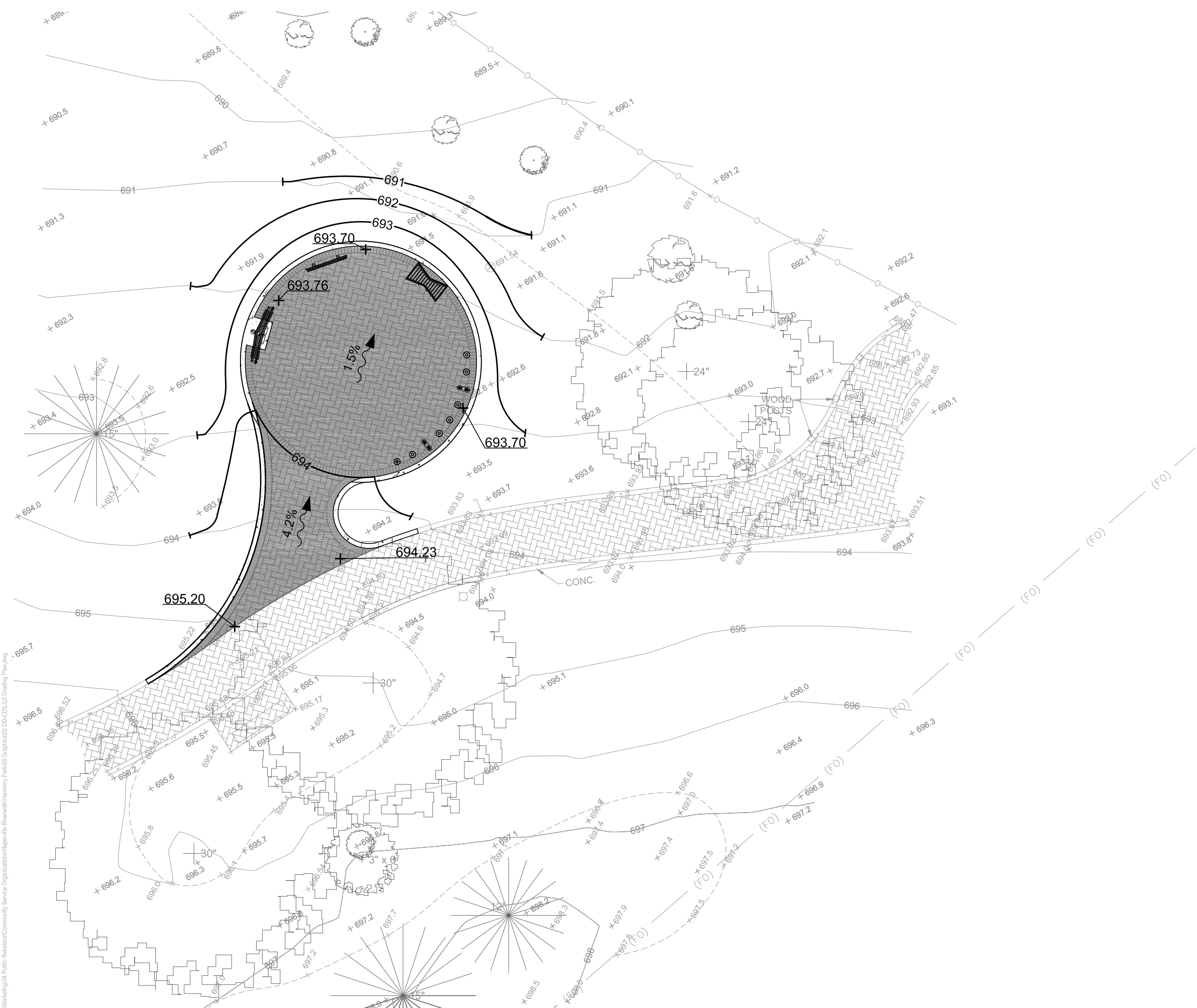

J:\Marketing\04 Public Relations\Community Service Organizations\Naperville Riverwalk\Harmony Park\09 Graphics\02 DD-CDD\3.0 Grading Plan.dwg

GRADING NOTES

1. All surfaces shall be graded for positive drainage. Grade pathways for 2% cross slope in direction shown on plan. Grade to divert water away from all walls, columns, steps, and structures. Where direction is not shown, cross slopes shall be in direction needed to achieve positive drainage.
2. Maximum slope of 20:1 on all paved areas unless otherwise noted. Slopes greater than 20:1 will not be accepted.
3. All slopes between spot elevations on pathways shall be consistent.
4. Avoid excessive filling over critical root zone of trees designated to remain. Feather newly graded areas into existing grade.
5. Strip topsoil in area of designated paving and respread in accordance with grading plan. Haul off site and legally dispose of unsuitable or excess excavated material.
6. Contractor to import and distribute structural fill material for hardscape areas to achieve grades as shown on the plans.
7. Contractor to import and distribute topsoil for all turf areas to minimum depth of 6" to achieve the grades and planting areas to minimum depth of 18" to achieve the grades, as shown on the plans. Granular fill will not be accepted under areas designated for turf or planting.
8. Promptly notify Owners Representative if unsatisfactory sub-grade materials are discovered.
9. Obtain Landscape Architect's review of fine grading prior to seeding operations.
10. Refer to specifications for additional conditions, standards and notes.

GRADING LEGEND

- 690.00 Spot Elevation
- 2% Direction of Slope
- 691 Minor Contour (1 foot)
- 690 Major Contour (5 foot)



225 W. Jefferson Avenue
Naperville, IL 60540
T 630.961.1787
F 630.961.9925
hitchcockdesigngroup.com

PREPARED FOR
Rotary Club of
Naperville

PROJECT
Harmony
Park
Naperville Riverwalk

ISSUED

March 5, 2018

REVISIONS

No	Date	Issue
01	2018.03.05	City Review

CHECKED BY
DSK

DRAWN BY
SAS

SHEET TITLE
Grading Plan

SCALE IN FEET
1" = 10'



NORTH



SHEET NUMBER

L3.0

©2018 Hitchcock Design Group

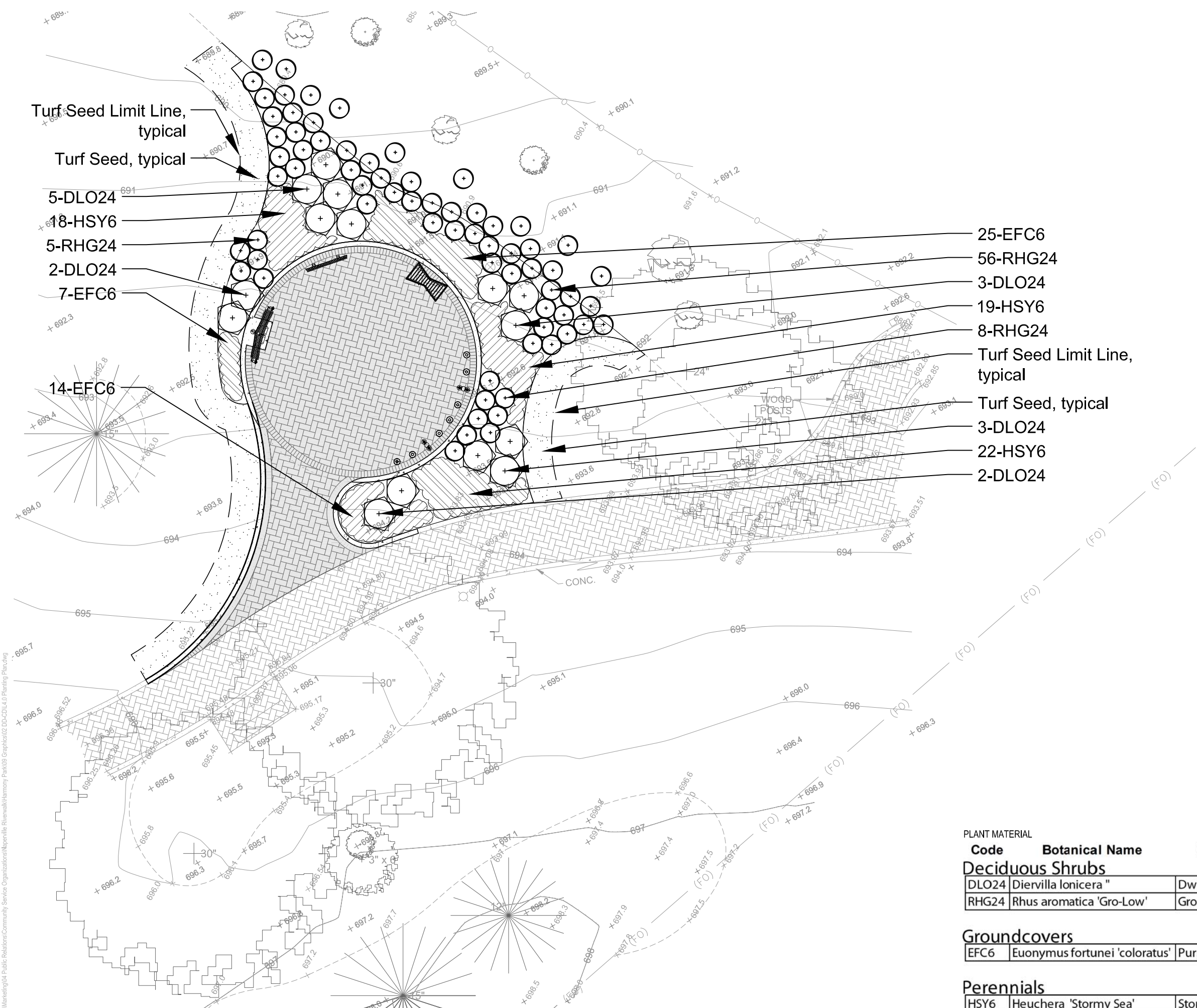

J:\Marketing\04 Public Relations\Community Service Organizations\Naperville Riverwalk\Harmony Park\09 Graphics\Site\2D-DD-CDU-4.0 Planting Plan.dwg

PLANTING NOTES

- Contractor responsible for erosion control in all seeded/sodded areas.
- Bedlines are to be spade cut to a minimum depth of 3 inches unless otherwise shown on the plans. Curved bedlines are to be smooth and not segmented.
- Do not locate plants within 10' of utility structures, or within 5' horizontally of underground utility lines unless otherwise shown on the plans. Consult with Landscape Architect if these conditions exist.
- Plants and other materials are quantified and summarized for the convenience of the Owner and jurisdictional agencies only. Confirm and install sufficient quantities to complete the work as drawn and specified. No additional payments will be made for materials required to complete the work as drawn and specified.
- FOR UNIT PRICE CONTRACTS, Payments will be made based on actual quantities installed as measured in place by the Owners Representative.
- Refer to specifications for additional conditions, standards and notes.

PLANTING LEGEND

- Shrub, typical. See detail for installation.
- Perennial, Groundcover and Annual, typical. See detail for installation.
- Turf Seed, typical
- Turf Seed Limit Line, typical

- 25-EFC6
- 56-RHG24
- 3-DLO24
- 19-HSY6
- 8-RHG24
- Turf Seed Limit Line, typical
- Turf Seed, typical
- 3-DLO24
- 22-HSY6
- 2-DLO24

PLANT MATERIAL

Code	Botanical Name	Common Name	Size	Qty
Deciduous Shrubs				
DLO24	Diervilla lonicera "	Dwarf Bush-honeysuckle	24" HT	15
RHG24	Rhus aromatica 'Gro-Low'	Gro-Low Fragrant Sumac	24" HT	69

Groundcovers

EFC6	Euonymus fortunei 'coloratus'	Purpleleaf Wintercreeper	1 GAL	46
------	-------------------------------	--------------------------	-------	----

Perennials

HSY6	Heuchera 'Stormy Sea'	Stormy Sea Coral Bells^	1 GAL	59
------	-----------------------	-------------------------	-------	----



225 W. Jefferson Avenue
 Naperville, IL 60540
 T 630.961.1787
 F 630.961.9925
 hitchcockdesigngroup.com

PREPARED FOR

Rotary Club of
 Naperville

PROJECT

Harmony
 Park
 Naperville Riverwalk

ISSUED

March 5, 2018

REVISIONS

No	Date	Issue
01	2018.03.05	City Review

CHECKED BY
 DSK

DRAWN BY
 SAS

SHEET TITLE

Planting Plan

SCALE IN FEET

1" = 10'



NORTH



SHEET NUMBER

L4.0

©2018 Hitchcock Design Group



FREENOTES HARMONY PARK
194 BODO DRIVE #F
DURANGO, CO 81303
PHONE: (970) 375-7825
FAX: (970) 247-0856
www.freenotesharmoniypark.com

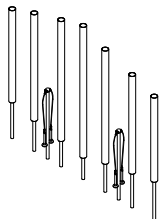

ISOMETRIC



PLAN VIEW



SIDE ELEVATION

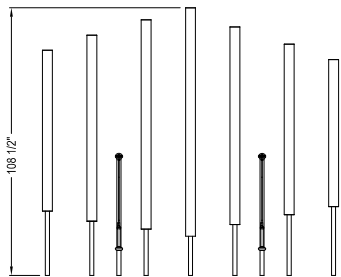

2 In Ground Site Attachment

- NOTES:
1. REFER TO FREENOTES MAINTENANCE INSTRUCTIONS FOR ALL REQUIRED INSPECTIONS AND/OR REGULARLY SCHEDULED MAINTENANCE.
 2. INSTALLATION TO BE COMPLETED IN ACCORDANCE WITH MANUFACTURER'S SPECIFICATIONS.
 3. ALL DIMENSIONS ARE CONSIDERED TRUE AND REFLECT MANUFACTURER'S SPECIFICATIONS.
 4. DO NOT SCALE DRAWING.
 4. CONTRACTOR'S NOTE: FOR PRODUCT AND COMPANY INFORMATION VISIT www.CADdetails.com/info REFERENCE NUMBER 4750-001.

1 Cymtrabass Chimes

Scale: NTS

d-chimes



FREENOTES HARMONY PARK
194 BODO DRIVE #F
DURANGO, CO 81303
PHONE: (970) 375-7825
FAX: (970) 247-0856
www.freenotesharmoniypark.com

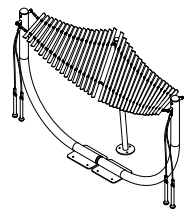

ISOMETRIC

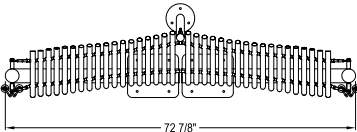

PLAN

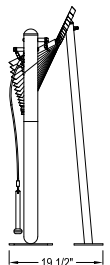

SIDE ELEVATION

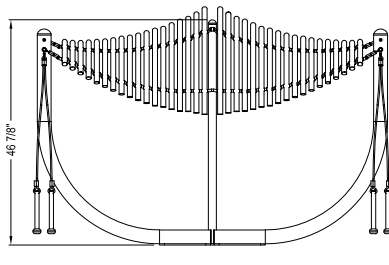

FRONT ELEVATION

7 Site Furnishing Attachment

- NOTES:
1. REFER TO FREENOTES MAINTENANCE INSTRUCTIONS FOR ALL REQUIRED INSPECTIONS AND/OR REGULARLY SCHEDULED MAINTENANCE.
 2. INSTALLATION TO BE COMPLETED IN ACCORDANCE WITH MANUFACTURER'S SPECIFICATIONS.
 3. ALL DIMENSIONS ARE CONSIDERED TRUE AND REFLECT MANUFACTURER'S SPECIFICATIONS.
 4. DO NOT SCALE DRAWING.
 4. CONTRACTOR'S NOTE: FOR PRODUCT AND COMPANY INFORMATION VISIT www.CADdetails.com/info REFERENCE NUMBER 4750-004.

2 Manta Ray Metallophone

Scale: NTS

d-metallophone



FREENOTES HARMONY PARK
194 BODO DRIVE #F
DURANGO, CO 81303
PHONE: (970) 375-7825
FAX: (970) 247-0856
www.freenotesharmoniypark.com

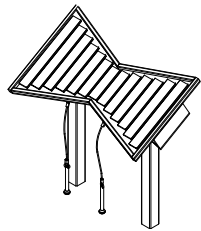

PERSPECTIVE

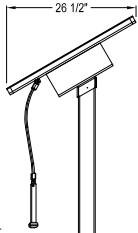

SIDE ELEVATION

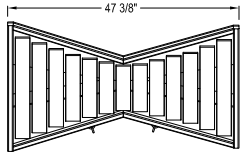

PLAN

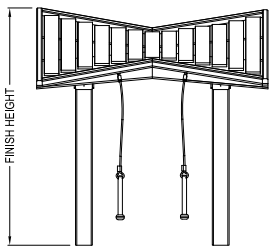

FRONT ELEVATION

2 In Ground Site Attachment

- FINISHED HEIGHT
AGES 3-5: 35"
AGES 5-7: 40"
AGES 7-11: 45"
ADULT: 49"
- FEATURES:
- C MAJOR PENTATONIC
- RECYCLED HDPE FRAME
- COATED FIBERGLASS BARS
- STAINLESS STEEL HARDWARE
- NOTES:
1. REFER TO FREENOTES MAINTENANCE INSTRUCTIONS FOR ALL REQUIRED INSPECTIONS AND/OR REGULARLY SCHEDULED MAINTENANCE.
 2. INSTALLATION TO BE COMPLETED IN ACCORDANCE WITH MANUFACTURER'S SPECIFICATIONS.
 3. ALL DIMENSIONS ARE CONSIDERED TRUE AND REFLECT MANUFACTURER'S SPECIFICATIONS.
 4. DO NOT SCALE DRAWING.
 4. CONTRACTOR'S NOTE: FOR PRODUCT AND COMPANY INFORMATION VISIT www.CADdetails.com/info REFERENCE NUMBER 4750-023.

3 Xylophones

Scale: NTS

d-xylophones



FREENOTES HARMONY PARK
194 BODO DRIVE #F
DURANGO, CO 81303
PHONE: (970) 375-7825
FAX: (970) 247-0856
www.freenotesharmoniypark.com

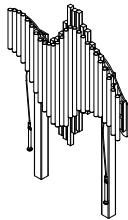

PERSPECTIVE

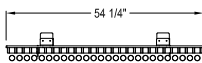

PLAN VIEW

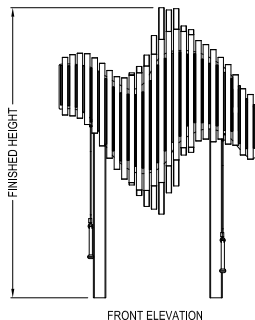

FRONT ELEVATION

2 In Ground Site Attachment

- FINISHED HEIGHT
AGES 3-5: 59"
AGES 5-7: 63"
AGES 7-11: 71"
ADULT: 80"
- MAIN FEATURES:
- (LH) C MAJOR / (RH) A MINOR PENTATONIC
- RECYCLED HDPE FRAME
- ANODIZED ALUMINUM CHIMES & RESONATORS
- STAINLESS STEEL HARDWARE
- NOTES:
1. REFER TO FREENOTES MAINTENANCE INSTRUCTIONS FOR ALL REQUIRED INSPECTIONS AND/OR REGULARLY SCHEDULED MAINTENANCE.
 2. INSTALLATION TO BE COMPLETED IN ACCORDANCE WITH MANUFACTURER'S SPECIFICATIONS.
 3. ALL DIMENSIONS ARE CONSIDERED TRUE AND REFLECT MANUFACTURER'S SPECIFICATIONS.
 4. DO NOT SCALE DRAWING.
 4. CONTRACTOR'S NOTE: FOR PRODUCT AND COMPANY INFORMATION VISIT www.CADdetails.com/info REFERENCE NUMBER 4750-010.

4 Swirl Chimes

Scale: NTS

d-swirl chimes

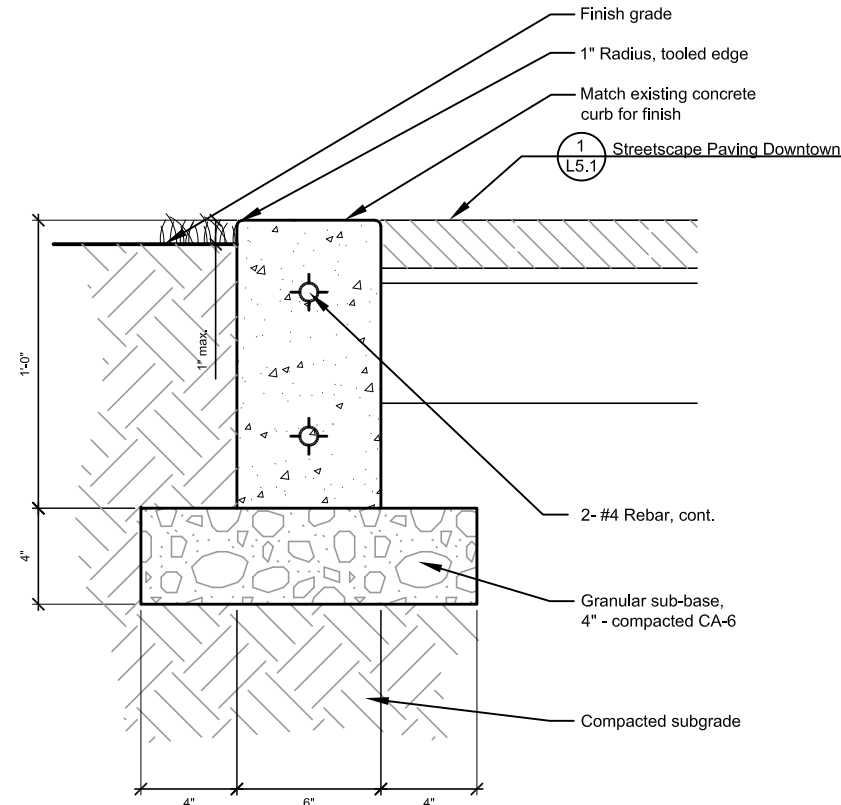

5 6\" Concrete Curb

Scale: 6\" = 1'-0\"

d-concrete curb flush

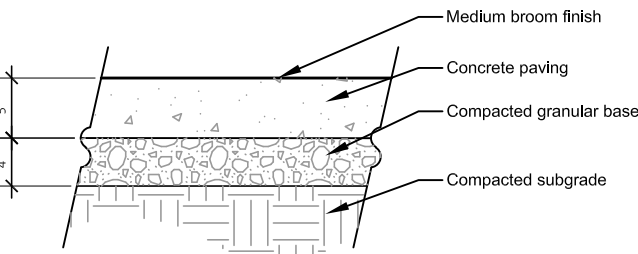

6 Concrete Paving - Pedestrian

Scale: 3\" = 1'-0\"

d-conc-flat

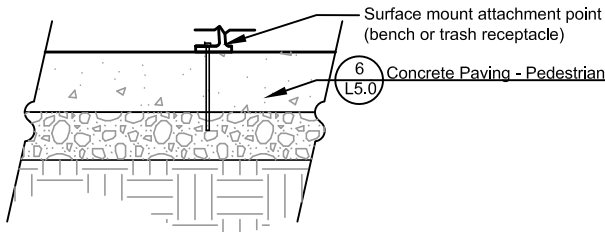

7 Site Furnishing Attachment

Scale: 3\" = 1'-0\"

d-conc-flat



225 W. Jefferson Avenue
Naperville, IL 60540
T 630.961.1787
F 630.961.9925
hitchcockdesigngroup.com

PREPARED FOR
**Rotary Club of
Naperville**

PROJECT
**Harmony
Park**
Naperville Riverwalk

ISSUED
March 5, 2018
REVISIONS

No	Date	Issue
01	2018.03.05	City Review

CHECKED BY
DSK

DRAWN BY
SAS

SHEET TITLE
Site Details

SCALE IN FEET
as noted

NORTH

SHEET NUMBER
L5.0
©2018 Hitchcock Design Group

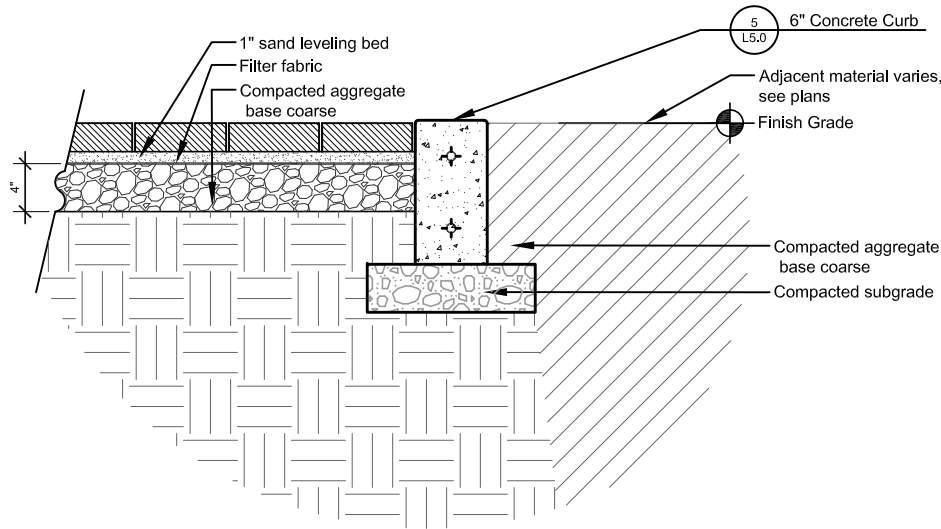

Concrete Pavers
Manufacturer: Unilock
Model: Stockholm
Size: 6 cm, Overall Dimensions:
4.75" x 9.50" x 2.38"
Color: Solid Red
Application: Downtown
Streetscape, corner

Manufacturer: Unilock
Model: Holland
Size: 6 cm, Overall Dimensions:
4.13" x 8.26" x 2.38"
Color: Solid Red
Application: Downtown
Streetscape, soldier course
banding

Concrete Paver Sealer
Manufacturer: Unilock - AS-1
Achro Seal 1315
Supplier: Illinois Brick Co.
708.344.1000

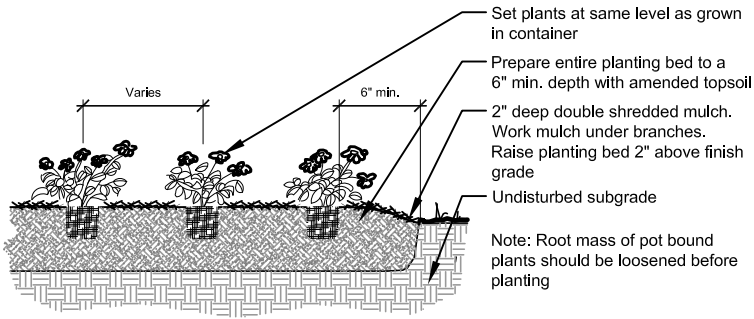

1 Streetscape Paving Downtown

Scale: 1 1/2" = 1'-0"

d-streetscape-paving

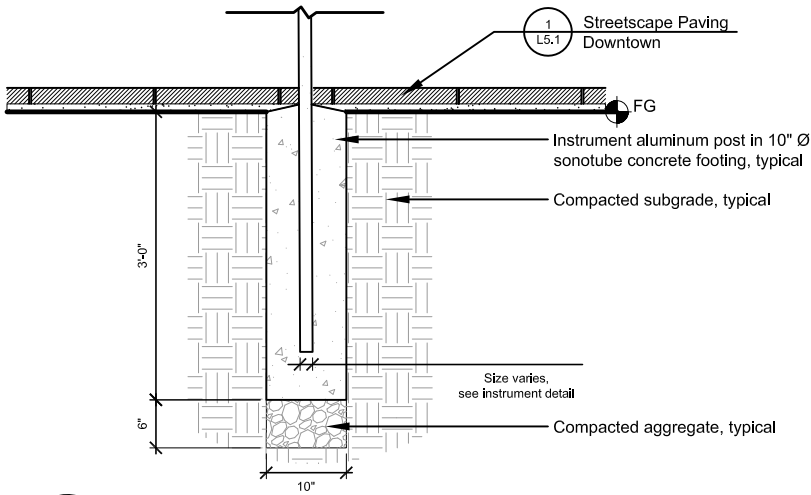

2 In Ground Site Attachment

Scale: 1 1/2" = 1'-0"

d-sonotube

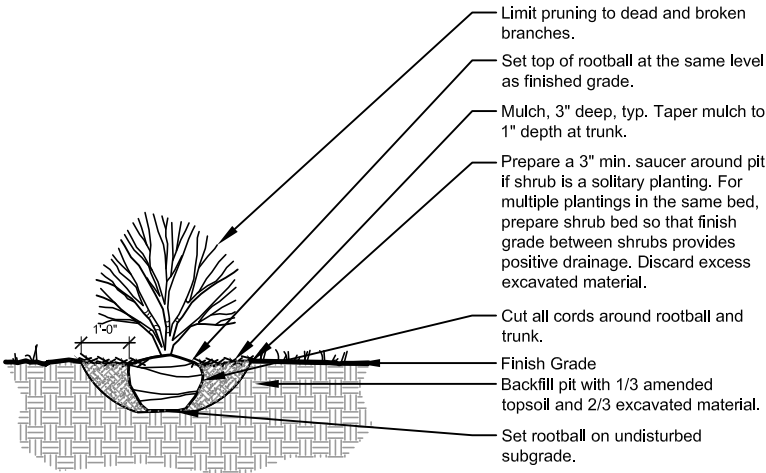

3 Shrub Planting

Scale: 3/4" = 1'-0"

d-plant-shrub

4 Perennial Planting

Scale: 3/4" = 1'-0"

d-plant-ann-perenn

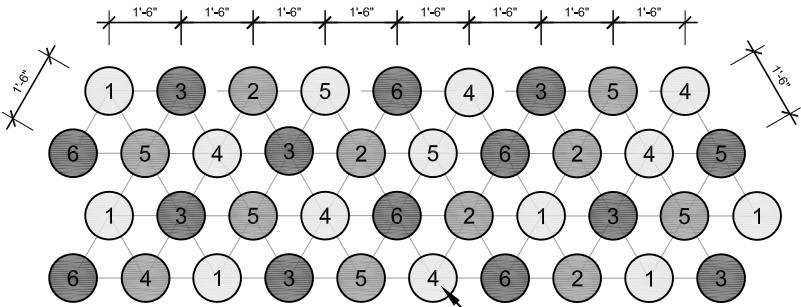

NOTE:
1. Spacing is to be triangular
2. Intent is for plant species to be randomly placed
3. Typical spacing is 18" O.C. unless noted otherwise on plans
Plant species quantities vary per planting bed, see planting plans for individual beds.

5 Perennial Spacing and Planting Pattern

Scale: 3/4" = 1'-0"

d-veg-trf-spacing



225 W. Jefferson Avenue
Naperville, IL 60540
T 630.961.1787
F 630.961.9925
hitchcockdesigngroup.com

PREPARED FOR
Rotary Club of
Naperville

PROJECT
Harmony
Park
Naperville Riverwalk

ISSUED
March 5, 2018
REVISIONS

No	Date	Issue
01	2018.03.05	City Review

CHECKED BY
DSK

DRAWN BY
SAS

SHEET TITLE
Site Details

SCALE IN FEET
as noted

NORTH

SHEET NUMBER
L5.1

©2018 Hitchcock Design Group