

Preliminary Landscape Development Plans



- ① 7.22.2022 - Per City Review Comments dated 7.13.2022
- ② 8.19.2022 - Per City Review Comments dated 8.9.2022
- ③ 8.26.2022 - Per Wolf Drive Removal
- ④ 9.28.2022 - Added Sitting Areas Outlot A & B

NAPERVILLE POLO CLUB

NAPERVILLE, ILLINOIS



DEVELOPER :

1900 E. Golf Road - Suite 300
Schaumburg, Illinois 60173
Project Manager : Rob Getz, P.E.

ENGINEER :

CEMCON, Ltd.
2280 White Oak Circle
Aurora, IL 60502
(630) 862.2100 voice
Project Manager : Chris Morgart, P.E.

LANDSCAPE ARCHITECT :

Signature Design Group, Inc.
132 N. Washington Street
Naperville, Illinois 60540
(630) 305.3980 voice
Project Manager: Greg G. Sagen, RLA

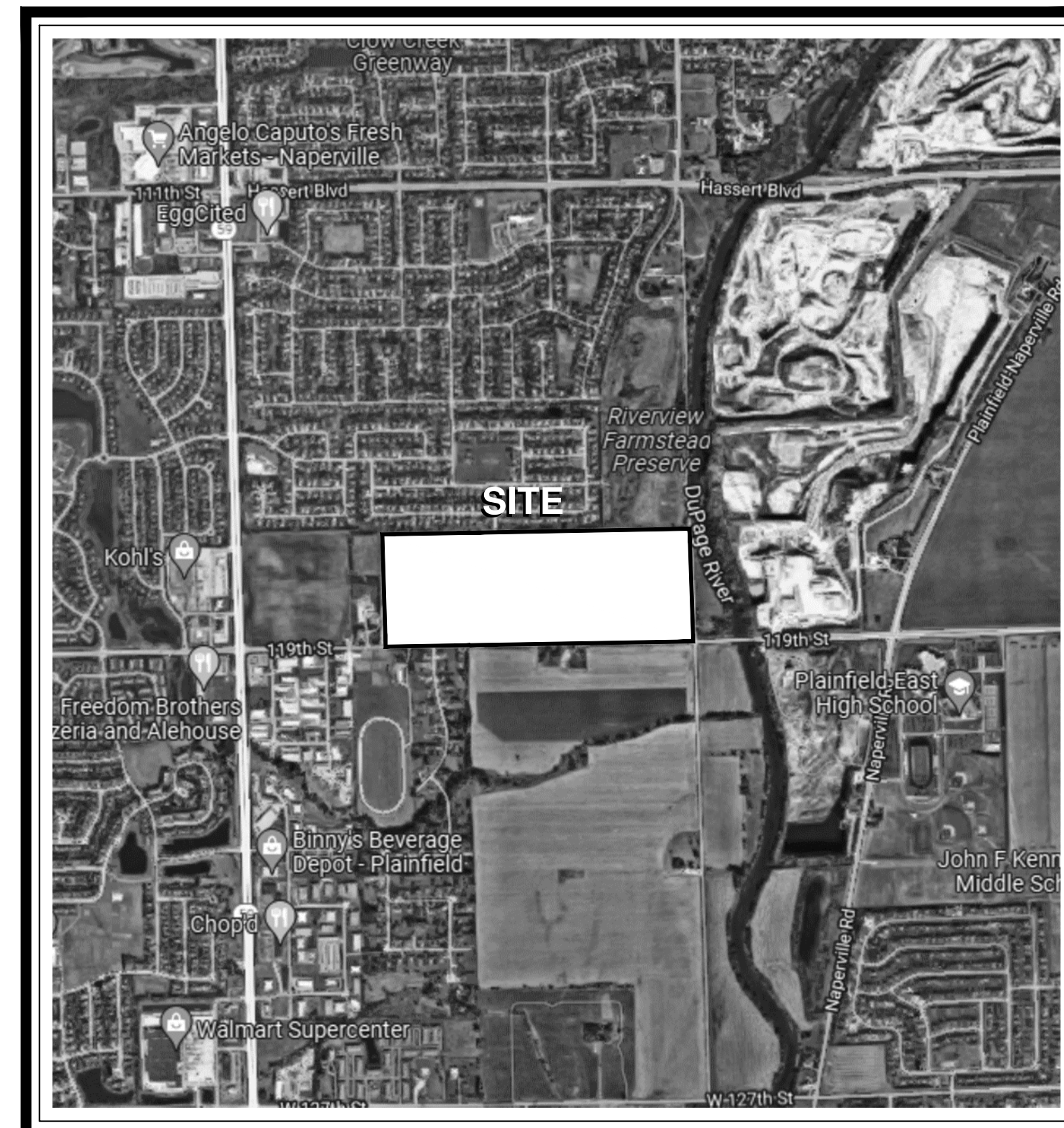

LOCATION MAP

INDEX OF DRAWINGS : ① ②

- L.100 Overall Landscape Plan
- L.101 Landscape Plan - West
- L.102 Landscape Plan - Central
- L.103 Landscape Plan - East
- L.104 Parkway Tree Plan
- L.105 Turf Exhibit
- L.106 Plant Material Legend & Details
- L.107 Prototypical House Planting Plans
- L.108 Prototypical Townhome Planting Plans
- ② L.109 Preliminary Project Signage
- ① TS.100 Existing Tree Survey

City of Naperville Project No. 22-1-056

project:

Polo Club

119th St. & Book Rd.
Naperville, Illinois

sheet description:

Preliminary Landscape Plan West Section

owner:

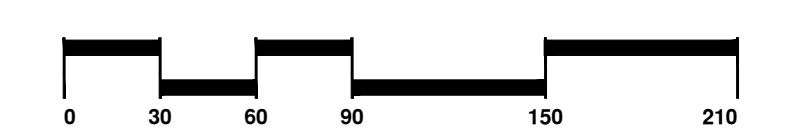

north: scale: 1" = 60'0"

revisions:	date:	description:
▲	9.28.2022	Added Sitting Areas outlot A & B
▲	8.26.2022	Per Wolf Drive Removal
▲	8.19.2022	Per City Review Comments dated 8.9.2022
▲	7.22.2022	Per City Review Comments dated 7.13.2022

original issue date: **6 June 2022**

drawn by:
checked by:
project no.: 22012
sheet no.:

L.101

Plant Material Legend :

- Parkway Trees, 2 1/2"
- Shade Tree, 2 1/2" - 3"
- River Birch, 8' - 12' m/s
- Ornamental Tree, 6' - 8'
- Evergreen Tree 6' - 8'
- Columnar Evergreen Tree, 6'
- Deciduous Shrub Bed, 18"-36"
- Evergreen Shrub Bed, 18"
- Ornamental Grass Bed, 1gal.

General Notes :

- See Sheet L.104 for Parkway Trees Plan
- See Sheet L.105 for Turf Establishment Plan
- See Sheet L.106 for Plant Material Information
- See Sheet L.107 for Typical House Landscape Packages
- See Sheet L.108 for Typical Townhome Foundation Planting Plans

Sheet Key:

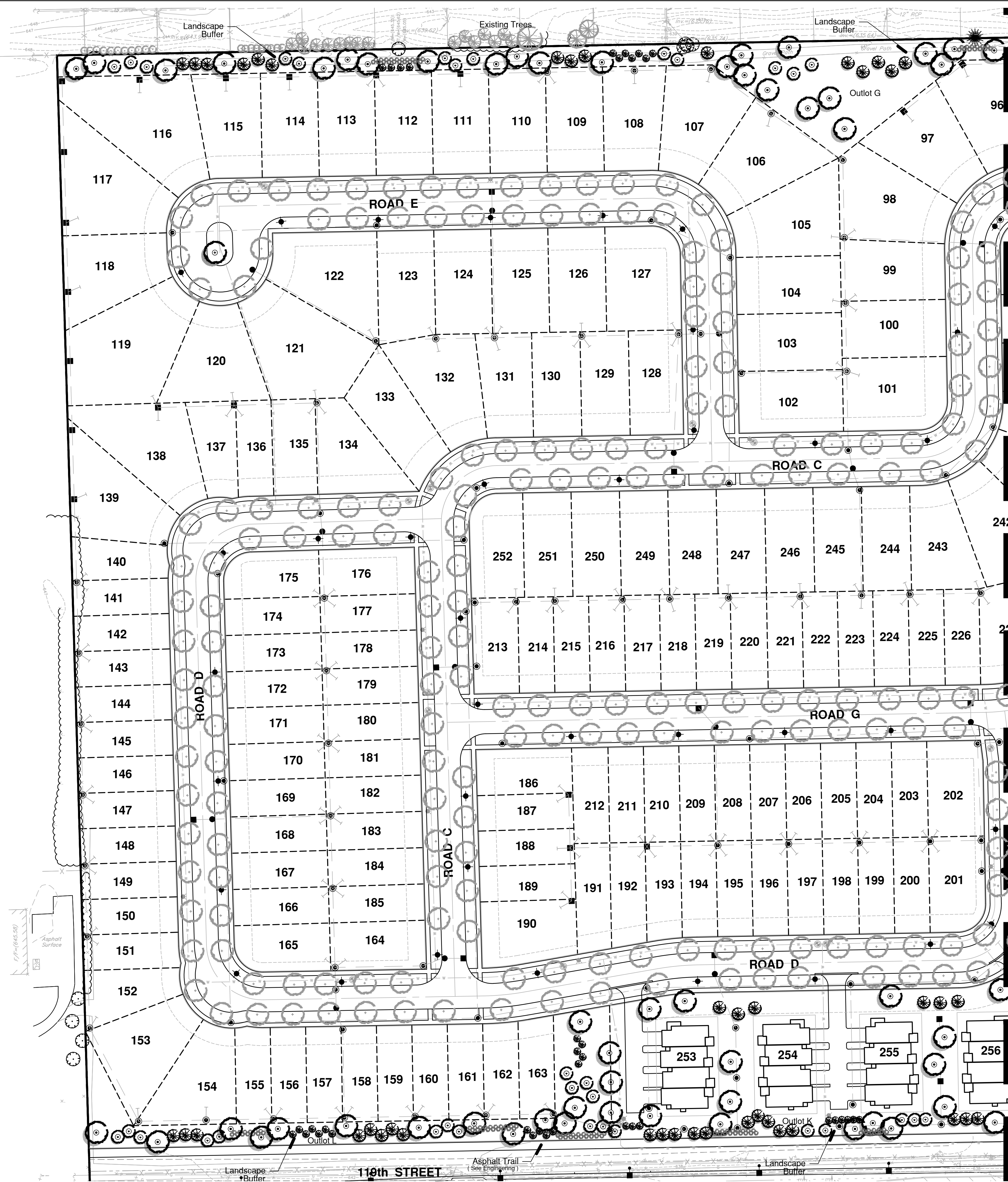
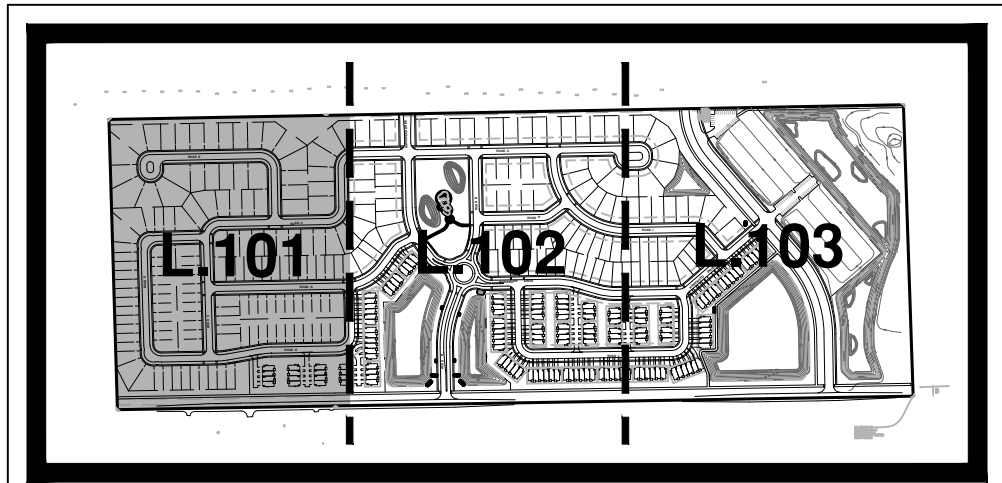

project:

Polo Club

119th St. & Book Rd.
Naperville, Illinois

sheet description:

Preliminary Landscape Plan Center Section

owner:

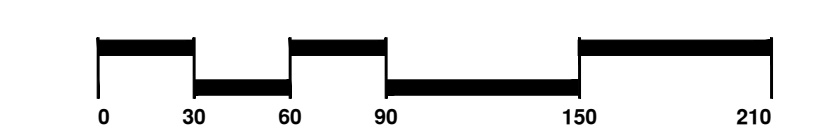

north: scale: 1" = 60'0"

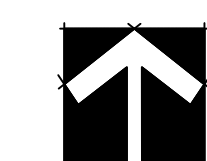

9.28.2022	Added Sitting Areas outlet A & B
8.26.2022	Per Wolf Drive Removal
8.19.2022	Per City Review Comments dated 8.9.2022
7.22.2022	Per City Review Comments dated 7.13.2022

original issue date: **6 June 2022**

drawn by:
checked by:
project no.: 22012
sheet no.:

L.102

Plant Material Legend :

- Parkway Trees, 2 1/2"
- Shade Tree, 2 1/2" - 3"
- River Birch, 8' - 12' m/s
- Ornamental Tree, 6' - 8'
- Evergreen Tree 6' - 8'
- Columnar Evergreen Tree, 6'
- Deciduous Shrub Bed, 18"-36"
- Evergreen Shrub Bed, 18"
- Ornamental Grass Bed, 1gal.

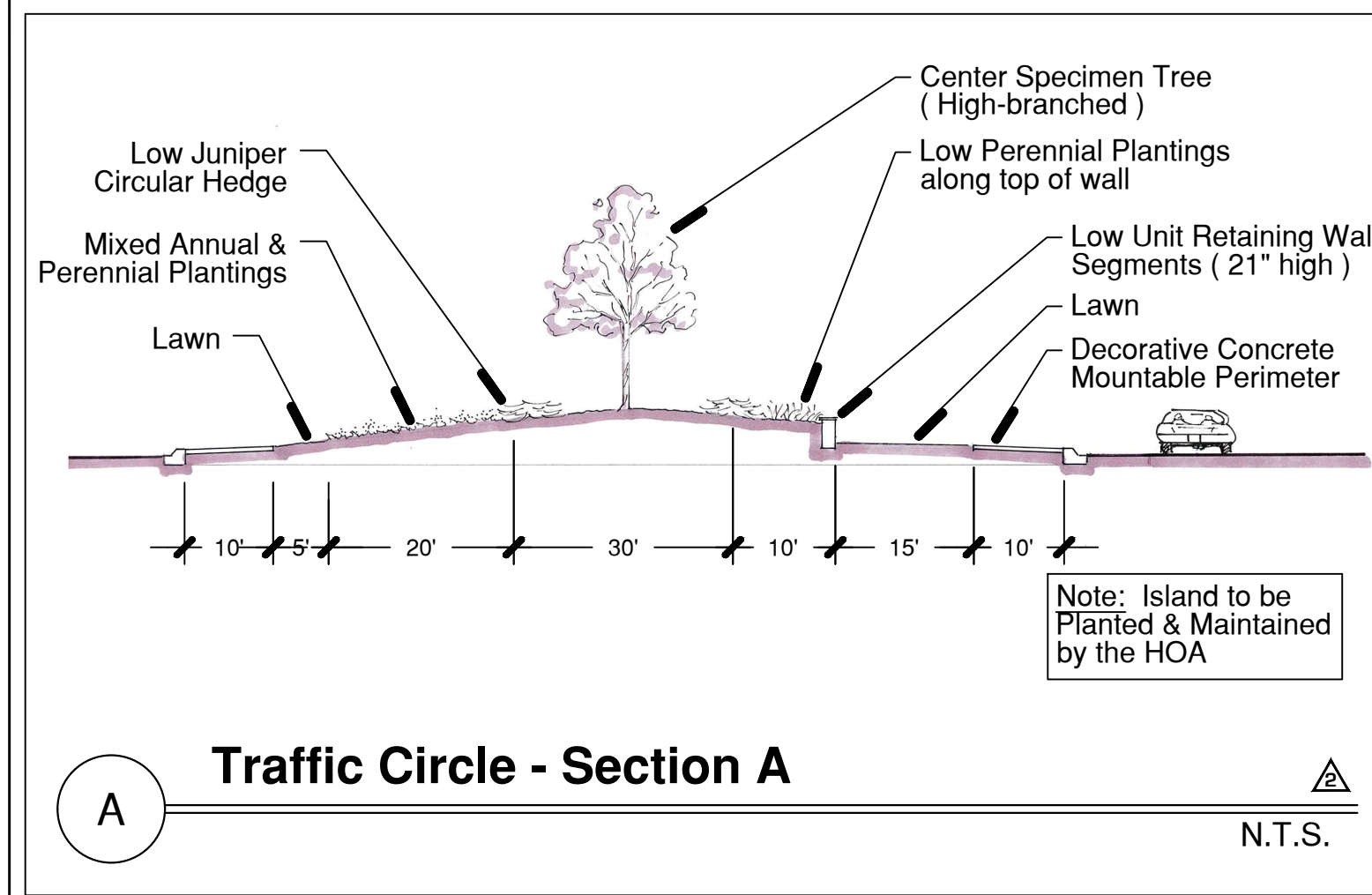

General Notes :

- See Sheet L.104 for Parkway Trees Plan
- See Sheet L.105 for Turf Establishment Plan
- See Sheet L.106 for Plant Material Information
- See Sheet L.107 for Typical House Landscape Packages
- See Sheet L.108 for Typical Townhome Foundation Planting Plans

Sheet Key:

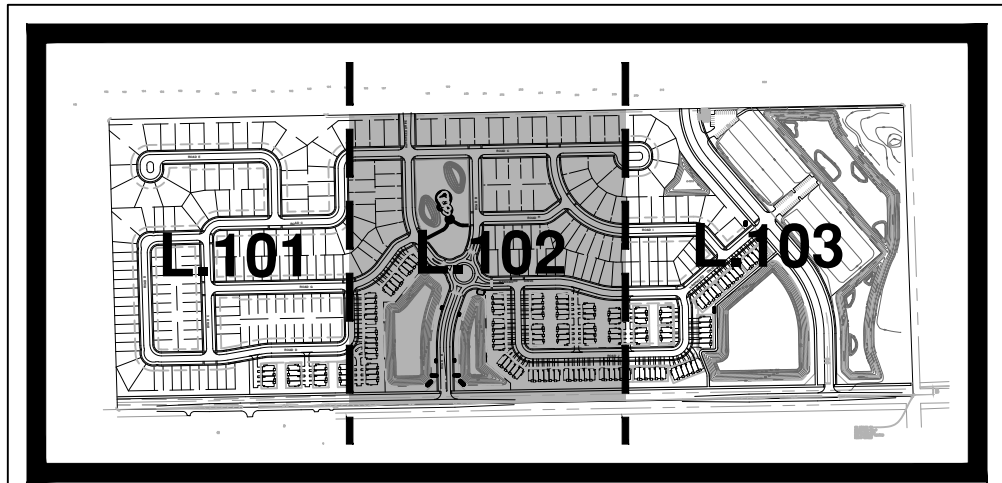

project:

Polo Club

119th St. & Book Rd.
Naperville, Illinois

sheet description:

Preliminary Landscape Plan East Section

owner:

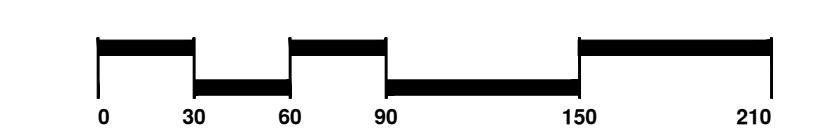

north: scale: 1" = 60'0"

	9.28.2022	Added Sitting Areas outlet A & B
	8.26.2022	Per Wolf Drive Removal
	8.19.2022	Per City Review Comments dated 8.9.2022
	7.22.2022	Per City Review Comments dated 7.13.2022

revisions:
original issue date: **6 June 2022**

drawn by:
checked by:
project no.: **22012**
sheet no.:

L.103

Plant Material Legend :

- Parkway Trees, 2 1/2"
- Shade Tree, 2 1/2" - 3"
- River Birch, 8' - 12' m/s
- Ornamental Tree, 6' - 8'
- Evergreen Tree 6' - 8'
- Columnar Evergreen Tree, 6'
- Deciduous Shrub Bed, 18"-36"
- Evergreen Shrub Bed, 18"
- Ornamental Grass Bed, 1gal.

General Notes :

- See Sheet L.104 for Parkway Trees Plan
- See Sheet L.105 for Turf Establishment Plan
- See Sheet L.106 for Plant Material Information
- See Sheet L.107 for Typical House Landscape Packages
- See Sheet L.108 for Typical Townhome Foundation Planting Plans

Sheet Key:

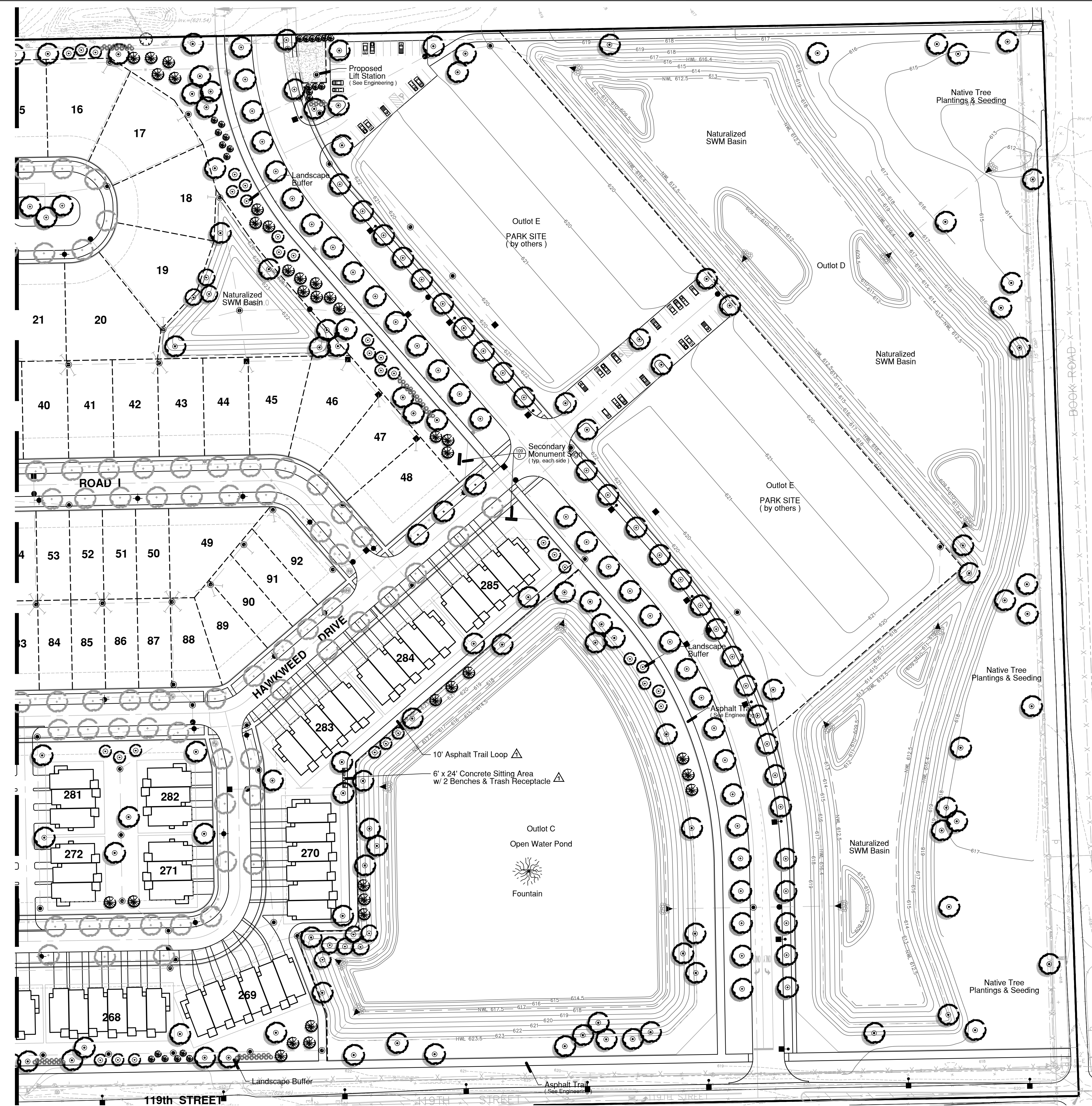
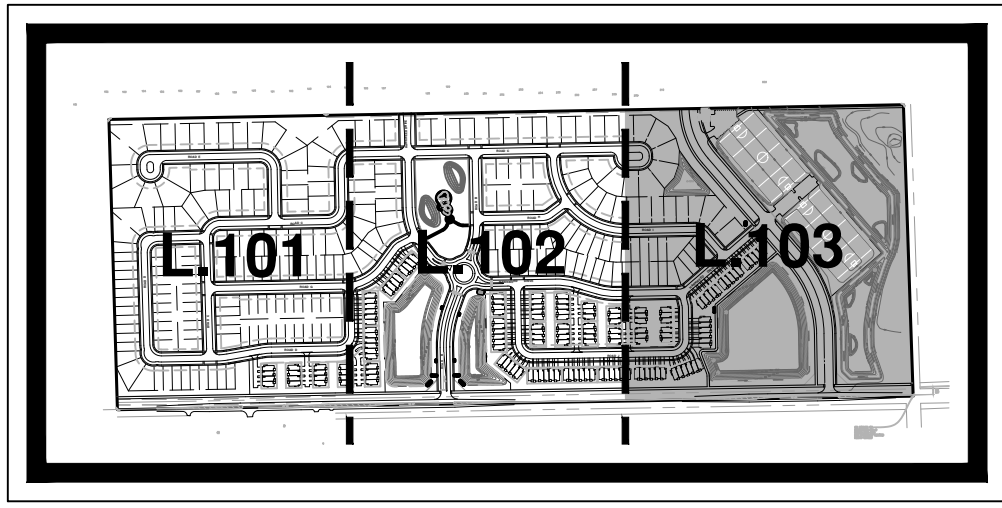



Land Planning
Landscape Architecture
Environmental Site Design

132 N. WASHINGTON ST. - NAPERVILLE, IL 60540 - 630.305.3980 Fax 630.305.3994

project:

Polo Club

119th St. & Book Rd.
Naperville, Illinois

sheet description:

Preliminary Parkway Tree Plan

owner:

Parkway Tree Legend : (Sheet L.104 Only)

Proposed Common Area Parkway Trees, 2.5" Caliper Planted at approx. 40' o.c. during Initial Site Development

- Species :
- | | |
|-----------------------|----------------------|
| Chicagoland Hackberry | Redmond Linden |
| Magyar Gingko | Swamp White Oak |
| Skyline Locust | Kentucky Coffeetree |
| Exclamation Planetree | Accolade Elm |
| Triumph Elm | Emerald Lustre Maple |
| State Street Maple | Tuliptree |

Proposed Individual Lot Parkway Trees, 2.5" Caliper at approx. 40' o.c. To be Planted by Pulte at the time of individual house construction

- Species :
- | | |
|-----------------------|----------------------|
| Chicagoland Hackberry | Redmond Linden |
| Magyar Gingko | Swamp White Oak |
| Skyline Locust | Kentucky Coffeetree |
| Exclamation Planetree | Accolade Elm |
| Triumph Elm | Emerald Lustre Maple |
| Autumn Blaze Maple | Red Oak |
| American Hornbeam | Bald Cypress |

Parkway Construction Notes :

- No more than 10% of the same species may be used in total.
- No more than 5 trees of the same species may be planted adjacently, except where noted for Boulevard continuity.
- Understory trees must be used in areas with an overhead utility conflict.
- Plant material sizing, branching and ball sizes shall conform to the "American Standards for Nursery Stock" (latest edition) by the American Association of Nurserymen, Inc.
- Plant material shall be nursery grown and be either balled and burlapped or container grown. Sizes and spreads on plant list represent minimum requirements.
- Quantity lists are supplied as a convenience. Contractor shall verify all quantities, and in case of a discrepancy, the plan shall prevail.
- Contractor shall report any discrepancies in the field to the Landscape Architect and/or Owner.
- The Landscape Contractor shall verify locations of all underground utilities prior to digging, is required to Contact J.U.L.I.E. (1.800.892.0123), and any other public or private agency necessary for utility location 48 hours prior to construction.
- Where underground utilities exist, all field adjustments must be approved by the landscape architect.
- The Landscape Contractor shall water plant material, seed and sod areas until the plants have become adequately established and until final acceptance by the owner. Owner to provide all supplemental watering and proper care and maintenance of all plant materials, seed and sod areas after acceptance of Landscape Contractors work.
- No plants are to be changed or substituted without the approval of the Landscape Architect and the City of Naperville.
- Landscape Contractor shall warrant all material and labor for a period of one year from the date of final acceptance and shall repair any defects and replace all dead plant material as required during the warranty period.
- Trees must be at least 10' away from fire hydrants and 5' away from valve boxes and manholes.
- Trees must be at least 10' away from storm structures and 5' away from storm sewers.
- Trees must be at least 10' away from water and sanitary structures and 5' away from water mains and sanitary sewers.
- No trees, shrubs or obstacles within 10' of the front, or within 5' of the sides / rear, of the transformer, or within 5' of underground cables. Larger trees have larger root systems and will require larger clearance.
- Trees shall not be planted within the sight line at intersections (30' measured from property line intersection).
- Parkway trees must be spaced no more than 40'

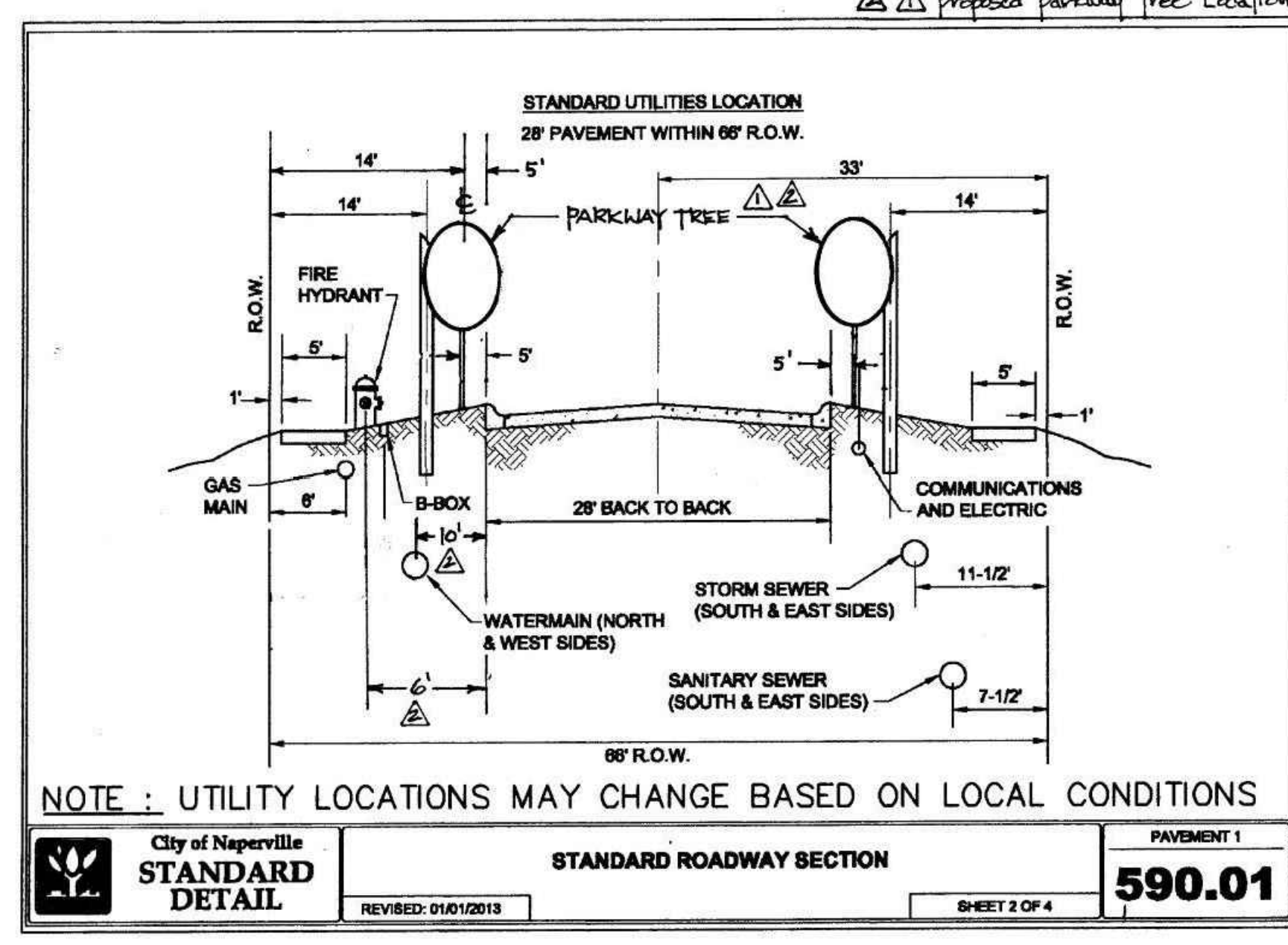

scale: Approx. 1" = 120'

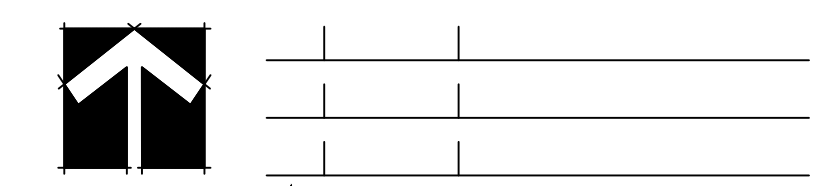

- revisions:
- 9.28.2022 Added Sitting Areas outlot A & B
 - 8.26.2022 Per Wolf Drive Removal dated 8.9.2022
 - 8.19.2022 Per City Review Comments dated 8.9.2022
 - 7.22.2022 Per City Review Comments dated 7.13.2022

original issue date: 6 June 2022

drawn by:
checked by:
project no.: 22012
sheet no.:

Standard Parkway Section w/ Parkway Tree Locations

project:

Polo Club

119th St. & Book Rd.
Naperville, Illinois

sheet description:

Turf Exhibit

owner:



SE CORNER OF SECTION 22-31-9 FOUND FROM ROD FOR MONUMENT RECORD R210-051825

north: scale: N.T.S.

revisions:	date:	description:
▲	9.28.2022	Added Sitting Areas outlet A & B
▲	8.26.2022	Per Wolf Drive Removal
▲	8.19.2022	Per City Review Comments dated 8.9.2022
▲	7.22.2022	Per City Review Comments dated 7.13.2022

original issue date: **6 June 2022**

drawn by: _____
checked by: _____
project no.: **22012**
sheet no.: _____

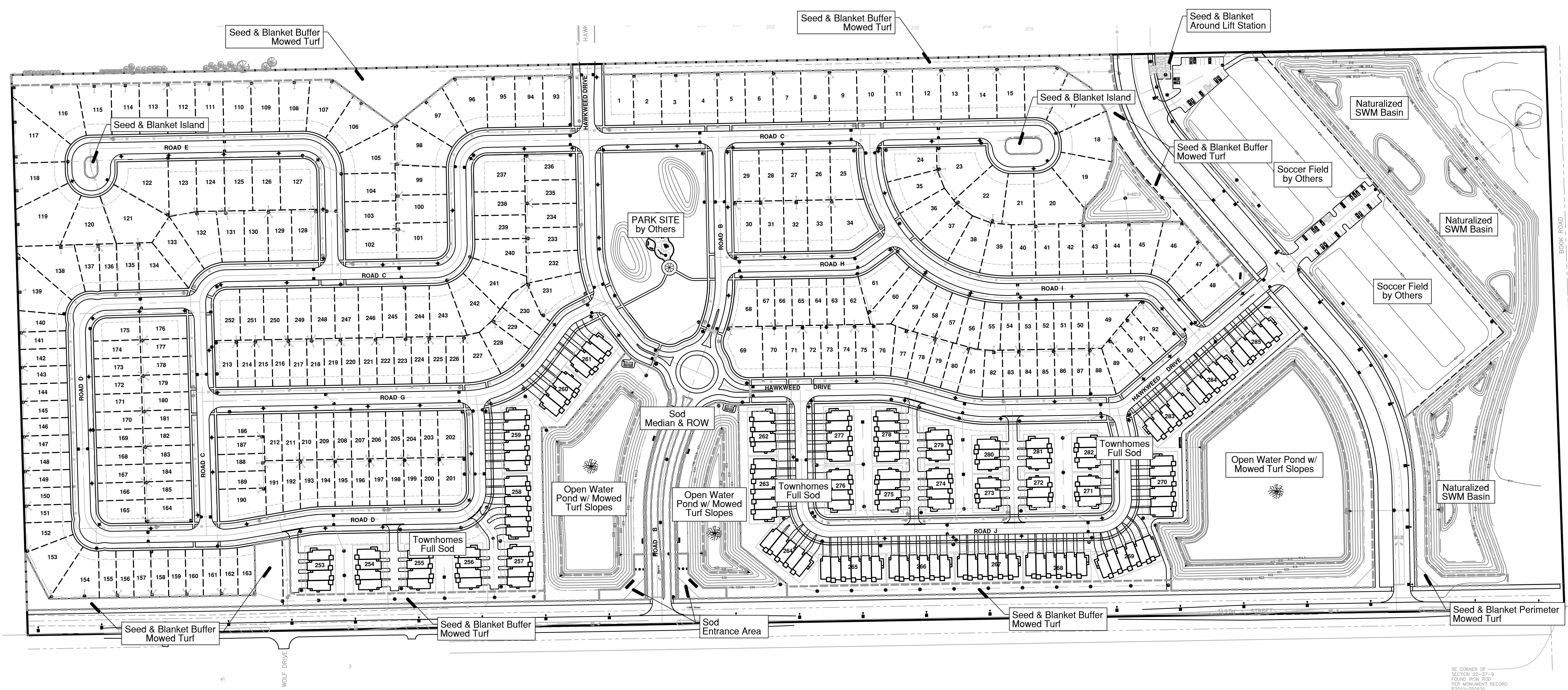

Preliminary Plant Material Legend : (Sheet L.101 - L.103)

-  **Parkway Tree, 2.5" Caliper**
(See Sheet L.104)
-  **Shade Trees, 2.5" - 3" Caliper**

Redpointe Maple	Swamp White Oak
State Street Maple	Chicagoland Hackberry
Shawnee Brave Baldcypress	Kentucky Coffeetree
Redmond Linden	Exclamation London Planetree
Red Oak	Bur Oak
Skyline Locust	Triumph Elm
-  **Large Ornamental Trees, 8' - 10' m/s**
River Birch
-  **Ornamental Trees, 6' - 8' m/s**

Blackhaw Viburnum	Prairie Fire Crab
Apple Serviceberry	Ivory Silk Tree Lilac
Redbud	Sargent Crab
Common Witchhazel	Donald Wyman Crab
-  **Evergreen Trees, 6' - 8' tall**

Norway Spruce	White Pine
Black Hills Spruce	White Fir
Limber Pine	
-  **Upright, Columnar Evergreen, 5' - 6' tall**

Wintergreen Arborvitae	Fairview Juniper
Mission Arborvitae	Green Giant Arborvitae
Spartan Juiper	Canartii Juniper
-  **Evergreen Shrubs, 18" - 24" wide**

Hughes Juniper	Bigleaf Wintercreeper
Kallay Compact Juniper	Dense Yew
Slomound Mugo Pine	
-  **Deciduous Shrubs, 18" - 48" tall**

Yellow Potentilla	Grolo Sumac
Black Chokeberry	Miss Kim Lilac
Dogwoods Var.	Viburnums Var.
Panicle Hydrangea Var.	Shrub Rose Var.
Texas Scarlet Quince	Spirea Var.
Annabelle Hydrangea	Dw. Bush Honeysuckle
-  **Perennials, Ornamental Grasses & Groundcovers, 1gal.**

Feather Reed Grass	Daylily sp.
Prairie Dropseed	Blue Wonder Catmint
Switchgrass	Black Eye Susan
Lillyturf	Russian Sage
Aut. Moor Grass	Allium sp.
Sedum sp.	Amsonia sp.

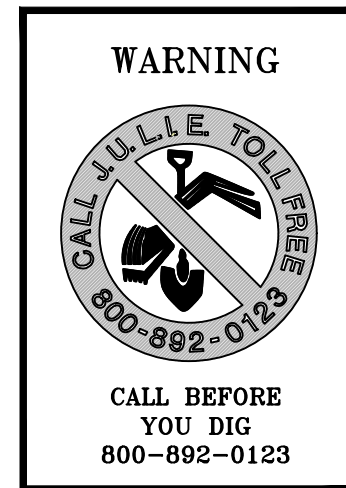

CONSTRUCTION NOTES :

- Sod all turf areas as noted with an approved blend of improved Kentucky Bluegrass Sod with a mineral soil back.
- Drill seed all remaining turf areas as noted and cover with an S-75 Straw Erosion Control Blanket and staple in place.
- Fine grading shall provide slopes which are smooth and continuous. Positive drainage shall be provided in all areas.
- Prior to turf installation all areas shall be fertilized with a 12-12-12 granular fertilizer at a rate of 400 lbs. per Acre.
- Prepare perennial, ornamental grass, groundcover and annual flower beds with 1 CY. mushroom compost per 100 SF. rototilled to an 8" depth.
- Mulch all trees, shrub, perennial & orn'l grass beds with a minimum of three inches shredded hardwood bark mulch.
- Mulch all groundcover and annual beds with minimum of one inch pinebark fines.
- All bed lines and tree saucers require a 4" deep spaded edge between lawn and mulch areas.
- All evergreen (conifers) trees and shrubs must be grown in a natural shape - and not sheared.
- Plant material sizing, branching and ball sizes shall conform to the "American Standards for Nursery Stock" (latest edition) by the American Association of Nurserymen, Inc.
- Plant material shall be nursery grown and be either balled and burlapped or container grown. Sizes and spreads on plant list represent minimum requirements.
- Quantity lists are supplied as a convenience. Contractor shall verify all quantities, and in case of a discrepancy, the plan shall prevail.
- The Landscape Contractor shall adjust plant locations in field to maintain appropriate spacing from fire hydrants, light poles, all utility structures, driveways and sidewalks. Approval of the Landscape Architect is required when field adjustments to be implemented do not conform to the intent of the plans.
- Contractor shall report any discrepancies in the field to the Landscape Architect and/or Owner.
- The Landscape Contractor shall verify locations of all underground utilities prior to digging, is required to Contact J.U.L.I.E. (1.800.892.0123), and any other public or private agency necessary for utility location 48 hours prior to construction.
- Where underground utilities exist, all field adjustments must be approved by the landscape architect.
- The Landscape Contractor shall water plant material, seed and sod areas until the plants have become adequately established and until final acceptance by the owner. Owner to provide all supplemental watering and proper care and maintenance of all plant materials, seed and sod areas after acceptance of Landscape Contractors work.
- No plants are to be changed or substituted without the approval of the Landscape Architect and the City of Naperville.
- Landscape Contractor shall warrantee all material and labor for a period of one year from the date of final acceptance and shall repair any defects and replace all dead plant material as required during the warranty period.

NOTE : • All fire hydrants shall have a minimum of 4 feet of clearance.

NOTE : • Trees must be at least 10' away from storm structures and 5' away from storm sewers.

NOTE : • Trees must be at least 10' away from water and sanitary structures and 5' away from water mains and sanitary sewers.

NOTE : • No trees, shrubs or obstacles within 10' of the front, or within 5' of the sides / rear, of the transformer, or within 5' of underground cables.

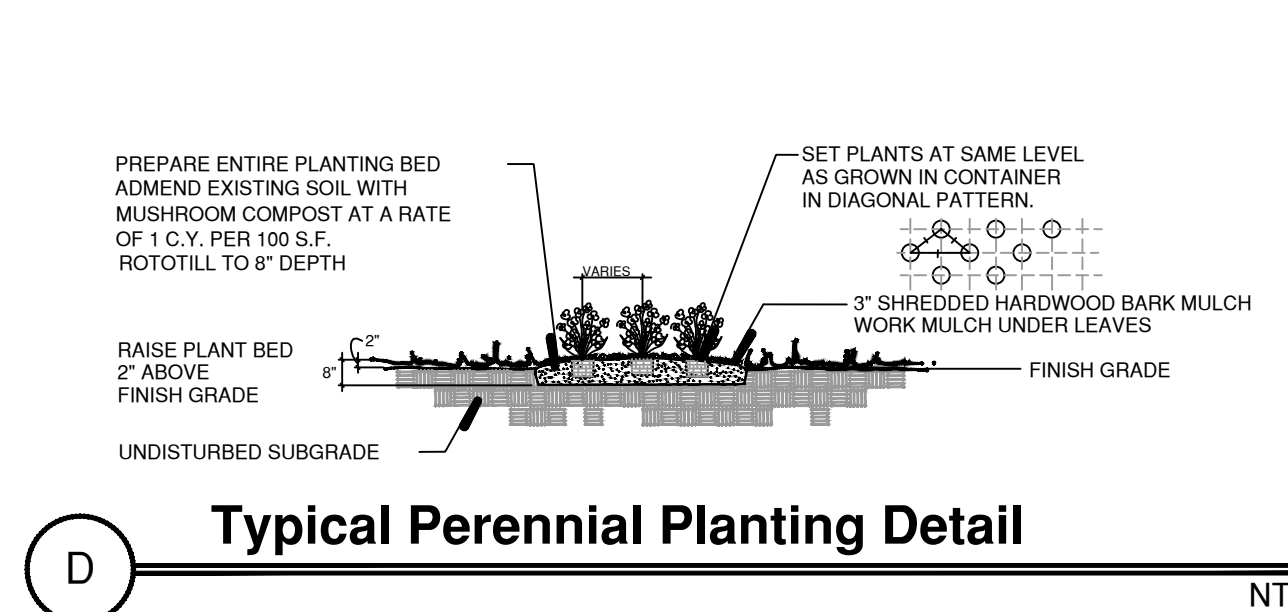
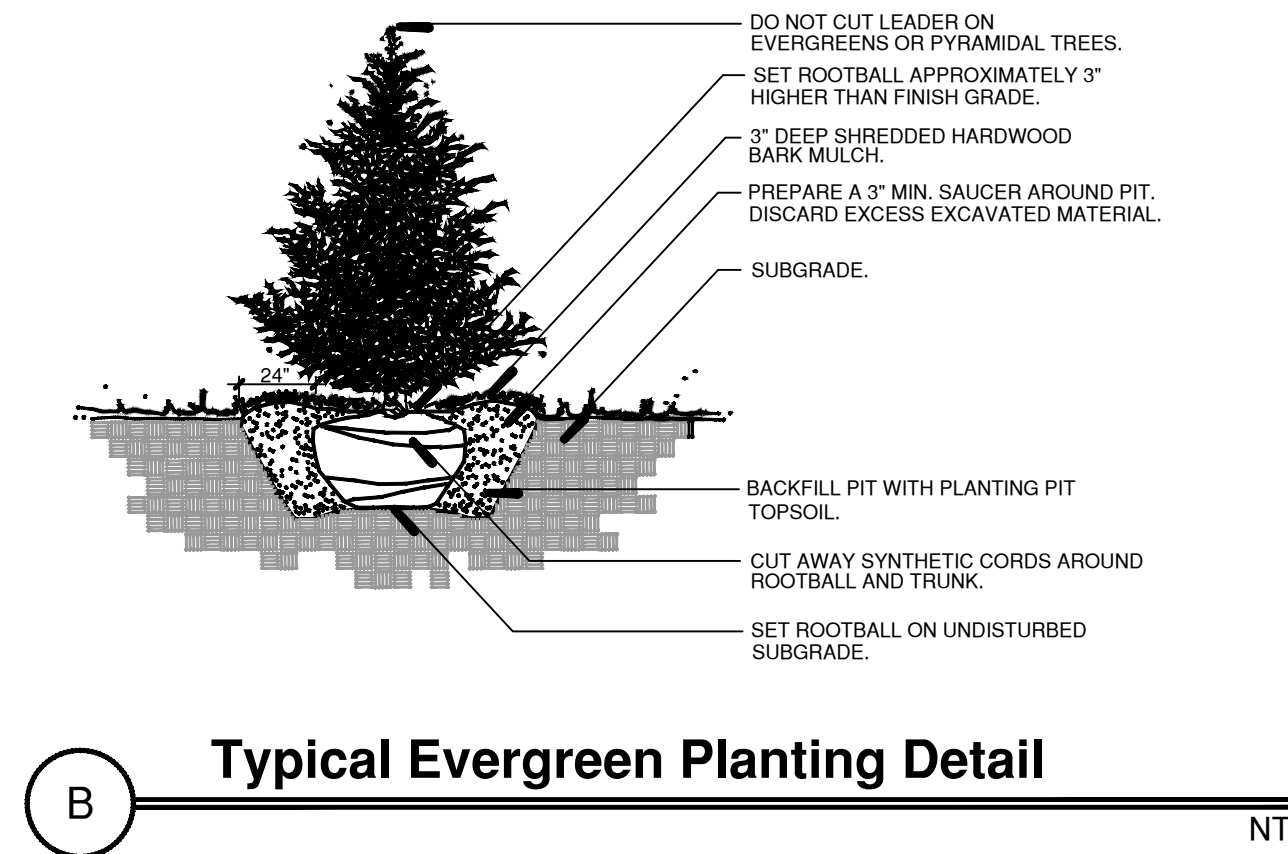
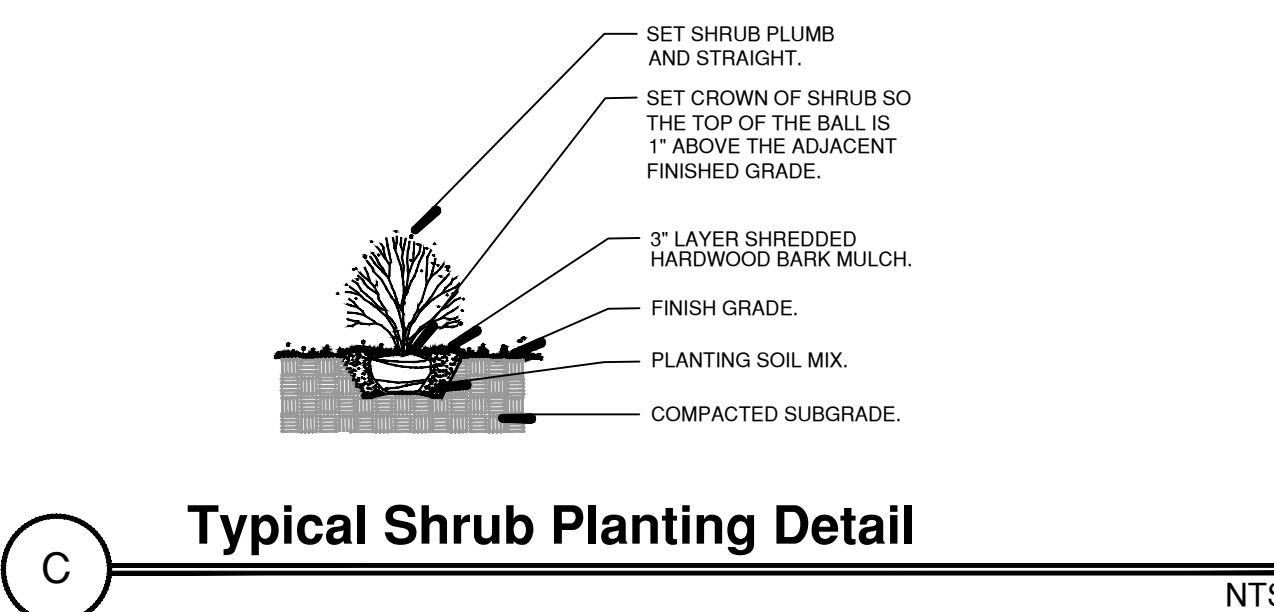
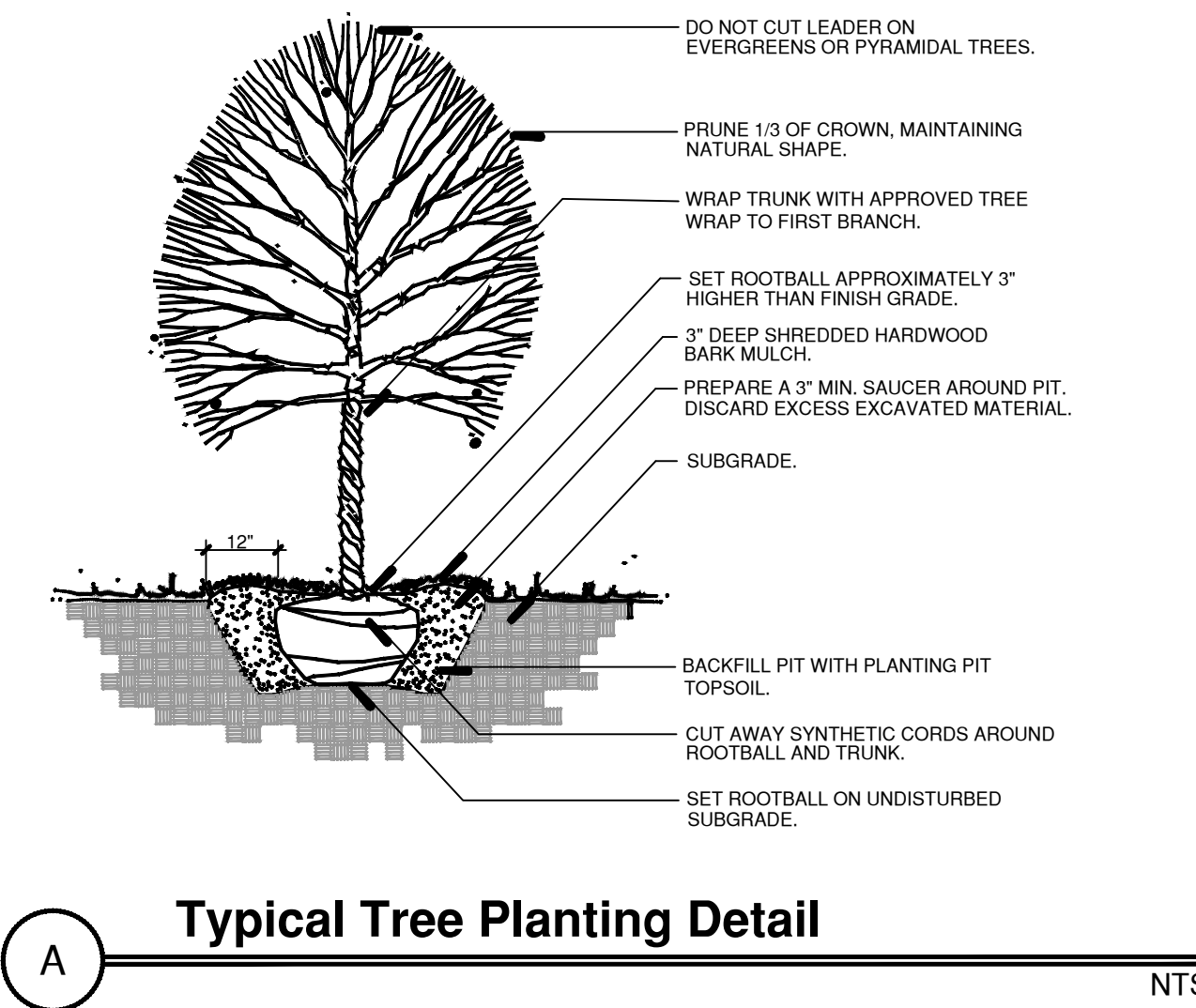

Land Planning
Landscape Architecture
Environmental Site Design

132 N. WASHINGTON ST. - NAPERVILLE, IL 60540 - 630.305.3980 Fax 630.305.3994

project:

Polo Club

119th St. & Book Rd.
Naperville, Illinois

sheet description:



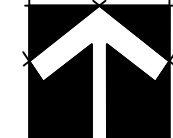
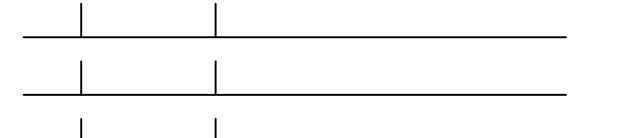
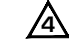
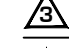
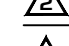
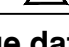

Plant Legend, Notes & Planting Details

owner:

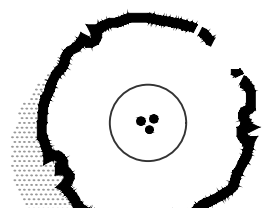

north:	scale:
	
revisions:	original issue date:
<ul style="list-style-type: none">  9.28.2022 Added Sitting Areas outlot A & B  8.26.2022 Per Wolf Drive Removal dated 8.9.2022  8.19.2022 Per City Review Comments dated 8.9.2022  7.22.2022 Per City Review Comments dated 7.13.2022 	6 June 2022
drawn by:	checked by:
project no.:	22012
sheet no.:	L.106

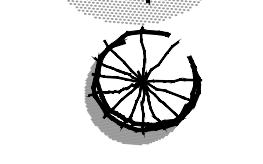
Preliminary Plant Material Legend : (Sheet L.107 Only)

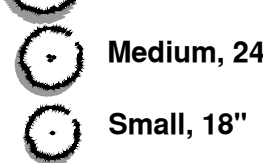
- | | |
|---|---|
|  | Ornamental Trees, 7' m/s or 2.5" Caliper |
| | River Birch Vernal Witchhazel |
| | Prairie Fire Crab Apple Serviceberry |
| | Red Jewel Crab Jap. Tree Lilac |
|  | Large Evergreen Trees, 6' tall |
| | Black Hills Spruce White Fir |
| | White Pine Canadian Hemlock |
|  | Upright Evergreens, 4' - 5' tall |
| | Nigra Arborvitae Fairview Upright Juniper |
| | Spartan Upright Juniper Mission Arborvitae |
|  | Evergreen Shrubs, 18" - 24" wide |
| | Dense Yew Green Velvet Boxwood |
| | Kallay Compact Juniper Bigleaf Euonymus (Vegetus) |
|  | Deciduous Shrubs, 18" - 36" tall |
| | M. Black Chokeberry S. Grolo Sumac |
| | L. Bergeson Comp. Dogwood L. Blue Muffin Viburnums |
| | L. Limeight Hydrangea M. Shurb Rose Var. |
| | M. Texas Scarlet Quince M. Grefshim Spirea |
| | S. G.M. Alpine Currant S. Dw. Bush Honeysuckle |
| | S. Goldmound Spirea L. Miss Kim Lilac |
| | M. Annabelle Hydrangea M. Little Quickfire Hydrangea |
|  | Perennials, Ornamental Grasses, 1gal. |
| | Black Eye Susan Switchgrass |
| | Purple Coneflower Prairie Dropseed |
| | Feather Reed Grass Autumn Moor Grass |
| | Blue Catmint Northern Sea Oats |
| | Happy Return Daylily |

CONSTRUCTION NOTES :

- Sod all turf areas as noted with an approved blend of improved Kentucky Bluegrass Sod with a mineral soil back.
- Drill seed all remaining turf areas as noted and cover with an S-75 Straw Erosion Control Blanket and staple in place. Seed shall be applied at a rate of 200 lbs. per Acre./300 lbs. per Acre for Detention mix. Lawn seed mix shall be as follows:
70% Improved, Kentucky Bluegrass (minimum three varieties)
20% Improved, Perennial Ryegrass (minimum two varieties with endophytes)
10% Creeping Red Fescue
- Fine grading shall provide slopes which are smooth and continuous. Positive drainage shall be provided in all areas.
- Prior to turf installation all areas shall be fertilized with a 12-12-12 granular fertilizer at a rate of 400 lbs. per Acre.
- Prepare perennial, ornamental grass, groundcover and annual flower beds with 1 CY. mushroom compost per 100 SF. rototilled to an 8" depth.
- Mulch all trees, shrub, perennial & ornamental grass beds with a minimum of three inches shredded hardwood bark mulch.
- Mulch all groundcover and annual beds with minimum of one inch pinebark fines.
- All bed lines and tree saucers require a 4" deep spaded edge between lawn and mulch areas.
- All evergreen (conifers) trees and shrubs must be grown in a natural shape - and not sheared.
- Plant material sizing, branching and ball sizes shall conform to the "American Standards for Nursery Stock" (latest edition) by the American Association of Nurseryman, Inc.
- Plant material shall be nursery grown and be either balled and burlapped or container grown. Sizes and spreads on plant list represent minimum requirements.
- Quantity lists are supplied as a convenience, Contractor shall verify all quantities, and in case of a discrepancy, the plan shall prevail.
- The Landscape Contractor shall adjust plant locations in field to maintain appropriate spacing from fire hydrants, light poles, all utility structures, driveways and sidewalks. Approval of the Landscape Architect is required when field adjustments to be implemented do not conform to the intent of the plans.
- Contractor shall report any discrepancies in the field to the Landscape Architect and/or Owner.
- The Landscape Contractor shall verify locations of all underground utilities prior to digging, is required to Contact J.U.L.I.E. (1.800.892.0123), and any other public or private agency necessary for utility location 48 hours prior to construction.
- Where underground utilities exist, all field adjustments must be approved by the landscape architect.
- The Landscape Contractor shall water plant material, seed and sod areas until the plants have become adequately established and until final acceptance by the owner. Owner to provide all supplemental watering and proper care and maintenance of all plant materials, seed and sod areas after acceptance of Landscape Contractors work.
- No plants are to be changed or substituted without the approval of the Landscape Architect and the City of Naperville.
- Landscape Contractor shall warrantee all material and labor for a period of one year from the date of final acceptance and shall repair any defects and replace all dead plant material as required during the warranty period.

Note: Adjacent common area trees, evergreens and ornamentals are note shown on this exhibit. See Common area landscape plans for additional plantings.

Note: Typical Home Planting Plans show the general layout, plant material selections and design intent. Final Plans will be adjusted as required for unit.

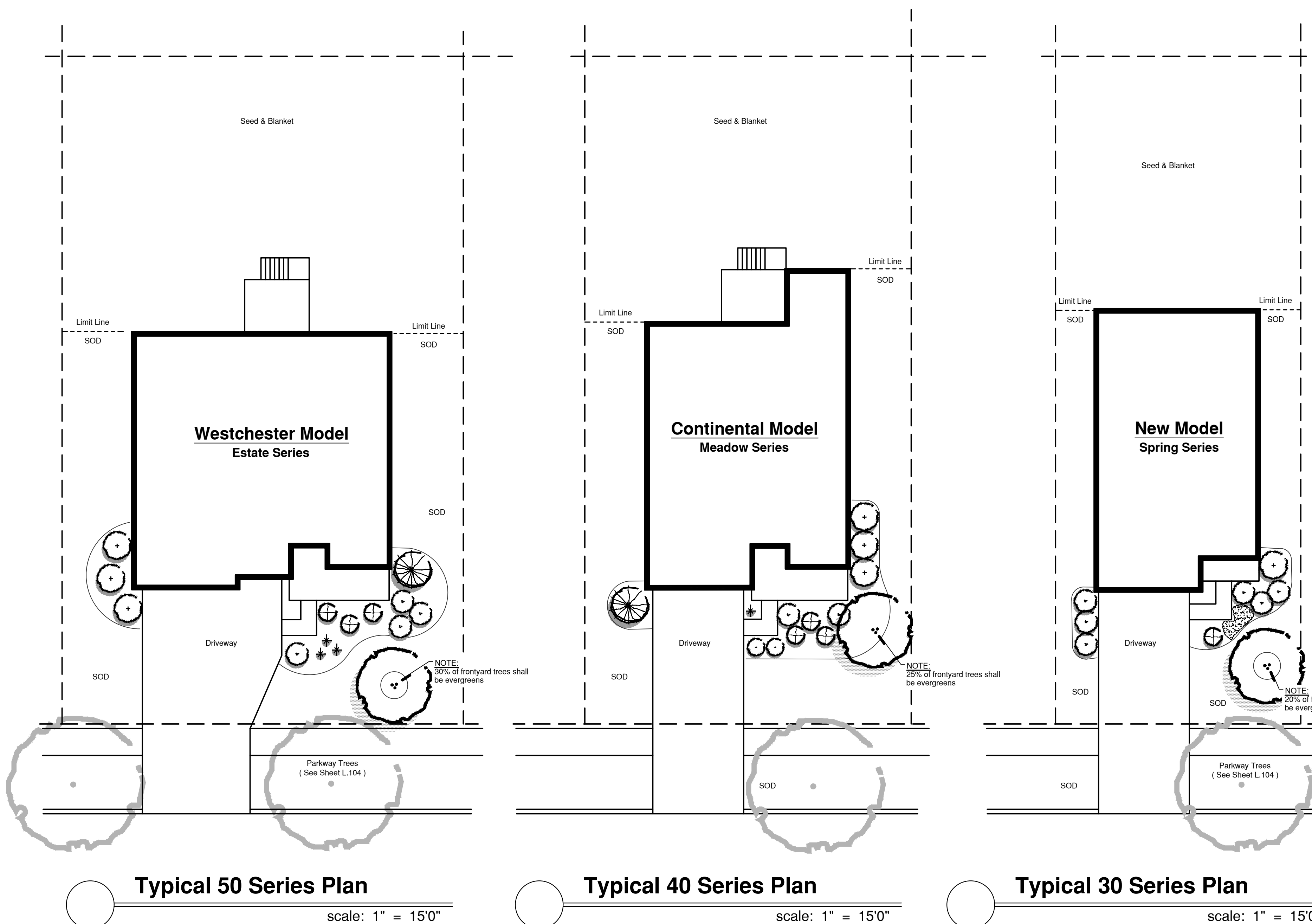

Typical 50 Series Plan
scale: 1" = 15'0"

Typical 40 Series Plan
scale: 1" = 15'0"

Typical 30 Series Plan
scale: 1" = 15'0"



Land Planning
Landscape Architecture
Environmental Site Design
132 N. WASHINGTON ST. - NAPERVILLE, IL 60540 - 630.305.3980 Fax 630.305.3994

project:

Polo Club

119th St. & Book Rd.
Naperville, Illinois

sheet description:
**Prototypical House
Planting Plans**

owner:

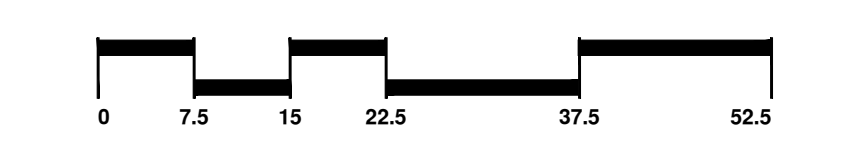

north: scale: 1" = 15'0"

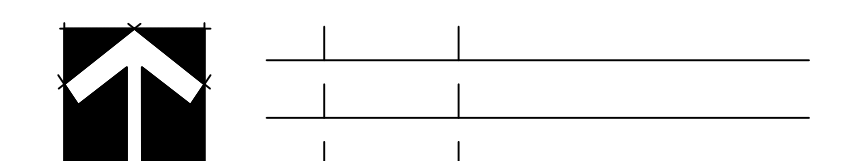

9.28.2022	Added Sitting Areas outlet A & B
8.26.2022	Per Wolf Drive Removal
8.19.2022	Per City Review Comments dated 8.9.2022
7.22.2022	Per City Review Comments dated 7.13.2022

original issue date: **6 June 2022**

drawn by:
checked by:
project no.: **22012**
sheet no.:

PLANT MATERIAL LEGEND : (Sheet L.108 Only)

- Ornamental Trees, 6' - 8' m/s or 2.5" cal.**
 20% Prairie Fire Crab, 8' or 2.5"
 20% Red Jewel Crab, 8' or 2.5"
 20% Apple Serviceberry, 7'
 50% Ann Magnolia, 5'
 10% Common Witchhazel, 6'
 10% Ivory Silk Tree Lilac, 6'
- Upright Evergreen, 4' - 6' tall**
 40% Mission Arborvitae, 6'
 40% Fairview Upright Juniper, 5'
 20% Green Giant Arborvitae, 4'
- Evergreen Shrubs, 24" wide**
 25% Dense Yew, 24"
 25% Green Velvet Boxwood, 18"
 50% Kallay Compact Juniper, 18"
- Deciduous Shrubs, 24" - 36" tall**
 35% Bergeson Comp. & Red Dogwood, 36" (large)
 25% Blue Muffin Viburnums, 36" (large)
 20% Limelight Hydrangeas, 30" (large)
 20% Miss Kim Lilac, 36" (large)
 50% Annabella Hydrangea, 24" (med.)
 20% Black Chokeberry, 24" (med.)
 20% Knockout Shrub Rose, 18" (med.)
 10% Snowmound Spirea, 24" (med.)
 20% G.M. Alpine Currant, 18" (small)
 20% Goldmound Spirea, 18" (small)
 20% Brox Forsythia, 18" (small)
 20% Potentilla - Yellow, 18" (small)
 20% Little Princess Spirea, 18" (small)
- Perennial, 1 gal.**
 25% Blue Wonder Catmint
 25% Happy Return Daylily
 25% Autumn Joy Sedum
 25% Summer Beauty Allium
- Ornamental Grass A, 1 gal.**
 50% K.F. Feather Reed Grass
 50% Shenandoah Red Switch Grass
- Ornamental Grass B, 1 gal.**
 50% Dwarf Prairie Dropseed (Tara)
 50% Autumn Moor Grass

CONSTRUCTION NOTES :

- Sod all turf areas as noted with an approved blend of improved Kentucky Bluegrass Sod with a mineral soil back.
- Fine grading shall provide slopes which are smooth and continuous. Positive drainage shall be provided in all areas.
- Prior to turf installation all areas shall be fertilized with a 12-12-12 granular fertilizer at a rate of 400 lbs. per Acre.
- Prepare perennial, ornamental grass, groundcover and annual flower beds with 1 CY. mushroom compost per 100 SF. rototilled to an 8" depth.
- Mulch all trees, shrub, perennial & orn grass beds with a minimum of three inches shredded hardwood bark mulch.
- Mulch all groundcover and annual beds with minimum of one inch pinebark fines.
- All bed lines and tree saucers require a 4" deep spaded edge between lawn and mulch areas.
- All evergreen (conifers) trees and shrubs must be grown in a natural shape - and not sheared.
- Plant material sizing, branching and ball sizes shall conform to the " American Standards for Nursery Stock " (latest edition) by the American Association of Nurserymen, Inc.
- Plant material shall be nursery grown and be either balled and burlapped or container grown. Sizes and spreads on plant list represent minimum requirements.
- Quantity lists are supplied as a convenience. Contractor shall verify all quantities, and in case of a discrepancy, the plan shall prevail.
- The Landscape Contractor shall adjust plant locations in field to maintain appropriate spacing from fire hydrants, light poles, all utility structures, driveways and sidewalks. Approval of the Landscape Architect is required when field adjustments to be implemented do not conform to the intent of the plans.
- Contractor shall report any discrepancies in the field to the Landscape Architect and/or Owner.
- The Landscape Contractor shall verify locations of all underground utilities prior to digging, is required to Contact J.U.L.I.E. (1.800.892.0123), and any other public or private agency necessary for utility location 48 hours prior to construction.
- Where underground utilities exist, all field adjustments must be approved by the landscape architect.
- The Landscape Contractor shall water plant material, seed and sod areas until the plants have become adequately established and until final acceptance by the owner. Owner to provide all supplemental watering and proper care and maintenance of all plant materials, seed and sod areas after acceptance of Landscape Contractors work.
- No plants are to be changed or substituted without the approval of the Landscape Architect and the City of Naperville.
- Landscape Contractor shall warrantee all material and labor for a period of one year from the date of final acceptance and shall repair any defects and replace all dead plant material as required during the warranty period.

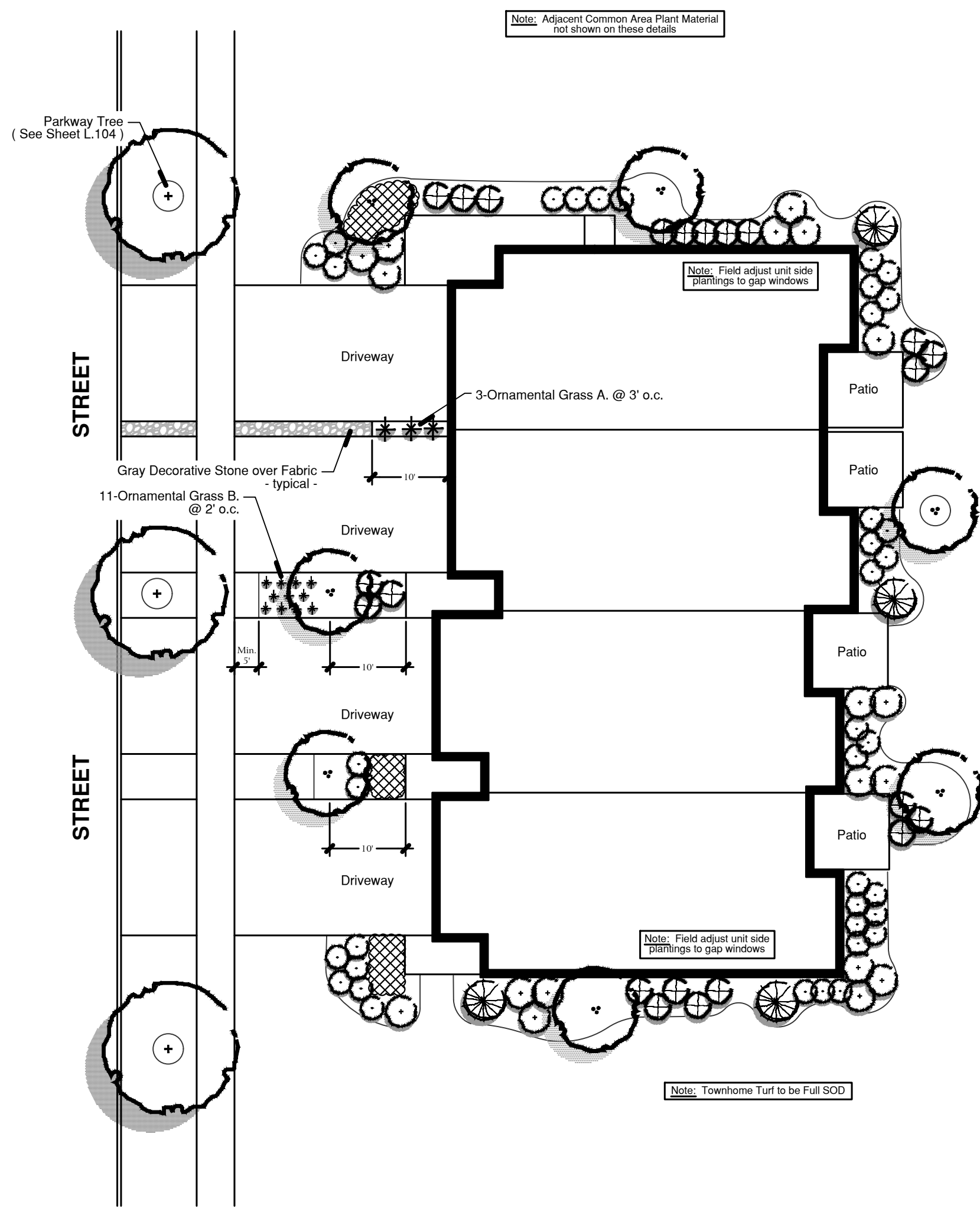

Typical 3 and 4 - Unit Building
scale: 1" = 15'0"

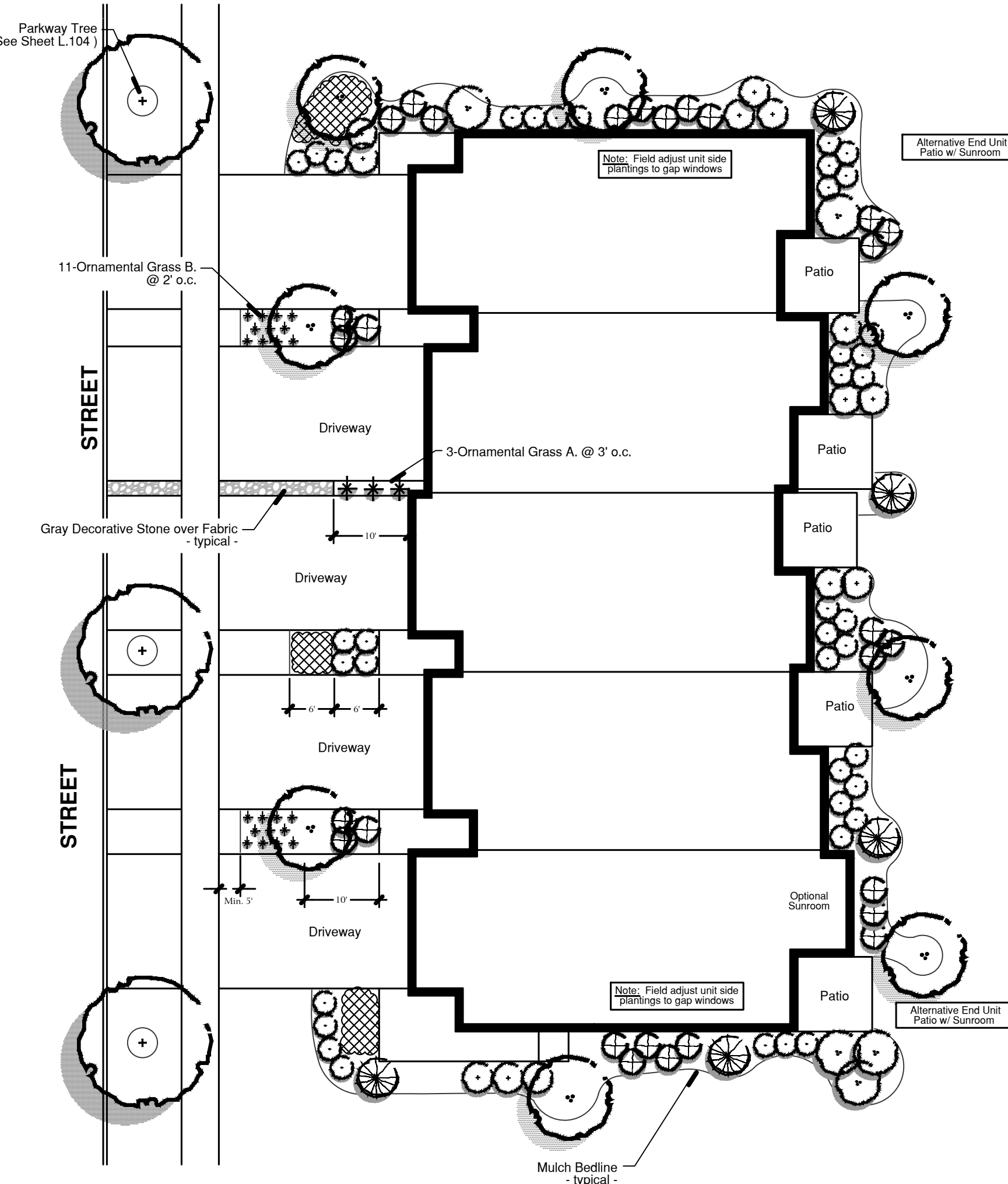

Typical 5 and 6 - Unit Building
scale: 1" = 15'0"

project:

Polo Club

119th St. & Book Rd.
Naperville, Illinois

sheet description:

Typical Townhome Landscape Package

owner:

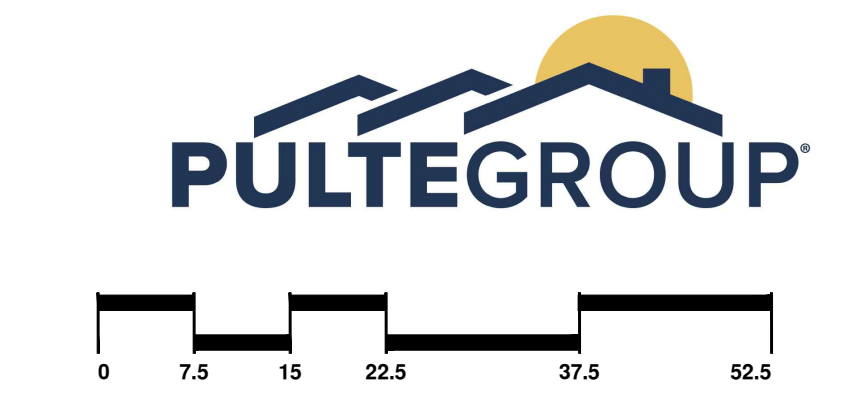

north: scale: 1" = 15'0"

Contractor Quality Control :

- Upon Completion of landscape installation, and prior to final acceptance, the Contractor Shall :
- Lightly hand-prune all trees and evergreens to remove broken, crossing or mis-shaped branches.
 - On clump-form ornamental trees, remove all minor branches, suckers and stems from the bottom 24" of the main trunks.
 - Lightly hand-prune all shrubs to remove wild branches and insure uniformity in groups of similar shrubs.
 - Dead head all perennials plants to remove all old flowers and dead or discolored foliage.
 - Remove all nursery tags and ribbons from all plantings
 - Hand water all plant material.
 - Rake out mulch beds to insure a smooth, uniform layer with a sharp, defined spade edge.

9.28.2022	Added Sitting Areas outlet A & B
8.26.2022	Per Wolf Drive Removal
8.19.2022	Per City Review Comments dated 8.9.2022
7.22.2022	Per City Review Comments dated 7.13.2022

revisions: (see table above)

original issue date: **6 June 2022**

drawn by: _____

checked by: _____

project no.: **22012**

sheet no.: _____

project:

Polo Club

119th St. & Book Rd.
Naperville, Illinois

sheet description:

Preliminary Project Signage

owner:



north: scale: As Noted

▲	9.28.2022	Added Sitting Areas outlet A & B
▲	8.26.2022	Per Wolf Drive Removal
▲	8.19.2022	Per City Review Comments dated 8.9.2022
▲	7.22.2022	Per City Review Comments dated 7.13.2022

original issue date: **10 August 2022**

drawn by:

checked by:

project no.: **22012**

sheet no.:

L.109

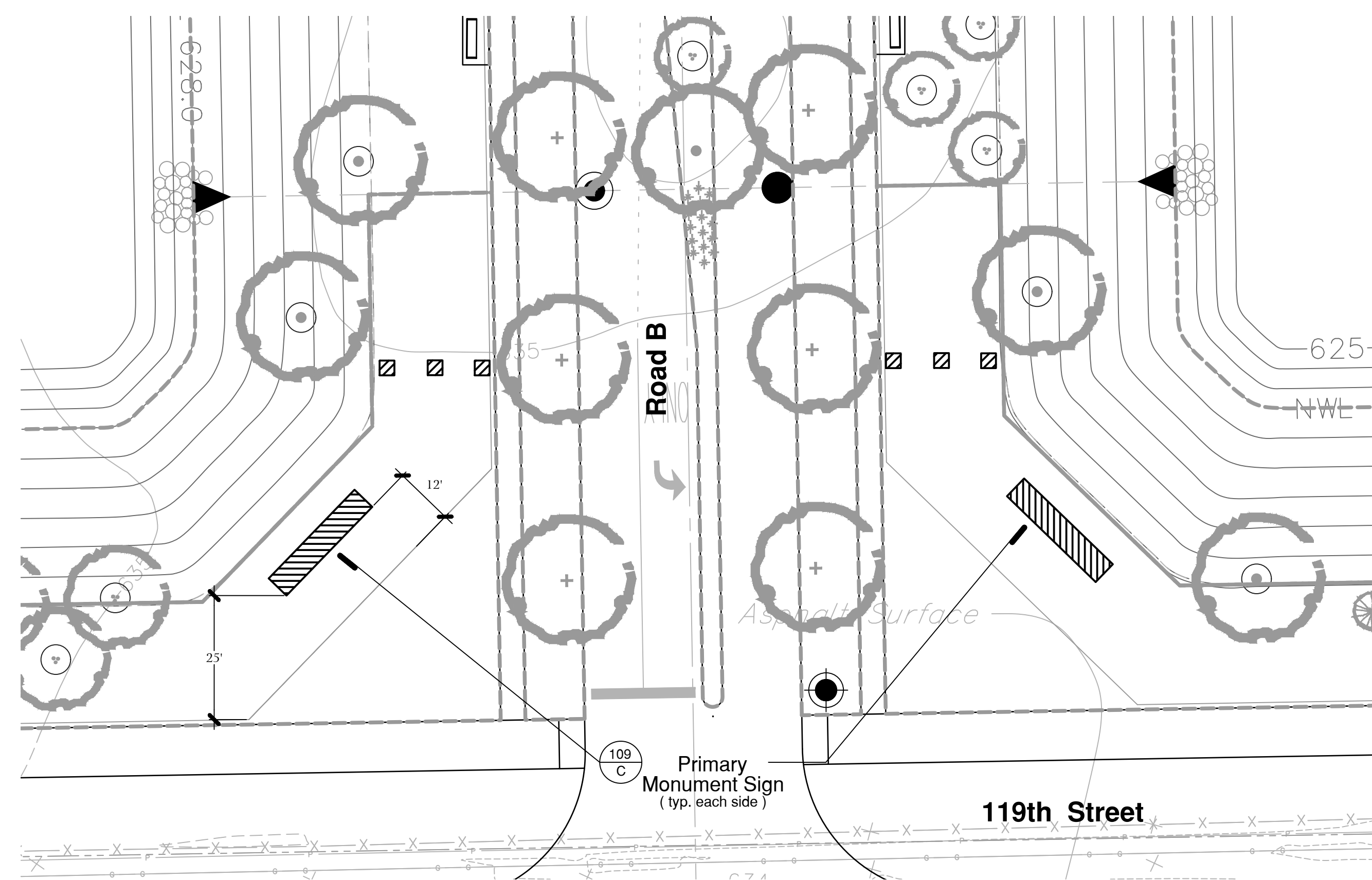

A Primary Monument Sign - 119th Street - Location Plan
scale: 1" = 20'0"

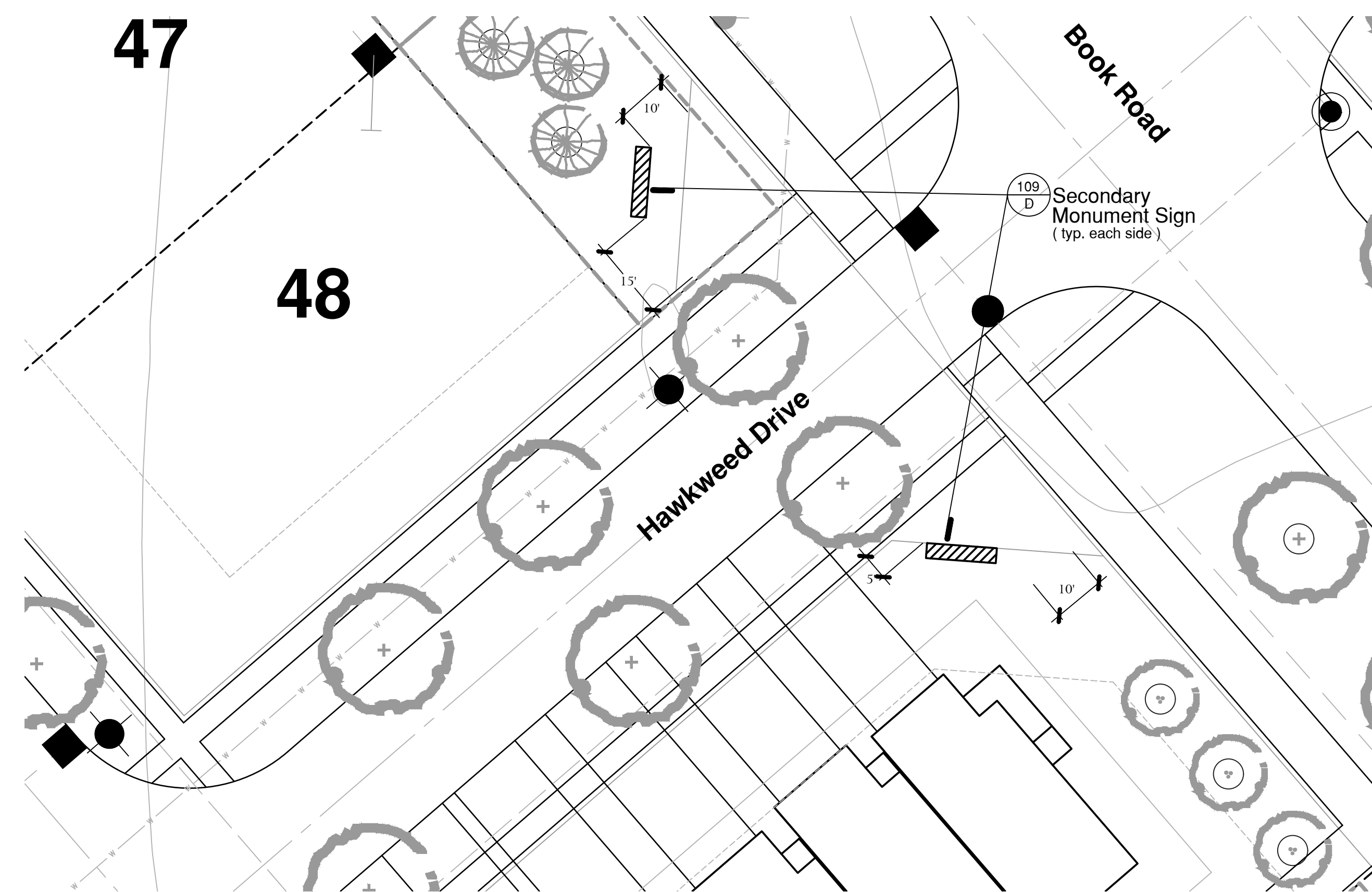

B Secondary Monument Sign - Book Road - Location Plan
scale: 1" = 20'0"

These are Preliminary Elevations intended to show the overall dimensions, materials and massing. These plans may be modified, or revised, in the Final Design Phase.

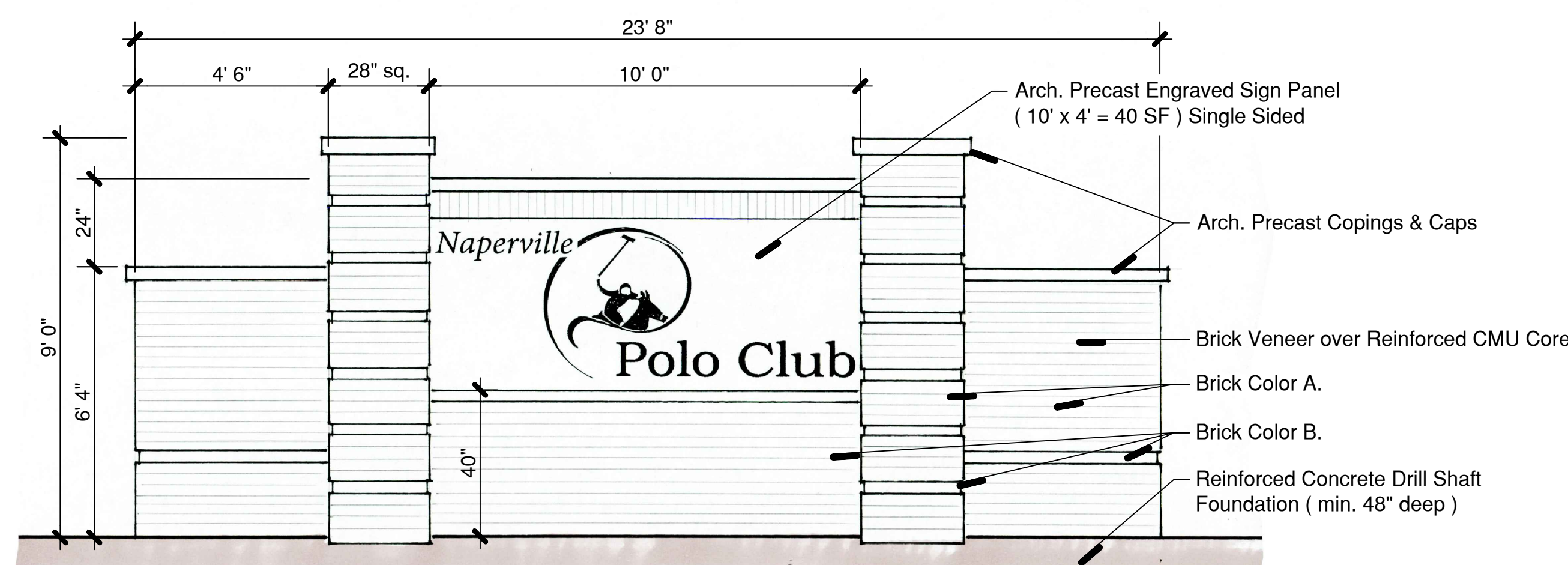

C Primary Monument Sign - 119th Street - Elevation
scale: 3/8" = 1'0"

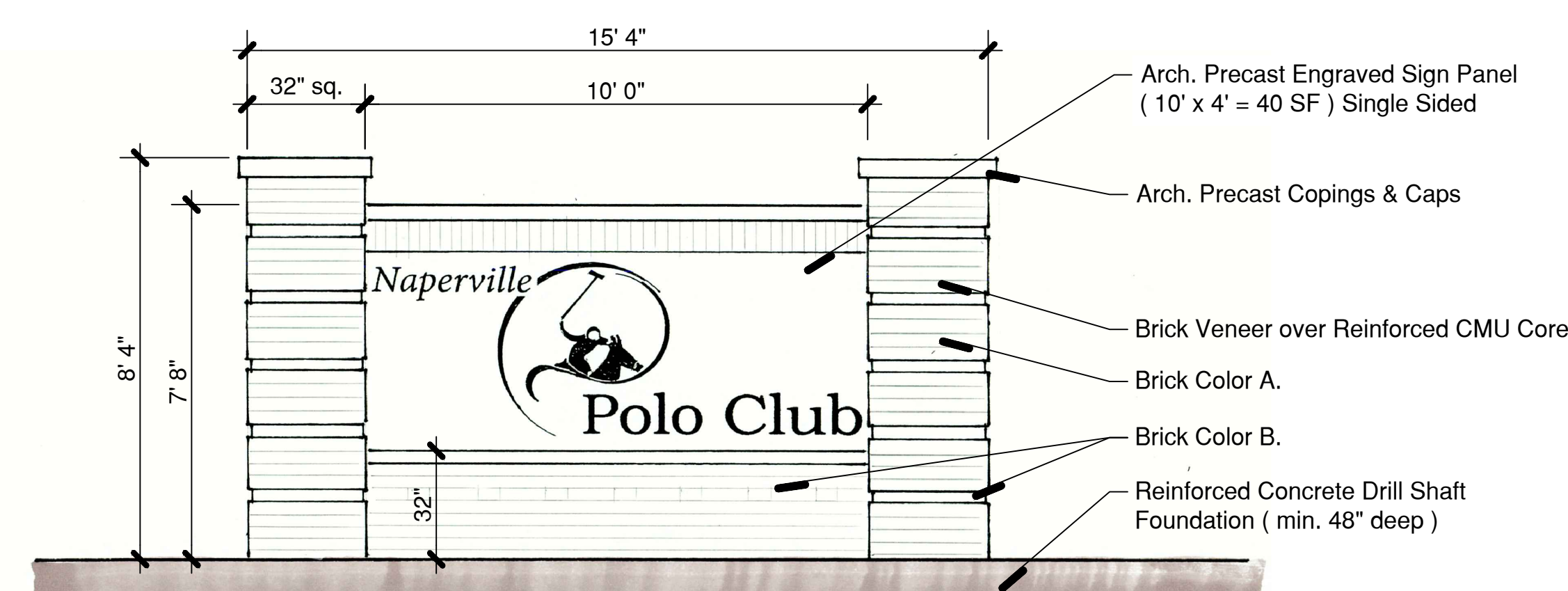

D Secondary Monument Sign - Book Road - Elevation
scale: 3/8" = 1'0"

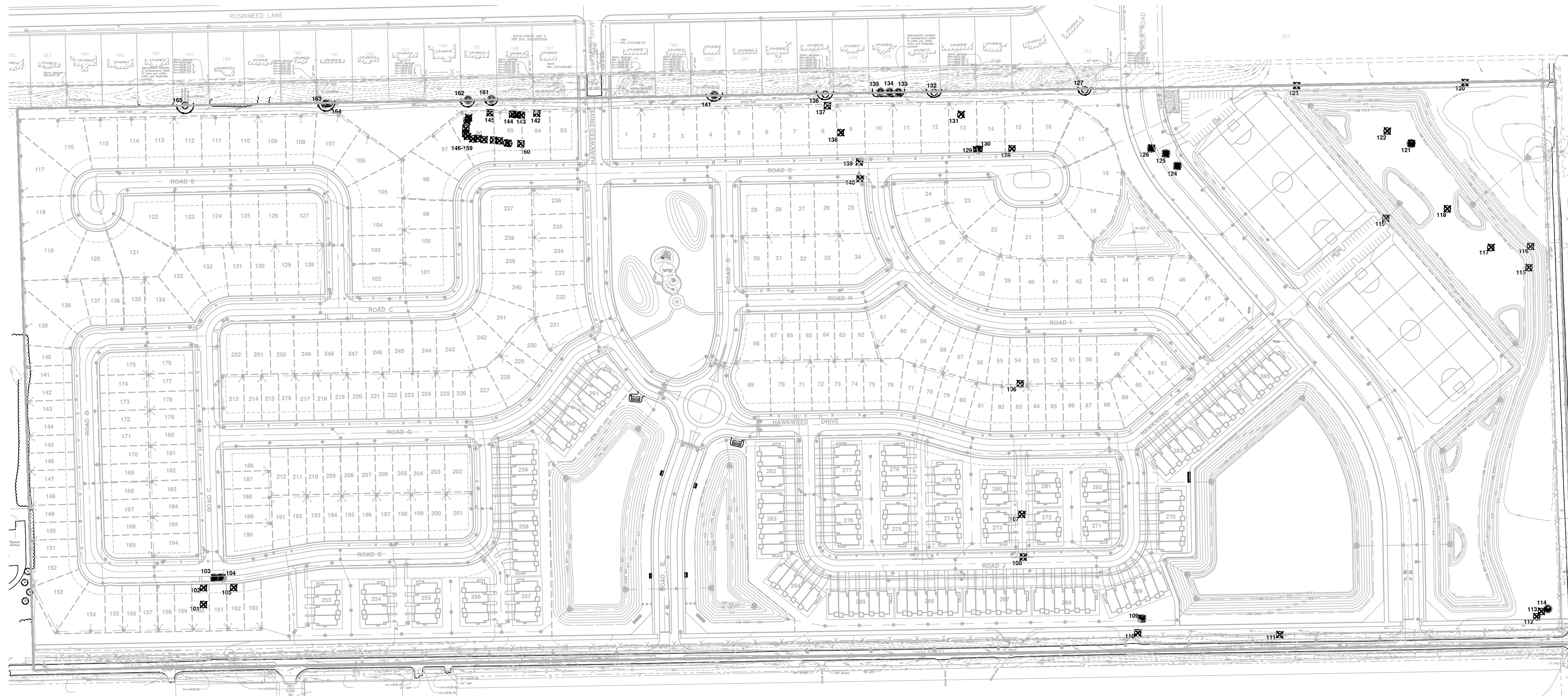

project:

Polo Club

119th St. & Book Rd.
Naperville, Illinois

sheet description:

Existing Tree Survey

owner:



north: scale: N.T.S.

	9.28.2022	Added Sitting Areas outlot A & B
	8.26.2022	Per Wolf Drive Removal dated 8.9.2022
	8.19.2022	Per City Review Comments dated 8.9.2022
	7.22.2022	Per City Review Comments dated 7.13.2022

revisions: original issue date: **6 June 2022**

drawn by:
checked by:
project no.: 22012
sheet no.:

TS.100

Tree Inventory Data : (See Above for Site Tree Survey)

Key No.	Botanic Name	Common Name	DBH	Condition	Comments	S / R
101	Gleditsia triacanthos	Honeylocust	36	Good		Remove
102	Gleditsia triacanthos	Honeylocust	32	Good		Remove
103	Pinus nigra	Austrian Pine	10	Dead		Remove
104	Pinus nigra	Austrian Pine	12	Poor		Remove
105	Gleditsia triacanthos	Honeylocust	32	Good		Remove
106	Morus alba	Mulberry	MT	Fair		Remove
107	Morus alba	Mulberry	MT	Fair		Remove
108	Morus alba	Mulberry	MT	Fair		Remove
109	Picea pungens	Colorado Spruce	10	Poor		Remove
110	Acer platanoides	Norway Maple	18	Good		Remove
111	Morus alba	Mulberry	MT	Good		Remove
112	Morus alba	Mulberry	12	Fair		Remove
113	Morus alba	Mulberry	8	Fair		Remove
114	Picea abies	Norway Spruce	18	Fair		Remove
115	Morus alba	Mulberry	4	Fair		Remove
116	Morus alba	Mulberry	MT	Fair		Remove
117	Morus alba	Mulberry	MT	Fair		Remove
118	Morus alba	Mulberry	MT	Fair		Remove
119	Morus alba	Mulberry	MT	Fair		Remove
120	Morus alba	Mulberry	MT	Fair		Remove
121	Picea abies	Norway Spruce	14	Fair		Remove
122	Morus alba	Mulberry	MT	Fair		Remove
123	Morus alba	Mulberry	MT	Good		Remove
124	Picea abies	Norway Spruce	8	Dead		Remove
125	Picea abies	Norway Spruce	10	Fair		Remove
126	Picea abies	Norway Spruce	10	Poor		Remove
127	Celtis occidentalis	Hackberry	4	Fair	in fence	SAVE
128	Morus alba	Mulberry	MT	Good		Remove
129	Acer saccharinum	Silver Maple	8	Fair		Remove
130	Acer saccharinum	Silver Maple	MT	Fair		Remove
131	Morus alba	Mulberry	MT	Fair		Remove
132	Acer saccharinum	Silver Maple	3x36	Good	at prop. line	SAVE
133	Picea pungens	Colorado Spruce	7	Good		SAVE
134	Picea pungens	Colorado Spruce	7	Good		SAVE
135	Picea pungens	Colorado Spruce	7	Good		SAVE
136	Acer saccharinum	Silver Maple	MT	Good		SAVE
137	Morus alba	Mulberry	MT	Fair		Remove
138	Morus alba	Mulberry	5	Fair		Remove
139	Morus alba	Mulberry	MT	Fair		Remove
140	Pinus nigra	Austrian Pine	MT	Good		Remove
141	Morus alba	Mulberry	10	Fair		SAVE
142	Morus alba	Mulberry	MT	Fair		Remove
143	Populus deltoides	Cottonwood	MT	Fair		Remove
144	Populus deltoides	Cottonwood	10	Fair		Remove
145	Populus deltoides	Cottonwood	MT	Fair		Remove
146	Populus deltoides	Cottonwood	12	Fair		Remove
147	Populus deltoides	Cottonwood	24	Fair		Remove
148	Populus deltoides	Cottonwood	24	Fair		Remove
149	Populus deltoides	Cottonwood	18	Fair		Remove
150	Populus deltoides	Cottonwood	14	Fair		Remove
151	Populus deltoides	Cottonwood	28	Fair		Remove
152	Populus deltoides	Cottonwood	20	Fair		Remove
153	Populus deltoides	Cottonwood	14	Fair		Remove
154	Populus deltoides	Cottonwood	15	Fair		Remove
155	Populus deltoides	Cottonwood	MT	Fair		Remove
156	Populus deltoides	Cottonwood	10	Fair		Remove
157	Populus deltoides	Cottonwood	8	Fair		Remove
158	Populus deltoides	Cottonwood	14	Fair		Remove
159	Populus deltoides	Cottonwood	12	Fair		Remove
160	Morus alba	Mulberry	MT	Fair		Remove
161	Pinus strobus	White Pine	8	Fair		SAVE
162	Pinus strobus	White Pine	8	Fair		SAVE
163	Morus alba	Mulberry	MT	Fair		SAVE
164	Morus alba	Mulberry	MT	Fair		SAVE
165	Celtis occidentalis	Hackberry	MT	Excellent		SAVE

LEGEND :

- Existing Tree & Key No.
- Existing Tree - To Be Preserved
- Existing Tree - To Be Removed
- Tree Preservation Fencing

Tree Survey Date :
Existing tree inventory and rating completed by Signature Design Group on 18 July 2022. Location Survey and Tree Sizing Plan prepared by CEMCON, Ltd.

THE CONTRACTOR SHALL HAVE THE TREE LIMBS PRUNED THAT MIGHT BE DAMAGED BY EQUIPMENT OPERATIONS PRIOR TO CONSTRUCTION COMMENCING.

PROTECTIVE TREE FENCE - TYP

ONE FOOT FOR EACH ONE INCH OF TREE DIA. - 30' MAX.

EARTH SAWCUTTING OF THE TREE ROOTS TO BE PERFORMED AT THE LIMITS OF THE TREE PROTECTION AREA OR AS INDICATED ON THE PLANS (2" MINIMUM DEPTH).

NOTES:

- A TREE PROTECTION AREA SHALL BE ESTABLISHED AROUND A TREE A DISTANCE OF ONE FOOT FOR EACH ONE INCH OF TREE DIAMETER, UP TO A MAXIMUM OF 30 FEET.
- PROTECTIVE TREE FENCE SHALL BE INSTALLED AT THE LIMITS OF THE TREE PROTECTION AREA. THE FENCE SHALL BE HIGH ENOUGH SO AS TO BE VISIBLE TO ALL CONSTRUCTION PERSONNEL.
- GRADE CHANGES, UTILITY TRENCHES, STORAGE OF CONSTRUCTION MATERIAL, DUMPING OF WASTE, OR OPERATION OR STORAGE OF ANY EQUIPMENT SHALL NOT BE ALLOWED WITHIN THE TREE PROTECTION AREA.
- AUGURING IS REQUIRED IF A UTILITY MUST BE INSTALLED WITHIN THE TREE PROTECTION AREA. AUGURED UTILITIES MUST BE A MINIMUM OF 24 INCHES BELOW GRADE.
- ALL TREES TO BE SAVED WHICH HAVE BEEN SUBJECTED TO CONSTRUCTION ACTIVITY WITHIN THE TREE PROTECTION AREA SHOULD BE SELECTIVELY THINNED 10% BY AN ARBORIST SKILLED AT THE SELECTIVE THINNING PROCEDURE. NONE OF THE TREES SHALL BE TOPPED, HEADED BACK, SKINNED (REMOVAL OF THE INTERIOR BRANCHES), OR CLIMBED WITH SPIKES. ALL DEAD WOOD SHOULD BE REMOVED TO AVOID HAZARD.
- IT IS RECOMMENDED THAT FOLLOWING CONSTRUCTION, TREES BE MAINTAINED IN THEIR NATIVE CONDITION. NO LAWN SHOULD BE PLACED AROUND THE TREES. IT IS RECOMMENDED THAT THE AREA BE MULCHED WITH 2 INCHES OF DECOMPOSED LEAVES AND 2 INCHES OF WOOD CHIPS OR BARK.

City of Naperville
STANDARD DETAIL
LANDSCAPE 10
TREE PROTECTION
REVISED: 08/01/2018 SHEET 1 OF 1
790.10