

Drawing name: K:\GIS_LDE\168865042_Casey's_6531_Naperville_IL\2 Design\CAD\PlanSheets\10 LANDSCAPE PLAN.dwg C-100A TREE PRESERVATION PLAN Apr 14, 2025 3:00pm by: Ian.Science
This document, together with the concepts and designs presented herein, is intended only for the specific purpose and client for which it was prepared. Reuse of and improper reliance on this document without written authorization and adaptation by Kimley-Horn and Associates, Inc. shall be without liability to Kimley-Horn and Associates, Inc.

WASHINGTON STREET

US/34 (OGDEN AVENUE)

ACER NEGUNDO,
MULTISTEM, TO BE
REMOVED

PINUS NIGRA, 22",
FAIR CONDITION

ACER PLATANOIDES,
15", GOOD CONDITION

PINUS NIGRA, 14",
FAIR CONDITION

MORUS ALBA, 7",
FAIR CONDITION

CORNUS SSP., 19", POOR
CONDITION, MULTISTEM

ACER PLATANOIDES,
22", GOOD CONDITION

CORNUS SSP., 26", POOR
CONDITION, MULTISTEM

DEAD, TO BE REMOVED

ACER PLATANOIDES,
15", GOOD CONDITION

MORUS ALBA, 8",
FAIR CONDITION

MORUS ALBA, 5",
FAIR CONDITION

ACER PLATANOIDES,
18", GOOD CONDITION

MORUS ALBA, 6",
FAIR CONDITION

PINUS NIGRA, 22",
FAIR CONDITION



City of Naperville
**STANDARD
DETAIL**

TREE PROTECTION

REVISED: 08/01/2018

SHEET 1 OF 1

LANDSCAPE 10

790.10

TREE PROTECTION AREA

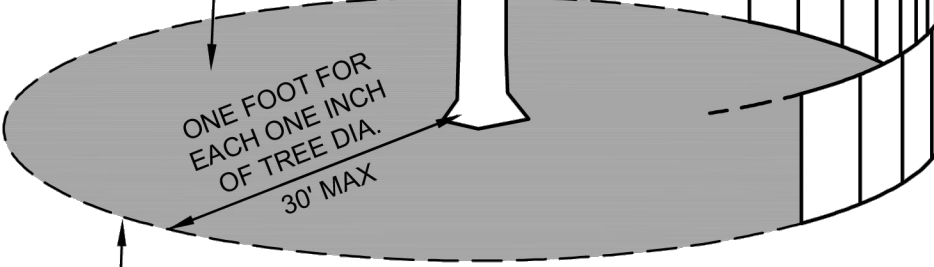

EARTH SAWCUTTING OF THE TREE ROOTS TO BE PERFORMED
AT THE LIMITS OF THE TREE PROTECTION AREA OR AS
INDICATED ON THE PLANS (24" MINIMUM DEPTH).

THE CONTRACTOR SHALL HAVE THE TREE
LIMBS PRUNED THAT MIGHT BE DAMAGED BY
EQUIPMENT OPERATIONS PRIOR TO
CONSTRUCTION COMMENCING.

NOTES:

1. A **TREE PROTECTION AREA** SHALL BE ESTABLISHED AROUND A TREE A DISTANCE OF ONE FOOT FOR EACH ONE INCH OF TREE DIAMETER, UP TO A MAXIMUM OF 30 FEET.
2. PROTECTIVE TREE FENCE SHALL BE INSTALLED AT THE LIMITS OF THE TREE PROTECTION AREA. THE FENCE SHALL BE HIGH ENOUGH SO AS TO BE VISIBLE TO ALL CONSTRUCTION PERSONNEL.
3. GRADE CHANGES, UTILITY TRENCHES, STORAGE OF CONSTRUCTION MATERIAL, DUMPING OF WASTE, OR OPERATION OR STORAGE OF ANY EQUIPMENT SHALL NOT BE ALLOWED WITHIN THE TREE PROTECTION AREA.
4. AUGURING IS REQUIRED IF A UTILITY MUST BE INSTALLED WITHIN THE TREE PROTECTION AREA. AUGURED UTILITIES MUST BE A MINIMUM OF 24 INCHES BELOW GRADE.
5. ALL TREES TO BE SAVED WHICH HAVE BEEN SUBJECTED TO CONSTRUCTION ACTIVITY WITHIN THE TREE PROTECTION AREA SHOULD BE SELECTIVELY THINNED 10% BY AN ARBORIST SKILLED AT THE SELECTIVE THINNING PROCEDURE. NONE OF THE TREES SHALL BE TOPPED, HEADED BACK, SKINNED (REMOVAL OF THE INTERIOR BRANCHES), OR CLIMBED WITH SPIKES. ALL DEAD WOOD SHOULD BE REMOVED TO AVOID HAZARD.
6. IT IS RECOMMENDED THAT FOLLOWING CONSTRUCTION, TREES BE MAINTAINED IN THEIR NATIVE CONDITION. NO LAWN SHOULD BE PLACED AROUND THE TREES. IT IS RECOMMENDED THAT THE AREA BE MULCHED WITH 2 INCHES OF DECOMPOSED LEAVES AND 2 INCHES OF WOOD CHIPS OR BARK.



TREE
PRESERVATION
PLAN

CASEY'S
NAPERVILLE #6531

20 E. OGDEN AVE
NAPERVILLE, IL 60563

ORIGINAL ISSUE:
10/01/2024

KHA PROJECT NO.
168865042

SHEET NUMBER

C-100A

Kimley»Horn

© 2024 KIMLEY-HORN AND ASSOCIATES, INC.
570 LAKE COOK ROAD, SUITE 200
NAPERVILLE, IL 60563
PHONE: 847-260-7804
WWW.KIMLEY-HORN.COM

SCALE:
AS NOTED

DESIGNED BY: JTA

DRAWN BY: TVC

CHECKED BY: INS

REVISED PER CITY

REVISED PER IDOT & CITY

REVISED PER CITY

REVISIONS

DATE

BY

04/10/25

03/07/25

11/26/24

INS

INS

INS

Drawing name: K:\GIS_LDE\16886042_Casey's_6531_Naperville_IL\2 Design\CAD\PlanSheets\1.0 LANDSCAPE PLAN.dwg C-701 LANDSCAPE PLAN Apr 14, 2025 3:23pm by: Jon Spence
This document, together with the concepts and designs presented herein, is intended only for the specific purpose and client for which it was prepared. Reuse of and improper reliance on this document without written authorization and adaptation by Kimley-Horn and Associates, Inc. shall be without liability to Kimley-Horn and Associates, Inc.

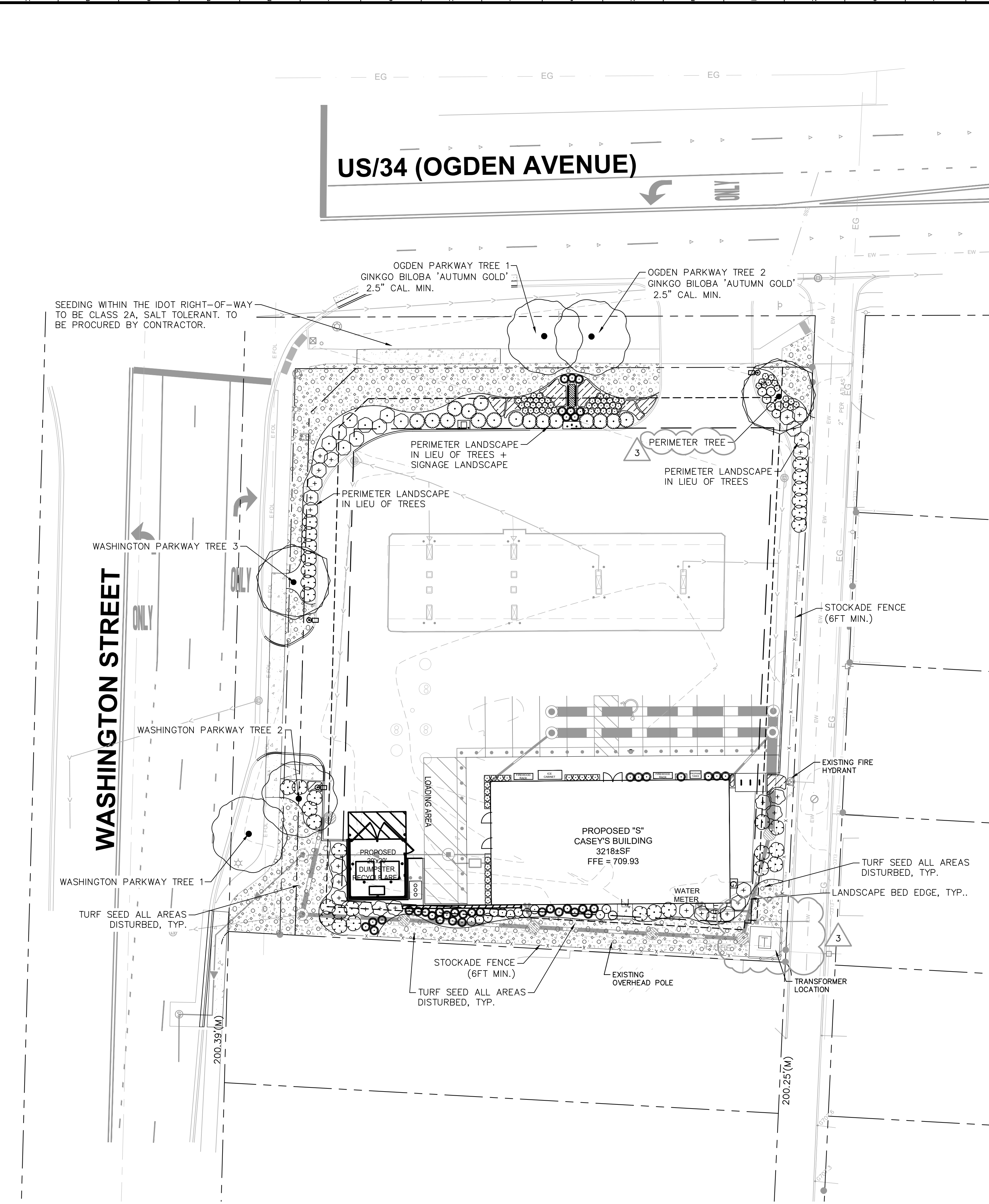

NOTE: ALL LANDSCAPE BEDS TO BE MULCHED WITH 1/2" DIAMETER DECORATIVE CA-11 ROUNDED RIVER ROCK. SEE STONE MULCH DETAILS ON SHEET C-702.

NAPERVILLE, IL LANDSCAPE CODE REQUIREMENTS		
ZONING ORDINANCE	REQUIRED	PROPOSED
SECTION 5-10-3-3 - PARKWAY LANDSCAPING		
PARKWAY TREES SHALL BE EVENLY SPACED AT NOT MORE THAN 40 FEET APART AND NOT LESS THAN FOUR FEET FROM THE ESTABLISHED SIDEWALK LINE OF SAID STREET, EXCLUSIVE OF WIDTHS OF CURB CUTS, AND THE 30-FOOT LINE OF SITE TRIANGLE AT THE INTERSECTION OF TWO STREETS	3 PARKWAY TREES REQUIRED ALONG WASHINGTON STREET 2 PARKWAY TREES REQUIRED ALONG OGDEN AVENUE	3 TREES PROVIDED ALONG WASHINGTON STREET 2 TREES PROVIDED ALONG OGDEN AVE
SECTION 5-10-3-4.1-2 PERIMETER TREE REQUIREMENTS		
SHADE TREES AND/OR EVERGREEN TREES SHALL BE SPACED AT THE EQUIVALENT OF NOT MORE THAN 70 FEET APART ALONG ALL PROPERTY LINES, EXCLUSIVE TO ACCESS DRIVES PERPENDICULAR TO LOT LINES.	164 LINEAR FT. / 70 FT = 3 TREES REQUIRED ALONG THE WEST (WASHINGTON STREET) 127 LINEAR FT. / 70 FT = 2 TREES REQUIRED ALONG THE NORTH (OGDEN AVENUE) 184 LINEAR FT. / 70 FT = 3 TREES REQUIRED ALONG THE SOUTH 196 LINEAR FT. / 70 FT = 3 TREES REQUIRED ALONG THE EAST (WASHINGTON ALLEY)	1 TREE PROVIDED ALONG OGDEN AVENUE AND SHRUBS PROVIDED ELSEWHERE IN LIEU OF TREES
SECTION 5-10-3-4.3 NON RESIDENTIAL ADJACENT TO RESIDENTIAL ZONES		
WHEN A NONRESIDENTIAL PROPERTY IS ADJACENT TO A SIDE YARD OF A RESIDENTIAL PROPERTY, A CONTINUOUS LANDSCAPE BUFFER WILL BE PROVIDED AS FOLLOWS IN ACCORDANCE WITH EXHIBIT L. THE BUFFER SHALL BE MAINTAINED TO A MINIMUM HEIGHT OF 3 FEET WHEN ADJACENT TO THE SIDE YARD OF THE NONRESIDENTIAL PROPERTY.	A CONTINUOUS LANDSCAPE BUFFER MAINTAINED AT A MINIMUM HEIGHT OF 3 FEET REQUIRED ALONG THE SOUTH SIDE OF PROPERTY	6FT MIN STOCKADE FENCE PROVIDED ALONG SOUTH SIDE PROPERTY LINE
SECTION 5-10-3-5.2.3.1 PERIMETER PARKING LOT LANDSCAPING - ACROSS FROM RESIDENTIAL		
CONTINUOUS LANDSCAPING SHALL BE PROVIDED ACROSS 100% OF THE PARKING LOT, EXCLUSIVE OF DRIVEWAYS TO A MINIMUM HEIGHT OF 30 INCHES. SUCH LANDSCAPING SHALL CONSIST OF EVERGREEN AND DECIDUOUS SHRUBBERY AND/OR HEDGES.	CONTINUOUS LANDSCAPING ACROSS 100% OF THE PARKING LOT REQUIRED ALONG THE EAST (WASHINGTON ALLEY)	6FT MIN STOCKADE FENCE PROVIDED ALONG PROPERTY LINE IN ADDITION TO 30" HT MIN SHRUBS, 4 FT O.C. SPACING
SECTION 5-10-3-5.2.3.2 PERIMETER PARKING LOT LANDSCAPING - ACROSS FROM NON-RESIDENTIAL		
CONTINUOUS LANDSCAPING SHALL BE PROVIDED ACROSS 50% OF THE PARKING LOT, EXCLUSIVE OF DRIVEWAYS TO A MINIMUM HEIGHT OF 30 INCHES. SUCH LANDSCAPING SHALL CONSIST OF EVERGREEN AND DECIDUOUS SHRUBBERY AND/OR HEDGES.	CONTINUOUS LANDSCAPING ACROSS 50% OF THE PARKING LOT REQUIRED ALONG WASHINGTON STREET AND OGDEN AVENUE	30" HT MIN SHRUBS, 4 FT O.C SPACING PROVIDED ALONG WASHINGTON STREET AND OGDEN AVENUE PROPERTY LINES
SECTION 5-10-4-2.1-1 FOUNDATION LANDSCAPING		
FOUNDATION PLANTINGS SHALL BE LOCATED ADJACENT TO ALL SIDES OF BUILDINGS WHICH FACE A PUBLIC RIGHT-OF-WAY OR INTERNAL STREET ACCESS DRIVE, OTHER THAN SINGLE-FAMILY ATTACHED AND DETACHED DEVELOPMENTS AND PROPERTIES ZONED B4 OR B5, IN A PLANTING BED A MINIMUM OF 2 FEET IN WIDTH. FOUNDATION PLANTINGS SHALL CONSIST OF A MINIMUM RATIO OF ONE PLANT FOR EVERY 3 LINEAR FEET OF BUILDING LENGTH. ALL PLANTING AREAS WHICH ARE NOT OCCUPIED BY TREES, SHRUBS, FLOWERS, GROUND COVER, ORNAMENTAL GRASSES OR MULCH SHALL BE SOODED OR CONTAIN DECORATIVE LANDSCAPE STONE APPROVED BY THE ZONING ADMINISTRATOR.	119.8 LF FOUNDATION 119.8 LF / 3 LF = 40 40 X (1) PLANT = 40 PLANTS 40 PLANTS REQUIRED ALONG FOUNDATION	27 PLANTS PROVIDED ALONG FOUNDATION ON THE NORTH AND WEST (ALL NOT PROVIDED DUE TO SPACE CONSTRAINTS) 45 PLANTS PROVIDED ALONG FOUNDATION ON THE SOUTH AND EAST
SECTION 6-16-7-3 - GROUND SIGN LANDSCAPE REQUIREMENT		
THE LANDSCAPE REQUIRMENT IS DETERMINED BY CALCULATING THE AREA OF THE LANDSCAPED AREA AROUND THE BASE OF THE GROUND SIGN. THE SIGN AREA IS DETERMINED BY CALCULATION THE MEASUREMENT OF THE OUTER DIMENSIONS OF SIGN.	DIMENSIONS OF DOUBLE-SIDED SIGN: 5' 7" X 7' = 39 SQ.FT. 39 SQ.FT X 2 = 78 SQ.FT. OF REQUIRED LANDSCAPE AREA	78 SQ.FT. OF LANDSCAPE AREA PROVIDED

PLANT SCHEDULE

<u>SYMBOL</u>	<u>CODE</u>	<u>QTY</u>	<u>REMARKS</u>	<u>BOTANICAL / COMMON NAME</u>	<u>CONT</u>	<u>CAL</u>	<u>SIZE</u>
TREES							
	GA	4	50'-80' HT.	GINKGO BILOBA 'AUTUMN GOLD' / AUTUMN GOLD MAIDENHAIR TREE	B & B	2.5" CAL. MIN.	
	QB	2	50'-60' HT.	QUERCUS BICOLOR / SWAMP WHITE OAK	B & B	2.5" CAL. MIN.	
<u>SYMBOL</u>	<u>CODE</u>	<u>QTY</u>	<u>REMARKS</u>	<u>BOTANICAL / COMMON NAME</u>	<u>CONT</u>	<u>SPACING</u>	<u>SIZE</u>
SHRUBS							
	DD	73	1'-2' HT.	DEUTZIA X 'NCDX2' / YUKI CHERRY BLOSSOM® DEUTZIA	3 GAL.	SEE PLAN	12" HT. MIN.
	VR	9	3'-4' HT.	DIERVILLA RIVULARIS 'SMNDRSF' / KODIAK® BLACK HONEYSUCKLE	5 GAL.	SEE PLAN	30" HT. MIN.
	HJ	16	3'-5' HT.	HYDRANGEA PANICULATA 'JANE' / LITTLE LIME® PANICLE HYDRANGEA	5 GAL.	SEE PLAN	30" HT. MIN.
	JF	9	10'-15' HT.	JUNIPERUS CHINENSIS 'FAIRVIEW' / FAIRVIEW JUNIPER	B & B	SEE PLAN	6" HT. MIN.
	JF2	17	4'-6' HT.	JUNIPERUS CHINENSIS 'SEA GREEN' / SEA GREEN JUNIPER	5 GAL.	SEE PLAN	30" HT. MIN.
	PW	18	2'-3' HT.	POTENTILLA FRUTICOSA 'WHITE LADY' / HAPPY FACE® WHITE BUSH CINQUEFOIL	3 GAL.	SEE PLAN	18" HT. MIN.
	VM	34	3'-5' HT.	VIBURNUM DENTATUM 'BLUE MUFFIN' / BLUE MUFFIN ARROWWOOD VIBURNUM	5 GAL.	SEE PLAN	36" HT. MIN.
ORNAMENTAL GRASSES							
	CK	40	3'-5' HT.	CALAMAGROSTIS X ACUTIFLORA 'KARL FOERSTER' / KARL FOERSTER FEATHER REED GRASS	1 GAL.		
PERENNIALS							
	HC	107	24"-36" HT.	HEMEROCALLIS X 'CHERRY CHEEKS' / CHERRY CHEEKS DAYLILY	1 GAL.	SEE PLAN	
<u>SYMBOL</u>			<u>REMARKS</u>	<u>BOTANICAL / COMMON NAME</u>			
GROUND COVERS							
				TURF SEED			

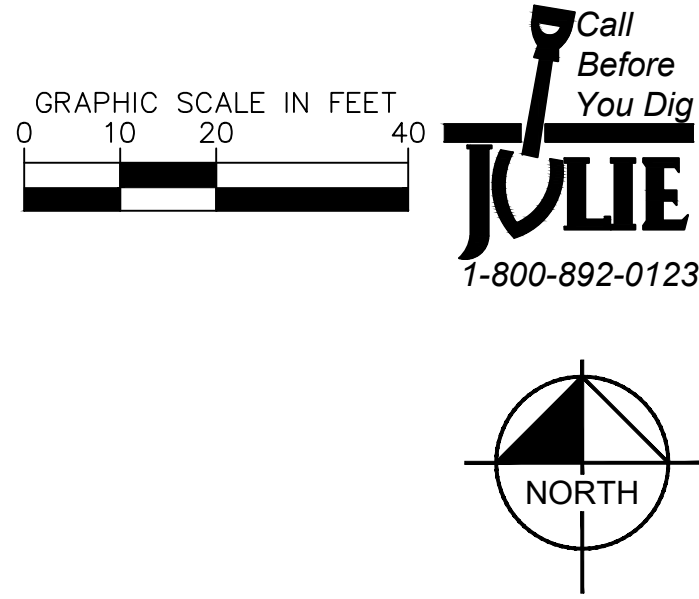

Call Before You Dig
JULIE
1-800-892-0123

SCALE:
AS NOTED
DESIGNED BY: JTA
DRAWN BY: TVC
CHECKED BY: INS

Kimley»Horn

© 2024 KIMLEY-HORN AND ASSOCIATES, INC.
570 LAKE COOK ROAD, SUITE 200
NAPERVILLE, IL 60563
PHONE: 630-260-7804
WWW.KIMLEY-HORN.COM

CASEY'S
NAPERVILLE #6531
20 E. OGDEN AVE
NAPERVILLE, IL 60563

LANDSCAPE PLAN

ORIGINAL ISSUE:
10/01/2024
KHA PROJECT NO.
168865042
SHEET NUMBER
C-701

REVISIONS

DATE	BY	REVISIONS
04/10/25	JTA	
03/07/25	INS	
11/26/24	INS	

