

LANDSCAPE PLAN FOR BEST BUY CARPET AND GRANITE NAPERVILLE, ILLINOIS

I, CRAIG A HERNAN, ILLINOIS REGISTERED LANDSCAPE ARCHITECT NO. 157-000419 DO HEREBY CERTIFY THE THE PLAN SHOWN HEREON IS A CORRECT REPRESENTATION OF LANDSCAPE IMPROVEMENTS TO THE NOTED PROPERTY.

CRAIG A HERNAN
IRLA #157-000419
WESTWOOD LANDSCAPE
WEST CHICAGO, IL

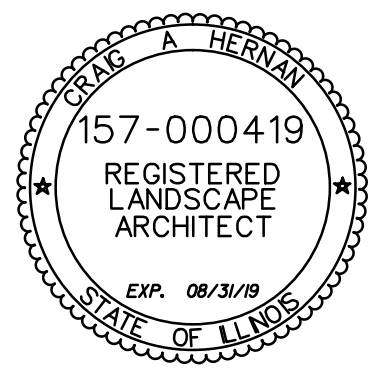

OF PART OF THE NORTHWEST QUARTER OF SECTION 34, TOWNSHIP 38 NORTH, RANGE 9 EAST OF THE THIRD PRINCIPAL MERIDIAN, DUPAGE COUNTY, ILLINOIS

PIN: 07-34-100-027
07-34-100-028
07-34-100-029

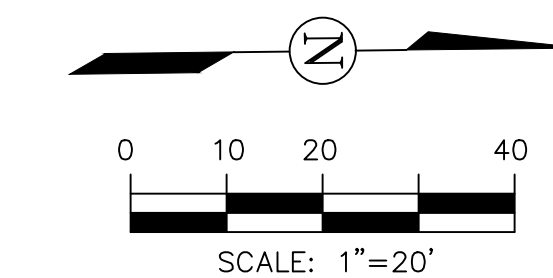

BASIS OF BEARINGS:
ILLINOIS STATE PLANE - EAST ZONE

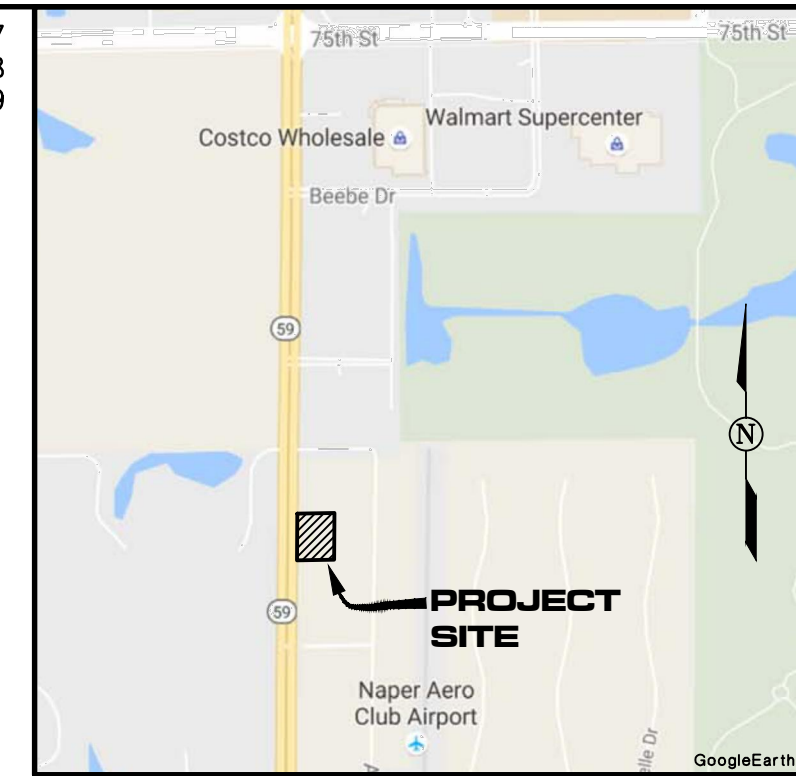

LOCATION MAP
N.T.S.

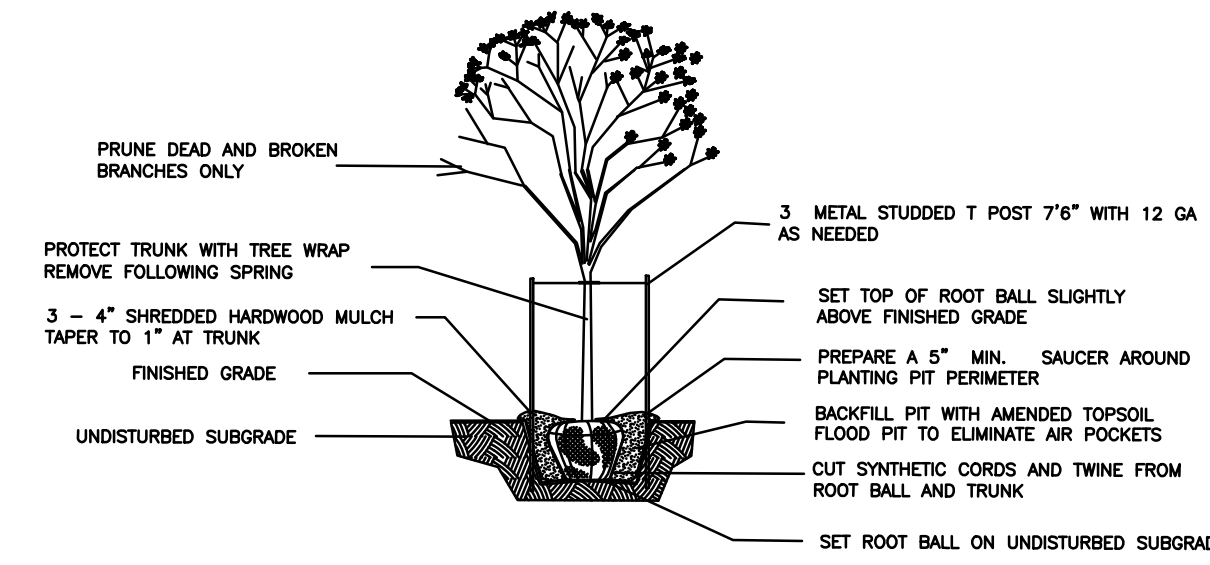

TREE PLANTING DETAIL

NOT TO SCALE USE ONLY NORTHERN ILLINOIS GROWN NURSERY STOCK

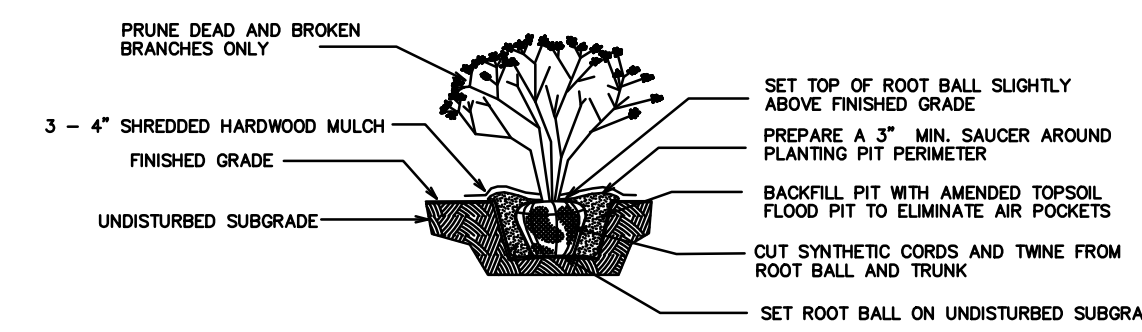

SHRUB PLANTING DETAIL

1. TREES SHALL BE INSTALLED A MINIMUM OF FIVE (5) FEET HORIZONTALLY FROM UNDERGROUND ELECTRICAL FEEDERS, SANITARY SEWERS, SANITARY SERVICES, WATER MAINS, AND WATER SERVICES. TREES SHALL BE INSTALLED A MINIMUM OF TEN (10) FEET HORIZONTALLY FROM UTILITY STRUCTURES AND APPURTENANCES, INCLUDING BUT NOT LIMITED TO MANHOLES, VALVE VAULTS, VALVE BOXES AND FIRE HYDRANTS. NO TREES, SHRUBS OR OBSTACLES WILL BE ALLOWED 10 FEET IN FRONT OF, 5 FEET ON THE SIDES AND 7 FEET TO THE REAR OF ELECTRICAL TRANSFORMER.

GENERAL NOTES

- ALL PLANT MATERIAL SHALL BE NORTHERN ILLINOIS NURSERY GROWN TO ASSURE CLIMATIC AND SOIL SIMILARITY. ALL MATERIAL SHALL BE BALLED AND BURLAP PER AMERICAN STANDARD FOR NURSERY STOCK BY THE AMERICAN ASSOCIATION OF NURSERYMEN, INC. PERENNIAL AND GROUND COVER SHALL BE CONTAINER GROWN.
- ALL BEDS SHALL RECEIVE 3-4" OF FINELY SHREDDED HARDWOOD MULCH. GROUND COVER BEDS SHALL BE TREATED WITH TRIFLOR PRE-EMERGENT HERBICIDE, ALL OTHER BEDS SHALL RECEIVE RONSTAR 5g OR SIMILAR PRE-EMERGENT HERBICIDE FOR WEED CONTROL. ALL TREES SHALL RECEIVE 6" OF FINELY SHREDDED HARDWOOD MULCH. ALL LANDSCAPE SPOILS SHALL BE REMOVED FROM THE SITE BY THE CONTRACTOR.
- OWNER SHALL PROVIDE SUFFICIENT WATER FOR THE CONTRACTOR TO MAINTAIN THE PLANT MATERIAL, SEED AND SOD AREAS. CONTRACTOR SHALL WATER SOD UNTIL THE TURF HAS BECOME ADEQUATELY ESTABLISHED. CONTRACTOR SHALL WARRANT ALL MATERIAL AND LABOR FOR A PERIOD OF ONE YEAR FROM ACCEPTANCE OF ALL WORK. OWNER TO PROVIDE ALL SUPPLEMENTAL WATERING AND PROPER CARE AND MAINTENANCE OF ALL MATERIAL AFTER CONTRACTOR'S INITIAL CARE.
- QUANTITY LISTS ARE SUPPLIED AS A CONVENIENCE. THE CONTRACTOR SHALL VERIFY ALL QUANTITIES ON-SITE. THE CONTRACTOR SHALL VERIFY LOCATION OF ALL UNDERGROUND UTILITIES PRIOR TO DIGGING.
- PLANTING BEDS SHALL BE ELEVATED SLIGHTLY TO INSURE PROPER DRAINAGE. ALL ROOT BALLS OF TREES SHALL BE ELEVATED ABOVE FINISHED GRADE. ALL GRADING SHALL PROVIDE SLOPES WHICH ARE SMOOTH, CONTINUOUS AND HAVE POSITIVE DRAINAGE IN ALL AREAS.
- CONTRACTOR SHALL BE RESPONSIBLE FOR PROVIDING TEMPORARY EROSION CONTROL FOR SOIL AREAS DUE TO SLOPE CONDITIONS. CONTRACTOR SHALL MAINTAIN ALL EROSION CONTROL STRUCTURES, FENCES, DITCH CHECKS, AND INLET PROTECTORS UNTIL ADEQUATE VEGETATION HAS BEEN ESTABLISHED.
- EXCAVATED MATERIALS IN EXCESS OR THOSE NOT REQUIRED OR UNSUITABLE FOR RE-USE SHALL BE DISPOSED OF OFF SITE AT CONTRACTORS EXPENSE. CONTRACTOR SHALL REMOVE ALL DEBRIS DAILY AND MAINTAIN THE SITE IN A NEAT AND SAFE CONDITION.
- SOIL TESTS SHALL BE MADE TO DETERMINE THE EXACT REQUIREMENTS FOR BOTH SOIL AMENDMENTS AND FERTILIZER. SOIL TESTS SHALL BE CONDUCTED BY A GOVERNMENT LABORATORY OR RECOGNIZED COMMERCIAL LABORATORY. COST OF WHICH SHALL BE BORNE BY THE CONTRACTOR. CONTRACTOR IS RESPONSIBLE FOR MATERIAL COST AND APPLICATION OF TESTING LABORATORY'S RECOMMENDATIONS.
- LANDSCAPE CONTRACTOR SHALL PROVIDE THE OWNER WITH AN EQUIPMENT AND LABOR RATE SCHEDULE. THIS LIST SHALL INCLUDE COST OF TOPSOIL AND LANDSCAPE DEBRIS/SPOILS REMOVAL WITH SQUARE FOOT COST FOR TURF RESTORATION (SOD AND SEED). LANDSCAPE CONTRACTOR SHALL RESTORE ALL TURF AREAS DAMAGED DUE TO CONSTRUCTION ON AND OFF SITE AT THE AGREED RATES TO RESTORE THE EXISTING CONDITIONS.
- LANDSCAPE CONTRACTOR SHALL FOLLOW ALL LOCAL AND MUNICIPAL CODES AND REQUIREMENTS. CONTRACTOR SHALL SECURE ALL REQUIRED PERMITS AS NECESSARY TO COMPLETE THE SCOPE OF THE JOB.

GENERAL SEED SPECIFICATIONS

TURF GRASS SEED RATE
250 LBS/ACRE

GREENSKEEPER PRIDE MIXTURE
20% FREEDOM III KENTUCKY BLUEGRASS
20% BLUE CHIP KENTUCKY BLUEGRASS
20% CHICAGO II KENTUCKY BLUEGRASS
20% CREEPING RED FESCUE
20% ACCENT PERENNIAL RYEGRASS

LINKS MIX NATIONAL LINKS MIX AVAILABLE FROM NATIONAL SEED
4720 YENDER AVE., LISLE, IL
630-963-8787

TURF FERTILIZATION
6-24-24 STARTER FERTILIZER
RATE: 250 LBS/ACRE

TREE, SHRUB AND PLANT BED FERTILIZER LESCO 14-14-14
PLY PLUS SULFUR COATED LANDSCAPE AND ORNAMENTAL ALL PURPOSE FERTILIZER RATE: 5 POUNDS PER 1000 S.F. PLANT BEDS ONE POUND PER CALIPER INCH FOR TREES

PLANT LIST

KEY	NAME	BOTANICAL/COMMON	SIZE	QUANTITY
AM	ACER MIYABEI 'MORTON'	STATE STREET MIYABE MAPLE	2.5"	6
CO	CELTIS OCCIDENTALIS	COMMON HACKBERRY	2.5"	2
GD	GYMNOCLADUS DIOICUS	KENTUCKY COFFEETREE	2.5"	3
QB	QUERCUS X BICOLOR	SWAMP WHITE OAK	2.5"	6
TTS	TILIA TOMENTOSA 'STERLING'	STERLING SILVER LINDEN	2.5"	6
UM	ULMUS X MORTON	ACCOLADE ELM	2.5"	2
SR	SYRINGA RETICULATA	JAPANESE TREE LILAC	2.5"	1
PO	PICEA OMORICA RIVERSIDE	RIVERSIDE SEBIAN SPRUCE	6"	14
TO	THUJA OCCIDENTALIS TECHNY	TECHNY ARBORVITAE	5"	5
TT	TAXUS X MEDIA TAUNTONII	TAUNTON YEW	30"	9
JCKC	JUNIPERUS CHINENSIS 'KALLAY'S COMPACT'	KALLAY'S COMPACT JUNIPER	5 GAL	14
JCPB	JUNIPERUS CONFERTA 'BLUE PACIFIC'	BLUE PACIFIC SHORE JUNIPER	5 GAL	6
CAF	CORNUS STOLONIFERA	ARTIC FIRE DOGWOOD	3"	29
HQF	HYDRANGEA PANICULATA 'QUICK FIRE'	HYDRANGEA QUICK FIRE	4"	12
RA	RHUS AROMATICA 'GRO-LOW'	GRO-LOW SUMAC	3 GAL	6
IGC	ILEX GLABRA COMPACTA	COMPACT INGBERRY	18"	7
SBF	SPIREA JAPONICA 'FROEBELII'	FROEBEL SPIREA	24"	36
VD	VIORNIUM DENTATUM	ARROWWOOD VIBURNUM	4"	30
HHR	HEMEROCALLIS 'HAPPY RETURNS'	HAPPY RETURNS DAYLILY	1 GAL	150
CB	CALAMAGROSTIS BRACHYTRICHA	KOREAN FEATHER REED GRASS	2 GAL	54
SA	SESILERIA AUTUMNALIS	AUTUMN MOOR GRASS	1 GAL	25
EC	EUONYMUS COLORATUS	LITTLE LEAF WINTERCREEPER	QTS	1380

CITY PROJECT NO: 17-1000093

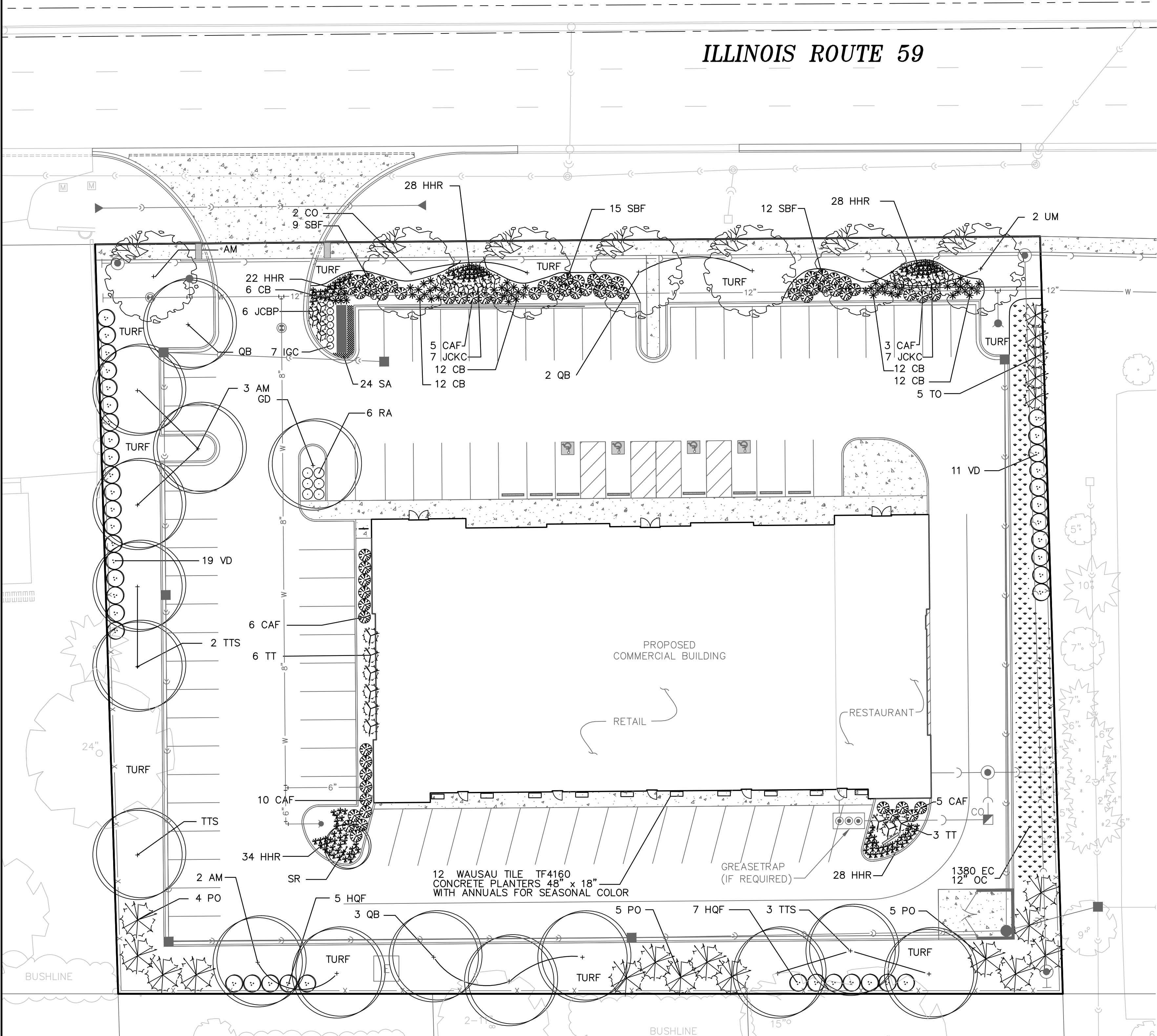

ROAKE AND ASSOCIATES, INC.
CONSULTING ENGINEERS • LAND SURVEYORS • PLANNERS
1884 QUINCY AVENUE, SUITE 100A • NAPERVILLE, ILLINOIS 60540
TEL (630) 366-3232 • FAX (630) 366-3287

PREPARED FOR:
BEST BUY CARPET AND GRANITE
585 SOUTH ROUTE 59
AURORA, ILLINOIS 60540
TEL. (630) 417-9162
TEL. (630) 686-2240

REVISIONS					
NO.	DATE	DESCRIPTION	NO.	DATE	DESCRIPTION
1	10/11/17	REV. PER CITY RVW (DATED 9/15/17)			

BEST BUY CARPET AND GRANITE

LANDSCAPE PLAN

DRN./CKD. BY: SRH/JGC FILE: 8381LS FLD. BK./PG.: 263/76-78 SHEET NO. 1 OF 1
SCALE: 1"=20' DATE: 08/21/17 JOB NO.: 838.001