



# LANDSCAPE PLANS

## 24 NORTH WASHINGTON

### NAPERVILLE, ILLINOIS

PN: 07-13-412-004  
08-18-303-009  
ADDRESS: 24 N. WASHINGTON ST.  
NAPERVILLE, IL 60540  
20-30 E. FRANKLIN ST.  
NAPERVILLE, IL 60540

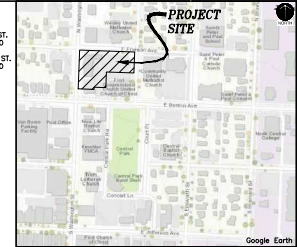

VICINITY MAP  
N.T.S.

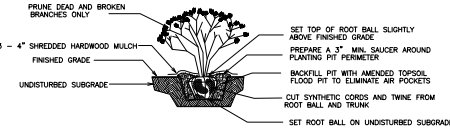
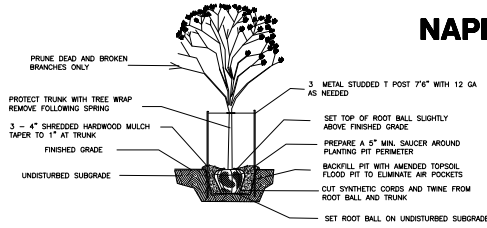

**PLANT LIST**

KEY	NAME	SIZE	QTY
CBS	CARPANUS BETULUS 'YACHTGATA'	3"	3
	PYRAMIDAL EUROPEAN HORNBAM		
TOH	THUJA OCCIDENTALIS 'HOLMSTRUP'	4"	35
	HOLMSTRUP ARBORVITAE		
DCS	DIERVILLA SESSILIFOLIA 'COOL SPLASH'	3 GAL	9
	COOL SPLASH DIERVILLA		
KGS	LEY GLABRA 'SHAMROCK'	3GAL	4
	SHAMROCK KIRGBERRY		
HPLL	HYDRANGEA PANCULATA 'LITTLE LIME'	5 GAL	3
	LITTLE LIME HYDRANGEA		

**TREE PLANTING DETAIL**

NOT TO SCALE USE ONLY NORTHERN ILLINOIS GROWN NURSERY STOCK

**SHRUB PLANTING DETAIL**

NOT TO SCALE USE ONLY NORTHERN ILLINOIS GROWN NURSERY STOCK

**GENERAL NOTES**

- ALL PLANT MATERIAL SHALL BE NORTHERN ILLINOIS NURSERY GROWN TO ASSURE CLIMATIC AND SOIL SIMILARITY. ALL MATERIAL SHALL BE BALLED AND BURLAP PER AMERICAN STANDARD FOR NURSERY STOCK BY THE AMERICAN ASSOCIATION OF NURSERYMEN, INC. PERENNIAL AND GROUND COVER SHALL BE CONTAINER GROWN.
- ALL BEDS SHALL RECEIVE 3-4" OF FINELY SHREDDED HARDWOOD MULCH. GROUND COVER BEDS SHALL BE TREATED WITH TRIFLUR PRE-EMERGENT HERBICIDE. ALL OTHER BEDS SHALL RECEIVE RONSTAR 5g OR SIMILAR PRE-EMERGENT HERBICIDE FOR WEED CONTROL. ALL TREES SHALL RECEIVE 6" OF FINELY SHREDDED HARDWOOD MULCH. ALL LANDSCAPE SPOILS SHALL BE REMOVED FROM THE SITE BY THE CONTRACTOR.
- OWNER SHALL PROVIDE SUFFICIENT WATER FOR THE CONTRACTOR TO MAINTAIN THE PLANT MATERIAL AND SEED AREAS. CONTRACTOR SHALL WATER SEED UNTIL THE TURF HAS BECOME ADEQUATELY ESTABLISHED. CONTRACTOR SHALL WARRANTEE ALL MATERIAL AND LABOR FOR A PERIOD OF ONE YEAR FROM ACCEPTANCE OF ALL WORK. OWNER TO PROVIDE ALL SUPPLEMENTAL WATERING AND PROPER CARE AND MAINTENANCE OF ALL MATERIAL AFTER CONTRACTOR'S INITIAL CARE.
- QUANTITY LISTS ARE SUPPLIED AS A CONVENIENCE. THE CONTRACTOR SHALL VERIFY ALL QUANTITIES ON-SITE. THE CONTRACTOR SHALL VERIFY LOCATION OF ALL UNDERGROUND UTILITIES PRIOR TO DIGGING.
- PLANTING BEDS SHALL BE ELEVATED SLIGHTLY TO INSURE PROPER DRAINAGE. ALL ROOT BALLS OF TREES SHALL BE ELEVATED ABOVE FINISHED GRADE. ALL GRADING SHALL PROVIDE SLOPES WHICH ARE SMOOTH, CONTINUOUS AND HAVE POSITIVE DRAINAGE IN ALL AREAS.
- CONTRACTOR SHALL BE RESPONSIBLE FOR PROVIDING TEMPORARY EROSION CONTROL FOR SOIL AREAS DUE TO SLOPE CONDITIONS. CONTRACTOR SHALL MAINTAIN ALL EROSION CONTROL STRUCTURES, FENCES, DITCH CHECKS, AND INLET PROTECTORS UNTIL ADEQUATE VEGETATION HAS BEEN ESTABLISHED.
- EXCAVATED MATERIALS IN EXCESS OR THOSE NOT REQUIRED OR UNSUITABLE FOR RE-USE SHALL BE DISPOSED OF OFF SITE AT CONTRACTOR'S EXPENSE. CONTRACTOR SHALL REMOVE ALL DEBRIS DAILY AND MAINTAIN THE SITE IN A NEAT AND SAFE CONDITION.
- SOIL TESTS SHALL BE MADE TO DETERMINE THE EXACT REQUIREMENTS FOR BOTH SOIL AMENDMENTS AND FERTILIZER. SOIL TESTS SHALL BE CONDUCTED BY A GOVERNMENT LABORATORY OR RECOGNIZED COMMERCIAL LABORATORY. COST OF WHICH SHALL BE BORNE BY THE CONTRACTOR. CONTRACTOR IS RESPONSIBLE FOR MATERIAL COST AND APPLICATION OF TESTING LABORATORY'S RECOMMENDATIONS.
- LANDSCAPE CONTRACTOR SHALL PROVIDE THE OWNER WITH AN EQUIPMENT AND LABOR RATE SCHEDULE. THIS LIST SHALL INCLUDE COST OF TOPSOIL AND LANDSCAPE DEBRIS/SPOILS REMOVAL WITH SQUARE FOOT COST FOR TURF RESTORATION. LANDSCAPE CONTRACTOR SHALL RESTORE ALL TURF AREAS DAMAGED DUE TO CONSTRUCTION ON AND OFF SITE AT THE AGREED RATES TO RESTORE THE EXISTING CONDITIONS.
- LANDSCAPE CONTRACTOR SHALL FOLLOW ALL LOCAL AND MUNICIPAL CODES AND REQUIREMENTS. CONTRACTOR SHALL SECURE ALL REQUIRED PERMITS AS NECESSARY TO COMPLETE THE SCOPE OF THE JOB.
- TREES SHALL BE INSTALLED A MINIMUM OF FIVE (5) FEET HORIZONTALLY FROM UNDERGROUND ELECTRICAL FEEDERS, SANITARY SEWERS, SANITARY SERVICES, WATER MAINS, WATER SERVICES AND STORM SEWERS. TREES SHALL BE INSTALLED A MINIMUM OF TEN (10) FEET HORIZONTALLY FROM UTILITY STRUCTURES AND APPURTENANCES, INCLUDING BUT NOT LIMITED TO MANHOLES, VALVE VAULTS, VALVE BOXES AND FIRE HYDRANTS. NO TREES, SHRUBS OR OBSTACLES WILL BE ALLOWED TO FEET IN FRONT OF, 5 FEET ON THE SIDES AND 7 FEET TO THE REAR OF ELECTRICAL TRANSFORMER.

I, CRAIG A. HERNAN, ILLINOIS REGISTERED LANDSCAPE ARCHITECT NO. 157-000419 DO HEREBY CERTIFY THE PLAN SHOWN HEREON IS A CORRECT REPRESENTATION OF LANDSCAPE IMPROVEMENTS TO THE NOTED PROPERTY.

CRAIG A. HERNAN  
IRLA #157-000419  
WESTWOOD LANDSCAPE  
ARCHITECT  
WEST CHICAGO, IL

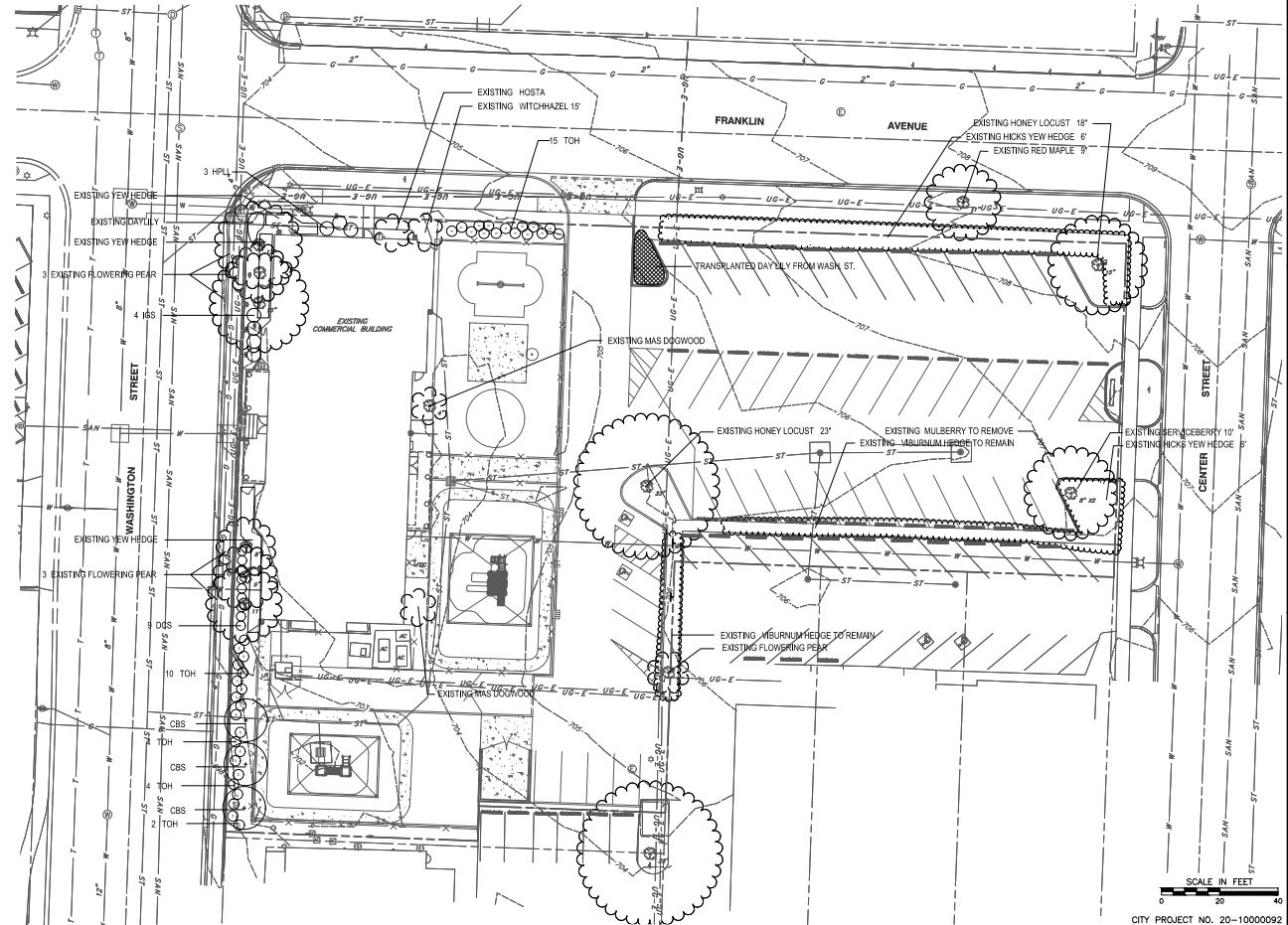

SCALE IN FEET  
0 20 40  
CITY PROJECT NO. 20-1000092

REVISION RECORD

NO.	DATE	DESCRIPTION

**CEC**  
Civill & Environmental Consultants, Inc.  
1230 East Dahl Road, Suite 200 - Naperville, IL 60563  
630-985-6626 - 677-983-6026  
www.cec.com

**HIGHER GROUND EDUCATION, INC.**  
24 NORTH WASHINGTON  
NAPERVILLE, ILLINOIS 60540

LANDSCAPE PLAN  
DRAWING NO. **LS01**  
DATE: 05/23/2020  
DWG SCALE: AS SHOWN  
PROJECT NO: 20-1000092  
APPROVED BY: [Signature]  
BRI: [Signature]  
JUC: [Signature]