

THESE PLANTINGS ARE PURPOSED FOR BUFFER-IMPACT MITIGATION. ALL PLANTINGS SHALL BE ALIVE AND APPARENT ONE YEAR-AFTER PLANTING. DEAD SHRUBS SHALL BE REPLACED. A SHORT LETTER REPORT SUMMARIZING THE PLANTINGS' CONDITION WITH PHOTO DOCUMENTATION SHALL BE PROVIDED TO DUPAGE COUNTY

REAR YARD: MIN. 85% SCREEN (65' FOOT BUILDING SETBACK WITH 15% REDUCTION)

TRASH ENCLOSURE (ENCLOSED ON THREE SIDES) (SEE ARCH PLANS)

EXISTING TREE TO REMAIN. (TYP)

PLANT SCHEDULE

CODE	BOTANICAL / COMMON NAME	CONT	SIZE	INSTALL HEIGHT	MATURE HEIGHT	QTY	REMARKS
TREES							
ACE DEB	Acer platanoides 'Deborah' / Deborah Norway Maple	B & B	2.5' Cal	12'-0"	50'-0"	4	
ACE AR6	Acer x freemanii 'Armstrong' / Armstrong Freeman Maple	B & B	2.5' Cal	12'-0"	60'-0"	7	
AME AU2	Amelanchier canadensis 'Autumn Brilliance' / Autumn Brilliance Serviceberry	B & B	2.5' Cal	10'-0"	20'-0"	3	
CAR NA6	Carpinus caroliniana 'Native Flame' / Native Flame Hornbeam	B & B	2.5' Cal	12'-0"	30'-0"	1	
PIC BUR	Picea omorika 'Brun's' / Brun's Serbian Spruce	B&B	8' H.	8'-0"	35'-0"	25	
TAX DIS	Taxodium distichum / Bald Cypress	B & B	2.5' Cal	12'-0"	60'-0"	2	
ULM PUM	Ulmus x 'Hornestead' / Elm	B & B	2.5' Cal	12'-0"	60'-0"	6	
ZEL GRE	Zelkova serrata 'Green Vase' / Green Vase Sawleaf Zelkova	B & B	2.5' Cal	12'-0"	60'-0"	6	

CODE	BOTANICAL / COMMON NAME	CONT	SPACING	INSTALL HEIGHT	MATURE HEIGHT	QTY	REMARKS
SHRUBS							
ARO LSC	Aronia melanocarpa UCONNAM165' / Low Scape Mound® Black Chokeberry	3 gal	18" H.	1'-6"	3'-0"	24	
COR ISA	Cornus sericea 'Isanti' / Isanti Red Twig Dogwood	3 gal	30" H.	2'-6"	5'-0"	14	
ILE SHA	Ilex glabra 'Shamrock' / Inkberry	3 gal	30" H.	2'-6"	4'-0"	22	
PHY N12	Physocarpus opulifolius / Ninebark	5 gal	4' H.	4'-0"	10'-0"	14	
PHY DIA	Physocarpus opulifolius 'Monlo' TM / Diabolo Purple Ninebark	5 gal	4' H.	4'-0"	10'-0"	28	
RIB GRE	Ribes alpinum 'Green Mound' / Green Mound Alpine Currant	3 gal	30" H.	2'-6"	5'-0"	13	
SPI MEA	Spiraea alba / Meadowsweet	3 gal	18" H.	1'-6"	6'-0"	13	
SYR BL2	Syringa x 'Bloomerang' / Bloomerang Series Lilac	3 gal	18" H.	1'-6"	6'-0"	13	
TAX HIC	Taxus x media 'Hicksii' / Hicks Yew	B & B	4' H.	4'-0"	12'-0"	18	
THU SMA	Thuja occidentalis 'Smaragd' / Emerald Green Arborvitae	B & B	6' H.	4'-0"	15'-0"	14	
VIB CO2	Viburnum carlesii 'Compactum' / Korean Spice Viburnum	B & B	4' H.	4'-0"	7'-0"	7	
VIB AUT	Viburnum dentatum 'Autumn Jazz' / Southern Arrowwood	3 gal	30" H.	2'-6"	8'-0"	4	

CODE	BOTANICAL / COMMON NAME	CONT	SPACING	INSTALL HEIGHT	MATURE HEIGHT	QTY	REMARKS
GROUND COVERS							
HEM RSE	Hemerocallis x 'Ruby Sentinel' / Ruby Sentinel Daylily	1 gal	18" o.c.	1'-0"	1'-0"	74	
LIR BIG	Liriope muscari 'Big Blue' / Big Blue Lilyturf	flat	12" o.c.	1'-0"	1'-0"	28	
PEN HAM	Pennisetum alopecuroides 'Hameln' / Hameln Dwarf Fountain Grass	1 gal	30" o.c.	2'-0"	4'-0"	30	
SPO HET	Sporobolus heterolepis / Prairie Dropseed	1 gal	36" o.c.	2'-0"	2'-0"	11	
SOD							
SEED	Premium Bluegrass Sod					1000 SF	
PRA1	Bluegrass, Fescue, Ryegrass Mix with Lightweight Erosion Control Blanket					5500 SF	
	No Mow Fescue Turf with Lightweight Erosion Control Blanket					3500 SF	

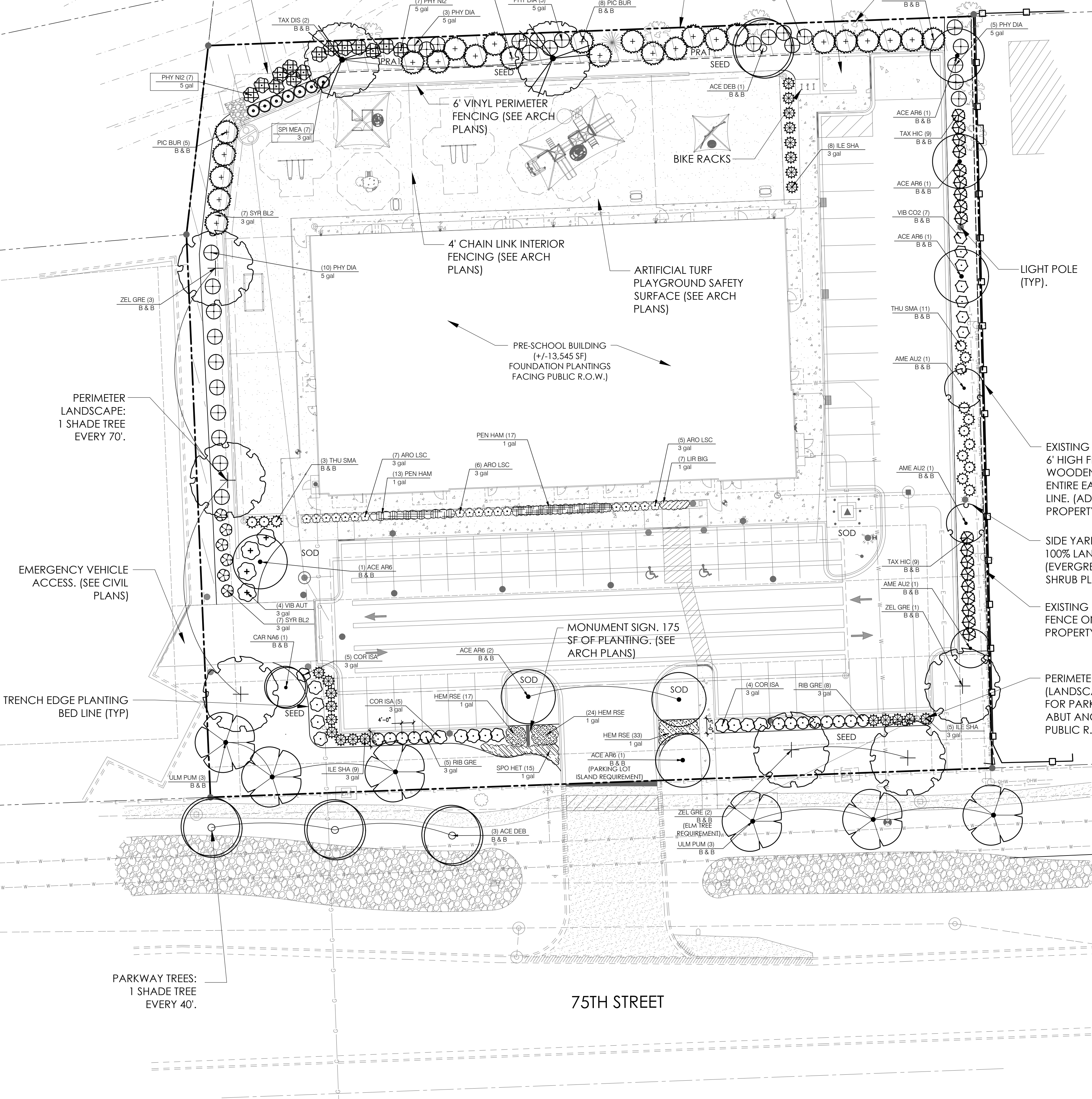

EXISTING CONTINUOUS 6' HIGH FENCE WOODEN ALONG ENTIRE EAST PROPERTY LINE. (ADJACENT TO PROPERTY) (TYP)

SIDE YARD 100% LANDSCAPE SCREEN (EVERGREEN & DECIDUOUS SHRUB PLANTINGS)

EXISTING CHAIN LINK FENCE ON SUBJECT PROPERTY TO REMAIN

PERIMETER PARKING (LANDSCAPE PROVIDED FOR PARKING LOTS THAT ADJUT ANOTHER PARCEL OR PUBLIC R.O.W.)

EXHIBIT D

LANDSCAPE NOTES:

- CLEARANCE TO TRANSFORMER PAD SHALL BE 5' FROM ALL SIDES, 10' FROM FRONT, AND THE AREA ABOVE MUST BE COMPLETELY CLEAR OF OBSTRUCTION. NO TREES, SHRUBS, OR OTHER OBSTACLES WILL BE ALLOWED WITHIN THIS AREA. PER DPUE SPECIFICATIONS C10-2130.
- ELECTRIC SERVICE CONDUCTOR REQUIRES 2' OF CLEARANCE FROM ALL PROPOSED PLANTS.



PRELIMINARY NOT FOR CONSTRUCTION



Design Perspectives Inc.
Grounded in Creativity

1167 Hobson Mill Drive
Naperville, Illinois 60540
Telephone: (630) 606-0776
www.design-perspectives.net

PRIMROSE SCHOOLS:
NAPERVILLE, IL

25W710 75TH STREET
NAPERVILLE, IL 60565

THESE DOCUMENTS CONTAIN INFORMATION PROPRIETARY TO ADA ARCHITECTS, INC. UNAUTHORIZED USE OF THESE DOCUMENTS IS EXPRESSLY PROHIBITED UNLESS AGREED UPON IN WRITING.

REVISIONS	
DATE	DESCRIPTION
07-19-2024	ZONING SUBMITTAL
11-1-2024	CITY RE-SUBMITTAL
12-16-2024	CITY RE-SUBMITTAL
1-13-2025	CITY REVISIONS
2-18-2025	CITY REVISIONS
2-24-2025	CITY REVISIONS
3-5-2025	CITY REVISIONS

LANDSCAPE PLAN

DATE: 07/19/2024
JOB NO.: 23529

LP-100
SHEET NO.

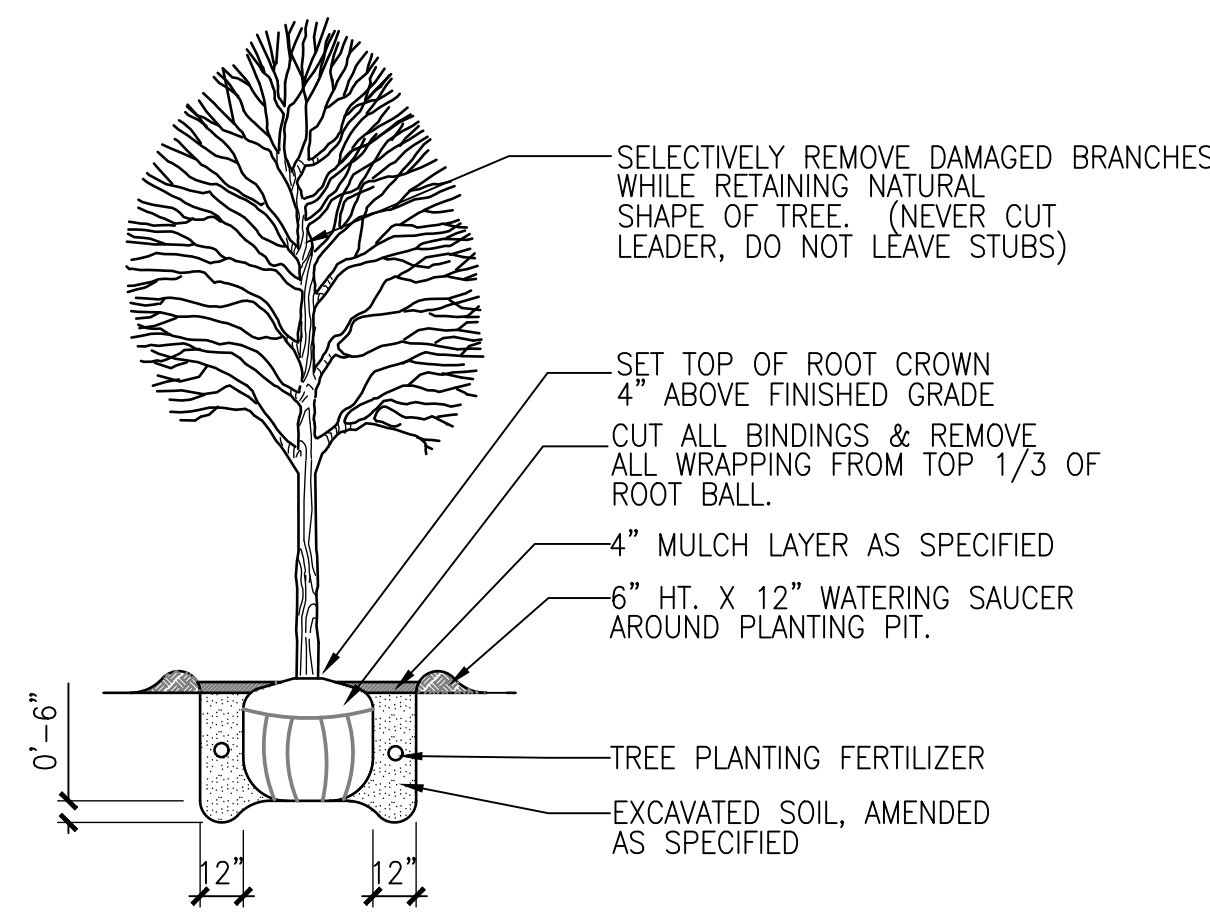

SHADE TREE PLANTING
SCALE: NTS DT--shade--gyn

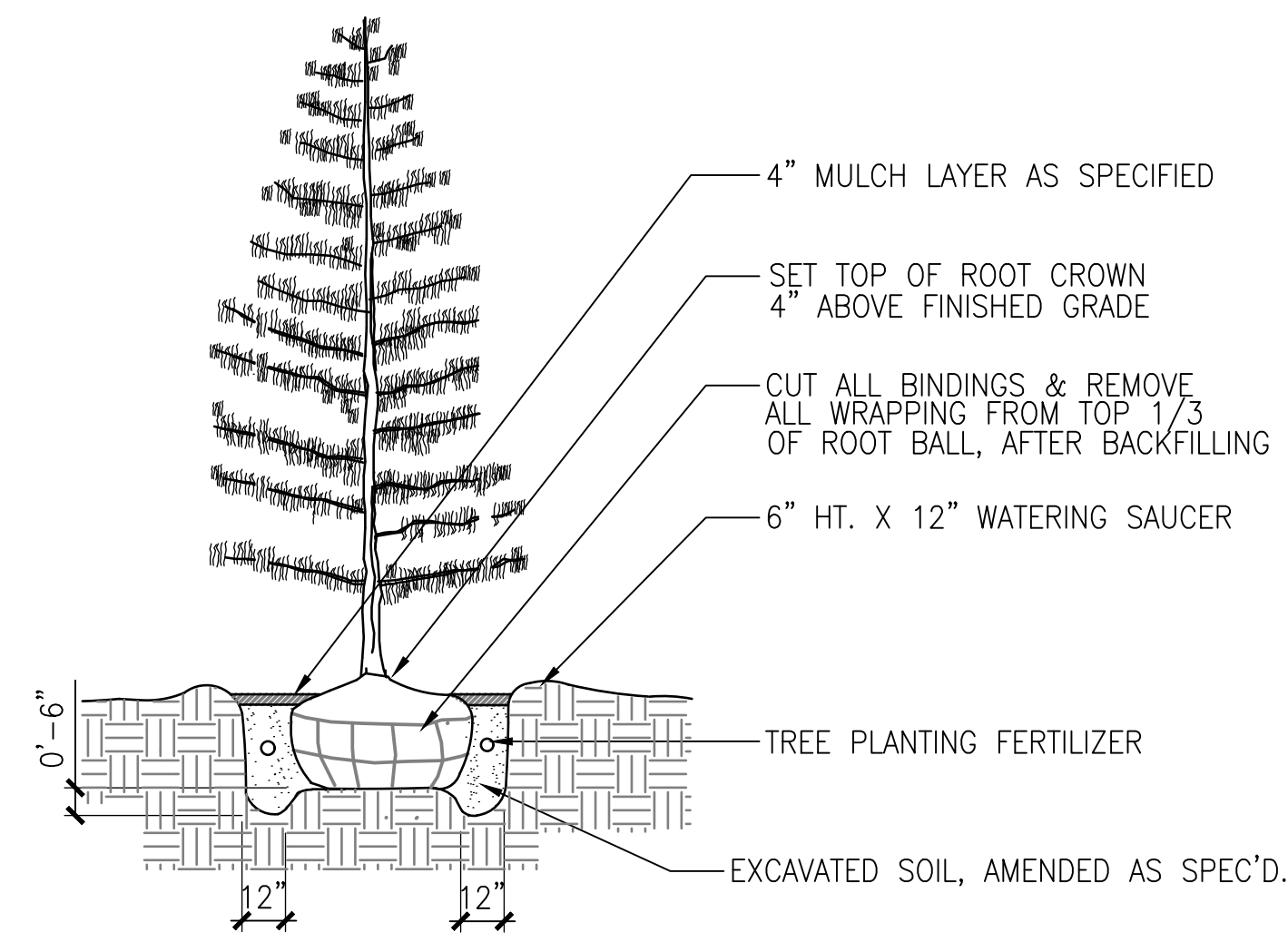

EVERGREEN TREE PLANTING
SCALE: 1/4"=1'-0" DT--evergreen--gyn

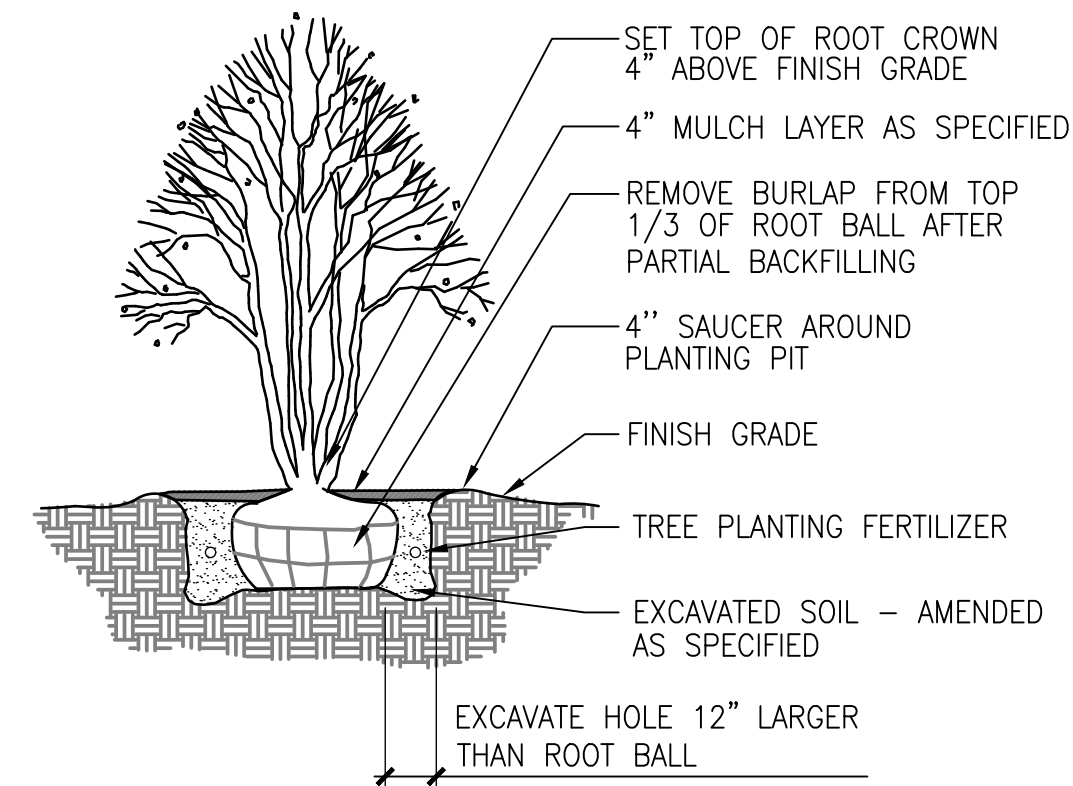

ORNAMENTAL TREE PLANTING
SCALE: 1/4"=1'-0" DT--ornamentaltree--gyn

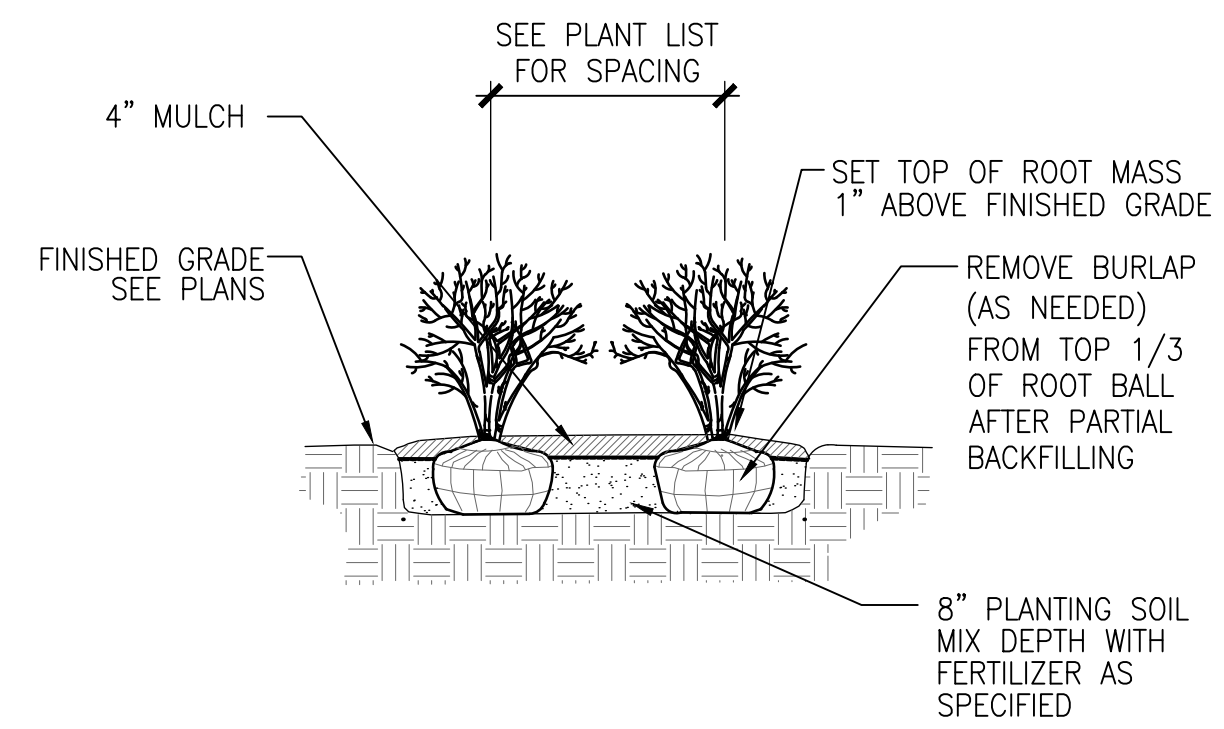

SHRUB PLANTING
SCALE: 1/2"=1'-0" DT--shrub--gyn

ALL PLANTS TO BE INSTALLED IN STAGGERED ROWS UNLESS OTHERWISE NOTED ON PLANS

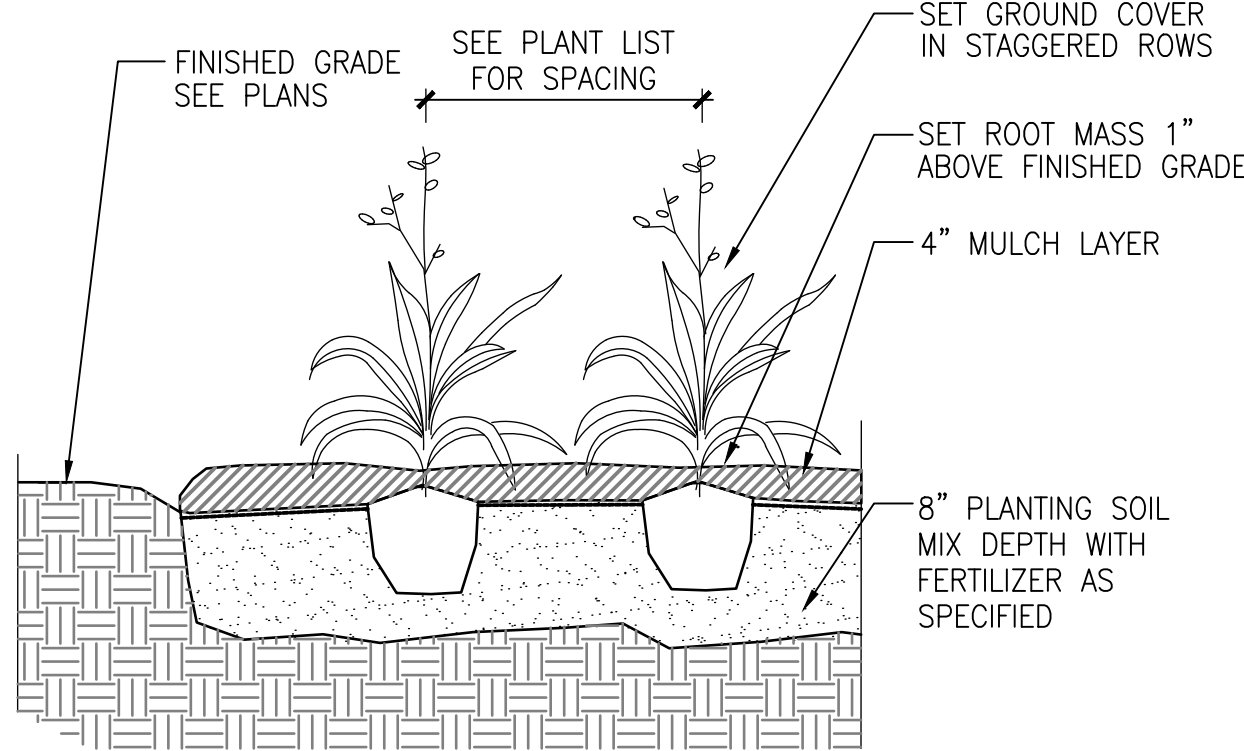

GROUNDCOVER PLANTING
SCALE: 1"=1'-0" DT--groundcover--gyn

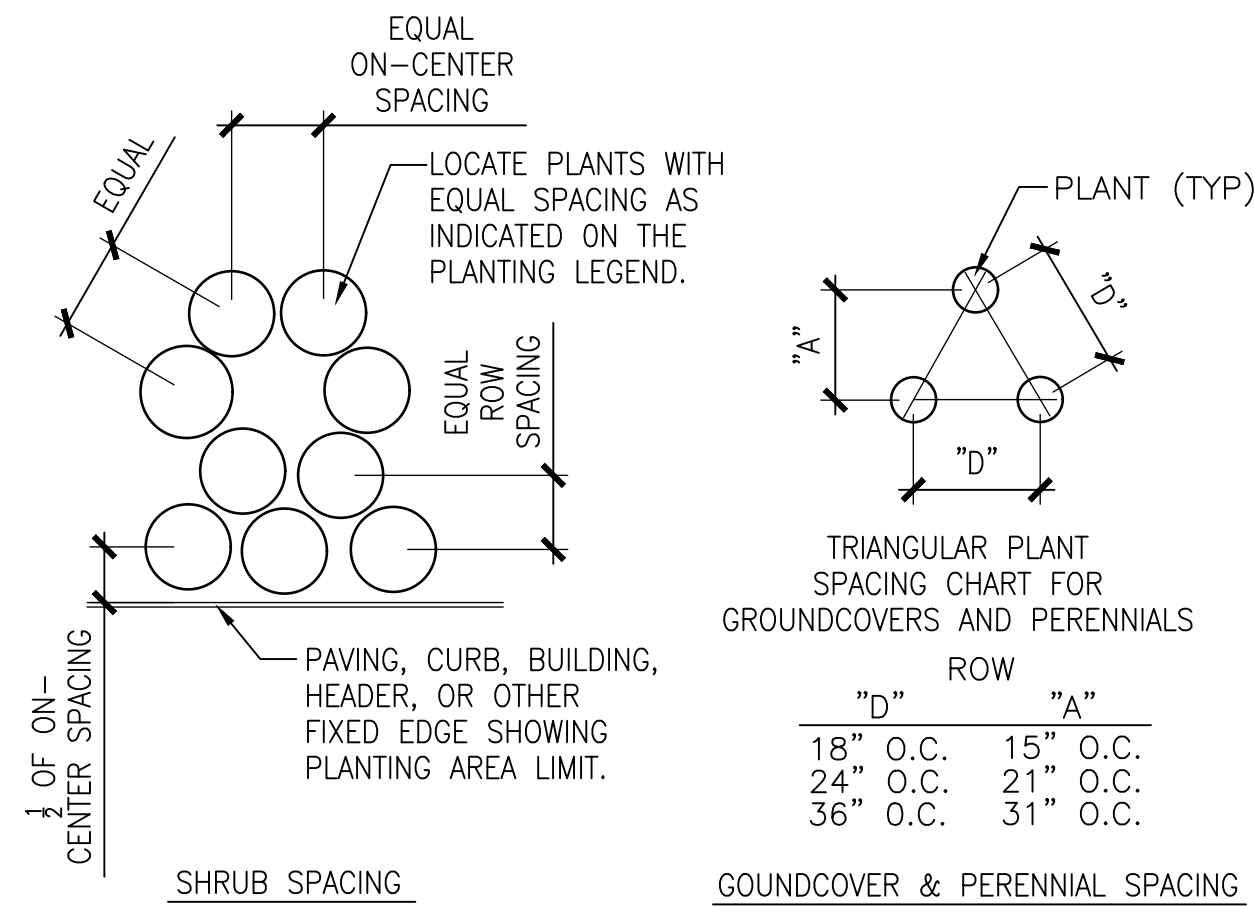

PLANT SPACING DETAIL
SCALE: 1/2"=1'-0" DT--plantspace--gyn

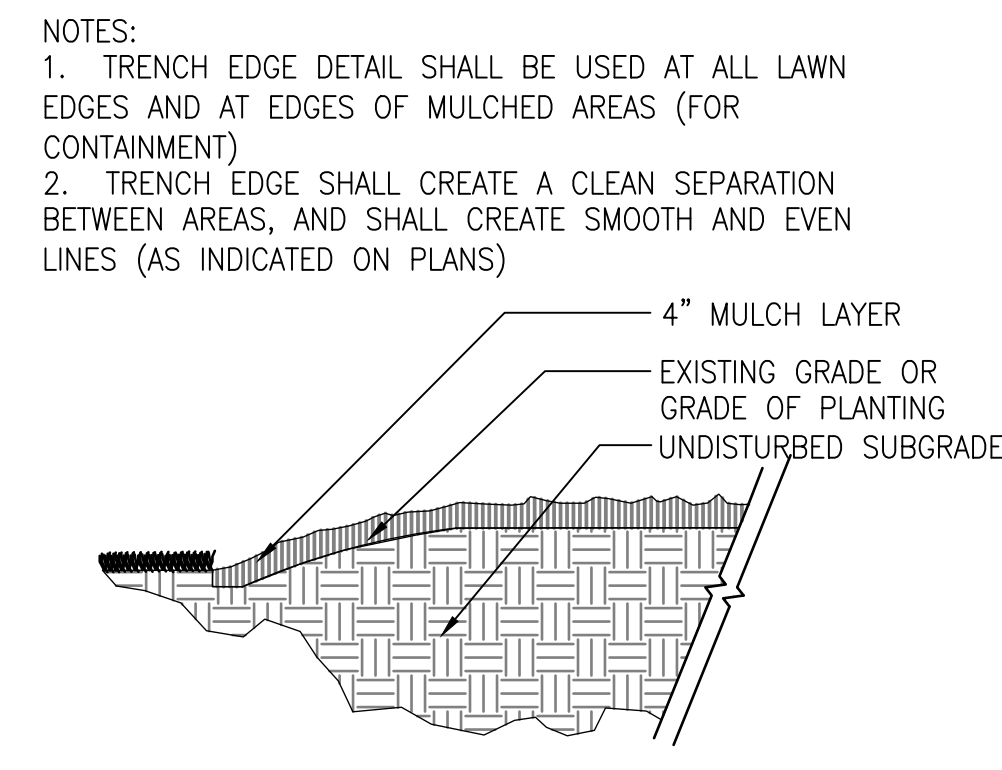

TRENCH EDGE DETAIL
SCALE: 1"=1'-0" DT--ls--trench--gyn

NOTES:
1. TRENCH EDGE DETAIL SHALL BE USED AT ALL LAWN EDGES AND AT EDGES OF MULCHED AREAS (FOR CONTAINMENT)
2. TRENCH EDGE SHALL CREATE A CLEAN SEPARATION BETWEEN AREAS, AND SHALL CREATE SMOOTH AND EVEN LINES (AS INDICATED ON PLANS)

1. THE LANDSCAPE CONTRACTOR SHALL BE RESPONSIBLE FOR MAKING HIMSELF FAMILIAR WITH ALL UNDERGROUND UTILITIES AND STRUCTURES. SEE CONSTRUCTION NOTES.
2. DO NOT WILLFULLY PROCEED WITH PLANTINGS AS DESIGNED WHEN IT IS OBVIOUS THAT OBSTRUCTIONS AND/OR GRADE DIFFERENCES EXIST THAT MAY NOT HAVE BEEN KNOWN DURING THE DESIGN PROCESS. SUCH CONDITIONS SHALL BE IMMEDIATELY BROUGHT TO THE ATTENTION OF THE PROJECT MANAGER. THE LANDSCAPE CONTRACTOR WILL BE HELD RESPONSIBLE FOR ANY NECESSARY REVISIONS AND COSTS DUE TO FAILURE TO GIVE SUCH NOTIFICATION.
3. THE LANDSCAPE CONTRACTOR SHALL BE RESPONSIBLE FOR ANY COORDINATION WITH SUBCONTRACTORS AND/OR SUPPLIERS AS REQUIRED TO ACCOMPLISH PLANTING OPERATIONS.
4. THE LANDSCAPE CONTRACTOR IS TO RECEIVE THE SITE AT +/- 1/10TH OF AN INCH. THE LANDSCAPE CONTRACTOR SHALL OBTAIN A LETTER OF GRADE FROM THE GENERAL CONTRACTOR PRIOR TO BEGINNING WORK.
5. REFER TO SPECIFICATIONS FOR PLANTING REQUIREMENTS, MATERIALS, AND EXECUTION.
6. ALL TREES SHALL BE TAGGED BY THE PROJECT MANAGER AT A NURSERY SELECTED BY THE LANDSCAPE CONTRACTOR OR AT THE DISCRETION OF THE PROJECT MANAGER.

PLANTING NOTES
SCALE: NTS DT--plantnote--gyn

7. FINAL LOCATION OF ALL PLANT MATERIAL SHALL BE SUBJECT TO APPROVAL OF THE PROJECT MANAGER PRIOR TO DIGGING ANY HOLES. THE LANDSCAPE CONTRACTOR IS RESPONSIBLE FOR PROVIDING PROJECT MANAGER ADEQUATE ADVANCE NOTICE FOR ON-SITE APPROVALS. THE LANDSCAPE CONTRACTOR IS TO FOLLOWING BEFORE BEGINNING INSTALLING PLANTINGS:
SHRUBS - LAY OUT THE ACTUAL CONTAINERS ON-SITE BEFORE DIGGING HOLES.
TREES - STAKE THE LOCATIONS BEFORE DIGGING HOLES. ANY TREE PLANTED WITHOUT ITS FINAL LOCATION APPROVED BY THE PROJECT MANAGER MAY BE REQUESTED TO BE RELOCATED AT THE SOLE EXPENSE OF THE LANDSCAPE CONTRACTOR.
8. THE LANDSCAPE CONTRACTOR SHALL NOTIFY THE PROJECT MANAGER AT LEAST 48 HOURS IN ADVANCE PRIOR TO COMMENCEMENT OF WORK TO COORDINATE PROJECT OBSERVATION SCHEDULES.
9. IF CONFLICTS ARISE BETWEEN THE ACTUAL SIZE OF AREAS ON THE SITE AND THE DRAWINGS, CONTACT THE PROJECT MANAGER FOR RESOLUTION.
10. IT IS THE LANDSCAPE CONTRACTOR'S RESPONSIBILITY TO FURNISH PLANTS FREE OF PESTS AND/OR DISEASES. PRE-SELECTED OR "PROJECT MANAGER TAGGED" PLANT MATERIAL MUST BE INSPECTED BY THE LANDSCAPE CONTRACTOR AND CERTIFIED PEST AND DISEASE FREE. IT IS THE LANDSCAPE CONTRACTOR'S OBLIGATION TO WARRANTY ALL PLANT MATERIAL PER THE SPECIFICATIONS.

11. GROUNDCOVERS AND SHRUBS ARE TO BE TRIANGULARLY SPACED UNLESS INDICATED ON THE PLANS.
12. ALL TREES WITHIN A SPECIES SHALL HAVE MATCHING FORM, UNLESS OTHERWISE NOTED.
13. ALL TREES, SHRUB AND GROUNDCOVER AREAS (EXCLUDING TURF AND SLOPE AREAS) ARE TO BE MULCHED PER DETAILS.
14. ALL MULCH TO BE DOUBLE SHREDDED HARDWOOD MULCH, BROWN IN COLOR MINIMUM 4" THICK.
15. TREES SHALL BE SET BACK A MINIMUM OF TEN FEET (10') HORIZONTALLY FROM UTILITY STRUCTURES, INCLUDING, BUT NOT LIMITED TO, MANHOLES, VALVE VAULTS, VALVE BOXES, FIRE HYDRANTS, TRANSFORMERS AND SWITCH CANS. TREES SHALL BE SET BACK A MINIMUM OF FIVE (5') HORIZONTALLY FROM SANITARY SEWER AND WATER SERVICES. CONTRACTOR TO MAKE NECESSARY ADJUSTMENTS UNDER THE APPROVAL OF OWNER.
16. PLANTING RESTRICTIONS: PLANT DURING ONE OF THE FOLLOWING PERIODS. COORDINATE PLANTING PERIODS WITH MAINTENANCE PERIODS TO PROVIDE REQUIRED MAINTENANCE FROM DATE OF SUBSTANTIAL COMPLETION.
 1. SPRING PLANTING: 5/1 - 6/15
 2. FALL PLANTING: 9/15 - 12/1

PRELIMINARY
NOT FOR CONSTRUCTION



Design Perspectives, Inc.
Grounded in Creativity

1167 Hobson Mill Drive
Naperville, Illinois 60540
Telephone: (630) 606-0776
www.design-perspectives.net

PRIMROSE SCHOOLS:
NAPERVILLE, IL

25W710 75TH STREET
NAPERVILLE, IL 60565

THESE DOCUMENTS CONTAIN INFORMATION PROPRIETARY TO ADA ARCHITECTS, INC. UNAUTHORIZED USE OF THESE DOCUMENTS IS EXPRESSLY PROHIBITED UNLESS AGREED UPON IN WRITING.

REVISIONS

#	DATE	TYPE
01	07-19-2024	ZONING SUBMITTAL
02	11-13-2024	CITY RE-SUBMITTAL
03	12-16-2024	CITY RE-SUBMITTAL
04	1-13-2025	CITY REVISIONS
05	2-18-2025	CITY REVISIONS
06	2-24-2025	CITY REVISIONS
07	3-5-2025	CITY REVISIONS

LANDSCAPE DETAILS

DATE 07/19/2024

JOB NO. 23529

LP-500

SHEET NO.



EXHIBIT D

SECTION 02920 - LANDSCAPING

PART 1 - GENERAL

1.1 RELATED DOCUMENTS

Retain or delete this article in all Sections of Project Manual.

A. Drawings and general provisions of the Contract, including General and Supplementary Conditions and Division 01 Specification Sections, apply to this Section.

1.2 SUMMARY

A. Furnish all trees, shrubs, and other plant materials, labor equipment, and non-plant materials required to complete installation of planting indicated on the Landscape Drawings and Details.

Furnish all soil preparation, fertilizer, soil mulching, trees, shrubs, groundcovers, sodding, bed mulching, labor and equipment required to landscape all areas as indicated on the Landscape Drawings.

B. Section Includes:

- 1. Trees
2. Shrubs
3. Perennials
4. Annuals
5. Ornamental grasses
6. Mulch
7. Pruning
8. Guying and Staking
9. Landscape Edging
10. Tree Watering Devices
11. Seeding.
12. Hydroseeding.
13. Sodding.
14. Plugging.
15. Meadow grasses and wildflowers.
16. Turf renovation.
17. Erosion-control material(s).

C. Related Requirements (If Used):

- 1. Section 02231 "Tree Protection and Trimming" for protecting, trimming, pruning, repairing, and replacing existing trees to remain that interfere with, or are affected by, execution of the Work.
2. Section 02810 "Design-Build Irrigation System".
3. Section 02300 "Earthwork".

1.3 ALLOWANCES

A. Perform planting work under quantity allowances and only as authorized. Authorized work includes work required by Drawings and the Specifications and work authorized in writing by the Project Manager.

B. Notify Project Manager weekly of extent of work performed that is attributable to quantity allowances.

C. Furnish trees as part of tree allowance.

1.4 UNIT PRICES

A. Work of this Section is affected by unit prices specified in Section 01270 "Unit Prices."

B. Unit prices apply to authorized work covered by quantity allowances.

C. Unit prices apply to additions to and deletions from the Work as authorized by Change Orders.

1.4 DEFINITIONS

A. Backfill: The earth used to replace or the act of replacing earth in an excavation.

B. Ball and Burlapped Stock: Plants dug with firm, natural balls of earth in which they were grown, with a ball size not less than diameter and depth recommended by ANSI Z60.1 for type and size of plant required; wrapped with burlap, tied, rigidly supported, and drum laced with twine with the root flare visible at the surface of the ball as recommended by ANSI Z60.1.

C. Container-Grown Stock: Healthy, vigorous, well-rooted plants grown in a container, with a well-established root system reaching sides of container and maintaining a firm ball when removed from container. Container shall be rigid enough to hold ball shape and protect root mass during shipping and be sized according to ANSI Z60.1 for type and size of plant required.

D. Finish Grade: Elevation of finished surface of planting soil.

E. Pesticide: A substance or mixture intended for preventing, destroying, repelling, or mitigating a pest. Pesticides include insecticides, miticides, herbicides, fungicides, rodenticides, and molluscicides. They also includes substances or mixtures intended for use as a plant regulator, defoliant, or desiccant.

F. Pests: Living organisms that occur where they are not desired or that cause damage to plants, animals, or people. Pests include insects, mites, grubs, mollusks (snails and slugs), rodents (gophers, moles, and mice), unwanted plants (weeds), fungi, bacteria, and viruses.

G. Planting Area: Areas to be planted

H. Planting Soil: Existing, on-site soil; imported soil; or manufactured soil that has been modified with soil amendments and perhaps fertilizers to produce a soil mixture best for plant growth. Plant; Plants; Plant Material: The terms refer to vegetation in general, including trees, shrubs, vines, groundcovers, ornamental grasses, bulbs, plugs, or herbaceous vegetation.

I. Root Flare: Also called "trunk flare." The area at the base of the plant's stem or trunk where the stem or trunk broadens to form roots; the area of transition between the root system and the stem or trunk.

J. Stem Girdling Roots: Roots that encircle the stems (trunks) of trees below the soil surface.

K. Subgrade: The surface or elevation of subsoil remaining after excavation is complete, or the top surface of a fill or backfill before planting soil is placed.

1.6 COORDINATION

A. Coordination with turf areas (lawns): Plant trees, shrubs, and other plants after finish grades are established and before planting turf areas unless otherwise indicated.

- 1. When planting trees, shrubs, and other plants after planting turf areas, protect turf areas, and promptly repair damage caused by planting operations.

1.7 SUBMITTALS

A. Qualification Data: For landscape Installer.

B. Product Data: For each type of product.

- 1. Plant Materials: Include quantities, sizes, quality, and sources for plant materials.
2. Plant Photographs: Include color photographs in digital format of each species and size of plant materials as it will be furnished to the Project. Take photographs from an angle depicting true size and condition of the typical plant to be furnished. Include scale rod or other measuring device in each photograph. For species where more than ten (10) plants are required, include a minimum of three (3) photographs showing the average plant, the best quality plant, and the worst quality plant to be furnished. Identify each photograph with the full botanical name of the plant, plant size, and name of the growing nursery.

C. Grower or Nursery Certifications

- 1. All State, Federal, or other certificates shall be submitted to the Project Manager prior to acceptance of plant material along with other information showing the source or origin.
2. Current grower or nursery certifications indicating that all contractor supplied plant material is healthy, vigorous, and free from insects, pests, plant diseases, and injuries.

D. Certification of Topsoil Mixture: Submit topsoil mix test reports to Project Manager for review. If existing material is to be re-used, topsoil to be tested and reviewed by Project Manager

E. Certification of each sod/seed mixture. Include identification of source and name and telephone number of supplier.

F. Product Certificates: For fertilizers, from manufacturer.

G. Pesticides and Herbicides: Product label and manufacturer's application instructions specific to Project.

H. Samples: Submit physical samples of each of the following materials for approval. All samples shall be submitted in a one quart, clear, plastic bag (Ziploc type) or appropriate container. Submittals must be made prior to commencing any activities. All samples shall be clearly labeled with the following information.

- Project Name Site Improvements
Material name as shown on plans and specifications
Supplier or distributor's name
Supplier or distributor's product name and/or order number

Required samples are as follows

- 1. Mulch
2. Compost

I. Slow-Release, Tree-Watering Device: One (1) unit of each size required.

J. Edging Materials and Accessories:

- 1. Manufacturer's product information sheet.
2. 12" length of Manufacturer's standard size, to verify color selected.

1.8 CONSTRUCTION SCHEDULE

A. Prior to beginning installation of the landscape, the Contractor is to submit a project construction schedule to the Project Manager for approval. The schedule should include the areas and types of construction to be undertaken and the sequence which will be used to accomplish the completion of the project. Schedule must be submitted prior to commencing any activities.

B. At the completion of the work, furnish three (3) copies of written maintenance instructions to the Owner for maintenance and care of the landscaping. Instructions shall include directions for irrigation, weeding, pruning, fertilization, and spraying as required for continuance of proper maintenance through a full growing season and dormant period.

C. Guarantee of Warranty: At completion of work, furnish written guarantee, and warranty, to the Owner based on the requirements of this section.

1.9 QUALITY ASSURANCE

A. Reference Standards

- 1. U.S. Department of Agriculture Rules and Regulations under the Federal Seed Act and equal in quality to standards for Certified Seed.
2. Requirements for measurements, grading, branching, quality, and the balling and burlapping of plants listed in the plant list shall follow the current issue of American Standards for Nursery Stock issued by the American Association of Nurserymen, Inc. (ANSI-Z 60.1-1990)
3. Plants shall equal or exceed the measurements specified in the plant list, which are minimum acceptable sizes. Plants shall be measured before pruning with branches in normal position. Any necessary pruning shall be done at the time of planting.
4. Other Plants: Measure with stems, petioles, and foliage in their normal position.

C. Installer Qualifications: A qualified landscape installer whose work has resulted in successful establishment of plants.

- 1. Professional Membership: Installer shall be a member in good standing of either the Professional Landcare Network or the American Nursery and Landscape Association.
2. Experience: Five years' experience in landscape installation in addition to requirements in Section 01400 "Quality Requirements."
3. Installer's Field Supervision: Require Installer to maintain an experienced full-time supervisor on Project site when work is in progress.
4. Personnel Certifications: Installer's field supervisor shall have certification in one of the following categories from the Professional Landcare Network:
a. Landscape Industry Certified Technician - Exterior.
b. Landscape Industry Certified Horticultural Technician.
5. Pesticide Applicator: State licensed, commercial.

D. Plant Material Observation: Project Manager may observe plant material either at place of growth or at site before planting for compliance with requirements for genus, species, variety, cultivar, size, and quality. Project Manager may also observe trees and shrubs further for size and condition of balls and not measure stems, disease symptoms, injuries, and latent defects and may reject unsatisfactory or defective material at any time during progress of work. Remove rejected trees or shrubs immediately from Project site.

- 1. Notify Project Manager of sources of planting materials five days in advance of delivery to site.

E. Vandalism: The Contractor will not be responsible for malicious destruction of plantings after final acceptance of the project. He will, however, be responsible for replacement of vandalized materials stored but not yet installed, and vandalized material prior to final acceptance. All cases of vandalism shall be promptly reported to the Owner. The Contractor shall inform the Owner in writing if additional protection must be installed to protect the landscaping from damage after installation.

1.1 DELIVERY, STORAGE, AND HANDLING

A. Packing and Shipping

- 1. Deliver fertilizer to site in original unopened containers bearing the manufacturer's guaranteed chemical analysis, name, trade name, trademark, and conformance to State law. Notify Project Manager of delivery schedule in advance so material may be inspected upon arrival at the job site.
2. Deliver packaged materials in original, unopened containers showing weight, analysis and name of manufacturer, and indication of compliance with state and Federal laws, if applicable. Provide copies of delivery receipts for materials to be incorporated into the construction to the Project Manager as deliveries are made. Materials to be accounted for include: fertilizers, soil amendments, peat moss, manure, grass seed, plant tabs, and mulch.
3. Plants shall be containerized with limbs bound, properly wrapped and prepared for shipping in accordance with recognized standard practice. The root system shall be kept moist and plants shall be protected from adverse conditions due to climate and transportation, between the time they are dug and actual planting.
4. Each plant shall be identified by means of a grower's label affixed to the plant. The grower's label shall give the data necessary to indicate conformance to specifications. Use durable waterproof labels with water resistant ink which will remain legible for at least 60 days. Notify the Project Manager prior to delivery of plant materials to the site so that a pre-planting inspection may be made or indicate delivery schedule in advance so plant material may be inspected upon arrival at job site, whichever is more appropriate. Grower's labels shall be removed prior to the walk through for initial acceptance.
5. Do not prune trees and shrubs before delivery.
6. Handle planting stock by root ball. Do not drop plants. Do not lift plants by the trunk, stems, or foliage. The ball of the plant shall be natural, and the plant shall be handled by the ball at all times. All plants shall be protected at all times from drying out or other injury. Minor broken and damaged roots shall be pruned before planting.

B. Acceptance at Site

- 1. Remove unacceptable plant material immediately from job site.
2. Major damage shall be cause for rejection.
3. No balled or burlapped plant shall be accepted if the ball is broken or the trunk is loose in the ball.

C. Storage and Protection

- 1. Deliver plants after preparations for planting have been completed, and install immediately. If planting is delayed more than six hours after delivery, set plants and trees in their appropriate aspect (sun, filtered sun, shade), protect from weather and mechanical damage, and keep roots moist.
a. Heel-in bare-root stock. Soak roots that are in less than moist conditions in water for two hours. Reject plants with dry roots.
b. Set balled stock on ground and cover ball with soil, peat moss, mulch, or other acceptable material.
c. Do not remove container-grown stock from containers before time of planting.
d. Water root systems of plants stored on-site deeply and thoroughly with a fine-mist spray. Water as often as necessary to maintain root systems in a moist, but not overly wet condition.
2. Protect bark, branches, and root systems from sun scald, drying, wind burn, sweating, whipping, and other handling and tying damage. Do not bend or bind-tie trees or shrubs in such a manner as they destroy their natural shape. Provide protective covering of plants during shipping and delivery. Do not drop plants during delivery and handling.
3. Apply antidesiccant to trees and shrubs using power spray to provide an adequate film over trunks (before wrapping), branches, stems, twigs, and foliage to protect during digging, handling, and transportation.
a. If deciduous trees or shrubs are moved in full leaf, spray with antidesiccant at nursery before moving and again two weeks after planting.
4. Wrap trees and shrubs with burlap fabric over trunks, branches, stems, twigs, and foliage to protect from wind and other damage during digging, handling, and transportation.
5. Protect all existing and newly planted trees, shrubs, and groundcover within the areas of construction and related excavation as herein specified. Provide suitable barricades and/or fences as required.
6. Store bulbs in a dry place at 60 to 65 deg. F (16 to 18 deg. C) until planting.

B. Sod: Harvest, deliver, store, and handle sod according to requirements in "Specifications for Turfgrass Sod Materials" and "Specifications for Turfgrass Sod Transplanting and Installation" sections in TPI's "Guideline Specifications to Turfgrass Sodding." Deliver sod within 24 hours of harvesting and in time for planting promptly. Protect sod from breakage and drying.

C. Bulk Materials:

- 1. Do not dump or store bulk materials near structures, utilities, walkways and pavements, or on existing turf areas or plants.
2. Provide erosion-control measures to prevent erosion or displacement of bulk materials; discharge of soil-bearing water runoff; and airborne dust reaching adjacent properties, water conveyance systems, or walkways.
3. Accompany each delivery of bulk materials with appropriate certificates.

1.11 PROJECT CONDITIONS

A. The Contractor must examine the subgrade upon which work is to be performed, verify subgrade elevations, observe the conditions under which work is to be performed, verify suitability of the soil and notify the Project Manager in writing of unsatisfactory conditions. Do not proceed with the work until unsatisfactory conditions have been corrected in a manner acceptable to the Project Manager. Commencement of work shall mean acceptance of the site conditions.

B. Existing Conditions

- 1. The site will be provided to the contractor within +/-0.2 foot finish grades.
2. Utilities - Determine location of underground utilities and perform work in a manner which will avoid possible damage. Do not permit heavy equipment such as trucks, rollers, or bulldozers to damage utilities. Hand excavate when called for to minimize the possibility of damage to underground utilities. Maintain grade stakes set by others until removal is mutually agreed upon by all parties concerned. Any damage to utilities that may result in spite of protective measures must be completely corrected and repaired by the Contractor at no additional cost to the Owner.

1.12 SEQUENCING AND SCHEDULING

A. Planting Schedule

Schedule each type of landscape work required during the normal season for such work in the area of the site. Establish dates for each type of work and establish a completion date. Correlate work with specified maintenance periods to provide maintenance until accepted by the Owner. Do not depart from the accepted schedule, except with written authorization. Submit request to the Project Manager for changes in the planting schedule. When delays in the planting schedule are unavoidable, include documentation of the reason for delay.

B. Plant trees and shrubs during normal season for such work in the location of the project.

C. Weather Limitations: Proceed with planting only when existing and forecasted weather conditions permit planting to be performed when beneficial and optimum results may be obtained. Apply products during favorable weather conditions according to manufacturer's written instructions.

D. Coordination with Lawns

Plant trees and shrubs after final grades are established and prior to planting of lawns, unless otherwise acceptable to the Project Manager. If planting of trees and shrubs occurs after lawn work, protect lawn areas and promptly repair damage to lawns resulting from planting operations.

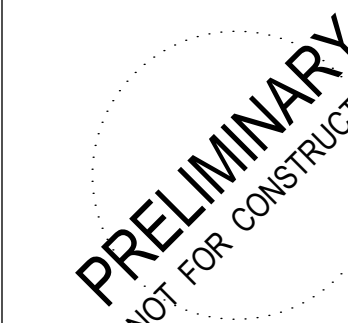

Design Perspectives, Inc.
Grounded in Creativity

1167 Hobson Mill Drive
Naperville, Illinois 60540
Telephone: (630) 606-0776
www.design-perspectives.net

PRIMROSE SCHOOLS:
NAPERVILLE, IL

NAPERVILLE, IL 60565

25W710 75TH STREET

THESE DOCUMENTS CONTAIN INFORMATION PROPRIETARY TO ADA ARCHITECTS, INC. UNAUTHORIZED USE OF THESE DOCUMENTS IS EXPRESSLY PROHIBITED UNLESS AGREED UPON IN WRITING.

REVISIONS

Table with columns: DATE, TYPE, #, and rows for ZONING SUBMITTAL, CITY RESUBMITTAL, CITY REVISIONS, CITY REVISIONS, CITY REVISIONS.

LANDSCAPE SPECIFICATIONS

DATE 07/19/2024

JOB NO. 23529

LP-501

SHEET NO.

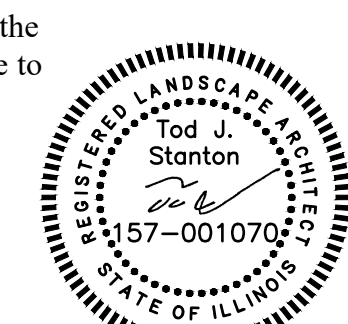

EXHIBIT D

1.13 WARRANTY AND GUARANTEE

- A. Guarantee trees, shrubs, groundcovers and all plant material for a period of one year from the date of final acceptance against defects not resulting from neglect of Owner, or abuse and damage by others.
B. For a period of one year after acceptance of work, at no additional cost to the Owner, the Contractor is to replace any plants that are dead, or that are in unhealthy or unsightly condition, or have lost their natural shape due to dead branches or excessive pruning and replace planting materials/products due to faulty performance and/or deterioration beyond normal weathering.
C. Replacement plants shall be of the same variety and size or larger as originally specified in the plant list.
D. A one year warranty shall also apply to the plants replaced at the first warranty walk-through.
E. Begin interim maintenance period immediately after planting of landscape materials, and after planting of lawn areas, and continue interim maintenance until landscape work is deemed substantially complete and accepted by the Owner or Landscape Architect.
F. The maintenance period, as specified on the bid form, will commence when all areas have received substantial completion.
G. Meet with the Owner prior to final acceptance, and prior to the termination of the maintenance period, to go over maintenance requirements of the project.

PART 2 - PRODUCTS

- A. Mulches
1. Refer to plans for specified materials.
B. Stakes and Guys (Use only if specified)
1. Stakes - 6' and 2' long, heavy-duty T-bar steel posts.
2. Guys - 12 gauge galvanized steel wire
3. Nylon straps - 1 1/2", with metal grommets ends.
4. 3/4" White, PVC pipe, 24" lengths.
C. Tree wrapping
Clark's Tree Wrap, 4" wide, designed to prevent winter bark injury. Secure with flexible grafting ties.
D. Landscape Edging (Use only if specified)
1. Steel edging: Standard commercial-steel edging, fabricated in sections of standard lengths, with loops stamped from or welded to face of sections to receive stakes.
E. Tree-Watering Devices
1. Slow-Release Watering Device: Standard product manufactured for drip irrigation of plants and emptying its water contents over 5 to 9 hours; manufactured from UV-light stabilized nylon-reinforced polyethylene sheet, PVC, or HDPE plastic.
F. Turf Seed
1. Grass seed: Fresh clean, dry, new-crop seed complying with AOSA's "Rules for Testing Seeds" for purity and germination tolerances.
G. Turf Sod
1. Number 1 Quality/Premium, including limitations on thatch, weeds, diseases, nematodes, and insects, complying with "Specifications for Turfgrass Sod Materials" in TPI's "Guideline Specifications to Turfgrass Sodding."
H. Native Prairie, Bioswale, Detention Area, and/or Wetland Seed
1. Fresh, clean, and dry new seed from a source specializing in native seed production.
I. Fertilizer
1. Commercial-grade complete fertilizer of neutral character, consisting of fast- and slow-release nitrogen, 50 percent derived from natural organic sources of urea formaldehyde, phosphorous, and potassium in the following composition:
J. Pesticides
1. General: Pesticide, registered and approved by the EPA, acceptable to authorities having jurisdiction, and of type recommended by manufacturer for each specific problem and as required for Project conditions and application.
K. Erosion Control Materials
1. Erosion-Control Blankets: Biodegradable wood excelsior, straw, or coconut-fiber mat enclosed in a photodegradable plastic mesh.

- L. Water
1. Free of substances harmful to plant growth. Be responsible for furnishing water from underground sprinkler system, quick couplers, or other source.
M. Trees, Shrubs, Ornamental Grasses, and Perennials
1. Provide nursery grown trees, shrubs, ornamental grasses, and perennials except as otherwise indicated, grown in a recognized nursery in accordance with good horticultural practice, with healthy root systems developed by transplanting or root pruning.
N. Deciduous Trees
1. Provide trees of the height and caliper listed or shown.
2. Where shade trees are required, provide single stem trees with straight trunk and intact leader, free of branches to a point.
3. Where small trees of upright or spreading type are required, provide trees with single stem, branched or pruned naturally according to species and type, and with the relationship of caliper and branching recommended by ANSI Z60.1, unless otherwise shown.
O. Deciduous Shrubs and Groundcovers
1. Provide deciduous shrubs with not less than the minimum number of canes required by ANSI Z60.1 for the type and height of shrub specified.
P. Coniferous and Broadleaf Evergreens
1. Provide evergreens of the size shown. Dimension indicates minimum spread for spreading and semi-spreading type evergreens and height for all other types such as globe, dwarf, cone, pyramidal, broad- up-right, and columnar.
Q. Requirements for Balled and Burlapped Stock:
1. Where shown or specified to be balled and burlapped, provide trees and shrubs dug with a firm, natural ball of earth in which they were grown.
R. Requirements for Container Grown Stock
1. Where specified as acceptable, provide healthy, vigorous well rooted shrubs or ornamental grasses established in the container in which they are sold.
S. Plugs
1. Provide plugs in 2-3/8" square x 3-3/4" deep open-bottomed pots from a source specializing in native species.
PART 3 - EXECUTION
3.1 EXAMINATION
A. Examine areas to be planted for compliance with requirements and other conditions affecting installation and performance of the Work.
1. Verify that no weeds, foreign or deleterious material or liquid such as paint, paint washout, concrete slurry, concrete layers or chunks, cement, plaster, oils, gasoline, diesel fuel, paint thinner, turpentine, tar, roofing compound, or acid has been deposited in soil within a planting area.
2. Verify that plants and vehicles loaded with plants can travel to planting locations with adequate overhead clearance.
3. Suspend planting operations during periods of excessive soil moisture until the moisture content reaches acceptable levels to attain the required results.
4. Uniformly moisten excessively dry soil that is not workable within the planting area.
B. If contamination by weeds, foreign or deleterious material or liquid is observed in soil in a planting area, direct as directed by Project Manager.
C. Proceed with installation only after unsatisfactory conditions have been corrected.

3.2 PREPARATION

- A. Protect structures; utilities; sidewalks; pavements; and other facilities, trees, shrubs, and plantings from damage caused by planting operations.
1. Protect adjacent and adjoining areas from hydroseeding and hydromulching overspray if used.
2. Protect grade stakes set by others until directed to remove them.
B. Install erosion-control measures to prevent erosion or displacement of soils and discharge of soil-bearing water runoff or airborne dust to adjacent properties and walkways.

3.3 INSTALLATION

- A. General: Prepare planting area for soil placement and mix planting soil as indicated on the drawings.
B. Before planting, obtain Project Manager's acceptance of finish grading; restore planting areas if eroded or otherwise disturbed after finish grading.
C. Proceed with and complete the landscape work as rapidly as portions of the site become available, working within the seasonal limitations for each kind of landscape work required.
D. Cooperate with any other Contractors and trades which may be working in and adjacent to the landscape work areas. Examine drawings which show the development of the entire site and become familiar with the scope of all work required.

3.4 FINAL PLANT LOCATIONS

- A. Stake location of individual trees, for approval by Project Manager, prior to planting or excavating
B. If a new tree or shrub relocation is necessary due to interference with underground piping or wiring, the Contractor shall notify the Project Manager and receive approval of a new location.
C. The Project Manager must approve the precise location of all plants prior to pit excavation and installation.
D. Make minor adjustments as requested by the Project Manager, or as necessary to avoid conflicts with utility locations.

3.5 EXCAVATION FOR PLANTING

- A. Where rubble fill is encountered, notify Project Manager and prepare planting pits properly by removal of rubble or other acceptable methods.
B. If rock, underground construction work, or other obstructions are encountered in excavation for planting of trees or shrubs, notify the Project Manager. If necessary, new locations may be selected by the Project Manager
C. If subsoil conditions indicate the retention of water in planting areas, as shown by seepage or other evidence indication the presence of underground water, notify the Project Manager before backfilling.
D. Planting Pits and Trenches: Excavate circular planting pits
1. Excavate planting pits with sides sloping at a 45-degree angle. Excavations with vertical sides are unacceptable. Trim perimeter of bottom leaving center area of bottom raised slightly to support root ball and assist in drainage away from center. Do not further disturb base. Ensure that root ball will sit on undisturbed base soil to prevent settling. Searily sides of planting pit smeared or smoothed during excavation.
2. Excavate at least 2-times the diameter of the root ball in width.
3. Do not excavate deeper than depth of root ball, measured from the root flare to the bottom of the root ball.
4. If area under the plant was initially dug too deep, add soil to raise it to the correct level and thoroughly tamp the added soil to prevent settling.
5. Maintain angles of repose of adjacent materials to ensure stability. Do not excavate subgrades of adjacent paving, structures, hardscapes, or other new or existing improvements.
6. Maintain supervision of excavations during working hours.
7. Keep excavations covered or otherwise protected when unattended by Installer's personnel.
8. If drain tile is indicated on Drawings, or required under planting areas, excavate to top of porous backfill over tile.

- E. At the Project Manager's option, plant pits will be filled with water and must drain completely within twenty-four hours to be acceptable. Pits that do not drain shall be provided with twelve inch (12") diameter X thirty six inch (36") deep auger holes (one per tree pit) to be filled with 1 1/2" gravel. A change order will be issued if the Project Manager determines drain holes shall be installed.
F. Backfill Soil: Subsoil and topsoil removed from excavation may be used as backfill soil unless otherwise indicated.

3.6 TREE, SHRUB, ORNAMENTAL GRASS, AND PERENNIAL PLANTING

- A. Inspection: At time of planting, verify that root flare is visible at top of root ball according to ANSI Z60.1. If root flare is not visible, remove soil in a level manner from the root ball to where the top-most root emerges from the trunk. After soil removal to expose the root flare, verify that root ball still meets size requirements.
B. Roots: Remove stem girdling roots and kinked roots. Remove injured roots by cutting cleanly; do not break.
C. Set container grown stock, excavate as specified for balled and burlapped stock except container width and depth shall govern. Pit shall be at least twice as wide as the container.
D. Set tree ball, plumb and in the center of pit or trench with top of ball 2", minimum, above adjacent landscape grades. Remove burlap from sides and tops of balls, but do not remove from under balls. Remove platforms, if any, before setting. Do not use stock if ball is cracked, or broken before or during planting operation. When setting place additional backfill around base and sides of ball, and work each layer to settle backfill and eliminate voids and air pockets. When excavation is approximately 2/3 full, water thoroughly before placing remainder of backfill. Repeat watering until no more is absorbed. Water again after placing final layer of backfill. No burlap shall be pulled out from under balls.
E. A minimum of three-quarters of the wire basket and surplus nylon or binding shall be completely removed, taking care not to damage the root ball. Any roots which are bruised or broken shall be pruned at the time of planting.
F. Set container grown stock as specified for balled and burlapped stock, except cut cans on 2 sides with a metal cutter, and remove bottoms of wooden boxes before setting. Carefully remove cans and sides of wooden boxes after partial backfilling so as not to damage root balls.
G. Set out ornamental grasses, perennials, and groundcovers at spacing noted on the Plans in even rows with triangular spacing. Dig holes large enough for spreading of roots. Work soil around roots to eliminate air pockets and leave a slight saucer indentation around plants to hold water.
H. For plantings in non-turf areas, provide berm around the edge of excavations to form shallow saucer to collect water and to hold mulch.

- I. After planting, the Contractor shall water each plant regularly until final acceptance.
J. All labels and tags shall be removed.

3.7 EDGING INSTALLATION

- A. Steel Edging: Install steel edging where indicated on the Drawings according to manufacturer's written instructions. Anchor with steel stakes spaced approximately 30 inches apart, driven below top elevation of edging.
B. Shovel-Cut (Spade) Edging: Separate mulched areas from turf areas with a 45-degree, 4 - 6 inch deep shovel-cut edge at bedlines shown on the Drawings.

EXHIBIT D

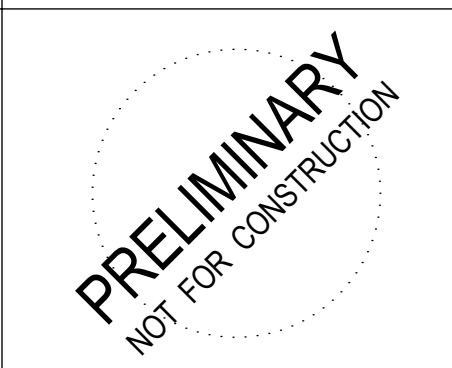
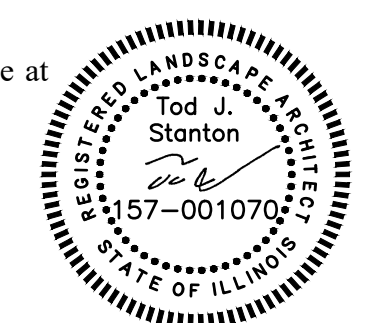

Design Perspectives, Inc.
Grounded in Creativity
1167 Hobson Mill Drive
Naperville, Illinois 60540
Telephone: (630) 606-0776
www.design-perspectives.net

PRIMROSE SCHOOLS: NAPERVILLE, IL

25W710 75TH STREET NAPERVILLE, IL 60566

THESE DOCUMENTS CONTAIN INFORMATION PROPRIETARY TO ADA ARCHITECTS, INC. UNAUTHORIZED USE OF THESE DOCUMENTS IS EXPRESSLY PROHIBITED UNLESS AGREED UPON IN WRITING.

Table with columns for DATE, TYPE, and #. Includes a REVISIONS table and a LANDSCAPE SPECIFICATIONS table with fields for DATE (07/19/2024), JOB NO. (23529), and SHEET NO. (LP-502).

- C. Mow-Strip/Maintenance Edge Installation:
- Excavate for mow strip or maintenance edge as indicated on Drawings.
 - Compact subgrade uniformly beneath mow strip or maintenance edge.
 - For mow strips, apply nonselective, pre-emergent herbicide that inhibits growth of grass and weeds. For maintenance edges, install 6-oz non-woven geotextile fabric as shown on the Drawing Details.
 - Install steel edging, delineating the edge of the mow strip or maintenance edge.
 - Place indicated thickness of mulch or stone.
 - Rake mulch to a uniform surface level with adjacent finish grades.

D. Outline Edger lines with stakes or paint for acceptance by Project Manager before installing irrigation.

E. Spade cut edger shall be in all locations identified on the Drawings. Minor fine tuning of these lines may be required after the placement of sod.

3.8 MULCHING

- A. Fine grade all planting beds to be mulched allowing for full depth of specified mulch.
- B. Place specified mulch evenly over all areas at depth indicated on plans.
- C. Rake and feather finish grade of mulch level and 1/8" below adjacent edger surfaces (if edger is specified).
- D. Make sure mulch is at full depth at adjacent walks and paved surfaces and that mulch doesn't protrude above these surfaces.
- E. Mulch a 36" diameter ring around all trees in turf areas with specified depth of wood mulch, after irrigation areas have been watered in.
- F. All trees and shrubs in native areas are to have a mulch ring equal to the diameter of the planting pit. Mulch shall be a uniform three inches in depth. Do not remove saucer (or berm) around plants in native areas when mulching.

3.9 PRUNING

- A. Remove only dead, dying, or broken branches. Do not prune for shape.
- B. Do not cut tree leaders, and remove only injured or dead branches from flowering trees, if any.
- C. Prune shrubs to retain their natural character and shape, and to accomplish their use in the landscape design.
- D. Do not apply pruning paint to wounds.
- E. Required shrub sizes are the size after pruning.
- F. Remove and replace excessively pruned or deformed stock resulting from improper pruning.

3.10 GUYING AND STAKING

- A. Standard guying system
- Pound stakes into undisturbed soil beyond the planting pit so that stake is secure (2' deep minimum). Secure wire through metal grommets on nylon strap and wrap above first branch or at mid-point of tree. Secure guy wire to stake so that it is taut but allows some movement and so that no sharp projection of wire are extending from post. Adjust tension on wire if needed. Flag guy wire with 3/4" PVC pipe for visibility.
- B. Alternate (conifer) guying system
- Pound stakes into undisturbed soil beyond the planting pit so that stake is secure (2' deep min.), angling away from planting pit and so that top is flush with finish grade. Secure wire through metal grommets on canvas strap and wrap at mid-point of tree. Secure guy wire to stake so that it is taut but not overly tight and so that no sharp projection of wire are extending from post. Adjust tension on wire if needed. Flag guy wire with 3/4" PVC for visibility.

3.11 INSTALLING SLOW-RELEASE WATERING DEVICE

- A. Provide one device for each tree.
- B. Place device on top of the mulch at base of tree stem and fill with water according to manufacturer's written instructions.

3.12 MECHANIZED TREE-SPADE PLANTING (FOR ON-SITE TRANSPLANTS, IF INDICATED ON PLANS)

- A. Trees may be planted with an approved mechanized tree spade at the designated locations. Do not use tree spade to move trees larger than the maximum size allowed for a similar field-grown, balled-and-burlapped root ball diameter according to ANSI Z60.1, or larger than manufacturer's maximum size recommendation for the tree spade being used, whichever is smaller.
- B. Use the same tree spade to excavate the planting hole as will be used to extract and transport the tree.
- C. When extracting the tree, center the trunk within the tree spade and move tree with a solid ball of earth.
- D. Cut exposed roots cleanly during transplanting operations.
- E. Plant trees following procedures in "Tree, Shrub, Ornamental Grass, and Perennial Planting" Article.
- F. Where possible, orient the tree in the same direction as in its original location (north side north).

3.13 PLACING SOIL IN PLANTERS

- A. Place a layer of drainage gravel at least 4 inches thick in bottom of planter. Cover bottom with filter fabric and wrap filter fabric 4 inches up on all sides. Duct tape along the entire top edge of filter fabric to secure the filter fabric against the sides during the soil-filling process.
- B. Fill planter with planting soil. Place soil in lightly compacted layers to an elevation of 1-1/2 inches below top of planter, allowing natural settlement.

3.14 TURF AREA PREPARATION

- A. General: Prepare planting area for soil placement and mix planting soil as indicated on the Drawings.
- B. Placing Planting Soil: Place planting soil as indicated on the Drawings.
- Reduce elevation of planting soil to allow for soil thickness of sod.
- C. Moisten prepared area before planting if soil is dry. Water thoroughly and allow surface to dry before planting. Do not create muddy soil.
- D. Before planting, obtain Project Manager's acceptance of finish grading; restore planting areas if eroded or otherwise disturbed after finish grading.

3.15 PREPARATION FOR EROSION-CONTROL MATERIALS

- A. Prepare area as specified in "Turf Area Preparation" Article.
- B. For erosion-control mats, install planting soil in two lifts, with second lift equal to thickness of erosion-control mats. Install erosion-control mat and fasten as recommended by material manufacturer.
- C. Fill cells of erosion-control mat with planting soil and compact before planting.
- D. For erosion-control blanket or mesh, install from top of slope, working downward, and as recommended by material manufacturer for site conditions. Fasten as recommended by material manufacturer.
- E. Moisten prepared area before planting if surface is dry. Water thoroughly and allow surface to dry before planting. Do not create muddy soil.

3.16 SEEDING

- A. Sow seed with spreader or seeding machine. Do not broadcast or drop seed when wind velocity exceeds 5 mph (8 km/h).
- Evenly distribute seed by sowing equal quantities in two directions at right angles to each other.
 - Do not use wet seed or seed that is moldy or otherwise damaged.
 - Do not seed against existing trees. Limit extent of seed to outside edge of planting saucer.
- B. Sow seed at a total rate according to the written recommendations of the seed supplier.
- C. Rake seed lightly into top 1/8 inch (3 mm) of soil, roll lightly, and water with fine spray.
- D. Protect seeded areas with slopes exceeding 1:4 with erosion-control blanket installed and stapled according to manufacturer's written instructions.
- E. Protect seeded areas with erosion-control mats where indicated on Drawings; install and anchor according to manufacturer's written instructions.
- F. Protect seeded areas with slopes not exceeding 1:4 by spreading straw mulch. Spread uniformly at a minimum rate of 2 tons/acre > to form a continuous blanket 1-1/2 inches (38 mm) in loose thickness over seeded areas. Spread by hand, blower, or other suitable equipment.
- Anchor straw mulch by crimping into soil with suitable mechanical equipment.
 - Bond straw mulch by spraying with asphalt emulsion at a rate of 10 to 13 gal/1000 sq. ft. (38 to 49 L/92.9 sq. m) Take precautions to prevent damage or staining of structures or other plantings adjacent to mulched areas. Immediately clean damaged or stained areas.
- G. Protect seeded areas from hot, dry weather or drying winds by applying compost mulch within 24 hours after completing seeding operations. Soak areas, scatter mulch uniformly to a thickness of 3/16 inch (4.8 mm) and roll surface smooth.

3.17 HYDROSEEDING

- A. Hydroseeding: Mix specified seed, fertilizer, and fiber mulch in water, using equipment specifically designed for hydroseed application. Continue mixing until uniformly blended into homogeneous slurry suitable for hydraulic application.
- Mix slurry with fiber-mulch manufacturer's recommended tackifier.
 - Spray-apply slurry uniformly to all areas to be seeded in a one-step process. Apply slurry at a rate so that mulch component is deposited at not less than 1500-lb/acre (15.6-kg/92.9 sq. m) dry weight, and seed component is deposited at not less than the specified seed-sowing rate.
 - Spray-apply slurry uniformly to all areas to be seeded in a two-step process. Apply first slurry coat at a rate so that mulch component is deposited at not less than 500-lb/acre (5.2-kg/92.9 sq. m) dry weight, and seed component is deposited at not less than the specified seed-sowing rate. Apply slurry cover coat of fiber mulch (hydromulching) at a rate of 1000 lb/acre (10.4 kg/92.9 sq. m).

3.18 SODDING

- A. Lay sod within 24 hours of harvesting. Do not lay sod if dormant or if ground is frozen or muddy.
- B. Lay sod to form a solid mass with tightly fitted joints. Butt ends and sides of sod; do not stretch or overlap. Stagger sod strips or pads to offset joints in adjacent courses. Avoid damage to soil or sod during installation. Tamp and roll lightly to ensure contact with soil, eliminate air pockets, and form a smooth surface. Work sifted soil or fine sand into minor cracks between pieces of sod; remove excess to avoid smothering sod and adjacent grass.
- Lay sod across slopes exceeding 1:3.
 - Anchor sod on slopes exceeding 1:6 with bio-degradable stakes spaced as recommended by sod manufacturer but not less than two anchors per sod strip to prevent slippage.
- C. Saturate sod with fine water spray within two hours of planting. During first week after planting, water daily or more frequently as necessary to maintain moist soil to a minimum depth of 1-1/2 inches (38 mm) below sod.

3.19 PLUGGING

- A. Plant plugs in holes or furrows, at spacings indicated on the Drawings in triangular pattern. On slopes, contour furrows to near level.

3.20 TURF RENOVATION

- A. Renovate existing turf where indicated.
- B. Renovate turf damaged by Contractor's operations, such as storage of materials or equipment and movement of vehicles.
- Reestablish turf where settlement or washouts occur or where minor regrading is required.
 - Install new planting soil as required.
- C. Remove sod and vegetation from diseased or unsatisfactory turf areas; do not bury in soil.
- D. Remove topsoil containing foreign materials, such as oil drippings, fuel spills, stones, gravel, and other construction materials resulting from Contractor's operations, and replace with new planting soil.
- E. Mow, dethatch, core aerate, and rake existing turf.
- F. Remove weeds before seeding. Where weeds are extensive, apply selective herbicides as required. Do not use pre-emergence herbicides.
- G. Remove waste and foreign materials, including weeds, soil cores, grass, vegetation, and turf, and legally dispose of them off Owner's property.
- H. Till stripped, bare, and compacted areas thoroughly to a soil depth of 6 inches (150 mm).
- I. Apply soil amendments as required based on site-specific soil conditions and initial fertilizer required for establishing new turf and mix thoroughly into top 4 inches (100 mm) of existing soil. Install new planting soil to fill low spots and meet finish grades.
- Initial Fertilizer: Slow-release fertilizer applied according to manufacturer's recommendations.
- J. Apply seed and protect with straw mulch or sod (see Drawings) as required for new turf.
- K. Water newly planted areas and keep moist until new turf is established.

3.21 TURF MAINTENANCE

- A. General: Maintain and establish turf by watering, fertilizing, weeding, mowing, trimming, replanting, and performing other operations as required to establish healthy, viable turf. Roll, regrade, and replant bare or eroded areas and remulch to produce a uniformly smooth turf. Provide materials and installation the same as those used in the original installation.
- Fill in as necessary soil subsidence that may occur because of settling or other processes. Replace materials and turf damaged or lost in areas of subsidence.
 - In areas where mulch or blanket has been disturbed by wind or maintenance operations, add new mulch/blanket and anchor as required to prevent displacement.
 - Apply treatments as required to keep turf and soil free of pests and pathogens or disease. Use integrated pest management practices whenever possible to minimize the use of pesticides and reduce hazards.
- B. Watering:
- Schedule watering to prevent wilting, puddling, erosion, or other problems. Water newly planted areas or mulch, lay out temporary watering system to avoid walking over muddy or newly planted areas.
 - Water turf with fine spray at a minimum rate of 1 inch (25 mm) per week unless rainfall precipitation is adequate until Owner Acceptance.

C. Mow turf as soon as top growth is tall enough to cut. Repeat mowing to maintain specified height without cutting more than one-third of grass height. Remove no more than one-third of grass-leaf growth in initial or subsequent mowings. Do not delay mowing until grass blades bend over and become matted. Do not mow when grass is wet. Schedule initial and subsequent mowings to maintain proper grass height.

D. Turf Post-fertilization: Apply as noted in Materials Article, I. Fertilizer, based on season.

3.22 SATISFACTORY TURF

- A. Turf installations shall meet the following criteria as determined by Project Manager:
- Satisfactory Seeded Turf: At end of maintenance period, a healthy, uniform, close stand of grass has been established, free of weeds and surface irregularities, with coverage exceeding 90 percent over any 10 sq. ft. (0.92 sq. m) and bare spots not exceeding 5 by 5 inches (125 by 125 mm)
 - Satisfactory Sodded Turf: At end of maintenance period, a healthy, well-rooted, even-colored, viable turf has been established, free of weeds, open joints, bare areas, and surface irregularities.
- B. Use specified materials to reestablish turf that does not comply with requirements, and continue maintenance until turf is satisfactory.

3.23 PESTICIDE APPLICATION

- A. Apply pesticides and other chemical products and biological control agents according to requirements of authorities having jurisdiction and manufacturer's written recommendations. Coordinate applications with Owner's operations and others in proximity to the Work. Notify Owner before each application is performed.
- B. Pre-Emergent Herbicides (Selective and Nonselective): Apply to tree, shrub, and groundcover areas according to manufacturer's written recommendations. Apply to seeded areas to remove already-germinated weeds 2 weeks min. to seeding.
- C. Post-Emergent Herbicides (Selective and Nonselective): Apply only as necessary to treat newly germinated weeds and according to manufacturer's written recommendations.

3.24 FIELD QUALITY CONTROL

- A. When all the landscape work is completed, the Project Manager shall, upon seven (7) calendar days advance notice, make an inspection of the landscape work to determine if the work is complete. The Project Manager shall prepare a punch list of items improperly installed, inadequately sized or otherwise deficient based on the findings of his inspection. The punch list shall be completed not more than seven (7) working days after the field inspection. When the Contractor has remedied all deficiencies and completed all items on the punch list, the Contractor shall request another inspection by the Project Manager to determine whether the deficiencies have been adequately corrected. Once the punch list items have been corrected and re-inspected, the Project Manager shall issue a written certificate to the Owner who will then respond to the Contractor in writing formally accepting the work and beginning the warranty and guarantee period.
- B. Additional landscape inspections shall be conducted upon request by the Project Manager, to determine the condition of the work at the completion of the guarantee period.
- C. The required maintenance instructions shall be forwarded to the Owner's representative prior to the final acceptance to inform the Owner of any maintenance responsibilities that would be required for the project.

3.25 CLEANING AND PROTECTION

- A. During landscape work, store materials and equipment where directed.
- B. Keep pavements clean and work areas in an orderly condition.
- C. Promptly remove soil and debris created by turf work from paved areas. Clean wheels of vehicles before leaving site to avoid tracking soil onto roads, walks, or other paved areas. At the time of the final inspection of the work and before the issuance of Final Acceptance, all paved areas shall be thoroughly cleaned by the Contractor by sweeping, and washing. All construction equipment and excess materials shall have been removed and any debris or rubbish shall have been removed from the site.
- D. Protect landscape work from loss, damage, and deterioration during storage, installation, and maintenance periods.
- E. Remove surplus soil and waste material, including excess subsoil, unsuitable soil, trash, and debris, and legally dispose of them off Owner's property.
- F. Erect temporary fencing or barricades and warning signs as required to protect newly planted areas from traffic. Maintain fencing and barricades throughout initial maintenance period and remove after plantings are established.
- G. Protect from unauthorized persons (trespassers), as well as from operations by other Contractors and tradesmen and landscape operations.
- H. Remove non-degradable erosion-control measures after grass establishment period.

END OF SECTION 02920

EXHIBIT D

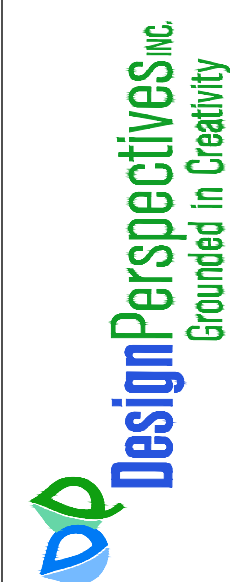

1167 Hobson Mill Drive
Naperville, Illinois 60540
Telephone: (630) 606-0776
www.design-perspectives.net

PRIMROSE SCHOOLS:
NAPERVILLE, IL

NAPERVILLE, IL 60565

25W710 75TH STREET

THESE DOCUMENTS CONTAIN INFORMATION PROPRIETARY TO ADA ARCHITECTS, INC. UNAUTHORIZED USE OF THESE DOCUMENTS IS EXPRESSLY PROHIBITED UNLESS AGREED UPON IN WRITING.

REVISIONS

#	DATE	TYPE
	07-19-2024	ZONING SUBMITTAL
	11-1-2024	CITY RE-SUBMITTAL
	12-16-2024	CITY RE-SUBMITTAL
	1-13-2025	CITY REVISIONS
	2-18-2025	CITY REVISIONS
	2-24-2025	CITY REVISIONS
	3-5-2025	CITY REVISIONS

LANDSCAPE SPECIFICATIONS

DATE 07/19/2024

JOB NO. 23529

LP-503

SHEET NO.

