

Parking Study

for



Islamic Center of Naperville

248th Avenue Campus

Naperville, Illinois

May 20, 2020

Revised July 15, 2021

Revised July 26, 2021

Intech Consultants, Inc.
1989 University Drive, Suite D
Lisle, Illinois 60532

PURPOSE OF THE STUDY

This parking study has been requested by the City of Naperville as a means of establishing the amount of parking that will likely be necessary for the new religious campus proposed by the Islamic Center of Naperville, to be located on the east side of 248th Avenue between 95th Street and 103rd Street in Naperville, Illinois.

Since the proposed campus will contain multiple uses (mosque, school, multi-purpose hall, and gymnasium), it was felt by the City of Naperville that a more in-depth analysis of the parking demands for this proposed site would be warranted rather than just a simple recitation of the zoning code requirements.

To this end, this report describes the project and its various land uses in some detail, outlines the zoning code requirements of the City, presents actual parking counts taken on various days during the week of January 20, 2020 at the other three ICN facilities in the area, and presents a series of projections of the likely parking demand at the new campus upon full build out.

DESCRIPTION OF PROJECT

The Islamic Center of Naperville (ICN) is the owner of a 13.63 acre site located on the east side of 248th Avenue between 95th and 103rd Streets in the City of Naperville, Illinois.

The Islamic Center desires to develop this site in accordance with their attached Master Plan to accommodate school, mosque, multi-purpose hall, and gymnasium uses. The site will be built in five (5) phases over the next 40 years, one phase for each of the uses.

Each of the intended uses and its operations are more fully described in the sections below.

Mosque (Phase I, Initial Construction 2020)

The mosque planned for the ICN campus is to be constructed in two phases. The initial Phase I construction will encompass the majority of the ultimate building, and many of the uses ultimately planned for this facility. The worship space in the mosque is planned to be enlarged as part of Phase V of the overall campus construction, and is more fully described in the Phase V narrative that follows.

The initial mosque construction proposed as part of Phase I is to be a two story building consisting of approximately 28,400 square feet which will initially provide worship space for 300 men and 157 women. It will also include space for offices, conference rooms, storage, multipurpose spaces, washrooms, and the like.

In addition to the times of worship, the mosque will also be used for the religious requirements of weddings, funerals, and special observances throughout the week as necessary.

The Islamic religion requires worship five times a day, seven days a week, not necessarily in a Mosque. The worship times are generally held before dawn, in the early afternoon, late afternoon, early evening, and late evening. Except for the Friday early afternoon services, attendance at prayer times is light, amounting to perhaps no more than 50-100 individuals at any one time. These prayer times are generally one hour or less.

Two prayer services are planned for Friday early afternoon between 12 PM and 3 PM, and are the most heavily attended services. Attendance at the first service in Phase 1 is expected to attract approximately 300 men and 150 women. The 2 PM service will have a somewhat smaller attendance.

In addition to the standard worship times, there will also be other services and activities held throughout the month-long observance of Ramadan. Ramadan occurs at different times each year, as the observance is based on the lunar calendar. Ramadan gatherings and prayers generally are held daily throughout the month after sunset (avg. 8 PM -12 AM) with attendance approximating that of Friday afternoon services for the first and last week, with reduced attendance in between.

School (Phase II, Initial Construction 2030)

The school will be a two story building consisting of approximately 41,749 square feet, and will contain 25 classrooms and space for support activities such as offices, storage, multipurpose room, mechanical spaces, staff lounge, nurse's office and the like.

The school is intended to provide full-time schooling for up to approximately 250 students from grades K-5. A preschool is also planned. Day care facilities are not proposed.

The school will operate during the normal school day on Monday through Friday as a full time school. On weekends, religious classes will be held between 9 AM – 2 PM on Saturday, with up to 500 children attending. On occasion, adult classes may also be held as need or demand dictates. These would occur mainly during evenings and weekends.

Multi-Purpose Hall (Phase III, Initial Construction 2040)

The Multi-Purpose Hall is a one story building consisting of approximately 22,226 square feet that will be used for conferences, interfaith events, and wedding receptions. The Hall will have a full-service kitchen and seating for 500. Use of the Hall is planned for Fridays – Sundays, with actual use depending on demand.

Gymnasium (Phase IV, Initial Construction 2050)

The gymnasium is a one story building consisting of approximately 25,595 square feet. It will provide the congregation with space for indoor physical activities including possible league play for volleyball, basketball, and badminton, "open gym" use times, and other uses such as Scouting activities. Use of the gymnasium will occur mostly in evenings and on weekends.

Mosque Expansion (Phase V, Initial Construction 2060)

The expansion of the mosque will enlarge the worship space of the facility by 3,265 square feet and increase the worship occupancy from the Phase I capacity of 300 men and 157 women to 461 men and 355 women.

TEMPORARY RIGHT-IN, RIGHT-OUT TO BE CONSTRUCTED WITH PHASE I. THIS DRIVE MAY BE CONVERTED TO FULL ACCESS BY THE CITY OF NAPERVILLE AS PART OF THE FUTURE PLANNED IMPROVEMENTS TO 248TH AVENUE.

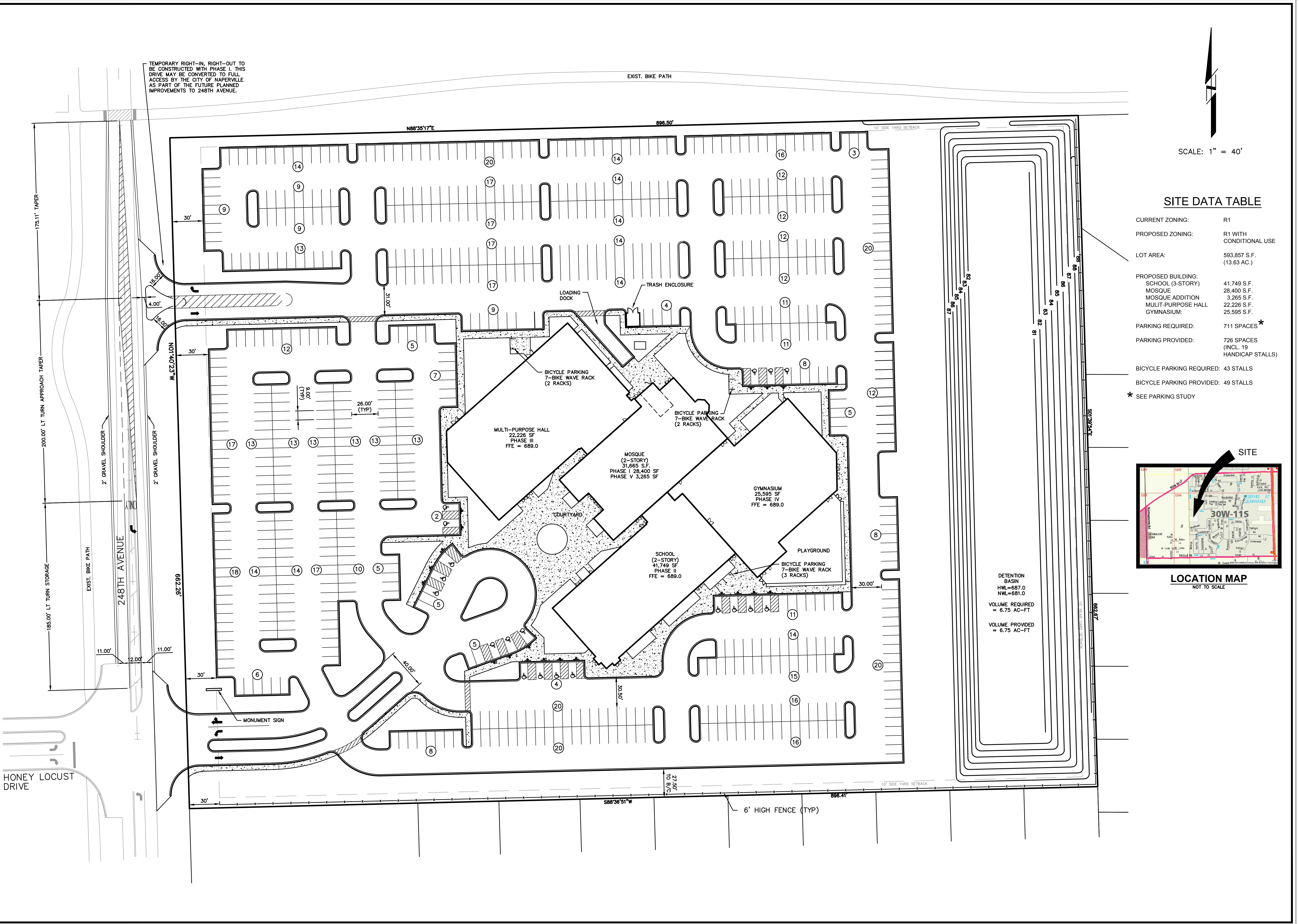

SCALE: 1" = 40'

SITE DATA TABLE

CURRENT ZONING:	R1
PROPOSED ZONING:	R1 WITH CONDITIONAL USE
LOT AREA:	593,857 S.F. (13.63 AC.)
PROPOSED BUILDING:	
SCHOOL (3-STORY)	41,749 S.F.
MOSQUE	28,400 S.F.
MOSQUE ADDITION	3,265 S.F.
MULTI-PURPOSE HALL	22,226 S.F.
GYMNASIUM:	25,595 S.F.
PARKING REQUIRED:	711 SPACES *
PARKING PROVIDED:	726 SPACES (INCL. 19 HANDICAP STALLS)
BICYCLE PARKING REQUIRED:	43 STALLS
BICYCLE PARKING PROVIDED:	49 STALLS

* SEE PARKING STUDY

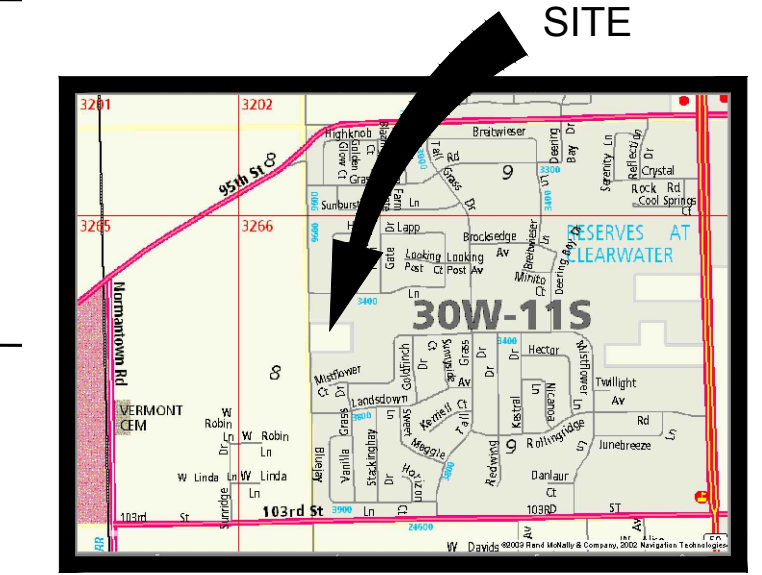

LOCATION MAP
NOT TO SCALE

DETENTION BASIN
HWL=687.0
NWL=681.0
VOLUME REQUIRED = 6.75 AC-FT
VOLUME PROVIDED = 6.75 AC-FT

7-28-21 4 PER CITY REVIEW
 7-28-21 3 PER CLIENT
 8-27-20 2 PER CITY REVIEW
 4-27-20 1 PER CLIENT REVIEW
 DATE NO. REVISION BY

INTECH CONSULTANTS, INC.
 1888 UNIVERSITY LANE, SUITE D ENGINEERS - SURVEYORS
 LISLE, ILLINOIS 60532
 ILLINOIS REGISTRATION NO. 184-007040
 PHONE: 630-964-5656

ISLAMIC CENTER OF NAPERVILLE
 ISLAMIC CENTER OF NAPERVILLE
 248TH AVENUE SITE
 NAPERVILLE, ILLINOIS

MASTER SITE PLAN

SCALE: 1"=40'
 DATE: 3-30-20
 DRAWN: BC
 DESIGNED: EFS
 PROJECT NO: **2011-016B**
 SHEET **1** OF **1**

M:\CAD Projects\2011\2011-016B\2011-016B PENG.dwg, MASTER SITE PLAN, 7/28/2021 11:17:38 AM, SJP

CITY OF NAPERVILLE PARKING REQUIREMENTS

Parking requirements as mandated by the City of Naperville's Municipal Code are dependent on upon the actual usage of proposed properties. Depending on the usage proposed, the required parking is arrived at by applying specified rates of parking required for each of the classifications of land and/or building usage that may be present in a particular project.

A detailed breakdown of the City's parking requirements as applied to the various uses contained in the enclosed Master Plan for the entire 248th Avenue campus that has been prepared by the project architect, Dome Structural Engineers, is included in this section of this report.

The City's requirements for the planned uses of the built-out campus generate a required total parking count of 726 cars, which is summarized as follows:

Phase I - Initial Mosque Construction	249 spaces required
Phase II – School	32 spaces required
Phase III – Multipurpose Hall	183 spaces required
Phase IV – Gymnasium	126 spaces required
Phase V – Mosque Expansion	<u>121 spaces required</u>
Total	711 spaces required

The Master Plan for the Islamic Center of Naperville's 248th Avenue campus totals 726 cars, and is therefore in compliance with the parking requirements of the City.

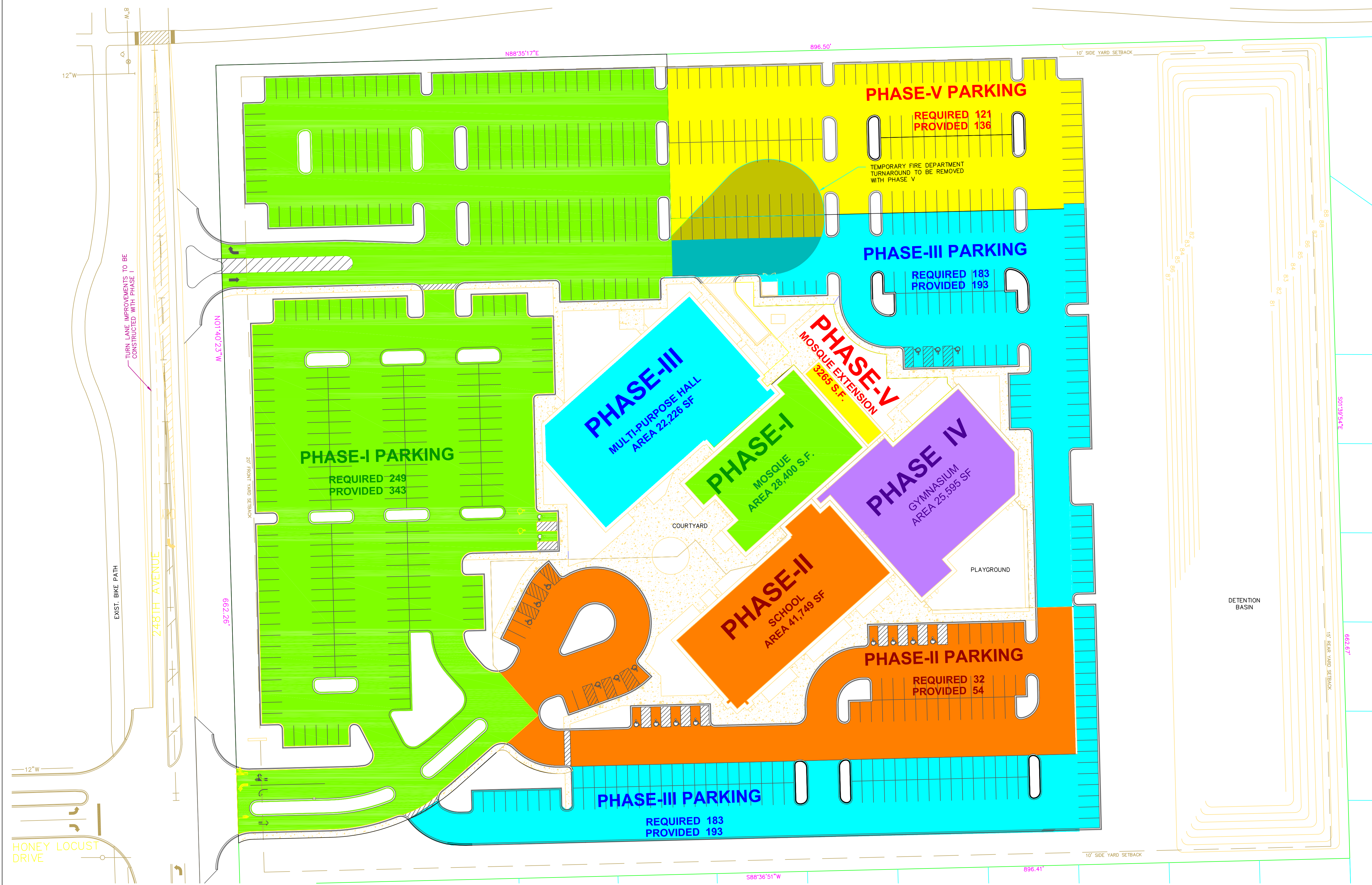

SCALE: 1" = 40'

I hereby certify that these drawings/documents were prepared under my direct supervision and to the best of my knowledge conform to the applicable building and zoning codes of the City of Naperville, State of IL.
 Jamshid Jahedi:
 Expires: 11/30/2021

REVISIONS:

DESCRIPTION	DATE

DESIGN: Jin Liu
 DRAW: Jin Liu
 CHECK: Jamshid Jahedi

DATE: 7/27/2021
 SCALE: 1"=40'
 FILE No: PC1706605-4

SHEET TITLE:
 MASTER SITE
 PHASING PLAN

SHEET No:
 PZC-1.0

PHASE-I
 MOSQUE AREA 28,400 S.F.

PARKING	REQUIRED	PROVIDED
PHASE I	249	343
TOTAL	249	343

PARKING	OCCUPANT	REQUIRED	CRITERIA
PRAYER HALLS (3,200SF) 75SF/OCCUPANT (NET)	457	153	1 SPACE/ 3 SEAT
ADMIN. 2890 SF (GROSS)	10	3.3	3.3 SPACE/ 1000 SF
BASEMENT(MULTI-PURPOSE FUTURE) 8197 SF(GROSS)		82	10 SPACE/ 1000 SF
FUTURE KITCHEN 203 SF	4 EMPLOYEE	4	1 SPACE/EMPLOYEE
TOTAL		249	

PHASE-II
 SCHOOL 41,749 SF

PARKING	REQUIRED	PROVIDED
PHASE II	32	54
TOTAL	281	397

PARKING	AREA	REQUIRED	CRITERIA
OFFICE	678 SF	3	3.3 SPACE/1000 SF
PRE SCHOOL	2941SF	5	2SPACE/1000 SF
ELEMENTARY/JUNIOR HIGH	22	22	1SPACE/EMPLOYEE
KITCHEN	263SF	2	1SPACE/EMPLOYEE
TOTAL		32	

PHASE-III
 MULTI-PURPOSE HALL 22,226 SF

PARKING	REQUIRED	PROVIDED
PHASE III	183	193
TOTAL	464	590

PARKING	AREA	REQUIRED	CRITERIA
FIRST FLOOR	17,768 SF	178	10 SPACE/1000 SF
BASEMENT	4,458 SF	5	1 SPACE/1000 SF
TOTAL	22,226 SF	183	

PHASE-IV
 GYMNASIUM 25,595 SF

PARKING	REQUIRED	PROVIDED
PHASE IV	126	0
TOTAL	590	590

PARKING	AREA	REQUIRED	CRITERIA
GYMNASIUM	24,889 SF	125	5 SPACE/1000 SF
STORAGE	706 SF	1	1 SPACE/1000 SF
TOTAL	25,595 SF	126	

PHASE-V
 MOSQUE EXPANSION 3,265 SF

PARKING	REQUIRED	PROVIDED
PHASE V	121	136
TOTAL	711	726

PARKING	OCCUPANT	REQUIRED	CRITERIA
PRAYER HALLS (2,513SF) 75SF/OCCUPANT (NET)	359	121	5 SPACE/ 3SEAT
TOTAL		121	

* Required parking for the worship space in the mosque per the Municipal Code is one stall per three worshippers. Includes the basement area per code.
 ** Actual parking needs for the worship space in the mosque during Friday services established by vehicle counts at other ICN facilities is one stall per 1.4 worshippers. Does not include the basement area since the basement area will not be used during Friday service

Note: Phase III parking includes the loss of 6 HC stalls and gain of 1 regular stall from Phase I, as well as a net increase of 16 stalls in the Phase I area when the temporary aisle is removed with Phase III construction, and a net gain of 1 stall when the temporary trash enclosure is moved to its permanent location during Phase III construction.

PARKING COUNTS AT OTHER ICN FACILITIES

The City of Naperville has requested that a series of parking counts be conducted at the other facilities of the Islamic Center of Naperville in the area.

The purpose of these counts is to determine the actual parking usage of these facilities so that the parking needs of the 248th Avenue campus can be projected based on actual usage elsewhere.

During the week of January 12-18, 2020, a series of counts were taken at ICN's three other locations:

- **Oleson Drive** – a converted single family residence with 19 parking spaces on site. Additional parking is accommodated on the streets in the adjacent residential areas.
- **75th Street** – a recently acquired site originally developed as a church with 140 parking spaces in the site's parking lot. Offsite parking is not available in the area.
- **Ogden Avenue** – a stand alone facility containing a mosque and gymnasium with 285 parking spaces in the site's parking lot. Offsite parking is also available in the commercial parking lot on the north side of Ogden Avenue.

The counts were taken at each site on Wednesday, Thursday, Friday, and Saturday of that week, at 8:00 AM, 10:00 AM, Noon, 1:00 PM, and 4:00 PM on each day. At the Ogden Avenue site, an additional count was taken at 2:00 PM on Friday to more accurately depict the actual usage of the site during the two worship services that occur at that location on Friday afternoons. Also, at each site counts were also taken not only on the individual sites, but also in the offsite areas mentioned above.

The counts that were obtained are displayed in the three tables contained in this section of the report.

For the majority of the time, the parking demand at each site was substantially less than the parking available on the site itself. However, on Friday afternoons during the most heavily attended worship time of the week, the parking demand was greater than the available site parking.

At the Oleson Drive site, once the onsite parking was filled the additional cars were double parked in the aisle in the lot, and on the streets in the adjacent residential areas. At the 75th Street site, the additional cars were double parked in the aisles in the lot. At the Ogden Avenue site, the additional cars were double parked in the aisle in the lot, and in the commercial parking lot on the north side of Ogden Avenue.

During the course of the counting of the cars at each of the sites, those individuals counting the cars made efforts to determine how many persons were in each vehicle. While it was not possible to conduct a comprehensive accounting of the occupants for each vehicle, it was clear that the majority of cars were occupied by a single person, especially during the peak Friday worship times. Of those cars where the number of occupants were observed, informal tallies averaged out to a vehicle occupancy rate of approximately 1.4 occupants per vehicle.

This occupancy rate differs markedly from the 3.0 rate assumed by the Naperville Municipal Code. Most such codes are based on experiences with other religions where the peak worship time is held on weekends when families have the opportunity to carpool to a great extent.

However, the peak worship time for the Islamic religion is held during the work week, and many of those attending services are coming from work, and will be returning to work after the services are over. As a result, a much greater number of individuals arrive by themselves, and the actual number of vehicles is greater than assumed by the Code.

In the next section of this report, the actual vehicle occupancy rate of 1.4 occupants per vehicle that was observed will be used to project the parking need during worship times for the proposed 248th Avenue campus.

Islamic Center of Naperville - Oleson Drive Site

Parking Counts - January 15, 16, 17, 18, 2020

Parking Facilities On Site = 19 spaces

Wednesday, January 15, 2020

<u>Time</u>	<u>On Site</u>	<u>Off Site</u>
8:00 AM	0	0
10:00 AM	2	0
Noon	3	0
1:00 PM	12	0
4:00 PM	0	0

Thursday, January 16, 2020

<u>Time</u>	<u>On Site</u>	<u>Off Site</u>
8:00 AM	0	0
10:00 AM	2	0
Noon	3	0
1:00 PM	10	0
4:00 PM	0	0

Friday, January 17, 2020

<u>Time</u>	<u>On Site</u>	<u>Off Site</u>
8:00 AM	0	0
10:00 AM	2	0
Noon	5	0
1:00 PM	22	117
4:00 PM	3	0

Saturday, January 18, 2020

<u>Time</u>	<u>On Site</u>	<u>Off Site</u>
8:00 AM	0	0
10:00 AM	0	0
Noon	0	0
1:00 PM	0	0
4:00 PM	0	0

Islamic Center of Naperville - 75th Street Site

Parking Counts - January 15, 16, 17, 18, 2020

Parking Facilities On Site = 140 spaces

Wednesday, January 15, 2020

<u>Time</u>	<u>On Site</u>	<u>Off Site</u>
8:00 AM	1	0
10:00 AM	4	0
Noon	3	0
1:00 PM	3	0
4:00 PM	2	0

Thursday, January 16, 2020

<u>Time</u>	<u>On Site</u>	<u>Off Site</u>
8:00 AM	1	0
10:00 AM	4	0
Noon	7	0
1:00 PM	4	0
4:00 PM	5	0

Friday, January 17, 2020

<u>Time</u>	<u>On Site</u>	<u>Off Site</u>
8:00 AM	3	0
10:00 AM	3	0
Noon	153	0
1:00 PM	21	0
4:00 PM	4	0

Saturday, January 18, 2020

<u>Time</u>	<u>On Site</u>	<u>Off Site</u>
8:00 AM	1	0
10:00 AM	2	0
Noon	1	0
1:00 PM	1	0
4:00 PM	2	0

Islamic Center of Naperville - Ogden Ave. Site

Parking Counts - January 15, 16, 17, 18, 2020

Parking Facilities On Site = 285 spaces

Wednesday, January 15, 2020

<u>Time</u>	<u>Cars in Lot</u>	<u>Offsite</u>
8:00 AM	12	0
10:00 AM	16	0
Noon	17	0
1:00 PM	56	0
4:00 PM	9	0

Thursday, January 16, 2020

<u>Time</u>	<u>Cars in Lot</u>	<u>Offsite</u>
8:00 AM	12	0
10:00 AM	17	0
Noon	34	0
1:00 PM	76	0
4:00 PM	10	0

Friday, January 17, 2020

<u>Time</u>	<u>Cars in Lot</u>	<u>Offsite</u>
8:00 AM	11	0
10:00 AM	36	0
Noon	333	15
1:00 PM	382	27
2:00 PM	65	0
4:00 PM	10	0

Saturday, January 18, 2020

<u>Time</u>	<u>Cars in Lot</u>	<u>Offsite</u>
8:00 AM	26	0
10:00 AM	5	0
Noon	5	0
1:00 PM	36	0
4:00 PM	6	0

PHASED PARKING PROJECTIONS FOR NEW 248TH AVENUE CAMPUS

It was seen in an earlier section of this report that when fully developed, the proposed parking for the Islamic Center of Naperville's new religious campus on 248th Avenue fully meets the parking requirements of the City of Naperville's Municipal Code.

It has also been determined through the parking counts obtained at the Islamic Center of Naperville's other three facilities in the area that each of these facilities has a high parking demand during the peak Friday worship times, primarily due to a low vehicle occupancy rate.

Since the campus will be constructed in five (5) separate phases over time, it is important to ensure that adequate parking is provided during all of the phases of development, and that the parking not only meets the Code requirements, but also the actual needs.

As noted earlier, the phasing of the campus is planned to occur as follows:

Phase I - Initial Mosque Construction

Phase II – School

Phase III – Multipurpose Hall

Phase IV – Gymnasium

Phase V – Mosque Expansion

The Islamic Center of Naperville and their design team has carefully considered numerous ways of phasing the project, and developed the attached Phasing Plan to guide the future development of the overall campus. Numerous factors were considered during the planning, with the foremost being to ensure that adequate parking would be available at all times.

Not only would each phase have to meet the code parking requirements, but the parking for the peak worship times would have to meet or exceed the necessary parking as established by the vehicle occupancy rate arrived as a result of the parking count survey conducted at the other ICN facilities in the area.

The parking to be provided in each Phase is summarized in the following chart. In each Phase, the parking to be provided not only meets the Naperville code requirements, it also meets the parking needs for the peak worship times using the vehicle occupancy rate.

ISLAMIC CENTER OF NAPERVILLE

PARKING BY PHASES

	<u>PHASE I</u>		<u>PHASE II</u>		<u>PHASE III</u>		<u>PHASE IV</u>		<u>PHASE V</u>		
	REQUIRED BY CODE*	NEEDED BY USE**	PARKING PROVIDED***	REQUIRED BY CODE	PARKING PROVIDED	REQUIRED BY CODE	PARKING PROVIDED	REQUIRED BY CODE	PARKING PROVIDED	REQUIRED BY CODE	PARKING PROVIDED
BASE MOSQUE	249	336	343	249	343	249	343	249	343	249	343
SCHOOL				32	54	32	54	32	54	32	54
MULT-PURPOSE HALL						183	193	183	193	183	193
GYMNASIUM								126	0	126	0
MOSQUE EXPANSION											
CUMULATIVE TOTALS	249	336	343	281	397	464	590	590	590	711	726

TOTAL PARKING AVAILABLE 726

* Required parking for the worship space in the mosque per the Municipal Code is one stall per three worshippers. Includes the basement area per code.

** Actual parking needs for the worship space in the mosque during Friday services established by vehicle counts at other ICN facilities is one stall per 1.4 worshippers. Does not include the basement area since the basement area will not be used during Friday services.

Note: Phase III parking includes the loss of 6 HC stalls and gain of 1 regular stall from Phase I, as well as a net increase of 16 stalls in the Phase I area when the temporary aisle is removed with Phase III construction, and a net gain of 1 stall when the temporary trash enclosure is moved to its permanent location during Phase III construction.

For example, in Phase I the parking required by the Municipal Code totals 249 stalls. However, based on the planned 457 parishioners (300 men and 157 women) and a vehicle occupancy rate of 1.4, the needed parking for the peak worship periods on Friday afternoons amounts to 326 parking spaces. Phase I is providing 343 parking spaces, and therefore should be considered adequate.

It should be noted that only some, but not all, of the various uses at this campus will occur concurrently, which will be discussed in the next section of this report. As a result, in addition to the required parking for each of the different uses within the campus, when a use is active it will have the benefit of being able to also use the parking for the other uses that are not active at that time. As a result, the parking that will be provided at any time will be more than adequate to handle the parking demand.

Friday afternoon worship generates by far the greatest parking demand. However, since none of the other uses are allowed to be active during the Friday services, there will be far more parking than is necessary to meet the demand. Even after buildout when the mosque expansion has increased the worship space to a capacity of 816 persons (461 men, 355 women), the parking that is needed based on the vehicle occupancy rate will be 583 cars, which is significantly less than the 726 spaces that will be present on the campus.

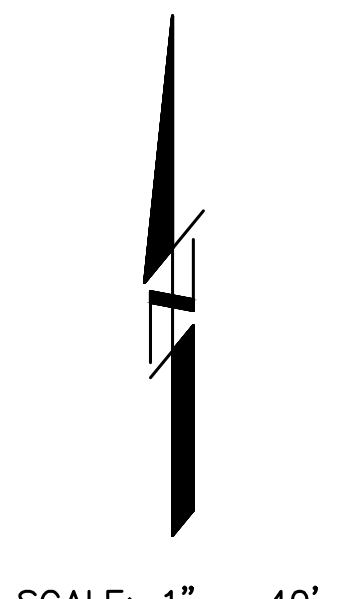
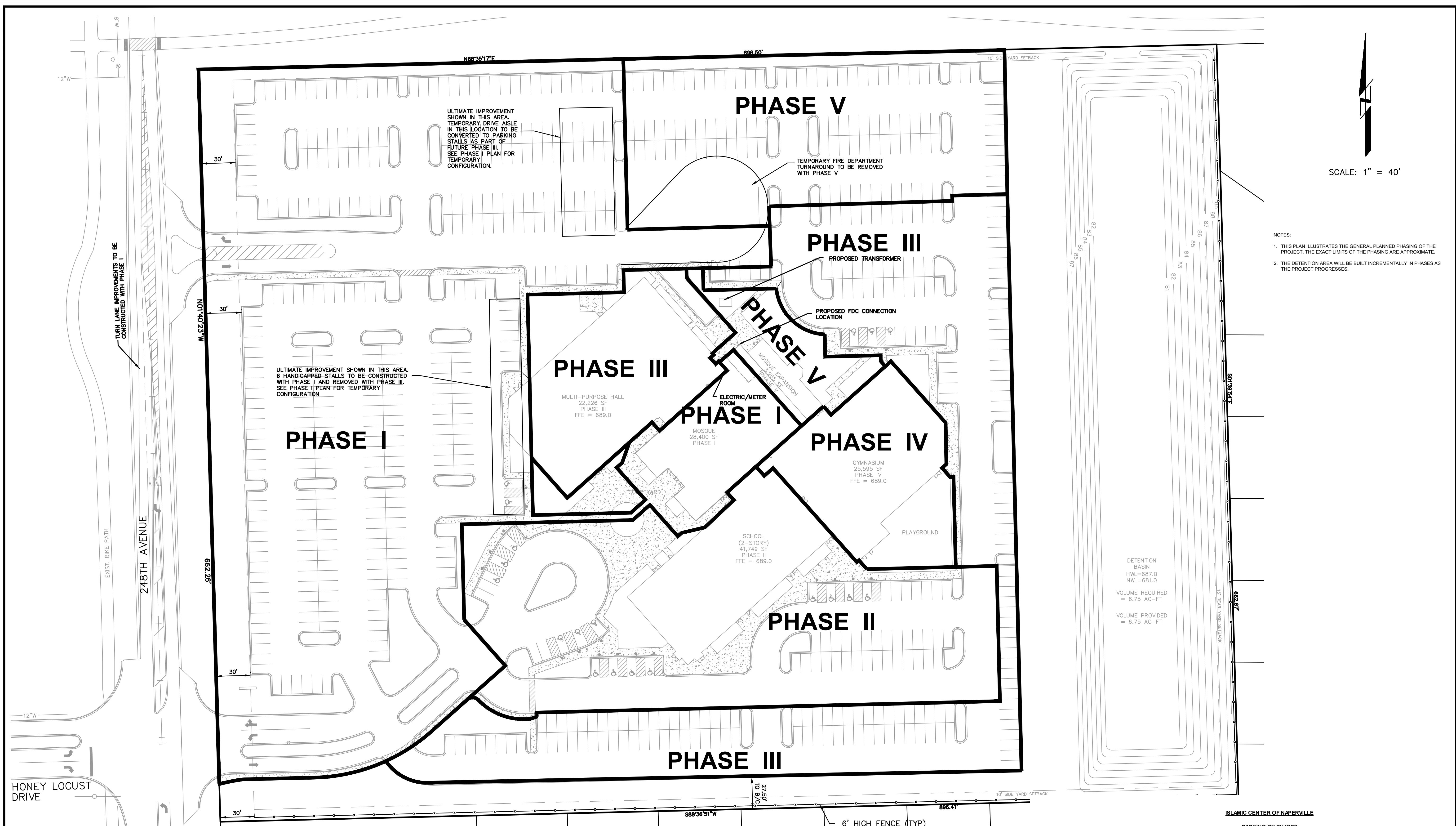

- NOTES:
1. THIS PLAN ILLUSTRATES THE GENERAL PLANNED PHASING OF THE PROJECT. THE EXACT LIMITS OF THE PHASING ARE APPROXIMATE.
 2. THE DETENTION AREA WILL BE BUILT INCREMENTALLY IN PHASES AS THE PROJECT PROGRESSES.

DETENTION BASIN
 HWL=687.0
 NWL=681.0
 VOLUME REQUIRED
 = 6.75 AC-FT
 VOLUME PROVIDED
 = 6.75 AC-FT

ISLAMIC CENTER OF NAPERVILLE
 PARKING BY PHASES

	PHASE I			PHASE II		PHASE III		PHASE IV		PHASE V	
	REQUIRED BY CODE*	NEEDED BY USE**	PARKING PROVIDED**	REQUIRED BY CODE	PROVIDED	REQUIRED BY CODE	PROVIDED	REQUIRED BY CODE	PROVIDED	REQUIRED BY CODE	PROVIDED
BASE MOSQUE	249	336	343	249	343	249	343	249	343	249	343
SCHOOL				32	54	32	54	32	54	32	54
MULTI-PURPOSE HALL						183	193	183	193	183	193
GYMNASIUM								126	0	126	0
MOSQUE EXPANSION										121	136
CUMULATIVE TOTALS	249	336	343	281	397	464	590	590	590	711	726

TOTAL PARKING AVAILABLE 726

* Required parking for the worship space in the mosque per the Municipal Code is one stall per three worshippers. Includes the basement area per code.
 ** Actual parking needs for the worship space in the mosque during Friday services established by vehicle counts at other ICN facilities is one stall per 1.4 worshippers. Does not include the basement area since the basement area will not be used during Friday services.
 Note: Phase III parking includes the loss of 6 HC stalls and gain of 1 regular stall from Phase I, as well as a net increase of 16 stalls in the Phase I area when the temporary aisle is removed with Phase III construction, and a net gain of 1 stall when the temporary trash enclosure is moved to its permanent location during Phase III construction.

PHASING PLAN

ISLAMIC CENTER OF NAPERVILLE
 248TH AVENUE SITE
 NAPERVILLE, ILLINOIS

INTECH CONSULTANTS, INC.
 1889 UNIVERSITY LANE, SUITE D
 LISLE, ILLINOIS 60532
 PHONE: 630-964-5656

SCALE: 1"=40'
 DATE: 3-30-20
 DRAWN: BC
 DESIGNED: EFS
 PROJECT NO: 2011-016B
 SHEET: 1 OF 1

DATE	NO.	BY
7-26-21	5	PER CITY REVIEW
11-30-20	3	PER CITY REVIEW
8-27-20	2	PER CITY REVIEW
4-27-20	1	PER CLIENT REVIEW

M:\CAD Projects\2011\016B\2011-016B PHASING PLAN.dwg, PHASE 1, 7/26/2021, 11:20:52 AM, SJP

Projected Actual Campus Parking Usage

Earlier in this report, it was seen that the total parking that is to be provided for each of the land uses within the campus at ultimate buildout as well as during each of the planned five (5) Phases of construction will meet the parking requirements of the City of Naperville.

In addition, the parking to be provided will meet the actual parking needs during peak Friday worship times using the vehicle occupancy rate that was determined as part of the parking counts that were taken at the other ICN facilities in the area.

However, these analyses only address the requirements and needs at peak times. They do not provide any insight as to when the various uses within the campus will actually be used, and what the likely parking loads will be under those circumstances.

To illustrate this, ICN and their design team mapped out the planned times and expected utilization of each of the buildings not only during normal weekly operations, but also during the month of Ramadan, when the timing of usages differs from the other 11 months of the year.

Because the expected use of the facilities varies throughout the week and is also different during Ramadan, it was found that there are eight different usage patterns that will occur. These are as follows:

- Monday – Thursday, Non Ramadan Weeks
- Monday – Thursday, Ramadan Weeks
- Friday, Non Ramadan Weeks
- Friday, Ramadan Weeks
- Saturday, Non Ramadan Weeks
- Saturday, Ramadan Weeks
- Sunday, Non Ramadan Weeks
- Sunday, Ramadan Weeks

The projected campus usage of the parking facilities is presented in the tables that follow. Several things can be seen clearly when examining these tables:

1. While several uses are planned to potentially occur concurrently, the attendance levels are such that the parking facilities are vacant much of the time.
2. Because the other uses are not allowed to operate during the peak worship times on Friday afternoons, there will be more than adequate parking at all times for the peak worship traffic.
3. Even if it was decided to expand the operations of the school, multipurpose hall, or the gymnasium, there would still be more than adequate parking available at all times for those expanded operations.

**Islamic Center of Naperville
Site Use and Parking Projections**

Monday - Thursday, Non-Ramadan Weeks

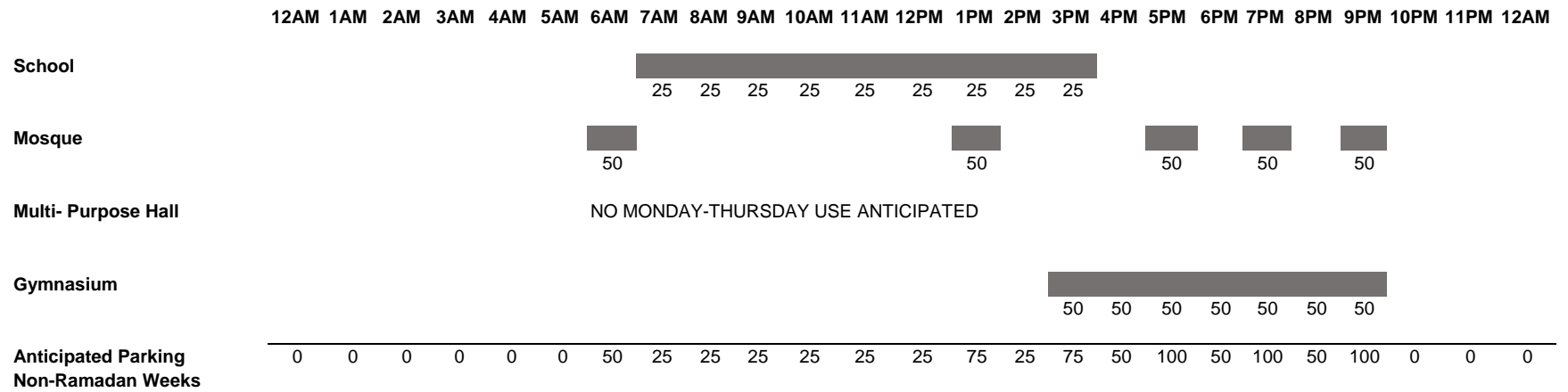

Usage times and anticipated number of vehicles provided by ICN.

**Islamic Center of Naperville
Site Use and Parking Projections**

Monday - Thursday, Ramadan Weeks

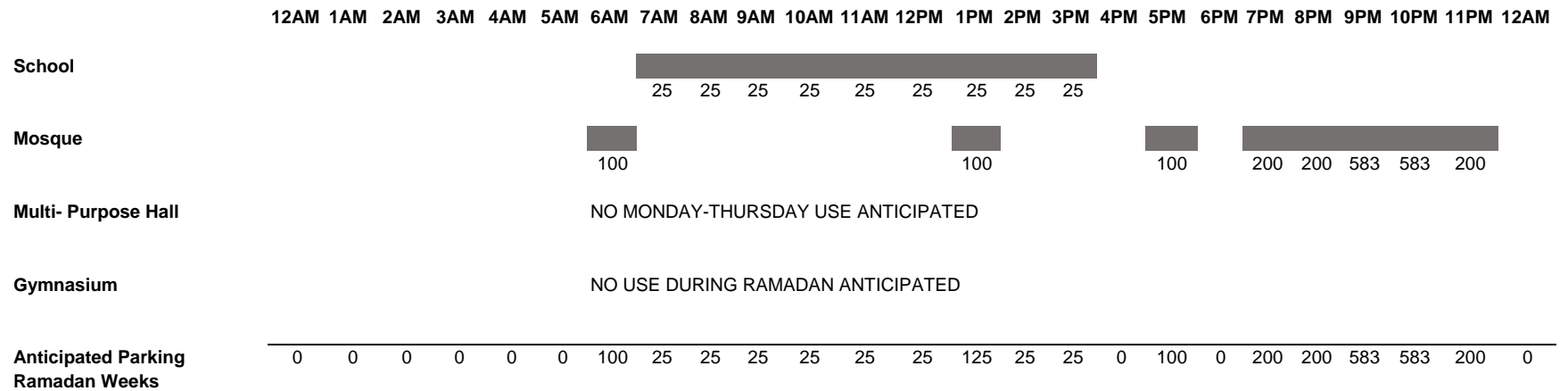

1. Usage times and anticipated number of vehicles provided by ICN.
2. Numbers shown for the mosque include both Phase I and Phase V usage for the first week and last week of Ramadan.

**Islamic Center of Naperville
Site Use and Parking Projections**

Friday, Non-Ramadan Weeks

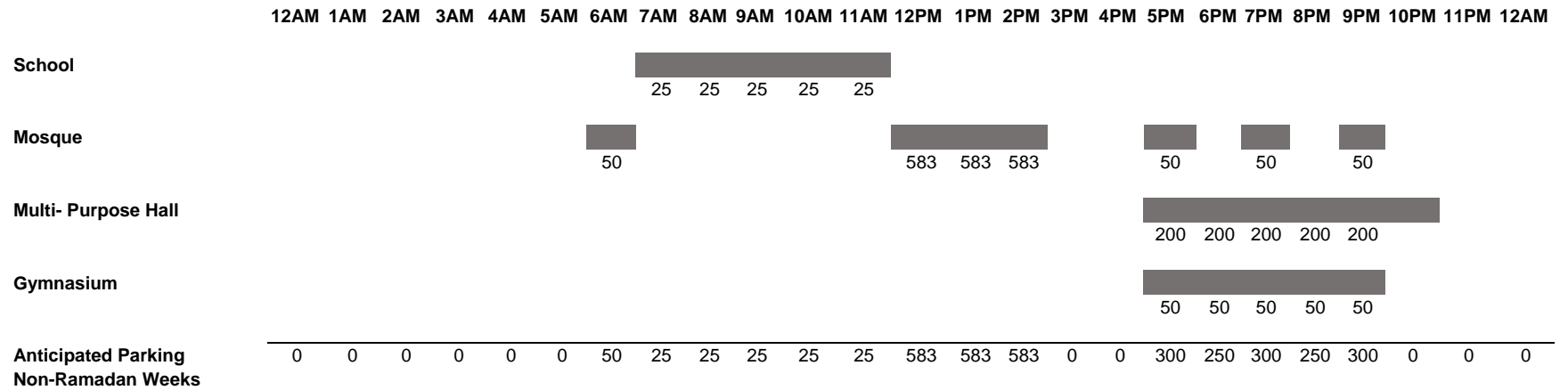

1. Usage times and anticipated number of vehicles provided by ICN.

**Islamic Center of Naperville
Site Use and Parking Projections**

Friday, Ramadan Weeks

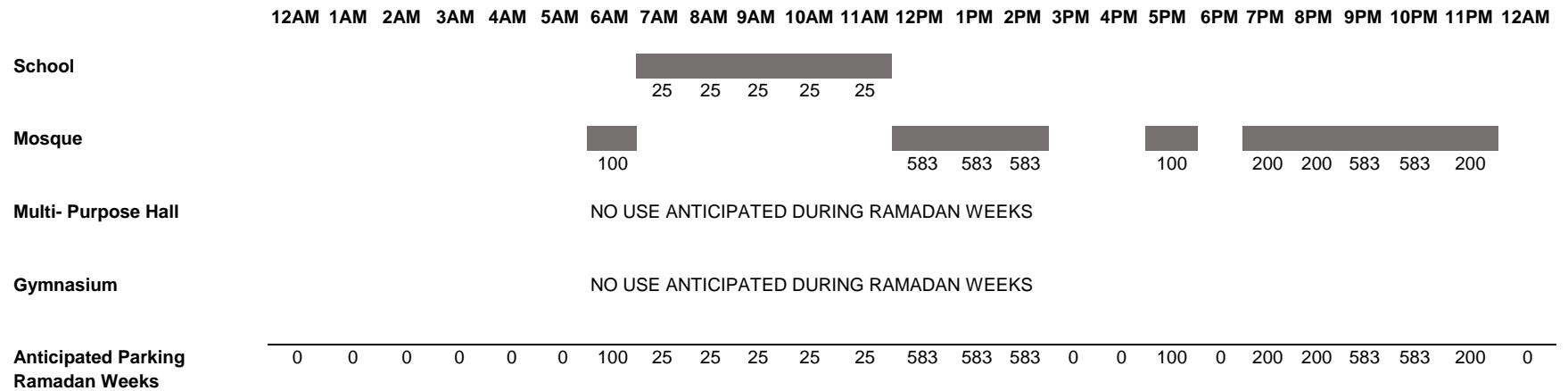

1. Usage times and anticipated number of vehicles provided by ICN.
2. Numbers shown for the mosque include both Phase I and Phase V usage for the first week and last week of Ramadan.

**Islamic Center of Naperville
Site Use and Parking Projections**

Saturday, Non-Ramadan Weeks

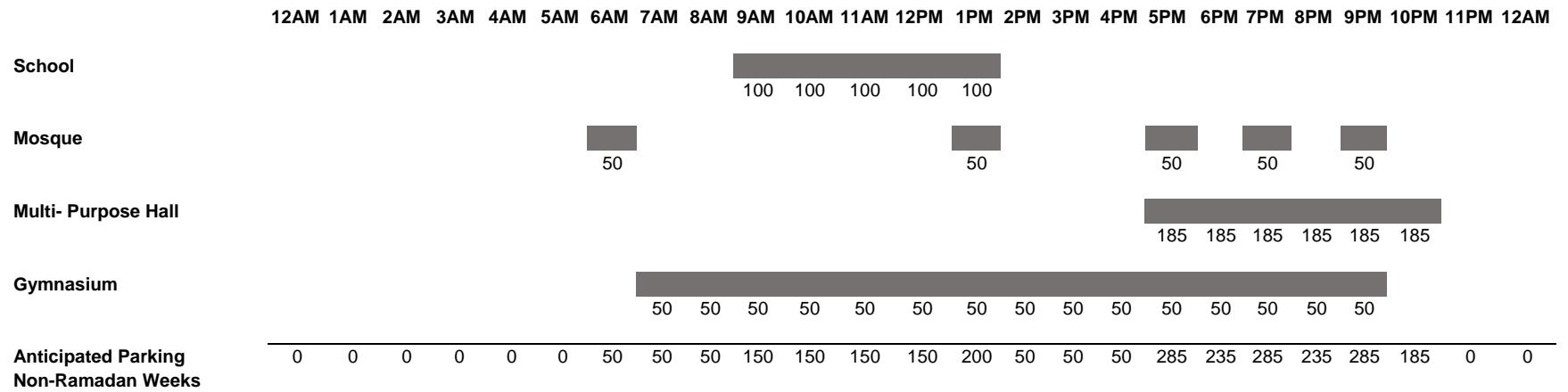

Usage times and anticipated number of vehicles provided by ICN.

**Islamic Center of Naperville
Site Use and Parking Projections**

Saturday, Ramadan Weeks

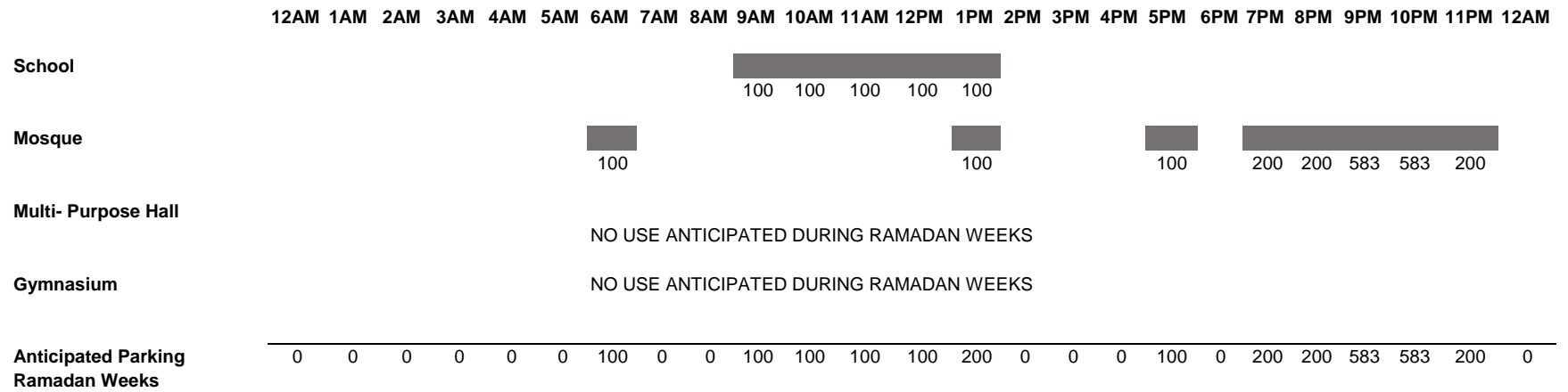

1. Usage times and anticipated number of vehicles provided by ICN.
2. Numbers shown for the mosque include both Phase I and Phase V usage for the first week and last week of Ramadan.

**Islamic Center of Naperville
Site Use and Parking Projections**

Sunday, Non-Ramadan Weeks

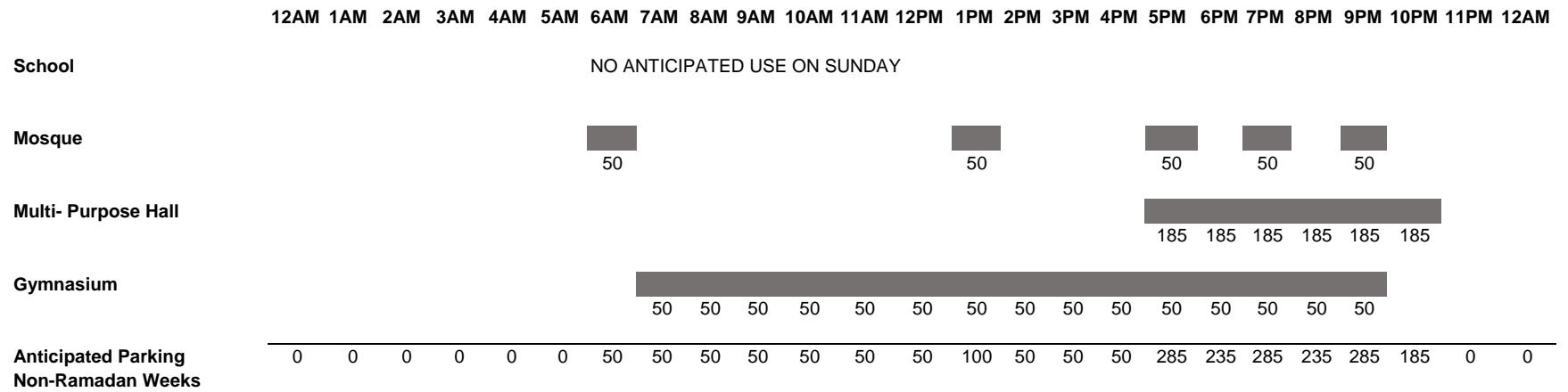

Usage times and anticipated number of vehicles provided by ICN.

**Islamic Center of Naperville
Site Use and Parking Projections**

Sunday, Ramadan Weeks

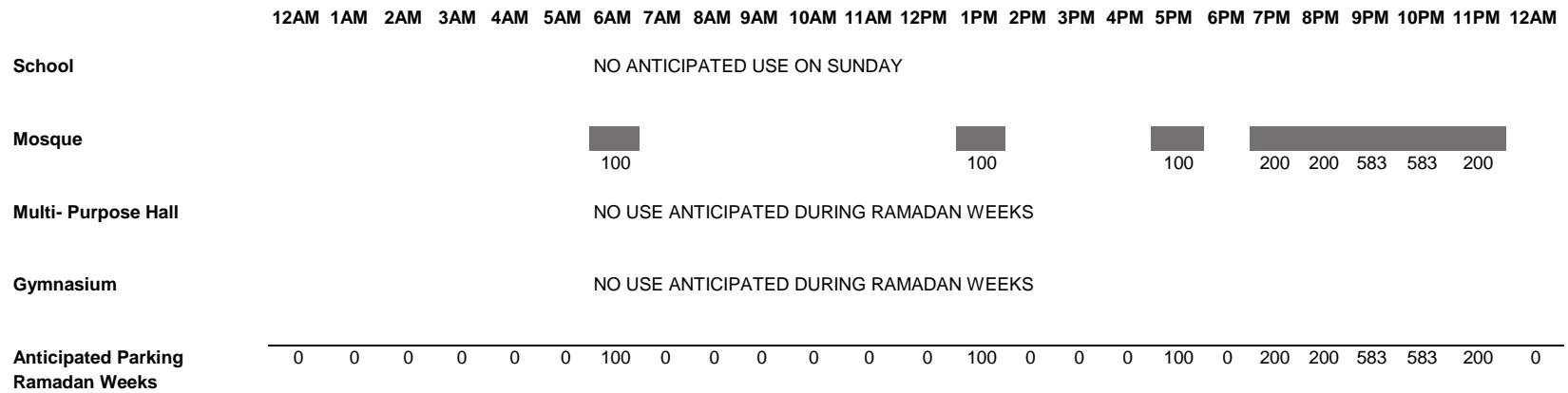

1. Usage times and anticipated number of vehicles provided by ICN.
2. Numbers shown for the mosque include both Phase I and Phase V usage for the first week and last week of Ramadan.

CONCLUSIONS

The Islamic Center desires to develop this site in accordance with their Master Plan to accommodate school, mosque, multi-purpose hall, and gymnasium uses. The site will be built in five (5) phases over the next 40 years, one phase for each of the uses plus a future expansion of the mosque.

Each of these uses is substantial, and will need to accommodate the necessary parking for those that will participate in the many activities that are planned.

In this report, it has been shown that:

- The parking being provided for the campus meets or exceeds the requirements of the City of Naperville's Municipal Code, not only at the time of ultimate buildout, but at all stages of the phased construction that is planned.
- The parking that is to be provided during peak worship times on Fridays is in excess of what is to be expected using the lower vehicle occupancy rates identified as part of the parking counts taken at the other three ICN facilities in the area.
- While concurrent usage of some of the facilities is planned to occur, the anticipated parking needs are far less than the parking that will be available.
- If it was decided in the future to expand the operations of the school, multipurpose hall, or the gymnasium, there would still be more than adequate parking available at all times for those expanded operations, since they cannot occur during the peak worship periods on Friday afternoons.

Given the above, it is apparent that the parking that will be provided for the Islamic Center of Naperville's new religious campus on 248th Avenue will be more than adequate to accommodate all of the uses and the activities that are planned.