

Riverwoods Daycare Center

Parcel F - River Road
Naperville, Illinois

sheet description:

Final Landscape Plan

owner:

BHC Construction LLC
640 N. River Road Suite 106
Naperville, IL 60563



north: scale: 1" = 20' 0"



revisions:	original issue date:
9.24.2024	Engineer Site Plan Rev. Per City Comments
8.30.2024	Per City Review Comments dated 7.22.2024

original issue date: **31 May 2024**

drawn by:

checked by:

project no.: **24003**

sheet no.:

L.100

Plant & Material List :

Code	Scientific Name	Common Name	Size	Qty	Remarks
SHADE TREES					
ARP	Acer rubrum 'Frank Jr.'	Red Pointe Maple	2.5"	1	B & B
COC	Celtis occidentalis 'Chicagoland'	Chicagoland Hackberry	2.5"	2	B & B
GD	Gymnocladus dioica	Kentucky Coffeetree	2.5"	2	B & B
TSB	Taxodium distichum 'Shawnee Brave'	Shawnee Brave Baldcypress	2.5"	2	B & B
EVERGREEN TREES					
TOM	Thuja occidentalis 'Mission'	Mission Arborvitae	6'	5	B & B, Multi-Stem
ORNAMENTAL TREES					
ASG	Amelanchier x grandiflora	Apple Serviceberry	6'	4	B & B, Multi-Stem
CRB	Cercis canadensis	Eastern Redbud	6'	3	B & B, Multi-Stem
EVERGREEN SHRUBS					
BGV	Buxus microphylla 'Green Velvet'	Green Velvet Boxwood	18"	5	5 Gallon Container
JKC	Juniperus chinensis 'Kallays Compacta'	Kallay's Compact Juniper	18"	13	5 Gallon Container
TMD	Taxus x media 'Densiformis'	Dense Yew	24"	7	B & B
ORNAMENTAL SHRUBS					
VDC	Viburnum dentatum 'Christorn'	Viburnum Blue Muffin	30"	16	5 Gallon Container
HAA	Hydrangea arborescens 'Annabelle'	Annabelle Hydrangea	24"	12	3 Gallon Container
HLQF	Hydrangea paniculata 'Little Quick Fire'	Little Quick Fire Hydrangea	18"	5	3 Gallon Container
HPL	Hydrangea paniculata 'Limelight'	Limelight Hydrangea	30"	5	3 Gallon Container
HQRS	Hydrangea 'Ruby Slippers'	Ruby Slippers Oakleaf Hydrangea	18"	4	3 Gallon Container
SGM	Spiraea japonica 'Goldmound'	Goldmound Spirea	18"	18	3 Gallon Container
SMK	Syringa patula 'Miss Kim'	Miss Kim Lilac	24"	17	5 Gallon Container
PERENNIALS & ORNAMENTAL GRASSES					
CKF	Calamagrostis acutiflora 'Karl Forester'	Karl Forester Feather Reed Grass	1 G	37	Container
HAG	Hakonechloa macra 'All Gold'	Gold Jap. Forest Grass	1 G	46	Container
HGS	Hosta 'Gold Standard'	Gold Standard Hosta	1 G	36	Container
HIP	Helleborus 'Walhellvor'	Ivory Prince Hellebors	1 G	36	Container
HSP	Hosta s. pinnatifida	Pinnatifid Hosta	1 G	36	Container
PAH	Phlox subulata 'Hemlin'	Dwarf Fountain Grass	1 G	72	Container
SGH	Sesleria 'Greenlee Hybrid'	Greenlee Aut. Moor Grass	1 G	48	Container

Construction Notes :

- Sod all turf areas as noted with an approved blend of improved Kentucky Bluegrass Sod with a mineral soil back.
- Drill seed all remaining turf areas as noted and cover with an S-75 Straw Erosion Control Blanket and staple in place. Seed shall be applied at a rate of 200 lbs. per Acre./300 lbs. per Acre for Detention mix
Lawn seed mix shall be as follows:
70% Improved, Kentucky Bluegrass (minimum three varieties)
20% Improved, Perennial Ryegrass (minimum two varieties with endophytes)
10% Creeping Red Fescue
- Fine grading shall provide slopes which are smooth and continuous. Positive drainage shall be provided in all areas.
- Prior to turf installation all areas shall be fertilized with a 12-12-12 granular fertilizer at a rate of 400 lbs. per Acre.
- Prepare perennial, ornamental grass, groundcover and annual flower beds with 1 CY. mushroom compost per 100 SF. retolled to an 8" depth.
- Mulch all trees, shrub, perennial & orn'l grass beds with a minimum of three inches shredded hardwood bark mulch.
- Mulch all groundcover and annual beds with minimum of one inch pinebark fines.
- All bed lines and tree saucers require a 4" deep spaded edge between lawn and mulch areas.
- All evergreen (conifers) trees and shrubs must be grown in a natural shape - and not sheared.
- Plant material sizing, branching and ball sizes shall conform to the "American Standards for Nursery Stock" (latest edition) by the American Association of Nurserymen, Inc.
- Plant material shall be nursery grown and be either balled and burlapped or container grown. Sizes and spreads on plant list represent minimum requirements.
- Quantity lists are supplied as a convenience. Contractor shall verify all quantities, and in case of a discrepancy, the plan shall prevail.
- The Landscape Contractor shall adjust plant locations in field to maintain appropriate spacing from fire hydrants, light poles, all utility structures, driveways and sidewalks. Approval of the Landscape Architect is required when field adjustments to be implemented do not conform to the intent of the plans.
- Contractor shall report any discrepancies in the field to the Landscape Architect and/or Owner.
- The Landscape Contractor shall verify locations of all underground utilities prior to digging, is required to Contact J.U.L.I.E. (1.800.892.0123), and any other public or private agency necessary for utility location 48 hours prior to construction.
- Where underground utilities exist, all field adjustments must be approved by the landscape architect.
- The Landscape Contractor shall water plant material, seed and sod areas until the plants have become adequately established and until final acceptance by the owner. Owner to provide all supplemental watering and proper care and maintenance of all plant materials, seed and sod areas after acceptance of Landscape Contractors work.
- No plants are to be changed or substituted without the approval of the Landscape Architect and the City of Naperville.
- Landscape Contractor shall warrantee all material and labor for a period of one year from the date of final acceptance and shall repair any defects and replace all dead plant material as required during the warranty period.
- Trees shall be set back a minimum of ten (10) feet horizontally from utility structures, including, but not limited to, manholes, valve vaults, valve boxes, fire hydrants, transformers and switch cans. Trees shall be set back a minimum of five (5) feet horizontally from sanitary sewer, water services and underground electric cable. Approval of the Landscape Architect is required when field adjustments to be implemented do not conform to the intent of the plans.
- Parkway Trees must be offset 5 feet from all storm sewer.
- No trees, shrubs or obstacles will be allowed 10' in front, 5' on the sides, and 7' to the rear of the electrical transformer.

- No trees or shrubs will be planted within 2' of underground electric conductors.

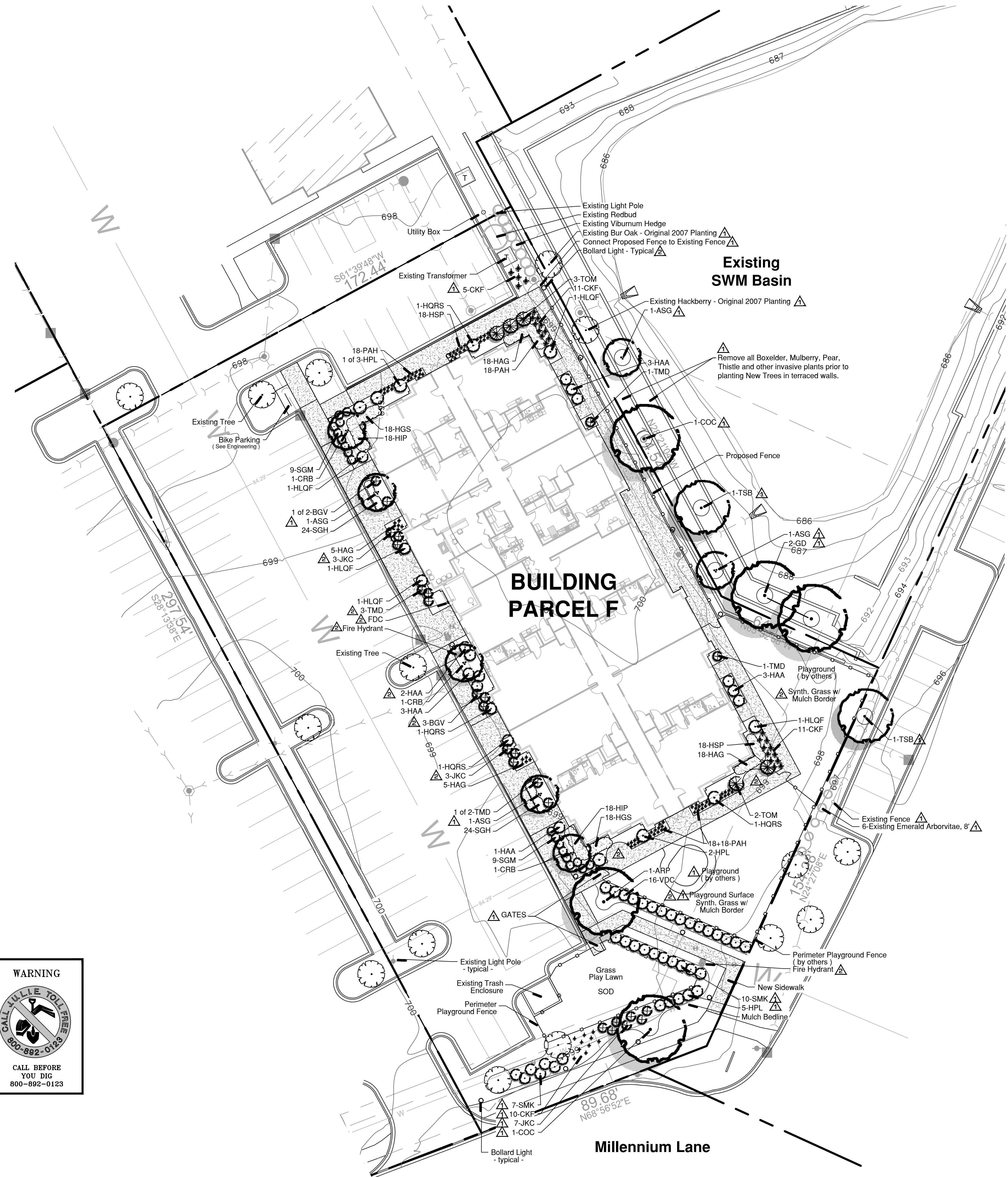
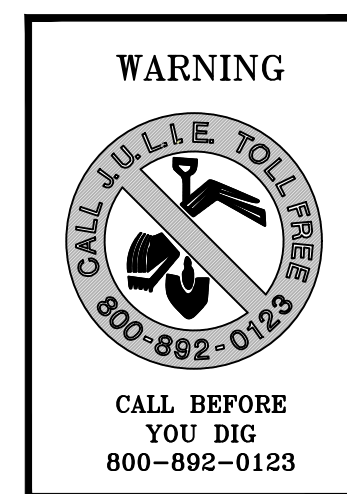

Tree Inventory Data Table :

Tag #	Common Name	Size	Cond.	Comments	S/R
176	Hybrid Elm	15	Excellent		S
177	Hybrid Elm	14	Good		S
178	Hybrid Elm	14	Good		S
179	Hackberry	6	Fair		S
180	Swamp White Oak	9	Excellent		R
181	Swamp White Oak	6	Fair		R
182	Callery Pear	14	Poor	off-site, Hazard	R
183	Sugar Maple	10	Good		S
184	Upright Juniper	10'	Fair		S
185	River Birch	10'	Fair		R
186	Blue Spruce	15'	Good		R
187	Blue Spruce	12'	Good		R
188	Autumn Blaze Maple	6	Good		S

Legend :

- Existing Tree - not Surveyed
- Existing Tree w/ Tag #
- Existing Tree to be Preserved
- Existing Tree to be Removed
- Tree Preservation Fencing

Condition Rating Key :

Rating	Description	General Criteria
5	Excellent	The tree is typical of the species, has less than 10% deadwood in the crown that is attributable to normal causes, has no other observed problems, and requires no remedial action
4	Good	The tree is typical of the species and / or has less than 20% deadwood in the crown, only 1 or 2 minor problems that are easily corrected with normal care.
3	Fair	The tree is typical of the species and / or has less than 40% deadwood in the crown, only 1 or 2 minor problems that are not imminently lethal to the tree and no significant decay or significant decay or structural problems, but the tree must have remedial care above normal care in order to minimize the impact of future stress and to ensure continued health.
2	Poor	The tree is not typical of the species and / or has over 50% deadwood in the crown, major decay or structural problems, is hazardous or is severely involved with insects, disease, or other problems that even if aggressively corrected would not result in the long term survival of the tree.
1	Dead	Less than 10% of the tree shows signs of life

Existing Tree Survey Date :

Existing tree tagging, inventory and rating completed by Signature Design Group on March 15, 2024. Location Survey prepared by : Bono Consultants and dated May 6, 2024.

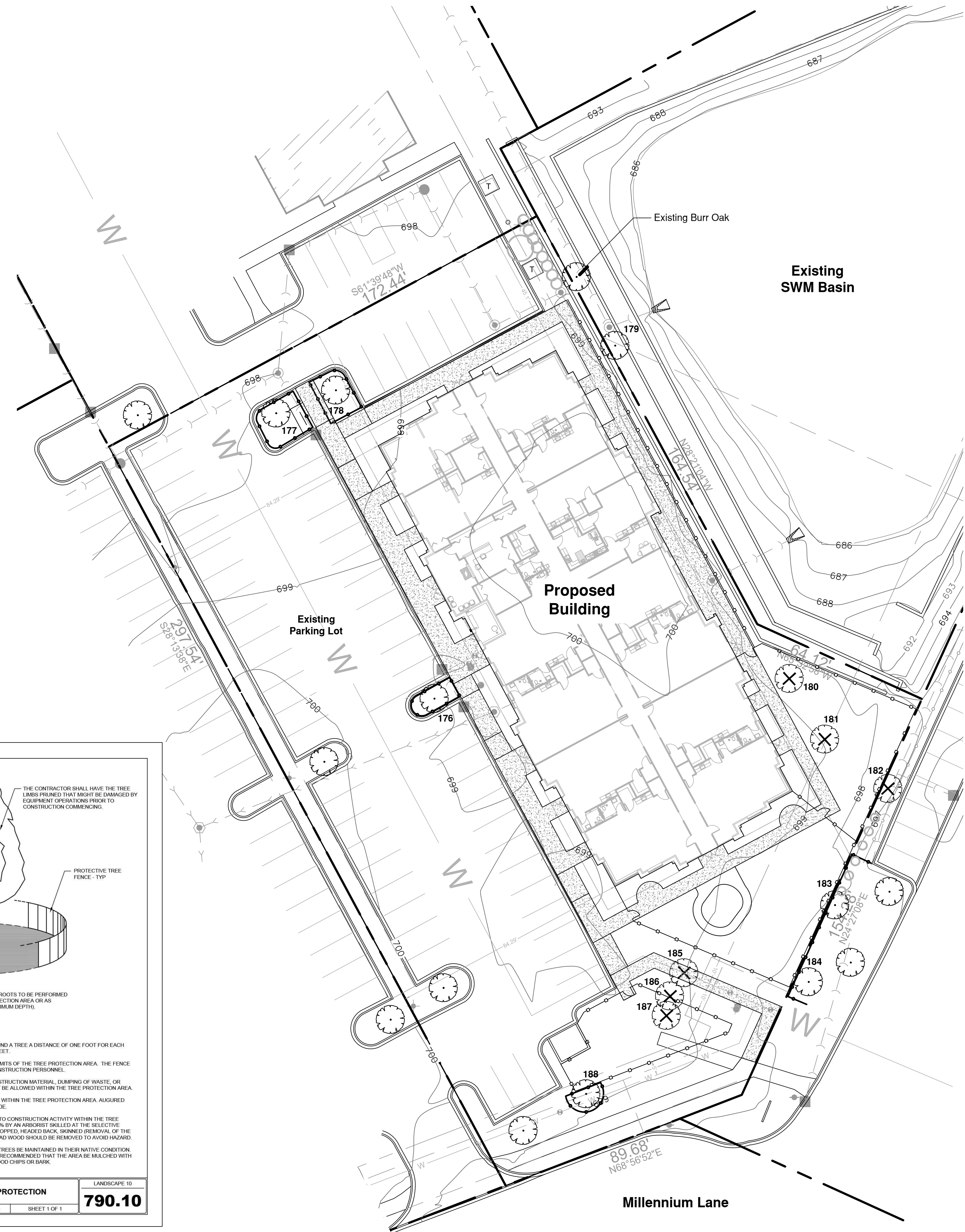
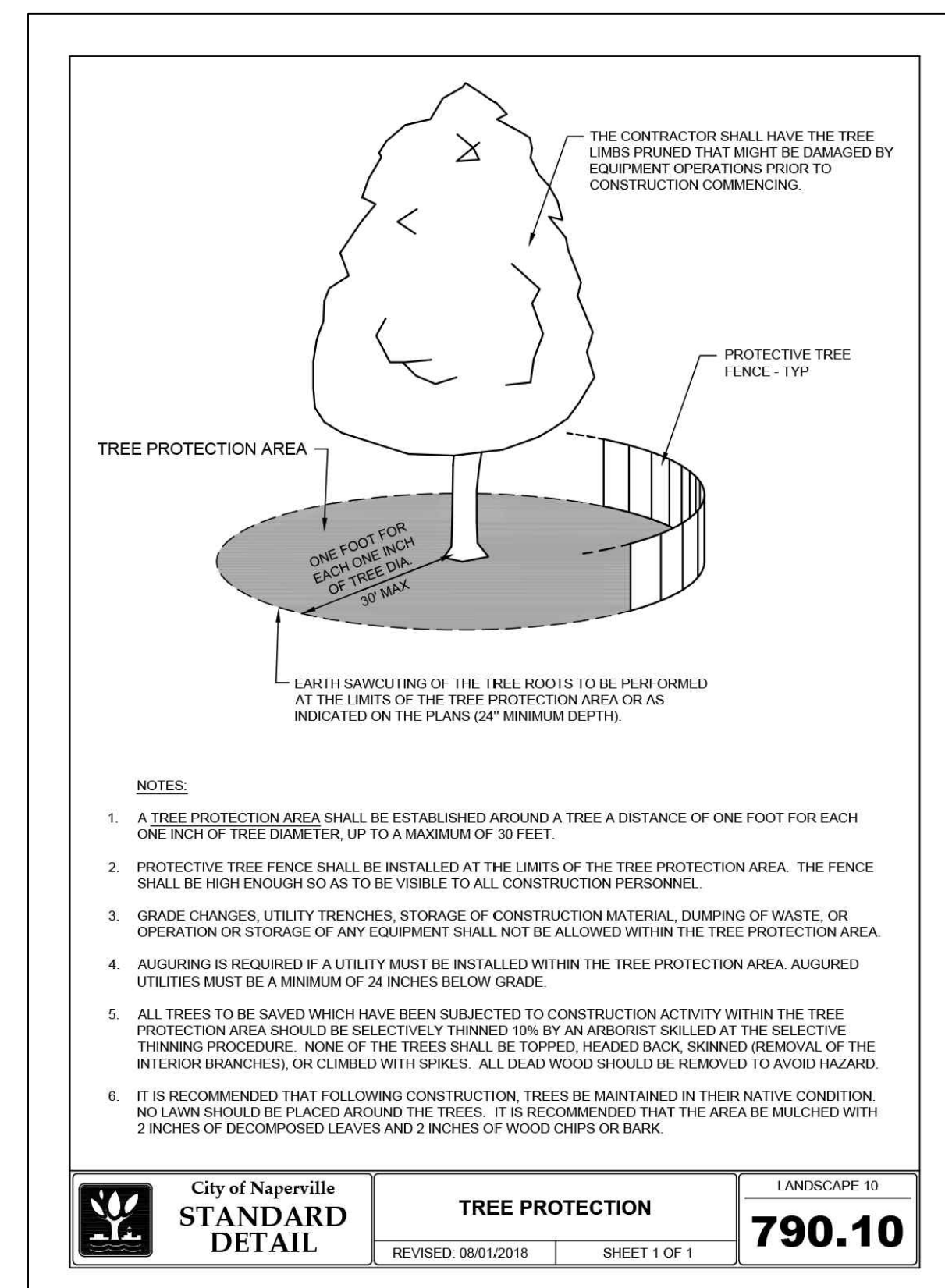

Land Planning
Landscape Architecture
Environmental Site Design

132 N. WASHINGTON ST. - NAPERVILLE, IL 60540 - 630.305.3880 Fax 630.305.3894

project:

**Riverwoods
Daycare Center**

Parcel F - River Road
Naperville, Illinois

sheet description:

**Existing Tree
Survey**

owner:

BHC Construction LLC
640 N. River Road Suite 106
Naperville, IL 60563



north: scale: 1" = 20' 0"

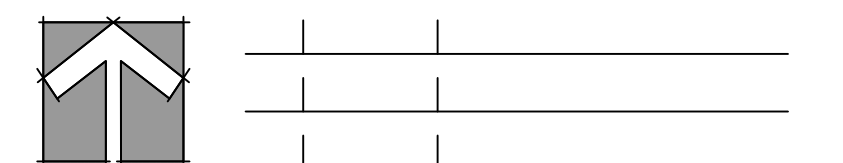

revisions:	original issue date:
9.24.2024 Engineer Site Plan Rev. Per City Comments	31 May 2024
8.30.2024 Per City Review Comments dated 7.22.2024	

original issue date: **31 May 2024**

drawn by:
checked by:
project no.: **24003**
sheet no.:

TS.100