

**GATE HARDWARE:** ALL HARDWARE AND ACCESSORIES SHALL BE HEAVY GALVANIZED.

**GATE STOP:** MUSHROOM TYPE OR FLUSH PLATE WITH ANCHORS SET IN CONCRETE TO ENGAGE THE CENTER DROP ROD OR PLUNGER BAR.

**GATE NOTES:** (4) EQUAL WIDE X 6'-0" HIGH MTL. GATES, TYPE 'B' 1 1/2" DECKING, 22GA. W/ T.S. 1 X .1875 BAR CROSS BRACING WELD AND GRIND SMOOTH ALL CONNECTIONS, TYP. PRIME AND PAINT ALL STEEL COMPONENTS.

**ENCLOSURE NOTES** N.T.S. **I**

SYMBOL	AREA	MANUFACTURER	COLOR
①	GATE FRAME COLOR	SHERWIN WILLIAMS	SW 7076 CYBER SPACE
②	PIPE BOLLARDS	SHERWIN WILLIAMS	CAUTION YELLOW
③	CMU	TBD	
④	THIN BRICK	INTERSTATE BRICK	ARCTIC WHITE

**FRONT ELEVATION** N.T.S. **E**

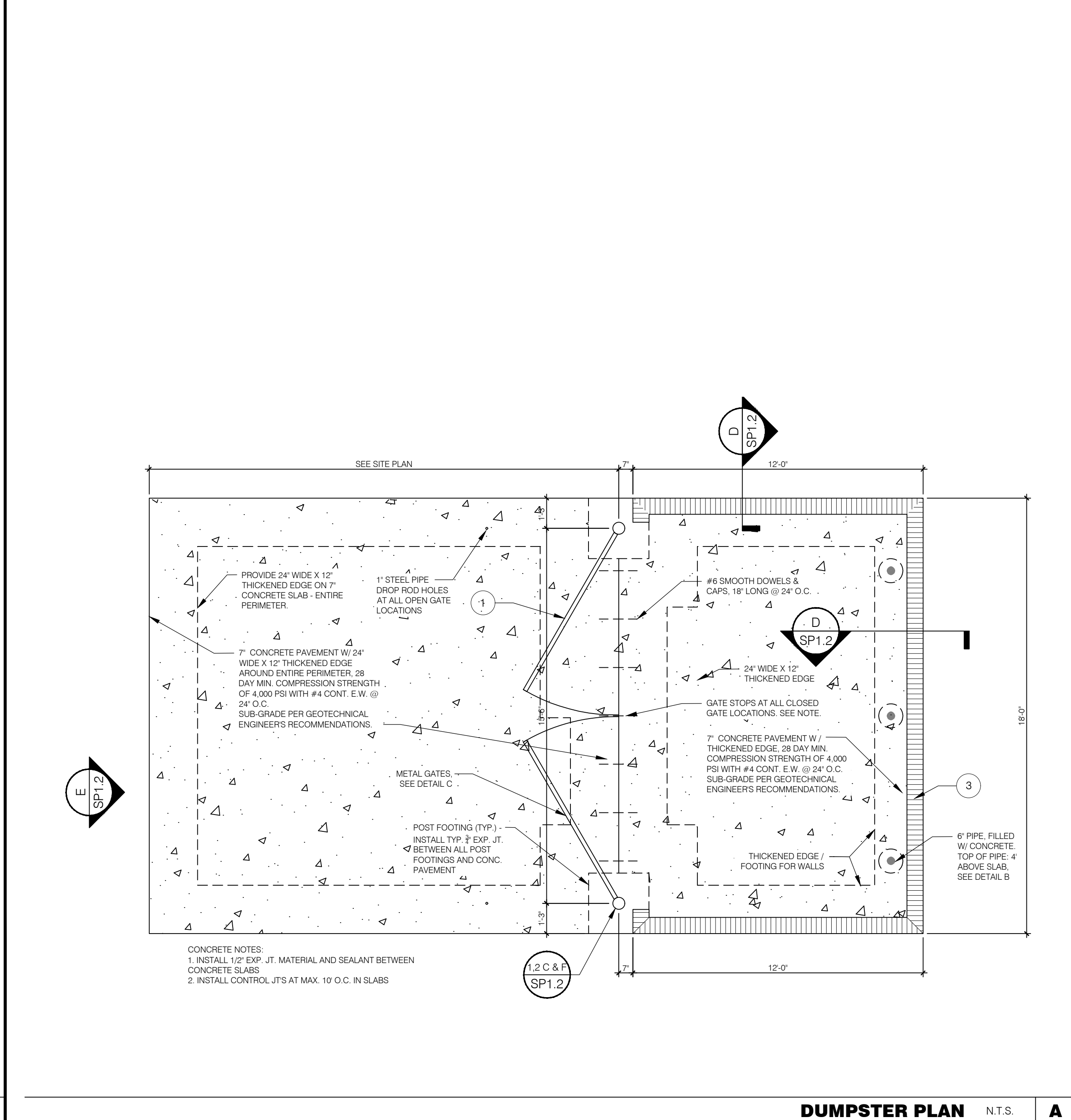
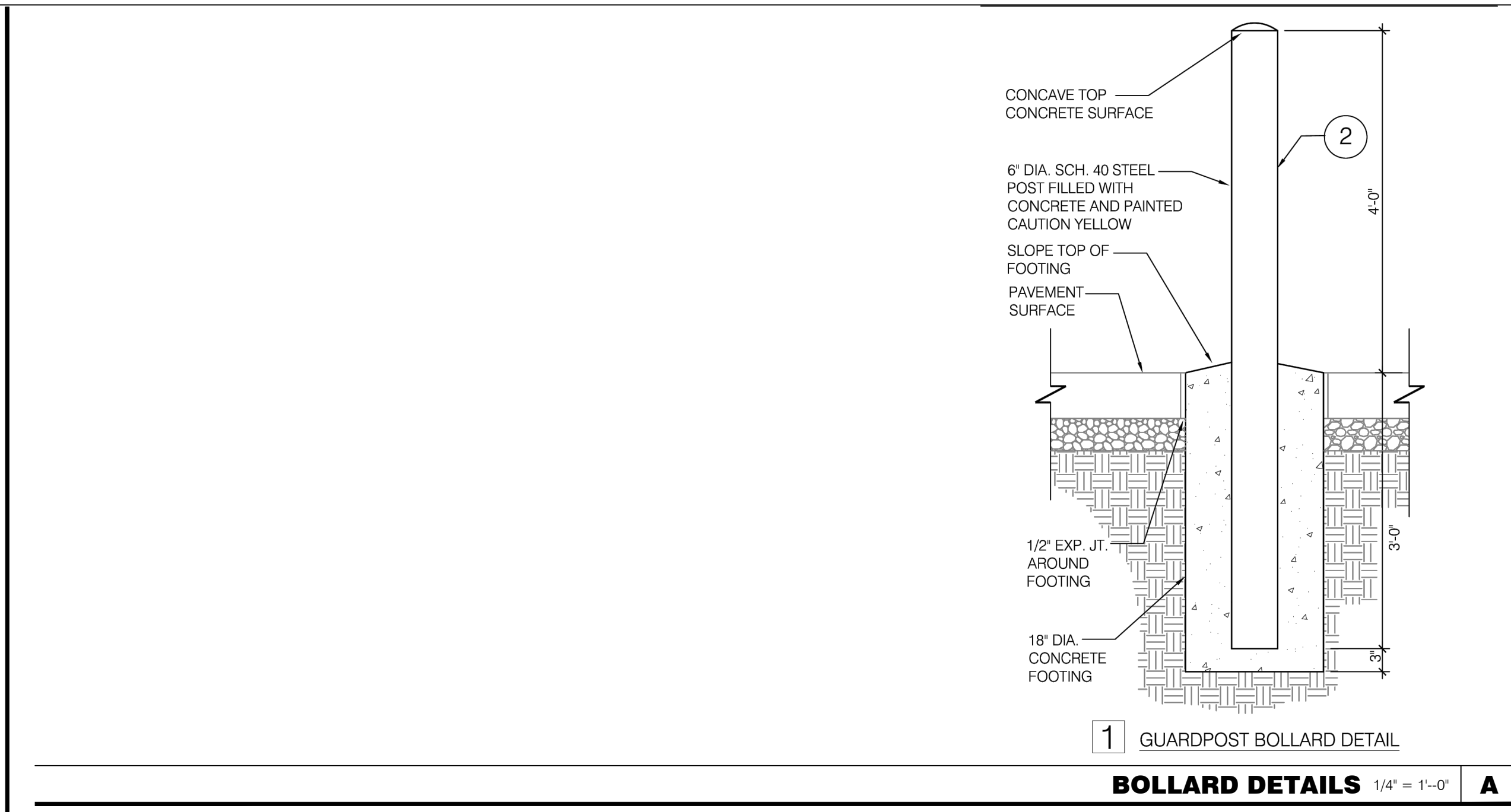
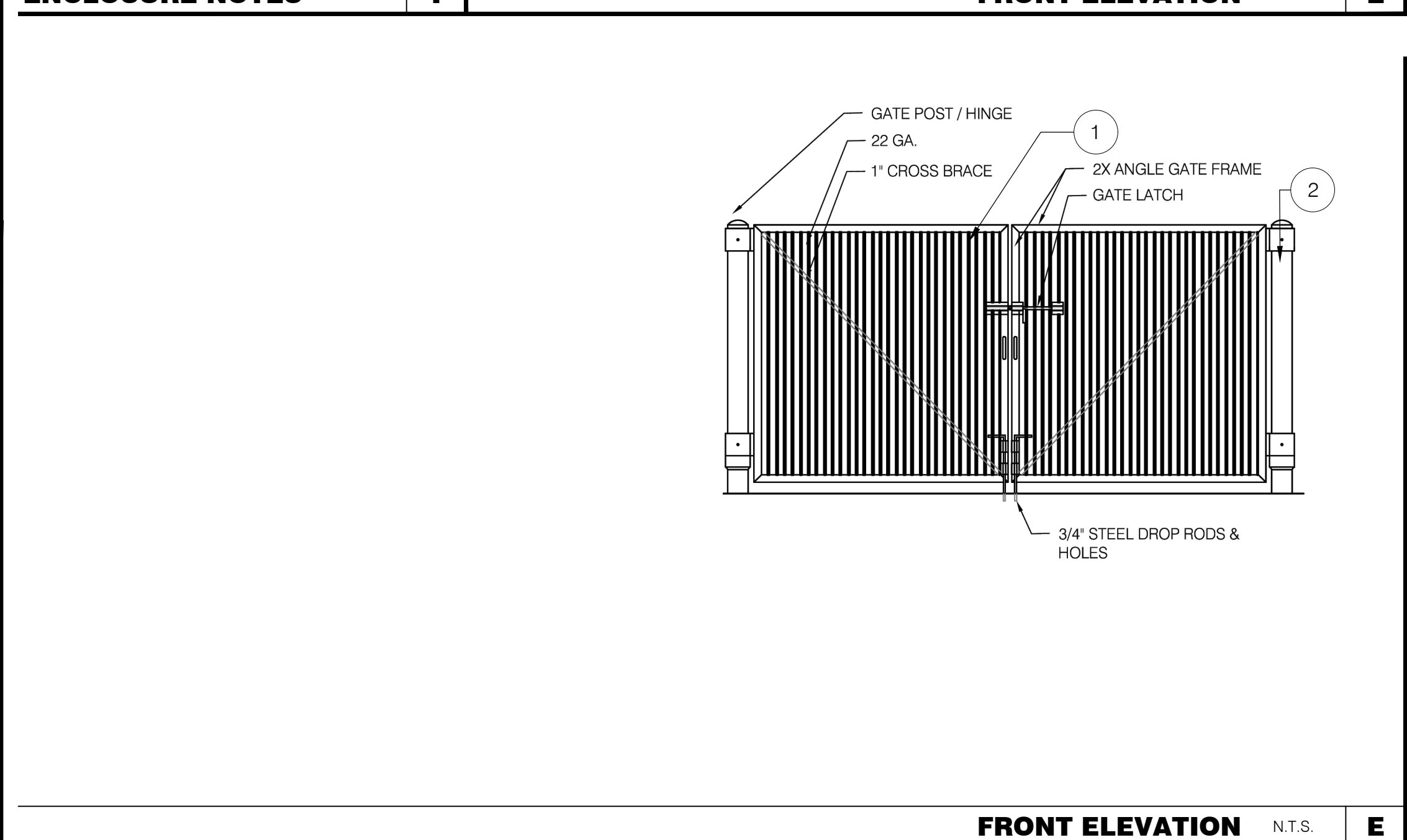

**MRV ARCHITECTS, INC.**

5105 TOLLVIEW DR., SUITE 201  
 ROLLING MEADOWS, IL 60008  
 TEL: 224-318-2140

MRV ARCHITECTS, INC. 2024

ALL DRAWINGS, SPECIFICATIONS, PLANS AND CONCEPTS ARE INSTRUMENTS OF SERVICE AND THEREFORE ARE PROPERTY OF MRV ARCHITECTS, INC. THEY MAY NOT BE REUSED, COPIED OR REPRODUCED WITHOUT PERMISSION AND EXPRESS WRITTEN CONSENT FROM MRV ARCHITECTS, INC.

△ 03-05-24 ZONING COMMENTS  
 △ 01-29-24 ZONING COMMENTS

CONTRACT DATE: ENDEAVOR  
 BUILDING TYPE: ENDEAVOR  
 PLAN VERSION:  
 SITE NUMBER:  
 STORE NUMBER:

**TACO BELL**

1019 E. OGDEN AVE.  
 NAPERVILLE, IL

**TACO BELL ENDEAVOR**

**TRASH ENCLOSURE DETAILS**

**SP1.2**

POST DATE