

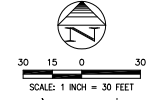

LOCATION MAP

PRELIMINARY ENGINEERING PLAN FOR 77TH STREET PROJECT

SHEET 1 OF 1



LEGEND		DESCRIPTION
	EXISTING	MANHOLE
	EXISTING	CATCH BASIN
	EXISTING	INLET
	EXISTING	CLEANOUT
	EXISTING	SLOPE INLET BOX
	EXISTING	HEADWALL
	EXISTING	END SECTION
	EXISTING	STORM SEWER
	EXISTING	SANITARY SEWER
	EXISTING	WATERMAIN
	EXISTING	VALVE & BOX
	EXISTING	WATER VALVE IN VAULT
	EXISTING	FIRE HYDRANT
	EXISTING	CONTOUR
	EXISTING	ELEVATION
	EXISTING	STREET LIGHT
	EXISTING	WATERMAIN PROTECTION
	EXISTING	CATCH ALL INLET PROTECTION (OR APPROVED EQUAL)
	EXISTING	TEMPORARY STRAW BALE DITCH CHECK
	EXISTING	SILT FENCE DITCH CHECK
	EXISTING	RIP-RAP
	EXISTING	OVERFLOW ROUTE
	PROPOSED	MANHOLE
	PROPOSED	CATCH BASIN
	PROPOSED	INLET
	PROPOSED	CLEANOUT
	PROPOSED	SLOPE INLET BOX
	PROPOSED	HEADWALL
	PROPOSED	END SECTION
	PROPOSED	STORM SEWER
	PROPOSED	SANITARY SEWER
	PROPOSED	WATERMAIN
	PROPOSED	VALVE & BOX
	PROPOSED	WATER VALVE IN VAULT
	PROPOSED	FIRE HYDRANT
	PROPOSED	CONTOUR
	PROPOSED	ELEVATION
	PROPOSED	STREET LIGHT
	PROPOSED	WATERMAIN PROTECTION
	PROPOSED	CATCH ALL INLET PROTECTION (OR APPROVED EQUAL)
	PROPOSED	TEMPORARY STRAW BALE DITCH CHECK
	PROPOSED	SILT FENCE DITCH CHECK
	PROPOSED	RIP-RAP
	PROPOSED	OVERFLOW ROUTE

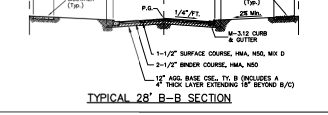
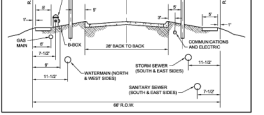
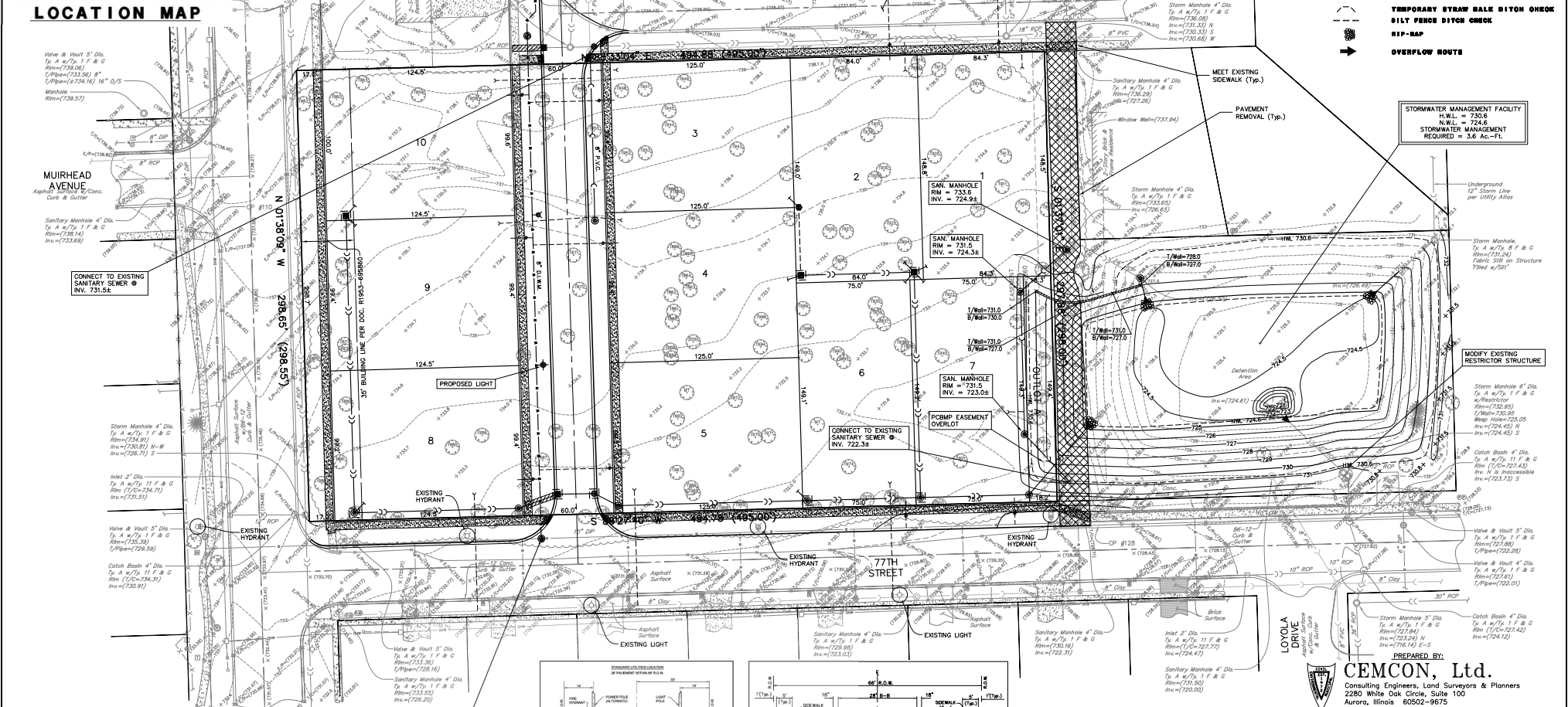

PREPARED FOR DEVELOPER/OWNER:
OAK CREEK CAPITAL PARTNERS, LLC
 P.O. BOX 716
 ST. CHARLES, IL 60174
 (847) 514-9144

PREPARED BY:

CEMCON, Ltd.
 Consulting Engineers, Land Surveyors & Planners
 2280 White Oak Circle, Suite 100
 Aurora, Illinois 60502-9675
 PH: 630.862.2100 FAX: 630.862.2199
 E-Mail: ccs@cemcon.com Website: www.cemcon.com

DWG NO: 782029 FILE NAME: PREVEOR
 DRAWN BY: JGC FLD BK / PLS NO: ---
 COMPLETION DATE: 06-03-19 JOB NO: 782.029
 XREF: TOPO PROJECT MANAGER: MAM/ARF
 REV. 09-13-19/ASC TAB: PREENG

CITY PROJECT NUMBER: 19-1000070
 Copyright © 2019 CEMCON, Ltd. All rights reserved.