

Drawing name: K:\GIS_DEVA\6844007_GBT_Naperville_IL2_Design\CAD\PlanSheets\Firestone\L1.0 - LANDSCAPE PLAN.dwg L1.0 LANDSCAPE PLAN Dec 13, 2019 9:15am by: Kevin Nowak
This document, together with the concepts and designs presented herein, is intended only for the specific purpose and client for which it was prepared. Reuse of and improper reliance on this document without written authorization and adaptation by Kimley-Horn and Associates, Inc. shall be without liability to Kimley-Horn and Associates, Inc.

PIN: 07-01-04-410-058-0000
OWNER: FIFTH THIRD BANK
ADDRESS: 2644 SHOWPLACE DR.
NAPERVILLE, IL 60564

PIN: 07-01-04-410-058-0000
OWNER: NAPERVILLE KING/FAE NAPERVILLE
PHILLIPS EDISON & COMPANY
ADDRESS: 2656 SHOWPLACE DR.
NAPERVILLE, IL 60564

PIN: 07-01-03-102-001-0000
OWNER: WINDRIDGE OF NAPERVILLE CONDO ASSOC.
ADDRESS: 2932 BARTLETT CT.
NAPERVILLE, IL 60564

PIN: 07-01-03-307-138-0000
OWNER: CSH NAPERVILLE LLC
ADDRESS: 2920 LEVERENZ RD.
NAPERVILLE, IL 60564

PIN: 07-01-03-307-125-0000
OWNER: J&A CANTORE LP
ADDRESS: 2695 FORGUE DR.
NAPERVILLE, IL 60564

IL ROUTE-59

LEVERENZ RD.

FORGUE DR.

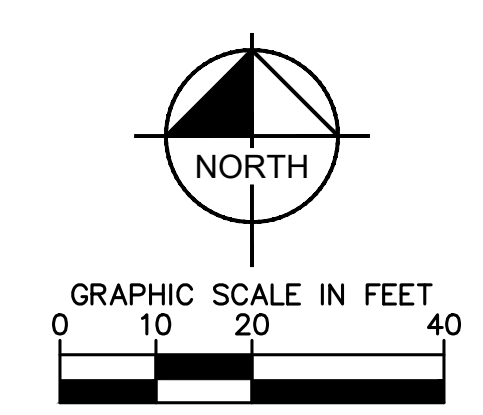
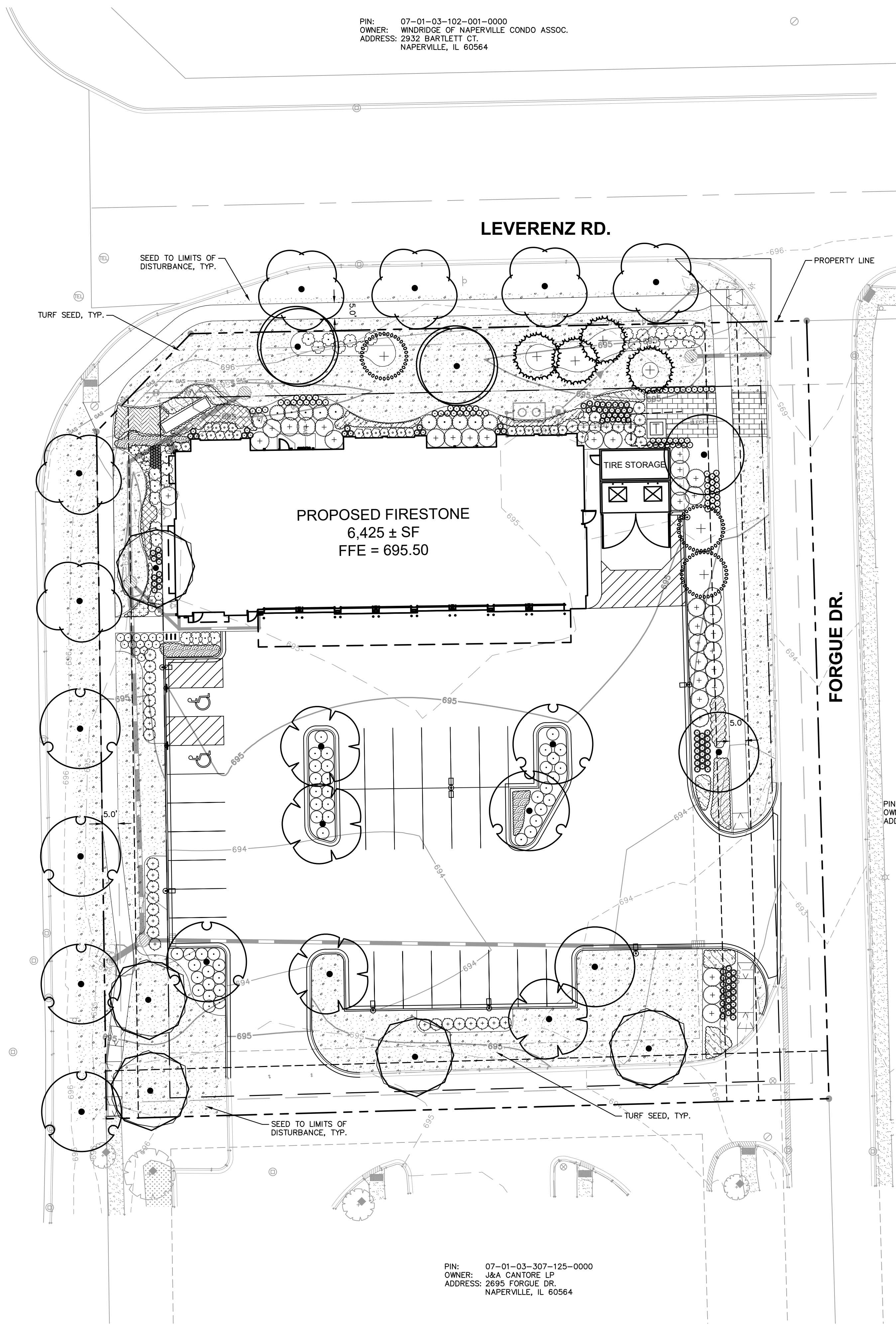

Call Before You Dig
JULIE
1-800-892-0123

	Landscape Code	
	Required	Provided
Parkway Landscape	2.5" Caliper tree requirement, evenly spaced not more than 40 feet apart	Provided
Perimeter landscape	2.5" Caliper trees and or 6 FT HT min evergreen trees shall be spaced not more than 70 feet apart along all property lines	North - 2 Canopy trees and 4 Evergreen provided (3 additional evergreens and other landscape provided) South - 2 Canopy trees provided East - 2 Canopy trees provided West - 3 Canopy trees provided
Foundation landscape shall be located adjacent to all sides of buildings which face a public ROW or internal street access drive.	1 plant for every three linear feet of building length. 127.4 North length/3= 42 plants 50.5 West length/3=17 50.5 East length/3=17	North - 60 Plants + Perennials provided West - 59 Plants + Perennials provided East - 20 Plants + Perennials provided
Interior parking lot landscape	1 shade tree 2.5" CAL for each 130 SF of landscape island. 50% of every landscape island shall be planted with live material, remaining can be covered with mulch. 686 SF of Landscape Island/130= 5 Trees	5 Trees provided
Perimeter parking lot landscape	5 ft wide landscape area shall be provided around that park of the perimeter of all parking lots.	Provided
Front and corner side yards	Across from nonresidential property landscaping shall be provided across 50% of parking lot 3 FT height.	West- Landscaping provided across 50% of parking lot
Rear and interior side yards	Abutting residential property continuous landscaping 3 FT height. Abutting nonresidential property landscaping shall be provided across 50% of parking lot 3 FT height. Shade trees 2.5" Caliper shall be spaced not more than 70 Feet	East- Continuous landscaping South-2 Canopy trees, landscape provided across 50% of parking lot
Parking lot islands	50% of islands planted with shrubs 30" at maturity	50% of islands planted

NO.	REVISIONS	DATE	BY
1	CITY COMMENTS	12/13/19	KRN
2	CITY COMMENTS	11/06/19	KRN
3			
4			

Kimley»Horn
© 2019 KIMLEY-HORN AND ASSOCIATES, INC.
1001 WARENVILLE ROAD, SUITE 350,
LISLE, IL 60532 • 616 650
WWW.KIMLEY-HORN.COM

SCALE: AS NOTED
DESIGNED BY: KRN
DRAWN BY: KRN
CHECKED BY: MEW

GBT REALTY CORPORATION
9010 OVERLOOK BOULEVARD
BRENTWOOD, TENNESSEE 37027
(615) 370-0670 • (615) 373-3111 FAX
www.gbtrealty.com

LANDSCAPE PLAN

Firestone
COMPLETE AUTO CARE
2643 FORGUE DR.
NAPERVILLE, IL 60564

ORIGINAL ISSUE:
10/01/19
KHA PROJECT NO.
168443007

SHEET NUMBER
L1.0

PROPOSED TREES SHALL BE HORIZONTALLY SEPARATED FIVE (5) FEET OR GREATER FROM EXISTING AND PROPOSED UNDERGROUND SANITARY SEWERS AND WATER MAINS AND TEN (10) FEET OR GREATER FROM EXISTING AND PROPOSED UTILITY STRUCTURES SUCH AS VALVE VAULTS AND FIRE HYDRANTS.

NOTES:

1. INSPECT TREE FOR DAMAGED BRANCHES. APPLY CORRECTIVE PRUNING.
2. SET ROOT BALL ON UNEXCAVATED OR TAMPED SOIL. TOP OF ROOTBALL SHALL BE TWO INCHES ABOVE SURROUNDING GRADE WITH BURLAP AND WIRE BASKET INTACT.
3. REMOVE WIRE BASKET AND BURLAP DOWN FOUR TO SIX INCHES BELOW TOP OF ROOT BALL. REMOVE ALL TWINE AND (IF USED), SYNTHETIC MATERIAL. REMOVE OR CORRECT GIRDLING ROOTS.
4. TAMP EXCAVATED SOIL AROUND BASE OF ROOTBALL.
5. BACKFILL REMAINDER EXCAVATED SOIL TAMPED LIGHTLY. HIGH CLAY OR POOR SOIL SHALL RECEIVE SOIL AMENDMENT PER LANDSCAPE NOTES.
6. WATER THOROUGHLY WITHIN TWO HOURS USING 10 TO 15 GALLONS OF WATER.
7. APPLY MULCH IN EVEN LAYER, KEEPING AWAY FROM ROOT FLARE.
8. FINAL LOCATION OF TREE TO BE APPROVED BY OWNER.

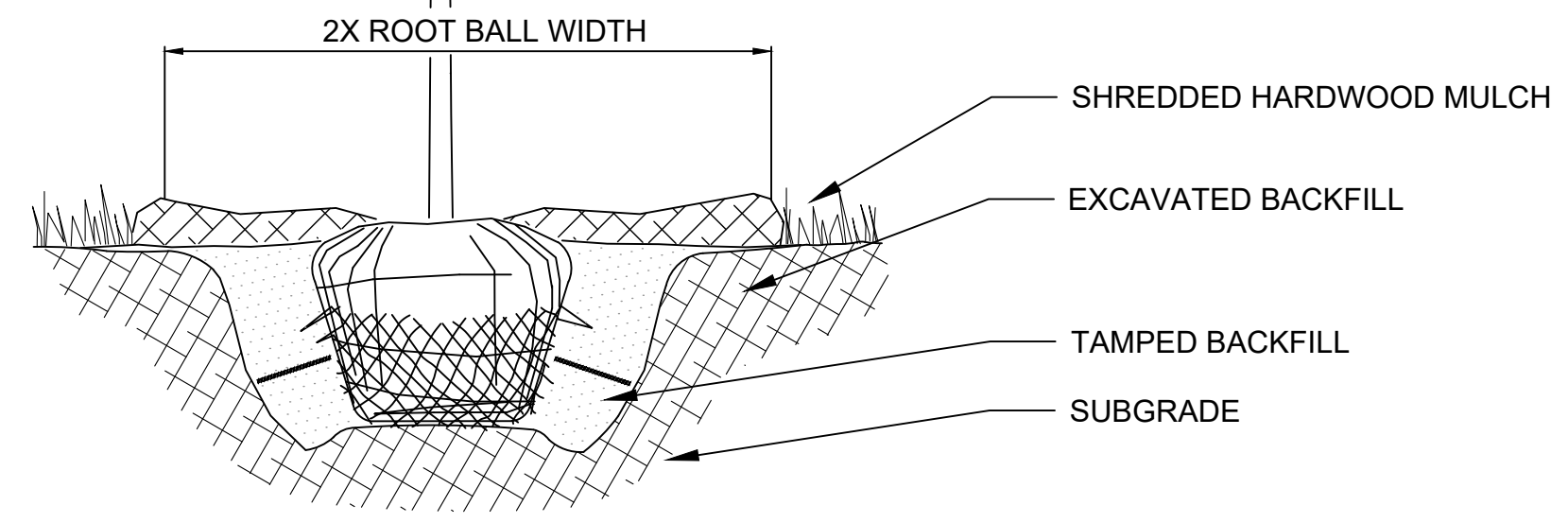

1 TREE PLANTING NTS

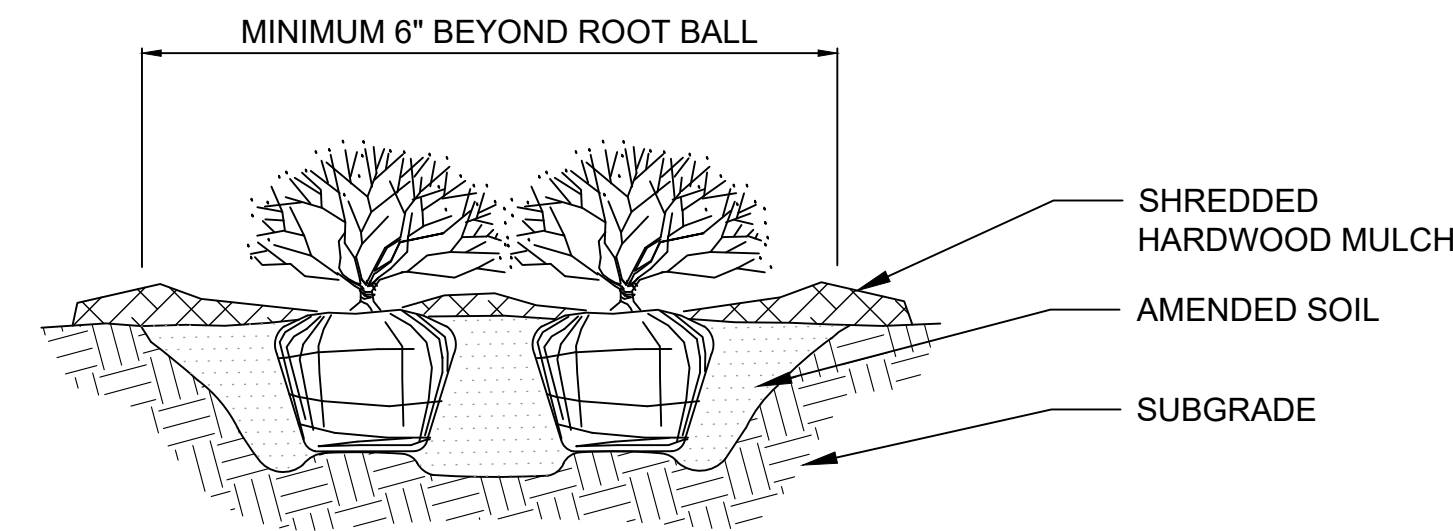

- NOTES:**
1. APPLY CORRECTIVE PRUNING.
 2. SET ROOT BALL OR CONTAINER ON UNEXCAVATED OR TAMPED SOIL. TOP OF ROOTBALL (CONTAINER) SHALL BE ONE INCH ABOVE SURROUNDING GRADE. FOR LARGER SHRUBS WITHIN PLANTING BED DIG A DEEPER PIT ONLY FOR THOSE SHRUBS.
 3. REMOVE BURLAP FROM TOP HALF THE LENGTH OF ROOTBALL. TWINE AND (IF USED) SYNTHETIC MATERIAL SHALL BE REMOVED FROM PLANTING BED. FOR CONTAINER GROWN SHRUBS, REMOVE CONTAINER AND LOOSEN ROOTS PRIOR TO INSTALLATION.
 4. REMOVE OR CORRECT GIRDLING ROOTS.
 5. PLUMB AND BACKFILL WITH AMENDED SOIL PER LANDSCAPE NOTES. WATER THOROUGHLY WITHIN TWO HOURS.
 6. APPLY MULCH IN EVEN LAYER, KEEPING AWAY FROM ROOT FLARE. MULCH LIMITS FOR SHRUBS EXTEND TO ALL LIMITS OF PLANTING BED. SEE PLANS FOR BED LAYOUTS.

2 SHRUB PLANTING NTS

NOTES:

1. EXCAVATE PLANTING BED.
2. BED HEIGHT IS TO BE 2" ABOVE FINISH GRADE AND WELL DRAINED.
3. REMOVE CONTAINER, SCORE SOIL MASS TO REDIRECT AND PREVENT CIRCLING ROOTS. CORRECT GIRDLING ROOTS.
4. PLANT MATERIAL SHALL BE LAID OUT BY FOLLOWING THE BED EDGE, WORKING TOWARDS THE CENTER OF THE BED USING TRIANGULAR (STAGGERED) SPACING AS PLASIBLE.
5. PLUMB AND BACKFILL WITH PLANTING MIX AS SPECIFIED IN LANDSCAPE NOTES.
6. APPLY MULCH IN EVEN LAYER, KEEPING AWAY FROM ROOT FLARE. MULCH LIMITS FOR PERENNIALS/GROUNDCOVER EXTEND TO ALL LIMITS OF PLANTING BED. SEE PLANS FOR BED LAYOUTS.
7. SPACING TO BE AS SPECIFIED IN THE PLANT LIST. PERENNIALS SHALL BE PLACED WITH THEIR CENTER 24" FROM EDGE OF BED.

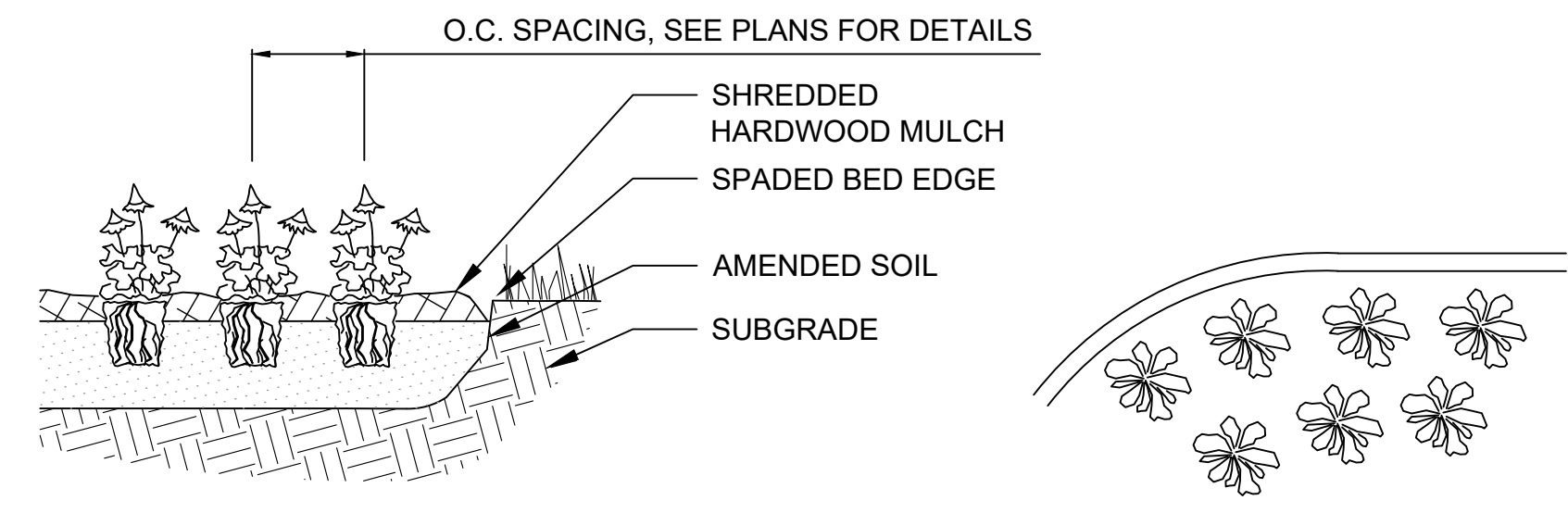

3 PERENNIAL PLANTING NTS

LANDSCAPE NOTES

1. THE LANDSCAPE CONTRACTOR SHALL BE RESPONSIBLE FOR INSTALLING MATERIALS AND PLANTS SHOWN ON THE LANDSCAPE PLAN. THE CONTRACTOR IS RESPONSIBLE FOR THE COST TO REPAIR UTILITIES, ADJACENT LANDSCAPE, PUBLIC AND PRIVATE PROPERTY THAT IS DAMAGED BY THE CONTRACTOR OR THEIR SUBCONTRACTOR'S OPERATIONS DURING INSTALLATION OR DURING THE SPECIFIED MAINTENANCE PERIOD. CALL FOR UTILITY LOCATIONS PRIOR TO ANY EXCAVATION.
2. THE CONTRACTOR SHALL REPORT ANY DISCREPANCY IN PLAN VS. FIELD CONDITIONS IMMEDIATELY TO THE LANDSCAPE ARCHITECT, PRIOR TO CONTINUING WITH THAT PORTION OF WORK.
3. THE CONTRACTOR SHALL BE RESPONSIBLE FOR THE REPAIR OF ANY OF THEIR TRENCHES OR EXCAVATIONS THAT SETTLE.
4. ALL NURSERY STOCK SHALL BE WELL BRANCHED, HEALTHY, FULL, PRE-INOCULATED AND FERTILIZED. DECIDUOUS TREES SHALL BE FREE OF FRESH SCARS. TRUNKS WILL BE WRAPPED IF NECESSARY TO PREVENT SUN SCALD AND INSECT DAMAGE. THE LANDSCAPE CONTRACTOR SHALL REMOVE THE WRAP AT THE PROPER TIME AS A PART OF THIS CONTRACT.
5. ALL NURSERY STOCK SHALL BE GUARANTEED, BY THE CONTRACTOR, FOR ONE YEAR FROM DATE OF FINAL INSPECTION.
6. AMENDED SOIL SHALL BE PROVIDED AND GRADED BY THE GENERAL CONTRACTOR UP TO 6 INCHES BELOW FINISHED GRADE IN TURF AREAS AND 18 INCHES IN PLANTING AREAS.
7. PLANTING AREA SOIL SHALL BE AMENDED WITH 25% SPHAGNUM PEATMOSS, 5% HUMUS AND 65% PULVERIZED SOIL FOR ALL SHRUB, ORNAMENTAL GRASS, PERENNIAL AND ANNUAL BEDS. AMENDED TURF AREA SOIL SHALL BE STANDARD TOPSOIL.
8. SEED/SOD LIMIT LINES ARE APPROXIMATE. CONTRACTOR SHALL SEED/SOD ALL AREAS WHICH ARE DISTURBED BY GRADING WITH THE SPECIFIED SEED/SOD MIXES.
9. CONTRACTOR SHALL INSTALL SHREDDED HARDWOOD MULCH AT A 3" DEPTH TO ALL TREES, SHRUB, PERENNIAL, AND GROUNDCOVER AREAS. TREES PLACED IN AREA COVERED BY TURF SHALL RECEIVE A 4 FT WIDE MAXIMUM TREE RING WITH 3" DEPTH SHREDDED HARDWOOD MULCH. A SPADED BED EDGE SHALL SEPARATE MULCH BEDS FROM TURF OR SEEDED AREAS. A SPADED EDGE IS NOT REQUIRED ALONG CURBED EDGES.
10. INSTALLATION OF TREES WITHIN PARKWAYS SHALL BE COORDINATED IN THE FIELD WITH LOCATIONS OF UNDERGROUND UTILITIES. TREES SHALL NOT BE LOCATED CLOSER THAN 5' FROM UNDERGROUND UTILITY LINES AND NO CLOSER THAN 10' FROM UTILITY STRUCTURES.
11. DO NOT DISTURB THE EXISTING PAVING, LIGHTING, OR LANDSCAPING THAT EXISTS ADJACENT TO THE SITE UNLESS OTHERWISE NOTED ON PLAN.
12. PLANT QUANTITIES SHOWN ARE FOR THE CONVENIENCE OF THE OWNER AND JURISDICTIONAL REVIEW AGENCIES. THE CONTRACTOR IS RESPONSIBLE FOR VERIFYING ALL PLANT QUANTITIES AS DRAWN.
13. THE OWNER'S REPRESENTATIVE MAY REJECT ANY PLANT MATERIALS THAT ARE DISEASED, DEFORMED, OR OTHERWISE NOT EXHIBITING SUPERIOR QUALITY.
14. THE CONTINUED MAINTENANCE OF ALL REQUIRED LANDSCAPING SHALL BE THE RESPONSIBILITY OF THE OWNER OF THE PROPERTY ON WHICH SAID MATERIALS ARE REQUIRED. ALL PLANT MATERIALS REQUIRED BY THIS SECTION SHALL BE MAINTAINED AS LIVING VEGETATION AND SHALL BE PROMPTLY REPLACED IF THE PLANT MATERIAL HAS DIED PRIOR TO FINAL ACCEPTANCE. PLANTING AREAS SHALL BE KEPT FREE OF TRASH, LITTER, AND WEEDS AT ALL TIMES.

VILLAGE NOTES:
 PROPOSED TREES SHALL BE HORIZONTALLY SEPARATED FIVE (5) FEET OR GREATER FROM EXISTING AND PROPOSED UNDERGROUND SANITARY SEWERS AND WATER MAINS AND TEN (10) FEET OR GREATER FROM EXISTING AND PROPOSED UTILITY STRUCTURES SUCH AS VALVE VAULTS AND FIRE HYDRANTS.

PLANT SCHEDULE

TREES	CODE	QTY	BOTANICAL / COMMON NAME	CONT	CAL	SIZE
	AM2	5	ACER MIYABEI / MIYABEI MAPLE	B & B	2.5"	CAL MIN
	GB	7	GINKGO BILOBA / MAIDENHAIR TREE	B & B	2.5"	CAL MIN
	GI2	3	GLEDITSIA TRIACANTHOS INERMIS / THORNLESS COMMON HONEYLOCUST	B & B	2.5"	CAL MIN
	QA	2	QUERCUS ALBA / WHITE OAK	B & B	2.5"	CAL MIN
	UA	6	ULMUS X 'ACCOLADE' / ACCOLADE ELM	B & B	2.5"	CAL MIN
	ZS	4	ZELKOVA SERRATA / JAPANESE ZELKOVA	B & B	2.5"	CAL MIN
EVERGREEN TREES	CODE	QTY	BOTANICAL / COMMON NAME	CONT	CAL	SIZE
	PD	4	PICEA GLAUCA 'DENSATA' / BLACK HILLS SPRUCE	B & B		6' HT MIN
	PF	3	PINUS FLEXILIS 'VANDERWOLF'S PYRAMID' / VANDERWOLF'S PYRAMID PINE	B & B		6' HT MIN
SHRUBS	CODE	QTY	BOTANICAL / COMMON NAME	CONT	SPACING	SIZE
	CP	13	CHAMAECYPARIS PISIFERA 'BOULEVARD' / DWARF BLUE CYPRESS	-	SEE PLAN	60" HT MIN
	FG	26	FOTHERGILLA GARDENII / DWARF FOTHERGILLA	-	SEE PLAN	18" HT MIN
	HA	11	HYDRANGEA ARBORESCENS 'ANNABELLE' / ANNABELLE SMOOTH HYDRANGEA	-	SEE PLAN	24" HT MIN
	IL	19	ITEA VIRGINICA 'LITTLE HENRY' TM / VIRGINIA SWEETSPIRE	-	SEE PLAN	24" HT MIN
	JF2	22	JUNIPERUS CHINENSIS 'FAIRVIEW' / FAIRVIEW JUNIPER	-	SEE PLAN	6' HT MIN
	JF3	38	JUNIPERUS CHINENSIS 'KALLAY'S COMPACT' / KALLAY'S COMPACT PFITZER JUNIPER	-	SEE PLAN	24" HT MIN
	RG	43	RHUS AROMATICA 'GRO-LOW' / GRO-LOW FRAGRANT SUMAC	-	SEE PLAN	12" HT MIN
	RR	5	ROSA X 'KNOCKOUT' TM / ROSE	-	SEE PLAN	18" HT MIN
	VA	28	VIBURNUM DENTATUM 'CHRISTOM' / BLUE MUFFIN VIBURNUM	-	SEE PLAN	24" HT MIN
GRASSES	CODE	QTY	BOTANICAL / COMMON NAME	CONT	SPACING	SIZE
	CK	97	CALAMAGROSTIS X ACUTIFLORA 'KARL FOERSTER' / FEATHER REED GRASS	1 GAL		
	PB	30	PENNISETUM ALOPECUROIDES 'BURGUNDY BUNNY' / BURGUNDY BUNNY DWARF FOUNTAIN GRASS	#1	SEE PLAN	
	PH	76	PANICUM VIRGATUM 'HEAVY METAL' / BLUE SWITCH GRASS	#1	SEE PLAN	

PERENNIALS AND GRASSES	CODE	QTY	BOTANICAL / COMMON NAME	CONT
	AB	54	AMSONIA TABERNAEMONTANA 'BLUE ICE' / BLUE ICE STAR FLOWER	1 GAL
	AS2	31	ALLIUM X 'SUMMER BEAUTY' / SUMMER BEAUTY ALLIUM	1 GAL
	CM	58	COREOPSIS VERTICILLATA 'MOONBEAM' / MOONBEAM THREAD LEAF COREOPSIS	1 GAL
	EP	19	ECHINACEA X 'PIXIE MEADOWBRITE' / PIXIE MEADOWBRITE PURPLE CONEFLOWER	1 GAL
	HB	56	HEUCHERA X 'BLACKBERRY ICE' TM / DOLCE BLACKBERRY ICE HEUCHERA	1 GAL
	HR	133	HEMEROCALLIS X 'ROSY RETURNS' / DAYLILY	1 GAL
	LB	83	LIRIOPE SPICATA 'BIG BLUE' / CREEPING LILY TURF	1 GAL
	SH2	51	SPOROBOLUS HETEROLEPIS 'TARA' / DWARF PRAIRIE DROPS EED	1 GAL

GROUND COVERS	BOTANICAL / COMMON NAME
	TURF SEED



DESIGNED BY: KRN	CITY COMMENTS	REVISIONS
DRAWN BY: KRN	12/13/19	BY: KRN
CHECKED BY: MEW	11/06/19	DATE

Kimley»Horn
 © 2019 KIMLEY-HORN AND ASSOCIATES, INC.
 1001 WARENVILLE ROAD, SUITE 350,
 LISLE, IL 60532 • 616-560-
 WWW.KIMLEY-HORN.COM

SCALE: AS NOTED
 DESIGNED BY: KRN
 DRAWN BY: KRN
 CHECKED BY: MEW

GBT REALTY CORPORATION
 9010 OVERLOOK BOULEVARD
 BRENTWOOD, TENNESSEE 37027
 (615) 370-0670 • (615) 373-3111 FAX
 www.gbtrealty.com

LANDSCAPE NOTES AND DETAILS

Firestone COMPLETE AUTO CARE
 2643 FORGUE DR.
 NAPERVILLE, IL 60564

ORIGINAL ISSUE: 10/01/19
 KHA PROJECT NO. 168443007

SHEET NUMBER
L2.0

Drawing name: K:\085_LDEV\168443007_GBT_Naperville_IL2_Landscape Plan.dwg Dec 13, 2019 9:15am by: Kevin Nowak
 This document, together with the concepts and designs presented herein, is intended only for the specific purpose and client for which it was prepared. Reuse of and improper reliance on this document without written authorization and adaptation by Kimley-Horn and Associates, Inc. shall be without liability to Kimley-Horn and Associates, Inc.