

September 20, 2017

Funtopia

**Conditional Use - Juvenile and Adult Recreation Facility**

2639 Aurora Avenue, Westridge Court

EXHIBIT 1: Section 6-3-8:2 Standards for Granting

1. No:  
The use of 2639 West Aurora for a juvenile and adult recreational facility with climbing and adventure play apparatus is fitting for this retail shopping area and will not degrade it in any way.  
It will fill a long vacant space.
2. No:  
The conditional use is consistent and compatible with the land uses and zoning (B2), and will not have any detrimental influence on any surrounding property.
3. No:  
Properties on all side of this development are of commercial use.  
The Westridge Court, of which this is a part, currently has a number of vacant stores.  
The granting of this conditional use will not impede the development and renovation of these stores.
4. No:  
The property is currently zoned B2 (Community Shopping Center District).  
This building use is unique, with one exception in the State of Illinois.  
This use is not in conflict with the adopted comprehensive master plan.

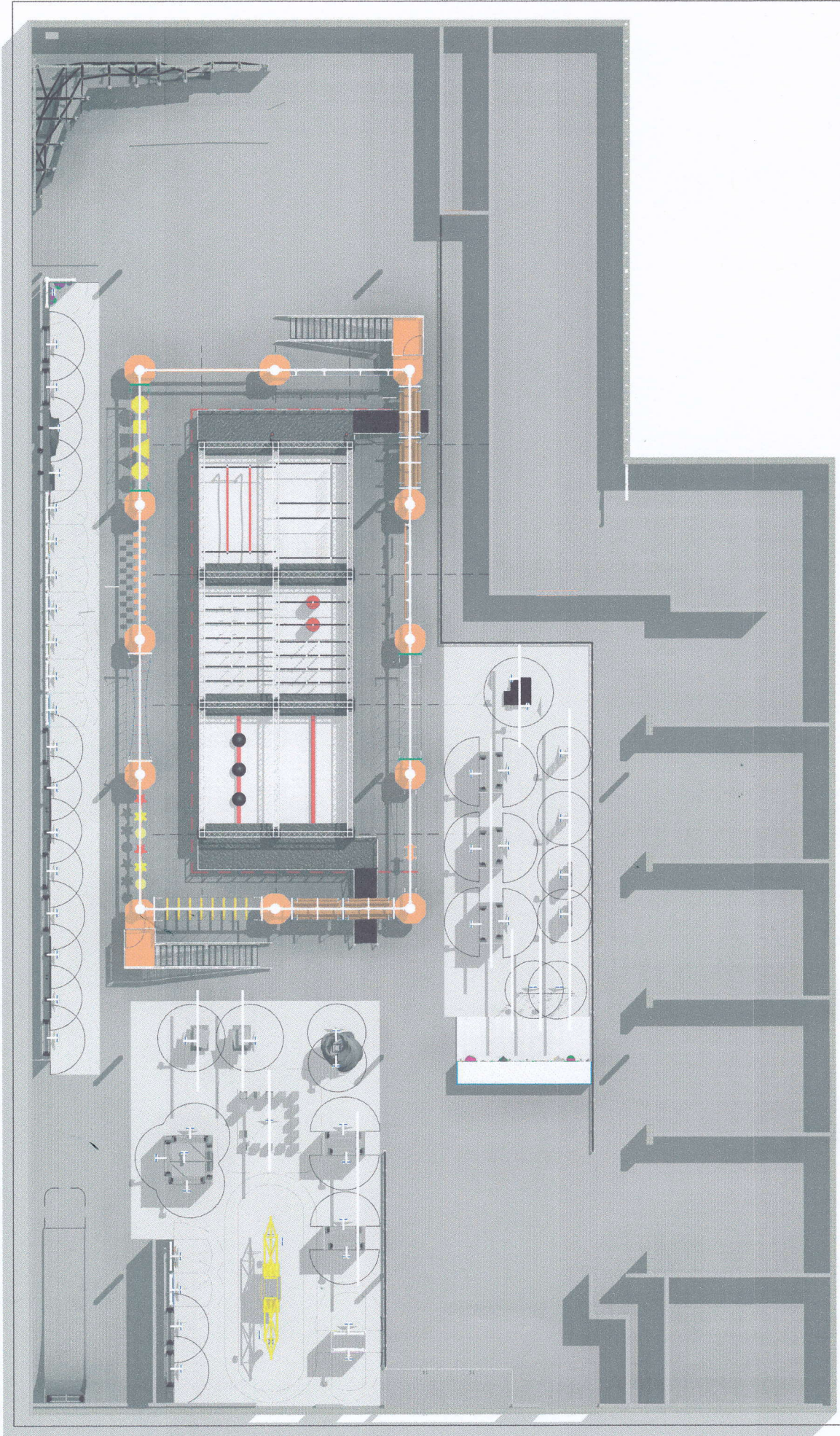

**PROJECT**

Naperville Funtopia

A1 - 0016

**CLIENT**

Naperville

**DESIGNER**

Radoslav Todorov

**HEAD DESIGNER**

Pencho Penchev

**DATE**

09/15/17

All plans, designs, and images are protected by EU and international copyright law and may not be duplicated, reproduced, modified, and/or distributed, in whole or in part, without the express written consent of Walltopia Ltd.

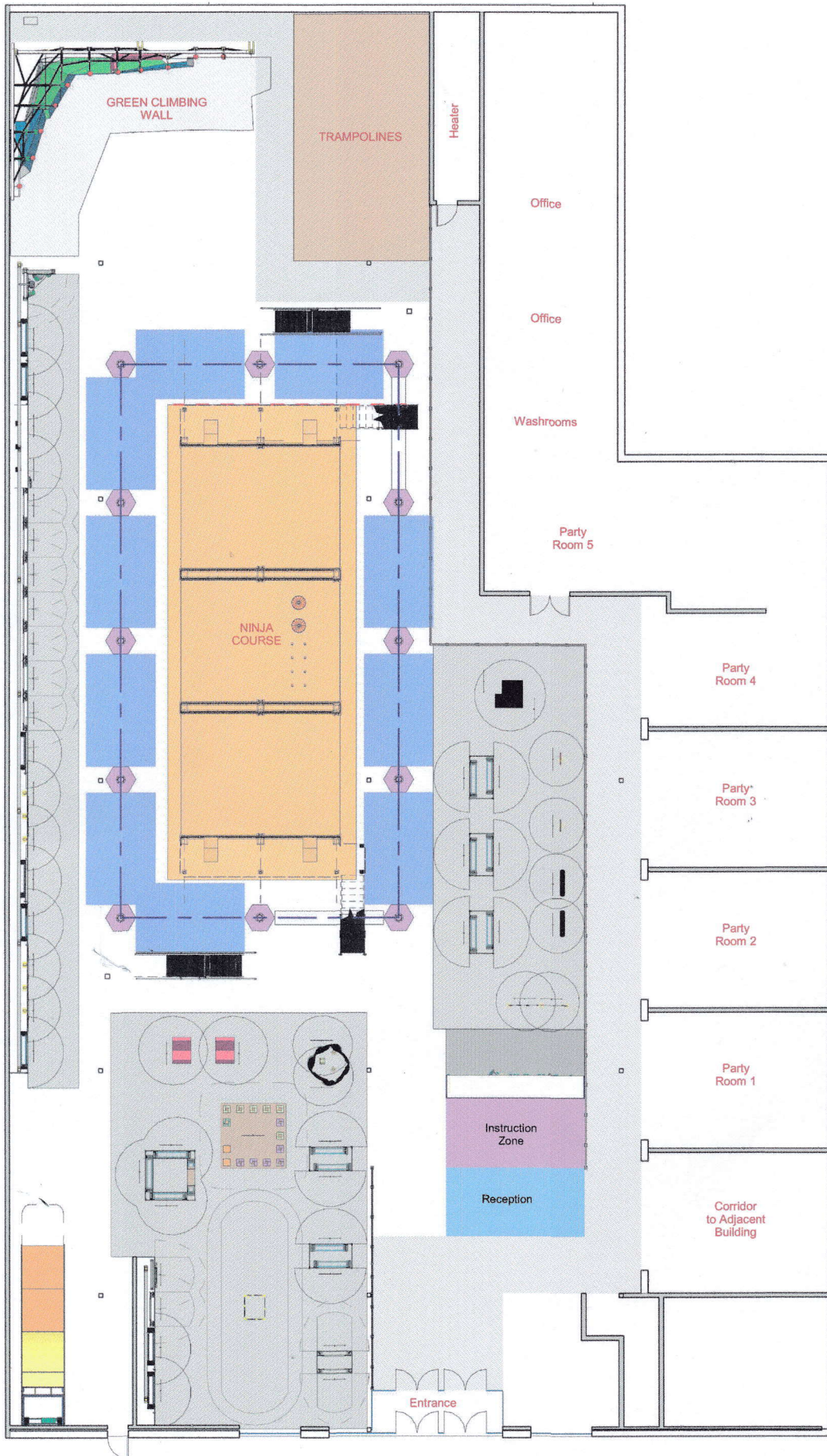

**PROJECT**

Naperville Funtopia

A1 - 0016

**CLIENT**

Naperville

**DESIGNER**

Radoslav Todorov

**HEAD DESIGNER**

Pencho Penchev

**DATE**

09/15/17

All plans, designs, and images are protected by EU and International copyright law and may not be duplicated, reproduced, modified, and/or distributed, in whole or in part, without the express written consent of Walltopia Ltd.

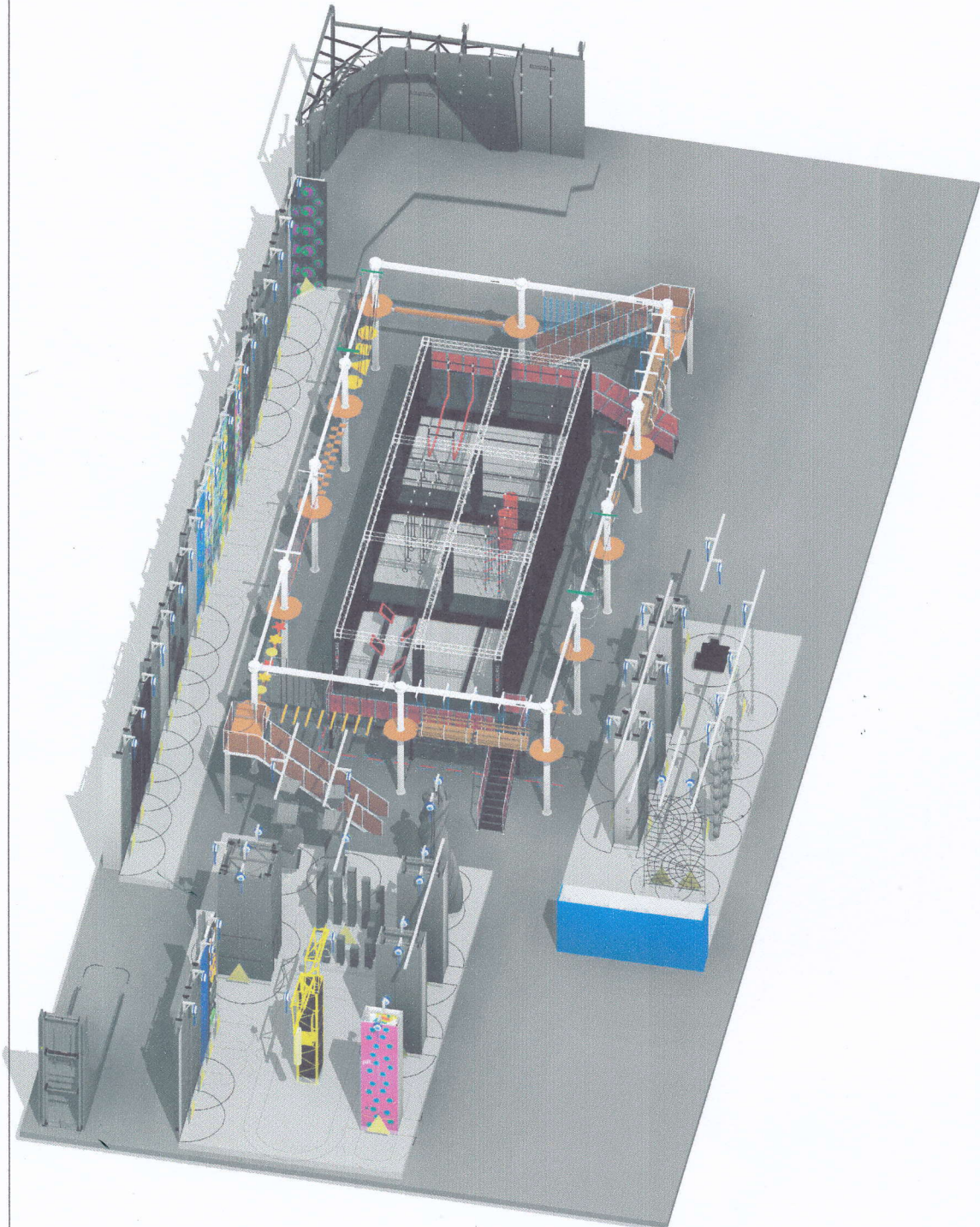

**PROJECT**

Naperville Funtopia

A1 - 0016

**CLIENT**

Naperville

**DESIGNER**

Radoslav Todorov

**HEAD DESIGNER**

Pencho Penchev

**DATE**

09/15/17

All plans, designs, and images are protected by EU and international copyright law and may not be duplicated, reproduced, modified, and/or distributed, in whole or in part, without the express written consent of Walltopia Ltd.