



**Culver's of Naperville**

1515 N. Naper Blvd  
Naperville, IL



Job #7030308

03.12.19

# PRELIMINARY ENGINEERING FOR TARTAN POINT SUBDIVISION

## NAPERVILLE, ILLINOIS

PART OF THE NORTHWEST QUARTER OF SECTION 8, TOWNSHIP 38 NORTH, RANGE 10, EAST OF THE THIRD PRINCIPAL MERIDIAN, IN DUPAGE COUNTY, ILLINOIS.

P.I.N. 08-08-101-007  
08-08-101-008  
ADDRESS: 1515 NAPER BLVD  
NAPERVILLE, ILLINOIS 60563

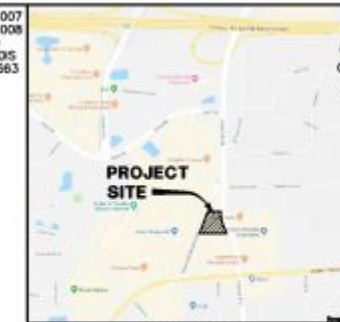

SCALE: 1"=30'  
BASIS OF BEARINGS: ILLINOIS STATE PLANE - EAST ZONE (TRUE NORTH)

### LEGEND

⊙	MNEMONIC
○	GATCH SIGN
□	WALK & VAULT
⊕	VALVE & BOX
⊗	FIRE HYDRANT
⊘	STREET LIGHT
⊙	POWER POLE
—	SIDEWALK
—	CURB
—	STORM SEWER
—	SANITARY SEWER
—	WATERMAIN
—	HEADWALL
—	END SECTION
—	CORRUGATED METAL PIPE
—	ELECTRIC LINE
—	GAS LINE
—	TELEPHONE LINE
—	FIBER OPTIC CABLE
—	OVERHEAD POWER LINES
—	CABLE TELEVISION
—	TRAFFIC SIGNAL LINE
—	STREET LIGHT CABLING
—	FENCE LINE
—	BITUMINOUS PAVEMENT
—	CONCRETE



### ABBREVIATIONS

000.00' M	MEASURED DATA
000.00' C	COMPUTED DATA
000.00' R	RECORD DATA
P.U. & D.E.	PUBLIC UTILITY & DRAINAGE EASEMENT
R	RADIUS
A	ARC LENGTH
PN	PERMANENT INDEX NUMBER
P.U. & D.E.	PUBLIC UTILITY & DRAINAGE EASEMENT

### LINE TYPE LEGEND

PROPOSED	EXISTING	DESCRIPTION
---	---	SUBDIVISION BOUNDARY
---	---	LOT LINE
---	---	CENTER LINE
---	---	RIGHT OF WAY
---	---	ACCESS EASEMENT LINE
---	---	EASEMENT LINE
---	---	BUILDING LINE
---	---	SECTION LINE
---	---	UNDERLYING LOT LINE

### BENCHMARKS

REFERENCE BENCHMARK:

- NAPERVILLE MONUMENT #703; BERNSTEIN 30 MONUMENT ALONG THE NORTH RIGHT OF WAY OF U.S. 34 (ODDEN AVENUE) BEHIND THE PUBLIC WALK IN THE CENTER OF THE RIGHT-IN RIGHT-OUT ISLAND TO ODDEN MALL SHOPPING CENTER, APPROXIMATELY 320.4 FEET WEST OF THE INTERSECTION OF U.S. 34 AND WHEATON NAPERVILLE ROAD. ELEVATION = 780.31 (780.38 MEAS.)

### SITE BENCHMARKS:

- CROSS IN PUBLIC SIDEWALK NEAR FACE OF WALK ALONG THE WEST RIGHT OF WAY OF NAPER BOULEVARD. SAID CROSS IS 25.74 FEET SOUTHWEST OF THE NORTHWEST PROPERTY CORNER OF THE SUBJECT SITE AND 5.44 FEET WEST OF THE LIGHT STANDARD. ELEVATION = 771.60
- CROSS IN PUBLIC SIDEWALK NEAR FACE OF WALK ALONG THE EAST RIGHT OF WAY OF WHEATON NAPERVILLE ROAD. SAID CROSS IS 244 FEET SOUTHWEST OF THE NORTHWEST PROPERTY CORNER OF THE SUBJECT SITE AND 94 FEET SOUTHWEST OF A FIRE HYDRANT. ELEVATION = 772.023

CITY PROJECT NO. 18-10000111

### SITE DATA

GROSS BOUNDARY AREA	130,838 S.F. OR 3.006 AC.
NET BOUNDARY AREA	130,838 S.F. OR 3.006 AC.
ROW DEDICATED	N/A
LOT AREA	
LOT 1 (CIRCLE K CONVENIENCE STORE)	57,309 S.F. OR 1.316 AC.
BUILDING AREA	4,430 S.F. (1.73%)
CARWASH	2,921 S.F. (1.25%)
PERVIOUS AREA	14,772 S.F. (25.78%)
IMPERVIOUS AREA	42,537 S.F. (74.22%)
PARKING REQUIRED (14,430/1000SF) X 4.3 SPACES/1000 SF (RETAIL)	20 SPACES
PARKING PROVIDED	
REGULAR SPACES	19 SPACES
HANDICAP SPACES	2 SPACES
TOTAL	21 SPACES
LOT 2 (CULVER'S RESTAURANT)	56,014 S.F. OR 1.286 AC.
BUILDING AREA	4,466 S.F. (7.96%)
PERVIOUS AREA	12,883 S.F. (23.00%)
IMPERVIOUS AREA	43,131 S.F. (77.00%)
PARKING REQUIRED (14,430/1000SF) X 1 SPACES/1000 SF (RESTAURANT)	76 SPACES
PARKING PROVIDED	
REGULAR SPACES	67 SPACES
HANDICAP SPACES	3 SPACES
TOTAL	70 SPACES
LOT 3 (ACCESS RD/DETENTION FACILITY)	26,316 S.F. OR 0.604 AC.
PERVIOUS AREA	15,999 S.F. (60.79%)
IMPERVIOUS AREA	10,316 S.F. (39.21%)
TOTAL SITE PERVIOUS AREA	43,254 S.F. (32.98%)
TOTAL SITE IMPERVIOUS AREA	86,584 S.F. (67.02%)

### NOTES

- UNLESS OTHERWISE NOTED, ALL DIMENSIONS ARE TO THE BACK OF CURB.
- FOR MONUMENT AND BUILDING SIGN DIMENSIONS AND DETAILS SEE SIGNAGE PACKAGE PREPARED BY OTHERS.
- FOR PAVEMENT SECTION DETAILS, SEE SHEET 3.
- FOR AUTOTURN EXHIBITS FOR CIRCLE K TANKER TRUCK AND PER DOC. R94-232085 REALTY RESOURCES SUBDIVISION PER DOC. R94-232085.

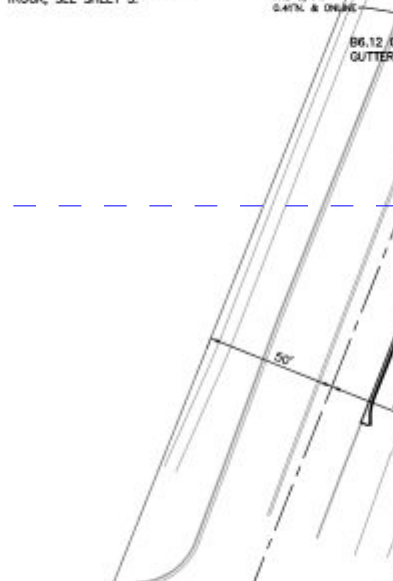

ROAKE AND ASSOCIATES, INC.  
CONSULTING ENGINEERS • LAND SURVEYORS • PLANNERS  
1084 QUINCY AVENUE, SUITE 100A • NAPERVILLE, ILLINOIS 60540  
TEL (833) 366-3252 • FAX (833) 366-5287

PREPARED FOR:  
TARTAN REALTY GROUP, INC.  
350 WEST HUBBARD STREET, #640  
CHICAGO, ILLINOIS 60654  
TEL (312) 377-8375  
FAX (312) 377-8351

### REVISIONS

NO.	DATE	DESCRIPTION	NO.	DATE	DESCRIPTION
1	10/22/18	REVISED PER INTERNAL REVIEW			
2	11/05/18	REVISED PER CITY ROW (10/19/18)			

### TARTAN POINT SUBDIVISION - NAPERVILLE, ILLINOIS

PRELIMINARY ENGINEERING - DIMENSION PLAN

DRN./CND. BY/SRN./JGC/MET FILE:	8533P	FLD. BK./PG:	273/30-31	SHEET NO.	1	OF	3
SCALE:	1"=30'	DATE:	09/25/18	JOB NO.:	853.003		

Sign Type: New Site  
Job Number #: 7030308  
Drawing Name: 7030308\_Culvers\_Naperville IL.cdr

Metro L 1.1  
DATE/REVISIONS 09/12/18 RM  
10/15/18 RM 02/25/19 JD  
12/04/18 RM 03/12/19 JD  
01/11/19 JD  
01/15/19 JD  
01/24/19 JD

## RESTAURANT SITE PLAN



934 N. Church Rd., Elmhurst, AZ 60126  
MEMBER INTERNATIONAL SIGN ASSOCIATION LISTED

© COPYRIGHT 2011, BY SOUTH WATER SIGNS, LLC.  
ALL DESIGNS AT THE SOLE PROPERTY OF SOUTH WATER, LLC.  
AND MAY NOT BE REPRODUCED IN PART OR WHOLE WITHOUT WRITTEN PERMISSION FROM SOUTH WATER SIGNS, LLC.



**Culver's of Naperville**  
1515 N. Naper Blvd.  
Naperville, IL

Sign Type: New Site  
Job Number #: 7030308  
Drawing Name:  
7030308\_Culvers\_Naperville IL.cdr

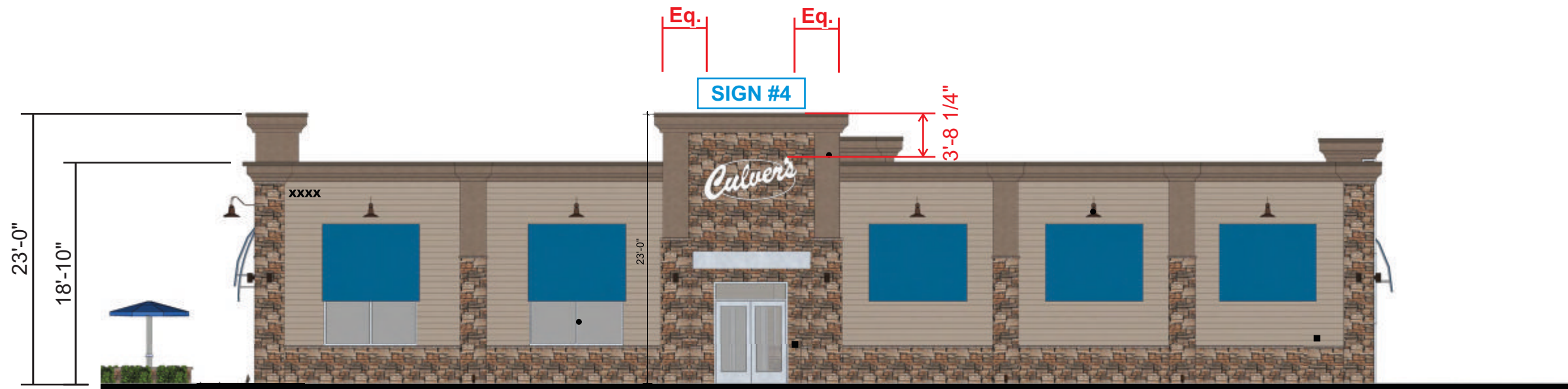

**North Building Elevation -**  
Scale 3/32" = 1'-0"

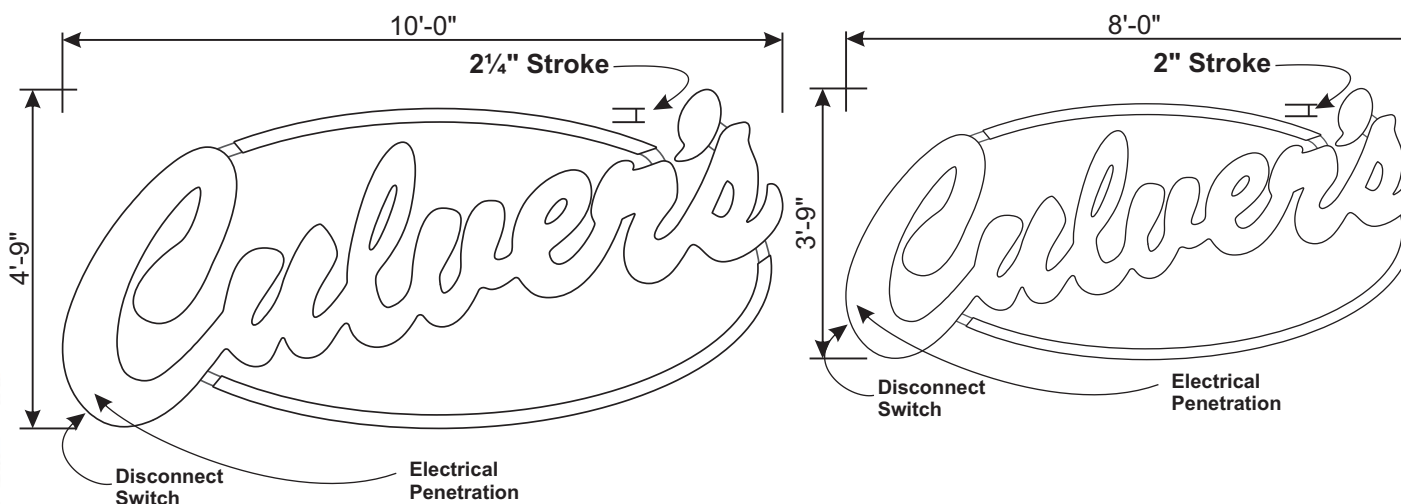

**SL-45W Illum. Script Channel Sign -**

Scale 3/8" = 1'-0"  
Qty Required: (1) Letterset

**SIGN #3**

**Specifications:**

- Channel Letter Returns: Blue - .040 Aluminum at 5" Depth
- Channel Letter Backs: White - .063 Aluminum
- Channel Letter Trim Caps: White
- Letter Faces: White Polycarb
- Illumination: Internally illuminated with White LEDs
- Electrical: 60W Power Supply
- Square Footage: 45.0

**Electrical Specifications:**

- LEDs: Sylvania Chain X1 Modules (3) #71071  
(13) Top Swoop, (18) Bottom Swoop, (78) Ltrs  
**(109) Modules Total**
- Power Supply: (3) Sylvania #51603
- Line Load: 1.6 Amps @ 120 VAC  
90 Watts - Total System

**SL-30W Illum. Script Channel Sign -**

Scale 3/8" = 1'-0"  
Qty Required: (1) Letterset

**SIGN #4**

**Specifications:**

- Channel Letter Returns: Blue - .040 Aluminum at 5" Depth
- Channel Letter Backs: White - .063 Aluminum
- Channel Letter Trim Caps: White
- Letter Faces: White Polycarb
- Illumination: Internally illuminated with White LEDs
- Electrical: 60W Power Supply
- Square Footage: 30.0

**Electrical Specifications:**

- LEDs: Sylvania Chain X1 Modules (2) #71071  
(10) Top Swoop, (14) Bottom Swoop, (63) Ltrs  
**(87) Modules Total**
- Power Supply: (2) Sylvania #51603
- Line Load: 1.28 Amps @ 120 VAC  
76 Watts - Total System

Metro L 1.2

DATE/REVISIONS	09/12/18 RM
10/15/18 RM	02/25/19 JD
12/04/18 RM	03/12/19 JD
01/11/19 JD	
01/15/19 JD	
01/24/19 JD	

**BUILDING ELEVATIONS**



934 N. Church Rd., Elmhurst, AZ 60126



© COPYRIGHT 2011, BY SOUTH WATER SIGNS, LLC.  
ALL DESIGNS AT THE SOLE PROPERTY OF SOUTH WATER, LLC.  
AND MAY NOT BE REPRODUCED IN PART OR WHOLE WITHOUT  
WRITTEN PERMISSION FROM SOUTH WATER SIGNS, LLC.

**West Building Elevation -**  
Scale 3/32" = 1'-0"

**NOTE:**  
Sign placement shown is approximate and is for concept purposes.  
Field verification of exact building dimensions will be required once  
structure is complete.





**Culver's of Naperville**  
1515 N. Naper Blvd.  
Naperville, IL

Sign Type: New Site  
Job Number #: 7030308  
Drawing Name:  
7030308\_Culvers\_Naperville IL.cdr



**South Building Elevation -**

Scale 3/32" = 1'-0"

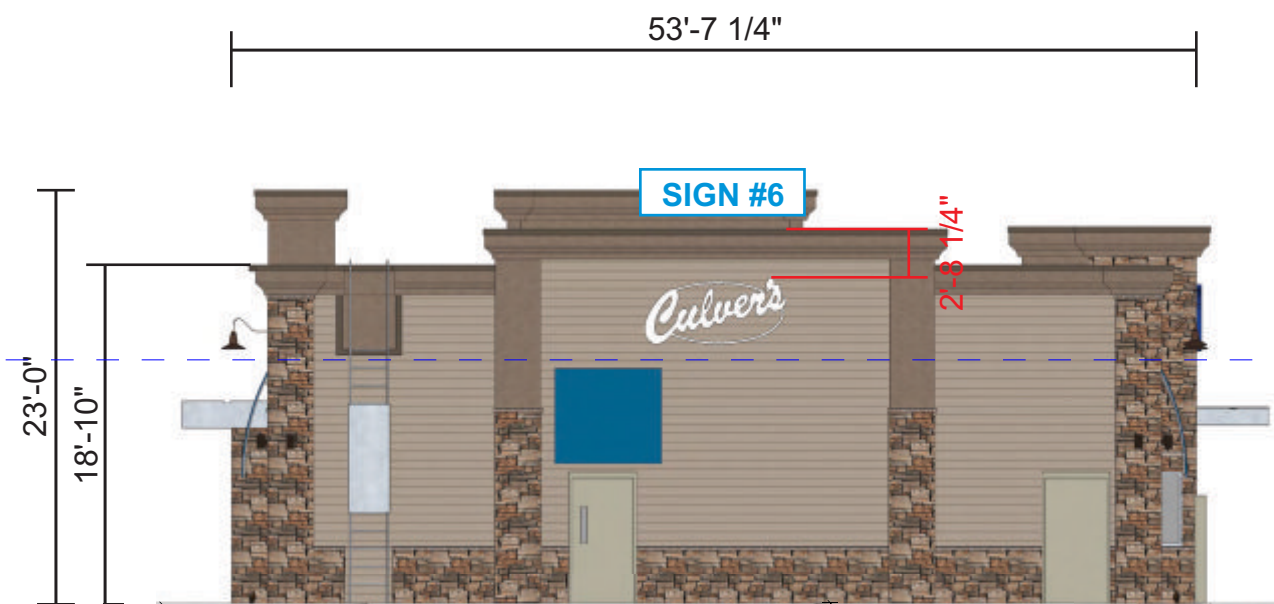

**West Building Elevation -**

Scale 3/32" = 1'-0"

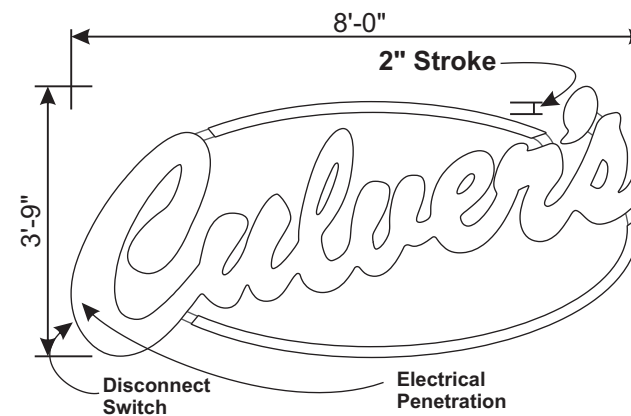

**SL-30W Illum. Script Channel Sign -**

Scale 3/8" = 1'-0"

Qty Required: (1) Letterset

**SIGN #6**

**Specifications:**

- Channel Letter Returns: Blue - .040 Aluminum at 5" Depth
- Channel Letter Backs: White - .063 Aluminum
- Channel Letter Trim Caps: White
- Letter Faces: White Polycarb
- Illumination: Internally illuminated with White LEDs
- Electrical: 60W Power Supply
- Square Footage: 30.0

**Electrical Specifications:**

- LEDs: Sylvania Chain X1 Modules (2) #71071  
(10) Top Swoop, (14) Bottom Swoop, (63) Ltrs  
(87) Modules Total
- Power Supply: (2) Sylvania #51603
- Line Load: 1.28 Amps @ 120 VAC  
76 Watts - Total System

Metro L 1.3

DATE/REVISIONS	09/12/18 RM
10/15/18 RM	02/25/19 JD
12/04/18 RM	03/12/19 JD
01/11/19 JD	
01/15/19 JD	
01/24/19 JD	

**BUILDING ELEVATIONS**



934 N. Church Rd., Elmhurst, AZ 60126



© COPYRIGHT 2011, BY SOUTH WATER SIGNS, LLC.  
ALL DESIGNS AT THE SOLE PROPERTY OF SOUTH WATER, LLC.  
AND MAY NOT BE REPRODUCED IN PART OR WHOLE WITHOUT  
WRITTEN PERMISSION FROM SOUTH WATER SIGNS, LLC.

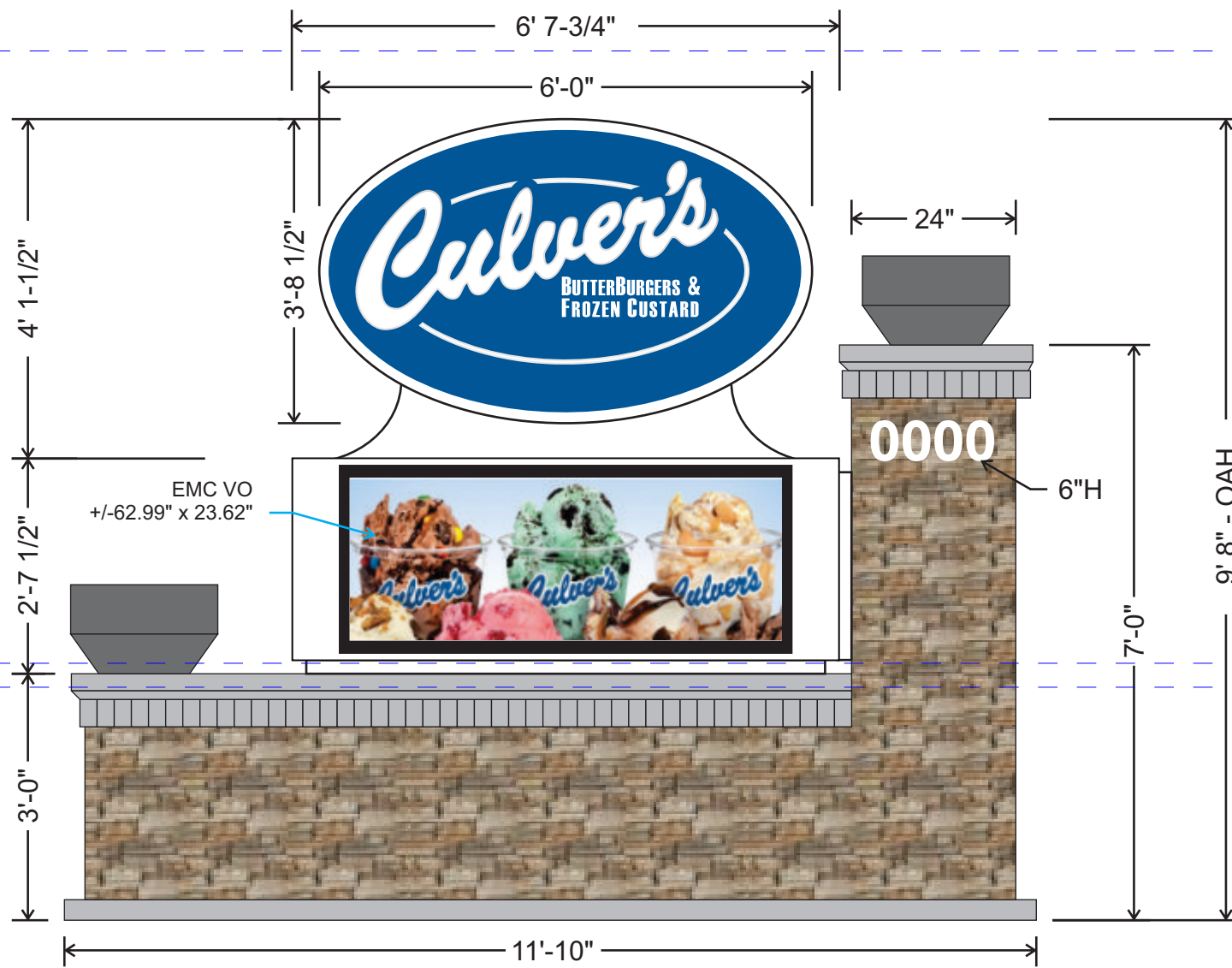

**SIGN #1**

**D/F Illuminated Monument Sign - with Full Color EMC**

Scale 1/2" = 1'-0"

**Specifications:**

- *Sign Cabinet:* Aluminum
  - *Face Panels:* .1875 White polycarbonate panel with block out vinyl and applied blue graphics, white copy reversed out to illuminate white
  - *Access:* Remove sign face to service inside of sign
  - *Wind Load:* Maximum wind load 30 psf
  - *EMC Surrounding Cabinet:* Aluminum
  - *EMC Copy Color:* **Full Color - 16mm**
  - *EMC Electrical Spec:* 120 VAC
  - *EMC Frame Rate:* 65 frames per second
- \*Per local code static images only, and change no more than once every 10 seconds.

**Color Specifications:**

- *Sign Exterior:* Matthews N202 White or Equivalent
- *Sign Graphics:* Color - Blue / PMS - 294c / 3M - Vq109041

**Base & Foundation:**

- Brick & stone foundation - To Match Building Brick  
(Brick base done by others)
- Cast limestone caps
- Planters - exact specifications TBD
- Address copy - 1/2"Th painted FCO aluminum numerals stud mounted flush

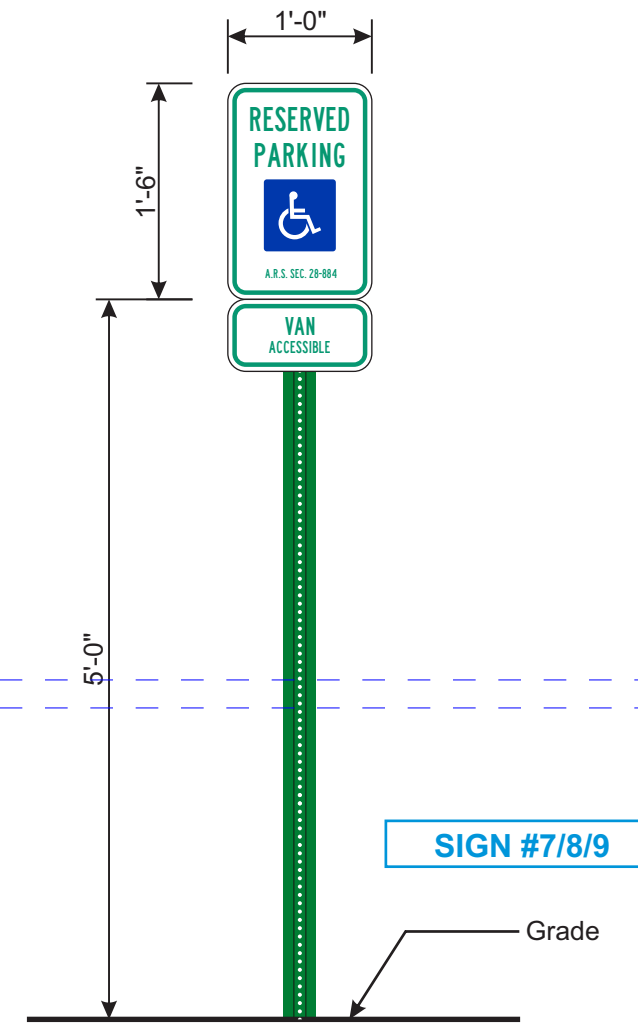

**REG-HC-1 Regulatory Sign -**

Scale 3/4" = 1'-0"  
Qty Required: (2) Signs

**Specifications:**

- *Sign Face:* Corrosion-resistant Aluminum
- *Sign Pole:* Steel Channel
- *Decoration:* Sign Face - Reflective enamel finish for day/night visibility  
Pre-drilled sign face.  
Complies with federal guidelines  
Pole - Baked enamel green
- *Area:* 1.5 Sq Ft
- *Weight (Est.):* 25 lbs. (crated) - 15 lbs. (uncrated)
- *Wind Load:* Maximum wind load 35 psf

Design to match City of Chandler required specifications



**Culver's of Naperville**  
1515 N. Naper Blvd.  
Naperville, IL

Sign Type: New Site  
Job Number #: 7030308  
Drawing Name:  
7030308\_Culvers\_Naperville IL.cdr

Metro L 1.4.1

DATE/REVISIONS	09/12/18 RM
10/15/18 RM	02/25/19 JD
12/04/18 RM	03/12/19 JD
01/11/19 JD	
01/15/19 JD	
01/24/19 JD	

**MAIN GROUND SIGNAGE**



934 N. Church Rd., Elmhurst, AZ 60126



© COPYRIGHT 2011, BY SOUTH WATER SIGNS, LLC.  
ALL DESIGNS AT THE SOLE PROPERTY OF SOUTH WATER, LLC.  
AND MAY NOT BE REPRODUCED IN PART OR WHOLE WITHOUT  
WRITTEN PERMISSION FROM SOUTH WATER SIGNS, LLC.

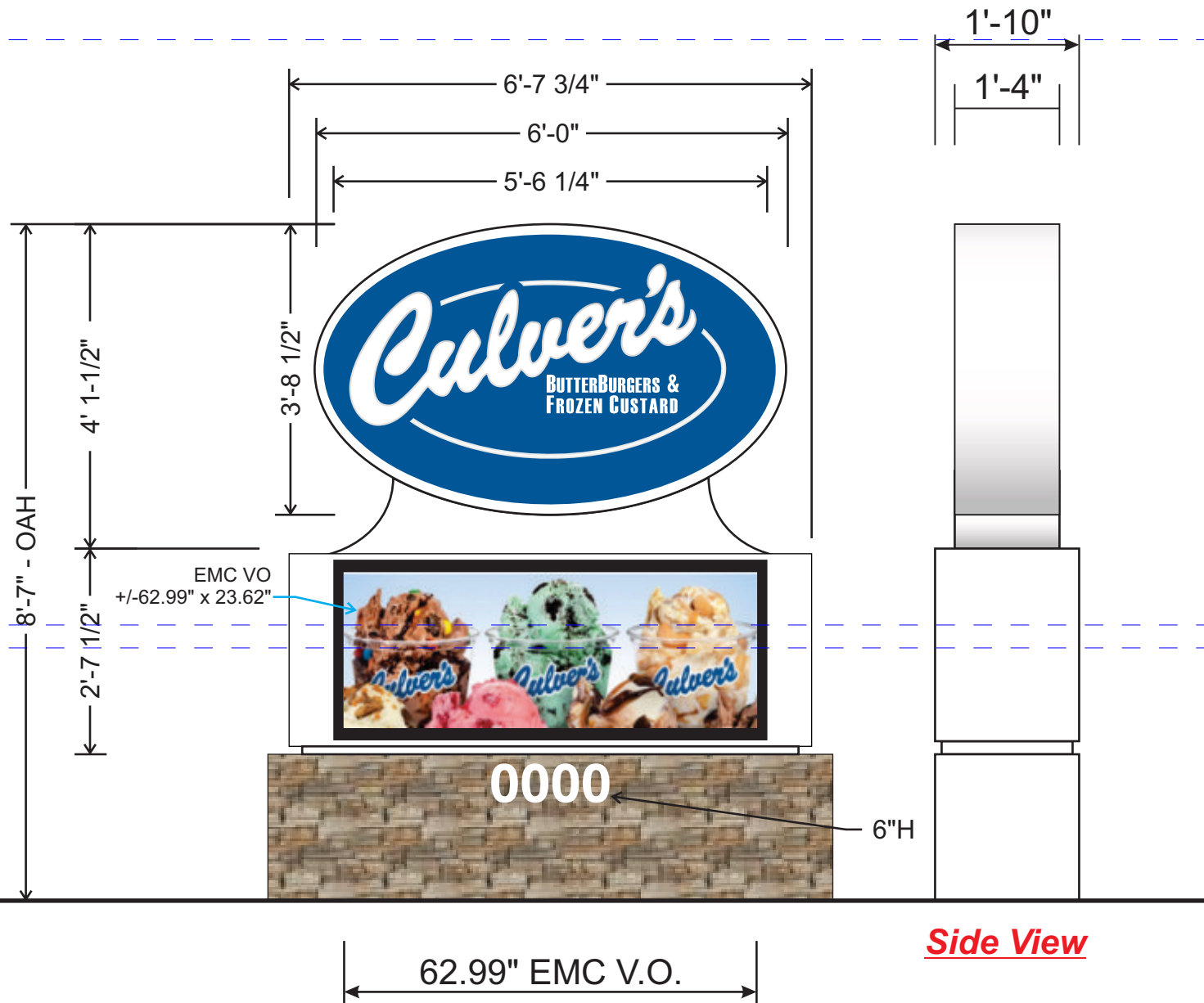

**Side View**

**SIGN #2**

**D/F Illuminated Monument Sign - with EMC**

Scale 1/2" = 1'-0"  
Qty Required: (1) Sign

**Specifications:**

- Sign Cabinet: Aluminum
- Face Panels: .1875 White polycarbonate panel with block out vinyl and applied blue graphics, white copy reversed out to illuminate white
- Access: Remove sign face to service inside of sign
- Wind Load: Maximum wind load 30 psf
- EMC Surrounding Cabinet: Aluminum
- EMC Copy Color: **Full Color - 16mm**
- EMC Electrical Spec: 120 VAC
- EMC Frame Rate: 65 frames per second

\*Per local code static images only, and change no more than once every 10 seconds.

**Color Specifications:**

- Sign Exterior: Matthews N202 White or Equivalent
- Sign Graphics: Color - Blue / PMS - 294c / 3M - Vq109041

**Base Specifications:**

- Fabricated aluminum frame with secured concrete board
- Thin-Brick veneer applied to concrete board - To Match Building Brick  
(Brick base done by others)
- Address copy - 1/2"Th painted FCO aluminum numerals stud mounted flush



**Culver's of Naperville**  
1515 N. Naper Blvd.  
Naperville, IL

Sign Type: New Site  
Job Number #: 7030308  
Drawing Name:  
7030308\_Culvers\_Naperville IL.cdr

Metro L 1.4.2

DATE/REVISIONS	09/12/18 RM
10/15/18 RM	02/25/19 JD
12/04/18 RM	03/12/19 JD
01/11/19 JD	
01/15/19 JD	
01/24/19 JD	

**MAIN GROUND SIGNAGE**



934 N. Church Rd., Elmhurst, AZ 60126



© COPYRIGHT 2011, BY SOUTH WATER SIGNS, LLC.  
ALL DESIGNS AT THE SOLE PROPERTY OF SOUTH WATER, LLC.  
AND MAY NOT BE REPRODUCED IN PART OR WHOLE WITHOUT WRITTEN PERMISSION FROM SOUTH WATER SIGNS, LLC.

**Culver's of Naperville**  
1515 N. Naper Blvd.  
Naperville, IL

Sign Type: New Site  
Job Number #: 7030308  
Drawing Name:  
7030308\_Culvers\_Naperville IL.cdr

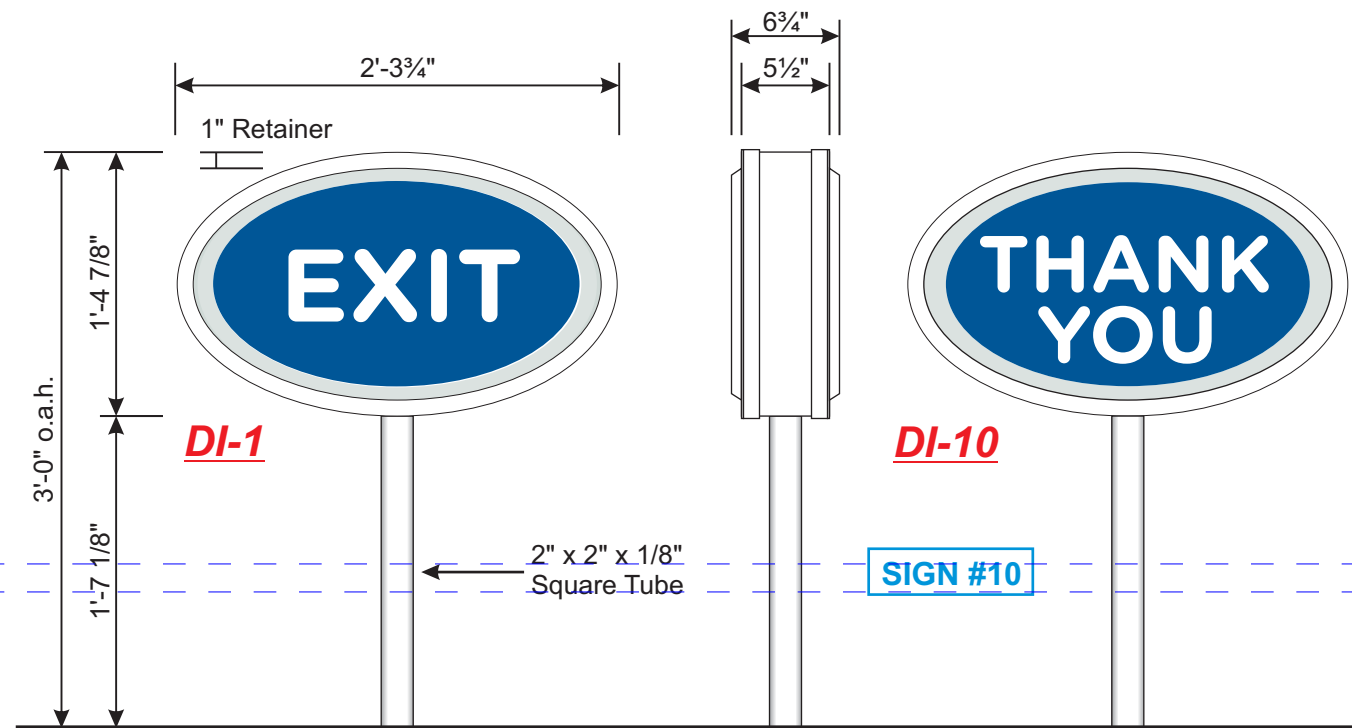

**NOTE: Landscaping by Owner**

**Side View**

**DI D.F. Illuminated Directional - LED**

Scale 1" = 1'-0"

**Specifications:**

- Sign Cabinet: .063 Aluminum cabinet
- Face Panels: .118 White Thermoformed SG Polycarbonate with Translucent film first surface
- Access: Remove sign face to service inside of sign
- Area: 3.2 Sq Ft.
- Wind Load: Maximum wind load 30 psf

**Electrical Specifications:**

- LEDs: Sylvania Chain X1 Modules (1) #71071
- Power Supply: (1) Sylvania #51603/51632
- Line Load: .64 Amps @ 120 VAC

**Color Specifications:**

- Sign Exterior: Matthews N202 White or Equivalent
- Sign Graphics: Color - Blue / PMS - 294c / 3M - VQ109041

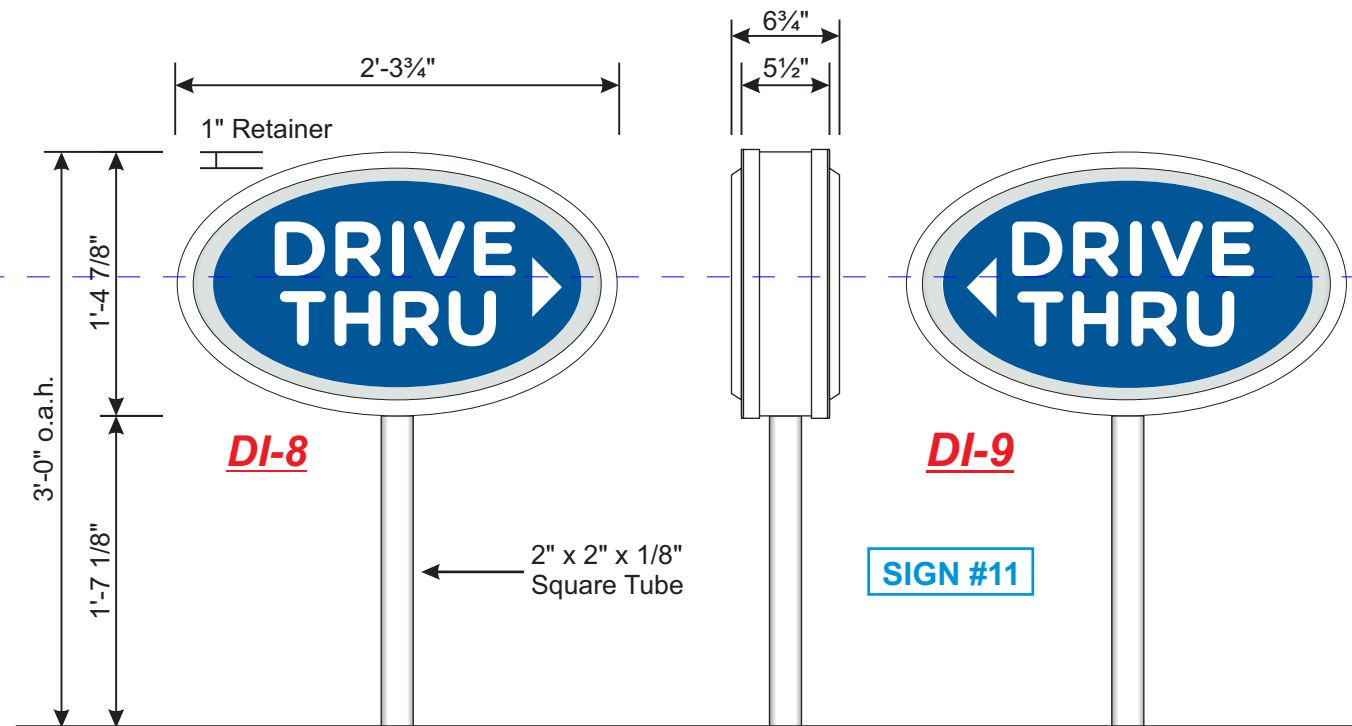

**NOTE: Landscaping by Owner**

**Side View**

Metro L 1.6

DATE/REVISIONS	09/12/18 RM
10/15/18 RM	02/25/19 JD
12/04/18 RM	03/12/19 JD
01/11/19 JD	
01/15/19 JD	
01/24/19 JD	

**DRIVE-THRU SIGNAGE**



934 N. Church Rd., Elmhurst, AZ 60126



© COPYRIGHT 2011, BY SOUTH WATER SIGNS, LLC.  
ALL DESIGNS AT THE SOLE PROPERTY OF SOUTH WATER, LLC.  
AND MAY NOT BE REPRODUCED IN PART OR WHOLE WITHOUT  
WRITTEN PERMISSION FROM SOUTH WATER SIGNS, LLC.

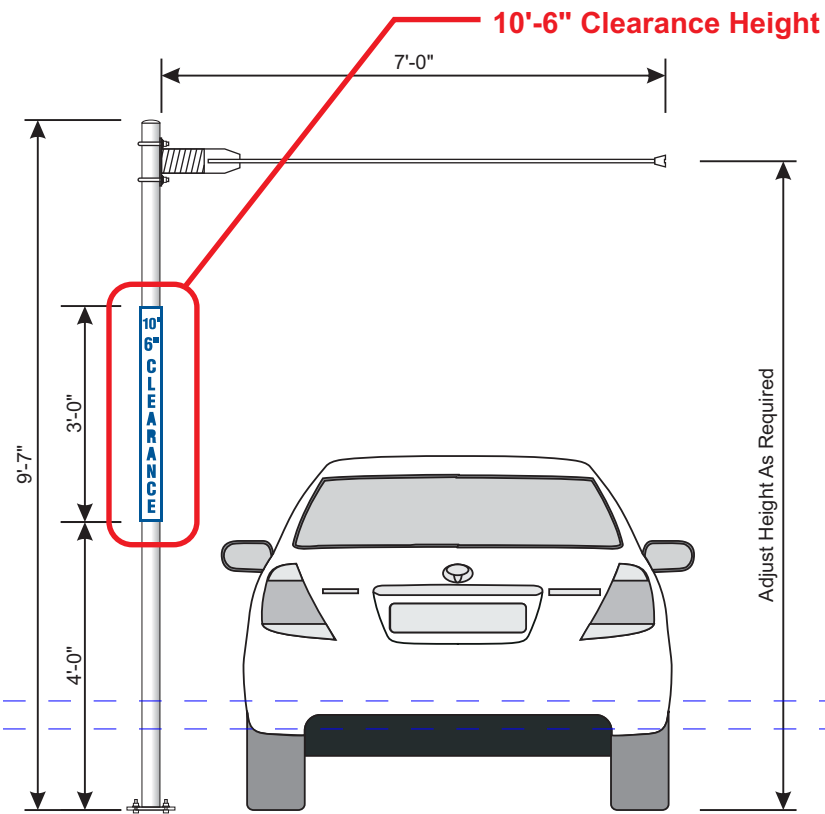

NOTE: Standard post height is 9'-0" but will vary by location.

### VHD-1 Vehicle Height Detector -

Scale 3/8" = 1'-0"  
Qty Required: (1) Sign

#### Specifications:

- Sign Face: .063 White Pre-Coat White Aluminum Panel - Bristol Blue vinyl copy 1st surface
- Sign Pole: Steel - White Finish
- Area: 1.92 Sq Ft
- Weight (Est.): 210 lbs. (crated) - 170 lbs. (uncrated)
- Wind Load: Maximum wind load 35 psf

#### Color Specifications:

- Sign Exterior: Matthews N202 White or Equivalent
- Sign Graphics: Color - Bristol Blue / PMS - 294c / 3M - 3632-97VQ

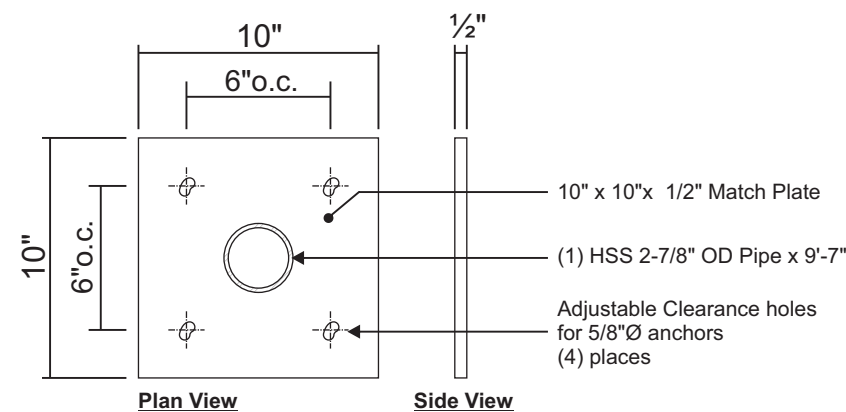

### Match Plate Layout for VHD

Scale 1 1/2" = 1'-0"

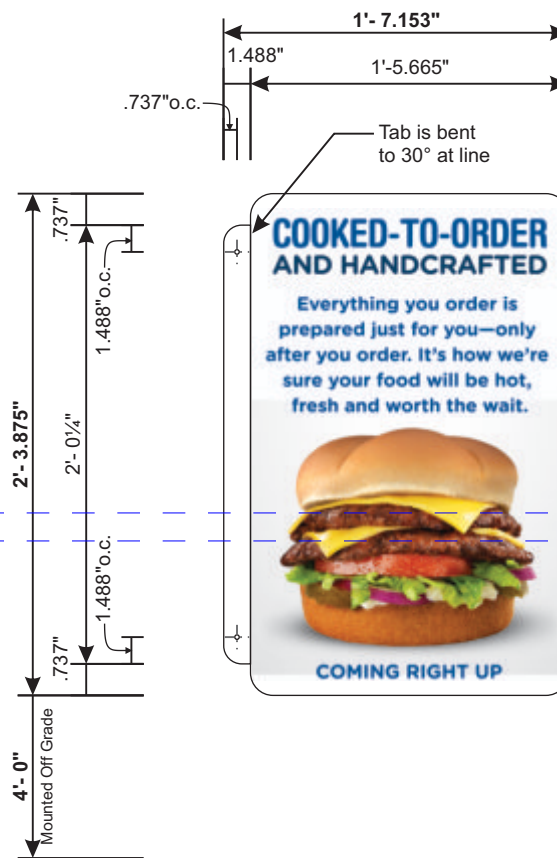

### OBS-1 Outdoor Blade Sign -

Scale 1" = 1'-0"  
Qty Required: (1) Sign

#### Specifications:

- Materials: .090 Aluminum Panel
- Decoration: Reflective #480-71 Yellow Vinyl with Spot Black Printed #220-10 White opaque vinyl with spot color # GCS-37 Bristol Blue printed copy.
- Area: 2.29 Sq Ft
- Weight (Est.): 25 lbs. (crated) - 10 lbs. (uncrated)
- Wind Load: Maximum wind load 35 psf

#### Color Specifications:

- Sign Exterior: Matthews N202 White or Equivalent

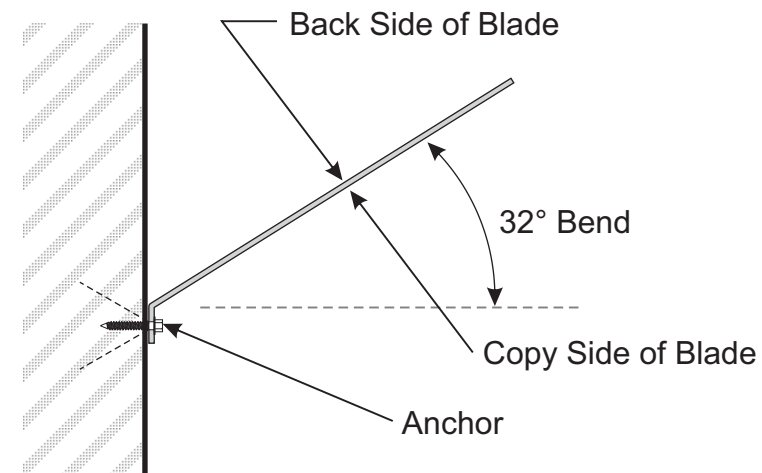

Top View

### OPTIONAL FLAG MOUNTED INSTALLATION



Culver's of Naperville  
1515 N. Naper Blvd.  
Naperville, IL

Sign Type: New Site  
Job Number #: 7030308  
Drawing Name: 7030308\_Culvers\_Naperville IL.cdr

Metro L 1.7

DATE/REVISIONS 09/12/18 RM  
10/15/18 RM 02/25/19 JD  
12/04/18 RM 03/12/19 JD  
01/11/19 JD  
01/15/19 JD  
01/24/19 JD

DRIVE THRU



934 N. Church Rd., Elmhurst, AZ 60126



© COPYRIGHT 2011, BY SOUTH WATER SIGNS, LLC.  
ALL DESIGNS AT THE SOLE PROPERTY OF SOUTH WATER, LLC.  
AND MAY NOT BE REPRODUCED IN PART OR WHOLE WITHOUT WRITTEN PERMISSION FROM SOUTH WATER SIGNS, LLC.



**Culver's of Naperville**  
 1515 N. Naper Blvd.  
 Naperville, IL

Sign Type: New Site  
 Job Number #: 7030308  
 Drawing Name:  
7030308\_Culvers\_Naperville IL.cdr

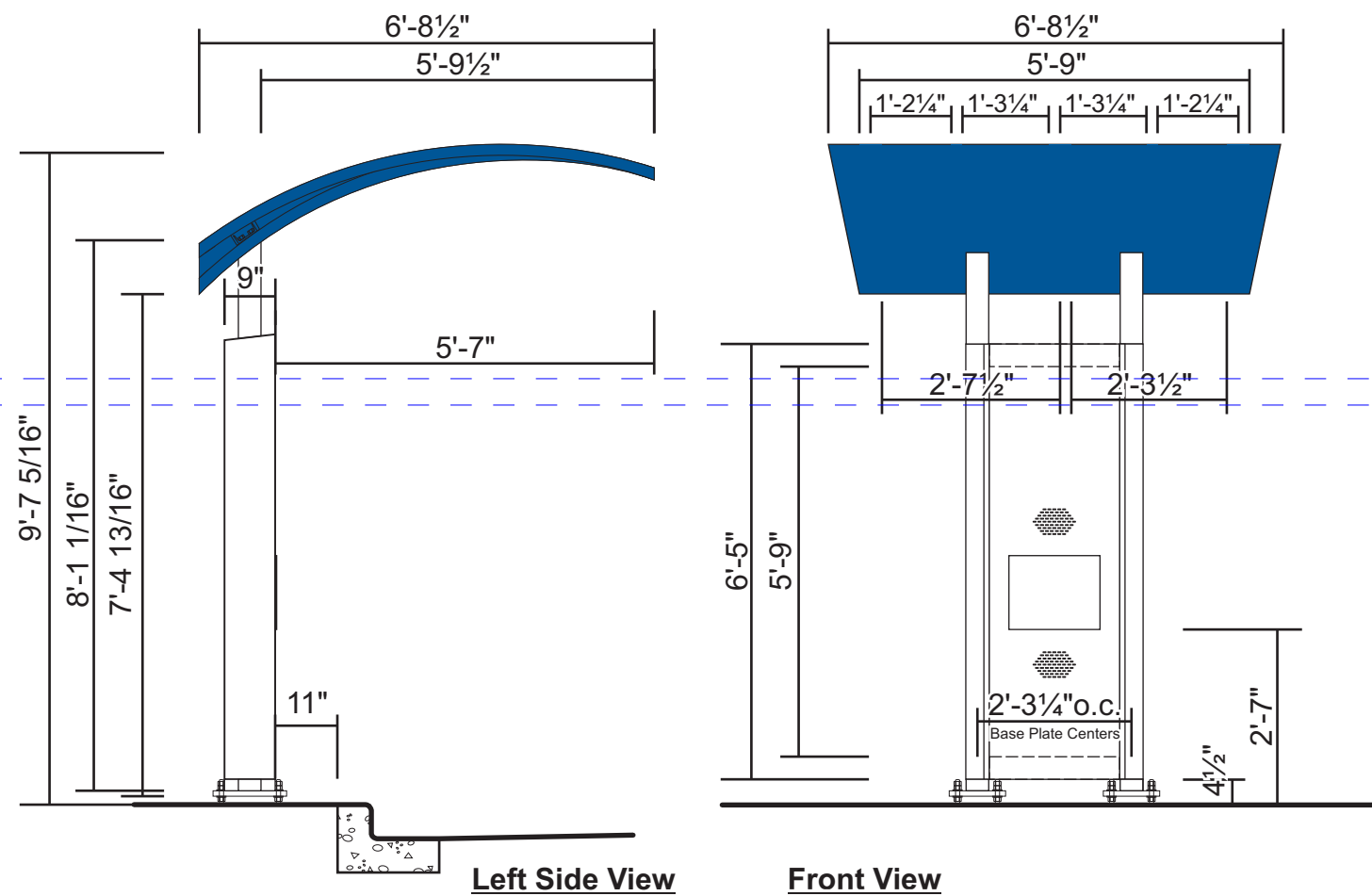

**Canopy System For Confirmation Speaker**

Scale 3/8" = 1'-0"

Qty Required: (1) Sign

**Specifications:**

- Sign Cabinet: Aluminum

**Color Specifications:**

- Sign Exterior: Matthews N202 White or Equivalent
- Sign Graphics: Color - Blue / PMS - 294c / 3M - VQ109041

Metro L 1.8

DATE/REVISIONS	09/12/18 RM
10/15/18 RM	02/25/19 JD
12/04/18 RM	03/12/19 JD
01/11/19 JD	
01/15/19 JD	
01/24/19 JD	

**CONFIRMATION CANOPY**



934 N. Church Rd., Elmhurst, AZ 60126



© COPYRIGHT 2011, BY SOUTH WATER SIGNS, LLC.  
 ALL DESIGNS AT THE SOLE PROPERTY OF SOUTH WATER, LLC.  
 AND MAY NOT BE REPRODUCED IN PART OR WHOLE WITHOUT  
 WRITTEN PERMISSION FROM SOUTH WATER SIGNS, LLC.

**NOTE:**  
Please keep areas under the exterior menu boards clear. Difficulties with the grease traps have occurred and other items running or being located under them.

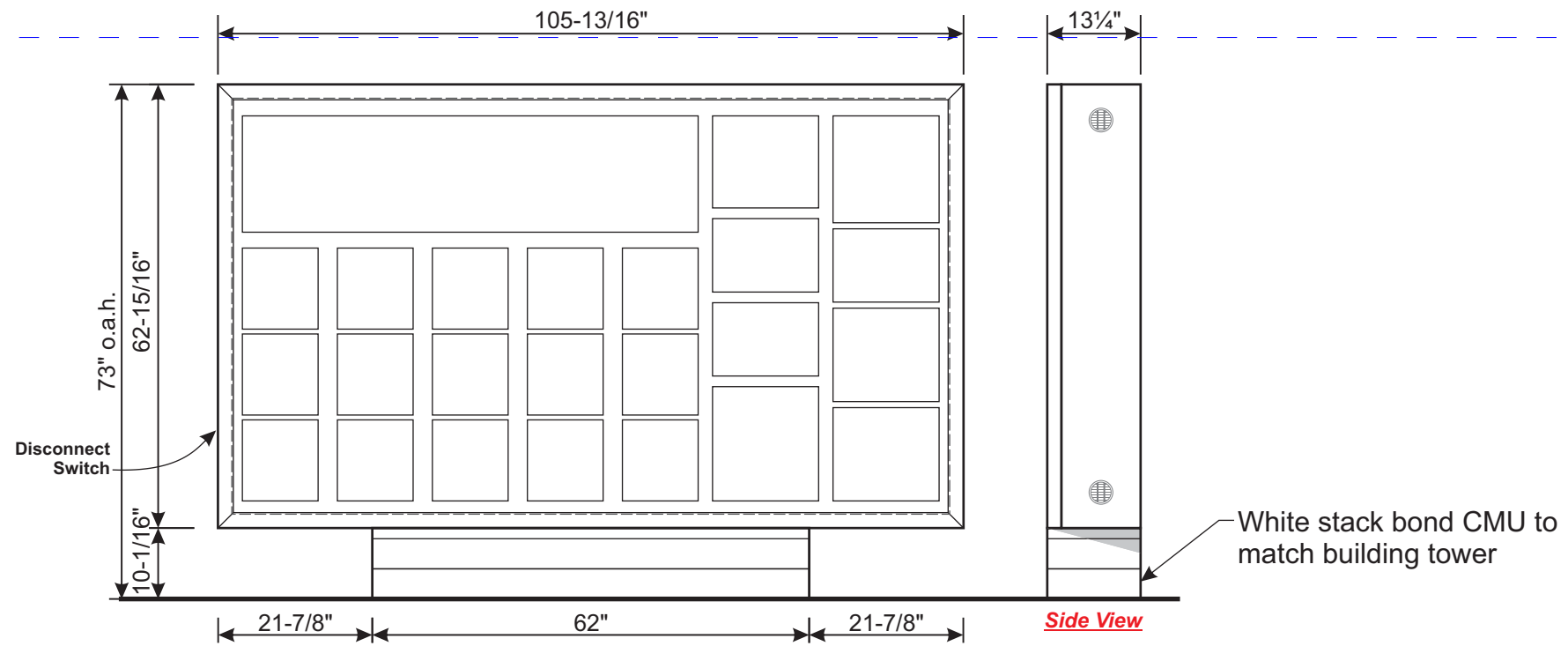

**MB-DT-46 Drive Thru Menu Board - Illuminated with LEDs**

Scale 1/2" = 1'-0"  
Qty Required: (1) Sign

**Specifications:**

- Sign Cabinet: Extruded Aluminum
- Face Panels: .150 White Flat SG Polycarbonate
- Access: Open front door to service sign cabinet
- Wind Load: Maximum wind load 35 psf
- Weight (Est.): 541 lbs. (crated) - 480 lbs. (uncrated)

**Color Specifications:**

- Sign Exterior: Matthews N202 White or Equivalent

**Electrical Specifications:**

- LEDs: Sylvania Chain X1 Modules (4) #71071 (4) Rows @ 14 Modules per door (224) Modules Total
- Power Supply: (3) Sylvania #51603/51632
- Line Load: 1.28 Amps @ 120 VAC 97 Watts - Total System

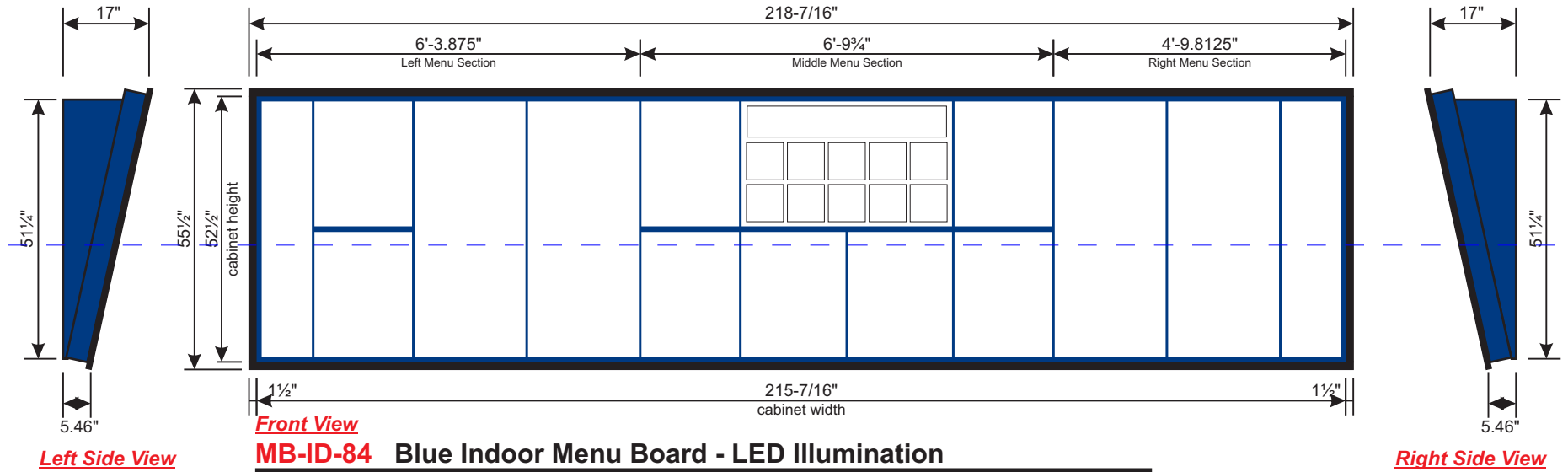

**MB-ID-84 Blue Indoor Menu Board - LED Illumination**

Scale 1/2" = 1'-0"  
Qty Required: (1) Sign

**Specifications:**

- Sign Cabinet: 1 1/2" wide x 1/2" thick red oak (1-coat clear satin polyurethane sealer) used for perimeter menuboard trim. Overall nominal dimensions: 218-5/8" w x 53 1/2" h x 15-5/8" d Square Footage: 81.23 Sq Ft
- Sign Cabinet Finish: New Builds trim painted Std Black

**Design Parameters:**

- UL Compliant
- Formed aluminum cabinet (welded construction)
- Outside of cabinet (visible areas) powder coated to match PMS 294c Blue

**Electrical Specifications:**

- LEDs: Sylvania Chain X1 Modules (7) #71071 (9) Rows @ 37 Modules per row (333) Modules Total
- Power Supply: (5) Sylvania #51603/51632
- Line Load: 3.2 Amps @ 120 VAC 290 Watts - Total System

**POP Frames:**

- Extruded aluminum frames
- .060" Clear non-glare acrylic front and (1) .060" Clear gloss acrylic backer plastic per frame element.

**NOTE:**  
All interior menu boards set mountings are to be field verified ensuring they are centered in alignment to the front order counter, typically item #90 in our plan sets.  
**Deviation of this is only by CFSI approval, not at direction of GC, franchise owner, etc.**



**Culver's of Naperville**  
1515 N. Naper Blvd.  
Naperville, IL

Sign Type: New Site  
Job Number #: 7030308  
Drawing Name: 7030308\_Culvers\_Naperville IL.cdr

Metro L 1.9

DATE/REVISIONS	09/12/18 RM
10/15/18 RM	02/25/19 JD
12/04/18 RM	03/12/19 JD
01/11/19 JD	
01/15/19 JD	
01/24/19 JD	

**MENU BOARD SIGNAGE**



934 N. Church Rd., Elmhurst, AZ 60126



© COPYRIGHT 2011, BY SOUTH WATER SIGNS, LLC.  
ALL DESIGNS AT THE SOLE PROPERTY OF SOUTH WATER, LLC.  
AND MAY NOT BE REPRODUCED IN PART OR WHOLE WITHOUT WRITTEN PERMISSION FROM SOUTH WATER SIGNS, LLC.



**NOTE:** Store hours to be verified with each store owner prior to fabrication

**V-1a Blue Store Hours with Proudly Operated By Door Vinyls**

Scale 3" = 1'-0" Qty: (2) Required

**Specifications:**

- **Materials:** 3M Bristol Blue #3632-97VQ and 3M White
- **Installation:** Vinyl applied on **second surface** of glass window

**Color Specifications:**

- **Sign Graphics:** Color - Bristol Blue / PMS - 294c / 3M - 3632-97VQ
- **Sign Graphics:** Color - White / 3M - 7725-10 White

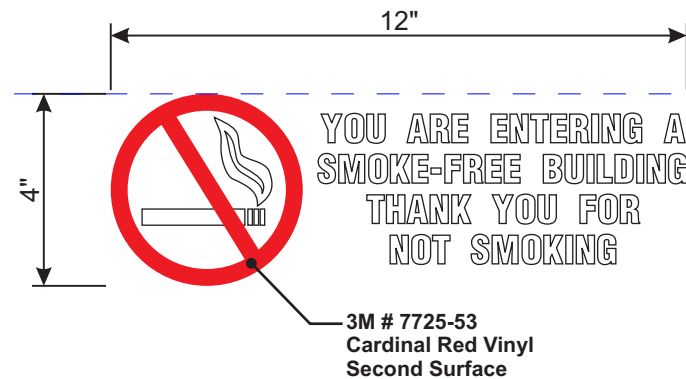

**V-2 White Vinyls -**

Scale 3" = 1'-0"

Qty Required: (2) Vinyls

**Specifications:**

- **Materials:** 3M Vinyl
- **Installation:** Vinyl applied on **second surface** of glass window

**Color Specifications:**

- **Sign Graphics:** Color - White / 3M 7725-10
- Color - Cardinal Red / 3M 7725-53

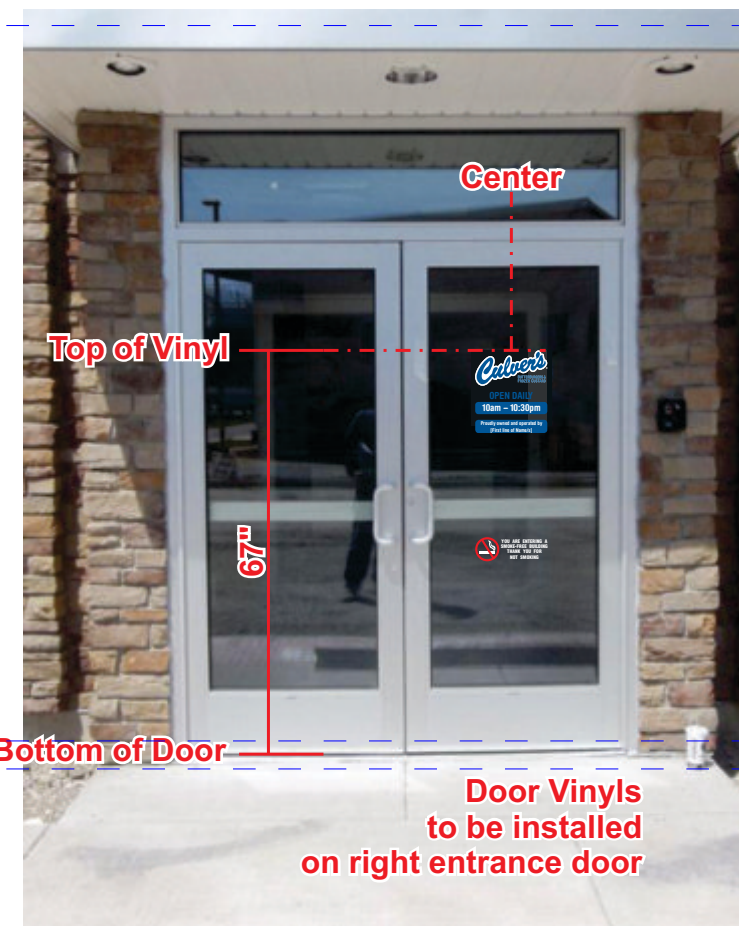

Typical Installation Example - Main Entrance



Typical Installation Example - Drive-Up Entrance



**Culver's of Naperville**  
1515 N. Naper Blvd.  
Naperville, IL

Sign Type: New Site

Job Number #: 7030308

Drawing Name:

7030308\_Culvers\_Naperville IL.cdr

Metro L 1.10

DATE/REVISIONS 09/12/18 RM

10/15/18 RM 02/25/19 JD

12/04/18 RM 03/12/19 JD

01/11/19 JD

01/15/19 JD

01/24/19 JD

**SIGNAGE**



934 N. Church Rd., Elmhurst, AZ 60126



© COPYRIGHT 2011, BY SOUTH WATER SIGNS, LLC.  
ALL DESIGNS AT THE SOLE PROPERTY OF SOUTH WATER, LLC.  
AND MAY NOT BE REPRODUCED IN PART OR WHOLE WITHOUT  
WRITTEN PERMISSION FROM SOUTH WATER SIGNS, LLC.

**Culver's of Naperville**  
1515 N. Naper Blvd.  
Naperville, IL

Sign Type: New Site  
Job Number #: 7030308  
Drawing Name:  
7030308\_Culvers\_Naperville IL.cdr

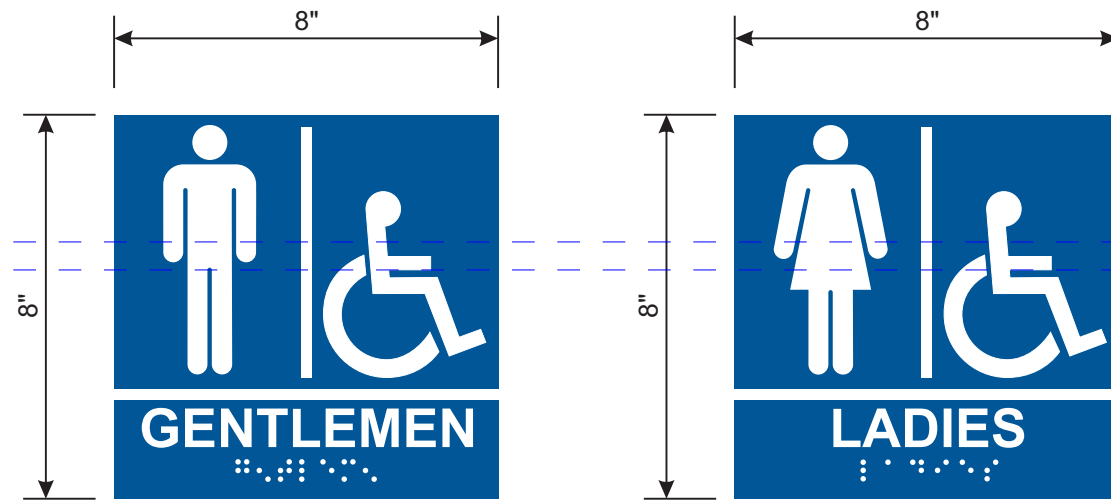

**RR-1**

### ADA Compliant Rest Room Signs -

Scale 3" = 1'-0"

**Specifications:**

- *Materials:* **ABS Plastic**
- *Decoration:* White copy on blue background
- *Area:* .44 Sq.Ft
- *Weight (Est.):* .5 lbs. (per set)
- *Installation:* VHB Tape on second surface  
Rest room signs are to be installed off grade 60" to the center of the sign on the wall alongside the door at the latch side.

**Color Specifications:**

- *Sign Graphics:* Color - Bristol Blue / PMS - 294c / 3M - VQ109041



**Finished Floor Grade**  
**Typical Installation Example -**

Metro L 1.11

DATE/REVISIONS	09/12/18 RM
10/15/18 RM	02/25/19 JD
12/04/18 RM	03/12/19 JD
01/11/19 JD	
01/15/19 JD	
01/24/19 JD	

### SIGNAGE



934 N. Church Rd., Elmhurst, AZ 60126



© COPYRIGHT 2011, BY SOUTH WATER SIGNS, LLC.  
ALL DESIGNS AT THE SOLE PROPERTY OF SOUTH WATER, LLC.  
AND MAY NOT BE REPRODUCED IN PART OR WHOLE WITHOUT  
WRITTEN PERMISSION FROM SOUTH WATER SIGNS, LLC.



**Culver's of Naperville**  
1515 N. Naper Blvd.  
Naperville, IL

Sign Type: New Site  
Job Number #: 7030308  
Drawing Name:  
7030308\_Culvers\_Naperville IL.cdr

Metro L 1.12

DATE/REVISIONS 09/12/18 RM  
10/15/18 RM 02/25/19 JD  
12/04/18 RM 03/12/19 JD  
01/11/19 JD  
01/15/19 JD  
01/24/19 JD

**F.C.O. LETTERS**



934 N. Church Rd., Elmhurst, AZ 60126



© COPYRIGHT 2011, BY SOUTH WATER SIGNS, LLC.  
ALL DESIGNS AT THE SOLE PROPERTY OF SOUTH WATER, LLC.  
AND MAY NOT BE REPRODUCED IN PART OR WHOLE WITHOUT  
WRITTEN PERMISSION FROM SOUTH WATER SIGNS, LLC.

**FCO-1S FCO Interior Sign -**

Scale 1½" = 1'-0"

**Specifications:**

• **"Culver's" FCO:** Black ¼" thick acrylic with .040 Brushed Pewter Aluminum #916 overlay attached with 3M super 77 adhesive. 6" studs and VHB to be used for installation. FCO letters must be mounted 6'-6" after finished floor is installed to the center of the copy.

• **PLEASE NOTE:** The "C" is lower than the "s" (as shown on drawing). Letters must be on the same plane as they are typically mounted on uneven surfaces. Some letters may stand off of the wall surface and some may be flush mounted. (Typical Installation for uneven surfaces)

**IF AN OWNER WOULD LIKE TO CHANGE THAT POSITION, SOUTH WATER SIGNS MUST APPROVE THE LOCATION CHANGE VIA CFSI SUPPORT TEAM.**

• **Secondary FCO letters on a background "Naperville, IL":** Black ¼" thick acrylic with .040 Brushed Pewter Aluminum #916 overlay attached with 3M super 77 adhesive. FCO letters are then attached to a Chemetal #902 brushed aluminum background. 6" studs and VHB to be used for installation.

• **The Secondary FCO letters on a background "Naperville, IL" must be on the same plane as they are typically mounted on uneven surfaces. Some letters may stand off of the wall surface and some may be flush mounted. (Typical Installation for uneven surfaces)**

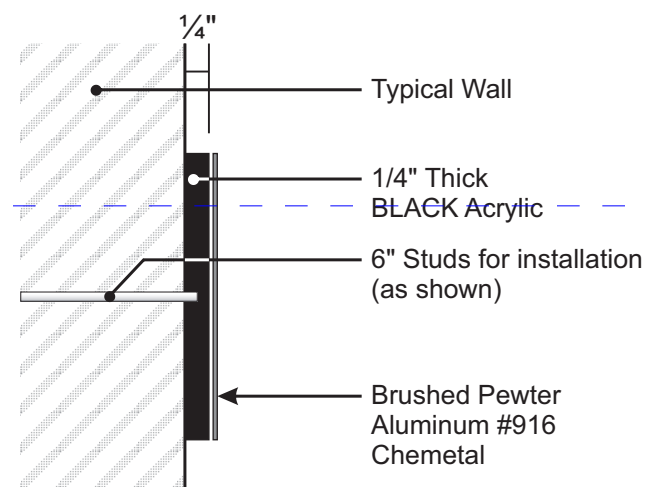
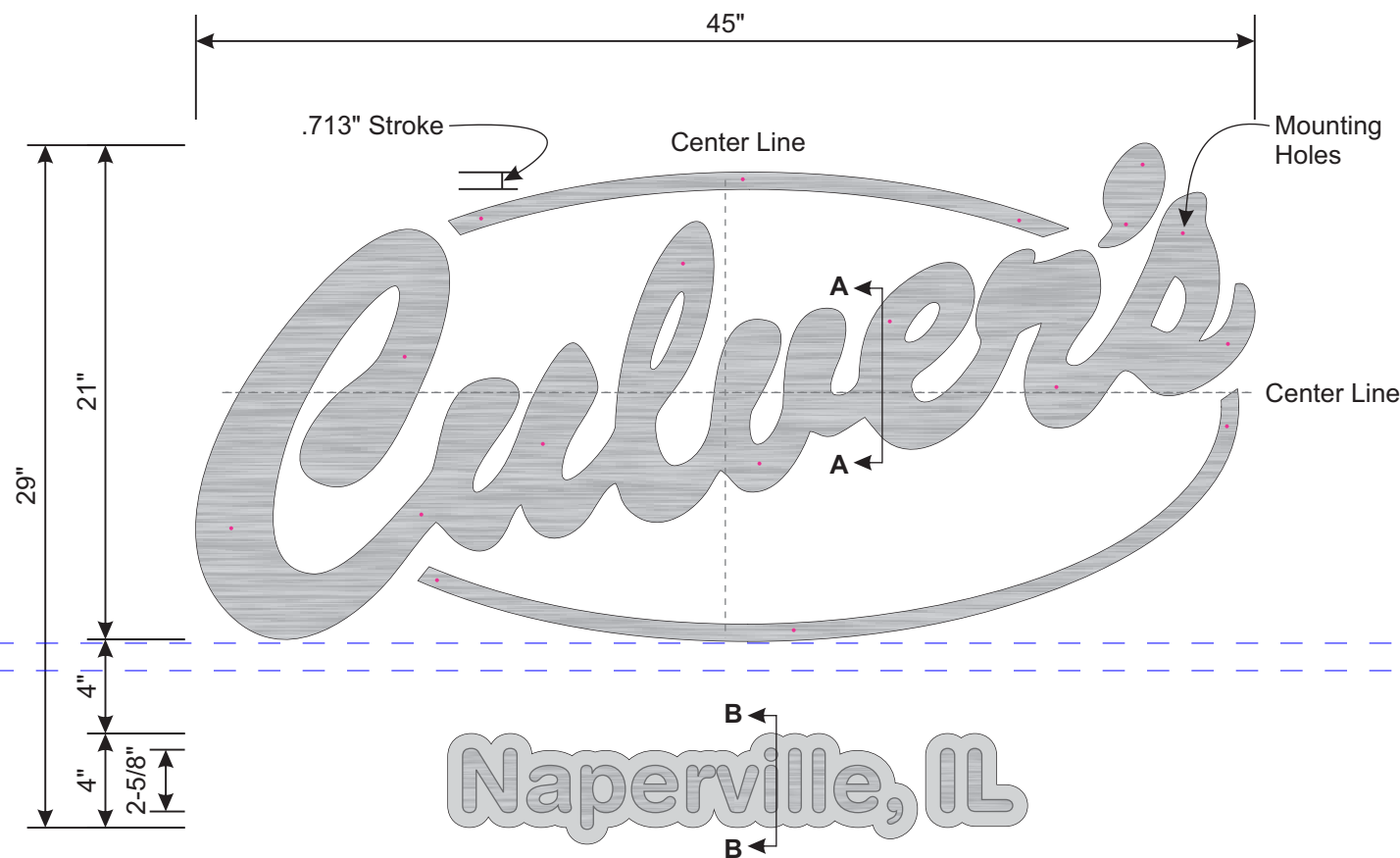

**"Culver's" Section View - A**

Scale 6" = 1'-0"

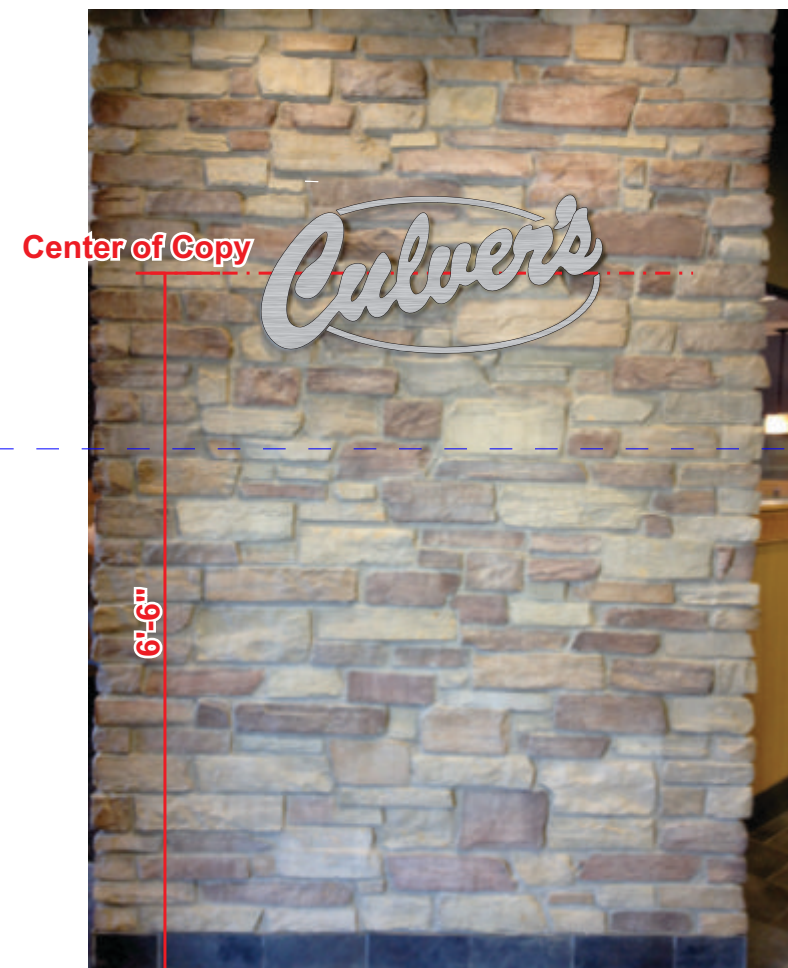

**Typical Installation Example -**



**Culver's of Naperville**  
1515 N. Naper Blvd.  
Naperville, IL

Sign Type: New Site  
Job Number #: 7030308  
Drawing Name:  
7030308\_Culvers\_Naperville IL.cdr

Metro L 1.13

DATE/REVISIONS	09/12/18 RM
10/15/18 RM	02/25/19 JD
12/04/18 RM	03/12/19 JD
01/11/19 JD	
01/15/19 JD	
01/24/19 JD	

### ADDRESS SIGNAGE



934 N. Church Rd., Elmhurst, AZ 60126



© COPYRIGHT 2011, BY SOUTH WATER SIGNS, LLC.  
ALL DESIGNS AT THE SOLE PROPERTY OF SOUTH WATER, LLC.  
AND MAY NOT BE REPRODUCED IN PART OR WHOLE WITHOUT  
WRITTEN PERMISSION FROM SOUTH WATER SIGNS, LLC.



### **FCO-N. Naper Blvd & Naperville Rd** Black Acrylic FCO's - Building Frontage

Scale 3" = 1'-0  
Qty Required: (1) Set of FCO's

**Specifications:**

- **Materials:** 1/4" Black Acrylic
- **Installation:** N. Naper Blvd & Naperville Rd numbers to be pin-mounted

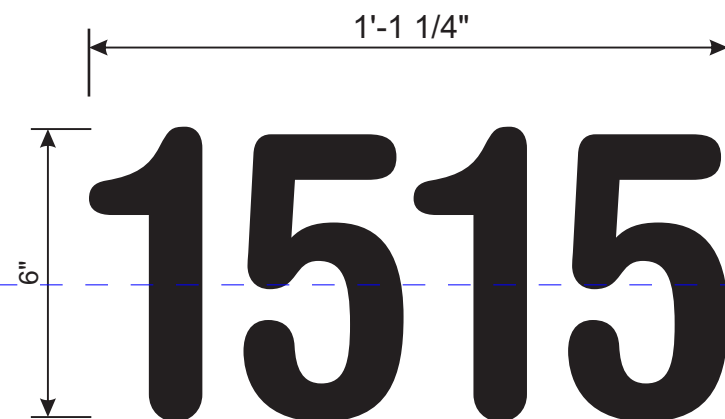

### **V-4** Black N. Naper Blvd & Naperville Rd Vinyls - Service Door

Scale 3" = 1'-0  
Qty Required: (1) Vinyls

**Specifications:**

- **Materials:** 3M Black vinyl
- **Installation:** Vinyl applied on **first surface** of service door at rear of building