



### PLANT LIST

Key	Qty	Botanical/Common Name	Size	Remarks
<b>SHADE TREES</b>				
AM	5	Acer miyabei 'Marton' STATE STREET MAPLE	2 1/2" Cal.	
CO	5	Celtis occidentalis COMMON HACKBERRY	2 1/2" Cal.	
GT	4	Gleditsia triacanthos var. inermis 'Skycole' SKYLINE HONEYLOCUST	2 1/2" Cal.	
GD	4	Gymnocladus dioica 'Espresso-JFS' ESPRESSO KENTUCKY COFFEETREE	2 1/2" Cal.	
QA	6	Quercus alba WHITE OAK	2 1/2" Cal.	
QR	6	Quercus rubra RED OAK	2 1/2" Cal.	
TC	6	Tilia cordata 'Greenspire' GREENSPIRE LITTLELEAF LINDEN	2 1/2" Cal.	
<b>ORNAMENTAL TREES</b>				
MP	3	Malus 'Prairifire' PRAIRIFIRE CRABAPPLE	6' Ht.	Multi-Stem
<b>EVERGREEN TREES</b>				
AC	6	Abies concolor WHITE FIR	6' Ht.	
PP	6	Picea pungens COLORADO GREEN SPRUCE	6' Ht.	
<b>DECIDUOUS SHRUBS</b>				
CR	28	Cornus sericea REDTWIG DOGWOOD	36" Tall	5' O.C.
CS	17	Cornus sericea 'Farrow' ARCTIC FIRE REDTWIG DOGWOOD	24" Tall	3' O.C.
RA	8	Rhus aromatica 'Gro-low' GRO-LOW SUMAC	24" Wide	3' O.C.
SM	23	Syringa meyeri 'Paladin' DWARF KOREAN LILAC	24" Tall	4' O.C.
VT	27	Viburnum trilobum 'Redwing' JN SELECT CRANBERRYBUSH VIBURNUM	36" Tall	5' O.C.
<b>EVERGREEN SHRUBS</b>				
JK	5	Juniperus chinensis 'Kallays Compact' KALLAYS COMPACT PFITZER JUNIPER	24" Wide	4' O.C.
JC	25	Juniperus chinensis 'Sea Green' SEA GREEN JUNIPER	30" Wide	5' O.C.
TM	18	Taxus x media 'Densiflora' DENSE YEW	24" Wide	4' O.C.
<b>ORNAMENTAL GRASSES</b>				
CK	22	Calamagrostis x acutiflora 'Karl Foerster' FEATHER REED GRASS	#1	36" O.C.
PV	18	Panicum virgatum 'Northwind' NORTHWIND SWITCHGRASS	#1	36" O.C.
SH	13	Sporobolus heterolepis PRAIRIE DROPSEED	#1	36" O.C.
<b>PERENNIALS</b>				
AB	29	Allium 'Summer Beauty' SUMMER BEAUTY ONION	#1	18" O.C.
HH	48	Hemerocallis 'Happy Returns' HAPPY RETURNS DAYLILY	#1	18" O.C.
HP	44	Hemerocallis 'Pardon Me' PARDON ME DAYLILY	#1	18" O.C.
<b>GROUNDCOVERS</b>				
LS	75	Liriope spicata CREEPING LILYTURF	#SP4	12" O.C.
<b>MISC. MATERIALS</b>				
36		SHREDDED HARDWOOD MULCH	C.Y.	
56		SOD	S.Y.	
1.0		TURF SEED & EROSION CONTROL BLANKET	AC.	
0.21		LOW PROFILE PRAIRIE SEED & EROSION CONTROL BLANKET	AC.	

### GENERAL NOTES

- Trees shall be installed a minimum of five (5) feet horizontally from underground electrical feeders, sanitary sewers, sanitary services, storm sewers, water mains, and water services. Trees shall be installed a minimum of ten (10) feet horizontally from utility structures and appurtenances, including, but not limited to, manholes, valve vaults, valve boxes and fire hydrants. No trees, shrubs or obstacles will be allowed 10' in front of, 5' on the sides, and 7' to the rear of the electrical transformer.
- Contractor shall verify underground utility lines and is responsible for any damage.
- Contractor shall verify all existing conditions in the field prior to construction and shall notify landscape architect of any variance.
- Material quantities shown are for contractors convenience only. The Contractor must verify all material and supply sufficient materials to complete the job per plan.
- The landscape architect reserves the right to inspect trees and shrubs either at place of growth or at site before planting, for compliance with requirements of variety, size and quality.
- Work shall conform to American Standard for Nursery Stock, State of Illinois Horticultural Standards, and Local Municipal requirements.
- Contractor shall secure and pay for all permits, fees, and inspections necessary for the proper execution of this work and comply with all codes applicable to this work.
- See General Conditions and Specifications for landscape work for additional requirements.

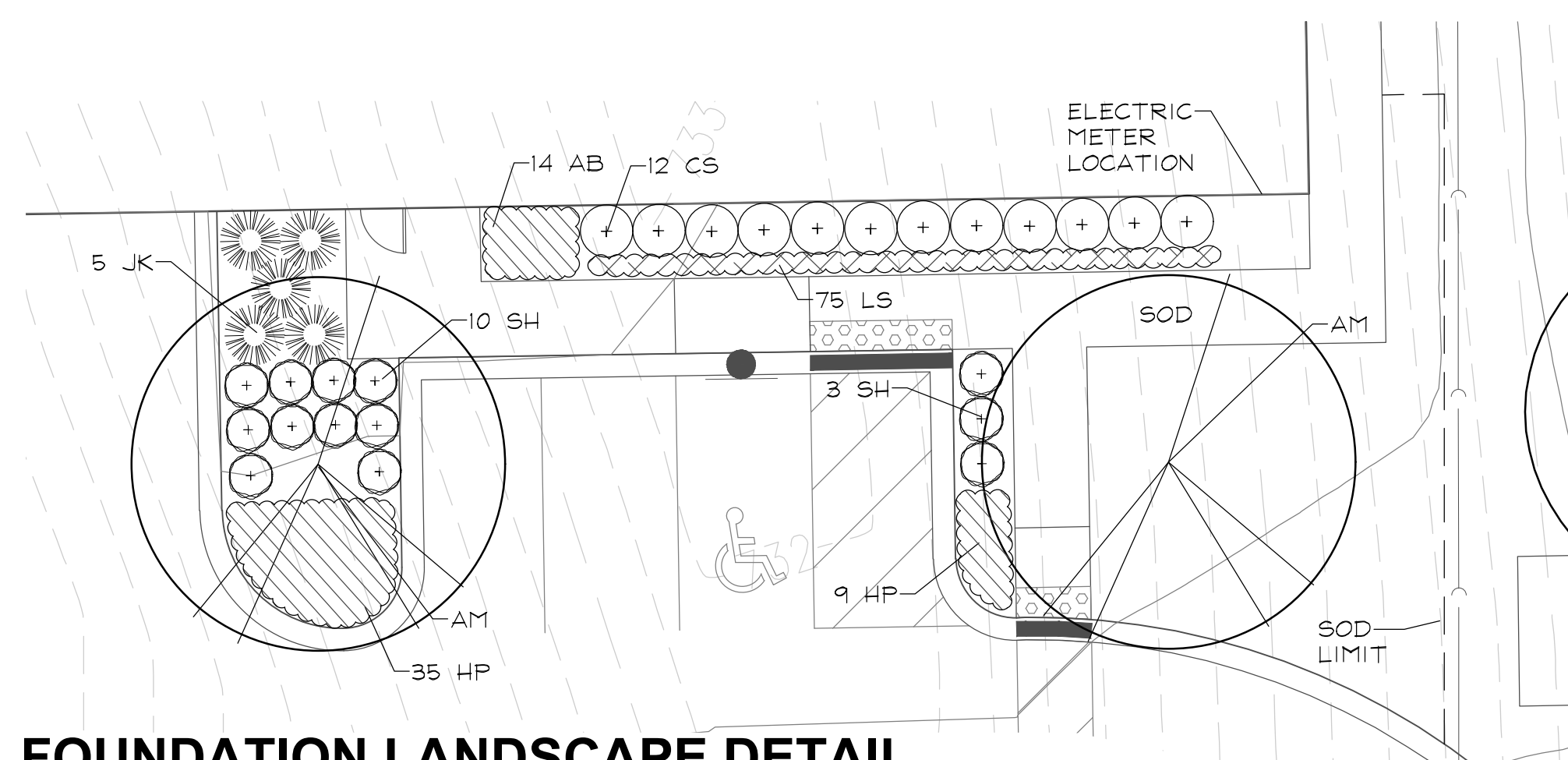
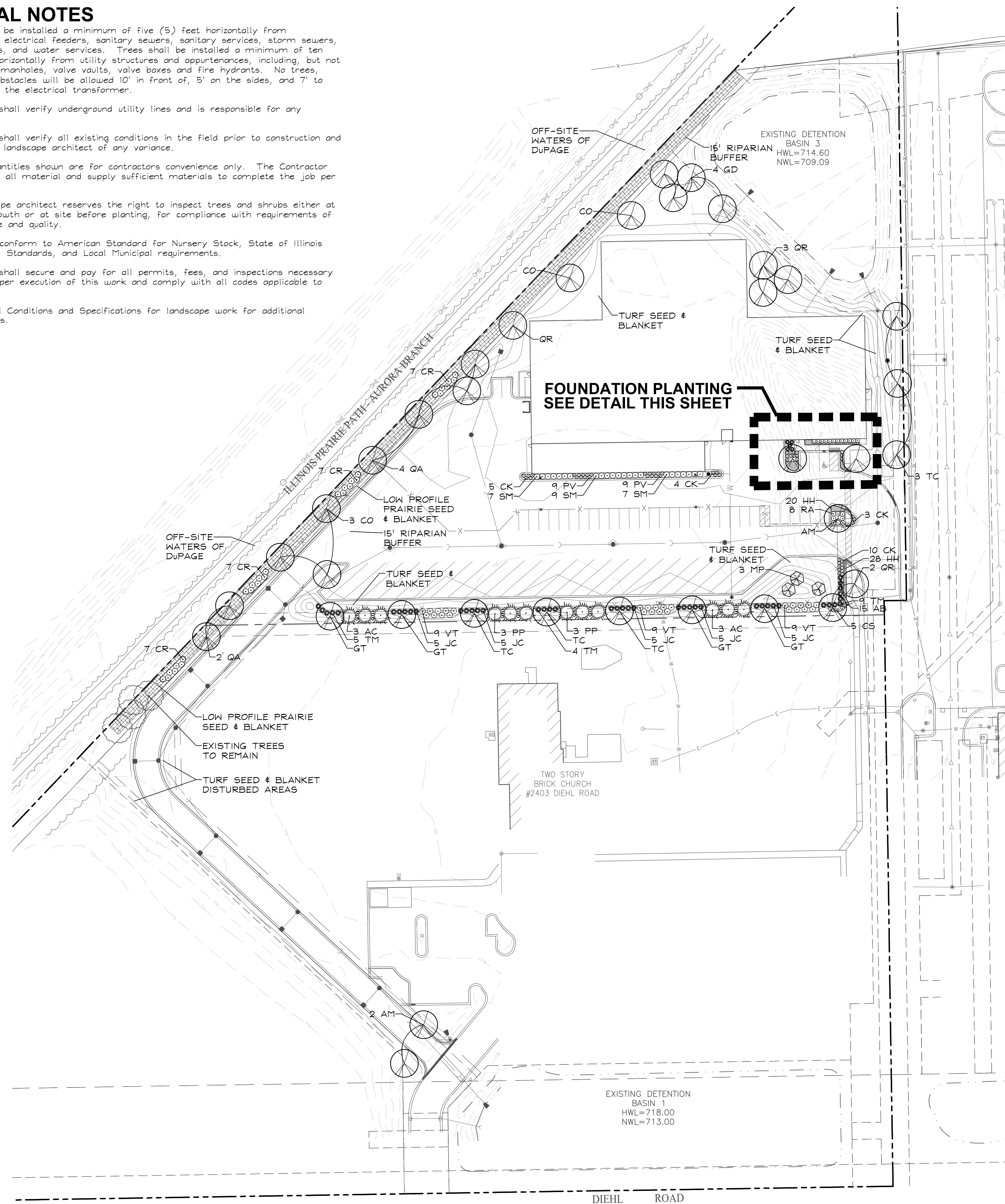

**FOUNDATION LANDSCAPE DETAIL**  
 SCALE: 1"=10'

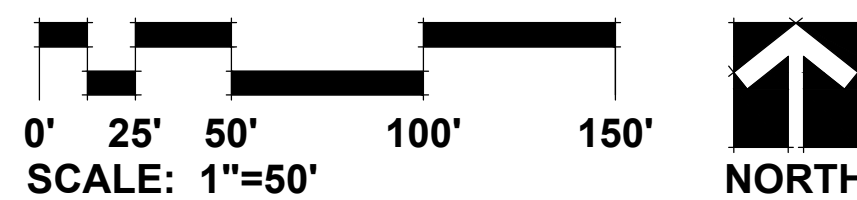

# BEYOND SELF STORAGE - NAPERVILLE

NAPERVILLE, ILLINOIS

## LANDSCAPE PLAN

REVISIONS	DATE
Rev 5	2.06.2020
Rev 4	2.03.2020
Rev 3	12.17.2019
Rev 2	11.21.2019
Rev 1	9.06.2019

DATE	8.02.19
PROJECT NO.	JH1954
DRAWN	GFB
CHECKED	MGM
SHEET NO.	





**TREE INVENTORY**

TAG NO.	BOTANICAL NAME	COMMON NAME	SIZE	HEALTH/STRUCTURE	NOTES	PROPOSED ACTIONS
2370	<i>Populus deltoides</i>	Eastern Cottonwood	6,2	Fair; dead branches	dbl leader	Remove
2371	<i>Prunus serotina</i>	Black Cherry	6	Fair; dead branches, lean		Preserve
2372	<i>Prunus serotina</i>	Black Cherry	6	Fair; dead branches, lean		Preserve
2373	<i>Celtis occidentalis</i>	Hackberry	5	Good		Preserve
2374	<i>Celtis occidentalis</i>	Hackberry	8, 6, 2	Good		Preserve
2375	<i>Populus deltoides</i>	Eastern Cottonwood	8	Fair; dead branches		Remove
2376	<i>Populus deltoides</i>	Eastern Cottonwood	8	Fair; dead branches, lean		Remove
2377	<i>Morus alba</i>	White Mulberry	6.5	Fair; dead branches, lean		Remove
NO TAG		3 DEAD ASH TREES				Remove
2378	<i>Salix nigra</i>	Black Willow	6.5, 4, 4	Fair; dead branches	3 leaders	Remove
2379	<i>Fraxinus pennsylvanica</i>	Ash	6	Fair; insect damage		Remove
2380	<i>Populus deltoides</i>	Eastern Cottonwood	9	Fair; dead branches		Remove
2381	<i>Populus deltoides</i>	Eastern Cottonwood	7	Fair; dead branches		Remove
2382	<i>Populus deltoides</i>	Eastern Cottonwood	8.5, 6	Poor; dead branches, v-shape split risk	dbl leader	Remove
2383	<i>Morus alba</i>	White Mulberry	6	Fair; dead branches, crowded by buckthorn		Remove
2384	<i>Populus deltoides</i>	Eastern Cottonwood	9	Fair; dead branches		Remove
2385	<i>Ulmus americana</i>	American Elm	6	Good		Remove
2386	<i>Ulmus americana</i>	American Elm	4	Good		Remove
2387	<i>Pyrus calleryana</i>	Pear	8, 5	Good	dbl leader	Remove
2388	<i>Fraxinus pennsylvanica</i>	Ash	4.5	Good		Remove
2389	<i>Salix nigra</i>	Black Willow	5, 2, 3	good	3 leaders	Remove
2390	<i>Populus deltoides</i>	Eastern Cottonwood	8	Fair; dead branches		Remove
2391	<i>Populus deltoides</i>	Eastern Cottonwood	13	Fair; dead branches		Remove
2392	<i>Populus deltoides</i>	Eastern Cottonwood	6	Fair; dead branches		Remove
2393	<i>Populus deltoides</i>	Eastern Cottonwood	6, 3	Fair; dead branches		Remove
2394	<i>Populus deltoides</i>	Eastern Cottonwood	12	Fair; dead branches		Remove
2395	<i>Populus deltoides</i>	Eastern Cottonwood	6	Fair; dead branches		Remove
2396	<i>Populus deltoides</i>	Eastern Cottonwood	8, 6	Fair; dead branches		Remove
2397	<i>Populus deltoides</i>	Eastern Cottonwood	10	Fair; dead branches		Remove
2398	<i>Pyrus calleryana</i>	Pear	5	Good	on slope of basin	Remove
2399	<i>Pyrus calleryana</i>	Pear	4.5	Good		Remove
2400	<i>Pyrus calleryana</i>	Pear	4, 4	Good	dbl leader	Remove
2401	<i>Pyrus calleryana</i>	Pear	6	Fair; overgrown		Remove
2402	<i>Pyrus calleryana</i>	Pear	6	Fair; overgrown		Remove
2403	<i>Pyrus calleryana</i>	Pear	5	Fair; overgrown		Remove
2404	<i>Pyrus calleryana</i>	Pear	4	Fair; overgrown		Remove

**LEGEND**

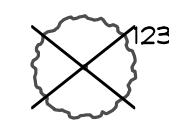
-  DECIDUOUS TREE TO BE PRESERVED
-  DECIDUOUS TREE TO BE REMOVED

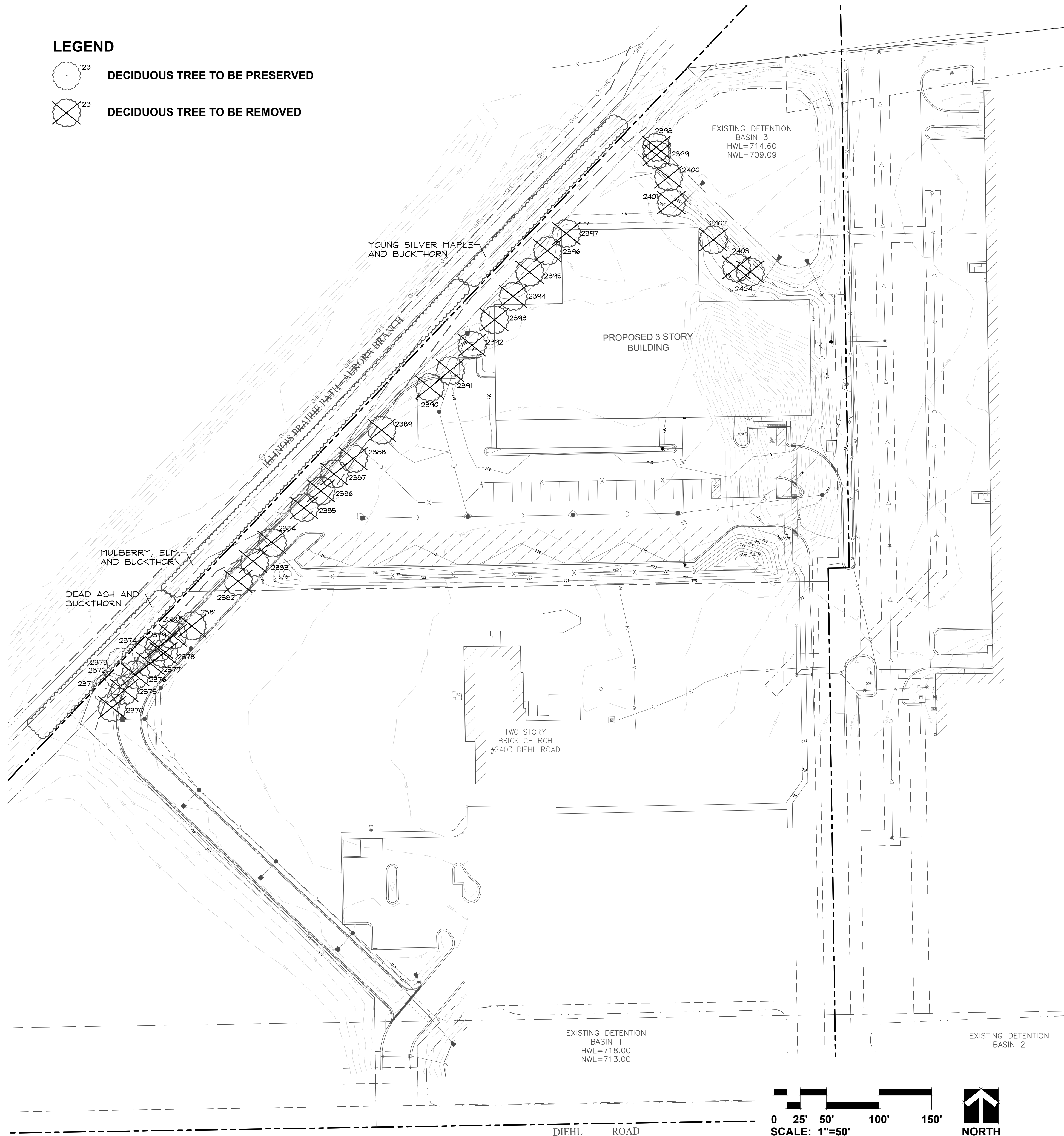

**TREE PRESERVATION NOTES**

- 48" high snow fence or wood barriers shall extend to the dripline of the tree or tree mass whenever possible, shall be installed before construction begins, and should not be removed until the completion of construction.
- Contractor shall take extreme care to protect the root system of existing trees. Should root pruning be necessary it shall not exceed 25% of the tree's root system and shall be done in accordance with recognized horticulture practices under the supervision of a professional arborists, Landscape Architect or Horticulturist.
- All accidental damage to existing trees that are to be preserved shall be promptly treated as required in accordance with recognized horticultural practices and the instructions of the professional Arborist, Landscape Architect or Horticulturist.
- Broken or badly bruised branches shall be removed with a clean cut. If recommended by the professional Arborist, Landscape Architect or Horticulturist.
- Care shall be exercised by the contractors to protect all overhead limbs and branches from damage by contact with material, machinery or equipment and by damage from engine exhaust.
- Contractors shall protect trees and vegetation against spills or discharge of fuels, lubricating oils, hydraulic fluids, anti-freeze and coolants, calcium chloride, lime and all other similar hydrocarbons, organic chemicals, and other materials which can be harmful.
- When underground utilities are proposed within 5' of a preserved tree trunk, they must be augered if possible.

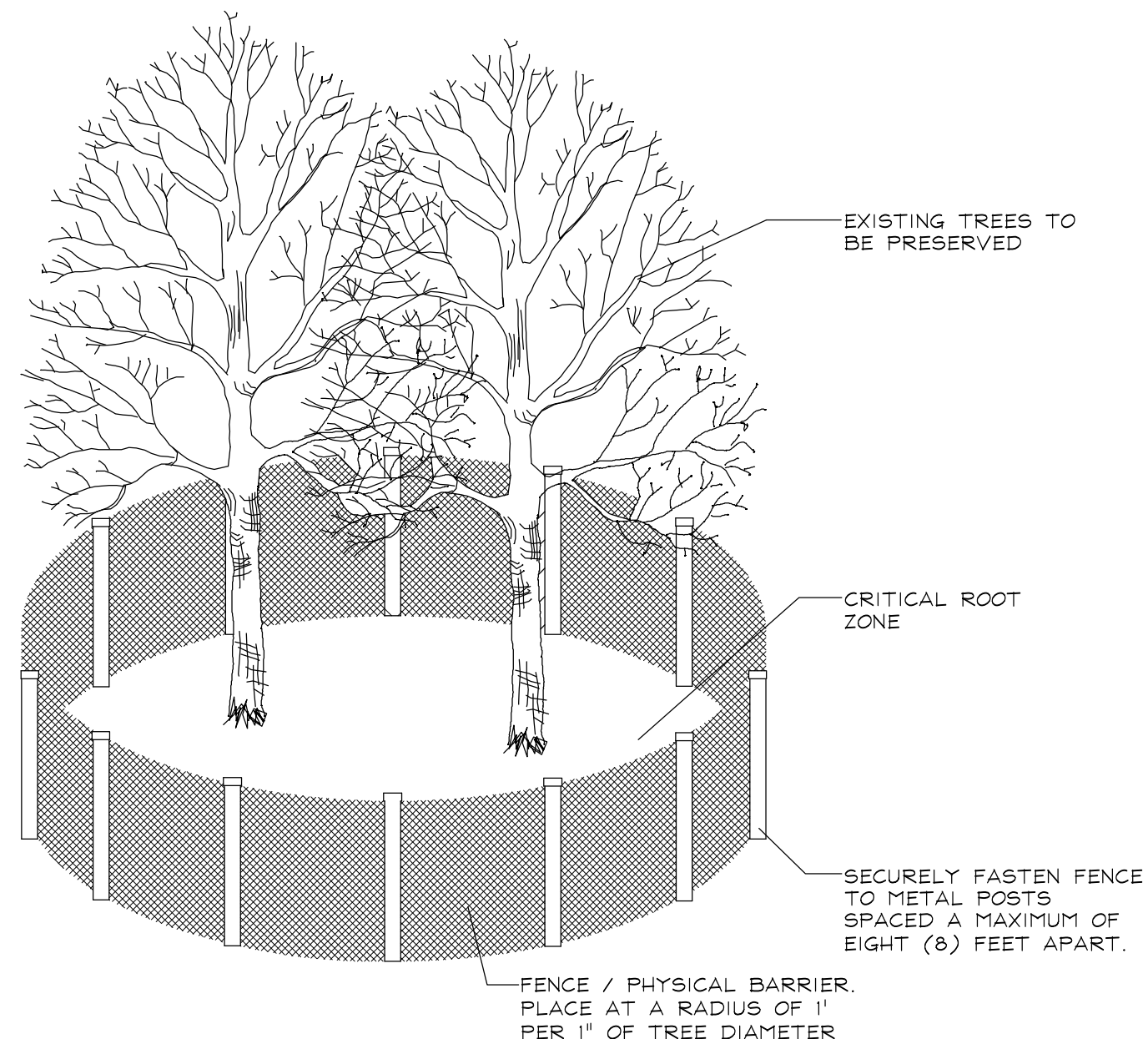

**TREE PRESERVATION DETAIL**

**BEYOND SELF STORAGE - NAPERVILLE**  
 NAPERVILLE, ILLINOIS  
**TREE PRESERVATION PLAN**

REVISIONS

Rev 5	2.06.2020
Rev 4	2.03.2020
Rev 3	12.17.2019
Rev 2	11.21.2019
Rev 1	9.06.2019

DATE: 8.02.19  
 PROJECT NO.: JH1954  
 DRAWN: GFB  
 CHECKED: MGM  
 SHEET NO.:

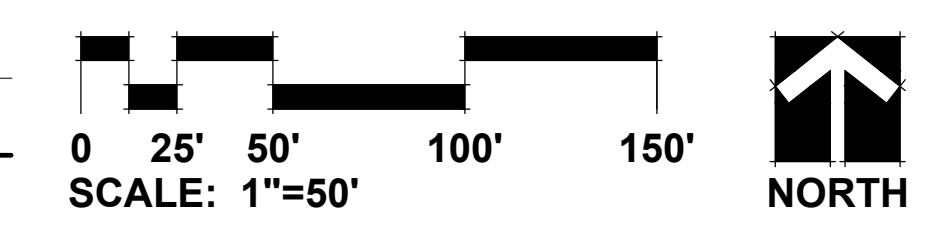

RECORD DRAWING

