

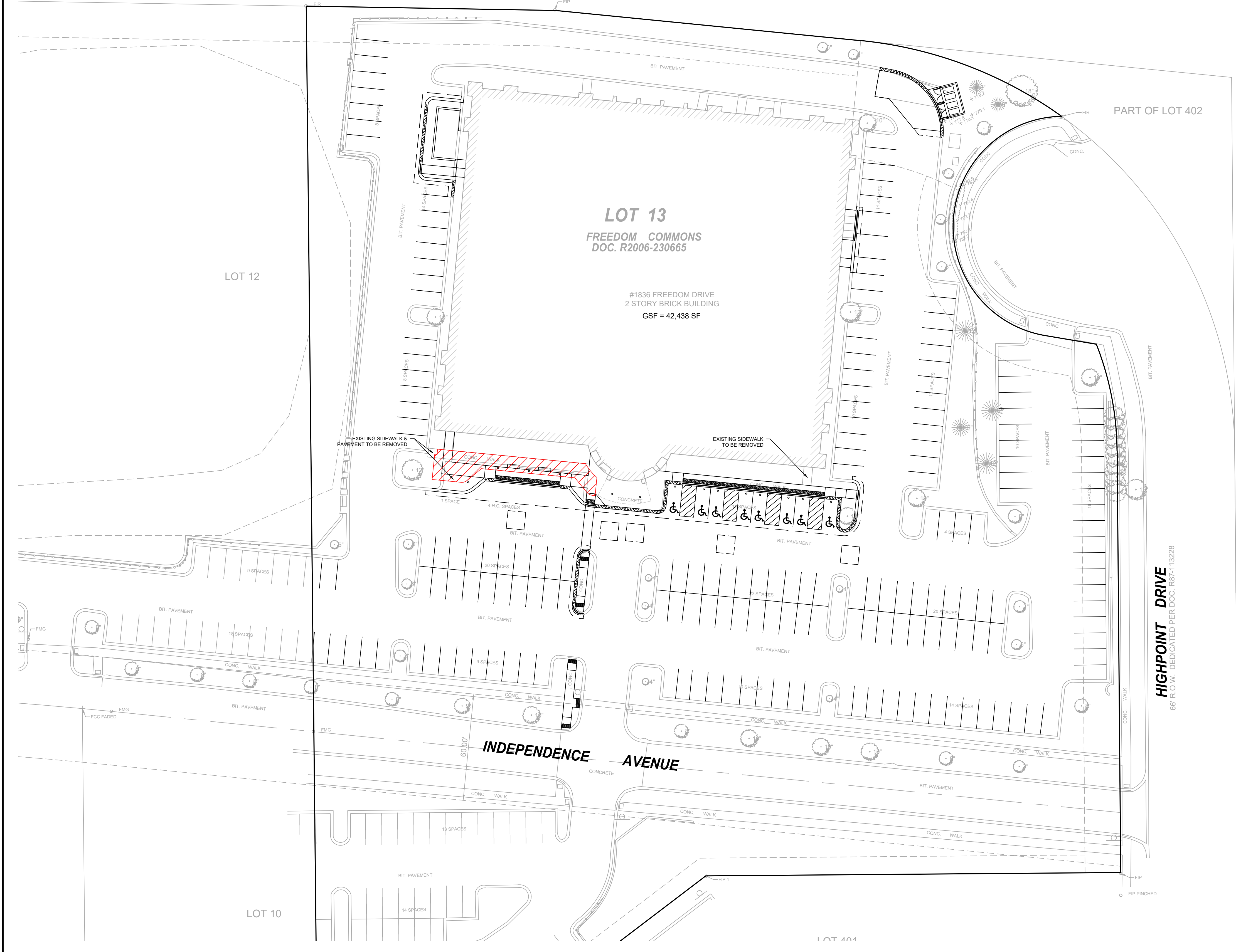

80' NORTHERN ILLINOIS GAS RIGHT-OF-WAY LOT 3
 NORTHERN ILLINOIS GAS COMPANY
 LISLE TOWNSHIP ASSESSMENT PLAT NO. 1
 DOC. R1964-028040



LEGEND

NEW OPEN SPACE

 INCREASED BY 1,017 SF

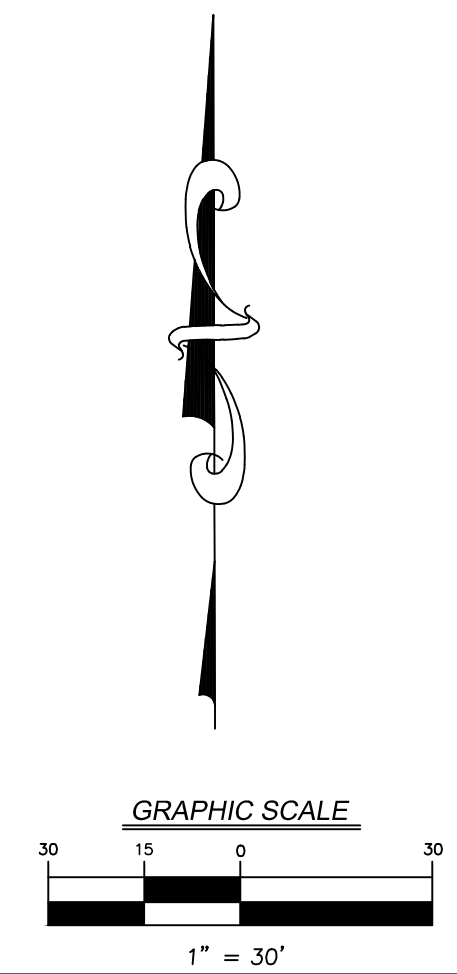

REVISIONS

NO.	DATE	DESCRIPTION
1	2/20/24	REVISED PER CITY COMMENTS
2	3/07/24	REVISED PER CITY COMMENTS

PROJECT NO.: 230604

PROJECT MANAGER:	RS
DESIGNED BY:	JR
DRAWN BY:	RI

OPEN SPACE EXHIBIT

FREEDOM COMMONS - MOB

NAPERVILLE FINAL ENGINEERING ILLINOIS

7325 Janes Avenue
 Woodridge, IL 60517
 630.724.9200 phone
 www.v3co.com

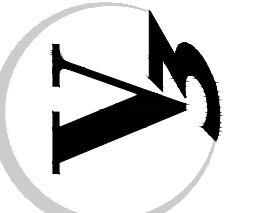

DRAWING NO.
EX