

Senior Drop-off Gate

Regular Front Gate



Available parking 52 spots in front of the unit and additional parking is available in the parking lot

Stacking Space
The front of the unit is 180' long.

Xilin Vehicle Operation Schedule:

4. Mini bus 23'6"
3. Passenger Van 19'6"

Xilin's drop-off service starts from 8:00-9:00 AM in the then from 3:00 - 3:40 PM in the afternoon.

We bus in/out 60 to 100 seniors on a daily bases.

In the morning, there is no more than two vehicles stop of the building, vehicles arrive at different times. In the afternoon, Xilin operates 5-7 vehicle at the same depends on the size of attendance. Most vehicles will r trips to take seniors home. They drop off senior at their then come back to Xilin to pick up the second trip.

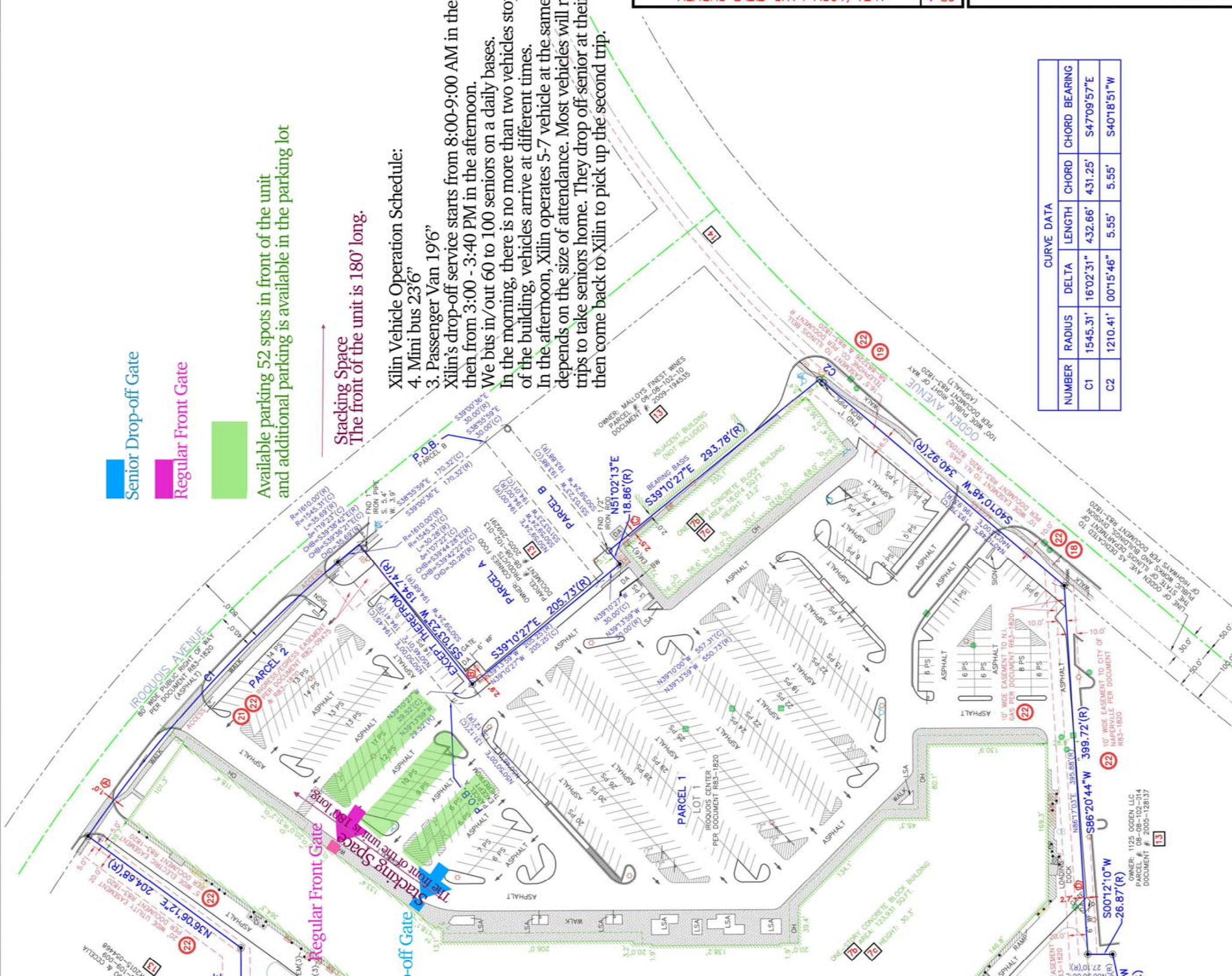

CURVE DATA					
NUMBER	RADIUS	DELTA	LENGTH	CHORD	BEARING
C1	1545.31'	16'02'31"	432.66'	431.25'	S47°09'57"E
C2	1210.41'	00°15'46"	5.55'	5.55'	S40°18'51"W

OWNER: 1125 OGDEN, LLC
PARCEL # 08-08-102-014
DOCUMENT # 2008-1126137