

5

4

3

2

1

PLANT LIST

COUNT	MARK	BOTANICAL NAME	COMMON NAME	SIZE	NOTES
SHADE TREES					
8	GYM-D	GYMNOCLADUS DIOICIS 'ESPRESSO'	ESPRESSO KENTUCKY COFFEE TREE	2 1/2"-3" CAL.	B&B
4	OST-V	OSTRYA VIRGINIANA	AMERICAN HOPHORNBEAN	2 1/2"-3" CAL.	B&B
10	PLA-A	PLATANUS x ACERIFOLIA 'BLOODGOOD'	BLOODGOOD LONDON PLANETREE	2 1/2"-3" CAL.	B&B
6	QUE-I	QUERCUS IMBRICARIA	SHINGLE OAK	2 1/2"-3" CAL.	B&B
6	QUE-S	QUERCUS SHUMARDII	SHUMARD OAK	2 1/2"-3" CAL.	B&B
10	TAX-D	TAXODIUM DISTICHUM	BALD CYRESS	2 1/2"-3" CAL.	B&B
ORNAMENTAL TREES					
3	HAL-T	HALESIA CAROLINA 'JERSEY BELLE'	CAROLINA SILVERBELL 'JERSEY BELLE'	1 1/2"-2" CAL.	B&B
SHRUBS					
16	CEP-O	CEPHALANTHUS OCCIDENTALIS	BUTTONBUSH	24"-30"	
13	COR-S	CORNUS SERICEA 'KELSEY'	KELSEY'S DWARF RED OSIER DOGWOOD	18"-24"	
27	FOT-G	FOTHERGILLA GARDENII	DWARF FOTHERGILLA	18"-24"	
35	POT-F	POTENTILLA FRUTICOSA 'GOLDFINGER'	GOLD FINGER POTENTILLA	18"-24"	
POND PLANTINGS					
582	PLAN NOTE 2	ASCLEPIAS INCARNATA	SWAMP MILKWEED	PLUG	PLANT ON A 2' GRID. MIX PLUGS RANDOMLY TO ACHIEVE EVEN DISTRIBUTION OF SPECIES. IF SPECIFIC SPECIES ARE NOT AVAILABLE, A COMPARABLE SPECIES FROM THE WETLAND SEED MIX MAY BE SUBSTITUTED. SUBMIT SUBSTITUTION REQUEST.
582	PLAN NOTE 2	CAREX HYSTERICINA	PORCUPINE SEDGE	PLUG	
582	PLAN NOTE 2	CAREX VULPINOIDEA	FOX SEDGE	PLUG	
582	PLAN NOTE 2	MONARDA FISTULOSA	WILD BERGAMOT	PLUG	
582	PLAN NOTE 2	PANICUM VIRGATUM	SWITCH GRASS	PLUG	
582	PLAN NOTE 2	RUDBECKIA TRILOBA	BROWN-EYED SUSAN	PLUG	
582	PLAN NOTE 2	SCIRPUS ATROVIRENS	DARK GREEN BULRUSH	PLUG	

LANDSCAPE ORDINANCE CHART

ORDINANCE SECTION	DESCRIPTION	MEASUREMENT	PLANTINGS REQUIRED	PLANTINGS PROVIDED
5-10-3.3.2.3	PARKWAY TREES- PARKWAY-THE UNPAVED PORTION OF A PUBLIC ROAD OR STREET RIGHT-OF-WAY ABUTTING A PARCEL. PARKWAY TREES SHALL BE EVENLY SPACED AT NOT MORE THAN FORTY (40) FEET APART AND NOT LESS THAN FOUR (4) FEET FROM THE ESTABLISHED SIDEWALK LINE OF SAID STREET. PERMIT REQUIRED. THE APPLICATION SHALL BE REVIEWED AND THE PERMIT SHALL BE ISSUED BY THE DEPARTMENT OF PUBLIC WORKS.	APPROX 580 LF OF FRONTAGE ON PUBLIC ROW	15 TREES	15 TREES
5-10-3.5.2.1	PERIMETER PARKING LOT LANDSCAPING: A MINIMUM FIVE-FOOT WIDE LANDSCAPE AREA SHALL BE PROVIDED AROUND THAT PART OF THE PERIMETER OF ALL PARKING LOTS WHICH ABUT ANOTHER PARCEL OR THE PUBLIC RIGHT-OF-WAY.	5' WIDE AREA PROVIDED- EXCLUDING NORTH DRIVE/ PROPERTY LINE- FOR WHICH A PUD DEVIATION IS REQUESTED.	SEE 5.2.4.2	SEE 5.2.4.2
5-10-3.5.2.4.2	PARKING PERIMETER LANDSCAPING REAR OR INTERIOR YARDS BY NON-RESIDENTIAL- ABUTTING NON-RESIDENTIAL PROPERTY: WHERE A PARKING LOT ABUTS A PROPERTY ZONED FOR NON-RESIDENTIAL USE, LANDSCAPING SHALL BE PROVIDED ACROSS FIFTY PERCENT (50%) OF THE PARKING LOT TO A MINIMUM HEIGHT OF THIRTY (30) INCHES. SUCH LANDSCAPING SHALL CONSIST OF EVERGREEN OR DECIDUOUS SHRUBBERY AND HEDGES SPACED AT A MAXIMUM OF FOUR (4) FEET ON CENTER. SHADE TREES OF A MINIMUM OF TWO AND ONE-HALF (2 1/2) INCHES IN DIAMETER AS MEASURED SIX (6) INCHES ABOVE THE ESTABLISHED GROUND LEVEL SHALL BE SPACED AT THE EQUIVALENT OF NOT MORE THAN SEVENTY (70) FEET APART ALONG THAT PORTION OF THE PARKING LOT ABUTTING THE NON-RESIDENTIAL PROPERTY, EXCLUSIVE OF ACCESS DRIVES, PERPENDICULAR TO THE LOT LINES.	238 LF W LOT EDGE - (EXCLUDING NORTH PROPERTY LINE- (SEE 5.2.1) AND EAST LOT LINE WHICH IS EXISTING STORAGE FACILITY)	119 LF=50% OF PARKING LOT. 25 SHRUBS AT 4' O.C. AND 3 TREES	9 TREES AND 30 SHRUBS- EXTRA PROVIDED TO ENHANCE ALTERNATE FOUNDATION LANDSCAPING.
5-10-3.4.1	LOT PERIMETER TREES SHADE TREES A MINIMUM OF TWO AND ONE-HALF (2 1/2) INCHES IN DIAMETER AS MEASURED SIX (6) INCHES ABOVE THE ESTABLISHED GROUND LEVEL AND/OR EVERGREEN TREES A MINIMUM OF SIX (6) FEET IN HEIGHT SHALL BE SPACED AT THE EQUIVALENT OF NOT MORE THAN SEVENTY (70) FEET APART ALONG ALL PROPERTY LINES, EXCLUSIVE OF ACCESS DRIVES PERPENDICULAR TO THE LOT LINES.	1500 LF EXCLUDING ENTRYS	22 TREES	20 NEW TREES AND 5 EXISTING TREES
5-10-3.4.2.1	FOUNDATION LANDSCAPING: FOUNDATION PLANTINGS SHALL BE LOCATED ADJACENT TO ALL SIDES OF BUILDINGS WHICH FACE A PUBLIC RIGHT-OF-WAY OR INTERNAL STREET ACCESS DRIVE, OTHER THAN SINGLE-FAMILY ATTACHED AND DETACHED DEVELOPMENTS AND PROPERTIES ZONED B4 OR B5, IN A PLANTING BED A MINIMUM OF TWO (2) FEET IN WIDTH. FOUNDATION PLANTINGS BEDS SHALL BE 2 FEET IN WIDTH, HOWEVER, FOUNDATION PLANTINGS SHALL CONSIST OF A MINIMUM RATIO OF ONE PLANT FOR EVERY 3 LINEAR FEET OF BUILDING LENGTH. A COMBINATION OF DECIDUOUS SHRUBS, EVER-GREENS, FLOWERS, ORNAMENTAL GRASSES AND OTHER NATIVE GROUND COVERS SHOULD BE USED. ALL PLANTING AREAS WHICH ARE NOT OCCUPIED BY TREES, SHRUBS, FLOWERS, GROUND COVER, ORNAMENTAL GRASSES OR MULCH SHALL BE SODDED OR CONTAIN DECORATIVE LANDSCAPE STONE APPROVED BY THE ZONING ADMINISTRATOR.	31.5 LF X 3 BUILDINGS 95 LF INCLUDING DOORWAYS	32 SHRUBS AT 3' O.C.	32 SHRUBS PROVIDED. ALTERNATE LOCATIONS SHOWN ALLOWS THE STORAGE FACILITY TO FUNCTION BY PLACING FOUNDATION PLANTINGS AT THE PERIMETER OF THE NEW COMPLEX OF BUILDINGS WHERE THEY WILL BE MOST VISIBLE TO FROM OGDEN AVE.

WETLAND SEED MIX

SEED AT A RATE OF 48 OZ/ ACRES

SEED MIX IS PREMIXED FROM ILLINOIS DNR. FOR MORE INFORMATION REFER TO SPECIFICATIONS

- BIG BLUESTEM (*ANDROPOGON GERARDII*)
- BLACK-EYED SUSAN (*RUDBECKIA HIRTA*)
- BLUE FLAG IRIS (*IRIS VERSICOLOR*)
- BLUE VERVAIN (*VERBENA HASTATA*)
- BROWN-EYED SUSAN (*RUDBECKIA TRILOBA*)
- SHOWY TICK TREFOIL (*DESMODIUM CANADENSE*)
- NODDING WILD RYE (*ELYMUS CANADENSIS*)
- COMMON IRONWEED (*VERNONIA FASCICULATE*)
- CULVER'S-ROOT (*VERONICASTRUM VIRGINICUM*)
- CUP-PLANT (*SILPHIUM PERFOLIATUM*)
- DARK GREEN BULRUSH (*SCIRPUS ATROVIRENS*)
- FOX SEDGE (*CAREX VULPINOIDEA*)
- GOLDEN ALEXANDERS (*ZIZIA AUREA*)
- GREAT BLUE LOBELIA (*LOBELIA SIPHILITICA*)
- INDIAN GRASS (*SORGHASTRUM NUTANS*)
- INDIAN PLANTAIN (*AMOGLOSSUM ATRIPLICIFOLIUM*)
- MARSH BLAZING-STAR (*LIATRIS SPICATA*)

- OHIO GOLDENROD (*SOLIDAGO OHIOENSIS*)
- OX-EYE SUNFLOWER (*HELIOPSIS HELIANTHOIDES*)
- PERFOLIATE BONESET (*EUPATORIUM PERFOLIATUM*)
- PORCUPINE SEDGE (*CAREX HYSTERICINA*)
- PRAIRIE BLAZING-STAR (*LIATRIS PYNOSTACHYA*)
- CORD GRASS (*SPARTINA PECTINATA*)
- PORCUPINE SEDGE (*CAREX COMOSA*)
- PORCUPINE SEDGE (*CAREX HYSTERICINA*)
- PRAIRIE DOCK (*SILPHIUM TEREBINTHACEUM*)
- ROSWINEED (*SILPHIUM INTEGRIFOLIUM*)
- SPONGY SEDGE (*CAREX STIPATA*)
- SPOTTED JOE-PYE-WEED (*EUTROCHIUM MACULATUM*)
- STIFF GOLDENROD (*OLIGONEURON RIGIDUM*)
- SWAMP MILKWEED (*ASCLEPIAS INCARNATA*)
- SWITCH GRASS (*PANICUM VIRGATUM*)
- VIRGINIA WILD RYE (*ELYMUS VIRGINICUS*)
- WILD BERGAMOT (*MONARDA FISTULOSA*)
- WILD BLUE IRIS (*IRIS SHREVEI*)
- WILD SENNA (*CASSIA HEBECARPA*)
- YELLOW CONEFLOWER (*RATIBIDA PINNATA*)
- YELLOW SNEEZEWEED (*HELENIUM AUTUMNALE*)

GENERAL NOTES

- ALL DISTURBED LAWN AREAS TO BE SEEDED UNLESS OTHERWISE NOTED.
- PLANTINGS COMPLY WITH THE SEPARATION DISTANCES FROM UTILITY SERVICES AND STRUCTURES AS REQUIRED BY MUNICIPAL CODE SECTION 5-10-3.10.
- SHADE TREES WILL HAVE A MINIMUM 2.5" CALIPER AND EVERGREEN TREES A MINIMUM 6' PLANTING HEIGHT AT THE TIME OF PLANTING.

PLAN NOTES

- SPADE EDGE
- AREA OF WETLAND SEEDING AND PLUG GRID. MIX TO BE AS DESCRIBED ON THIS SHEET AND IN THE SPECIFICATION
- AREA OF STANDARD TURF SEEDING. INCLUDES POND SLOPES.
- AREA OF STONE MULCH.

D

C

B

A

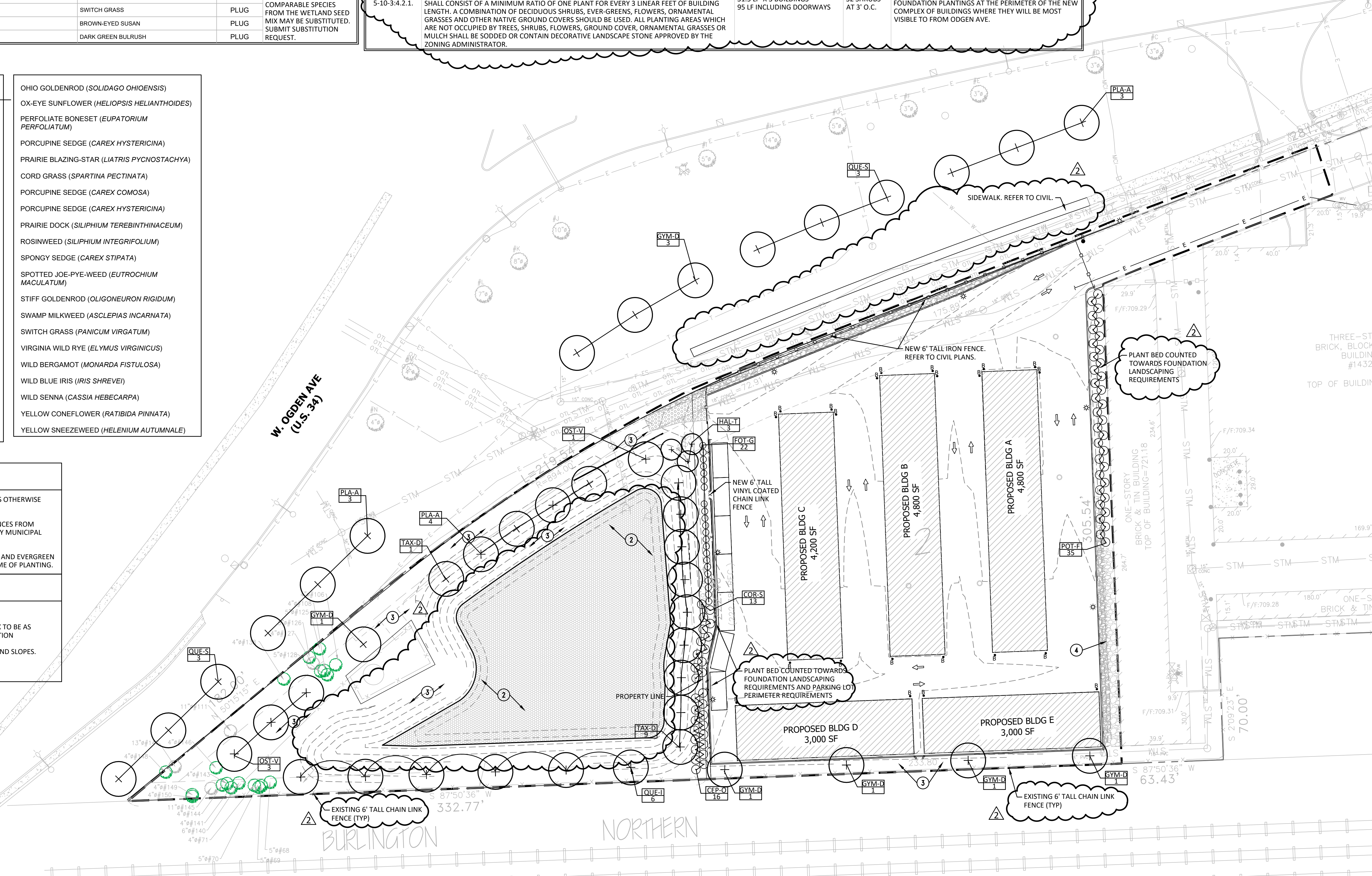

100% CONSTRUCTION DOCUMENTS
 EXTRA SPACE STORAGE, INC.
ESS NAPERVILLE
STORAGE #1259
 1432 W OGDEN AVE. NAPERVILLE, IL 60563

#	Revision	Date
1	CITY RESUBMITTAL	22 AUG 2024
2	CITY RESUBMITTAL	04 NOV 2024

Project #: 23-700-300-1
 Designed By: RKF
 Drawn By: RKF
 Checked By: NBV
 Date: 04.12.2024

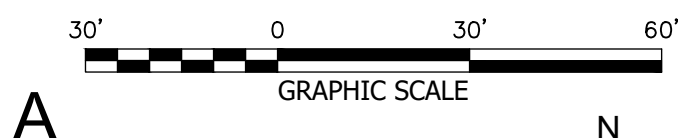

LANDSCAPE PLAN

L200