

LANDSCAPE PLAN

MILL AND BAUER TOWNHOMES

NAPERVILLE, ILLINOIS



LOCATION MAP
N.T.S.

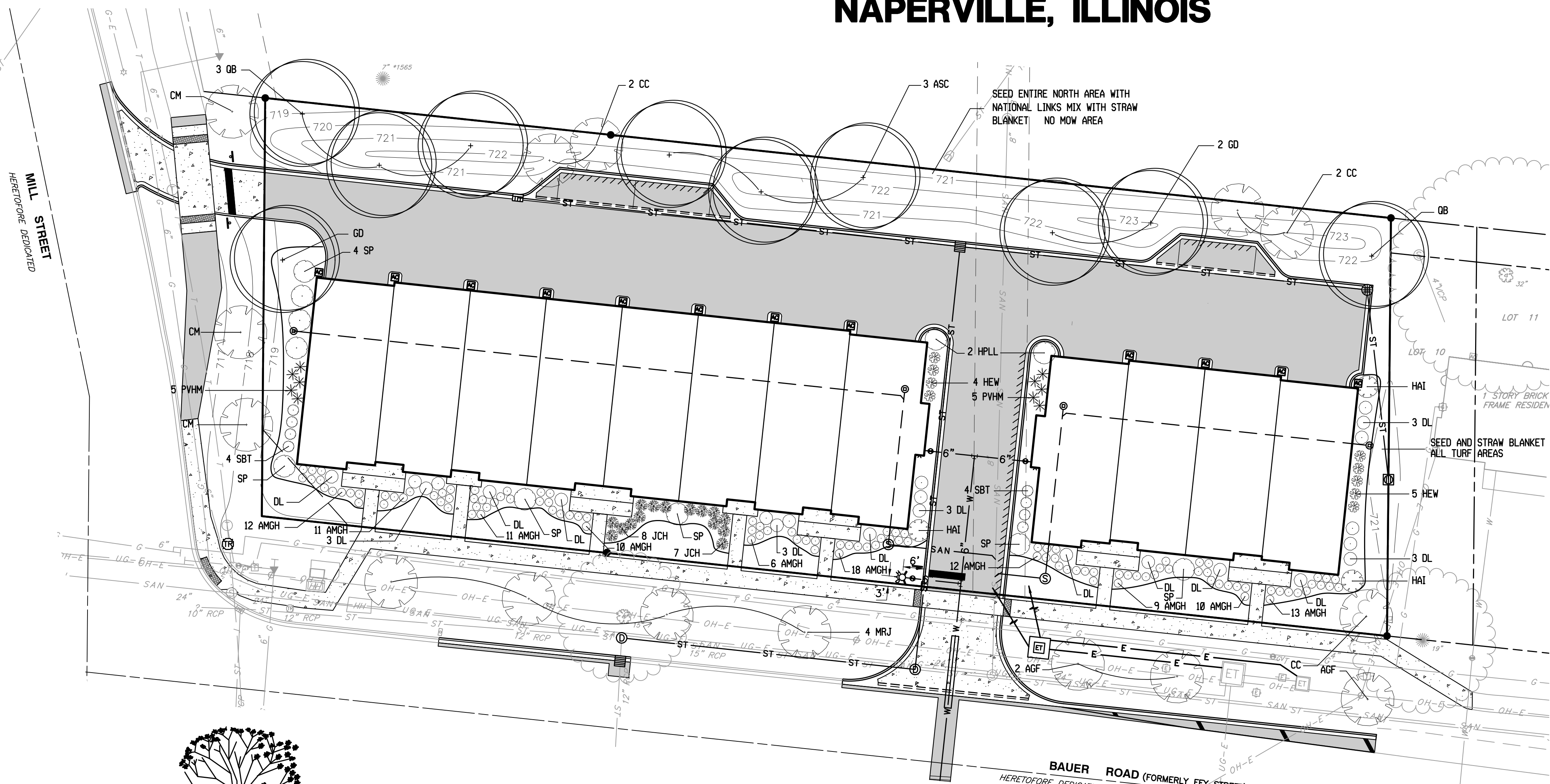

GENERAL NOTES

- ALL PLANT MATERIAL SHALL BE NORTHERN ILLINOIS NURSERY GROWN TO ASSURE CLIMATIC AND SOIL SIMILARITY. ALL MATERIAL SHALL BE BALLED AND BURLAP PER AMERICAN STANDARD FOR NURSERY STOCK BY THE AMERICAN ASSOCIATION OF NURSERYMEN, INC. PERENNIAL AND GROUND COVER SHALL BE CONTAINER GROWN.
- ALL BEDS SHALL RECEIVE 3-4" OF FINELY SHREDDED HARDWOOD MULCH. GROUND COVER BEDS SHALL BE TREATED WITH TRIFLUR PRE-EMERGENT HERBICIDE. ALL OTHER BEDS SHALL RECEIVE RONSTAR 5g OR SIMILAR PRE-EMERGENT HERBICIDE FOR WEED CONTROL. ALL TREES SHALL RECEIVE 6" OF FINELY SHREDDED HARDWOOD MULCH. ALL LANDSCAPE SPOILS SHALL BE REMOVED FROM THE SITE BY THE CONTRACTOR.
- OWNER SHALL PROVIDE SUFFICIENT WATER FOR THE CONTRACTOR TO MAINTAIN THE PLANT MATERIAL AND SEED AREAS. CONTRACTOR SHALL WATER SEED UNTIL THE TURF HAS BECOME ADEQUATELY ESTABLISHED. CONTRACTOR SHALL WARRANT ALL MATERIAL AND LABOR FOR A PERIOD OF ONE YEAR FROM ACCEPTANCE OF ALL WORK. OWNER TO PROVIDE ALL SUPPLEMENTAL WATERING AND PROPER CARE AND MAINTENANCE OF ALL MATERIAL AFTER CONTRACTOR'S INITIAL CARE.
- QUANTITY LISTS ARE SUPPLIED AS A CONVENIENCE. THE CONTRACTOR SHALL VERIFY ALL QUANTITIES ON-SITE. THE CONTRACTOR SHALL VERIFY LOCATION OF ALL UNDERGROUND UTILITIES PRIOR TO DIGGING.
- PLANTING BEDS SHALL BE ELEVATED SLIGHTLY TO INSURE PROPER DRAINAGE. ALL ROOT BALLS OF TREES SHALL BE ELEVATED ABOVE FINISHED GRADE. ALL GRADING SHALL PROVIDE SLOPES WHICH ARE SMOOTH, CONTINUOUS AND HAVE POSITIVE DRAINAGE IN ALL AREAS.
- CONTRACTOR SHALL BE RESPONSIBLE FOR PROVIDING TEMPORARY EROSION CONTROL FOR SOIL AREAS DUE TO SLOPE CONDITIONS. CONTRACTOR SHALL MAINTAIN ALL EROSION CONTROL STRUCTURES, FENCES, DITCH CHECKS, AND INLET PROTECTORS UNTIL ADEQUATE VEGETATION HAS BEEN ESTABLISHED.
- EXCAVATED MATERIALS IN EXCESS OR THOSE NOT REQUIRED OR UNSUITABLE FOR RE-USE SHALL BE DISPOSED OF OFF SITE AT CONTRACTOR'S EXPENSE. CONTRACTOR SHALL REMOVE ALL DEBRIS DAILY AND MAINTAIN THE SITE IN A NEAT AND SAFE CONDITION.
- SOIL TESTS SHALL BE MADE TO DETERMINE THE EXACT REQUIREMENTS FOR BOTH SOIL AMENDMENTS AND FERTILIZER. SOIL TESTS SHALL BE CONDUCTED BY A GOVERNMENT LABORATORY OR RECOGNIZED COMMERCIAL LABORATORY, COST OF WHICH SHALL BE BORNE BY THE CONTRACTOR. CONTRACTOR IS RESPONSIBLE FOR MATERIAL COST AND APPLICATION OF TESTING LABORATORY'S RECOMMENDATIONS.
- LANDSCAPE CONTRACTOR SHALL PROVIDE THE OWNER WITH AN EQUIPMENT AND LABOR RATE SCHEDULE. THIS LIST SHALL INCLUDE COST OF TOPSOIL AND LANDSCAPE DEBRIS/SPOILS REMOVAL WITH SQUARE FOOT COST FOR TURF RESTORATION. LANDSCAPE CONTRACTOR SHALL RESTORE ALL TURF AREAS DAMAGED DUE TO CONSTRUCTION ON AND OFF SITE AT THE AGREED RATES TO RESTORE THE EXISTING CONDITIONS.
- LANDSCAPE CONTRACTOR SHALL FOLLOW ALL LOCAL AND MUNICIPAL CODES AND REQUIREMENTS. CONTRACTOR SHALL SECURE ALL REQUIRED PERMITS AS NECESSARY TO COMPLETE THE SCOPE OF THE JOB.
- TREES SHALL BE INSTALLED A MINIMUM OF FIVE (5) FEET HORIZONTALLY FROM SANITARY SEWERS, SANITARY SERVICES, WATER MAINS, WATER SERVICES AND STORM SEWERS. TREES SHALL BE INSTALLED A MINIMUM OF TEN (10) FEET HORIZONTALLY FROM UTILITY STRUCTURES AND APPURTENANCES, INCLUDING BUT NOT LIMITED TO MANHOLES, VALVE VAULTS, VALVE BOXES AND FIRE HYDRANTS. NO TREES, SHRUBS OR OBSTACLES WILL BE ALLOWED 10 FEET IN FRONT OF, 5 FEET ON THE SIDES AND 7 FEET TO THE REAR OF ELECTRICAL TRANSFORMERS.

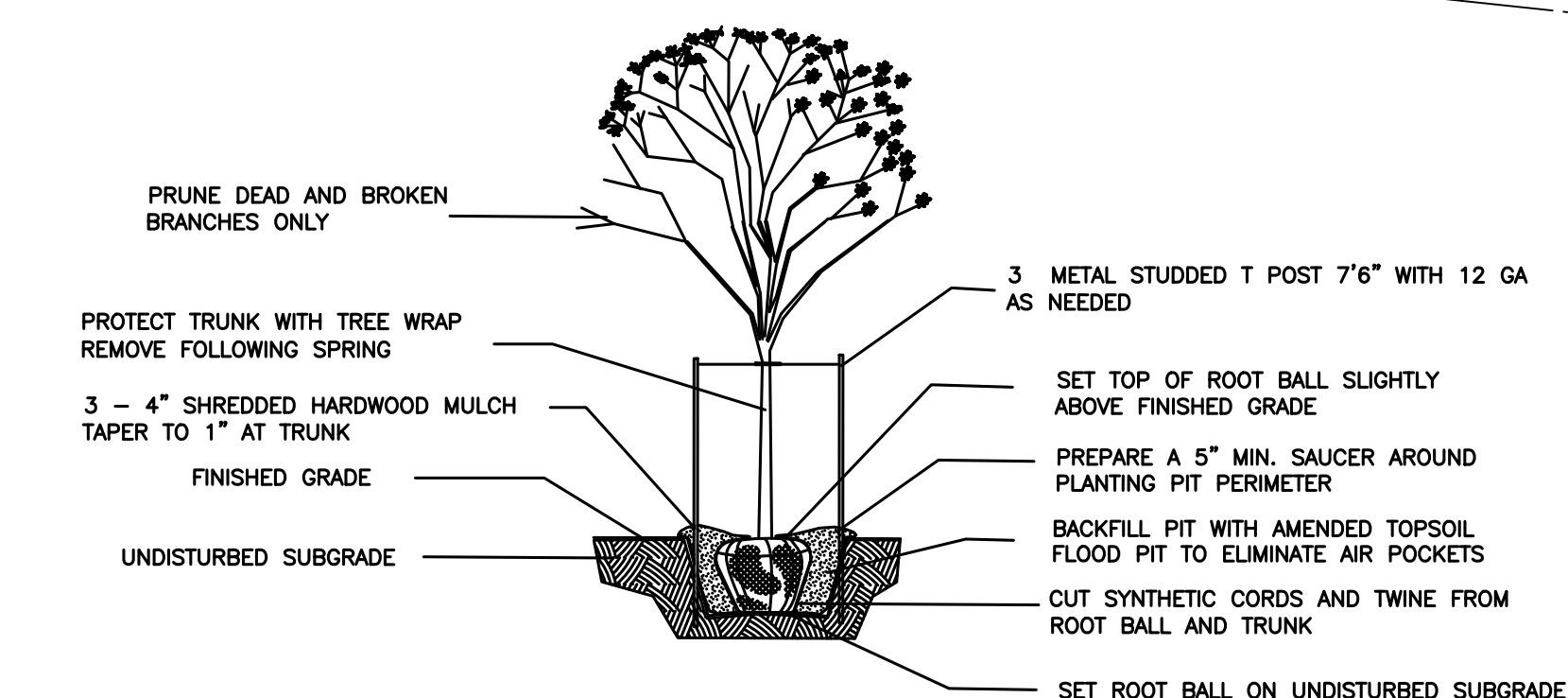

TREE PLANTING DETAIL

NOT TO SCALE USE ONLY NORTHERN ILLINOIS GROWN NURSERY STOCK

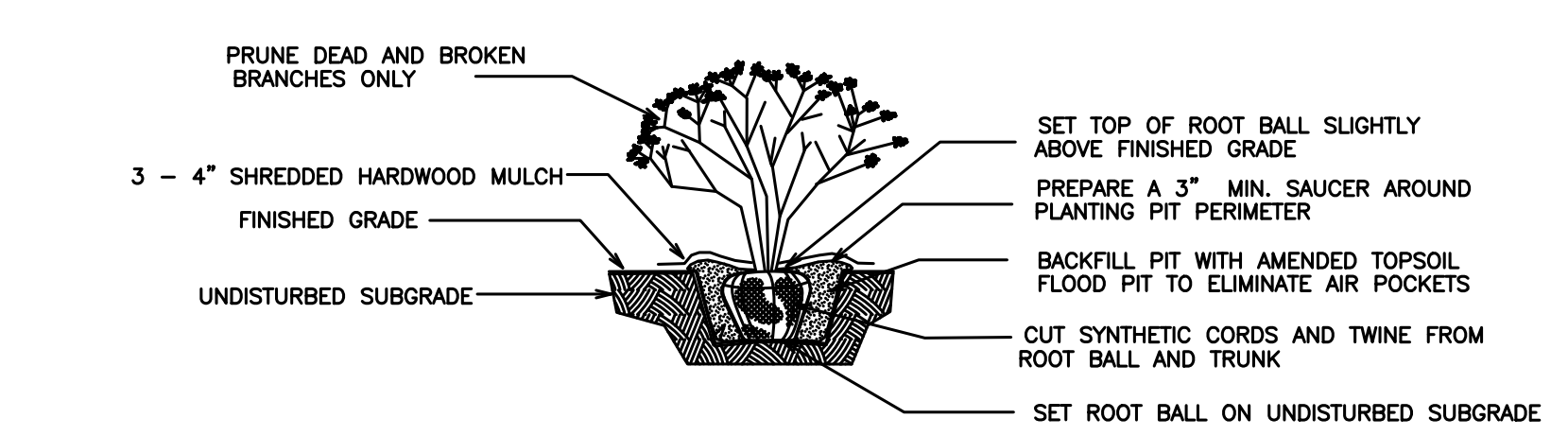

SHRUB PLANTING DETAIL

NOT TO SCALE USE ONLY NORTHERN ILLINOIS GROWN NURSERY STOCK

PLANT LIST

KEY	NAME	BOTANICAL/COMMON	SIZE	QUANTITY
AGF	ACER GINNALA 'FLAMR'	AUTUMN FLAME MAPLE	2.5"	3
ASC	ACER SACCHARUM 'COMMEMORATION'	COMMEMORATION SUGAR MAPLE	2.5"	3
CC	CERCIS CANADENSIS	EASTERN RED BUD	2.5"	5
CM	CORNUS MAS 'GOLDEN GLORY'	GOLDEN GLORY CORNELIANCHERRY DOGWOOD	2.5"	3
GD	GYMNOCLADUS DIOICUS	KENTUCKY COFFEE TREE	2.5"	3
MRJ	MALUS RED JEWEL	RED JEWEL FLOWERING CRAB APPLE	2.5"	4
QB	QUERCUS BICOLOR	SWAMP WHITE OAK	2.5"	4
JCH	JUNIPERUS CHINENSIS 'HUGHES'	HUGHES JUNIPER	5 GAL	15
AMGH	ARONIA MELANOCARPA 'GROUND HOG'	GROUND HOG CHOKEBERRY	2 GAL	112
DL	DIERVILLA LONICERA	DWF BUSH-HONEYSUCKLE	5 GAL	23
HAI	HYDRANGEA ARDRESCENS 'INCREDIBALL'	INCREDIBALL HYDRANGEA	5 GAL	3
HPLL	HYDRANGEA PANICULATA 'LITTLE LIME'	LITTLE LIME HYDRANGEA	3 GAL	2
SP	SYRINGA PATULA 'MISS KIM'	MISS KIM LILAC	5 GAL	9
SB	SPIREA BETULIFOLIA 'TOR'	BIRCHLEAF SPIREA	5 GAL	8
HEW	HOSTA EMPRESS WU	EMPRESS WU HOSTA	3 GAL	9
PAVN	PANICUM VIRGATUM 'HEAVY METAL'	HEAVY METAL SWITCH GRASS	3 GAL	10

GENERAL SEED SPECIFICATIONS

- TURF GRASS SEED RATE
250 LBS/ACRE
- GREENSKEEPER PRIDE MIXTURE
 - 20% BLUE MOON KENTUCKY BLUEGRASS
 - 20% FREDDOM III KENTUCKY BLUEGRASS
 - 20% EVEREST KENTUCKY BLUEGRASS
 - 20% CREEPING RED FESCUE
 - 20% ACCENT PERENNIAL RYEGRASS
- NATIONAL LINKS MIX
 - 25% CREEPING RED FESCUE
 - 25% CHEWINGS FESCUE
 - 25% HARD FESCUE
 - 25% SHEEP FESCUE
- CONSERV FS
4720 YENDER AVE., LISLE, IL
630-963-8787
- TURF FERTILIZATION
6-24-24 STARTER FERTILIZER
RATE: 250 LBS/ACRE

TREE, SHRUB AND PLANT BED FERTILIZER LESCO 14-14-14 POLY PLUS SULFUR COATED LANDSCAPE AND ORNAMENTAL ALL PURPOSE FERTILIZER RATE: 5 POUNDS PER 1000 S.F. PLANT BEDS ONE POUND PER CALIPER INCH FOR

I, CRAIG A HERNAN, ILLINOIS REGISTERED LANDSCAPE ARCHITECT NO. 157-000419 DO HEREBY CERTIFY THE PLAN SHOWN HEREON IS A CORRECT REPRESENTATION OF LANDSCAPE IMPROVEMENTS TO THE NOTED PROPERTY.

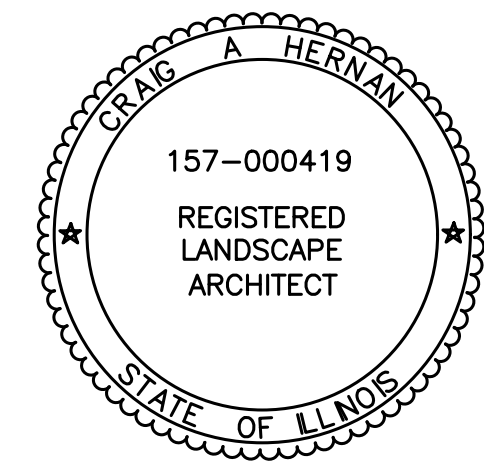

CRAIG A HERNAN
IRLA #157-000419
WESTWOOD LANDSCAPE
WEST CHICAGO, IL

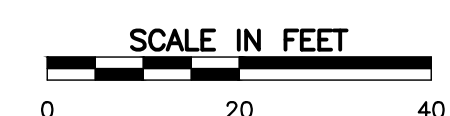

- #### REFERENCE
- EXISTING CONDITIONS ARE BASED UPON FIELD OBSERVATIONS MADE ON OCTOBER 31, 2022 BY CIVIL & ENVIRONMENTAL CONSULTANTS, INC.
 - FIELD DATUM: ILLINOIS STATE PLANE NSRS 2011, EAST ZONE- US SURVEY FOOT CITY OF NAPERVILLE DATUM NAVD 88.
 - UNDERGROUND UTILITY INFORMATION SHOWN HEREON IS BASED UPON FIELD OBSERVATIONS, ATLAS MAPS PROVIDED BY THE CITY OF NAPERVILLE AND THOSE PUBLIC UTILITY COMPANIES OPERATING UNDER FRANCHISE OR CONTRACT WITH THE CITY OF NAPERVILLE.

NO.	DATE	DESCRIPTION
1	03/21/2023	REVISION PER CITY REVIEW, DATED 02/15/2023

Civil & Environmental Consultants, Inc.
1230 East Diehl Road, Suite 200 - Naperville, IL 60563
630-963-6026 - 877-963-6026
www.cecinc.com

MILL AND BAUER, LLC
MILL AND BAUER TOWNHOMES
27W280 BAUER ROAD
NAPERVILLE, ILLINOIS 60563

DATE	DRAWN BY	MSK/MAJ	JGC
JANUARY 19, 2023			
DWG SCALE	PROJECT NO.	CHECKED BY	JGC
1"=20'	326-656.0002		
APPROVED BY:	JGC		