

SCALE: 1" = 40'

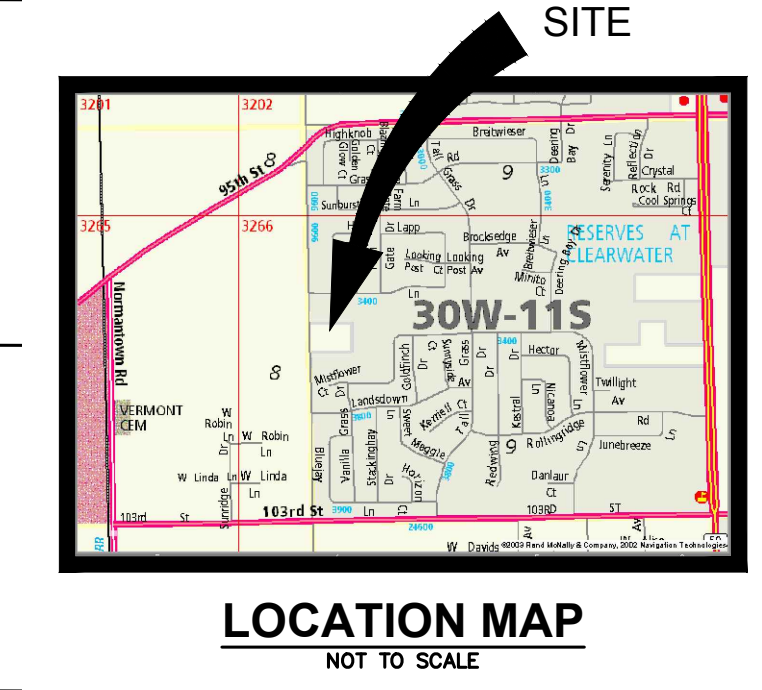

NOTE:
 DETENTION BASIN
 CONSTRUCTION TO BE
 PHASED TO ACCOMMODATE
 STORAGE REQUIREMENTS.

DETENTION
 BASIN
 HWL=687.0
 NWL=681.0

VOLUME REQUIRED
 = 6.75 AC-FT

VOLUME PROVIDED
 = 6.75 AC-FT

INTECH CONSULTANTS, INC. 1889 UNIVERSITY LANE, SUITE D LISLE, ILLINOIS 60532 PHONE: 630-964-5656 ILLINOIS REGISTRATION NO. 184-001040		
ISLAMIC CENTER OF NAPERVILLE 248TH AVENUE SITE NAPERVILLE, ILLINOIS		
PHASE I PLAN		
SCALE	1"=40'	
DATE	3-30-20	
DRAWN	BC	
DESIGNED	EFS	
PROJECT NO.	2011-016B	
SHEET	1 OF 1	
DATE	NO.	BY
7-26-21	1	PER CITY REVIEW
11-30-20	3	PER CITY REVIEW
8-27-20	2	PER CITY REVIEW
4-27-20	1	PER CLIENT REVIEW

M:\CAD Projects\2011\2011-016B\2011-016B PENG.dwg, PHASE 1, 7/26/2021 11:20:06 AM, SJP