

**PROJECT:**

**Willoway LLC**

419 S. Washington Street  
Naperville, IL 60540

**CUSTOMER APPROVAL:**

DATE

AUTHORIZED SIGNATURE

REPRESENTATIVE

Dan Olson / JB

DRAWN BY

Bill Marlow

DATE

2.07.22

SCALE

1/2" = 1'

SHEET NO.

1 of 2

ESTIMATE / JOB NUMBER

8983

FILE NAME

WIL8983

**REVISIONS:**

- 1
- 2
- 3
- 4
- 5
- 6
- 7
- 8

This sign is intended to be installed in accordance with the requirements of Article 600 of the National Electrical Code and/or other applicable local codes. This includes proper grounding and bonding of the sign.

**Remove & Relocate (1) 5'-8" x 7'-0" Double Face Illuminated Pylon Sign**

**Sign Cabinets:** Existing - Fabricated Aluminum

**Faces:** Polycarbonate with Vinyl Graphics

**Illumination:** Retrofit to New White LEDs w/ 12V 60W 120/277V Power Supplies

**Power:** (1) 20Amp @ 120Volts Electrical Circuit Run to Site by Others

**Mounting:** (2) New 3" (3½" O.D.) Sch. 40 Steel Pipes Sleeved into (2) New 6" (6.625" O.D.) Std. Steel Pipes

- Pipes Painted MP 41313 Dark Bronze

- Direct Burial into (2) 1'-0" Dia. x 5'-3" Deep Concrete Foundations

**NOTE: FIELD SURVEY REQUIRED PRIOR TO FABRICATION**

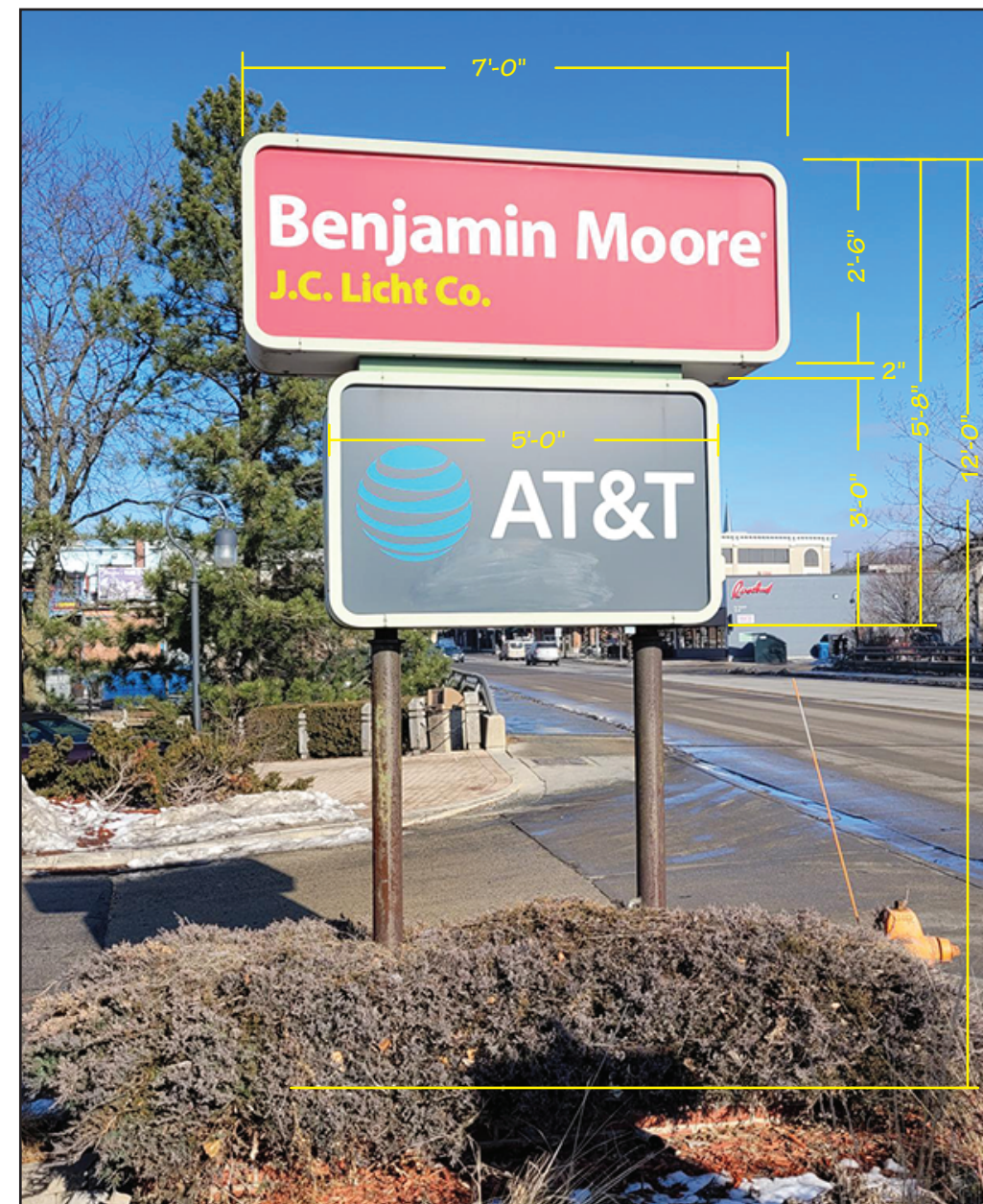
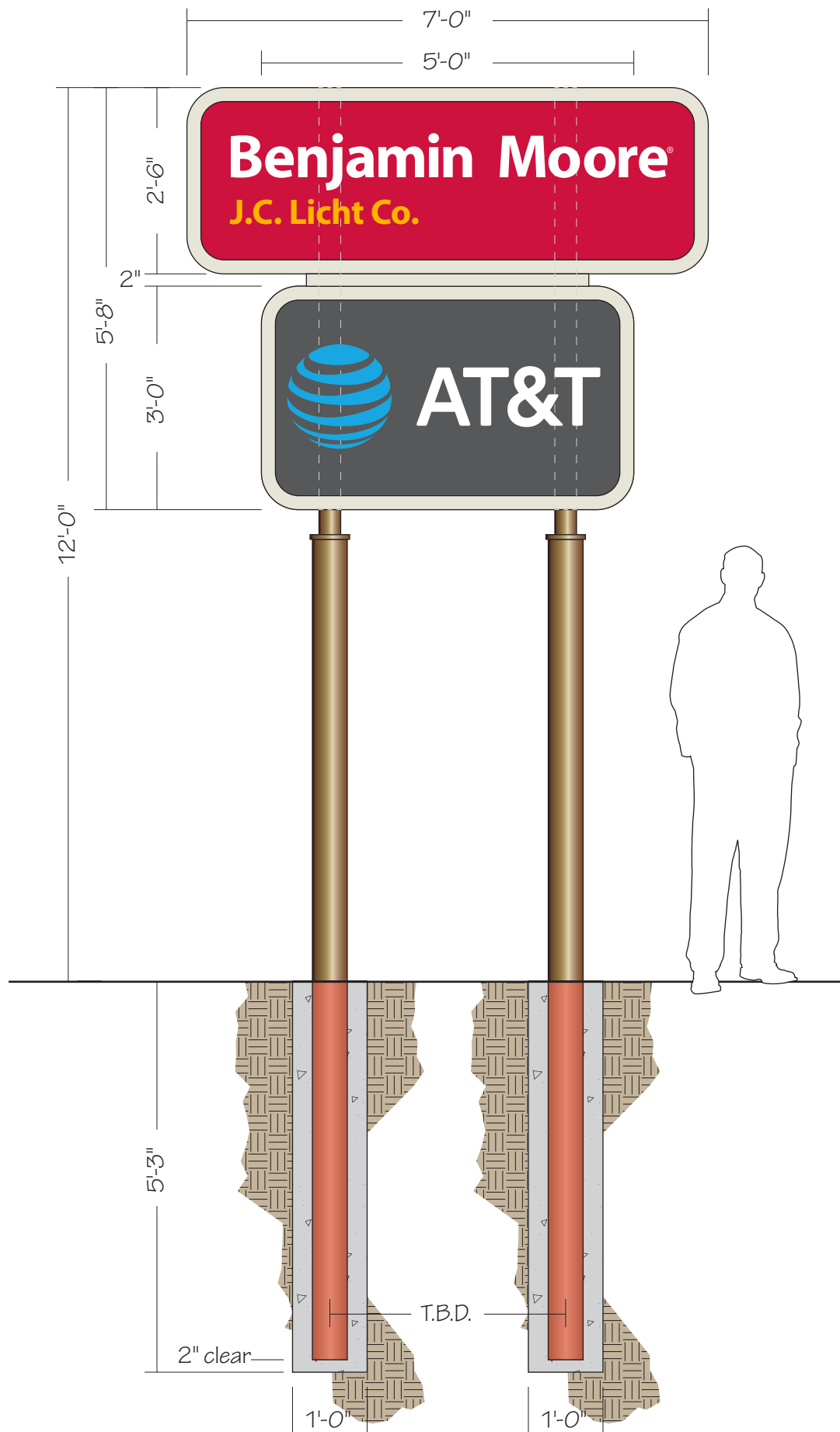

**PROJECT:**

**Willoway LLC**

419 S. Washington Street  
Naperville, IL 60540

**CUSTOMER APPROVAL:**

DATE

AUTHORIZED SIGNATURE

REPRESENTATIVE

Dan Olson / JB

DRAWN BY

Bill Marlow

DATE

2.07.22

SCALE

1" = 50'

SHEET NO.

2 of 2

ESTIMATE / JOB NUMBER

8983

FILE NAME

WIL8983

**REVISIONS:**

1	
2	
3	
4	
5	
6	
7	
8	

This sign is intended to be installed in accordance with the requirements of Article 600 of the National Electrical Code and/or other applicable local codes. This includes proper grounding and bonding of the sign.

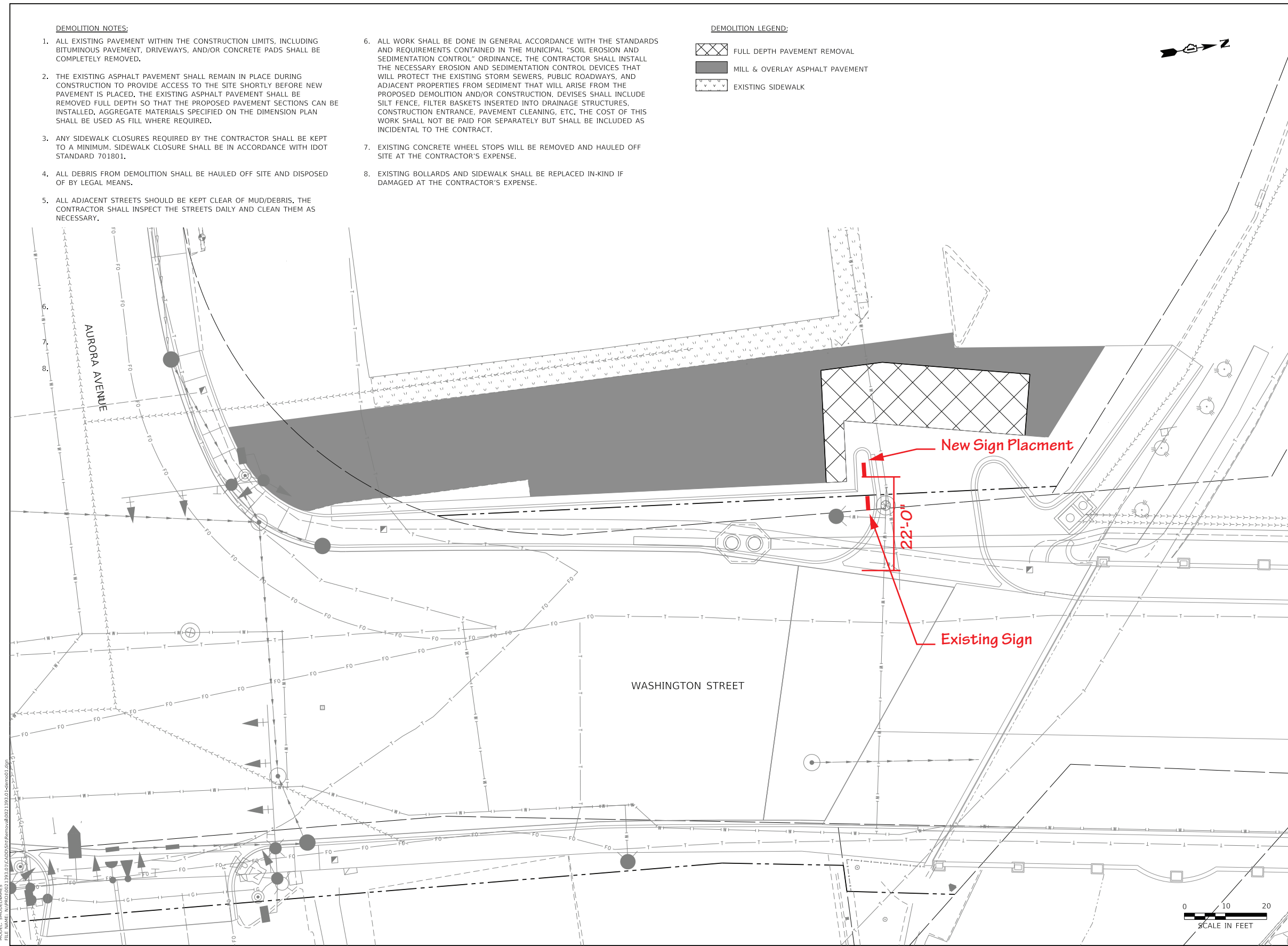

**DEMOLITION LEGEND:**

- FULL DEPTH PAVEMENT REMOVAL
- MILL & OVERLAY ASPHALT PAVEMENT
- EXISTING SIDEWALK

- DEMOLITION NOTES:**
- ALL EXISTING PAVEMENT WITHIN THE CONSTRUCTION LIMITS, INCLUDING BITUMINOUS PAVEMENT, DRIVEWAYS, AND/OR CONCRETE PADS SHALL BE COMPLETELY REMOVED.
  - THE EXISTING ASPHALT PAVEMENT SHALL REMAIN IN PLACE DURING CONSTRUCTION TO PROVIDE ACCESS TO THE SITE SHORTLY BEFORE NEW PAVEMENT IS PLACED. THE EXISTING ASPHALT PAVEMENT SHALL BE REMOVED FULL DEPTH SO THAT THE PROPOSED PAVEMENT SECTIONS CAN BE INSTALLED. AGGREGATE MATERIALS SPECIFIED ON THE DIMENSION PLAN SHALL BE USED AS FILL WHERE REQUIRED.
  - ANY SIDEWALK CLOSURES REQUIRED BY THE CONTRACTOR SHALL BE KEPT TO A MINIMUM. SIDEWALK CLOSURE SHALL BE IN ACCORDANCE WITH IDOT STANDARD 701801.
  - ALL DEBRIS FROM DEMOLITION SHALL BE HAULED OFF SITE AND DISPOSED OF BY LEGAL MEANS.
  - ALL ADJACENT STREETS SHOULD BE KEPT CLEAR OF MUD/DEBRIS. THE CONTRACTOR SHALL INSPECT THE STREETS DAILY AND CLEAN THEM AS NECESSARY.
  - ALL WORK SHALL BE DONE IN GENERAL ACCORDANCE WITH THE STANDARDS AND REQUIREMENTS CONTAINED IN THE MUNICIPAL "SOIL EROSION AND SEDIMENTATION CONTROL" ORDINANCE. THE CONTRACTOR SHALL INSTALL THE NECESSARY EROSION AND SEDIMENTATION CONTROL DEVICES THAT WILL PROTECT THE EXISTING STORM SEWERS, PUBLIC ROADWAYS, AND ADJACENT PROPERTIES FROM SEDIMENT THAT WILL ARISE FROM THE PROPOSED DEMOLITION AND/OR CONSTRUCTION. DEVICES SHALL INCLUDE SILT FENCE, FILTER BASKETS INSERTED INTO DRAINAGE STRUCTURES, CONSTRUCTION ENTRANCE, PAVEMENT CLEANING, ETC. THE COST OF THIS WORK SHALL NOT BE PAID FOR SEPARATELY BUT SHALL BE INCLUDED AS INCIDENTAL TO THE CONTRACT.
  - EXISTING CONCRETE WHEEL STOPS WILL BE REMOVED AND HAULED OFF SITE AT THE CONTRACTOR'S EXPENSE.
  - EXISTING BOLLARDS AND SIDEWALK SHALL BE REPLACED IN-KIND IF DAMAGED AT THE CONTRACTOR'S EXPENSE.

**REVISION RECORD**

NO.	DATE

**CiorbaGroup**  
8725 W. Higgins Rd, Ste 600, Chicago, IL 60631  
P 773.775.4009 | www.ciorba.com

**417-423 WASHINGTON STREET  
PARKING LOT DESIGN  
NAPERVILLE, IL**

**DEMOLITION PLAN**  
SCALE: 1"=10'  
PROJ. NO.:  
DESIGNED - TBH  
DRAWN - VZ  
CHECKED - DLD  
DATE - 12/15/2021

**C300**  
SHEET 4 OF 8



This sign is built to UL Standards for operation in North America.

"This Document is owned by, and the information contained in it is proprietary to, Parvin-Clauss Sign Company. By receipt hereof the holder agrees not to use the information, disclose it to any third party, nor reproduce this document without the prior written consent of Parvin-Clauss Sign Company. Holder also agrees to immediately return this document upon request of Parvin-Clauss Sign Company."

© Copyright 2022 by Parvin-Clauss Sign Co.