

ARCHITECTURE

PLANNING

ENGINEERING

LINEAR ARCHITECTS INC.  
4849 N. Milwaukee Ave.  
Suite # 306  
Chicago, Illinois 60630  
tel. 773.628.7273

COPYRIGHT 2020, LINEAR ARCHITECTS INC.  
THE DRAWINGS AND SPECIFICATIONS ARE AND SHALL REMAIN THE PROPERTY AND COPYRIGHT OF LINEAR ARCHITECTS INC. THESE DOCUMENTS ARE NOT TO BE USED, IN WHOLE OR IN PART, FOR OTHER PROJECTS OR PURPOSES WITHOUT SPECIFIC WRITTEN AUTHORIZATION AND CONSENT.

LICENSE EXP. 11-30-20

11/23/20	ISSUED FOR 2nd REVIEW	
10/21/20	ISSUED FOR REVIEW	
NO.	DATE	DESCRIPTION

DESCRIPTION:  
**(3) SEVEN CAR GARAGE BUILDINGS**  
970 FAIRWAY DRIVE  
NAPERVILLE, IL 60563

EXISTING DIAGRAMMATIC SITE PLAN

Scale: AS SHOWN Sheet Number:  
Drawn By: P.K.  
Project Number: 202008 **A1.1**



PARKING COUNT THIS AREA  
79 STANDARD SPACES  
1 HANDICAP SPACE  
7 GARAGE SPACES  
87 TOTAL SPACES

SEE ENLARGED SITE PLAN  
THIS AREA 3/A1.2

PARKING COUNT THIS AREA  
129 STANDARD SPACES  
7 HANDICAP SPACES  
136 TOTAL SPACES

PARKING COUNT THIS AREA  
79 STANDARD SPACES  
1 HANDICAP SPACE  
7 GARAGE SPACES  
87 TOTAL SPACES

SEE ENLARGED SITE PLAN  
THIS AREA 2/A1.2

EXISTING APARTMENT  
BUILDING TO REMAIN,  
TYP.

EXISTING PROPERTY  
LINE, TYP.

PARKING COUNT THIS AREA  
82 STANDARD SPACES  
2 HANDICAP SPACES  
7 GARAGE SPACES  
91 TOTAL SPACES

SEE ENLARGED SITE PLAN  
THIS AREA 1/A1.2

**EXISTING DIAGRAMMATIC SITE PLAN**  
SCALE: 1"= 60'-0"

SITE PARKING COUNT:  
369 STANDARD SPACES  
11 HANDICAP SPACES  
21 GARAGE SPACES  
401 TOTAL SPACES



ARCHITECTURE  
PLANNING  
ENGINEERING

LINEAR  
ARCHITECTS INC.  
4849 N. Milwaukee Ave.  
Suite # 306  
Chicago, Illinois 60630  
tel. 773.628.7273

COPYRIGHT 2020, LINEAR ARCHITECTS INC.;  
THE DRAWINGS AND SPECIFICATIONS ARE AND  
SHALL REMAIN THE PROPERTY AND COPYRIGHT  
OF LINEAR ARCHITECTS INC. THESE DOCUMENTS  
ARE NOT TO BE USED, IN WHOLE OR IN PART,  
FOR OTHER PROJECTS OR PURPOSES WITHOUT  
SPECIFIC WRITTEN AUTHORIZATION AND CONSENT.

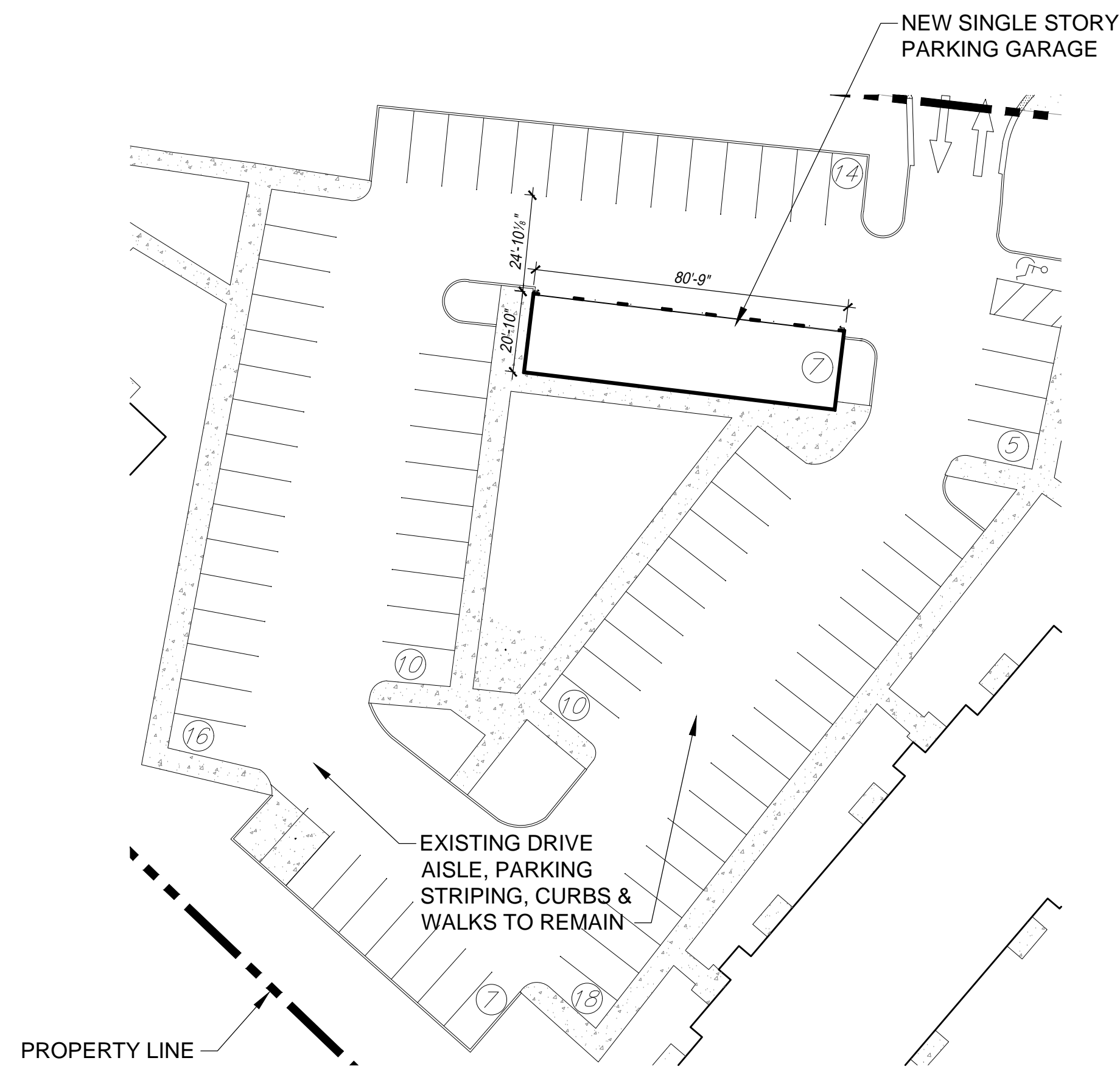

**PARTIAL SITE PLAN 3**  
SCALE: 1"= 30'-0"  
NORTH

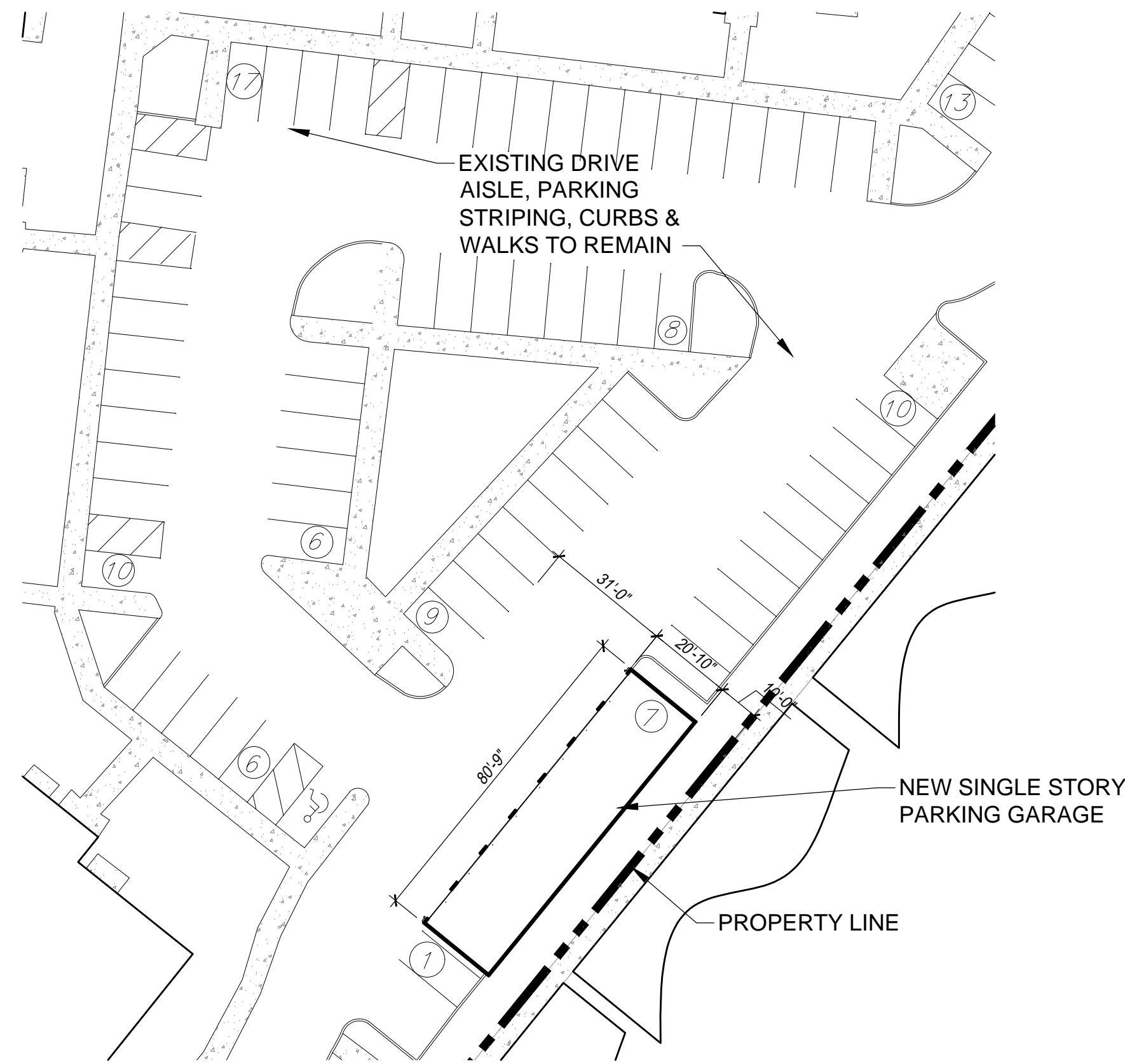

**PARTIAL SITE PLAN 2**  
SCALE: 1"= 30'-0"  
NORTH

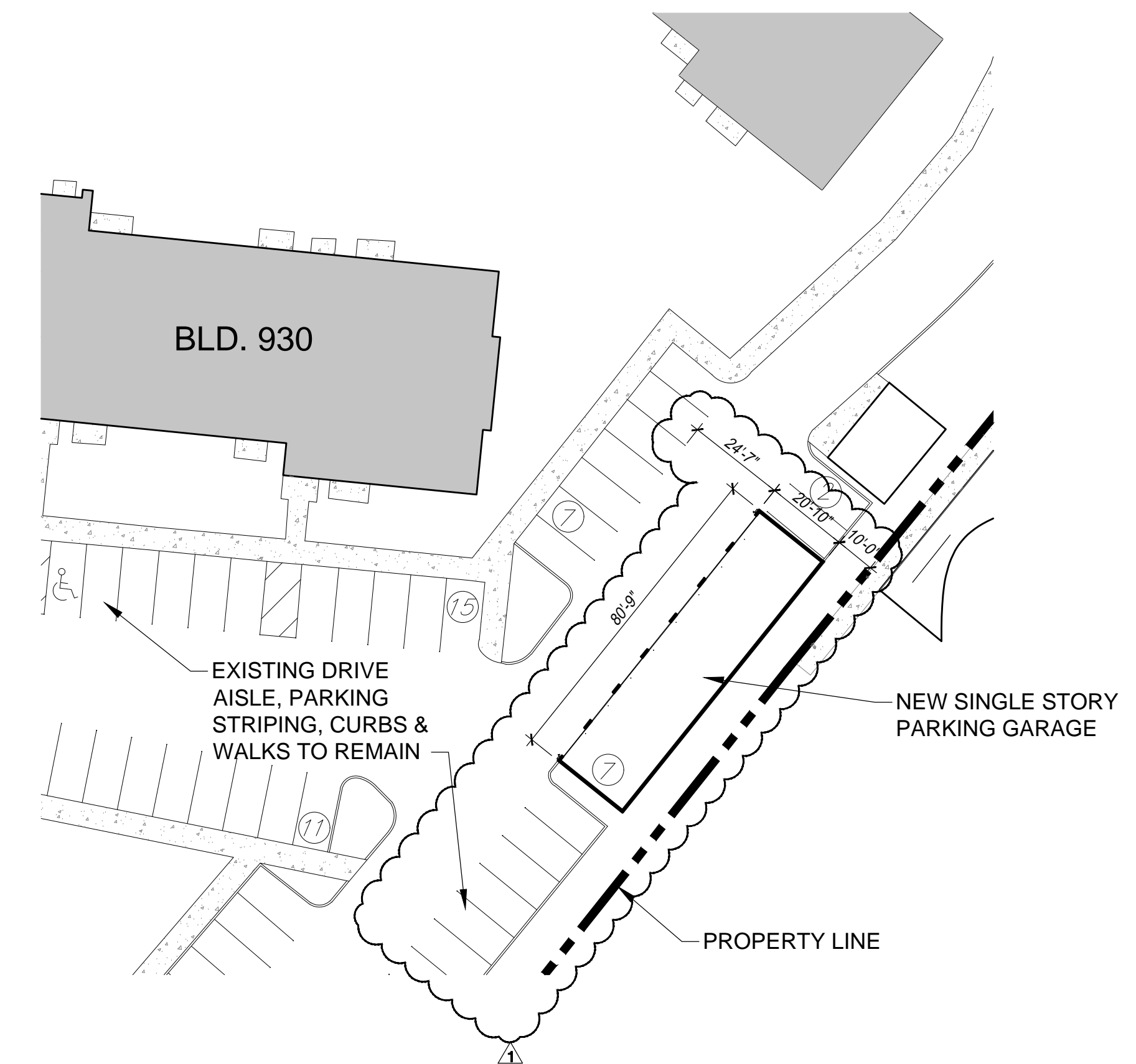

**PARTIAL SITE PLAN 1**  
SCALE: 1"= 30'-0"  
NORTH

LICENSE EXP. 11-30-20

11/23/20	ISSUED FOR 2nd REVIEW	
10/21/20	ISSUED FOR REVIEW	
NO.	DATE	DESCRIPTION
RECORD		

DESCRIPTION:

**(3) SEVEN CAR GARAGE BUILDINGS**

970 FAIRWAY DRIVE  
NAPERVILLE, IL 60563

**ENLARGED PARTIAL SITE PLANS**

Scale: AS SHOWN	Sheet Number:
Drawn By: P.K.	<b>A1.2</b>
Project Number: 202008	