

1 DECIDUOUS TREE PLANTING
1/4" = 1'-0" 32 9343.33-20

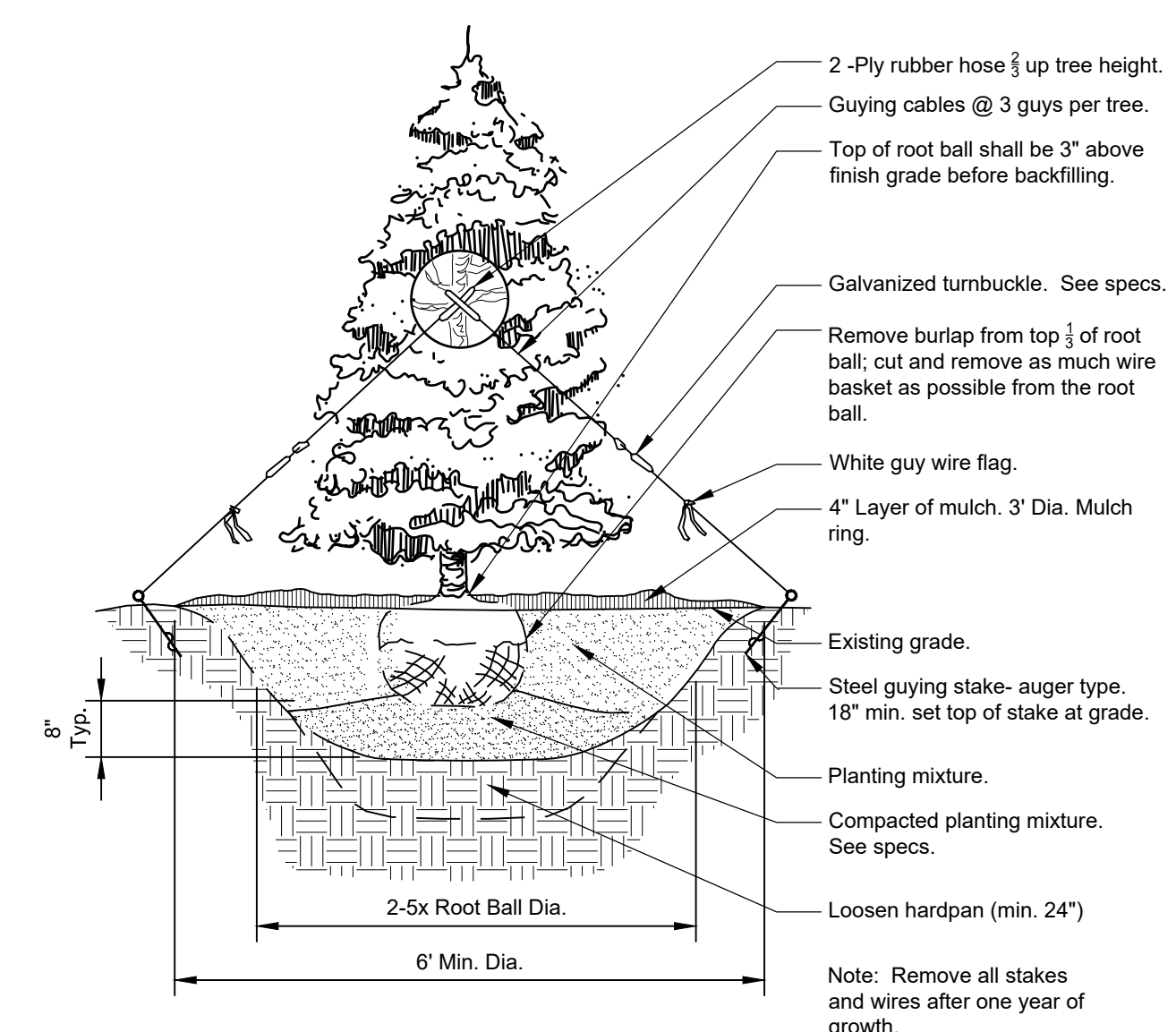

2 CONIFER TREE PLANTING
1/4" = 1'-0" 32 9343.46-01

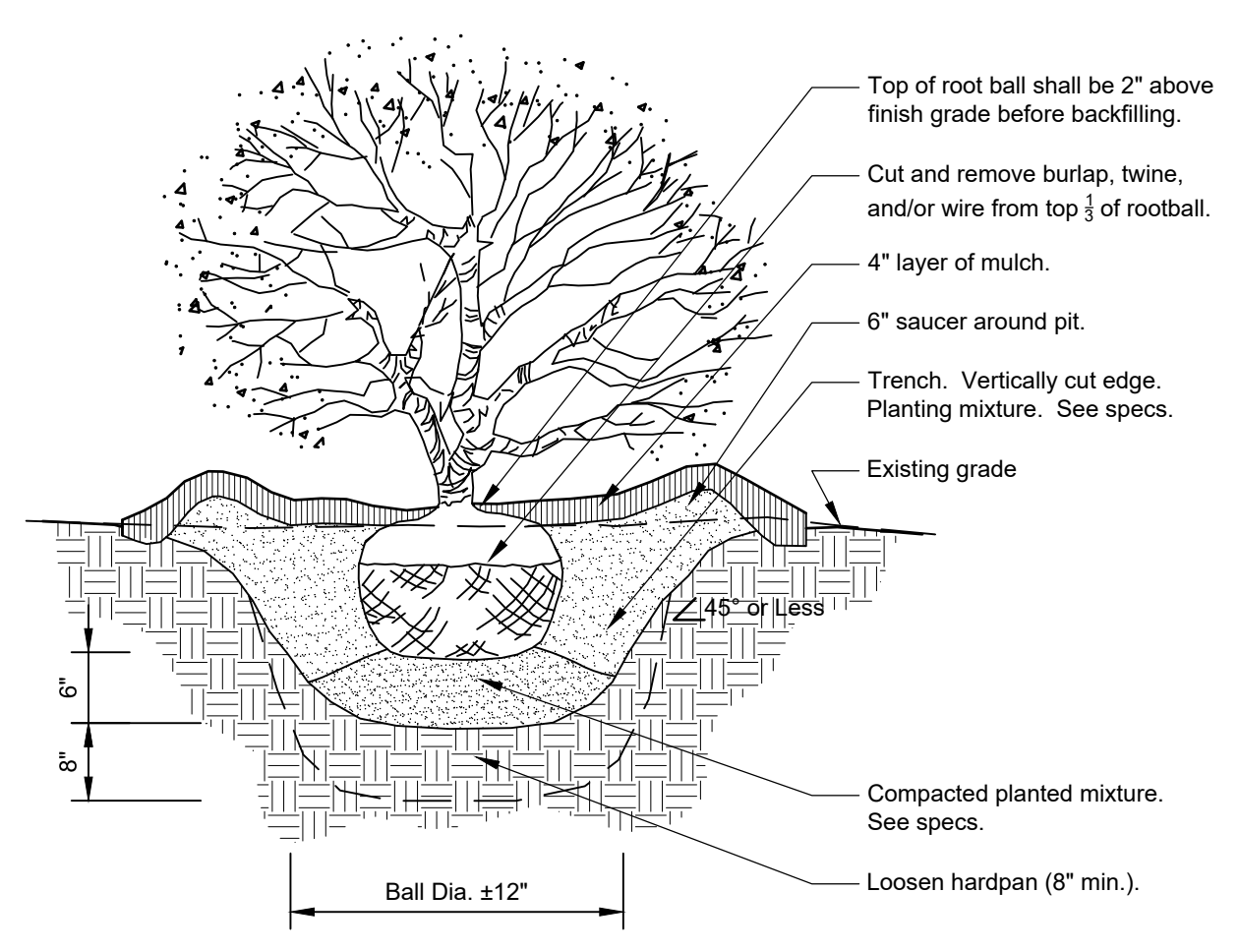

3 SHRUB PLANTING DETAIL
3/4" = 1'-0" 32 9333.16-05

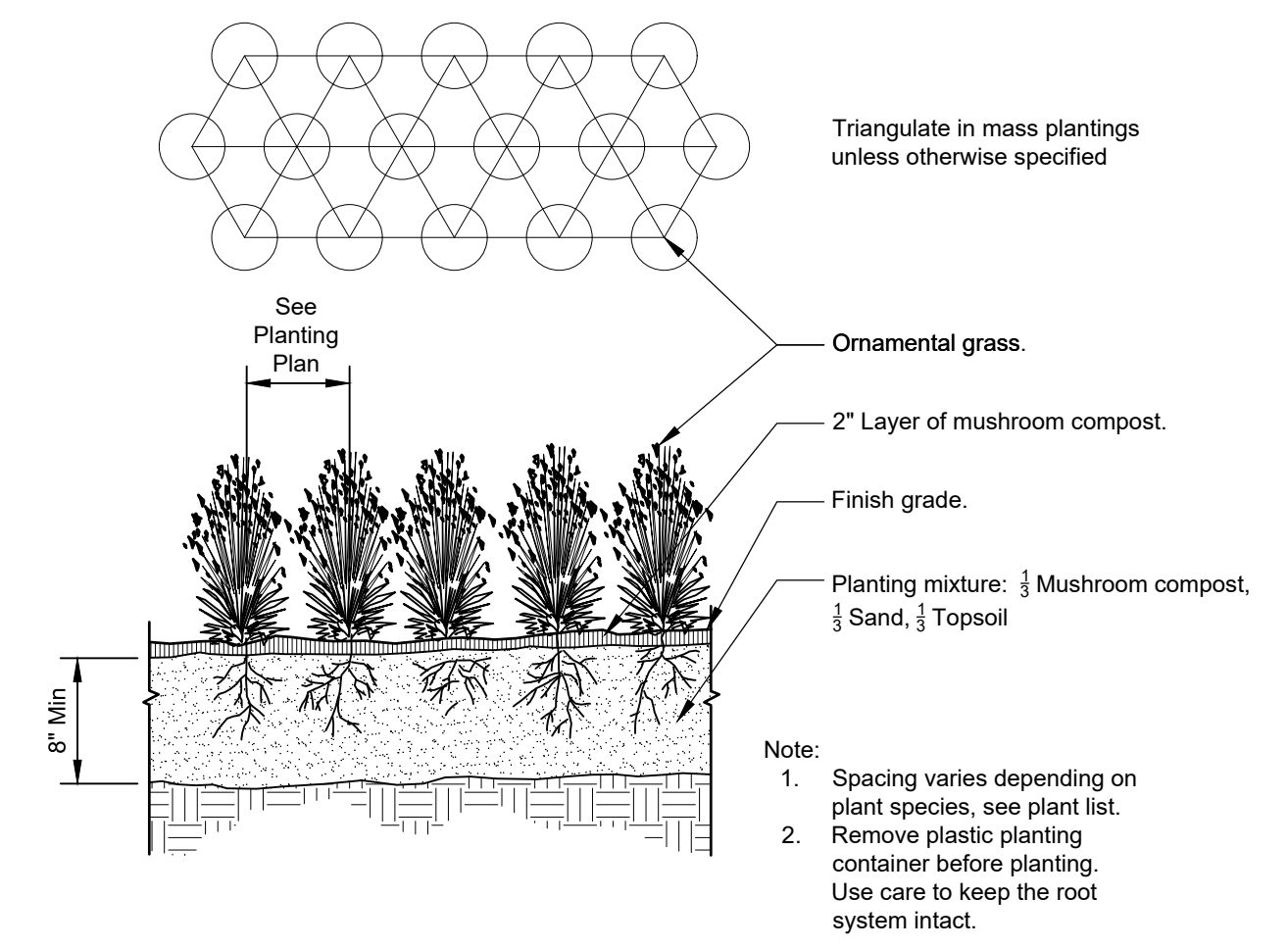

4 ORNAMENTAL GRASS PLANTING
1" = 1'-0" 32 9313-01

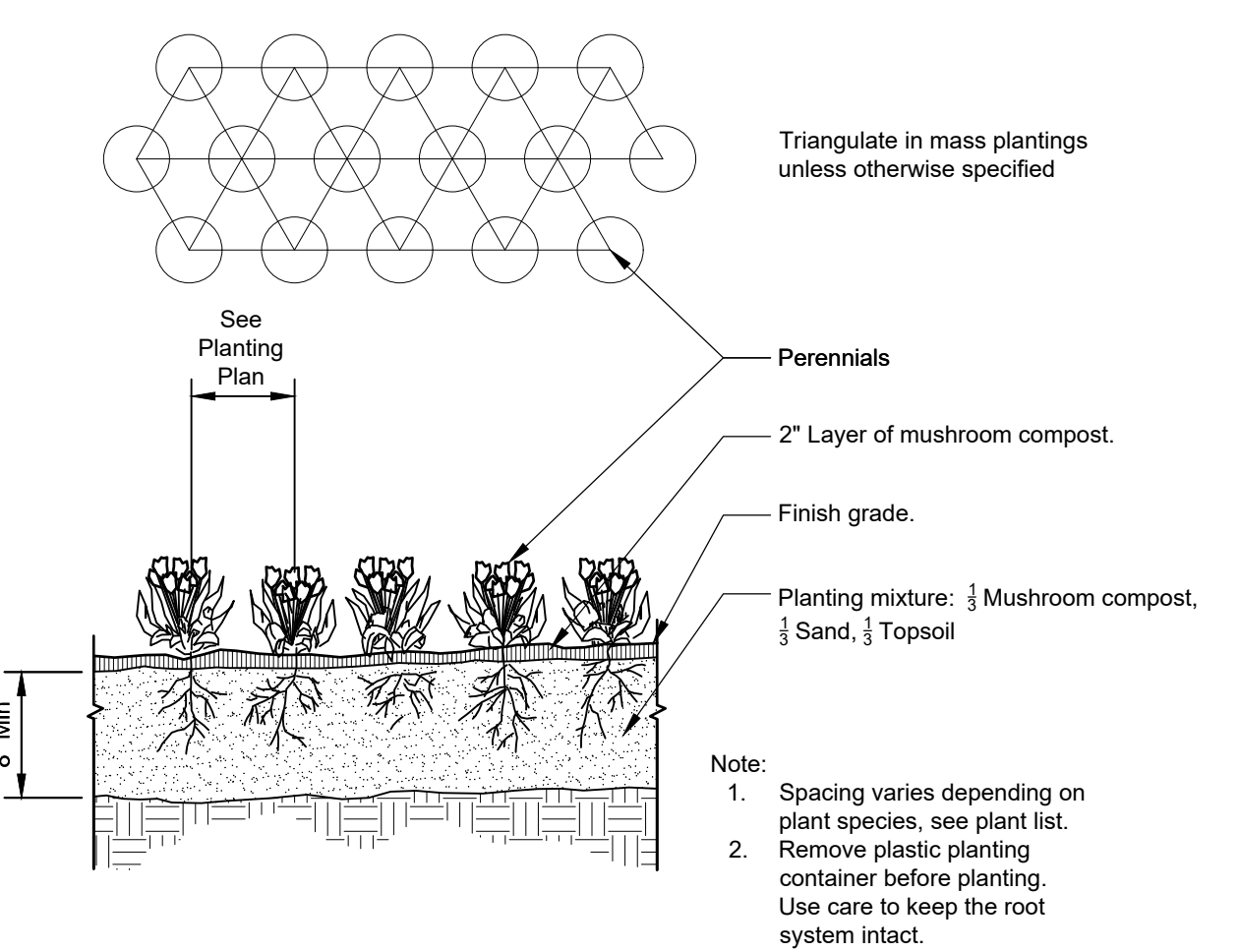

5 PERENNIAL / ANNUAL PLANTING
1" = 1'-0" 32 9313-02

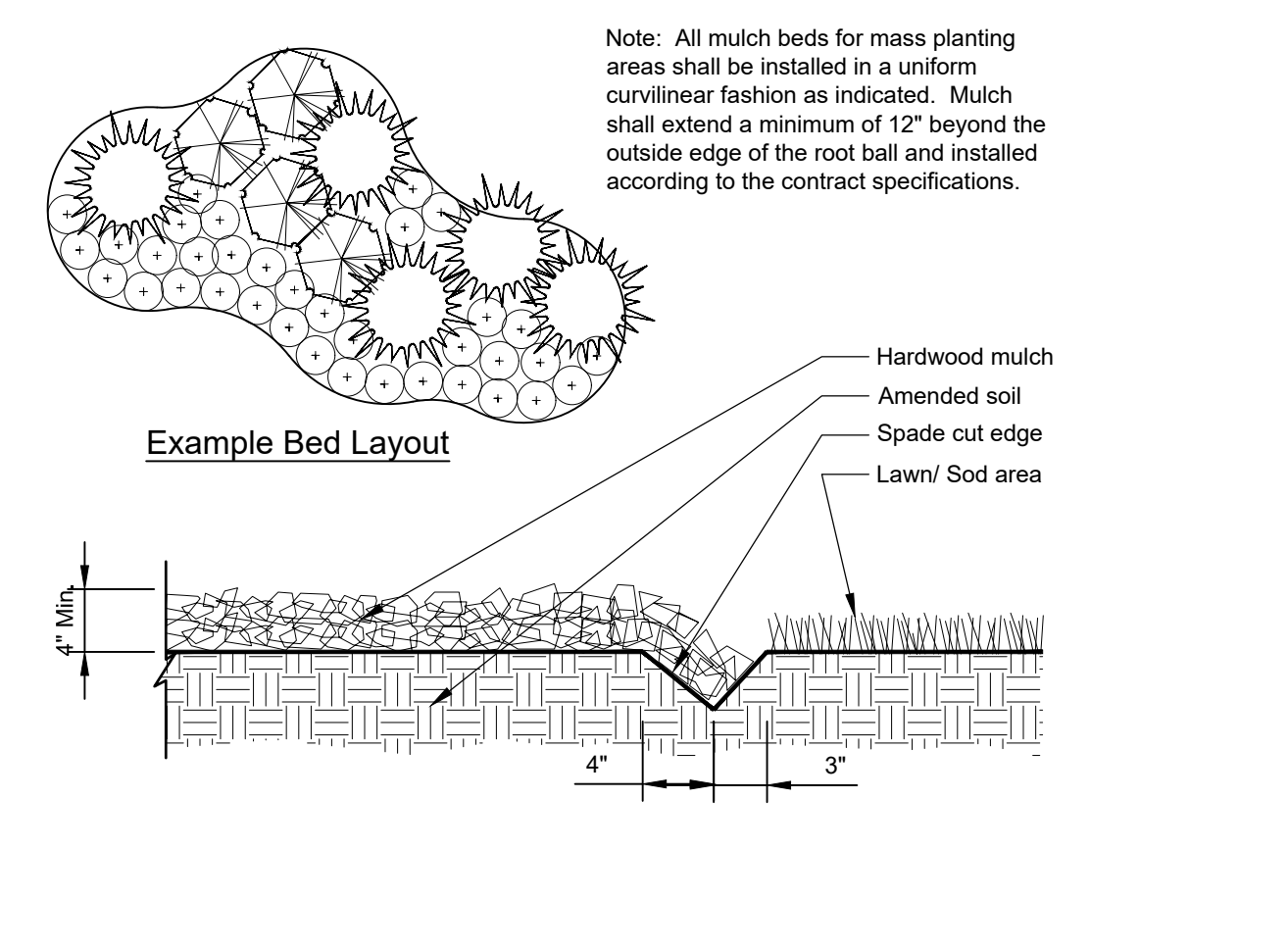

6 CONTINUOUS MULCH EDGING
1" = 1'-0" 32 9113.26-01

PLANT SCHEDULE						
DECIDUOUS TREES	QTY	BOTANICAL NAME	COMMON NAME	SIZE	CONTAINER	REMARKS
ACE AMS	7	Acer x freemanii 'Armstrong'	Armstrong Freeman Maple	2.5" Cal.	B&B	
GIN BIL	7	Ginkgo biloba	Maidenhair Tree	2.5" Cal.	B&B	
TAX DIS	8	Taxodium distichum	Bald Cypress	2.5" Cal.	B&B	
TIL SHA	3	Tilia cordata 'Bailey' TM	Shamrock Littleleaf Linden	2.5" Cal.	B&B	
DECIDUOUS SHRUBS	QTY	BOTANICAL NAME	COMMON NAME	SIZE	CONTAINER	REMARKS
ARO LSC	166	Aronia melanocarpa 'UCONNAM165' TM	Low Scape Mound Black Chokeberry	1 gal.	Pot	
CLE SIX	86	Clethra alnifolia 'Sixteen Candles'	Sixteen Candles Summersweet	3 gal.	Pot	
PHY XKO	43	Diervilla x 'G2X885411' TM	Kodiak Red Diervilla	3 gal.	Pot	
HYD VIM	11	Hydrangea paniculata 'Kolmavesu' TM	Lavalamp Flare Panicle Hydrangea	3 gal.	Pot	
HYD UUE	121	Hydrangea serrata 'MAKD' TM	Tiny Tuff Stuff Mountain Hydrangea	1 gal.	Pot	
RHU GRO	70	Rhus aromatica 'Gro-Low'	Gro-Low Fragrant Sumac	1 gal.	Pot	
ORNAMENTAL GRASSES	QTY	BOTANICAL NAME	COMMON NAME	SIZE	CONTAINER	REMARKS
PAN SHD	32	Panicum virgatum 'Shenandoah'	Shenandoah Switch Grass	1 gal.	Pot	
SES AUT	12	Sesleria autumnalis	Autumn Moor Grass	1 Ht.	Pot	
SPO AIR	4	Sporobolus airoides	Alkali Sacaton	1 gal.	Pot	

City of Naperville Required Landscaping

PARKWAY LANDSCAPING REQUIREMENT
One approved species of parkway tree per 40 feet of street or internal drive frontage, not less than 4 feet from established sidewalk line, exclusive of widths of curb cuts and 30 foot line of sight triangle at intersections of two streets. Trees shall be minimum 2.5" trunk diameter.
Provided: West internal parkway trees are spaced at no more than 40' on center. **Requirement is met.**
South internal parkway trees have insufficient space to be planted; **Variance is being requested.**

PERIMETER LANDSCAPING REQUIREMENTS
Shade trees (min. 2.5" diameter) and/or evergreen trees (min. 6' height) not more than 70 feet apart along all property lines. **Requirement is met.**

FOUNDATION LANDSCAPING REQUIREMENTS
Foundation plantings shall be located adjacent to all sides of buildings which face a public right-of-way or internal drive in a planting bed a minimum of 2 feet in width. These plantings shall consist of a minimum of one plant per every 3 linear feet of building length.
Particular attention should be paid to providing transitions between the building and ground plane, visual breaks along monotonous building facades, and enhancing walkways, entrances, seating areas or other pedestrian areas.
Required: 2' wide foundation planting bed
Provided: Foundation beds are a minimum of 3' wide

Building frontage: 196 lf. / 3 = 65 plants
Required: 1 plant per 3 l.f. of building frontage (65 plants)
Provided: 46 shrubs, 48 ornamental grasses.
Requirement is met.

PARKING LOT INTERIOR LANDSCAPING
Landscape islands (min. of 130 square feet in area and min. 8 feet in width) at end of each parking row and such that no more than 20 adjacent parking spaces are located without a landscaping area.

One shade tree (min. 2.5" diameter) per 130 square feet of landscape island. Minimum of 50% of every landscape island shall be planted with live plant material to a maximum height of 30" at maturity.
Requirement is met.

PARKING LOT PERIMETER LANDSCAPING
Min. 5 foot-wide landscape area required around that part of the perimeter of all parking lots which abut another parcel or the public right-of-way (ROW). If the perimeter landscape area is interrupted for an access drive, required planting along this lot line shall be located elsewhere on site.
Across from public ROW, internal drives, or non-residential property, landscaping required across 50% of the parking lot, exclusive of driveways, to a min. height of 30". Such landscaping shall be shrubs or hedges spaced at a max. of 4 feet on center. Shade trees (min. 2.5" diameter) at no more than 70 feet apart, exclusive of access drives.

Parking Lot perimeter - 592 lineal feet adjacent to internal drives
592 l.f. / 70 l.f. = 8.45 (8 trees)
592 l.f. x 50% = 296 linear feet of parking perimeter bed

Required - 8 canopy trees, 296 linear feet of beds
Provided - 8 canopy trees, 303 linear feet of beds

UTILITY SEPARATION REQUIREMENT
Trees - 10 feet horizontally from utility structures, 5 feet horizontally from sanitary, sewer, and water services.

The landscape plants comply with the separation distances from utility services and structures as required by Subsection 5-10-3.9 of Chapter 10 of the Municipal Code.

No obstructions shall be placed within four (4) feet of the front and two (2) feet of the sides of the electrical meter. Per Naperville Service Rules and Policies 22.2.F.
This electrical requirement is met, per plans.

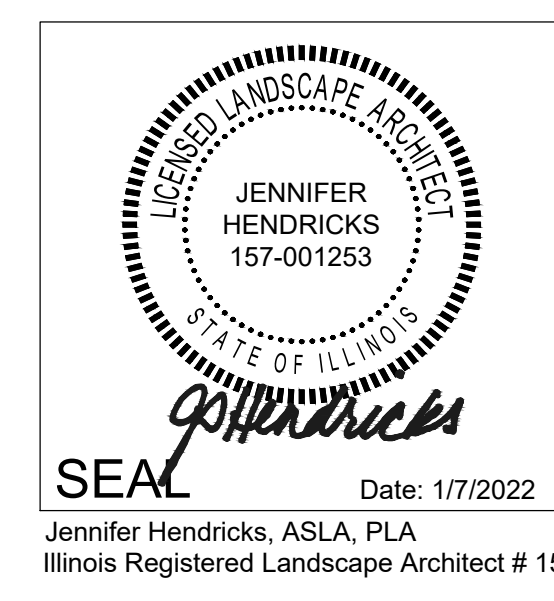

April 12, 2022 - 11:27 Dog Name: \\red-lp-sas\Projects\W\Naperville\01\Draw\Landscaping\Perennials\02_Landscaping_Plan.dwg Updated by: jhendricks

Manhard CONSULTING
 700 Springer Drive, Lombard, IL 60148 ph:630.691.8500 fx: 630.691.8585 manhard.com
 Environmental Scientists | Landscape Architects | Planners
 Construction Managers | Environmental Scientists | Landscape Architects | Planners

EASTGATE OUTLOT DEVELOPMENT
 OGDEN AVENUE & IROQUOIS AVENUE
 LANDSCAPE COVER SHEET

PROJ. MGR.:
 PROJ. ASSOC.:
 DRAWN BY: JSH
 DATE: 1/7/2022
 SCALE: 1" = 20'
 SHEET
L1 OF **L4**
 NCP.NVL01

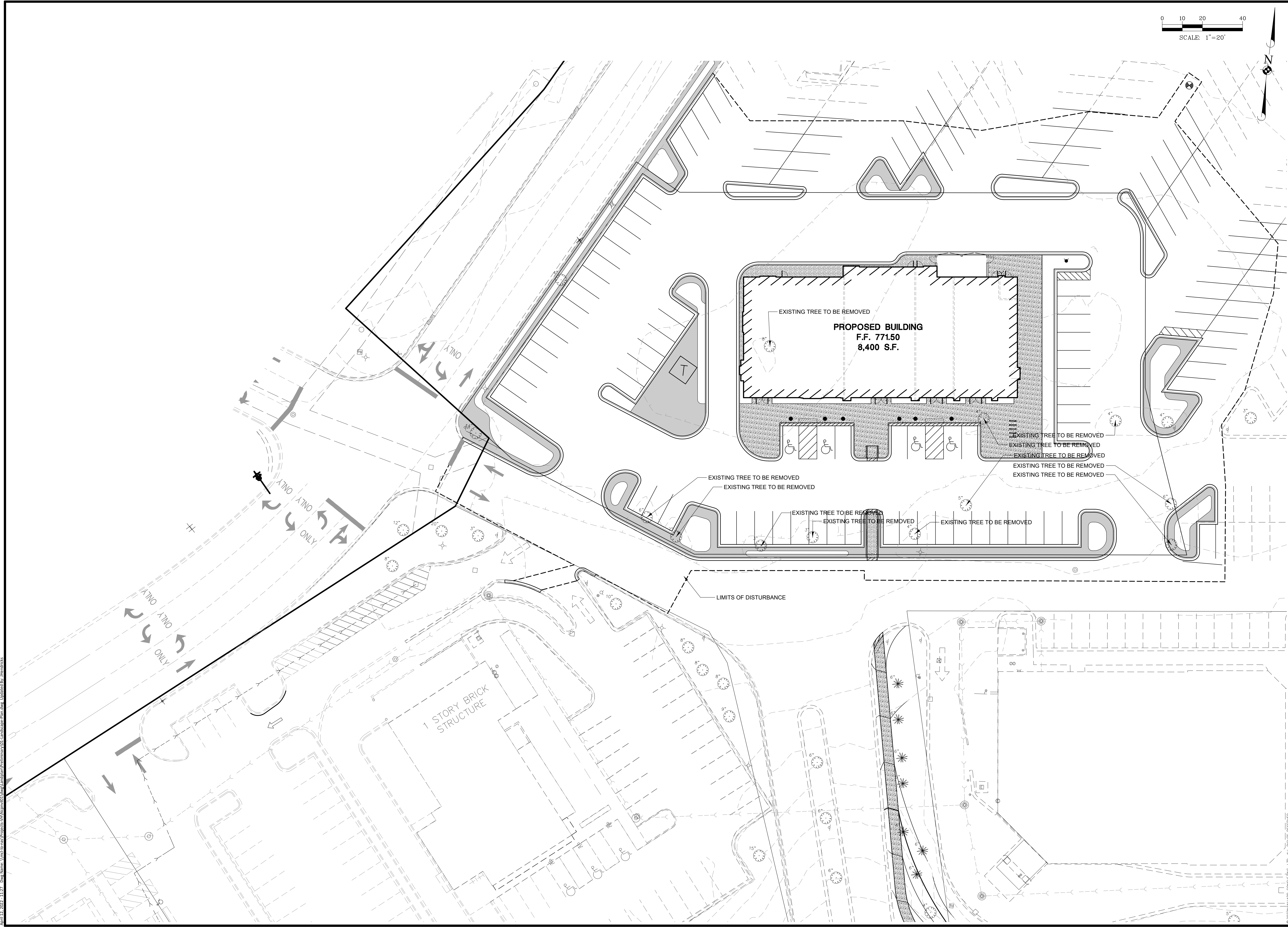
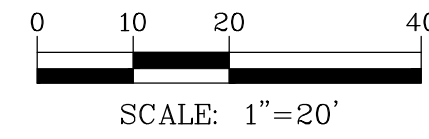

DATE	REVISIONS
7/6/2022	PER BASESIE ADJUSTMENTS

Manhard CONSULTING
 700 Springer Drive, Lombard, IL 60148 ph:630.691.8800 fx: 630.691.8885 manhard.com
 Environmental Scientists | Landscape Architects | Planners
 Construction Managers | Environmental Scientists | Landscape Architects | Planners

EASTGATE OUTLOT DEVELOPMENT
OGDEN AVENUE & IROQUOIS AVENUE
TREE REMOVALS

PROJ. MGR.: _____
 PROJ. ASSOC.: _____
 DRAWN BY: JSH
 DATE: 1/7/2022
 SCALE: 1"=20'

SHEET
L2 OF **L4**
 NCP.NVL01

© 2022 MANHARD CONSULTING, LTD. ALL RIGHTS RESERVED

April 12, 2022 - 11:27 Draw Name: \\red-lb-001\Projects\NCP\NCP001\Draw\Landplan\Preliminary\02_Landscape_Plan.dwg Updated by: jherndicks

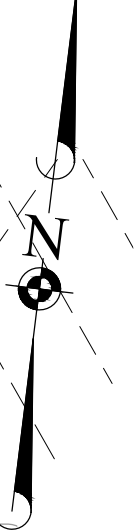
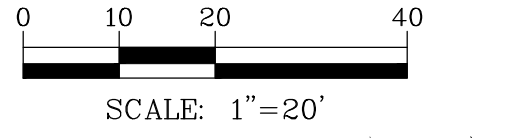

Legend:

- TURF

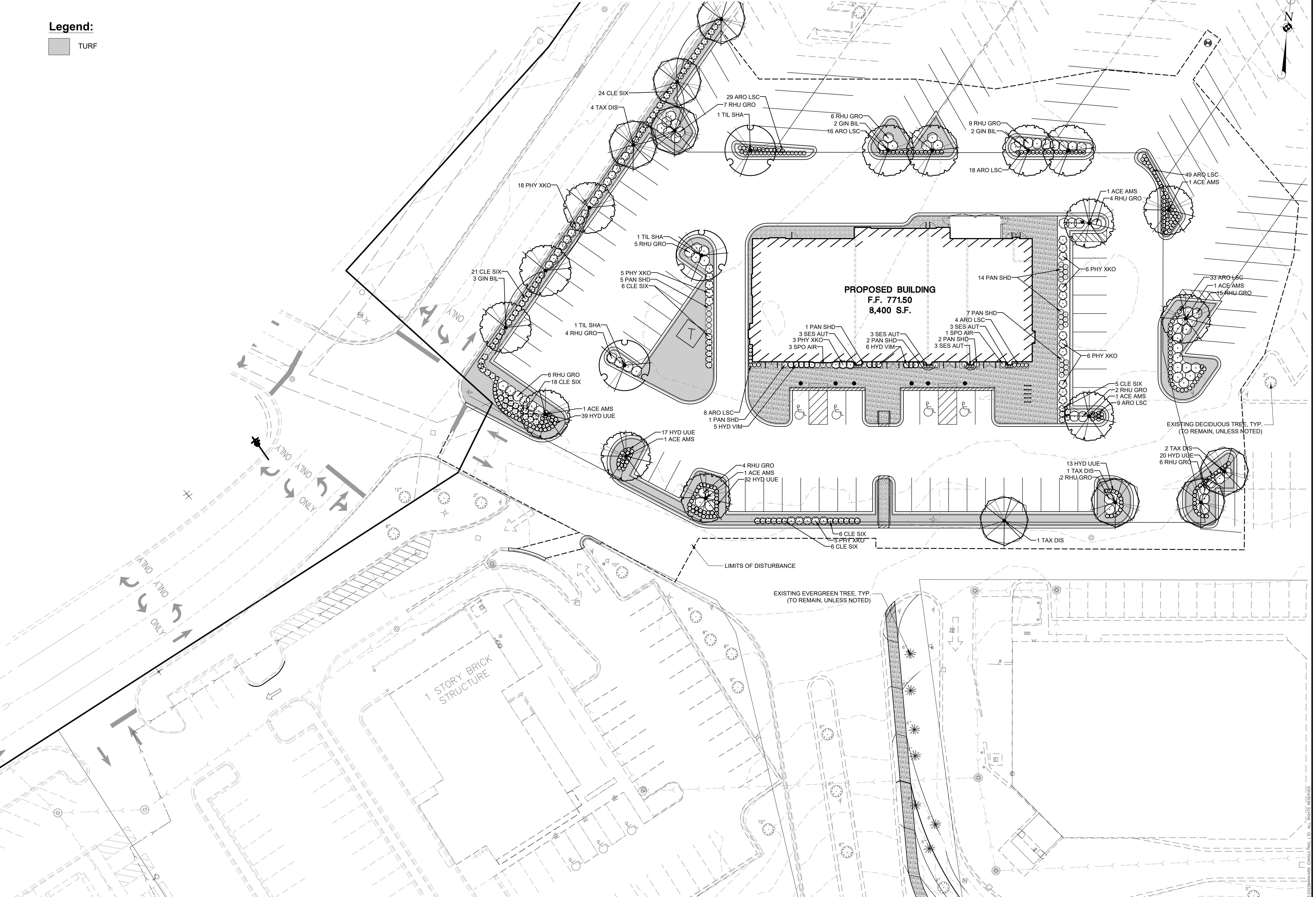

DATE	REVISIONS

Manhard CONSULTING
 700 Springer Drive, Lombard, IL 60148, phone: 630.991.8800, fax: 630.991.8895, manhard.com
 Landscape Architecture, Civil, Mechanical, Electrical & Plumbing Engineering
 Construction Managers | Environmental Scientists | Landscaping Architects | Planners

**EASTGATE OUTLOT DEVELOPMENT
 OGDEN AVENUE & IROQUOIS AVENUE
 LANDSCAPE PLAN**

PROJ. MGR: _____
 PROJ. ASSOC: _____
 DRAWN BY: **JSH**
 DATE: **1/7/2022**
 SCALE: **1"=20'**

SHEET
L3 OF L4
 NCP.NVL01

April 12, 2022 - 11:27 Draw Name: \\red-be-sas\Projects\NCP\01\Land\Landscaping\01\Landscaping\Plan.dwg Updated By: jshenrickss

© 2022 MANHARD CONSULTING, LTD. ALL RIGHTS RESERVED.

