

Layout Tab Name: C200 SITE PLAN, Images: aerial.jpg, SOUTH LOT AERIAL.jpg, Xrefs: 078581-TBLK.dwg, 078581-X.dwg, 078581-P.dwg, 078581-D.dwg, X=digitized.dwg  
 Last Saved By: ccooke, 11/19/2018 4:01:00 PM  
 G:\DE\Clients\Brikmor\078581 Heritage Square (Lazy Dog) - Naperville, IL\4.0 Disciplines\Civil\Cadd\Cad\C200-SIT.dwg Plotted By: Cooke, Jake Plotted: November 19, 2018, 4:38:38 PM

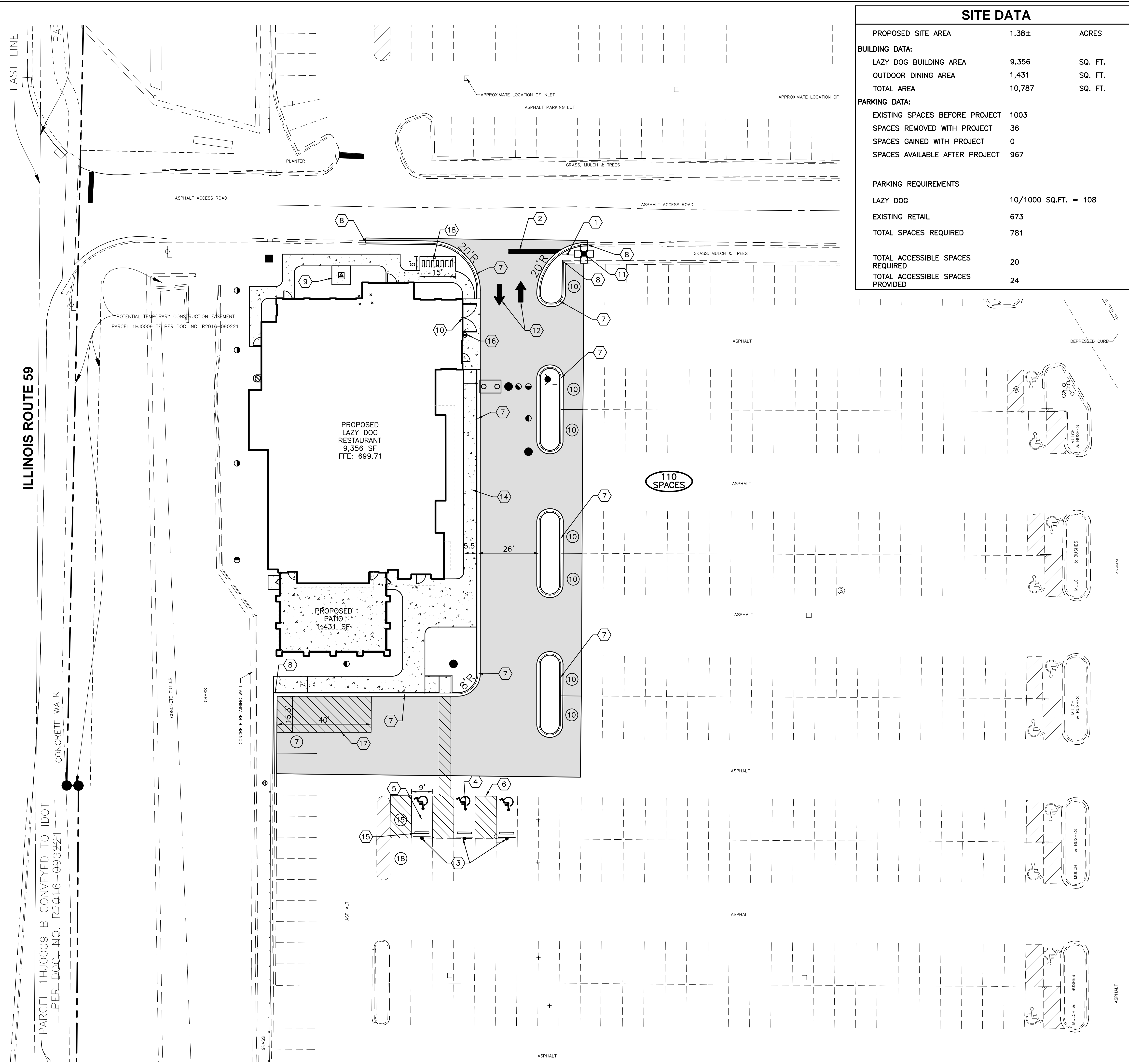

SITE DATA		
PROPOSED SITE AREA	1.38±	ACRES
<b>BUILDING DATA:</b>		
LAZY DOG BUILDING AREA	9,356	SQ. FT.
OUTDOOR DINING AREA	1,431	SQ. FT.
TOTAL AREA	10,787	SQ. FT.
<b>PARKING DATA:</b>		
EXISTING SPACES BEFORE PROJECT	1003	
SPACES REMOVED WITH PROJECT	36	
SPACES GAINED WITH PROJECT	0	
SPACES AVAILABLE AFTER PROJECT	967	
<b>PARKING REQUIREMENTS</b>		
LAZY DOG	10/1000 SQ.FT. = 108	
EXISTING RETAIL	673	
TOTAL SPACES REQUIRED	781	
TOTAL ACCESSIBLE SPACES REQUIRED	20	
TOTAL ACCESSIBLE SPACES PROVIDED	24	

### SITE LEGEND

- INDICATES LIGHT DUTY PAVEMENT—SEE DETAILS FOR PAVEMENT COMPOSITION
- INDICATES HEAVY DUTY PAVEMENT—SEE DETAILS FOR PAVEMENT COMPOSITION
- INDICATES NEW CONCRETE PAVEMENT/SIDEWALK—SEE DETAILS FOR PAVEMENT COMPOSITION
- LIGHT POLES
- EXISTING CURB AND GUTTER
- POSITIVE SLOPED CURB
- NEGATIVE SLOPED CURB
- INDICATES ROW PARKING COUNT
- INDICATES PARKING TOTAL FOR SURROUNDING AREA
- PROPERTY BOUNDARY

- ### SITE KEY NOTES
- NO. DESCRIPTION
  - 1 "STOP" SIGN, R1-1
  - 2 24" WIDE STOP BAR, TRAFFIC WHITE PAINT
  - 3 ACCESSIBLE PARKING SIGN
  - 4 ACCESSIBLE PARKING SYMBOL
  - 5 ACCESSIBLE PARKING SPACES & THEIR ACCESS AISLES SHALL BE 2% MAX. SLOPE IN ALL DIRECTIONS
  - 6 PAINT 4" WIDE STRIPES @ 2'-0" O.C. @ 45° ANGLE, TRAFFIC YELLOW PAINT
  - 7 CURB AND GUTTER
  - 8 BEGIN/END PROPOSED CURB AND GUTTER. SAWCUT EXISTING CURB TO PROVIDE CLEAN CONSTRUCTION JOINT.
  - 9 CONCRETE TRANSFORMER PAD
  - 10 DUMPSTER ENCLOSURE (SEE ARCHITECTURAL PLANS)
  - 11 LIGHT POLE LOCATION
  - 12 DIRECTIONAL ARROW, TRAFFIC WHITE PAINT
  - 13 CONCRETE BOLLARDS
  - 14 CONCRETE 5' WALK
  - 15 PARKING BLOCK
  - 16 FIRE DEPARTMENT CONNECTION
  - 17 LOADING ZONE
  - 18 BICYCLE PARKING RACK

- ### SITE NOTES
1. ALL DIMENSIONS, RADII AND COORDINATES ARE TO BACK OF CURB WHERE APPLICABLE. ALL RADII SHALL BE 4' UNLESS INDICATED OTHERWISE.
  2. ALL PAVEMENT MARKING SHALL BE YELLOW IN COLOR UNLESS INDICATED OTHERWISE.
  3. ALL CURB & GUTTER SHALL BE B6.12, "POSITIVE", UNLESS NOTED OTHERWISE (SEE DETAILS).
  4. ADA DETECTABLE WARNINGS/TRUNCATED DOMES TO BE PROVIDED AT SIDEWALKS ON EITHER SIDE OF EACH DRIVEWAY CROSSING.
  5. SEE ARCHITECTURAL PLANS FOR BUILDING DIMENSIONS.
  6. WHERE NEW PAVEMENT IS TO BE PLACED OVER CURBED ISLANDS THAT HAVE BEEN REMOVED, CONTRACTOR TO PROVIDE AGGREGATE BASE & BINDER COURSE MATCHING THE EXISTING PAVEMENT SECTIONS PRIOR TO PLACEMENT OF SURFACE COURSE.
  7. CONTRACTOR TO PERFORM PAVEMENT RESTORATION FOR ALL BUILDING FOOTINGS AND UTILITY INSTALLATIONS. CONTRACTOR TO PROVIDE 8" AGGREGATE BASE, 3" BINDER COURSE, AND 1.5" SURFACE COURSE OR MATCH THE EXISTING PAVEMENT SECTION, WHICHEVER IS GREATER.
  8. AREAS OF PAVEMENT RESTORATION SHALL BE PROOF ROLLED TO DETERMINE IF FULL DEPTH RESTORATION IS REQUIRED OR IF ONLY THE BITUMINOUS MATERIAL IS TO BE REPLACED.

**BENCHMARK:**  
 THE BASIS OF ELEVATIONS HEREON IS NAVD 88.  
 REBAR SET - SEE VICINITY MAP FOR LOCATION.  
 ELEVATION = 700.85'

<b>REVISION</b>				
No.	DATE	PROJECT No:	078581	
		DATE	08/31/18	
		DES. RW		
		DR. JC		
		CKD. RW		
		2	11/19/18	REVISED PER CITY COMMENTS
		1	10/05/18	REVISED PER CITY COMMENTS

1815 South Meyers Road  
 Suite 950  
 Oakbrook Terrace, IL 60181  
 630.424.9080  
 FAX: 630.495.3731

**SITE IMPROVEMENT PLANS**  
**HERITAGE SQUARE**  
**LAZY DOG RESTAURANT**  
 NE CORNER ROUTE 59 & AURORA AVENUE  
 NAPERVILLE, ILLINOIS

**SITE PLAN**

SHEET NO. **C200**