

- NOTES:**
1. EACH LIGHT FIXTURE TO HAVE MOTION SENSOR CONTROL. LIGHT FIXTURES TO DIM TO 33% AFTER 15 MINUTES OF NO MOTION DETECTED. ALL LIGHTS ON THAT CIRCUIT TO COME TO FULL BRIGHTNESS WHEN ONE MOTION SENSOR IS ACTIVATED ON THAT CIRCUIT.
 2. 2 #8 THWN & 1 #8 GND. IN 3/4" C. TO LIGHTING PANEL VIA PHOTOCELL-ON, TIMECLOCK-OFF.
 3. THESE PLANS COMPLY WITH NAPERVILLE MUNICIPAL CODE SECTION 6-14-4:3 AND ALL LIGHT FIXTURES ARE "DARK SKY" COMPLIANT.

ELECTRICAL SITE PLAN
SCALE: 1"=60'-0"

No.	Description	Date
09/22/25	PERMIT REVIEW COMMENTS	09/22/25
07/31/25	PERMIT REVIEW COMMENTS	07/31/25
06/12/25	ISSUED FOR PERMIT	06/12/25

INITIAL BUILDING ELECTRICAL SITE PLAN
1960 W LUCENT LANE
NAPERVILLE, ILLINOIS
KARIS CRITICAL

JACOB & HEFNER ASSOCIATES
1333 Butterfield Rd, Suite 300, Downers Grove, IL 60515
PHONE: (630) 652-4600, FAX: (630) 652-4601
www.jacobandhefner.com

Corporation Registration #194.008374
KORNACKI & ASSOCIATES, INC.
Electrical Design Consultants
262-784-3323
2645 S. Moorland Rd., New Berlin, WI 53151

DAVID B. KORNACKI
062.052986
Date: 09/22/25
Lic. Exp.: 11/30/25

AS NOTED
25057IB
E1

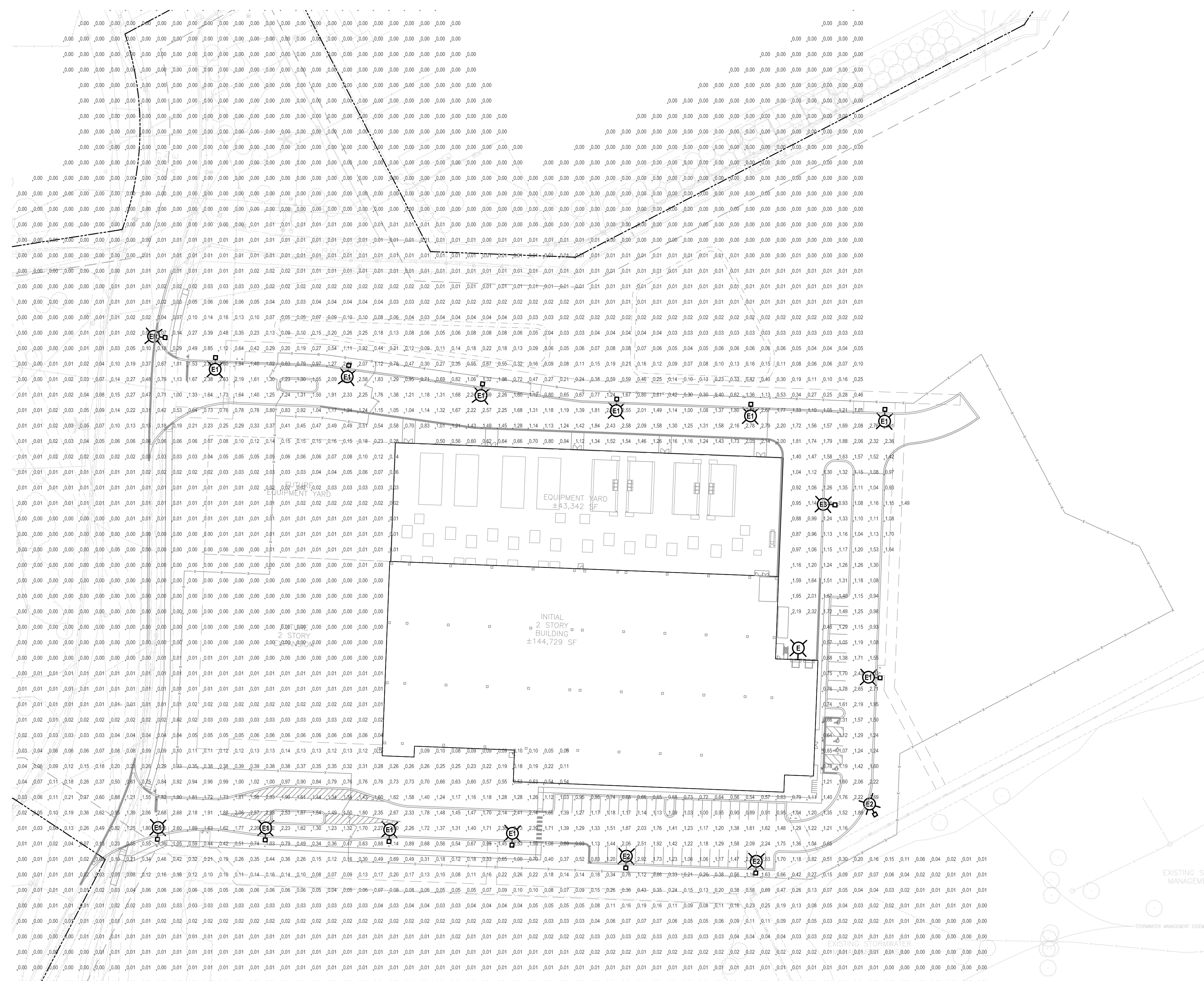

NOTES:
 1. THESE PLANS COMPLY WITH NAPERVILLE MUNICIPAL CODE SECTION 6-14-4.3 AND ALL LIGHT FIXTURES ARE "DARK SKY" COMPLIANT.

PHOTOMETRIC SITE PLAN
 SCALE: 1"=60'-0"

- LIGHTING ANALYSIS NOTES: (NAPERVILLE REQUIREMENTS)**
1. AVERAGE FOOTCANDLES: > 0.8
 2. MAXIMUM FOOTCANDLES: NA
 3. MINIMUM FOOTCANDLES: > 0.2
 4. MAXIMUM/MINIMUM RATIO: NA
 5. AVERAGE/MINIMUM RATIO: < 4:1

- LIGHTING ANALYSIS NOTES: (PAVED AREAS ONLY)**
1. AVERAGE FOOTCANDLES: 1.58
 2. MAXIMUM FOOTCANDLES: 2.92
 3. MINIMUM FOOTCANDLES: 0.53
 4. MAXIMUM/MINIMUM RATIO: 5.5:1
 5. AVERAGE/MINIMUM RATIO: 3.0:1

<p>JACOB & HEFNER ASSOCIATES 1333 Butterfield Rd., Suite 300, Downers Grove, IL 60515 PHONE: (630) 652-4600, FAX: (630) 652-4601 www.jacobandhefner.com</p>	
<p>INITIAL BUILDING PHOTOMETRIC SITE PLAN 1960 W LUCENT LANE NAPERVILLE, ILLINOIS KARIS CRITICAL</p>	
<p>PERMIT REVIEW COMMENTS 09/22/25</p>	<p>PERMIT REVIEW COMMENTS 07/31/25</p>
<p>ISSUED FOR PERMIT 06/12/25</p>	<p>Date</p>
<p>AS NOTED</p>	<p>25057IB</p>
<p>E2</p>	<p>Date: 09/22/25 Lic. Exp.: 11/30/25</p>

DAVID B. KORNACKI
 LICENSED PROFESSIONAL ENGINEER
 STATE OF ILLINOIS
 062.052986

David B. Kornacki

KORNACKI & ASSOCIATES, INC.
 Electrical Design Consultants
 262-784-3323
 2845 S. Moorland Rd., New Berlin, WI 53151

AS NOTED
 25057IB
 E2

NOTES:
 1. THESE PLANS COMPLY WITH NAPERVILLE MUNICIPAL CODE SECTION 6-14-4.3 AND ALL LIGHT FIXTURES ARE "DARK SKY" COMPLIANT.

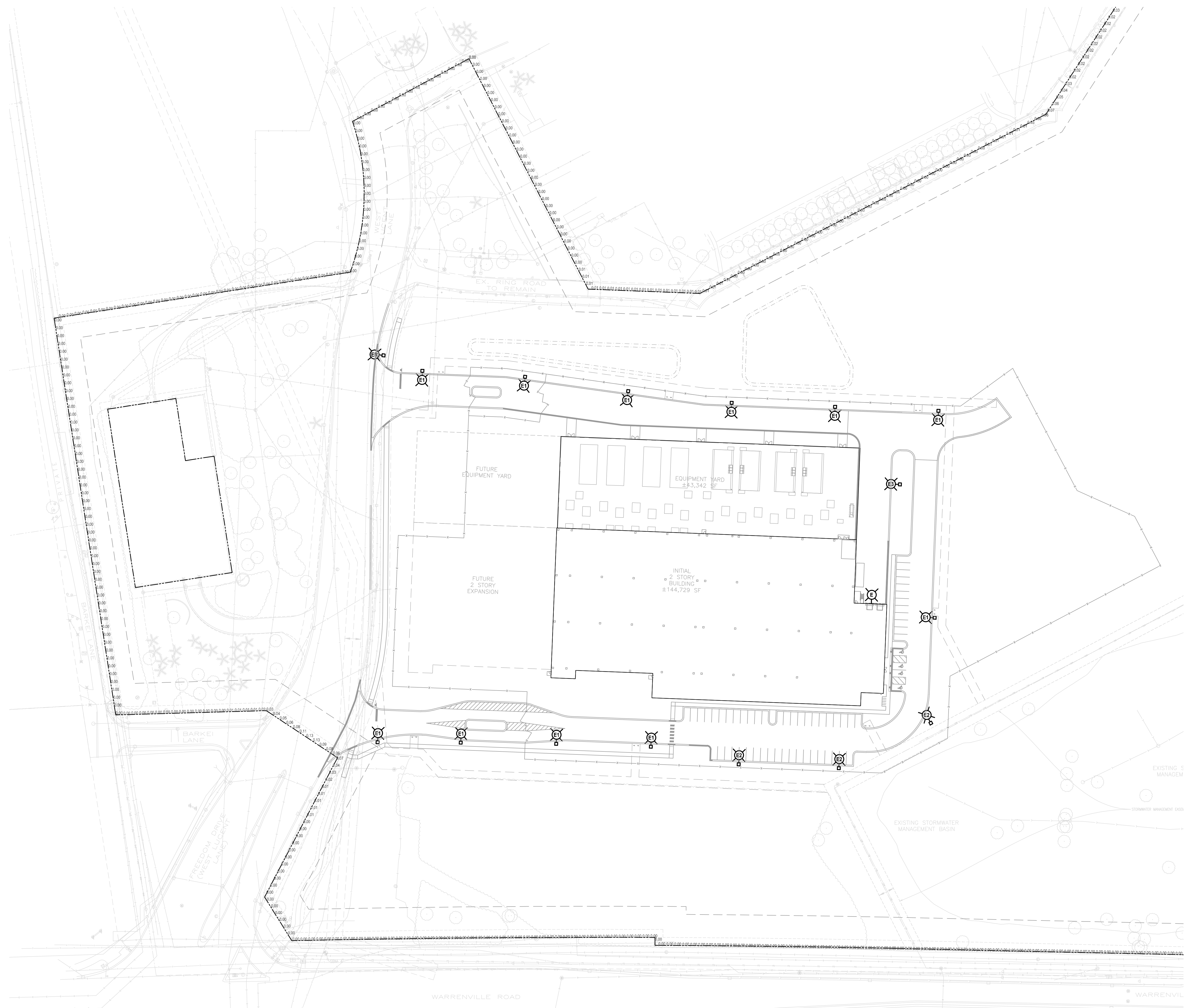

PROPERTY LINE PHOTOMETRIC SITE PLAN
 SCALE: 1"=60'-0"

LIGHTING ANALYSIS NOTES:
 (NAPERVILLE REQUIREMENTS)
 1. MAXIMUM AT PROPERTY LINE TO BE LESS THAN 2.0 FOOTCANDLES.

LIGHTING ANALYSIS NOTES:
 1. MAXIMUM AT PROPERTY LINE IS LESS THAN 0.5 FOOTCANDLES.



David B. Kornacki
 Date: 09/22/25
 Lic. Exp.: 11/30/25

JACOB & HEFNER ASSOCIATES 1333 Butterfield Rd, Suite 300, Downers Grove, IL 60515 PHONE: (630) 652-4600, FAX: (630) 652-4601 www.jacobandhefner.com	
INITIAL BUILDING PHOTOMETRIC SITE PLAN 1960 W LUCENT LANE NAPERVILLE, ILLINOIS KARIS CRITICAL	
PERMIT REVIEW COMMENTS 09/22/25	No.
PERMIT REVIEW COMMENTS 07/31/25	Description
ISSUED FOR PERMIT 06/12/25	Date
AS NOTED 25057IB E3	

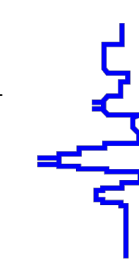
KORNACKI & ASSOCIATES, INC.
 Electrical Design Consultants
 262-784-3323
 2845 S. Moorland Rd., New Berlin, WI 53151

Corporation Registration # 194.008374

