

NORTH

DIMENSION NOTES:

- UNLESS OTHERWISE NOTED, ALL DIMENSIONS ARE TO THE BACK OF CURB AND FACE OF MONOLITHIC SIDEWALK.
- FOR MONUMENT AND BUILDING SIGN DIMENSIONS AND DETAILS SEE SIGNAGE PACKAGE PREPARED BY OTHERS.
- FOR PROPOSED BUILDING, PATIO AND TRASH ENCLOSURE DIMENSIONS, SEE ARCHITECTURAL PLANS.
- ON-SITE AND PUBLIC HANDICAP RAMP DETAILS SHALL BE CONSTRUCTED IN ACCORDANCE WITH IDOT STANDARD 424001.
- WHERE CONCRETE PAVEMENT ABUTS B6.12 CONCRETE CURB & GUTTER, B6 CONCRETE CURB OR MONOLITHIC SIDEWALK, #6 TIE BARS SHALL BE INSTALLED AT 36-INCH CENTERS.
- THE CONTRACTOR SHALL REVIEW THE PROPOSED GRADING PLAN AND TAKE NOTE WHERE PROPOSED CURB OR MONOLITHIC SIDEWALK VARIES IN HEIGHT.
- PAVEMENT MARKINGS SHALL BE AS FOLLOWS:
 - ACCESSIBLE PARKING SPACE - AS DETAILED ON ACCESSIBLE PARKING SPACE MARKINGS AND HANDICAPPED PAINTED SYMBOL.
 - PARKING SPACES AND ISLANDS - YELLOW PAINT, 4" WIDE.
 - CROSSWALK - WHITE PAINT, 12" WIDE, 6' LONG STRIPE.
- PROPOSED IMPROVEMENTS TO REFLECTION DRIVE, INCLUDING MEDIAN MODIFICATION, PAVEMENT PATCHING OR PAVEMENT OVERLAY SHALL BE CONSTRUCTED BY OTHERS.

SITE DATA

GROSS AREA:	33,624 S.F. (0.772 AC.)
NET AREA:	33,624 S.F. (0.772 AC.)
NO. OF LOTS:	1
CURRENT ZONING:	B2 PUD (COMMUNITY SHOPPING CENTER DISTRICT - PUD)
BUILDING AREA:	1,998 S.F.
PARKING REQUIRED:	10 PARKING SPACES PER 1,000 S.F. OF GROSS FLOOR AREA
PARKING PROVIDED:	
REGULAR SPACES	19
HANDICAP SPACES	1
TOTAL	20

95TH STREET
HERETOFORE DEDICATED PER
DOC. R96-057827 & DOC. R2004-090887

SIGN LEGEND

STOP
R1-1
30"x30"

RESERVED PARKING
R7-8
12"x18"

DO NOT ENTER
R7-1101

\$250 FINE
SIGN REQUIRING \$250 FINE
ILLINOIS STANDARD
R7-1101

VAN ACCESSIBLE
VAN ACCESSIBLE SIGN
18"x9"
2" SERIES D LETTERS

REFERENCE

- EXISTING CONDITIONS ARE BASED UPON FIELD OBSERVATIONS MADE ON JUNE, 10, 2021 BY CIVIL & ENVIRONMENTAL CONSULTANTS, INC.
- FIELD DATUM: ILLINOIS STATE PLANE NAVD83 (2011) NAVD88 (VRS) GEOID18 - U.S. SURVEY FOOT.
- UNDERGROUND UTILITY INFORMATION SHOWN HEREON IS BASED UPON FIELD OBSERVATIONS, ATLAS MAPS PROVIDED BY THE CITY OF NAPERVILLE AND FINAL ENGINEERING PLANS FOR ADVANCE CARE MEDICAL (ACM), PREPARED BY BARGE DESIGN SOLUTIONS WITH LAST REVISION DATE OF 04/03/2020.

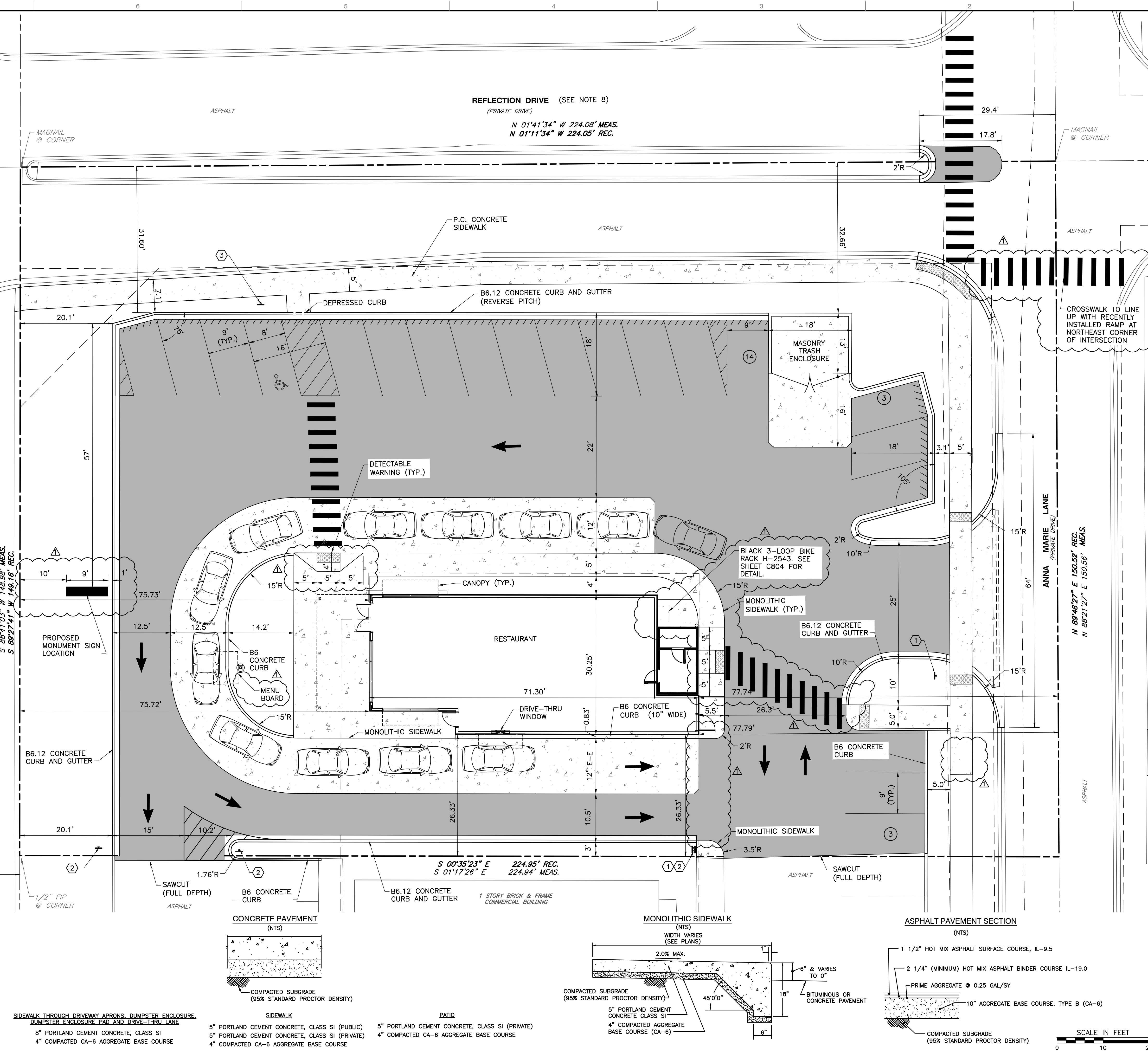

REVISION RECORD

NO.	DATE	DESCRIPTION
1	04/18/2021	REVISED PER CITY REVIEW DATED 04/16/2021

Civil & Environmental Consultants, Inc.
1230 East Diehl Road, Suite 200 - Naperville, IL 60563
630-963-6026 - 877-963-6026
www.cedinc.com

VEDASRIKANTH LLC
SCHLOTZSKY'S
3056 ANNA MARIE DRIVE
NAPERVILLE, ILLINOIS 60564

DIMENSION PLAN

DATE:	07/15/2021	DRAWN BY:	JGC
DWG. SCALE:	AS SHOWN	CHECKED BY:	311-811
PROJECT NO.:		APPROVED BY:	DRAFT

DRAWING NO. **C200**

SHEET 7 OF 14

EXHIBIT D