

PRO Fence

Naperville

Custom solutions for your fencing needs



24W640 Partridge Court, Naperville, IL 60540

www.pro-fence.net

630 864 6444

Customer	Maura and Travis	Lumley	Appt.	07/17/2023
Address	804 S Wright St.	Naperville	IL	60540
Contact	702 806 3252	mauralumely@gmail.com	Notes	Hand dig only

LF	Height	Color	Style/Model /Manufacturer	Panel	Gate	Size	Qty	Posts	Hardware	Caps
143'	6'H	Wood	PTP Traditional Board on Batton	8'W	Rack NA	NA	0	4x4	✓	✓
					Rack				✓	✓

*DuPage County fence contractor license: CR0000977 Mix concrete on site Concrete post footings Haul away post hole dirt Hang Sign

Takedown	✓	✓ Haul	Leave on Site
Soil	✓	✓ Haul	Spread Pile
Core Drills		Yes / QTY ___	No
Asphalt Drills		Yes / QTY ___	No
Permit by	✓	✓ PRO Fence	Owner
Fence Line	✓	Clear ✓ by Owner	TD
Other			

Total USD	\$6,216
Discounts	Applied
Deposit 50%	\$3,108
Final payment	\$3,108
Lead Time	3-6 Weeks
Quote Expires	10/14/2023

Traditional Board on Batton 1" Overlap
 1 x 6" PTP
 Dog Ear Pickets
 2x4 Rails
 4x4 Posts
 4x4 Cedar Post Caps

6'H 3 Rail 8' Wide Panels
 Face Nail Installation

Follow the Grade/Best Top Line

Gates:
 Cedar 2x4 Gate Frame
 Hardware: Maxima Deluxe Latch Set
 Metal, Black Painted, 8" Hinges
 Drop Rod for Double Gate

Insert removable panels by utility pole

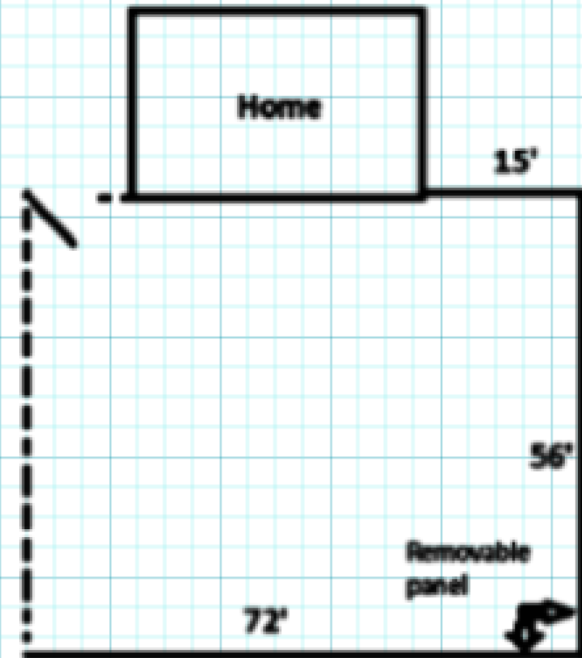

Payment: check, Zelle. Final payment is due upon completion.
 NOTE: 3% credit card fees may apply, if paid with a credit card.

Customer signature Date/...../ 2024

PRO Fence signature *Ethan Root* Date 03/22/2024

See page 2 for important information



Custom solutions for your fencing needs



www.pro-fence.net

office@pro-fence.net

630 864 6444

Customer	Maura	Lumley	Notes	PTP 6'H Traditional B on B
----------	-------	--------	-------	----------------------------

PRO Fence Naperville Will Do. Please check the box and initial:

- Complete this project as agreed and according to the fence industry standards, local municipality fence building codes and guidelines.
- 5 Year guarantee against improper fence line installation workmanship and 1 year guarantee against improper gate installation workmanship.
- If for any unforeseen circumstances beyond our ability to deliver on our promise, PRO Fence Naperville will return the deposit.
- We call J.U.L.I.E a few days prior to installation - J.U.L.I.E utility crews will come to mark electric, gas, water, sewer and telecommunications underground lines in the digging area of your yard.
- Schedule post hole inspection, if required.
- Confirm installation one or two days before we come, weather permitting.

Customer Will Do. Please read carefully. If it does not apply, please make notes.

- Clear fence line 12" on both sides of the proposed fence perimeter, unless agreed otherwise.
- Wood may shrink, warp, bow, crack and fade upon installation. These conditions are not covered by PRO Fence Naperville workmanship warranty.
- If PRO Fence has to perform light landscaping work, extra charges may apply and we will leave the debris on site.
- Mark all private utility underground lines, such as, sprinkler lines, cables, drainage or any other underground lines that might be damaged during the installation.
- PRO Fence Naperville should not be held responsible for damaging unmarked privately installed underground lines.
- Provide PRO Fence with a written consent from your neighbor to take their fence down, if applicable.
- Provide access to water and electricity.
- Understand that "Lead Time" starts after PRO Fence has the following documents: 1. Signed and dated contract; 2. 50% deposit; 3. Plat of Survey; 4. Permit and HOA approval, if required.
- Additional charges may apply, if unaccounted for conditions, such as, but not limited to rock, asphalt, concrete, etc. are encountered during digging that would require additional labor and/or equipment.
- If PRO Fence Naperville is required to enforce this contract, collection fees, court costs and attorney's fees shall be paid by Customer.
- Customer's signature below is the acknowledgement and legal acceptance of this contract.

Payment options: check, cash, or credit card (credit card transaction fees may apply) and should be made, as agreed.

- Payments will be made as outlined in this contract, unless agreed otherwise.
- Final payment is due upon completion of this project. A late fee of \$20 a day will be assessed after 7 days, unless agreed otherwise.

To apply for permit, prepare : 1. 2-3 Copies of the plat of survey, 2. a copy of this contract, 3. the brochure, and 4. your HOA approval letter, if applicable.

Thanks for an opportunity to work with you!

Customer signature Date/...../ 2024

PRO Fence Naperville signature *Phan Root* Date 03/22/2024