

SCALE: 1" = 40'

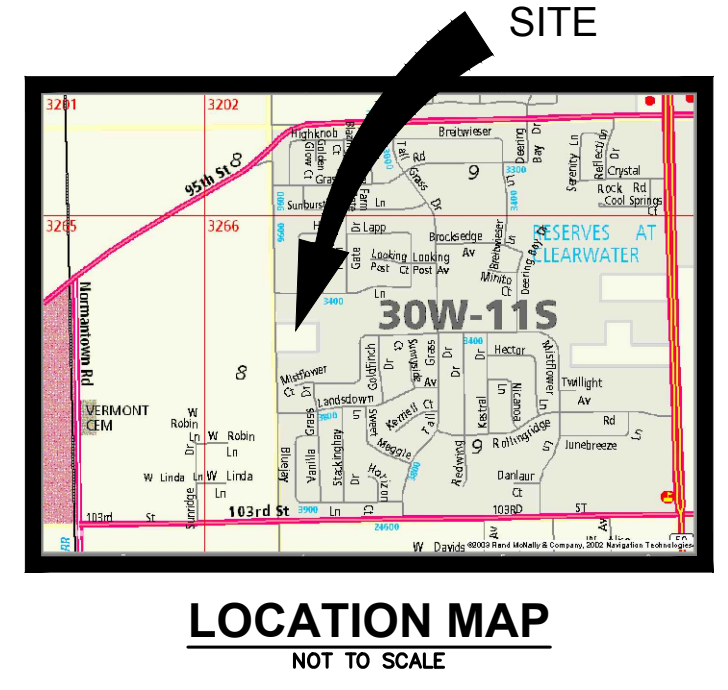

**NOTE:**  
 DETENTION BASIN  
 CONSTRUCTION TO BE  
 PHASED TO ACCOMMODATE  
 STORAGE REQUIREMENTS.

DETENTION  
 BASIN  
 HWL=687.0  
 NWL=681.0

VOLUME REQUIRED  
 = 6.75 AC-FT

VOLUME PROVIDED  
 = 6.75 AC-FT

<b>INTECH CONSULTANTS, INC.</b> 1889 UNIVERSITY LANE, SUITE D LISLE, ILLINOIS 60532 PHONE: 630-964-5656 ILLINOIS REGISTRATION NO. 184-001040		PER CITY REVIEW PER CITY REVIEW PER CLIENT REVIEW DATE NO. REVISION
<b>ISLAMIC CENTER OF NAPERVILLE</b> 248TH AVENUE SITE NAPERVILLE, ILLINOIS		11-30-20 3 8-27-20 2 4-27-20 1
<b>PHASE I PLAN</b>		PROJECT NO. <b>2011-016B</b> SHEET <b>1</b> OF <b>1</b>

M:\CAD Projects\2011\2011-016B\2011-016B PENG.dwg, PHASE 1, 12/20/20 7:33:18 AM, S/P