

Parking Study

for



Islamic Center of Naperville

248th Avenue Campus

Naperville, Illinois

May 20, 2020

Intech Consultants, Inc.
1989 University Drive, Suite D
Lisle, Illinois 60532

PURPOSE OF THE STUDY

This parking study has been requested by the City of Naperville as a means of establishing the amount of parking that will likely be necessary for the new religious campus proposed by the Islamic Center of Naperville, to be located on the east side of 248th Avenue between 95th Street and 103rd Street in Naperville, Illinois.

Since the proposed campus will contain multiple uses (mosque, school, multi-purpose hall, and gymnasium), it was felt by the City of Naperville that a more in-depth analysis of the parking demands for this proposed site would be warranted rather than just a simple recitation of the zoning code requirements.

To this end, this report describes the project and its various land uses in some detail, outlines the zoning code requirements of the City, presents actual parking counts taken on various days during the week of January 20, 2020 at the other three ICN facilities in the area, and presents a series of projections of the likely parking demand at the new campus upon full build out.

DESCRIPTION OF PROJECT

The Islamic Center of Naperville (ICN) is the owner of a 13.63 acre site located on the east side of 248th Avenue between 95th and 103rd Streets in the City of Naperville, Illinois.

The Islamic Center desires to develop this site in accordance with their attached Master Plan to accommodate school, mosque, multi-purpose hall, and gymnasium uses. The site will be built in five (5) phases over the next 40 years, one phase for each of the uses.

Each of the intended uses and its operations are more fully described in the sections below.

Mosque (Phase I, Initial Construction 2020)

The mosque planned for the ICN campus is to be constructed in two phases. The initial Phase I construction will encompass the majority of the ultimate building, and many of the uses ultimately planned for this facility. The worship space in the mosque is planned to be enlarged as part of Phase V of the overall campus construction, and is more fully described in the Phase V narrative that follows.

The initial mosque construction proposed as part of Phase I is to be a two story building consisting of approximately 26,219 square feet which will initially provide worship space for 300 men and 157 women. It will also include space for offices, conference rooms, storage, multipurpose spaces, washrooms, and the like.

In addition to the times of worship, the mosque will also be used for the religious requirements of weddings, funerals, and special observances throughout the week as necessary.

The Islamic religion requires worship five times a day, seven days a week, not necessarily in a Mosque. The worship times are generally held before dawn, in the early afternoon, late afternoon, early evening, and late evening. Except for the Friday early afternoon services, attendance at prayer times is light, amounting to perhaps no more than 50-100 individuals at any one time. These prayer times are generally one hour or less.

Two prayer services are planned for Friday early afternoon between 12 PM and 3 PM, and are the most heavily attended services. Attendance at the first service in Phase 1 is expected to attract approximately 300 men and 150 women. The 2 PM service will have a somewhat smaller attendance.

In addition to the standard worship times, there will also be other services and activities held throughout the month-long observance of Ramadan. Ramadan occurs at different times each year, as the observance is based on the lunar calendar. Ramadan gatherings and prayers generally are held daily throughout the month after sunset (avg. 8 PM -12 AM) with attendance approximating that of Friday afternoon services for the first and last week, with reduced attendance in between.

School (Phase II, Initial Construction 2030)

The school will be a two story building consisting of approximately 41,749 square feet, and will contain 25 classrooms and space for support activities such as offices, storage, multipurpose room, mechanical spaces, staff lounge, nurse's office and the like.

The school is intended to provide full-time schooling for up to approximately 250 students from grades K-5. A preschool is also planned. Day care facilities are not proposed.

The school will operate during the normal school day on Monday through Friday as a full time school. On weekends, religious classes will be held between 9 AM – 2 PM on Saturday, with up to 500 children attending. On occasion, adult classes may also be held as need or demand dictates. These would occur mainly during evenings and weekends.

Multi-Purpose Hall (Phase III, Initial Construction 2040)

The Multi-Purpose Hall is a one story building consisting of approximately 22,814 square feet that will be used for conferences, interfaith events, and wedding receptions. The Hall will have a full-service kitchen and seating for 500. Use of the Hall is planned for Fridays – Sundays, with actual use depending on demand.

Gymnasium (Phase IV, Initial Construction 2050)

The gymnasium is a one story building consisting of approximately 26,852 square feet. It will provide the congregation with space for indoor physical activities including possible league play for volleyball, basketball, and badminton, "open gym" use times, and other uses such as Scouting activities. Use of the gymnasium will occur mostly in evenings and on weekends.

Mosque Expansion (Phase V, Initial Construction 2060)

The expansion of the mosque will enlarge the worship space of the facility by 3,259 square feet and increase the worship occupancy from the Phase I capacity of 300 men and 157 women to 461 men and 355 women.

C:\Cad Projects\2011-016B Peng.dwg, MASTER SITE PLAN, 4/27/2020, 1:28:00 PM, BY: BC

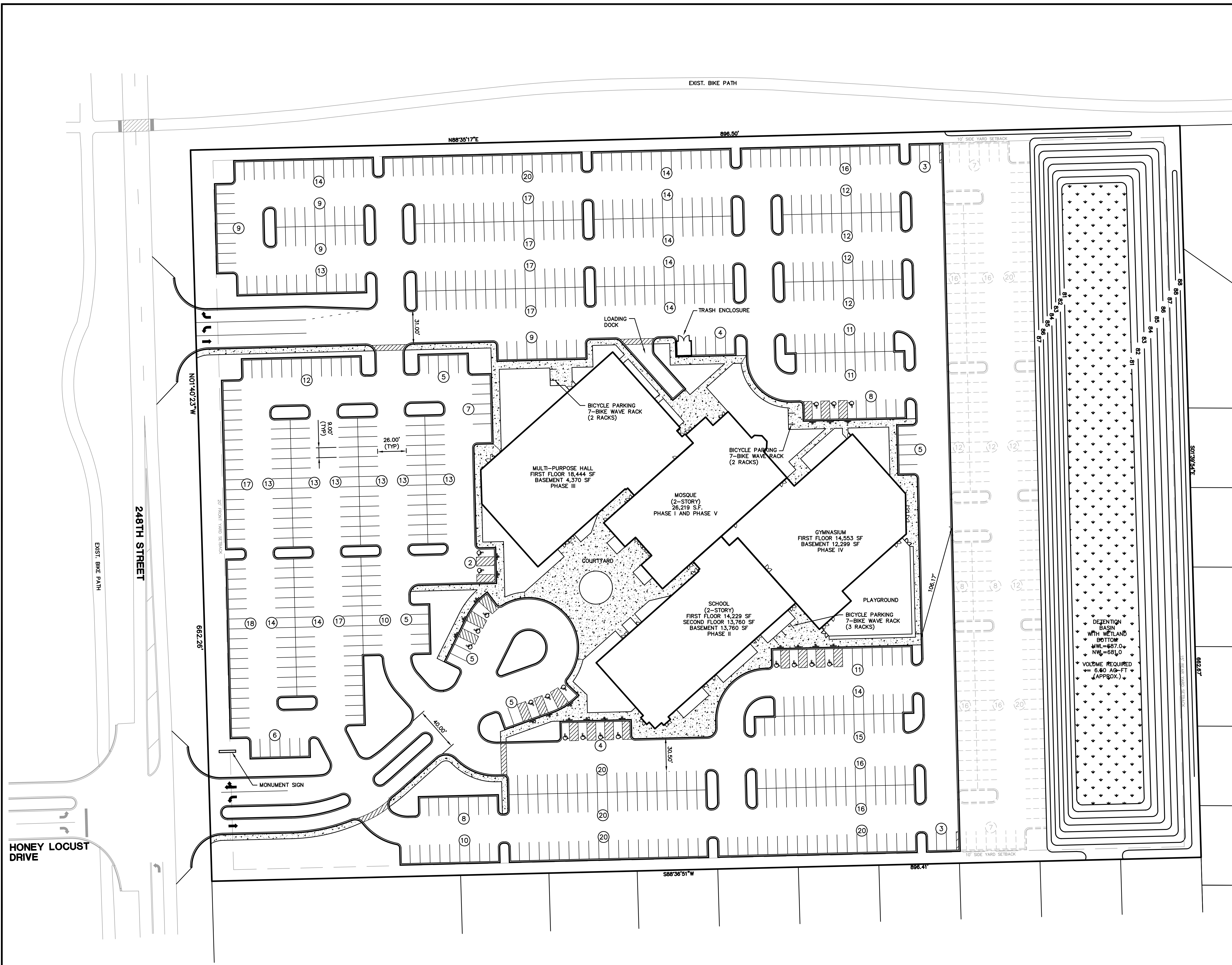

SCALE: 1" = 40'

SITE DATA TABLE

CURRENT ZONING:	R1
PROPOSED ZONING:	R1 WITH CONDITIONAL USE
LOT AREA:	593,857 S.F. (13.63 AC.)
PROPOSED BUILDING:	41,749 S.F.
SCHOOL (3-STORY):	26,219 S.F.
MOSQUE:	3,259 S.F.
MULTI-PURPOSE HALL:	22,814 S.F.
GYMNASIUM:	26,852 S.F.
PARKING REQUIRED:	711 SPACES *
PARKING PROVIDED:	719 PLANNED (INCL. 19 HANDICAP STALLS) 182 FUTURE PARKING IF NECESSARY
BICYCLE PARKING REQUIRED:	43 STALLS
BICYCLE PARKING PROVIDED:	49 STALLS
* SEE PARKING STUDY	

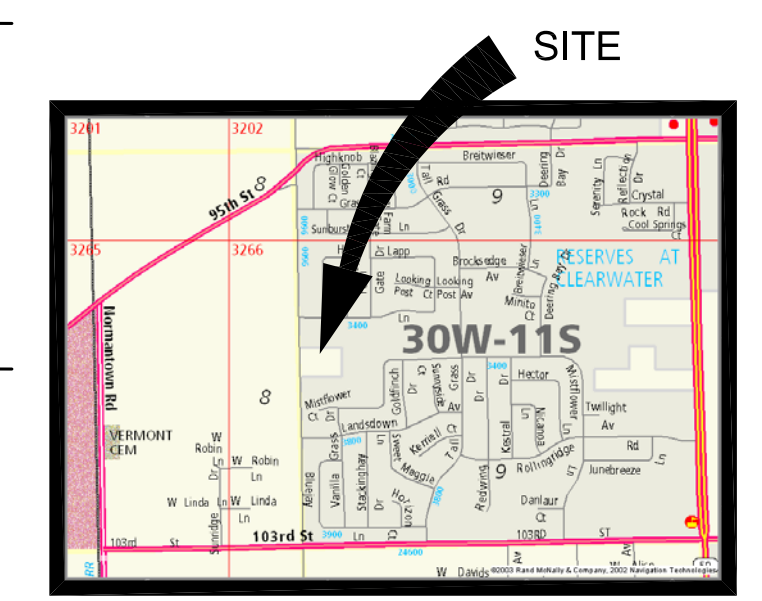

DEZENTION BASIN WITH WETLAND BOTTOM
 #WL=687.0
 #NW=681.0
 VOLUME REQUIRED = 5.60 AG-FT (APPROX.)

BC BY
4-27-20 1 PER CLIENT REVIEW REVISION DATE INC.
INTECH CONSULTANTS, INC. ENGINEERS - SURVEYORS <small>1989 UNIVERSITY LANE, SUITE D LISLE, ILLINOIS 60532 ILLINOIS REGISTRATION No. 194-001040 PHONE: 630-964-9856</small>
ISLAMIC CENTER OF NAPERVILLE
ISLAMIC CENTER OF NAPERVILLE 248TH AVENUE SITE NAPERVILLE, ILLINOIS
MASTER SITE PLAN
SCALE 1"=40' DATE 3-30-20 DRAWN BC DESIGNED EFS PROJECT NO. 2011-016B SHEET 1 OF 1

CITY OF NAPERVILLE PARKING REQUIREMENTS

Parking requirements as mandated by the City of Naperville's Municipal Code are dependent on upon the actual usage of proposed properties. Depending on the usage proposed, the required parking is arrived at by applying specified rates of parking required for each of the classifications of land and/or building usage that may be present in a particular project.

A detailed breakdown of the City's parking requirements as applied to the various uses contained in the enclosed Master Plan for the entire 248th Avenue campus that has been prepared by the project architect, Buchar, Bajt Architects, Inc. is included in this section of this report.

The City's requirements for the planned uses of the built-out campus generate a required total parking count of 711 cars, which is summarized as follows:

Phase I - Initial Mosque Construction	249 spaces required
Phase II – School	32 spaces required
Phase III – Multipurpose Hall	183 spaces required
Phase IV – Gymnasium	126 spaces required
Phase V – Mosque Expansion	<u>121 spaces required</u>
Total	711 spaces required

The Master Plan for the Islamic Center of Naperville's 248th Avenue campus totals 719 cars, and is therefore in compliance with the parking requirements of the City.

In addition to the 719 stalls that will be provided, the Master Plan also includes space for additional parking stalls to be constructed should the need arise in the future. The additional stalls, which amounts to another 182 spaces, will be "land banked" unless the need for additional parking would become necessary or desirable.

Counting the land-banked stalls, the total parking capacity of the campus is planned to contain 901 parking stalls, which is 26.7% more than the requirements of the City of Naperville.

ICN PARKING REQUIREMENTS

Date: 3/30/2020

Phase I Mosque

First Floor

Worship Space	1 space per 3 seats	300 seats	100 space
Office Space	3.3 space per 1000 sf	1,402 sf	5 spaces
			Total 105 Spaces

Second Floor

Worship Space	1 space per 3 seats	157 seats	53 spaces
Office Space	3.3 space per 1000 sf	1,458 sf	5 spaces
			Total 58 Spaces

Basement

Future Kitchen	4 employee	223 sf	4 spaces
Multipurpose	10 spaces per 1000 sf	8,197 sf	82 spaces
			Total 86 Spaces

Phase II School

First Floor

Office 3.3 spaces per 1000 sf 158 sf 1 space

Kitchen 2 employee 263 sf 2 space

Classroom

 Preschool

 2 spaces per 1000 sf 2,491 sf 5 spaces

 Elementary

 1 space per employee 1 space

Total 9 Spaces

Second Floor

Office 3.3 spaces per 1000 sf 550 sf 2 space

Classroom

 Elementary/Junior High

 1 space per employee 9 space

Total 11 Spaces

Basement

Classroom

 Elementary /Junior High

 1 space per employee 12 spaces

Total 12 Spaces

Phase III Multipurpose

First Floor

Multipurpose	10 spaces per 1000 sf	17,768 sf	178 spaces
---------------------	-----------------------	-----------	------------

Basement

Storage	1 space per 1000 sf	4,458 sf	5 spaces
----------------	---------------------	----------	----------

Total 183 Spaces

Phase IV Gymnasium

First Floor

Gymnasium	5 spaces per 1000 sf	13,700 sf	69 spaces
------------------	----------------------	-----------	-----------

Basement

Gymnasium	5 spaces per 1000 sf	11,189 sf	56 spaces
------------------	----------------------	-----------	-----------

Storage	1 spaces per 1000 sf	706 sf	1 spaces
----------------	----------------------	--------	----------

Total 126 Spaces

Phase V Mosque Expansion

First Floor

Worship Space	1 space per 3 seats	161 seats	54 spaces
----------------------	---------------------	-----------	-----------

Second Floor

Worship Space	1 space per 3 seats	198 seats	67 spaces
----------------------	---------------------	-----------	-----------

Total 121 Spaces

Handicap Spaces	2% of parking stalls	711 total	14 spaces
Bike Parking	5% of parking stalls (nic gym)	585 total	29 spaces
	10% of parking stalls (gym)	126 total	13 spaces
Loading Birth	1 loading birth 10,000 sf to 100,000 sf		
	Total 120,893 sf		2 loading birth

Area Calculation

Phase I Mosque	First Floor	9,343 sf
	Second Floor	6,158 sf
	Basement	<u>10,718 sf</u>
	Total Mosque	26,219 sf
Phase II School	First Floor	14,229 sf
	Second Floor	13,760 sf
	Basement	<u>13,760 sf</u>
	Total School	41,749 sf
Phase III Multipurpose	First Floor	18,444 sf
	Basement	<u>4,370 sf</u>
	Total Multipurpose	22,814 sf
Phase IV Gymnasium	First Floor	14,553 sf
	Basement	<u>12,299 sf</u>
	Total Gymnasium	26,852 sf
Phase V Mosque Expansion	First Floor	1,659 sf
	Second Floor	<u>1,600 sf</u>
	Total Expansion	3,259 sf

Total Phases I thru Phase V Area 120,893 sf

PARKING COUNTS AT OTHER ICN FACILITIES

The City of Naperville has requested that a series of parking counts be conducted at the other facilities of the Islamic Center of Naperville in the area.

The purpose of these counts is to determine the actual parking usage of these facilities so that the parking needs of the 248th Avenue campus can be projected based on actual usage elsewhere.

During the week of January 12-18, 2020, a series of counts were taken at ICN's three other locations:

- **Oleson Drive** – a converted single family residence with 19 parking spaces on site. Additional parking is accommodated on the streets in the adjacent residential areas.
- **75th Street** – a recently acquired site originally developed as a church with 140 parking spaces in the site's parking lot. Offsite parking is not available in the area.
- **Ogden Avenue** – a stand alone facility containing a mosque and gymnasium with 285 parking spaces in the site's parking lot. Offsite parking is also available in the commercial parking lot on the north side of Ogden Avenue.

The counts were taken at each site on Wednesday, Thursday, Friday, and Saturday of that week, at 8:00 AM, 10:00 AM, Noon, 1:00 PM, and 4:00 PM on each day. At the Ogden Avenue site, an additional count was taken at 2:00 PM on Friday to more accurately depict the actual usage of the site during the two worship services that occur at that location on Friday afternoons. Also, at each site counts were also taken not only on the individual sites, but also in the offsite areas mentioned above.

The counts that were obtained are displayed in the three tables contained in this section of the report.

For the majority of the time, the parking demand at each site was substantially less than the parking available on the site itself. However, on Friday afternoons during the most heavily attended worship time of the week, the parking demand was greater than the available site parking.

At the Oleson Drive site, once the onsite parking was filled the additional cars were double parked in the aisle in the lot, and on the streets in the adjacent residential areas. At the 75th Street site, the additional cars were double parked in the aisles in the lot. At the Ogden Avenue site, the additional cars were double parked in the aisle in the lot, and in the commercial parking lot on the north side of Ogden Avenue.

During the course of the counting of the cars at each of the sites, those individuals counting the cars made efforts to determine how many persons were in each vehicle. While it was not possible to conduct a comprehensive accounting of the occupants for each vehicle, it was clear that the majority of cars were occupied by a single person, especially during the peak Friday worship times. Of those cars where the number of occupants were observed, informal tallies averaged out to a vehicle occupancy rate of approximately 1.4 occupants per vehicle.

This occupancy rate differs markedly from the 3.0 rate assumed by the Naperville Municipal Code. Most such codes are based on experiences with other religions where the peak worship time is held on weekends when families have the opportunity to carpool to a great extent.

However, the peak worship time for the Islamic religion is held during the work week, and many of those attending services are coming from work, and will be returning to work after the services are over. As a result, a much greater number of individuals arrive by themselves, and the actual number of vehicles is greater than assumed by the Code.

In the next section of this report, the actual vehicle occupancy rate of 1.4 occupants per vehicle that was observed will be used to project the parking need during worship times for the proposed 248th Avenue campus.

Islamic Center of Naperville - Oleson Drive Site

Parking Counts - January 15, 16, 17, 18, 2020

Parking Facilities On Site = 19 spaces

Wednesday, January 15, 2020

<u>Time</u>	<u>On Site</u>	<u>Off Site</u>
8:00 AM	0	0
10:00 AM	2	0
Noon	3	0
1:00 PM	12	0
4:00 PM	0	0

Thursday, January 16, 2020

<u>Time</u>	<u>On Site</u>	<u>Off Site</u>
8:00 AM	0	0
10:00 AM	2	0
Noon	3	0
1:00 PM	10	0
4:00 PM	0	0

Friday, January 17, 2020

<u>Time</u>	<u>On Site</u>	<u>Off Site</u>
8:00 AM	0	0
10:00 AM	2	0
Noon	5	0
1:00 PM	22	117
4:00 PM	3	0

Saturday, January 18, 2020

<u>Time</u>	<u>On Site</u>	<u>Off Site</u>
8:00 AM	0	0
10:00 AM	0	0
Noon	0	0
1:00 PM	0	0
4:00 PM	0	0

Islamic Center of Naperville - 75th Street Site

Parking Counts - January 15, 16, 17, 18, 2020

Parking Facilities On Site = 140 spaces

Wednesday, January 15, 2020

<u>Time</u>	<u>On Site</u>	<u>Off Site</u>
8:00 AM	1	0
10:00 AM	4	0
Noon	3	0
1:00 PM	3	0
4:00 PM	2	0

Thursday, January 16, 2020

<u>Time</u>	<u>On Site</u>	<u>Off Site</u>
8:00 AM	1	0
10:00 AM	4	0
Noon	7	0
1:00 PM	4	0
4:00 PM	5	0

Friday, January 17, 2020

<u>Time</u>	<u>On Site</u>	<u>Off Site</u>
8:00 AM	3	0
10:00 AM	3	0
Noon	153	0
1:00 PM	21	0
4:00 PM	4	0

Saturday, January 18, 2020

<u>Time</u>	<u>On Site</u>	<u>Off Site</u>
8:00 AM	1	0
10:00 AM	2	0
Noon	1	0
1:00 PM	1	0
4:00 PM	2	0

Islamic Center of Naperville - Ogden Ave. Site

Parking Counts - January 15, 16, 17, 18, 2020

Parking Facilities On Site = 285 spaces

Wednesday, January 15, 2020

<u>Time</u>	<u>Cars in Lot</u>	<u>Offsite</u>
8:00 AM	12	0
10:00 AM	16	0
Noon	17	0
1:00 PM	56	0
4:00 PM	9	0

Thursday, January 16, 2020

<u>Time</u>	<u>Cars in Lot</u>	<u>Offsite</u>
8:00 AM	12	0
10:00 AM	17	0
Noon	34	0
1:00 PM	76	0
4:00 PM	10	0

Friday, January 17, 2020

<u>Time</u>	<u>Cars in Lot</u>	<u>Offsite</u>
8:00 AM	11	0
10:00 AM	36	0
Noon	333	15
1:00 PM	382	27
2:00 PM	65	0
4:00 PM	10	0

Saturday, January 18, 2020

<u>Time</u>	<u>Cars in Lot</u>	<u>Offsite</u>
8:00 AM	26	0
10:00 AM	5	0
Noon	5	0
1:00 PM	36	0
4:00 PM	6	0

PHASED PARKING PROJECTIONS FOR NEW 248TH AVENUE CAMPUS

It was seen in an earlier section of this report that when fully developed, the proposed parking for the Islamic Center of Naperville's new religious campus on 248th Avenue fully meets the parking requirements of the City of Naperville's Municipal Code.

It has also been determined through the parking counts obtained at the Islamic Center of Naperville's other three facilities in the area that each of these facilities has a high parking demand during the peak Friday worship times, primarily due to a low vehicle occupancy rate.

Since the campus will be constructed in five (5) separate phases over time, it is important to ensure that adequate parking is provided during all of the phases of development, and that the parking not only meets the Code requirements, but also the actual needs.

As noted earlier, the phasing of the campus is planned to occur as follows:

Phase I - Initial Mosque Construction

Phase II – School

Phase III – Multipurpose Hall

Phase IV – Gymnasium

Phase V – Mosque Expansion

The Islamic Center of Naperville and their design team has carefully considered numerous ways of phasing the project, and developed the attached Phasing Plan to guide the future development of the overall campus. Numerous factors were considered during the planning, with the foremost being to ensure that adequate parking would be available at all times.

Not only would each phase have to meet the code parking requirements, but the parking for the peak worship times would have to meet or exceed the necessary parking as established by the vehicle occupancy rate arrived as a result of the parking count survey conducted at the other ICN facilities in the area.

The parking to be provided in each Phase is summarized in the following chart. In each Phase, the parking to be provided not only meets the Naperville code requirements, it also meets the parking needs for the peak worship times using the vehicle occupancy rate.

For example, in Phase I the parking required by the Municipal Code totals 249 stalls. However, based on the planned 457 parishioners (300 men and 157 women) and a vehicle occupancy rate of 1.4, the needed parking for the peak worship periods on Friday afternoons amounts to 326 parking spaces. Phase I is providing 336 parking spaces, and therefore should be considered adequate.

It should be noted that only some, but not all, of the various uses at this campus will occur concurrently, which will be discussed in the next section of this report. As a result, in addition to the required parking for each of the different uses within the campus, when a use is active it will have the benefit of being able to also use the parking for the other uses that are not active at that time. As a result, the parking that will be provided at any time will be more than adequate to handle the parking demand.

Friday afternoon worship generates by far the greatest parking demand. However, since none of the other uses are allowed to be active during the Friday services, there will be far more parking than is necessary to meet the demand. Even after buildout when the mosque expansion has increased the worship space to a capacity of 816 persons (461 men, 355 women), the parking that is needed based on the vehicle occupancy rate will be 583 cars, which is significantly less than the 719 spaces that will be present on the campus.

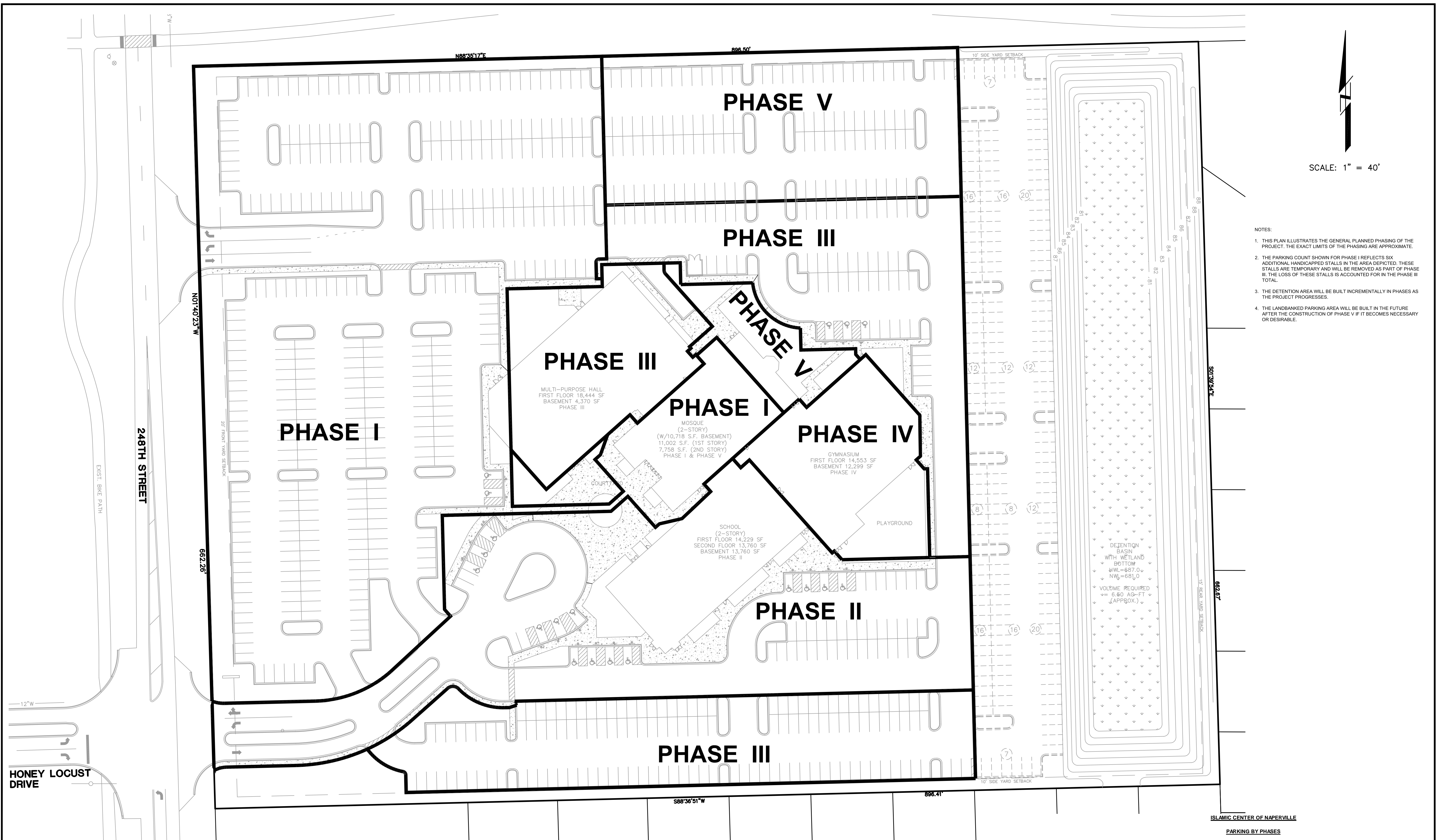

SCALE: 1" = 40'

- NOTES:
1. THIS PLAN ILLUSTRATES THE GENERAL PLANNED PHASING OF THE PROJECT. THE EXACT LIMITS OF THE PHASING ARE APPROXIMATE.
 2. THE PARKING COUNT SHOWN FOR PHASE I REFLECTS SIX ADDITIONAL HANDICAPPED STALLS IN THE AREA DEPICTED. THESE STALLS ARE TEMPORARY AND WILL BE REMOVED AS PART OF PHASE III. THE LOSS OF THESE STALLS IS ACCOUNTED FOR IN THE PHASE III TOTAL.
 3. THE DETENTION AREA WILL BE BUILT INCREMENTALLY IN PHASES AS THE PROJECT PROGRESSES.
 4. THE LANDBANKED PARKING AREA WILL BE BUILT IN THE FUTURE AFTER THE CONSTRUCTION OF PHASE V IF IT BECOMES NECESSARY OR DESIRABLE.

	PHASE I			PHASE II		PHASE III		PHASE IV		PHASE V	
	REQUIRED BY CODE*	NEEDED BY USE**	PARKING PROVIDED	REQUIRED BY CODE*	PARKING PROVIDED	REQUIRED BY CODE	PARKING PROVIDED	REQUIRED BY CODE	PARKING PROVIDED	REQUIRED BY CODE	PARKING PROVIDED
BASE MOSQUE	249	336	348	249	348	249	348	249	348	249	348
SCHOOL				32	54	32	54	32	54	32	54
GYMNASIUM						126	194	126	194	126	194
MULTI-PURPOSE HALL								183	0	183	0
MOSQUE EXPANSION										121	123
CUMULATIVE TOTALS	249	336	348	281	402	407	596	590	596	711	719
								LANDBANKED PARKING		182	
								TOTAL PARKING AVAILABLE		901	

* Required parking for the worship space in the mosque per the Municipal Code is one stall per three worshippers. Includes the basement area per code.
 ** Actual parking needs for the worship space in the mosque during Friday services established by vehicle counts at other ICN facilities is one stall per 1.4 worshippers. Does not include the basement area since the basement area will not be used during Friday services.

BC BY

1 PER CLIENT REVIEW REVISION

4-27-20 DATE NO.

1989 UNIVERSITY LANE, SUITE D ENGINEERS - SURVEYORS ILLINOIS REGISTRATION NO. 194-001040

1889 UNIVERSITY LANE, SUITE D LISLE, ILLINOIS 60532 PHONE: 630-964-9556

INTECH CONSULTANTS, INC.

ISLAMIC CENTER OF NAPERVILLE

ISLAMIC CENTER OF NAPERVILLE
248TH AVENUE SITE
NAPERVILLE, ILLINOIS

PHASING PLAN

SCALE 1"=40'

DATE 3-30-20

DRAWN BC

DESIGNED EFS

PROJECT NO. 2011-016B

SHEET 1 OF 1

Projected Actual Campus Parking Usage

Earlier in this report, it was seen that the total parking that is to be provided for each of the land uses within the campus at ultimate buildout as well as during each of the planned five (5) Phases of construction will meet the parking requirements of the City of Naperville.

In addition, the parking to be provided will meet the actual parking needs during peak Friday worship times using the vehicle occupancy rate that was determined as part of the parking counts that were taken at the other ICN facilities in the area.

However, these analyses only address the requirements and needs at peak times. They do not provide any insight as to when the various uses within the campus will actually be used, and what the likely parking loads will be under those circumstances.

To illustrate this, ICN and their design team mapped out the planned times and expected utilization of each of the buildings not only during normal weekly operations, but also during the month of Ramadan, when the timing of usages differs from the other 11 months of the year.

Because the expected use of the facilities varies throughout the week and is also different during Ramadan, it was found that there are eight different usage patterns that will occur. These are as follows:

- Monday – Thursday, Non Ramadan Weeks
- Monday – Thursday, Ramadan Weeks
- Friday, Non Ramadan Weeks
- Friday, Ramadan Weeks
- Saturday, Non Ramadan Weeks
- Saturday, Ramadan Weeks
- Sunday, Non Ramadan Weeks
- Sunday, Ramadan Weeks

The projected campus usage of the parking facilities is presented in the tables that follow. Several things can be seen clearly when examining these tables:

1. While several uses are planned to potentially occur concurrently, the attendance levels are such that the parking facilities are vacant much of the time.
2. Because the other uses are not allowed to operate during the peak worship times on Friday afternoons, there will be more than adequate parking at all times for the peak worship traffic.
3. Even if it was decided to expand the operations of the school, multipurpose hall, or the gymnasium, there would still be more than adequate parking available at all times for those expanded operations.

Islamic Center of Naperville
 Site Use and Parking Projections

Monday - Thursday, Non-Ramadan Weeks

12AM 1AM 2AM 3AM 4AM 5AM 6AM 7AM 8AM 9AM 10AM 11AM 12PM 1PM 2PM 3PM 4PM 5PM 6PM 7PM 8PM 9PM 10PM 11PM 12AM

School



Mosque



Multi-Purpose Hall

NO MONDAY-THURSDAY USE ANTICIPATED

Gymnasium



Anticipated Parking
 Non-Ramadan Weeks

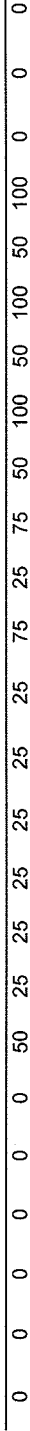

Usage times and anticipated number of vehicles provided by ICN.

Islamic Center of Naperville
Site Use and Parking Projections

Monday - Thursday, Ramadan Weeks

12AM 1AM 2AM 3AM 4AM 5AM 6AM 7AM 8AM 9AM 10AM 11AM 12PM 1PM 2PM 3PM 4PM 5PM 6PM 7PM 8PM 9PM 10PM 11PM 12AM

School

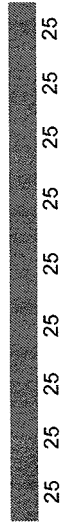

Mosque



Multi- Purpose Hall

NO MONDAY-THURSDAY USE ANTICIPATED

Gymnasium

NO USE DURING RAMADAN ANTICIPATED

Anticipated Parking
Ramadan Weeks



Usage times and anticipated number of vehicles provided by ICN.

**Islamic Center of Naperville
Site Use and Parking Projections**

Friday, Non-Ramadan Weeks

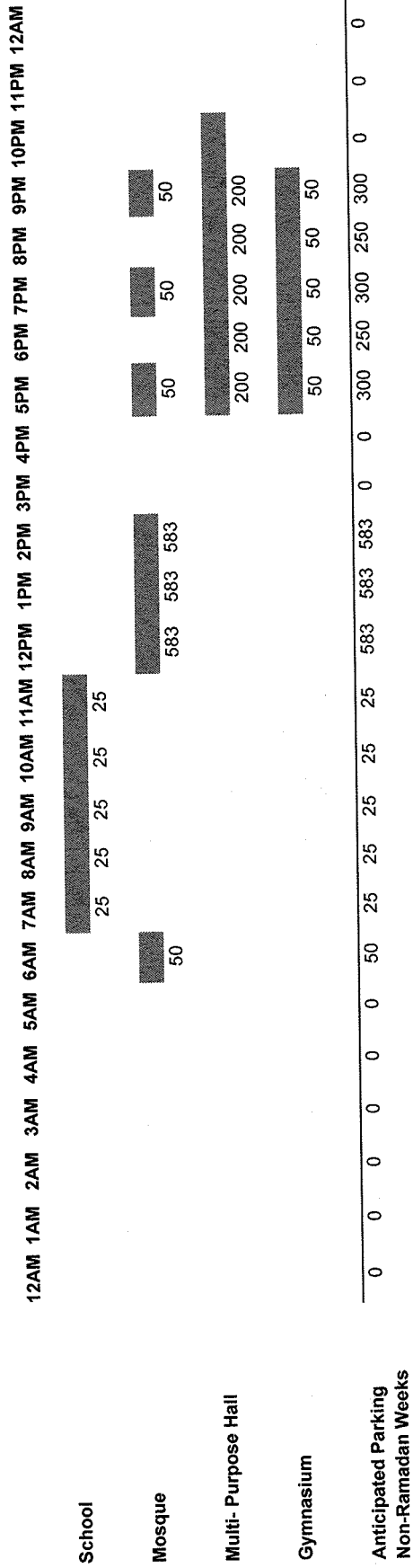

Usage times and anticipated number of vehicles provided by ICN.

Islamic Center of Naperville
 Site Use and Parking Projections

Friday, Ramadan Weeks

12AM 1AM 2AM 3AM 4AM 5AM 6AM 7AM 8AM 9AM 10AM 11AM 12PM 1PM 2PM 3PM 4PM 5PM 6PM 7PM 8PM 9PM 10PM 11PM 12AM

School

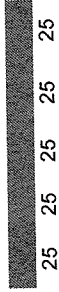

Mosque



Multi-Purpose Hall

NO USE ANTICIPATED DURING RAMADAN WEEKS

Gymnasium

NO USE ANTICIPATED DURING RAMADAN WEEKS

Anticipated Parking
 Ramadan Weeks

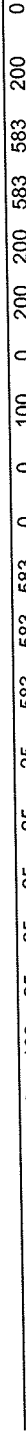

Usage times and anticipated number of vehicles provided by ICN.

Islamic Center of Naperville
 Site Use and Parking Projections

Saturday, Non-Ramadan Weeks

12AM 1AM 2AM 3AM 4AM 5AM 6AM 7AM 8AM 9AM 10AM 11AM 12PM 1PM 2PM 3PM 4PM 5PM 6PM 7PM 8PM 9PM 10PM 11PM 12AM

School

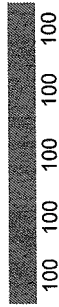

Mosque



Multi-Purpose Hall



Gymnasium



Anticipated Parking
 Non-Ramadan Weeks

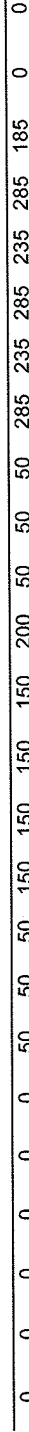

Usage times and anticipated number of vehicles provided by ICN.

**Islamic Center of Naperville
Site Use and Parking Projections**

Saturday, Ramadan Weeks

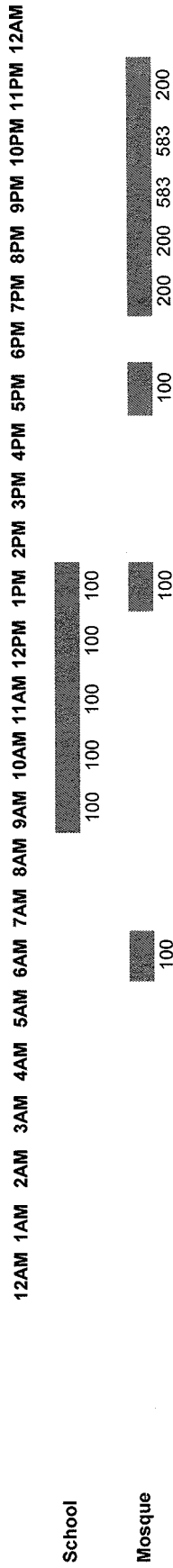

Multi- Purpose Hall
NO USE ANTICIPATED DURING RAMADAN WEEKS

Gymnasium
NO USE ANTICIPATED DURING RAMADAN WEEKS

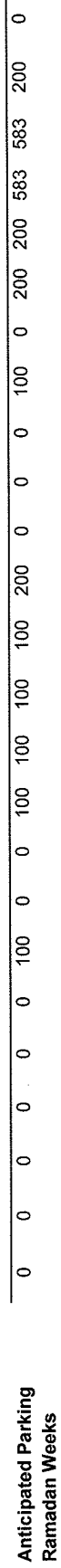

Usage times and anticipated number of vehicles provided by ICN.

**Islamic Center of Naperville
Site Use and Parking Projections**

Sunday, Non-Ramadan Weeks

12AM 1AM 2AM 3AM 4AM 5AM 6AM 7AM 8AM 9AM 10AM 11AM 12PM 1PM 2PM 3PM 4PM 5PM 6PM 7PM 8PM 9PM 10PM 11PM 12AM

NO ANTICIPATED USE ON SUNDAY

School

Mosque



Multi- Purpose Hall



Gymnasium

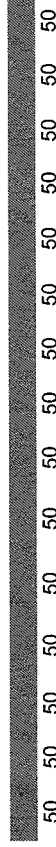

**Anticipated Parking
Non-Ramadan Weeks**



Usage times and anticipated number of vehicles provided by ICN.

**Islamic Center of Naperville
Site Use and Parking Projections**

Sunday, Ramadan Weeks

12AM 1AM 2AM 3AM 4AM 5AM 6AM 7AM 8AM 9AM 10AM 11AM 12PM 1PM 2PM 3PM 4PM 5PM 6PM 7PM 8PM 9PM 10PM 11PM 12AM

School

NO ANTICIPATED USE ON SUNDAY

Mosque

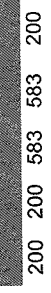

Multi- Purpose Hall

NO USE ANTICIPATED DURING RAMADAN WEEKS

Gymnasium

NO USE ANTICIPATED DURING RAMADAN WEEKS

**Anticipated Parking
Ramadan Weeks**

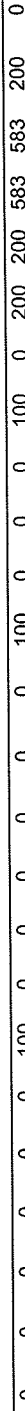

Usage times and anticipated number of vehicles provided by ICN.

CONCLUSIONS

The Islamic Center desires to develop this site in accordance with their Master Plan to accommodate school, mosque, multi-purpose hall, and gymnasium uses. The site will be built in five (5) phases over the next 40 years, one phase for each of the uses plus a future expansion of the mosque.

Each of these uses is substantial, and will need to accommodate the necessary parking for those that will participate in the many activities that are planned.

In this report, it has been shown that:

- The parking being provided for the campus meets or exceeds the requirements of the City of Naperville's Municipal Code, not only at the time of ultimate buildout, but at all stages of the phased construction that is planned.
- The parking that is to be provided during peak worship times on Fridays is in excess of what is to be expected using the lower vehicle occupancy rates identified as part of the parking counts taken at the other three ICN facilities in the area.
- While concurrent usage of some of the facilities is planned to occur, the anticipated parking needs are far less than the parking that will be available.
- If it was decided in the future to expand the operations of the school, multipurpose hall, or the gymnasium, there would still be more than adequate parking available at all times for those expanded operations, since they cannot occur during the peak worship periods on Friday afternoons.
- In the event that the actual usage of the facilities is greater than anticipated, the plan includes additional land banked parking that could increase the parking capacity of the site by another 182 stalls, which would amount to a very substantial increase of over 27%.

Given the above, it is apparent that the parking that will be provided for the Islamic Center of Naperville's new religious campus on 248th Avenue will be more than adequate to accommodate all of the uses and the activities that are planned.