

SITE LIGHTING PREPARED BY: CITY LIGHTING PRODUCTS COMPANY, ST. LOUIS, MO

City Lighting Products certifies that the exterior lighting depicted on this plan complies with the requirements of Section 6-14-1 of the Naperville Code of Ordinances.

Label	CalcType	Units	Avg	Max	Min	Avg/Min	Max/Min
Street - 95th Street	Illuminance	FC	1.82	2.4	0.1	18.20	24.00
Parking Drive Stat Area	Illuminance	FC	1.85	2.4	0.1	18.50	24.00

Parking Drive Stat Area
 Illuminance (FC)
 Average = 1.64
 Maximum = 2.4
 Minimum = 0.8
 Avg/Min Ratio = 2.05
 Max/Min Ratio = 3.00

Anna Marie Lane

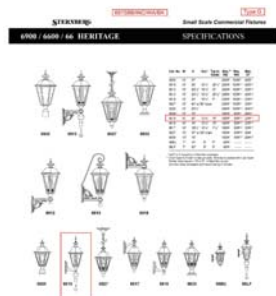
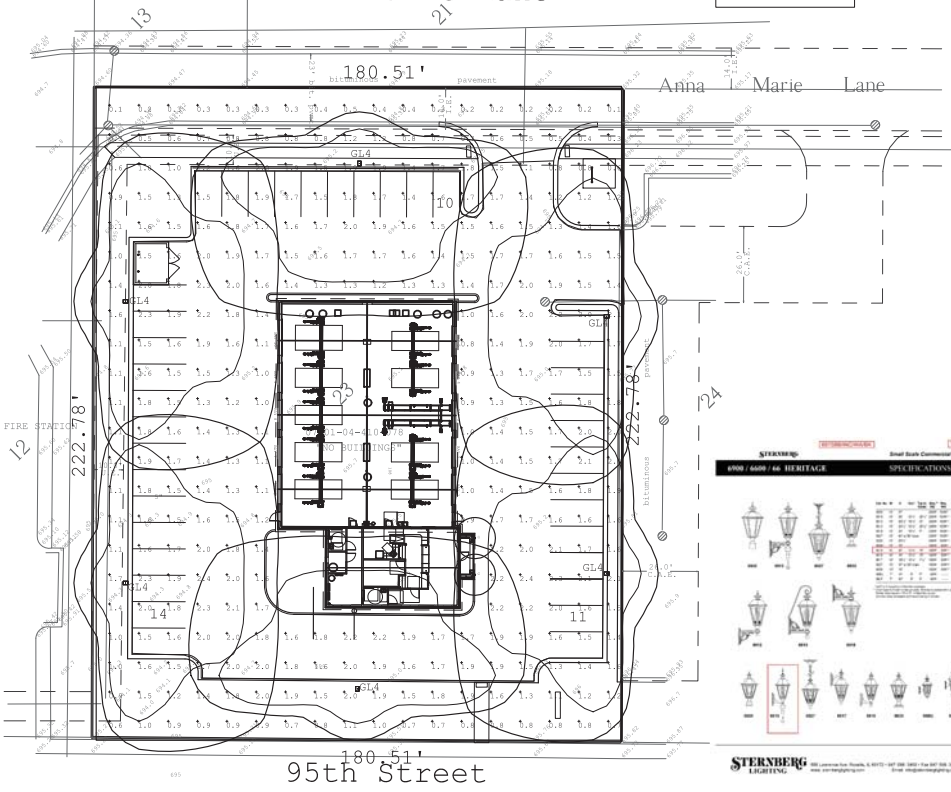

STERNBERG LIGHTING

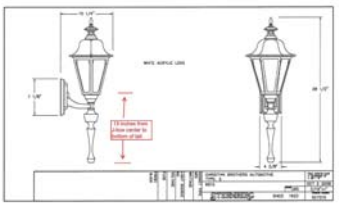

TYPE G

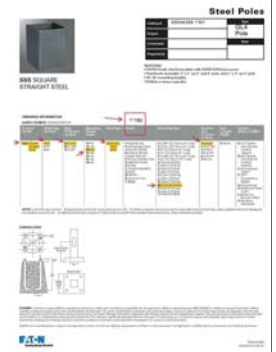

TYPE GL4 POLE

Item	Description	Quantity	Unit	Notes
1	GL4 Pole	1	EA	
2	Street Light Fixture	1	EA	



Item	Description	Quantity	Unit	Notes
3	Street Light Fixture	1	EA	

Item	Description	Quantity	Unit	Notes
4	Street Light Fixture	1	EA	

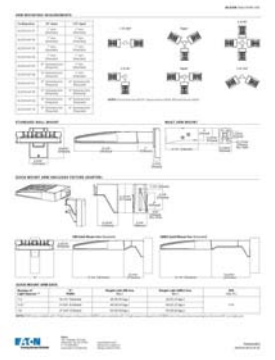

Item	Description	Quantity	Unit	Notes
5	Street Light Fixture	1	EA	

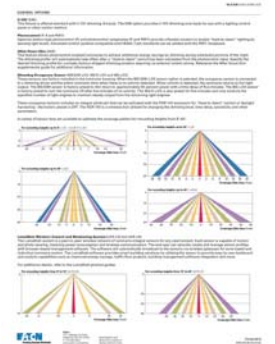

TYPE GL4 FIXTURE

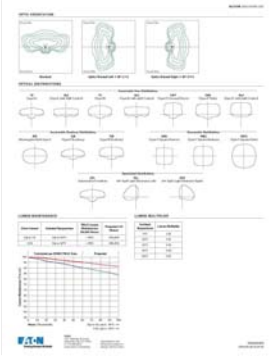

Item	Description	Quantity	Unit	Notes
6	Street Light Fixture	1	EA	



PREPARED FOR: CHRISTIAN BROTHERS AUTOMOTIVE CORP.
 17700 W. WOODWAY
 HOUSTON, TEXAS 77055
 PH: (281) 675-6105

Bollinger Lach & Associates, Inc.
 CONSULTING ENGINEERS
 330 PRINCE ROAD SUITE 200 PLAZA 1, 60103
 HOUSTON, TEXAS 77055
 PH: (281) 438-4600 FAX: (281) 438-4444 www.bollingerlach.com

SITE LIGHTING PLAN
 CHRISTIAN BROTHERS AUTOMOTIVE CORP.
 CITY OF NAPERVILLE

SHEET NUMBER
C8
 OF 13

Design Firm License No. 184-001129