

GROSS SQUARE FOOTAGE: 942 SF
 NET SQUARE FOOTAGE: 871 SF
 RETAIL: 350 SF - 40%
 PIERCING: 182 SF - 21%
 BACK OF HOUSE/OFFICE: 339 SF - 39%

LEGEND

	NEW FULL HEIGHT WALL
	EXISTING WALL
	EXISTING WALL WITH NEW FURRING WALL
EX	EXISTING TO REMAIN

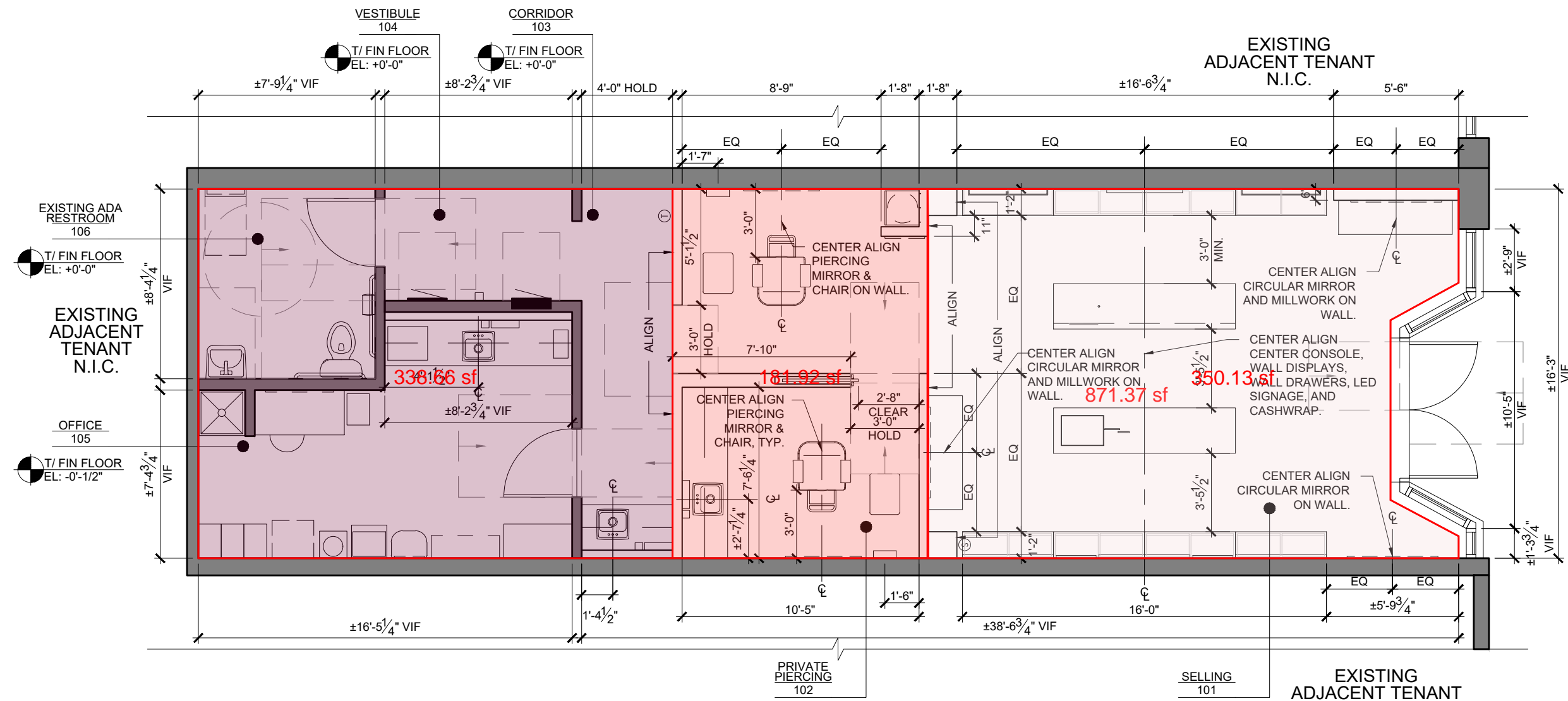

01 PARTIAL GROUND FLOOR DIMENSION PLAN
 3/16" = 1'-0"

PLOT DATE: 11/27/2024 9:49 AM PLOTTED BY: MADISON WEICK

	CLIENT 50 SOUTH MAIN STREET, SUITE #136, NAPERVILLE, IL 60540	 <small>412 S. Wells Street • 2nd Floor • Chicago • IL • 60607 P: 312 955 0334 • dxuarch.com</small>	DATE 11-27-2024
	STUDIO DESIGN PACKAGE		SHEET NO. A1-21

© DXU 2020