



## **SIGN PACKAGE PROPOSAL**

**RE-IMAGE**

**PRESENTED TO:**  
Culver's - Naperville, IL

**DATE PREPARED:**  
March 9, 2021  
April 27, 2021 - Rev1 - Dumpster Elevation Update

# DUMPSTER ELEVATION WALL SIGN

NAPERVILLE, IL

SL-30 Illuminated White Script Channel Letters

## SL-SERIES

Channel letter construction

One piece (saddle capped sections)

LED internal illumination

Typical application for new construction

Embedded power supplies

UL marked product

No install pattern needed, level line scribed in back of sign

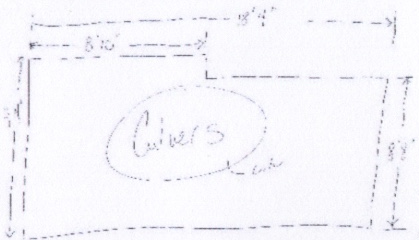

SCALE: 1/4" = 1'

\*SCALE AND COLORS NOT REPRESENTATIVE FROM EMAIL ATTACHMENTS  
\*ALL MEASUREMENTS ARE APPROXIMATE

### SIGN SQUARE FOOTAGE

DUMPSTER ENCLOSURE ELEVATION:  
QTY: 1 SL-30 (44.37" X 94.50") = 29.12 SF

SITE SURVEY RECEIVED ON 4/27/21

### NOTES

SL-30 ADDED TO DUMPSTER ENCLOSURE PER FRANCHISEE  
UTILIZE SAME SIZE OF 4XB SCRIPT CHANNEL FOR THIS  
ELEVATION

### DATE CREATED / REVISION HISTORY

3/9/21-NEW  
4/27/21-REV1-SALES REV-DUMPSTER ART UPDATE

SALES PERSON:  
MARK WESSELL

DESIGNED BY:  
B BLAUVELT

AO:  
30212

FILE PATH: T:\Cyrious\Doc\Order\30212\Art\Working Files

© 2021 Springfield Sign & Graphics Inc., Springfield Sign

This drawing is Copyrighted material, it remains the property of Springfield Sign & Graphics Inc. unless otherwise agreed upon in writing. It is unlawful to use this drawing for bidding purposes, nor can it be reproduced, copied or used in the production of a sign without written permission from Springfield Sign.

This is an artistic rendition and final colors / sizes may vary from that depicted herein.



www.springfieldsign.com