

Layout Tab Name: EX-1, Images: Aerid.jpg, CREE OSQ MEDIUM.PNG, Xrefs: 80835-p.dwg; 80835TLK.dwg; 80835-x.dwg; 80835LTG.dwg; Bell Tire - Naperville.dwg  
 Last Saved By: Cederquist, 7/15/2020 10:48:12 AM  
 \oad5d6c1\srvin\DE\clients\Enright\_Architects\80835 - Belle Tire - Naperville\4.0 Disciplines\Civil\Cadd\Cad\80835ATURN.dwg Plotted By: Cederquist, Brooke Plotted July 15, 2020, 12:11:51 PM

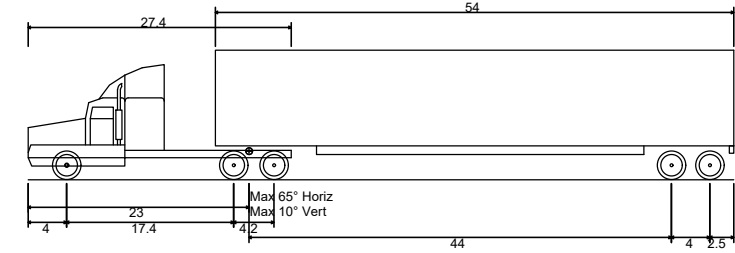

Interstate Semitrailer - WB-65 or WB-67  
 Overall Length 73.500ft  
 Overall Width 8.500ft  
 Overall Body Height 13.500ft  
 Min Body Ground Clearance 1.422ft  
 Track Width 8.500ft  
 Lock-to-lock time 6.00s  
 Curb to Curb Turning Radius 44.800ft

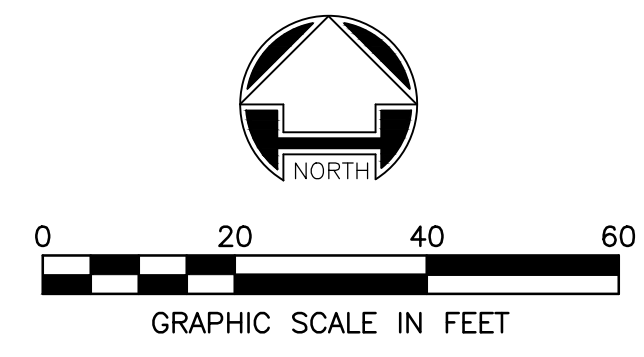
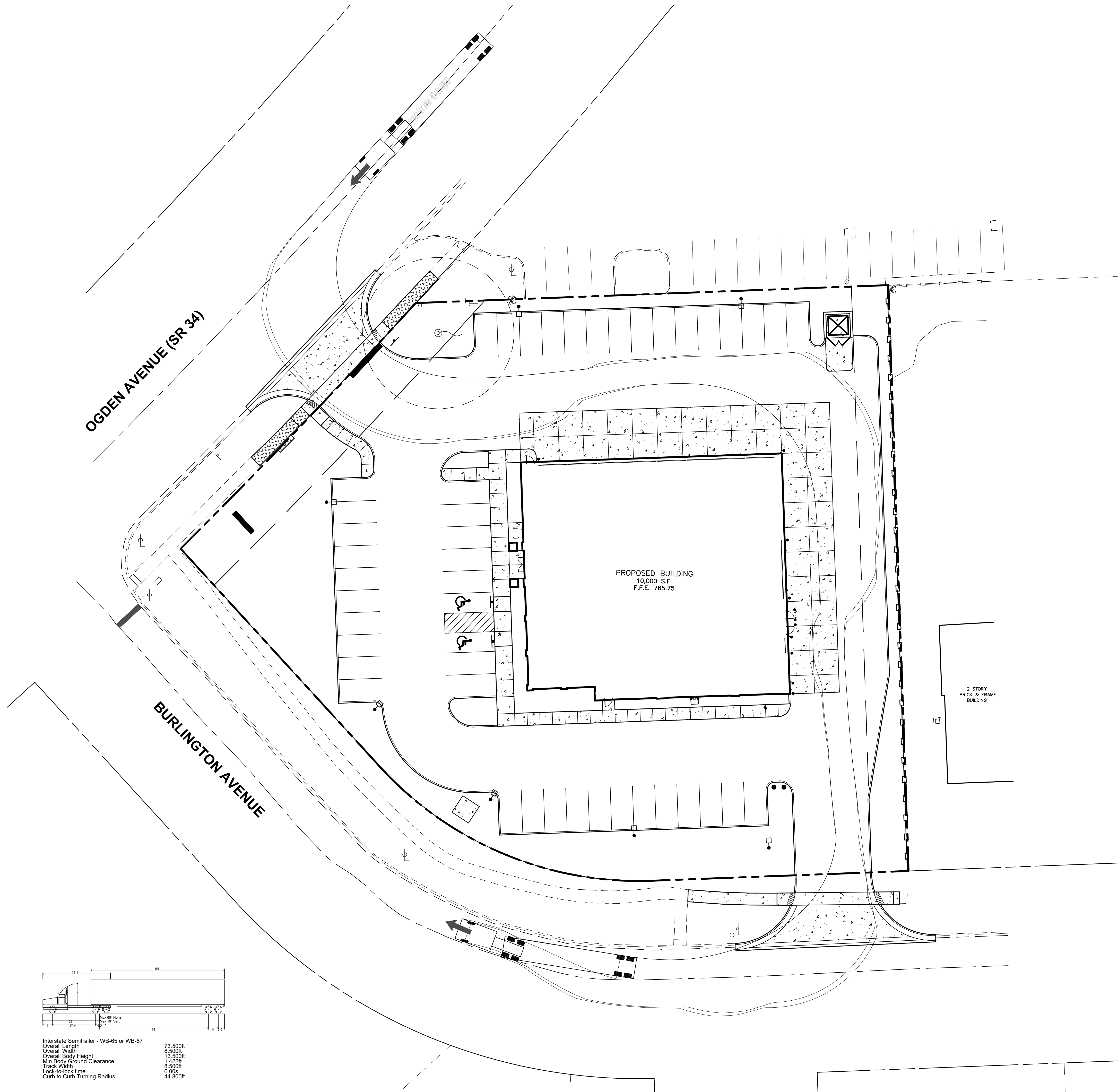

PENDING APPROVAL  
 NOT FOR CONSTRUCTION

PROJECT No:	REVISION
80835	
DATE 07/16/20	
DES. PJD	
DR. PJD	
CKD. ARS	
No.	DATE

1815 South Meyers Road  
 Suite 950  
 Oakbrook Terrace, IL 60181  
 630.424.9080  
 FAX: 630.485.3731

**WOOLPERT**  
 ARCHITECTURAL ENGINEERING (CORPORATE)

**BELLE TIRE NAPERVILLE**

1126 EAST OGDEN AVENUE  
 NAPERVILLE, ILLINOIS 60563

**AUTOTURN EXHIBIT**

SHEET NO.  
**EX-1**

Layout Tab Name: EX-1A, Images: Aerol.jpg: CREE OSO MEDIUM.PNG: , Xrefs: 80835-p.dwg: 80835TLK.dwg: 80835-x.dwg: 80835LTG.dwg; Bell Tire - Naperville.dwg  
 Last Saved By: Cederquist, 7/15/2020 10:48:12 AM  
 \s\ad56d1\srvin\clients\enright\_architects\80835 - Belle Tire - Naperville\4.0 Disciplines\Civil\Cadd\Cad\80835ATURN.dwg Plotted By: Cederquist, Brooke Plotted July 15, 2020, 12:12:32 PM

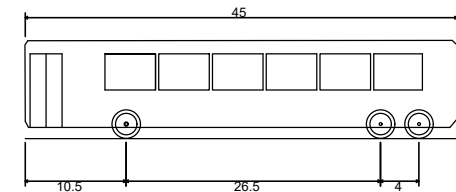

45ft Bus Design Vehicle  
 Overall Length 45.00ft  
 Overall Width 8.50ft  
 Overall Body Height 10.22ft  
 Min Body Ground Clearance 1.56ft  
 Track Width 8.50ft  
 Look-to-look time 6.00s  
 Max Steering Angle (Virtual) 44.30°

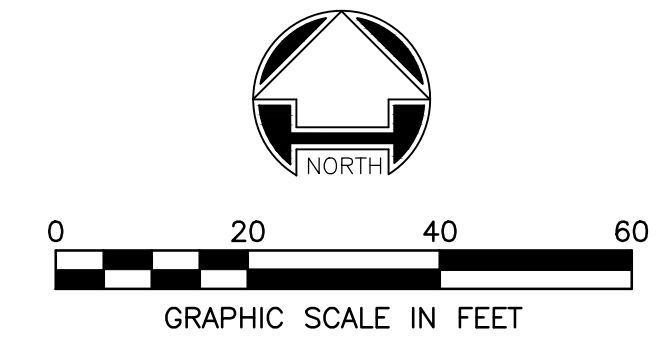
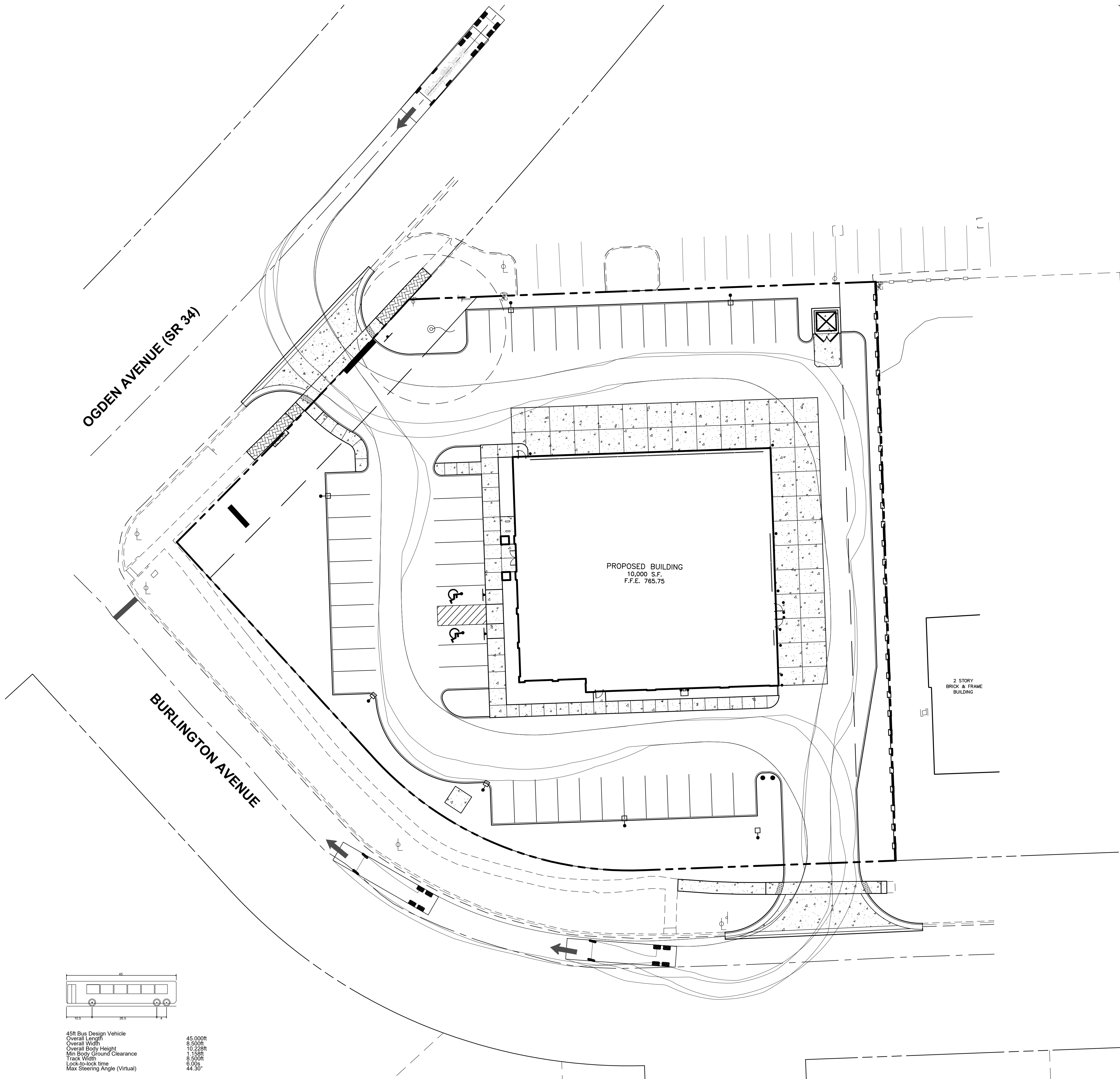

PENDING  
 APPROVAL  
 NOT FOR  
 CONSTRUCTION

No.	DATE	REVISION

PROJECT No: 80835  
 DATE 07/16/20  
 DES. PJD  
 DR. PJD  
 CKD. ARS

1815 South Meyers Road  
 Suite 950  
 Oakbrook Terrace, IL 60181  
 630.424.9080  
 FAX: 630.485.3731

**WOOLPERT**  
 ARCHITECTURAL ENGINEERING (CORPORATE)

**BELLE TIRE NAPERVILLE**

1126 EAST OGDEN AVENUE  
 NAPERVILLE, ILLINOIS 60563

**AUTOTURN EXHIBIT**

SHEET NO.  
**EX-1A**