

Luminaire Schedule				
Symbol	Qty	LLF	Description	Type
	15	0.750	ATBS P10 XXXXX R2 3K	S1
	216	0.750	500 LUMEN DOWNLIGHT CYLINDER - 2700K - MEDIUM BEAM	W1
	11	0.750	WDGE2 LED P4 40K 70CRI T3M	W2
	7	0.750	WDGE2 LED P4 40K 70CRI TFTM	W3
	1	0.750	WDGE2 LED P3 40K 70CRI TFTM	W4
	7	0.750	WDGE2 LED P1 40K 70CRI T1S	W5

Calculation Summary							
Label	CalcType	Units	Avg	Max	Min	Avg/Min	Max/Min
Whole Site_Planar_1	Illuminance	Fc	0.28	7.1	0.0	N.A.	N.A.

\*\*This document contains confidential and proprietary information of KSA Lighting & Controls. This document may only be used by or for the benefit of KSA Lighting & Controls representatives and customers. This lighting layout is not a professional engineering drawing and is provided for informational purposes only, without warranty as to accuracy, completeness, reliability or otherwise. KSA Lighting & Controls is not responsible for specifying the light fixtures or illumination requirements for any specific project, nor is it responsible for meeting municipal or building code requirements. It is the obligation of the end-user to consult with a professional engineering advisor to determine whether this lighting layout meets the applicable project requirements for lighting system performance, safety, suitability and effectiveness for use in a particular application. Field verification is recommended when calculations are based on end-user or customer-provided information. End-user environment and application (including, but not limited to, voltage variation and dirt accumulation) can cause actual field performance to differ from the calculated photometric performance represented in this lighting layout. In no event will KSA Lighting & Controls be responsible for any loss resulting from any use of this drawing.

- Notes :
- 1. Calculation Work Plane : 10' x 10'
  - 2. Fixture Mounting Height : Noted Above
  - 3. Calculation Point Spacing : 10' x10'



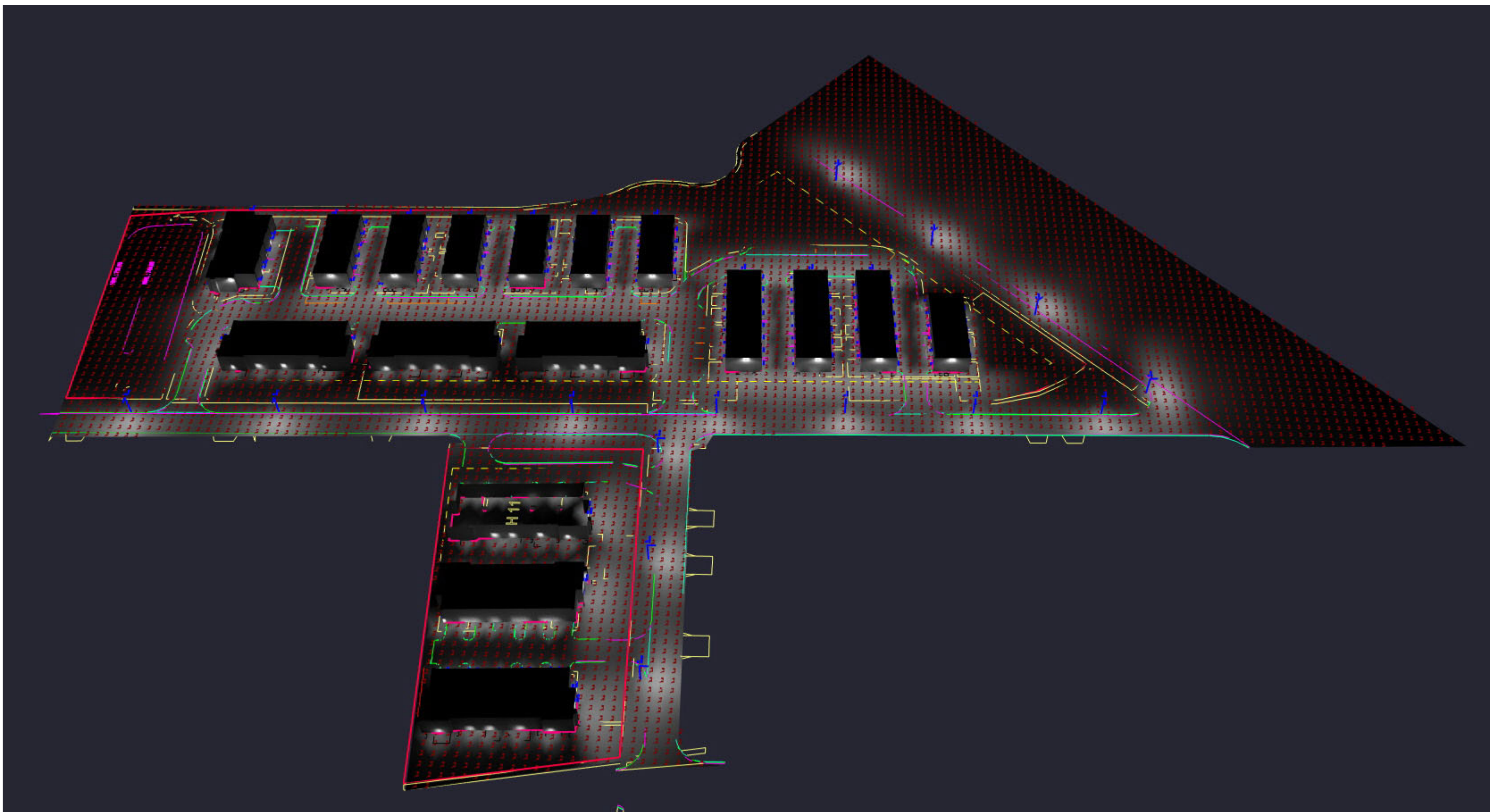
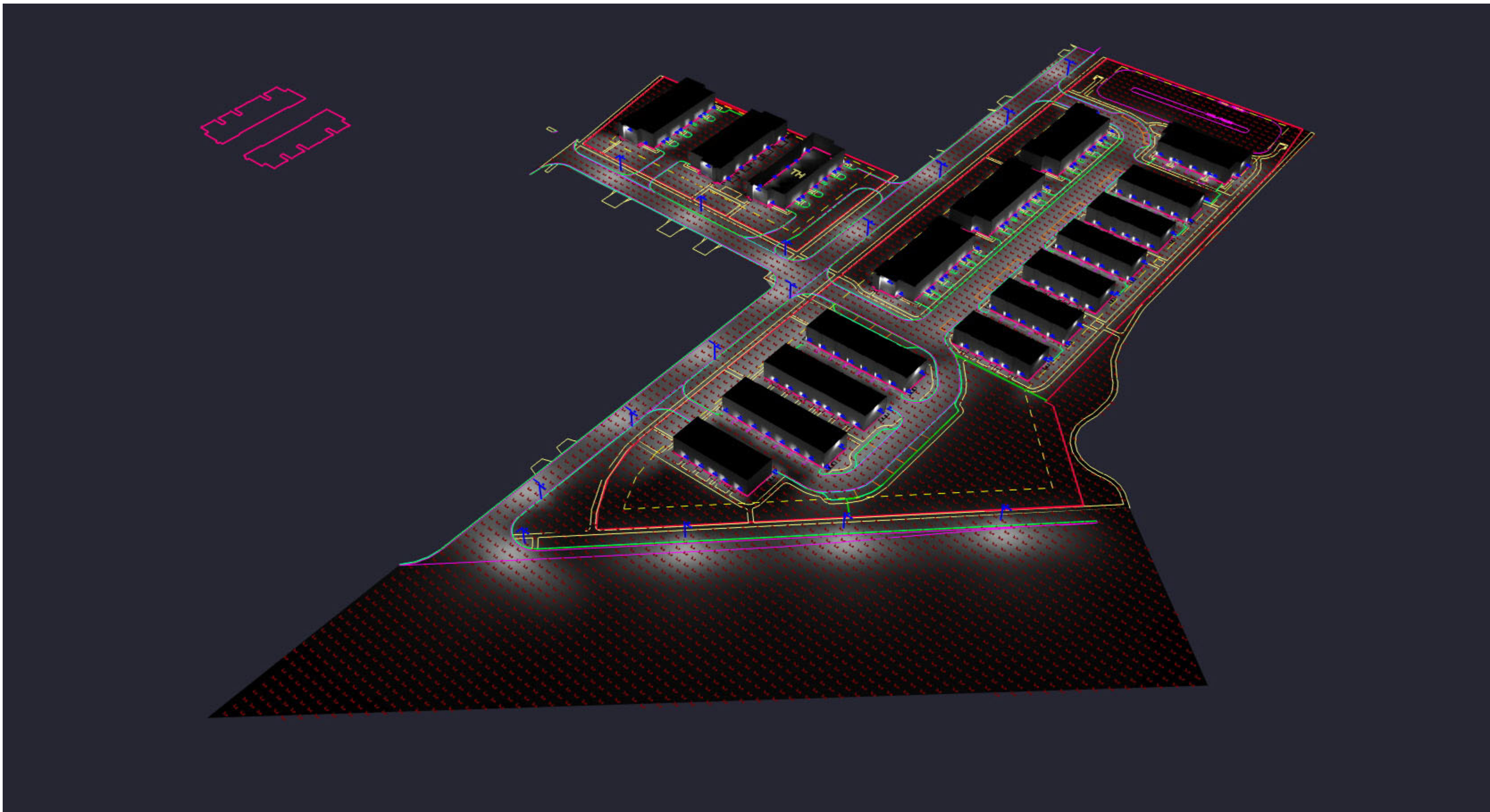

Luminaire Schedule				
Symbol	Qty	LLF	Description	Type
	15	0.750	ATBS P10 XXXXX R2 3K	S1
	216	0.750	500 LUMEN DOWNLIGHT CYLINDER - 2700K - MEDIUM BEAM	W1
	11	0.750	WDGE2 LED P4 40K 70CRI T3M	W2
	7	0.750	WDGE2 LED P4 40K 70CRI TFTM	W3
	1	0.750	WDGE2 LED P3 40K 70CRI TFTM	W4
	7	0.750	WDGE2 LED P1 40K 70CRI T1S	W5

**\*\*This document contains confidential and proprietary information of KSA Lighting & Controls. This document may only be used by or for the benefit of KSA Lighting & Controls representatives and customers. This lighting layout is not a professional engineering drawing and is provided for informational purposes only, without warranty as to accuracy, completeness, reliability or otherwise. KSA Lighting & Controls is not responsible for specifying the light fixtures or illumination requirements for any specific project, nor is it responsible for meeting municipal or building code requirements. It is the obligation of the end-user to consult with a professional engineering advisor to determine whether this lighting layout meets the applicable project requirements for lighting system performance, safety, suitability and effectiveness for use in a particular application. Field verification is recommended when calculations are based on end-user or customer-provided information. End-user environment and application (including, but not limited to, voltage variation and dirt accumulation) can cause actual field performance to differ from the calculated photometric performance represented in this lighting layout. In no event will KSA Lighting & Controls be responsible for any loss resulting from any use of this drawing.**

Calculation Summary							
Label	CalcType	Units	Avg	Max	Min	Avg/Min	Max/Min
Whole Site_Planar_1	Illuminance	Fc	0.28	7.1	0.0	N.A.	N.A.

- Notes :
1. Calculation Work Plane : 10' x 10'
  2. Fixture Mounting Height : Noted Above
  3. Calculation Point Spacing : 10' x10'

Drawn By: Scott Shellberg	
Date:4/10/2025	
Notes :	