

SITE LIGHTING PREPARED BY: CITY LIGHTING PRODUCTS COMPANY, ST. LOUIS, MO

City Lighting Products certifies that the exterior lighting depicted on this plan complies with the requirements of Section 6-14-1 of the Naperville Code of Ordinances.

Label	CalcType	Units	Avg	Max	Min	Avg/Min	Max/Min
Street - 95th Street	ILLUMINANCE	FC	1.82	2.4	0.1	18.20	24.00
Parking Drive Stat Area	ILLUMINANCE	FC	1.85	2.4	0.1	18.50	24.00

Parking Drive Stat Area
 Illuminance (FC)
 Average = 1.64
 Maximum = 2.4
 Minimum = 0.8
 Avg/Min Ratio = 2.05
 Max/Min Ratio = 3.00

Anna Marie Lane

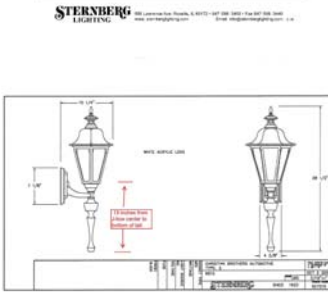
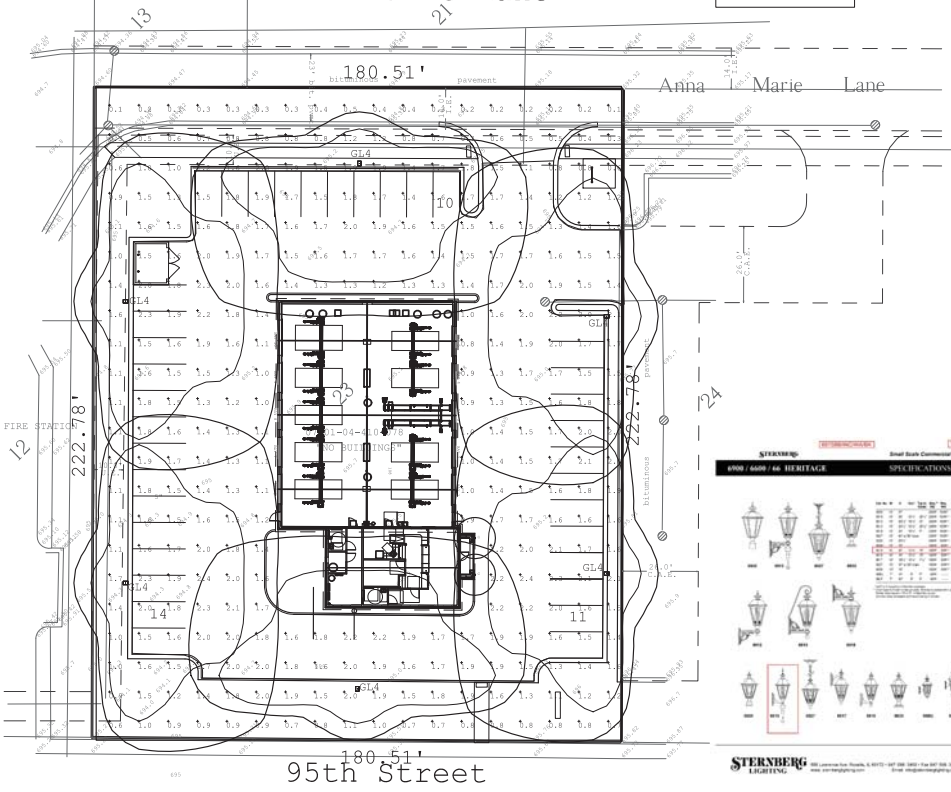

TYPE G

Steel Poles

Label	CalcType	Units	Avg	Max	Min	Avg/Min	Max/Min
95th Street	ILLUMINANCE	FC	1.82	2.4	0.1	18.20	24.00

TYPE GL4 POLE

Label	CalcType	Units	Avg	Max	Min	Avg/Min	Max/Min
95th Street	ILLUMINANCE	FC	1.82	2.4	0.1	18.20	24.00



Label	CalcType	Units	Avg	Max	Min	Avg/Min	Max/Min
95th Street	ILLUMINANCE	FC	1.82	2.4	0.1	18.20	24.00

Label	CalcType	Units	Avg	Max	Min	Avg/Min	Max/Min
95th Street	ILLUMINANCE	FC	1.82	2.4	0.1	18.20	24.00

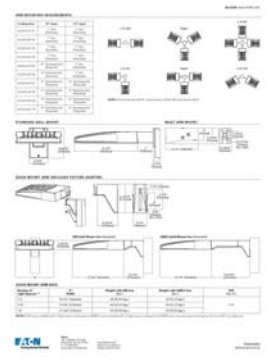

Label	CalcType	Units	Avg	Max	Min	Avg/Min	Max/Min
95th Street	ILLUMINANCE	FC	1.82	2.4	0.1	18.20	24.00

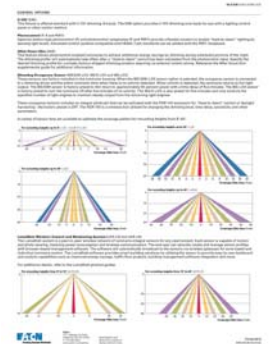

TYPE GL4 FIXTURE

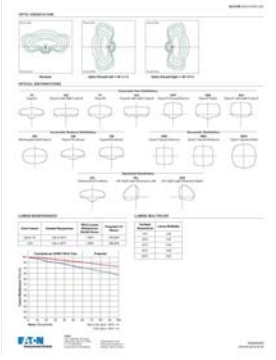

Label	CalcType	Units	Avg	Max	Min	Avg/Min	Max/Min
95th Street	ILLUMINANCE	FC	1.82	2.4	0.1	18.20	24.00



PREPARED FOR: CHRISTIAN BROTHERS AUTOMOTIVE CORP.
 17700 W. WOODWAY BLVD. SUITE 200
 HOUSTON, TEXAS 77055
 PH: (281) 675-6105

CONSULTING ENGINEER: Bollinger Lach & Associates, Inc.
 330 PRINCE ROAD SUITE 200 PLAZA 1, 60143
 P.O. BOX 438 4600 F.R. 208 438 444 www.bollingerlach.com
 ILLINOIS • INDIANA • MISSOURI

SHEET NUMBER: C8
 OF 13