

All Signs shall be installed in accordance with N.E.C. Article 600
 Electrical Code. All signs shall be installed in accordance with
 A.S.C. Code of Ethics & Standards. All signs shall be installed in accordance with
 A.S.C. Code of Ethics & Standards.

SIGN TO BE UL LISTED

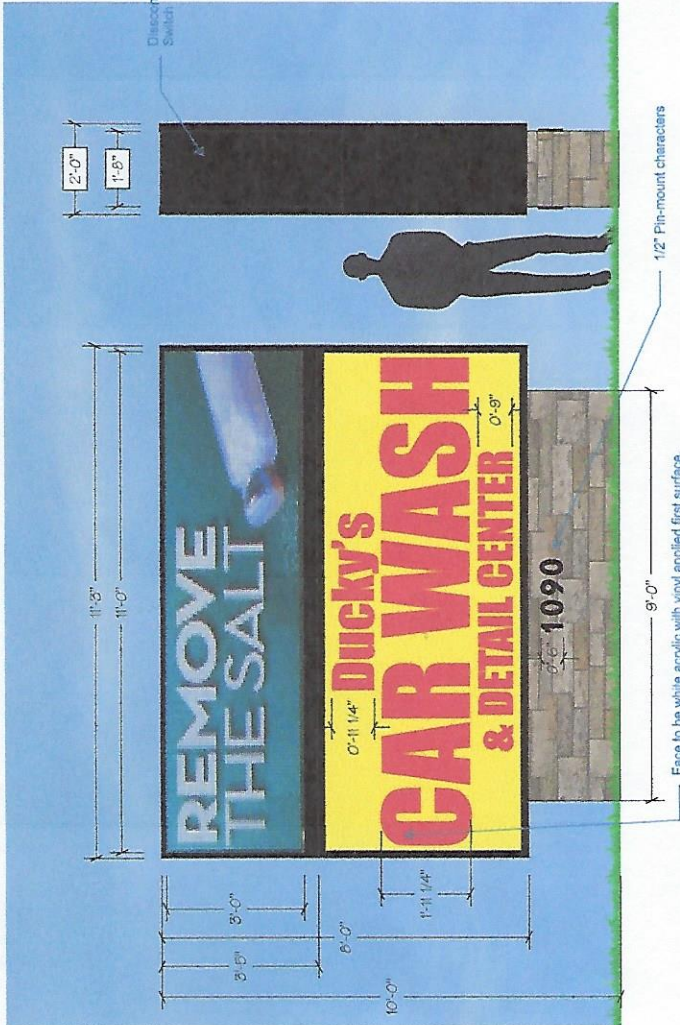

DOUBLE SIDED ILLUMINATED SIGN 1 REQUIRED

FABRICATE AND INSTALL SIGN OF ALUMINUM AND ACRYLIC.
 FACE TO BE WHITE ACRYLIC WITH VINYL APPLIED FIRST SURFACE.
 ALL EXPOSED METAL TO BE COATED WITH ACRYLIC POLYURETHANE.
 INTERNAL ILLUMINATION TO BE WHITE LEDS.
 SEE SCHEDULE A FOR MESSAGE UNIT.
 SCALE 3/8" = 1'

SCHEDULE A MESSAGE UNIT
 W 16MM COLOR, PIXEL MATRIX 36 X 126. CABINET SIZE 4" H X 11" 3" L
 VIEWING AREA 36" X 11" L. DOUBLE FACE. CHARACTER SIZE 4 LINES

90 overall
 342 EMC

INSTALLATION INSTRUCTIONS
 REMOVE EXISTING SIGN AND DISPOSE.
 CUSTOMER IS RESPONSIBLE FOR REMOVING THE
 EXISTING FOUNDATION AND PIPE. ASC WILL NOT REMOVE.
 SET AN 8" STEEL PIPE IN CONCRETE FOOTING TO BE
 4" DEEP BY 2X3". CONNECT TO ELECTRICAL SERVICE
 TO BE PROVIDED BY OTHERS PRIOR TO INSTALL.

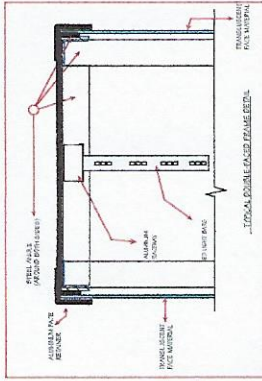
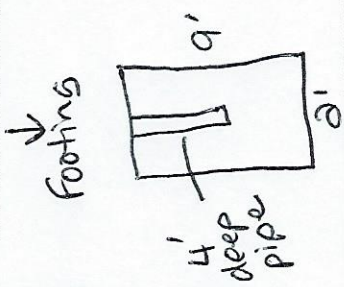

Computer generated colors are not a true match to any PMS, vinyl or paint.
 Rendering shown is for concept only. Actual scale and placement shown are approximate.

1100 Route 34 Aurora, Illinois 60503 JC 630 898 5900 office 630 898 6091 fax	Prepared For: NAPER MOTORS CAR WASH Location Name:	Address: 1090 75TH ST City/State: NAPERVILLE, IL	Drawg: 190235 Rev 1: Rev 2:	Sheet: 2 Design Date: 6/28/19	LANDLORD APPROVAL SIGNATURE PRINT	TITLE: DATE:
---	--	---	-----------------------------------	----------------------------------	--------------------------------------	-----------------

NOTE: THIS DRAWING IS THE PROPERTY OF AURORA SIGN CO. IT IS NOT TO BE REPRODUCED, COPIED, OR EXHIBITED IN ANY FASHION WITHOUT WRITTEN CONSENT FROM AURORA SIGN CO. CHARGES OF UP TO \$2000.00 WILL BE ASSESSED FOR ANY MISUSE OF THESE DRAWINGS.

EXHIBIT D