

GENERAL NOTES

- Contractor shall verify underground utility lines and is responsible for any damage.
- Contractor shall verify all existing conditions in the field prior to construction and shall notify landscape architect of any variance.
- Material quantities shown are for contractors convenience only. The Contractor must verify all material and supply sufficient materials to complete the job per plan.
- The landscape architect reserves the right to inspect trees and shrubs either at place of growth or at site before planting, for compliance with requirements of variety, size and quality.
- Plan shall conform to American Standard for Nursery Stock, State of Illinois Horticultural Standards, and Local Municipal requirements.
- Contractor shall secure and pay for all permits, fees, and inspections necessary for the proper execution of this work and comply with all codes applicable to this work.
- See General Conditions and Specifications for landscape work for additional requirements.

PLANT LIST

Key	Qty.	Botanical/Common Name	Size	Remarks
SHADE TREES				
AF	3	Acer x freemanii 'Jeffers Red' AUTUMN BLAZE MAPLE	2 1/2' Cal.	
CO	3	Celtis occidentalis COMMON HACKBERRY	2 1/2' Cal.	
GT	5	Gleditsia triacanthos inermis 'Skyline' SKYLINE HONEYLOCUST	2 1/2' Cal.	
UH	6	Ulmus 'Morton Glossy' TRUMPET ELM	2 1/2' Cal.	
SR	7	Syringa reticulata 'Ivory Silk' IVORY SILK JAPANESE TREE LILAC	2 1/2' Cal.	Tree Form
MR	5	Malus 'Royalty' ROYALTY CRABAPPLE	2 1/2' Cal.	Tree Form
DECIDUOUS SHRUBS				
RA	40	Rhus aromatica 'Gro-Low' GRO-LOW FRAGRANT SUMAC	5 Gal/24" Wide	4' O.C.
SM	24	Syringa meyeri 'Palibin' DIARF KOREAN LILAC	5 Gal/24" Tall	4' O.C.
PERENNIALS AND ORNAMENTAL GRASSES				
CK	94	Coleragrostis ovaliflora 'Karl Foerster' FEATHER REED GRASS	#1	24" O.C.
HI	124	Hemerocallis 'Happy Returns' HAPPY RETURNS DAYLILY	#1	18" O.C.
HP	105	Hemerocallis 'Pardon Me' PARDON ME DAYLILY	#1	18" O.C.
NF	24	Nepeta x fossenii 'Cat's Meow' CAT'S MEOW CATMINT	#1	18" O.C.
MISC. MATERIALS				
1B		Shredded Hardwood Bark Mulch	C.Y.	

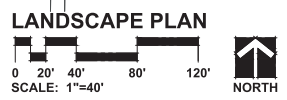

PLANTING DETAILS

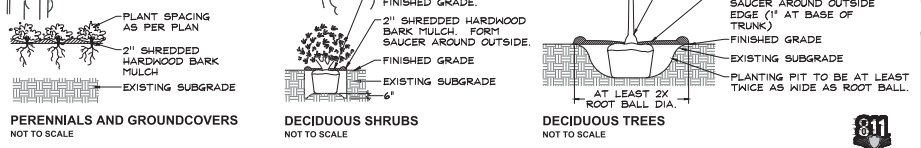

PRUNE ONLY TO ENCOURAGE CENTRAL LEADER. DO NOT CUT CENTRAL LEADER.

MAINTAIN EXPOSURE OF ROOT FLARE. IF ROOT FLARE IS NOT EXPOSED, CAREFULLY REMOVE EXCESS SOIL. SET ROOT BALL SO THAT BASE OF ROOT FLARE IS 3-4" HIGHER THAN ADJACENT FINISH GRADE.

3" SHREDDED HARDWOOD BARK MULCH FORM SAUCER AROUND OUTSIDE EDGE (1" AT BASE OF TRUNK)

FINISHED GRADE

EXISTING SUBGRADE

PLANTING PIT TO BE AT LEAST TWICE AS WIDE AS ROOT BALL.

GRWA
GARY R. WEBER ASSOCIATES, INC.
 LAND PLANNING
 BIOLOGICAL CONSULTING
 LANDSCAPE ARCHITECTURE
 212 SOUTH MAIN STREET
 WHEATON, ILLINOIS 60097
 PHONE: 630-666-1797

LEAD ENGINEER:
ADVANTAGE CONSULTING ENGINEERS
 80 MAIN STREET, SUITE 17
 LEMONT, ILLINOIS 60469
 P: 647-200-4750

PATEL BROTHERS
 NAPERVILLE, ILLINOIS
LANDSCAPE PLAN

REVISIONS

NO.	DATE	DESCRIPTION

DATE: 5.19.17
 PROJECT NO.: AC1112
 DRAWN: MSM
 CHECKED: JCT
 SHEET NO.

EXHIBIT B