

CONTROL POINT FOR LAYOUT OF ALL PROPOSED IMPROVEMENTS. BUILDING AND PARKING TO BE PARALLEL AND PERPENDICULAR TO NORTH PROPERTY LINE UNLESS OTHERWISE NOTED.

E CHICAGO AVENUE

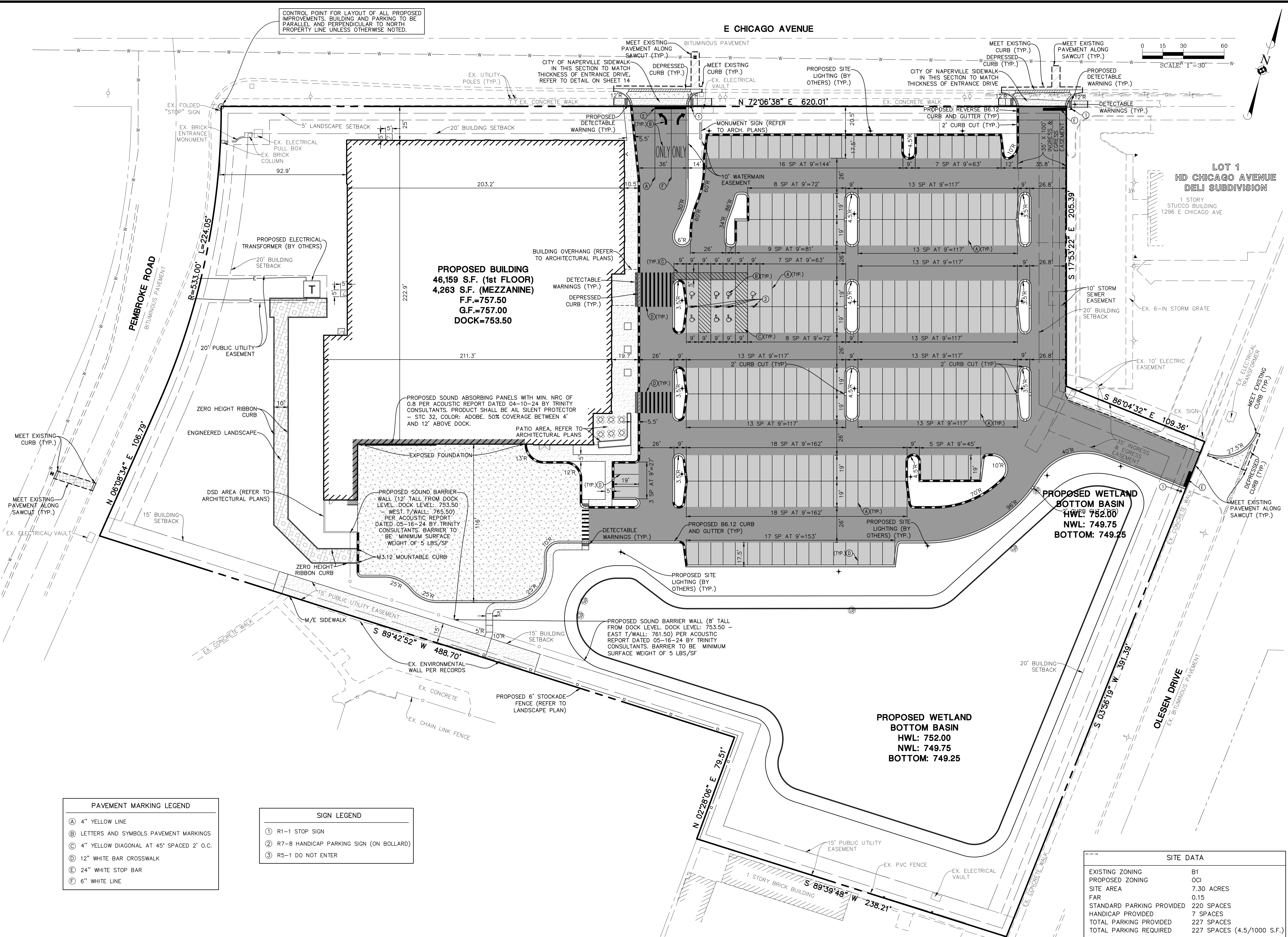
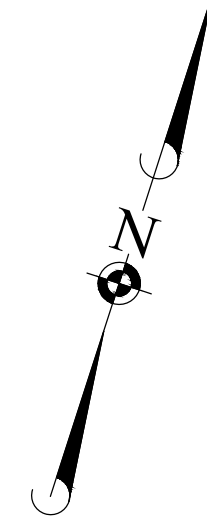
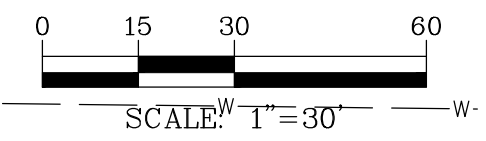

**PROPOSED BUILDING**  
**46,159 S.F. (1st FLOOR)**  
**4,263 S.F. (MEZZANINE)**  
**F.F.=757.50**  
**G.F.=757.00**  
**DOCK=753.50**

**PROPOSED WETLAND BOTTOM BASIN**  
**HWL: 752.00**  
**NWL: 749.75**  
**BOTTOM: 749.25**

**PROPOSED WETLAND BOTTOM BASIN**  
**HWL: 752.00**  
**NWL: 749.75**  
**BOTTOM: 749.25**

**PAVEMENT MARKING LEGEND**

(A)	4" YELLOW LINE
(B)	LETTERS AND SYMBOLS PAVEMENT MARKINGS
(C)	4" YELLOW DIAGONAL AT 45° SPACED 2' O.C.
(D)	12" WHITE BAR CROSSWALK
(E)	24" WHITE STOP BAR
(F)	6" WHITE LINE

**SIGN LEGEND**

①	R1-1 STOP SIGN
②	R7-8 HANDICAP PARKING SIGN (ON BOLLARD)
③	R5-1 DO NOT ENTER

**SITE DATA**

EXISTING ZONING	B1
PROPOSED ZONING	OCI
SITE AREA	7.30 ACRES
FAR	0.15
STANDARD PARKING PROVIDED	220 SPACES
HANDICAP PROVIDED	7 SPACES
TOTAL PARKING PROVIDED	227 SPACES
TOTAL PARKING REQUIRED	227 SPACES (4.5/1000 S.F.)

REVISIONS

NO.	DATE	DESCRIPTION

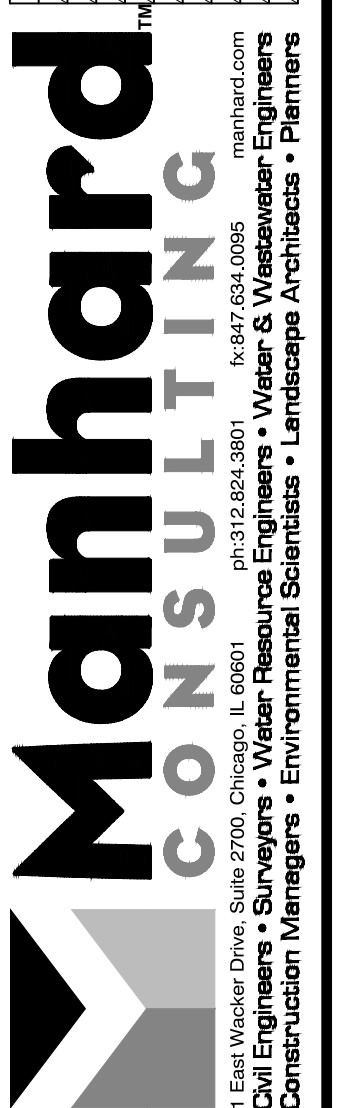

**PROPOSED HEINEN'S GROCERY STORE**  
**CITY OF NAPERVILLE, ILLINOIS**  
**SITE PLAN**

PROJ. MGR.: MDE  
 PROJ. ASSOC.: JCM  
 DRAWN BY: EJB  
 DATE: 02/09/24  
 SCALE: 1"=30'

SHEET  
**EXB.**  
 HGS.NVL01

© 2024 MANHARD CONSULTING. ALL RIGHTS RESERVED.

15-16-2024-1504 - Draw Name: P:\Naper\01\Draw\Final\Drawings\Plan\_Site\SITE.dwg, Updated By: Mhanh

FINAL ENGINEERING - NOT FOR CONSTRUCTION