

AMC NAPERVILLE 16

COMMERCIAL BUILDING

PAVING LEGEND

- HMA PAVEMENT (SHOWPLACE DRIVE)
- HMA PAVEMENT (PRIVATE)
- CONCRETE SIDEWALK
- BRICK PAVEMENT (REFER TO LANDSCAPE PLAN FOR ADDITIONAL DETAILS)
- TURF OR LANDSCAPING (GREEN SPACE)
- B6.12 CURB AND GUTTER
- DEPRESSED CURB
- REVERSE CURB
- ADA DETECTABLE WARNING

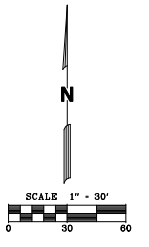

- PAVING PLAN GENERAL NOTES**
1. ALL DIMENSIONS ARE TO BACK OF CURB OR FACE OF BUILDING, UNLESS OTHERWISE NOTED.
 2. ALL RADII ARE TO BACK OF CURB, UNLESS OTHERWISE NOTED.
 3. ALL BUILDING DIMENSIONS ARE BASED ON ARCHITECTURAL PLANS PREPARED BY LENNAR HOMES. CONTRACTOR SHALL REFER TO ARCHITECTURAL PLANS FOR EXACT BUILDING DIMENSIONS AND CONTACT THE ARCHITECT FOR ANY DISCREPANCIES.
 4. ALL ON-SITE PAVEMENT MARKINGS SHALL BE PAINTED, UNLESS OTHERWISE NOTED.
 5. ALL PROPOSED CURB AND GUTTER SHALL BE B6.12 AND SHALL BE DEPRESSED CURB WHERE SIDEWALK MEETS A STREET, UNLESS OTHERWISE INDICATED. CURB DEPRESSIONS SHALL MEET ADA REQUIREMENTS AS NOTED IN THE CONSTRUCTION DETAILS.
 6. ALL JOINTS MADE WITH EXISTING PAVEMENT, CURB, WALK OR CURB AND GUTTER ARE TO BE SAWCUT FULL DEPTH WITHIN 24 HOURS OF PLACEMENT.
 7. ALL CURB ISLANDS TO HAVE 1-FOOT MINIMUM RADIUS ON CORNERS, UNLESS OTHERWISE SHOWN.
 8. BOLLARDS TO BE PLACED AROUND TRANSFORMER PADS, IF DEEMED NECESSARY DUE TO PROXIMITY TO VEHICULAR TRAFFIC. FINAL TRANSFORMER PAD LOCATIONS TO BE COORDINATED WITH NMP&E.

- ① R1-1 "STOP" (30"x30")
- ② R7-1 "NO PARKING ANYTIME" (12"x18")

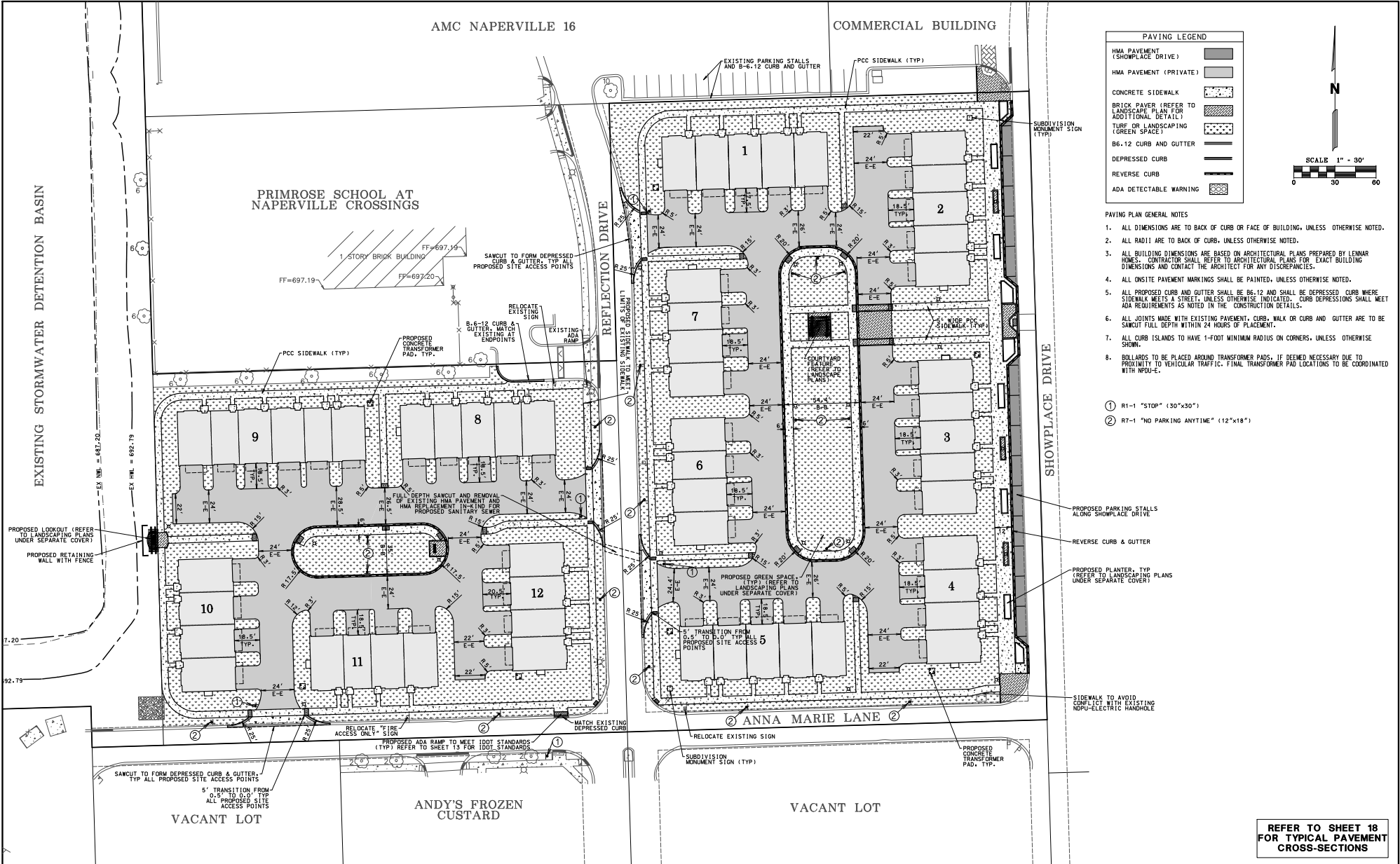

REFER TO SHEET 18 FOR TYPICAL PAVEMENT CROSS-SECTIONS

Mackie Consultants, LLC
 9575 W. Higgins Road, Suite 500
 Rosemont, IL 60018
 (847) 696-1400
 www.mackieconsult.com

CLIENT:
LENNAR
 Lennar Homes
 1141 East Main Street, Suite 108
 East Dundee, IL 60118
 Phone: 224-293-3100 Fax: 224-293-3101

DATE	DESCRIPTION OF REVISION	BY	SCALE
09/04/2019	REVISED PER CITY COMMENT LETTER DATED 8/21/2019	OZ	DATE 06/11/2019
08/08/2019	REVISED PER CITY COMMENT LETTER DATED 7/10/2019	OZ	DATE 06/11/2019

DESIGNED	OZ
DRAWN	DWP
APPROVED	RNM

**PAVING & GEOMETRY PLAN
 NAPERVILLE CROSSINGS COMMUNITY
 NAPERVILLE, WILL COUNTY, IL**

SHEET
12 OF 21
 PROJECT NUMBER: 3687
 © MACKIE CONSULTANTS, LLC 2019
 LICENSE FROM LICENSE 84-00894