



BASE OF BEARINGS
EAST LINE OF THE
LAUREL - 500°04'03"

CITY OF NAPERVILLE
Address: Lot 2,3 Laurel
Last Revision Date: 6/6/24
Approval Date: 9/27/24



GENERAL NOTES

- ALL PLANT MATERIAL SHALL BE NORTHERN ILLINOIS NURSERY GROWN TO ASSURE CLIMATIC AND SOIL SIMILARITY. ALL MATERIAL SHALL BE BALLED AND BURLAP PER AMERICAN STANDARD FOR NURSERY STOCK BY THE AMERICAN ASSOCIATION OF NURSEYMEN, INC. PERENNIAL AND GROUND COVER SHALL BE CONTAINER GROWN.
- ALL BEDS SHALL RECEIVE 3"-4" OF FINELY SHREDED HARDWOOD MULCH. GROUND COVER BEDS SHALL BE TREATED WITH TRIFLUR PRE-EMERGENT HERBICIDE. ALL OTHER BEDS SHALL RECEIVE RONSTAR 5g OR SIMILAR PRE-EMERGENT HERBICIDE FOR WEED CONTROL. ALL TREES SHALL RECEIVE 6" OF FINELY SHREDED HARDWOOD MULCH. ALL LANDSCAPE SPOILS SHALL BE REMOVED FROM THE SITE BY THE CONTRACTOR.
- OWNER SHALL PROVIDE SUFFICIENT WATER FOR THE CONTRACTOR TO MAINTAIN THE PLANT MATERIAL AND SEED AREAS. CONTRACTOR SHALL WATER SEED UNTIL THE TURF HAS BECOME ADEQUATELY ESTABLISHED. CONTRACTOR SHALL WARRANTEE ALL MATERIAL AND LABOR FOR A PERIOD OF ONE YEAR FROM ACCEPTANCE OF ALL WORK. OWNER TO PROVIDE ALL SUPPLEMENTAL WATERING AND PROPER CARE AND MAINTENANCE OF ALL MATERIAL AFTER CONTRACTOR'S INITIAL CARE.
- QUANTITY LISTS ARE SUPPLIED AS A CONVENIENCE. THE CONTRACTOR SHALL VERIFY ALL QUANTITIES ON-SITE. THE CONTRACTOR SHALL VERIFY LOCATION OF ALL UNDERGROUND UTILITIES PRIOR TO DIGGING.
- PLANTING BEDS SHALL BE ELEVATED SLIGHTLY TO INSURE PROPER DRAINAGE. ALL ROOT BALLS OF TREES SHALL BE ELEVATED ABOVE FINISHED GRADE. ALL GRADING SHALL PROVIDE SLOPES WHICH ARE SMOOTH, CONTINUOUS AND HAVE POSITIVE DRAINAGE IN ALL AREAS.
- CONTRACTOR SHALL BE RESPONSIBLE FOR PROVIDING TEMPORARY EROSION CONTROL FOR SOIL AREAS DUE TO SLOPE CONDITIONS. CONTRACTOR SHALL MAINTAIN ALL EROSION CONTROL STRUCTURES, FENCES, DITCH CHECKS, AND INLET PROTECTORS UNTIL ADEQUATE VEGETATION HAS BEEN ESTABLISHED.
- EXCAVATED MATERIALS IN EXCESS OR THOSE NOT REQUIRED OR UNSUITABLE FOR RE-USE SHALL BE DISPOSED OF OFF SITE AT CONTRACTOR'S EXPENSE. CONTRACTOR SHALL REMOVE ALL DEBRIS DAILY AND MAINTAIN THE SITE IN A NEAT AND SAFE CONDITION.
- SOIL TESTS SHALL BE MADE TO DETERMINE THE EXACT REQUIREMENTS FOR BOTH SOIL AMENDMENTS AND FERTILIZER. SOIL TESTS SHALL BE CONDUCTED BY A GOVERNMENT LABORATORY OR RECOGNIZED COMMERCIAL LABORATORY, COST OF WHICH SHALL BE BORNE BY THE CONTRACTOR. CONTRACTOR IS RESPONSIBLE FOR MATERIAL COST AND APPLICATION OF TESTING LABORATORY'S RECOMMENDATIONS.
- LANDSCAPE CONTRACTOR SHALL PROVIDE THE OWNER WITH AN EQUIPMENT AND LABOR RATE SCHEDULE. THIS LIST SHALL INCLUDE COST OF TOPSOIL AND LANDSCAPE DEBRIS/SPOILS REMOVAL WITH SQUARE FOOT COST FOR TURF RESTORATION. LANDSCAPE CONTRACTOR SHALL RESTORE ALL TURF AREAS DAMAGED DUE TO CONSTRUCTION ON AND OFF SITE AT THE AGREED RATES TO RESTORE THE EXISTING CONDITIONS.
- LANDSCAPE CONTRACTOR SHALL FOLLOW ALL LOCAL AND MUNICIPAL CODES AND REQUIREMENTS. CONTRACTOR SHALL SECURE ALL REQUIRED PERMITS AS NECESSARY TO COMPLETE THE SCOPE OF THE JOB.
- ALL TREES SHALL BE INSTALLED A MINIMUM OF FIVE (5) FEET HORIZONTALLY FROM SANITARY SEWERS, SANITARY SERVICES, WATER MAINS, WATER SERVICES AND STORM SEWERS. TREES SHALL BE INSTALLED A MINIMUM OF TEN (10) FEET HORIZONTALLY FROM UTILITY STRUCTURES AND APPURTENANCES, INCLUDING BUT NOT LIMITED TO MANHOLES, VALVE VAULTS, VALVE BOXES AND FIRE HYDRANTS. NO TREES, SHRUBS OR OBSTACLES WILL BE ALLOWED 10 FEET IN FRONT OF, 5 FEET ON THE SIDES AND 7 FEET TO THE REAR OF ELECTRICAL TRANSFORMERS. FIELD ADJUST ANY CONFLICTS AS NEEDED.
- NO TREES CAN BE PLANTED WITHIN FIVE (5) FEET OF ELECTRIC LINES.

LANDSCAPE PLAN

LOTS 2 AND 3 THE LAUREL SUBDIVISION

NAPERVILLE, ILLINOIS

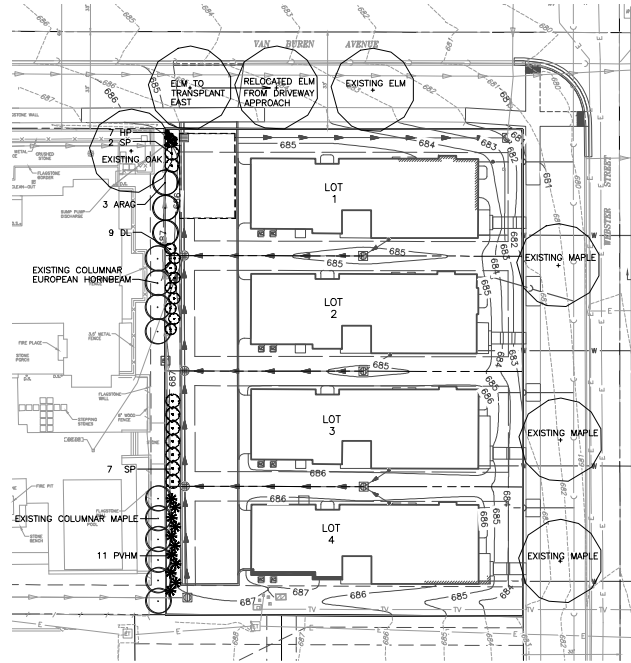

LOCATION MAP
N.T.S.
MAP PROVIDED BY USGS DATED 2021

PLANT LIST

| KEY | NAME | BOTANICAL/COMMON | SIZE | QUANTITY |
|------|--------------------------------|--------------------------|-------|----------|
| ARAG | ACER RUBRUM 'ARMSTRONG GOLD' | | 2.6' | 3 |
| DL | DIERYLLA LONGIFLORA | ARMSTRONG GOLD RED MAPLE | 5 GAL | 9 |
| SP | SYRINGA PATULIA 'MISS KIM' | DWARF BUSH-HONEYSUCKLE | 5 GAL | 9 |
| HP | HOSTA PATRIOT | MISS KIM LILAC | 1 GAL | 7 |
| PVHM | PANICUM VIRGATUM 'HEAVY METAL' | PATRIOT-HOSTA | 2 GAL | 11 |
| | | HEAVY METAL-SWISS GRASS | | |

GENERAL SEED SPECIFICATIONS

- TURF GRASS SEED RATE: 250 LBS/ACRE
- GREENSKEEPER PRIDE MIXTURE
- 20% BLUE MOON KENTUCKY BLUEGRASS
- 20% FREDDOM II KENTUCKY BLUEGRASS
- 20% EVEREST KENTUCKY BLUEGRASS
- 20% CREEPING RED FESCUE
- 20% ACCENT PERENIAL RYEGRASS
- CONSERV FS 4720 YENDER AVE, JULE, IL 630-963-8787
- TURF FERTILIZATION: 6-24-24 STARTER FERTILIZER RATE: 250 LBS/ACRE
- TREE, SHRUB AND PLANT BED FERTILIZER LESCO 14-14-14 POLY PLUS SULFUR COATED LANDSCAPE AND ORNAMENTAL ALL PURPOSE FERTILIZER RATE: 5 POUNDS PER 1000 S.F. PLANT BEDS ONE POUND PER CALIPER INCH FOR TREES

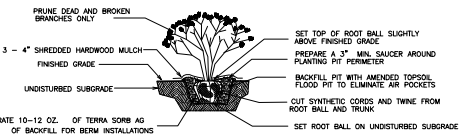

SHRUB PLANTING DETAIL
NOT TO SCALE. USE ONLY NORTHERN ILLINOIS GROWN NURSERY STOCK

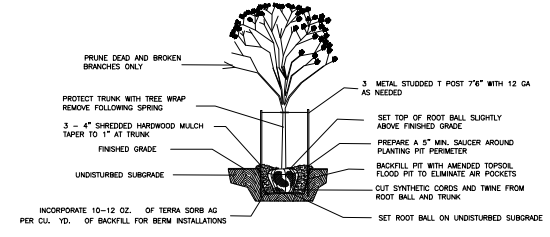

TREE PLANTING DETAIL
NOT TO SCALE. USE ONLY NORTHERN ILLINOIS GROWN NURSERY STOCK

- REFERENCE**
- EXISTING CONDITIONS ARE BASED UPON FIELD OBSERVATIONS MADE ON MARCH 4-5, 2024 BY CIVIL & ENVIRONMENTAL CONSULTANTS, INC.
 - FIELD DATUM: US SURVEY FOOT, CITY OF NAPERVILLE DATUM NAVD 88.
 - UNDERGROUND UTILITY INFORMATION SHOWN HEREON IS BASED UPON FIELD OBSERVATIONS, ATLAS MAPS PROVIDED BY THE CITY OF NAPERVILLE AND THOSE PUBLIC UTILITY COMPANIES OPERATING UNDER FRANCHISE OR CONTRACT WITH THE CITY OF NAPERVILLE.

I, CRAIG A. HERMAN, ILLINOIS REGISTERED LANDSCAPE ARCHITECT NO. 157-000419 DO HEREBY CERTIFY THE PLAN SHOWN HEREON IS A CORRECT REPRESENTATION OF LANDSCAPE IMPROVEMENTS TO THE NOTED PROPERTY.

Craig A. Herman

CRAIG A. HERMAN
IRLA #157-000419
WESTWOOD LANDSCAPE
WEST CHICAGO, IL

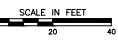

CITY PROJECT NUMBER 24-10000035

REVISION RECORD

| NO. | DATE | DESCRIPTION |
|-----|------|-------------|
| | | |
| | | |
| | | |
| | | |
| | | |

1230 East Diehl Road
Suite 200
Naperville, IL 60563
Ph: 630.963.6026
www.ccecinc.com



TRIFOX PROPERTIEZ, LLC
LOTS 2 AND 3 THE LAUREL SUBDIVISION
204 AND 212 WEST VAN BUREN AVENUE
NAPERVILLE, ILLINOIS 60540

LANDSCAPE PLAN

| DATE | BY | CHECKED BY | SCALE |
|--------------|-------------|------------|----------|
| MAY 17, 2024 | DAVID BYRNE | 1:1=20' | 3/16=20' |

PROJECT NO. 24-10000035
DRAWING NO. LS-01