



**LOCATION MAP**

# OPEN SPACE EXHIBIT FOR THE BELVEDERE

THE EAST HALF OF THE SOUTHWEST QUARTER OF THE SOUTHEAST QUARTER  
OF SECTION 16, TOWNSHIP 37 NORTH, RANGE 9, EAST OF THE THIRD  
PRINCIPAL MERIDIAN, IN WILL COUNTY, ILLINOIS.

**PARCEL INDEX NUMBER**  
07-01-16-400-004

**PARCEL AREA**  
PARCEL AREA = 878,719 S.F.  
OR 20.173 ACRES

**LOT DIMENSIONS & AREAS ARE  
APPROXIMATIONS & WILL VARY  
AT TIME OF FINAL PLATTING.**

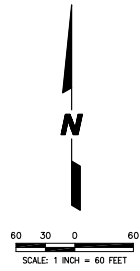

**TOTAL OPEN SPACE AREA = 419,377 S.F. or 9.63 Ac.**

**346,627  
S.F.  
Around  
Perimeter**

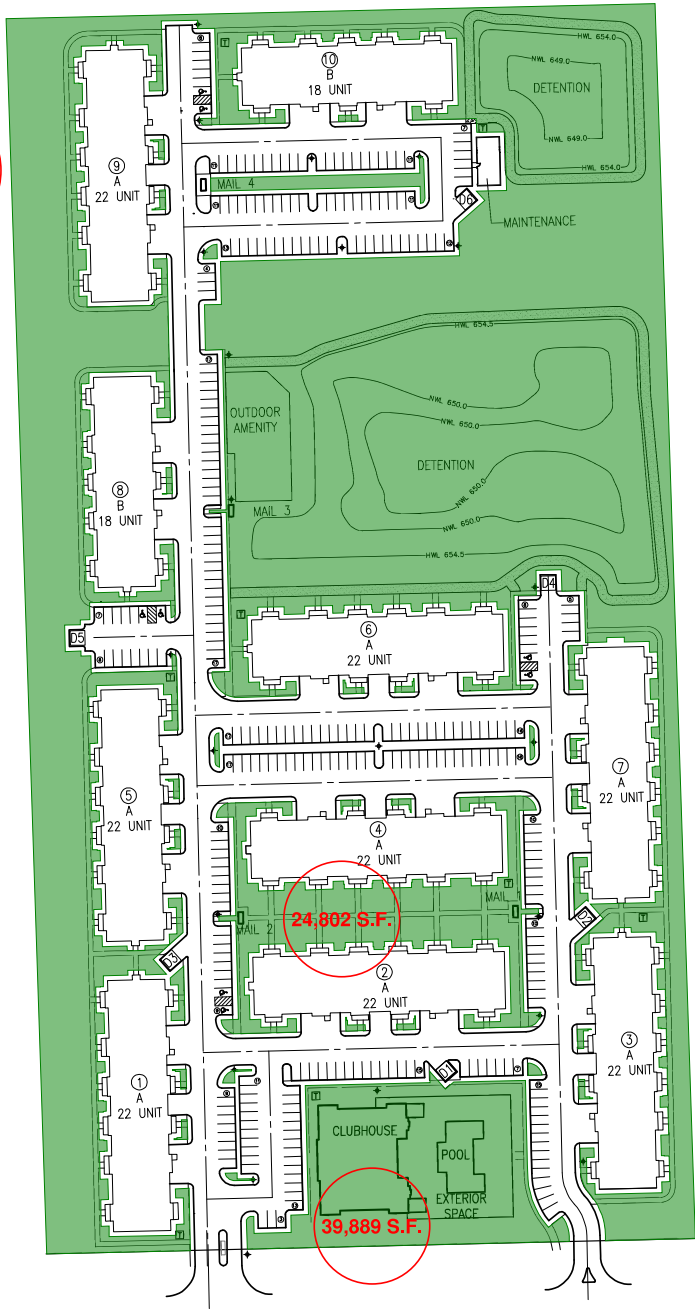

**8,059 S.F.  
Various  
Islands**

SITE DATA	
A. TOTAL AREA	20.17 AC.±
B. PROPOSED ZONING OOI PUD	
C. 1111th R.O.W. DEDICATION	0.91 AC.±
D. P.U.D. OPEN SPACE CALCULATION	9.63 AC OR 47,748
E. UNITS	212 UNITS
F. DENSITY	10.51 DU/AC
G. 1111th STREET SETBACK	20 FT.
H. BUILDING HEIGHT	28 FT.
I. PARKING PROVIDED	480
J. SURFACE PARKING	76
K. DRIVEWAY PARKING	76
L. ACCESSIBLE PARKING SPACES REQUIRED	328
M. ACCESSIBLE PARKING SPACES PROVIDED	9
N. ACCESSIBLE PARKING SPACES PROVIDED	10

PREPARED FOR:  
**BRIDGE CAPITAL PARTNERS**  
899 PINE STREET #2000  
SAN FRANCISCO, CA. 94108

PREPARED BY:  
**CEMCON, Ltd.**  
Consulting Engineers, Land Surveyors & Planners  
2280 White Oak Circle, Suite 100  
Aurora, Illinois 60502-9675  
PH: 630.862.2100 FAX: 630.862.2199  
E-Mail: info@cemcon.com Website: www.cemcon.com

DISC NO.: 904411 FILE NAME: PREOVER-05E  
DRAWN BY: PRP/DJF FLD. BK. / PG. NO.: -----  
COMPLETION DATE: 05-11-2022 JOB NO.: 904-411  
XREF : PROJECT MANAGER : KMM

## EXHIBIT H

**PRELIMINARY P.U.D. FOR THE BELVEDERE**  
CITY OF HANOVERVILLE PROJECT NO.: 22-12322XX  
Copyright © 2022 Cemcon, Ltd. All rights reserved.