

Drawing name: A:\GIS\16811000\16811000\_Landscaping\16811000\_Landscaping\_Plan.dwg, Plot Date: 02/10/20, 4:08pm, by: jkha  
 This document is the property of Kimley-Horn and Associates, Inc. and is to be used only for the specific purpose and client for which it was prepared. Reuse of any portion of this document without written authorization and adaptation by Kimley-Horn and Associates, Inc. shall be without liability to Kimley-Horn and Associates, Inc.

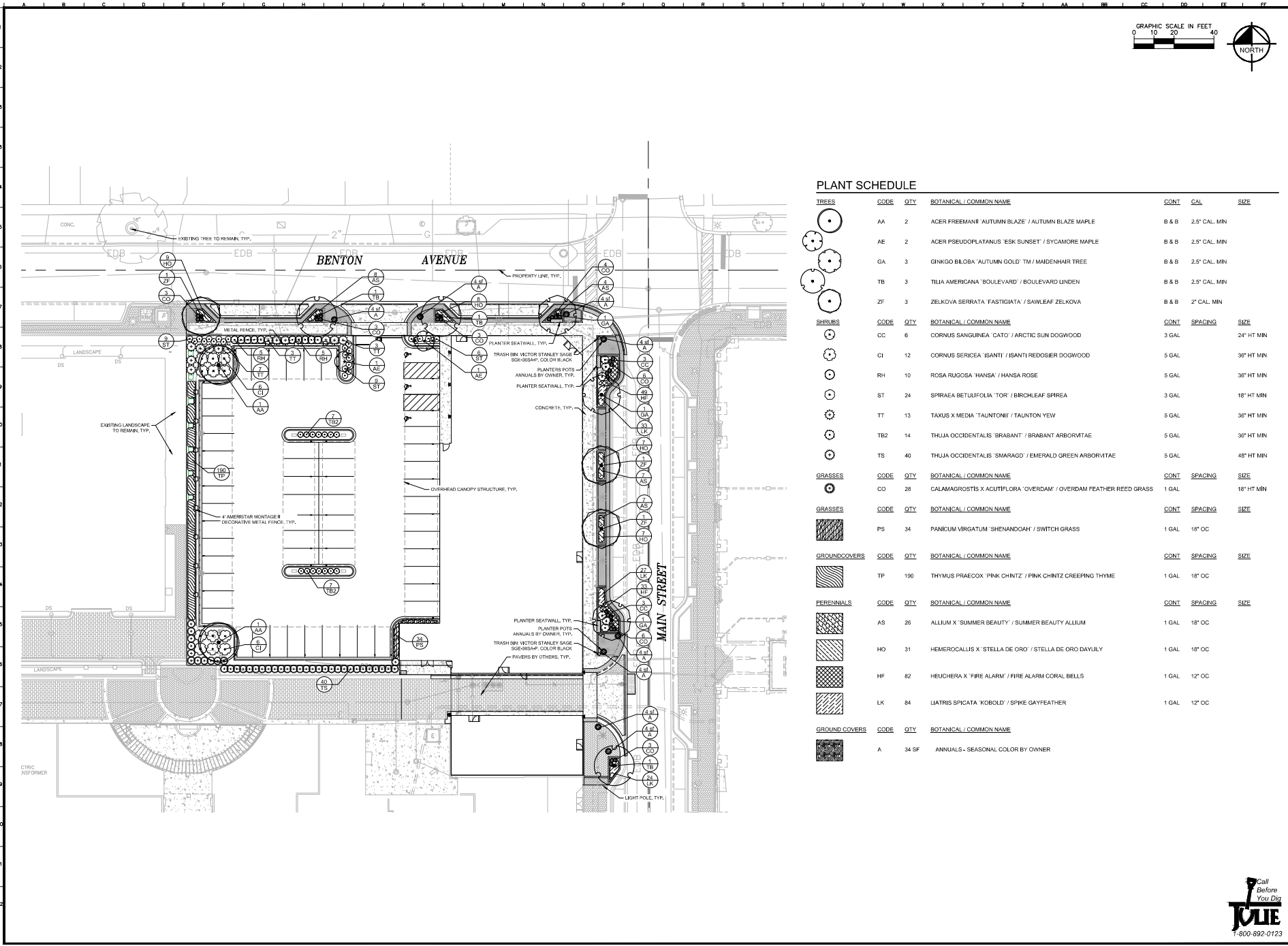

### PLANT SCHEDULE

TREES	CODE	QTY	BOTANICAL / COMMON NAME	CONT.	CAL.	SIZE
AA	2	ACER FREEMANI 'AUTUMN BLAZE' / AUTUMN BLAZE MAPLE	8 & B	2.5'	2.5' CAL. MIN	
AE	2	ACER PSEUDOPLATANUS 'ESK SUNSET' / SYCAMORE MAPLE	8 & B	2.5'	2.5' CAL. MIN	
GA	3	GINKGO BILOBA 'AUTUMN GOLD' TM / MAIDENHAIR TREE	8 & B	2.5'	2.5' CAL. MIN	
TB	3	TILIA AMERICANA 'BOULEVARD' / BOULEVARD LINDEN	8 & B	2.5'	2.5' CAL. MIN	
ZF	3	ZELKOVA SERRATA 'FASTIGIATA' / SAWLEAF ZELKOVA	8 & B	2'	2' CAL. MIN	
SHRUBS	CODE	QTY	BOTANICAL / COMMON NAME	CONT.	SPACING	SIZE
CC	6	CORNUS SANGUINEA 'CATO' / ARCTIC SUN DOGWOOD	3 GAL			24" HT MIN
CI	12	CORNUS SERICEA 'ISANTI' / ISANTI REDOSIER DOGWOOD	5 GAL			36" HT MIN
RH	10	ROSA RUGOSA 'HANSA' / HANSA ROSE	5 GAL			36" HT MIN
ST	24	SPIRAEA BETULIFOLIA 'TOR' / BIRCHLEAF SPIREA	3 GAL			18" HT MIN
TT	13	TAXUS X MEDIA 'TAUNTONII' / TAUNTON YEW	5 GAL			36" HT MIN
TB2	14	THUJA OCCIDENTALIS 'BRABANT' / BRABANT ARBORVITAE	5 GAL			36" HT MIN
TS	40	THUJA OCCIDENTALIS 'SMARAGO' / EMERALD GREEN ARBORVITAE	5 GAL			48" HT MIN
GRASSES	CODE	QTY	BOTANICAL / COMMON NAME	CONT.	SPACING	SIZE
CO	28	CALAMAGROSTIS X ACUTIFLORA 'OVERDAM' / OVERDAM FEATHER REED GRASS	1 GAL			18" HT MIN
GRASSES	CODE	QTY	BOTANICAL / COMMON NAME	CONT.	SPACING	SIZE
PS	34	PANICUM VIRGATUM 'SHENANDOAH' / SWITCH GRASS	1 GAL			18" OC
GROUNDCOVERS	CODE	QTY	BOTANICAL / COMMON NAME	CONT.	SPACING	SIZE
TP	190	THYMUS PRAECOX 'PINK CHINTZ' / PINK CHINTZ CREEPING THYME	1 GAL			18" OC
PERENNIALS	CODE	QTY	BOTANICAL / COMMON NAME	CONT.	SPACING	SIZE
AS	26	ALLIUM X 'SUMMER BEAUTY' / SUMMER BEAUTY ALLIUM	1 GAL			18" OC
HO	31	HEMEROCALLIS X 'STELLA DE ORO' / STELLA DE ORO DAYLILY	1 GAL			18" OC
HF	82	HEUCHERA X 'FIRE ALARM' / FIRE ALARM CORAL BELLS	1 GAL			12" OC
LK	84	LIATRIS SPICATA 'KOBOLD' / SPIKE GAYFEATHER	1 GAL			12" OC
GROUND COVERS	CODE	QTY	BOTANICAL / COMMON NAME	CONT.	SPACING	SIZE
A	34 SF	ANNUALS - SEASONAL COLOR BY OWNER				

<b>Kimley-Horn</b> <small>INCORPORATED</small> <small>1001 WASHINGTON AVENUE, SUITE 300</small> <small>SPRINGFIELD, ILLINOIS 62761</small> <small>PH: 618-797-5000</small> <small>FAX: 618-797-5000</small> <small>WWW.KIMLEY-HORN.COM</small>	SCALE: AS NOTED DESIGNED BY: CAW DRAWN BY: CAW CHECKED BY: JPO	<b>LANDSCAPE PLAN</b>  <b>MAIN STREET PROMENADE</b> <small>BENTON AVENUE &amp; MAIN STREET</small> <small>SPRINGFIELD, ILLINOIS</small>	ORIGINAL ISSUE: 02/10/20 KHA PROJECT NO. 168811000 SHEET NUMBER <b>L1.0</b>	DATE 02/10/20 DATE 02/10/20 DATE 02/10/20
--	---	---	--	--

EXHIBIT G

Scale: 1/4" = 1'-0" (1/8" = 1'-0")  
 Date: 02/10/20  
 Project: 168811000  
 Drawing: L2.0 LANDSCAPE NOTES & DETAILS  
 Designer: KHA  
 Checker: JLP  
 Title: LANDSCAPE NOTES & DETAILS  
 This document, together with the contract and original printed plans, is to be read in conjunction with the specifications and other documents referred to herein.

### LANDSCAPE NOTES

- THE LANDSCAPE CONTRACTOR SHALL BE RESPONSIBLE FOR INSTALLING MATERIALS AND PLANTS SHOWN ON THE LANDSCAPE PLAN. THE CONTRACTOR IS RESPONSIBLE FOR THE COST TO REPAIR UTILITIES, ADJACENT LANDSCAPE, PUBLIC AND PRIVATE PROPERTY THAT IS DAMAGED BY THE CONTRACTOR OR THEIR SUBCONTRACTOR'S OPERATIONS DURING INSTALLATION OR DURING THE SPECIFIED MAINTENANCE PERIOD. CALL FOR UTILITY LOCATIONS PRIOR TO ANY EXCAVATION.
- THE CONTRACTOR SHALL REPORT ANY DISCREPANCY IN PLAN VS. FIELD CONDITIONS IMMEDIATELY TO THE LANDSCAPE ARCHITECT, PRIOR TO CONTINUING WITH THAT PORTION OF WORK.
- THE CONTRACTOR SHALL BE RESPONSIBLE FOR THE REPAIR OF ANY OF THEIR TRENCHES OR EXCAVATIONS THAT SETTLE.
- ALL NURSERY STOCK SHALL BE WELL BRANCHED, HEALTHY, FULL, PRE-INOCULATED AND FERTILIZED. DECIDUOUS TREES SHALL BE FREE OF FRESH SCARS. TRUNKS WILL BE WRAPPED IF NECESSARY TO PREVENT SUN SCALD AND INSECT DAMAGE. THE LANDSCAPE CONTRACTOR SHALL REMOVE THE WRAP AT THE PROPER TIME AS A PART OF THIS CONTRACT.
- ALL NURSERY STOCK SHALL BE GUARANTEED, BY THE CONTRACTOR, FOR ONE YEAR FROM DATE OF FINAL INSPECTION.
- AMENDED SOIL SHALL BE PROVIDED AND GRADED BY THE GENERAL CONTRACTOR UP TO 6 INCHES BELOW FINISHED GRADE IN TURF AREAS AND 18 INCHES IN PLANTING AREAS.
- PLANTING AREA SOIL SHALL BE AMENDED WITH 25% SPHAGNUM PEATMOSS, 5% HUMUS AND 65% PULVERIZED SOIL FOR ALL SHRUB, ORNAMENTAL GRASS, PERENNIAL AND ANNUAL BEDS. AMENDED TURF AREA SOIL SHALL BE STANDARD TOPSOIL.
- SEED/SOD LIMIT LINES ARE APPROXIMATE. CONTRACTOR SHALL SEED/SOD ALL AREAS WHICH ARE DISTURBED BY GRADING WITH THE SPECIFIED SEED/SOD MIXES.
- CONTRACTOR SHALL INSTALL SHREDDED HARDWOOD MULCH AT A 3" DEPTH TO ALL TREES, SHRUB, PERENNIAL, AND GROUND COVER AREAS. TREES PLACED IN AREA COVERED BY TURF SHALL RECEIVE A 4 FT WIDE MAXIMUM TREE RING WITH 3" DEPTH SHREDDED HARDWOOD MULCH. A SPADED BED EDGE SHALL SEPARATE MULCH BEDS FROM TURF OR SEEDED AREAS. A SPADED EDGE IS NOT REQUIRED ALONG CURBED EDGES.
- INSTALLATION OF TREES WITHIN PARKWAYS SHALL BE COORDINATED IN THE FIELD WITH LOCATIONS OF UNDERGROUND UTILITIES. TREES SHALL NOT BE LOCATED CLOSER THAN 5' FROM UNDERGROUND UTILITY LINES AND NO CLOSER THAN 10' FROM UTILITY STRUCTURES. DO NOT DISTURB THE EXISTING PAVING, LIGHTING, OR LANDSCAPING THAT EXISTS ADJACENT TO THE SITE UNLESS OTHERWISE NOTED ON PLAN.
- PLANT QUANTITIES SHOWN ARE FOR THE CONVENIENCE OF THE OWNER AND JURISDICTIONAL REVIEW AGENCIES. THE CONTRACTOR IS RESPONSIBLE FOR VERIFYING ALL PLANT QUANTITIES AS DRAWN.
- THE OWNER'S REPRESENTATIVE MAY REJECT ANY PLANT MATERIALS THAT ARE DISEASED, DEFORMED, OR OTHERWISE NOT EXHIBITING SUPERIOR QUALITY.
- THE CONTINUED MAINTENANCE OF ALL REQUIRED LANDSCAPING SHALL BE THE RESPONSIBILITY OF THE OWNER OF THE PROPERTY ON WHICH SAID MATERIALS ARE REQUIRED. ALL PLANT MATERIALS REQUIRED BY THIS SECTION SHALL BE MAINTAINED AS LIVING VEGETATION AND SHALL BE PROMPTLY REPLACED IF THE PLANT MATERIAL HAS DIED PRIOR TO FINAL ACCEPTANCE. PLANTING AREAS SHALL BE KEPT FREE OF TRASH, LITTER, AND WEEDS AT ALL TIMES.

1 LANDSCAPE NOTES NTS

### NOTES:

- INSPECT TREE FOR DAMAGED BRANCHES. APPLY CORRECTIVE PRUNING.
- SET ROOT BALL ON UNEXCAVATED OR TAMPED SOIL. TOP OF ROOTBALL SHALL BE TWO INCHES ABOVE SURROUNDING GRADE WITH BURLAP AND WIRE BASKET INTACT.
- REMOVE WIRE BASKET AND BURLAP DOWN FOUR TO SIX INCHES BELOW TOP OF ROOT BALL. REMOVE ALL TWINE AND IF USED, SYNTHETIC MATERIAL, REMOVE ON CORRECT GIRDLING ROOTS.
- TAMP EXCAVATED SOIL AROUND BASE OF ROOTBALL. BACKFILL REMAINDER EXCAVATED SOIL TAMPED LIGHTLY. HIGH CLAY OR POOR SOIL SHALL RECEIVE SOIL AMENDMENT PER LANDSCAPE NOTES.
- WATER THOROUGHLY WITHIN TWO HOURS USING 10 TO 15 GALLONS OF WATER.
- APPLY MULCH IN EVEN LAYER, KEEPING AWAY FROM ROOT FLARE.
- FINAL LOCATION OF TREE TO BE APPROVED BY OWNER.

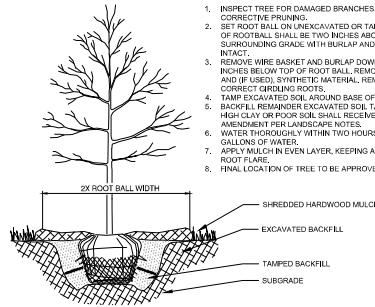

2 TREE PLANTING NTS

### NOTES:

- EXCAVATE PLANTING BED.
- BED HEIGHT IS TO BE 2" ABOVE FINISH GRADE AND WELL DRAINED.
- REMOVE CONTAINER. SCORE SOIL MASS TO REDIRECT AND PREVENT CIRCLING ROOTS. CORRECT GIRDLING ROOTS.
- PLANT MATERIAL SHALL BE LAD OUT BY FOLLOWING THE BED EDGE, WORKING TOWARDS THE CENTER OF THE BED USING TRIANGULAR (STAGGERED) SPACING AS PLAUSIBLE.
- PLUMB AND BACKFILL WITH PLANTING MIX AS SPECIFIED IN LANDSCAPE NOTES.
- APPLY MULCH IN EVEN LAYER, KEEPING AWAY FROM ROOT FLARE. MULCH LIMITS FOR PERENNIALS/GROUND COVER EXTEND TO ALL LIMITS OF PLANTING BED. SEE PLANS FOR BED LAYOUTS.
- SPACING TO BE AS SPECIFIED IN THE PLANT LIST. PERENNIALS SHALL BE PLACED WITH THEIR CENTER 24" FROM EDGE OF BED.

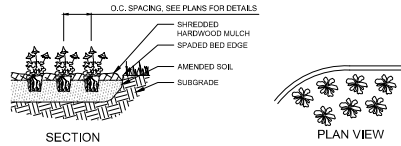

4 PERENNIAL PLANTING NTS

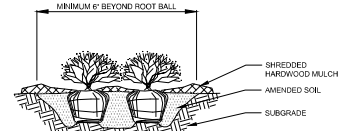

### NOTES:

- APPLY CORRECTIVE PRUNING.
- SET ROOT BALL OR CONTAINER ON UNEXCAVATED OR TAMPED SOIL. TOP OF ROOTBALL/CONTAINER SHALL BE ONE INCH ABOVE SURROUNDING GRADE. FOR LARGER SHRUBS WITHIN PLANTING BED DIG A DEEPER PIT ONLY FOR THOSE SHRUBS.
- REMOVE BURLAP FROM TOP HALF THE LENGTH OF ROOTBALL. TWINE AND IF USED SYNTHETIC MATERIAL SHALL BE REMOVED FROM PLANTING BED. FOR CONTAINER GROWN SHRUBS, REMOVE CONTAINER AND LOOSEN ROOTS PRIOR TO INSTALLATION.
- REMOVE OR CORRECT GIRDLING ROOTS.
- PLUMB AND BACKFILL WITH AMENDED SOIL PER LANDSCAPE NOTES. WATER THOROUGHLY WITHIN TWO HOURS.
- APPLY MULCH IN EVEN LAYER, KEEPING AWAY FROM ROOT FLARE. MULCH LIMITS FOR SHRUBS EXTEND TO ALL LIMITS OF PLANTING BED. SEE PLANS FOR BED LAYOUTS.

3 SHRUB PLANTING NTS

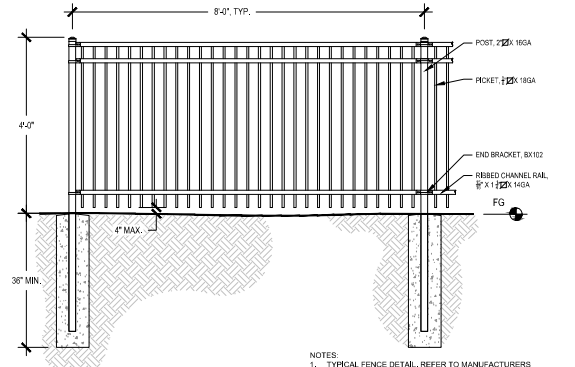

### NOTES:

- TYPICAL FENCE DETAIL. REFER TO MANUFACTURERS SPECIFICATIONS.
- POST SIZE VARIES BY FENCE HEIGHT AND WIND LOAD.
- CONCRETE FOOTING VARIES BASED ON LOCAL SOIL CONDITIONS.

5 4' ORNAMENTAL FENCE 3/4" x 1'-0"

SCALE: AS NOTED	DESIGNED BY: CALW	DATE: 02/10/20
DRAWN BY: CALW	CITY COMMENTS	CALW
CHECKED BY: JLP	REVISIONS	DATE
<b>Kimley-Horn</b>		
1001 W. MAIN STREET, SUITE 300 INDEPENDENCE, MO 64601 PH: 816-842-1000 WWW.KIMLEY-HORN.COM		
<b>LANDSCAPE NOTES &amp; DETAILS</b>		
<b>MAIN STREET PROMENADE</b>		
BENTON AVENUE & MAIN STREET INDEPENDENCE, MO 64601		
ORIGINAL ISSUE:	02/10/20	
KHA PROJECT NO.	168811000	
SHEET NUMBER	L2.0	