

- Phase 1A - Fall 2023
- Phase 1B - Summer 2024
- Phase 2 - 2025

80 40 0 80
SCALE: 1" = 80'

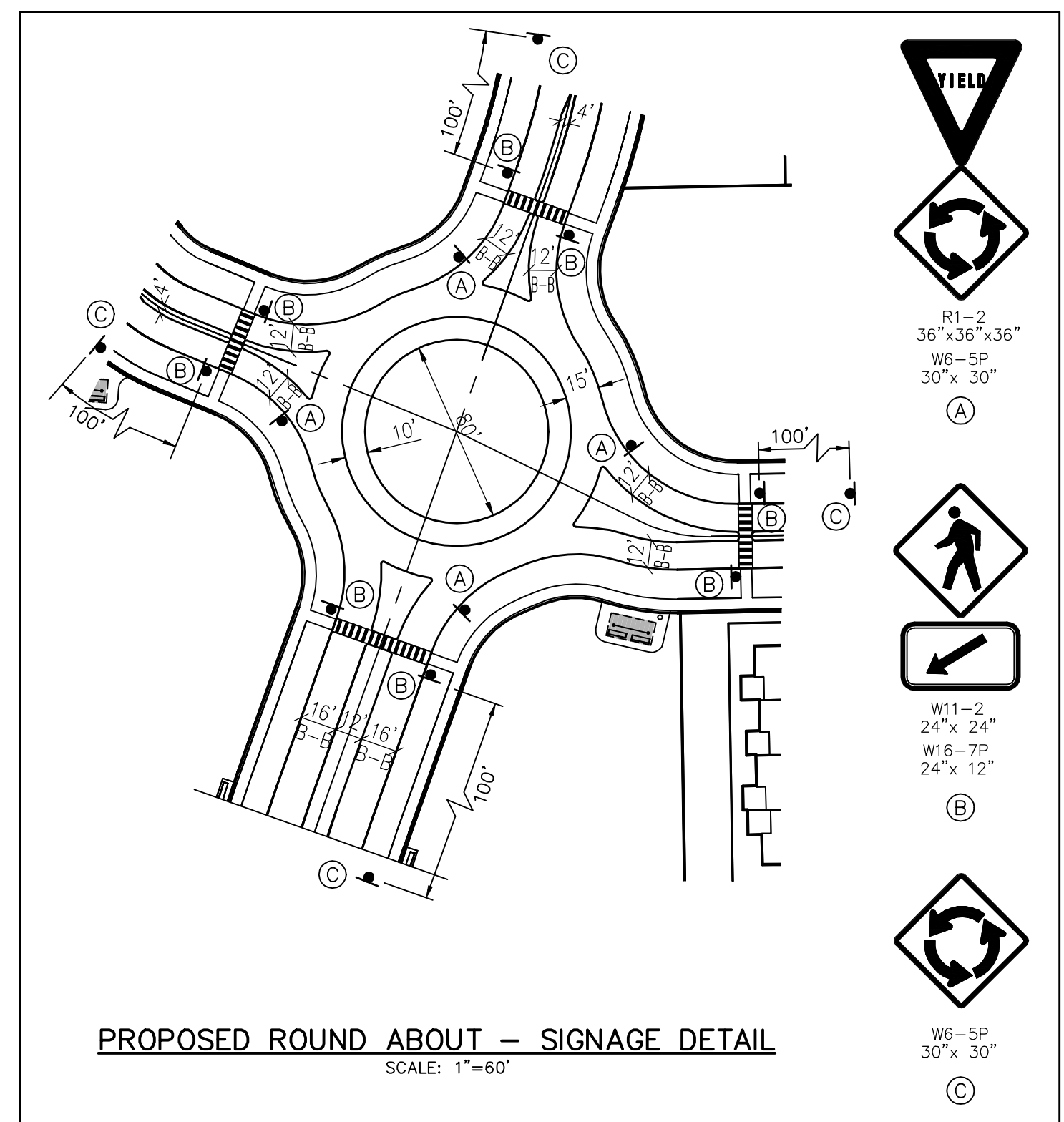

STORMWATER MANAGEMENT FACILITY 004
 HWL = 634.0
 NWL = 628.0
 STORMWATER MANAGEMENT REQUIRED=10.75 AC./FT.
 STORMWATER MANAGEMENT PROVIDED=10.96 AC./FT.

PREPARED FOR:
PULTE HOME COMPANY, LLC
 1900 E. GOLF ROAD, SUITE 300
 SCHAMBURG, IL 60173
 (847) 230-5400

PREPARED BY:
CEMCON, Ltd.
 Consulting Engineers, Land Surveyors & Planners
 2280 White Oak Circle, Suite 100
 Aurora, Illinois 60502-9675
 PH: 630.862.2100 FAX: 630.862.2199
 E-Mail: info@cemcon.com Website: www.cemcon.com

DISC NO.: 402151 FILE NAME: PROEVR
 DRAWN BY: LAL FLD. BK. / PG. NO.: ----
 COMPLETION DATE: 06-06-2022 JOB NO.: 402.151
 XREF : TOPO PROJECT MANAGER : CRM

DRAWING PATH: P:\402151\DWG\402151\DWG\PRELIMINARY\PROEVR.DWG
 PLOT FILE CREATOR: 7/16/2022 BY: LESLIE LANGRISH

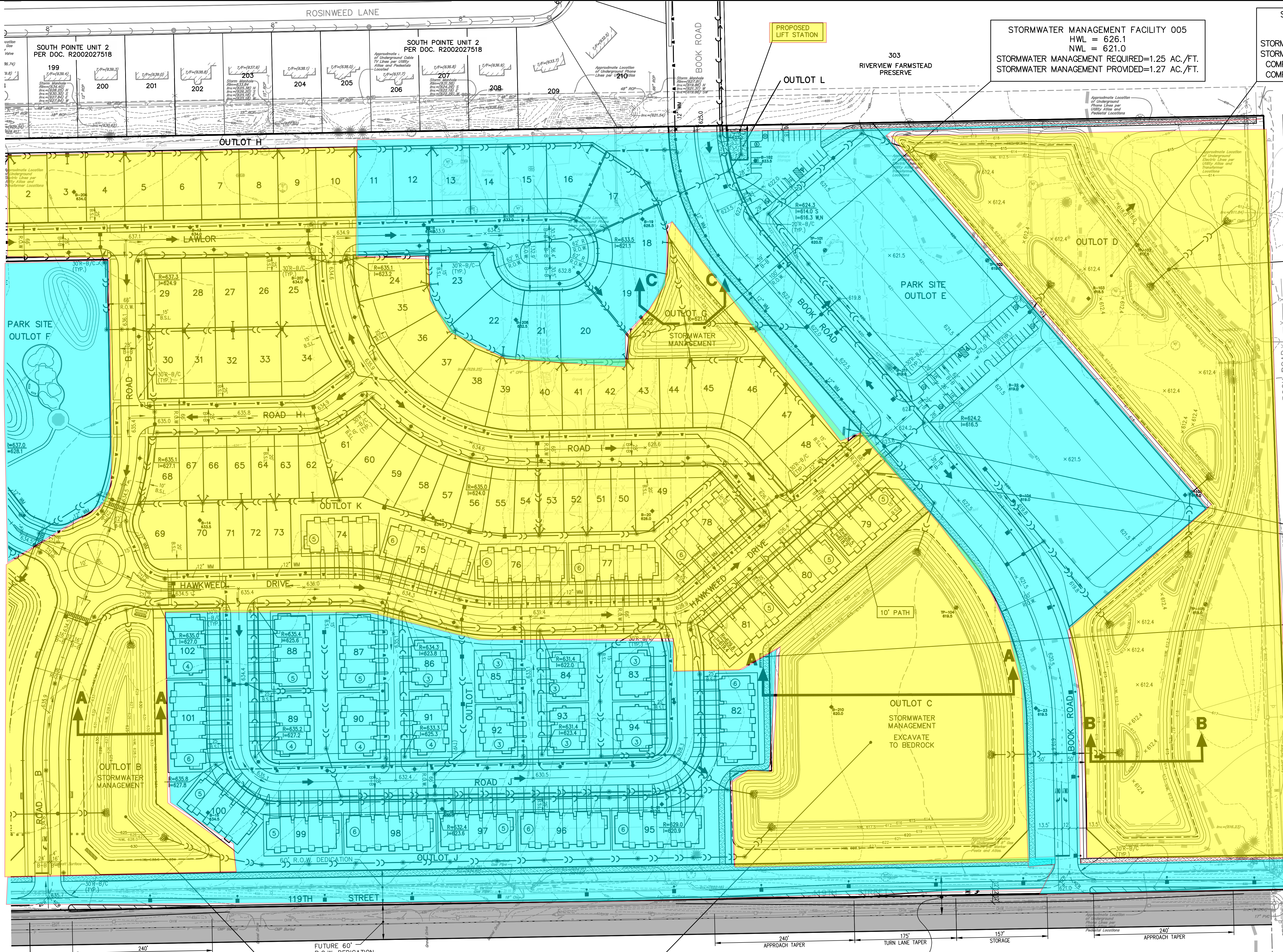

STORMWATER MANAGEMENT FACILITY 001
HWL = 616.4
NWL = 612.5
STORMWATER MANAGEMENT REQUIRED = 14.43 AC./FT.
STORMWATER MANAGEMENT PROVIDED = 22.19 AC./FT.
COMPENSATORY STORAGE REQUIRED = 2.70 AC./FT.
COMPENSATORY STORAGE PROVIDED = 3.30 AC./FT.

STORMWATER MANAGEMENT FACILITY 005
HWL = 626.1
NWL = 621.0
STORMWATER MANAGEMENT REQUIRED = 1.25 AC./FT.
STORMWATER MANAGEMENT PROVIDED = 1.27 AC./FT.

STORMWATER MANAGEMENT FACILITY 002
HWL = 623.5
NWL = 617.5
STORMWATER MANAGEMENT REQUIRED = 22.39 AC./FT.
STORMWATER MANAGEMENT PROVIDED = 22.53 AC./FT.

STORMWATER MANAGEMENT FACILITY 003
HWL = 633.9
NWL = 628.0
STORMWATER MANAGEMENT REQUIRED = 4.37 AC./FT.
STORMWATER MANAGEMENT PROVIDED = 4.43 AC./FT.

NOTE: NO CLOMR/LOMR TO BE FILED AS FLOODPLAIN LIMITS ARE NOT REQUIRED TO BE MODIFIED AS FLOODPLAIN IS NOT IN A BUILDABLE LOT.

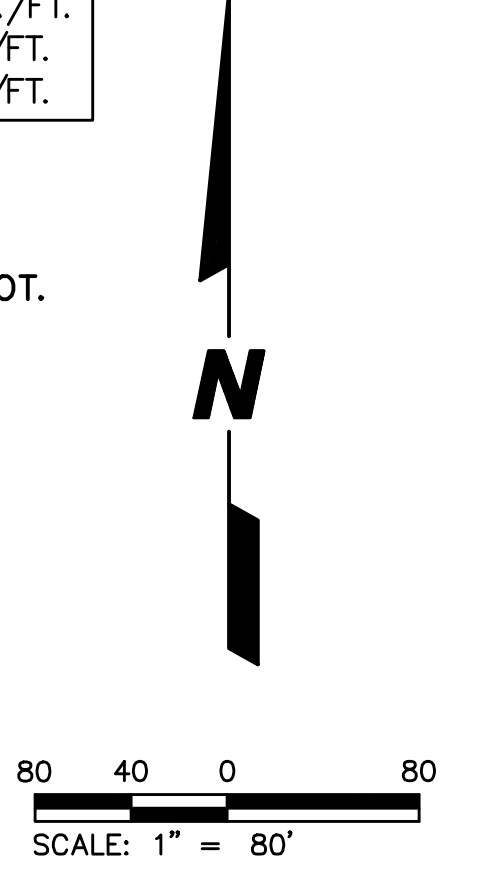

RESTRICTOR STRUCTURE

MONUMENT SIGNS
(SEE LANDSCAPE PLANS FOR DETAILS)

SITTING AREA w/ 2 BENCHES
(SEE LANDSCAPE PLANS FOR DETAILS)

APPROXIMATE SCALED LOCATION OF FLOODWAY FROM F.I.R.M. MAP

APPROXIMATE SCALED LOCATION OF FLOODPLAIN BY ELEVATION

PREPARED FOR:
PULTE HOME COMPANY, LLC
1900 E. GOLF ROAD, SUITE 300
SCHAUMBURG, IL 60173
(847) 230-5400

PREPARED BY:
CEMCON, Ltd.
Consulting Engineers, Land Surveyors & Planners
2280 White Oak Circle, Suite 100
Aurora, Illinois 60502-9675
PH: 630.862.2100 FAX: 630.862.2199
E-Mail: info@cemcon.com Website: www.cemcon.com

DISC NO.: 402151 FILE NAME: PREOVR
DRAWN BY: LAL FLD. BK. / PG. NO.: ---
COMPLETION DATE: 06-06-2022 JOB NO.: 402.151
XREF : TOPO PROJECT MANAGER : CRM

DRAWING PATH: P:\402151\DWG\PRELIM\PRELIM\PRELIM\PRELIM.DWG
PLOT FILE CREATOR: 7/16/2022 BY: LESLIE LANGBERG