

SHOWPLACE DRIVE

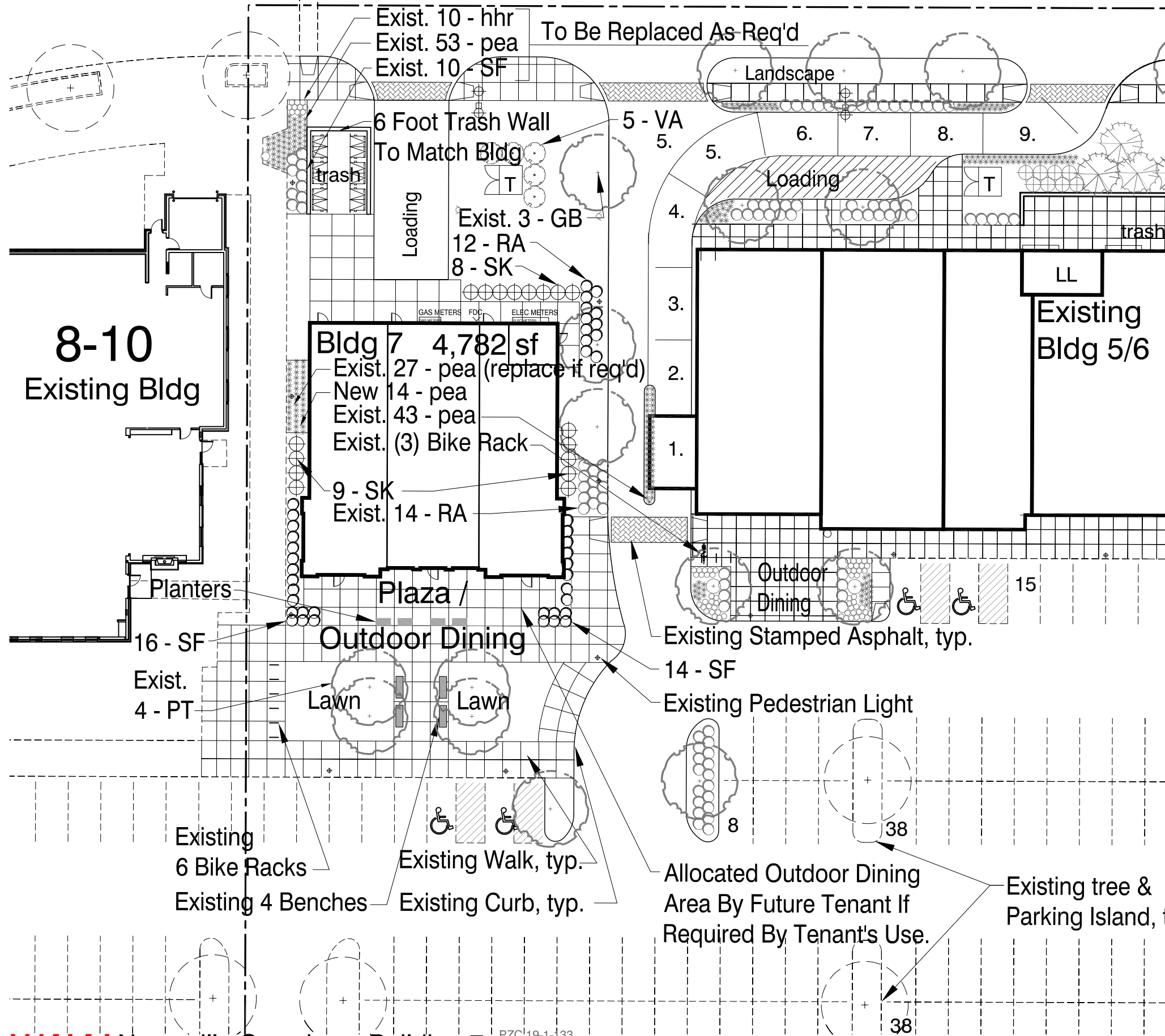

Trees			
Botanic Name	Common Name	Installation Size	
AG	Alnus glutinosa	Black Alder	M_stem 12' Ht BB
CO	Celtis occidentalis 'Windy City'	Windy City Hackberry	3" BB
GB	Ginkgo biloba	Maidenhair Tree	3" BB
GT	Gleditsia triacanthos 'Skyline'	Skyline Honeylocust	3" BB
MS	Malus 'Sentinel'	Sentinel Crabapple	3" BB
PA	Platanus x acerifolia 'Morton Circle'	London Planetree	3" BB
PI	Picea glauca densata	Norway Spruce	10' Ht BB
PT	Populus tremuloides	Quaking Aspen	M_stem 12' Ht BB
UM	Ulmus x 'Morton'	Morton Elm	3" BB

Shrubs			
Botanic Name	Common Name	Installation Size	
BG	Buxus x 'Green Velvet'	Hardy Boxwood	24" BB
EA	Euonymus alatus 'Compactus'	Compact Burning Bush	24" BB
RA	Rhus aromatica 'Gro Low'	Gro Low Sumac	24" BB
SF	Spiraea x bumalda 'Froebellii'	Froebell's Spirea	24" BB
SK	Syringa patula 'Miss Kim'	Dwarf Korean Lilac	30" BB
TT	Taxus x media 'Tauntonii'	Taunton Yew	24" BB
VA	Viburnum dentatum 'Autumn Jazz'	Autumn Jazz Viburnum	3' Ht BB

Perennials			
Botanic Name	Common Name	Installation Size	
als	Alium 'Summer Beauty'	Ornamental Onion	#1 Cont.
hhr	Hemerocallis 'Happy Returns'	Yellow Daylily	#1 Cont.
hpm	Hemerocallis 'Pardon Me'	Red Daylily	#1 Cont.
efc	Euonymus fortunei 'Coloratus'	Purpleleaf Wintercreeper	#1 Cont.
pea	Pennisetum alopecuroides 'Cassian'	Cassian Fountain Grass	#1 Cont.
ssn	Sedum spectabile 'Neon'	Neon Sedum	#1 Cont.

Trees shall be installed a min. of 5 ft horizontally from underground elect. feeders, sanitary & storm sewers lines, sanitary services, water mains & water services. Trees shall be installed a min. of 10 ft horizontally from utility & storm structures & appurtenances, including but not limited to manholes, valve vaults, valve boxes & fire hydrants. no trees, shrubs or obstacles will be allowed 10 ft in front of, 5 ft on sides & 7 ft to the rear of the elect. transformer.