



NORTHWIND SWITCHGRASS



STONECROP SEDUM



FEATHER REED GRASS



LIRIOPE PERENNIAL

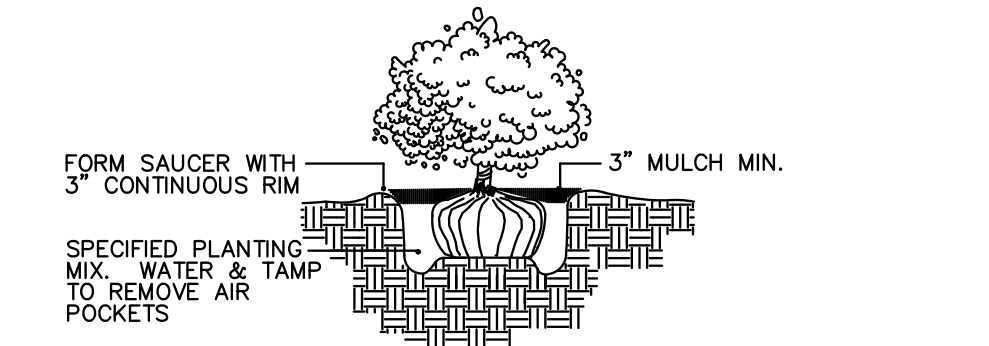

SHRUB PLANTING NOT TO SCALE

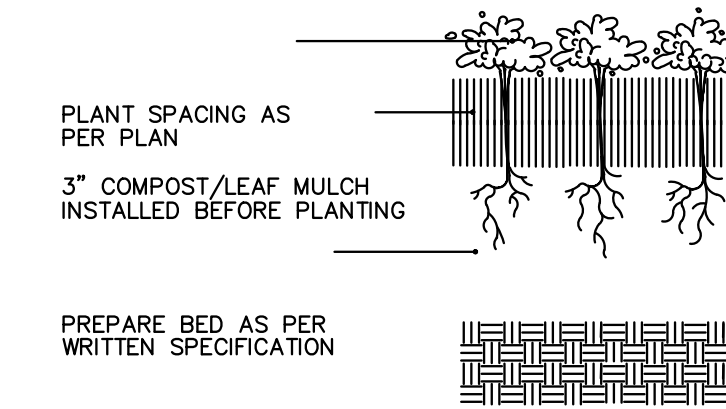

PERENNIAL PLANTING DETAIL NOT TO SCALE



RED TWIG DOGWOOD

PLANT & MATERIALS LIST				
SYMBOL	QTY	SIZE	BOTANIC NAME	COMMON NAME
ORNAMENTAL GRASSES				
	15	1 Qt.	Panicum virgatum	Northwind Switchgrass
	17	1 Qt.	Calamagrostis x acutiflora 'Karl Foerster'	Feather Reed Grass
PERENNIALS				
	151	EA	Sedum spectabile	Stonecrop Sedum
	147	EA	Liriope muscari	Liriope Perennial
SHRUBS				
	20	3 Gal.	Cornus sericea	Red Twig Dogwood
MATERIALS				
-	10	CY		Soil Amendment
-	12	CY		Shredded Hardwood Mulch
-	75	SY	Turf Restoration or New Turf - Kentucky Bluegrass Blend Seed & Blanket or Sod (mineral, not peat)	

SITE AREA STATISTICS

TOTAL OWNERSHIP AREA:	20,005 SF	0.46 AC
OVERALL DISTURBED / DEVELOPMENT AREA:	20,005 SF	0.46 AC

	DEVELOPMENT AREA STATISTICS			
	EXISTING CONDITIONS (SF)	EXISTING CONDITIONS (AC)	PROPOSED CONDITIONS (SF)	PROPOSED CONDITIONS (AC)
PERVIOUS (GRASSED) AREA	6,756	0.16	2,149	0.05
PERMEABLE PAVERS BMP AREA		0.00	2,166	0.05
IMPERVIOUS (WET POND HWL) AREA	0	0.00	0	0.00
IMPERVIOUS (BUILDING) AREA	5,035	0.12	5,035	0.12
IMPERVIOUS (PAVEMENT & CURB) AREA	8,214	0.19	10,655	0.24
TOTAL AREA	20,005	0.46	20,005	0.46
TOTAL IMPERVIOUS AREA	13,249	0.76	15,690	0.87
PERCENT IMPERVIOUS		66.2%		78.4%
NET NEW IMPERVIOUS				2,441

PARKING SUMMARY

PARKING PROVIDED = 16 STALLS INCLUDING 1 HC SPACE

STABILIZATION TYPE	JAN.	FEB.	MAR.	APR.	MAY	JUN.	JUL.	AUG.	SEP.	OCT.	NOV.	DEC.
PERMANENT SEEDING			A									
DORMANT SEEDING	B											
TEMPORARY SEEDING			C			D						
SODDING			E									
MULCHING	F											

- A. - KENTUCKY BLUEGRASS 68 LBS/ACRE MIXED WITH CREEPING RED FESCUE 16 LBS/ACRE
- B. - KENTUCKY BLUEGRASS 136 LBS/ACRE MIXED WITH PERENNIAL RYEGRASS 45 LBS/ACRE PLUS 2 TONS STRAW MULCH PER ACRE
- C. - SPRING OATS 100 LBS/ACRE
- D. - WHEAT OF CEREAL RYE 150 LBS/ACRE
- E. - SOD
- F. - STRAW MULCH 2 TONS/ACRE

- * IRRIGATION NEEDED DURING JUNE AND JULY
- ** IRRIGATION NEEDED FOR 2 TO 3 WEEKS AFTER APPLYING SOD

SOIL PROTECTION CHART

NOTES

- ALL PLANTING BEDS SHALL:
 - HAVE AT LEAST 4" - 8" OF TOPSOIL INSTALLED PRIOR TO PLANTING BE PREPARED WITH A TWO INCH (2") LAYER OF PEAT MOSS, ALONG WITH A ONE INCH (1") LAYER OF MUSHROOM COMPOST, AND A GRANULAR FERTILIZER.
 - INSTALLED IN ACCORDANCE WITH THE PLANTING PROCEDURES ESTABLISHED BY THE AMERICAN ASSOCIATION OF NURSERYMEN.
 - RECEIVE SHREDDED HARDWOOD MULCH AT A DEPTH OF 3" (NON-COLORED, NON-DYED) HAVE A SHADED EDGE.
- PLANTS SHALL BE:
 - ALLOWED TO GROW AND BE MAINTAINED IN THEIR NATURAL FORM
 - MAINTAINED IN GOOD CONDITION AT ALL TIMES. ALL DEAD, DISEASED, OR DAMAGED PLANT MATERIAL SHALL BE REPLACED PROMPTLY WITH LIVE MATERIAL IN GOOD CONDITION AND IN QUANTITIES AND SIZES THAT MEET THE REQUIREMENTS OF THE MUNICIPALITY.
- THE DPU-E ENGINEER FOR THIS PROJECT IS ERIC MIKSZTA. PLEASE CONTACT HIM AT (630) 420-6180 WITH ANY QUESTIONS REGARDING THE ELECTRIC SERVICE. NO ENCROACHMENTS ARE ALLOWED IN THE UTILITY EASEMENTS. DPU-E REQUIRES A MINIMUM 6' OF SEPARATION BETWEEN ITS ELECTRIC FACILITIES AND ANY FIRE HYDRANT'S STORM DRAINS, STORM SEWERS, WATER MAINS, GAS MAINS, ETC. THAT RUN PARALLEL TO ITS FACILITIES.
- LOCATIONS OF PLANT MATERIAL ARE SUBJECT TO CHANGE BASED ON FINAL GRADING AND SITE UTILITIES.
- PLANT QUANTITIES ARE APPROXIMATIONS. CONTRACTORS ARE RESPONSIBLE FOR COMPLETING THEIR OWN QUANTITY TAKE-OFFS. IF A DISCREPANCY BETWEEN THE PLAN AND THE PLANT LIST ARISES, THE PLAN SHALL PREVAIL.
- PLANT SUBSTITUTIONS ARE ALLOWED ONLY WITH PRIOR APPROVAL FROM THE OWNER. IF PRIOR APPROVAL WAS NOT GRANTED, PLANT SUBSTITUTIONS CAN BE REJECTED IN FIELD, REPLACED AT THE COST TO THE INSTALLING CONTRACTOR.
- TREES SHALL BE INSTALLED A MINIMUM OF FIVE (5) FEET FROM UNDERGROUND ELECTRICAL FEEDERS, SANITARY SEWERS, SANITARY SERVICES, WATER MAINS AND WATER SERVICES. TREES SHALL BE INSTALLED A MINIMUM OF TEN (10) FEET HORIZONTALLY FROM UTILITY STRUCTURES AND APPURTENANCES, INCLUDING BUT NOT LIMITED TO, MANHOLES, VALVE VAULTS, VALVE BOXES AND FIRE HYDRANTS.
- THE DPU-E ENGINEER FOR THIS PROJECT IS ERIC MIKSZTA. PLEASE CONTACT HIM AT (630) 420-6180 WITH ANY QUESTIONS REGARDING THE ELECTRIC SERVICE.
- NO ENCROACHMENTS ARE ALLOWED IN THE UTILITY EASEMENTS.
- DPU-E REQUIRES A MINIMUM 6' OF SEPARATION BETWEEN ITS ELECTRIC FACILITIES AND ANY FIRE HYDRANT'S STORM DRAINS, STORM SEWERS, WATER MAINS, GAS MAINS, ETC. THAT RUN PARALLEL TO ITS FACILITIES.

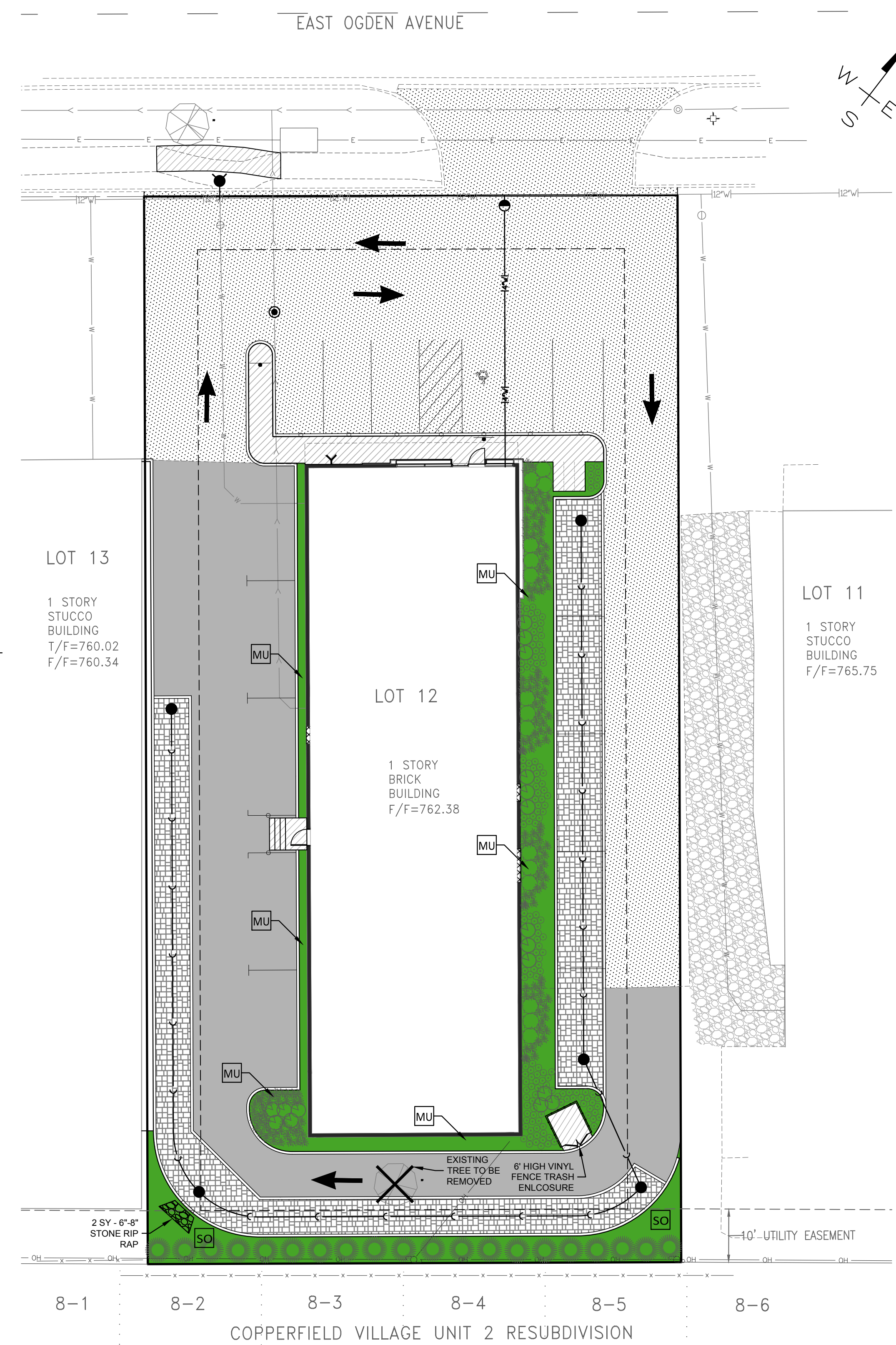

6' HIGH VINYL FENCE TRASH ENCLOSURE

LEGEND

- SODDING
- MULCH

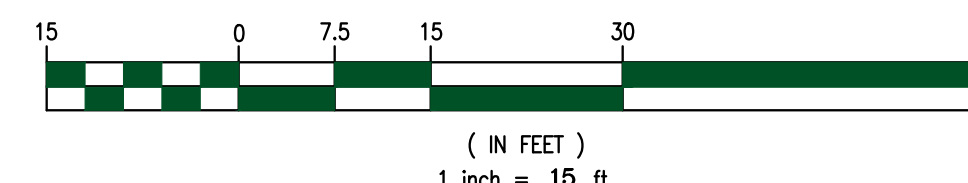

Civil Engineering & Land Development Consulting
 26316 Mapleview Drive
 Plainfield, IL 60585
 815.577.1707 T 815.577.2895 F
 www.cookengr.com

COOK ENGINEERING GROUP

#	DATE	REVISION DESCRIPTION
1	06/20/2022	PER CITY REVIEW DATED 06/27/22
2	08/07/2022	PER CITY REVIEW DATED 08/28/22
3		
4		
5		
6		
7		
8		
9		
10		

LANDSCAPE PLAN
G&G PEDIATRIC DENTISTRY
 1108 EAST OGDEN AVENUE
 NAPERVILLE, ILLINOIS

PREPARED FOR
 APEX DESIGN BUILD, INC
 9550 W HIGGINS RD, STE 170
 ROSEMONT, IL 60018
 847-960-1784 (T)

MR. JASON BERGWERFF
 CEG JOB NUMBER
 2022-109
 SCALE: 1" = 15'
 DRAWN BY: CNW
 CHECKED BY: MDC
 DATE: 04/28/2022
 SHEET: 1 of 1
 © Copyright, 2022