

Calculation Summary	Category	Units	Req	Min	Max	Actual
Level at Front of Building	illumination	fc	5.0	2.0	2.0	2.0
Entrance Area	illumination	fc	10.0	5.0	5.0	5.0
Walk Parking Area	illumination	fc	3.50	1.5	1.5	1.5
Open Drive Aisle	illumination	fc	2.18	1.2	1.2	1.2

Luminaire Schedule	Qty	Label	Arrangement	Description	SPR	MF	Footcandle Density	Luminaire Watts	Total Watts
1	1	SL-42	Single	For use with Series E EDGE, 250, 104 and 10700 luminaires	0.800	10703	101	103	103
1	1	SL-43	Back-back	For use with Series E EDGE, 250, 104 and 10700 luminaires	0.800	10703	101	202	202
1	1	SL-43	3 @ 90 degree	For use with Series E EDGE, 250, 104 and 10700 luminaires	0.800	10703	101	303	303
1	1	SL-44	Single	For use with Series E EDGE, 250, 104 and 10700 luminaires	0.800	10703	101	202	202
1	1	SL-44	3 @ 90 degree	For use with Series E EDGE, 250, 104 and 10700 luminaires	0.800	10703	101	303	303
1	1	SL-44	Single	For use with Series E EDGE, 250, 104 and 10700 luminaires	0.800	10703	101	202	202
1	1	SL-43	Single	For use with Series E EDGE, 250, 104 and 10700 luminaires	0.800	10703	101	202	202

- THE SITE LIGHTING IS DESIGNED TO MEET THE FOLLOWING CRITERIA EXCEPT WHERE LIMITED BY SITE CONSTRAINTS AND LOCAL REQUIREMENTS:
 - AVG MAINTAINED HORIZONTAL ILLUMINATION LEVEL AT FINISHED GRADE NO LESS THAN 3.6FC AT TRUCKWELL, RAMPS, STAIRS, EXTERIOR DINING, CANOPY AND MAIN ENTRY/EXIT AREAS.
 - AVG MAINTAINED HORIZONTAL ILLUMINATION LEVEL AT FINISHED GRADE NO LESS THAN 3.6 FC AT THE FRONT ENTRY AND FIRELANE AREA.
 - AVG MAINTAINED HORIZONTAL ILLUMINATION LEVEL AT FINISHED GRADE NO LESS THAN 3.6 FC AT THE FRONT PARKING AREAS.
 - AVG MAINTAINED HORIZONTAL ILLUMINATION LEVEL AT FINISHED GRADE NO LESS THAN 3.6 FC AT THE REAR PAVED AREAS AND DRIVE AISLES.
 - MINIMUM MAINTAINED HORIZONTAL ILLUMINATION LEVEL AT FINISHED GRADE OF 0.9 FC AT ALL PAVED PARKING AND WALKING SURFACES.
 - UNIFORMITY RATIO FOR EACH AREA SHALL BE LESS THAN 4:1.
- PHOTOMETRIC CALCULATION GRID SHALL NOT EXCEED A 10' X 10' SPACING.
- THE TOTAL LIGHT LOSS FACTOR USED FOR THE CALCULATIONS SHALL BE .85 OF INITIAL LUMEN OUTPUT FOR LED SOURCES.
- MAXIMUM LUMINAIRE MOUNTING HEIGHT (INCLUDING POLE AND BASE) OF 25' ABOVE FINISHED GRADE.

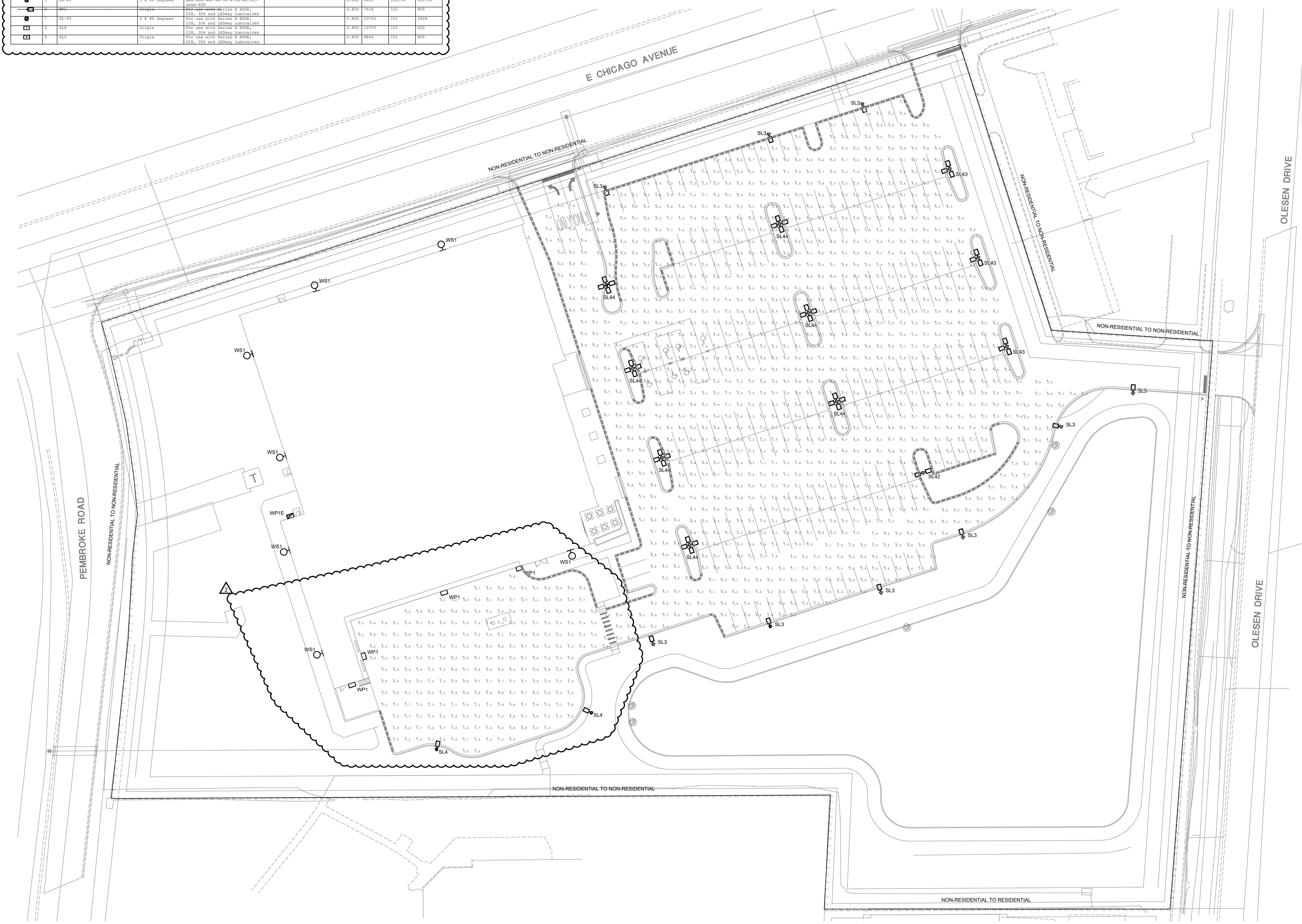

1 SITE LIGHTING PHOTOMETRICS
1"=30'-0"

